

KINGSMEN (THAMES) INC. / Havelock Corners (Kingsmen)

Lot/Unit: 65 Phase/Building: 5B Model/Floor Plan: James (3601) Elev C 4 Bed - 2+1 Bath

ELECTRICAL

Inv.6366	1 - To supply & install the standard T.V. rough in in the great room and master bedroom... see sketch # 1 & # 2	
Line 79996	Note:	
14Aug23 / 15Aug23		
Inv.6366	1 - To supply & install the standard Phone (CAT5) rough in in the great room, master bedroom and bedroom # 2 ... see sketch # 1 & # 2	
Line 79997	Note:	
14Aug23 / 15Aug23		

HEATING AND AIR CONDITIONING

Inv.6366	1 - As per schedule "PE": Vendor to install capped gas line (Rough in only) at rear of home for future BBQ location. Location to be finalized at vendors sole discretion.	
Line 79994	Note:	
14Aug23 / 15Aug23		
Inv.6366	1 - As per schedule "PE": Vendor to supply & install air conditioning unit, sized accordingly, from vendors standard samples.	
Line 79995	Note:	
14Aug23 / 15Aug23		

EXTRAS AS PER OFFER

5 FREE APPLIANCES – STAINLESS STEEL FRONT - FRIDGE; STOVE AND DISHWASHER. WHITE WASHER AND DRYER (SUPPLIED ONLY, NOT INSTALLED, FROM BUILDERS STANDARD LINE). AN APPLIANCES VOUCHER WILL BE GIVEN BY OUR DECOR CONSULTANT AT THE TIME OF BOOKING YOUR COLOUR A Worksheet Note:	
VENDOR TO INSTALL CAPPED GAS LINE (ROUGH-IN ONLY) AT REAR OF HOME FOR FUTURE BBQ LOCATION. LOCATION TO BE FINALIZED AT VENDORS SOLE DISCRETION. Worksheet Note:	
VENDOR TO SUPPLY & INSTALL AIR CONDITIONING UNIT, SIZED ACCORDINGLY, FROM VENDORS STANDARD SAMPLES. Worksheet Note:	

Purchaser:AMANPREET,S SAHOTA,Telephone Res. / Bus: /Decor Advisor:Barbara CocciaLayout Changes: ☐ Yes ☒ NoSketch Attached: ☒ Yes ☐ NoExterior Colour Scheme:

Property: 65 of Plan - Draft Approval SB17-03-08Project: KINGSMEN (THAMES) INC.Model and Elevation: James (3601) Elev C 4 Bed - 2+1 Bath

1. Cabinetry	Style and Colour	Counter Top	Hardware
Kitchen / Breakfast	# 3 Simcoe Rain Cloud	#1, C/S # 9141 Ice Snow 3cm.	# 12881 Handle
Kitchen Island	# 3 Simcoe Rain Cloud	#1, C/S # 9141 Ice Snow 3cm.	# 12881 Handle
Laundry Room	/		
Powder Room	# 3 Simcoe Rain Cloud	# 6698-46 Paloma Polar	# 12881 Handle
Main Bathroom	# 3 Simcoe Moonlight	# 6698-46 Paloma Polar	# 12881 Handle
Master Ensuite Bathroom	# 3 Simcoe Moonlight	# 6698-46 Paloma Polar	# 12881 Handle
Second Ensuite Bathroom (If Applicable)	/		
	/		
	/		

AppliancesCustom Size Fridge☐ Yes ☒ NoCooktop / Rangetop☐ Yes ☒ NoValance Lighting☐ Yes ☒ NoBuilt in Wall Oven☐ Yes ☒ NoMicrowave / Range Hood☐ Yes ☒ NoSlide-in Range☐ Yes ☒ No

Comment

2. Flooring

	Selection
Foyer	13 x13" Cinq White
Main Hall	13 x13" Cinq White
Back Hall	/
Breakfast	13 x13" Cinq White
Laundry Room	13 x13" Cinq White
Kitchen	13 x13" Cinq White
Powder Room	13 x13" Cinq White
Main Bathroom	13 x13" Cinq White
Master Ensuite	13 x13" Cinq White
Bathroom (If Applicable)	/
Mud Room	13 x13" Cinq White
Master ens. shower floor:	2x2" Ontario Snow White Matte
Living Room	/
Dining Room	/
Family / Great Room	3 1/2" Elements Oak Natural
Den / Library / Study	/
Basement Landing (If Applies)	
Lower Landing (If Applicable)	3 1/2" Elements Oak Natural
Upper Landing	(if applicable) 3 1/2" Elements Oak Natural
Upper Hall	Modern Story 1, # 945 Felt Hat
Master Bedroom	Modern Story 1, # 945 Felt Hat
Bedroom #2	Modern Story 1, # 945 Felt Hat
Bedroom #3	Modern Story 1, # 945 Felt Hat
Bedroom #4	Modern Story 1, # 945 Felt Hat
Bedroom #5	/
Master ens. shower jamb:	Anatolia Marmiline SNOW

SEE ATTACHED FOR SIGNATURES

Purchaser: AMANPREET,S SAHOTA,

Property: 65 of Plan - Draft Approval SB17-03-08

Telephone Res. / Bus: /

Project: KINGSMEN (THAMES) INC.

Decor Advisor: Barbara Coccia

Model and Elevation: James (3601) Elev C 4 Bed - 2+1 Bath

2. Flooring - Continued -

Upgrade Underpad	Type	Area
	Standard	2nd. floor
Carpet on Stairs	Capped	Runner - *Upgrade
Comment	/	/

3. Plumbing Fixtures / Faucets

Kitchen	Standard	Second Ensuite	/	Powder Room	Standard
Master Ensuite	Standard			Other Room	/
Main Bathroom	Standard		/		

Comment

Still to install the standard top mount kitchen sink.

4. Wall Tile

	Tile Selection	Listello	Insert	Insert Selection
Main Bathroom	8x10" Cinq Grey	<input type="checkbox"/>	<input type="checkbox"/>	
Master Ensuite				
Tub Deck	13 x13" Cinq White	<input type="checkbox"/>	<input type="checkbox"/>	
Tub Apron	13 x13" Cinq White	<input type="checkbox"/>	<input type="checkbox"/>	
Tub Surround	13 x13" Cinq White	<input type="checkbox"/>	<input type="checkbox"/>	
Shower Stall	8x10" Cinq Grey	<input type="checkbox"/>	<input type="checkbox"/>	
Second Ensuite	/	<input type="checkbox"/>	<input type="checkbox"/>	
	/	<input type="checkbox"/>	<input type="checkbox"/>	
	/	<input type="checkbox"/>	<input type="checkbox"/>	
Kitchen Backsplash	/	<input type="checkbox"/>	<input type="checkbox"/>	
Complete Backsplash	/	<input type="checkbox"/>	<input type="checkbox"/>	

Comment

/



horizontal stacked



brick pattern



vertical stacked



diagonal/diamond

5. Fireplace

Living Room

Purchased ☐ As Per Plan ☐ N/A ☒

Family Room

Purchased ☐ As Per Plan ☐ N/A ☒

Other Room - Specify Great Room

Purchased ☐ As Per Plan ☒ N/A ☐

Fireplace Type

Mantle Type

Over Mantle

Colour / Stain

Surround

Hearth

Comment

/

Front Facing

NF-08

/

White

/

/

SEE ATTACHED FOR SIGNATURES

Initial:



Page 2 of 3

Purchaser: AMANPREET, S SAHOTA,

Property: 65 of Plan - Draft Approval SB17-03-08

Telephone Res. / Bus: /

Project: KINGSMEN (THAMES) INC.

Decor Advisor: Barbara Coccia

Model and Elevation: James (3601) Elev C 4 Bed - 2+1 Bath

6. Trim Carpentry

Door Hardware Standard Handle

Interior Trim Standard

Comment

/

Interior Doors

☐ 2 Panel Arch Top

☒ 2 Panel Square Top

☐ 6 Panel

Initial for Door Style

7. Railings and Pickets

Railing Package Standard oak STRAIGHT picket package

Railing Colour Elements Natural

Picket Colour Elements Natural

Wood Stairs ☐ No ☒ Oak

Tread Colour Elements Natural

Comment

/

SEE ATTACHED FOR SIGNATURES

8. Plaster Mouldings and Medallions

Foyer /

Kitchen/Breakfast /

Main Hall /

Den/Library /

Living Room /

Lower Landing /

Dining Room /

Family Room /

Comment

/

9. Wall Paint

Kingsmen White

Smooth Ceilings

☐ First Floor

☐ First Floor incl. Second Floor Hall

☐ First and Second Floor

☒ Throughout

☐ Not Applicable

Trim Paint Kingsmen White

10. Additional Comments

/

11. Disclaimers and Notes

- Colours of all materials are as close as possible to builder's selection, but not necessarily identical due to variances in manufacturing.
- Any extras listed above are null and void unless accompanied by a separate invoice/amendment. Said invoice must be paid in full.
- The Purchaser acknowledges that after Interior Colour Selection form is signed and dated, no further changes will be permitted other than re-selection due to unavailability. Purchaser's Initials
- The Purchaser acknowledges reading and accepting the "Kingsmen Group Décor Centre Disclaimers" form. This document contains other miscellaneous disclaimers.

SEE ATTACHED FOR SIGNATURES

This Interior Colour Selection is final and approved by:

Purchaser:

Signature: _____ Date: _____

SEE ATTACHED FOR SIGNATURES

Vendor:

KINGSMEN (THAMES) INC.

SCHEDULE "B-1"
Floor Plan

5B-65

Lot 65
Phase 5B
Standard

Model: James (3601) Elev C 4 Bed - 2+1 Bath

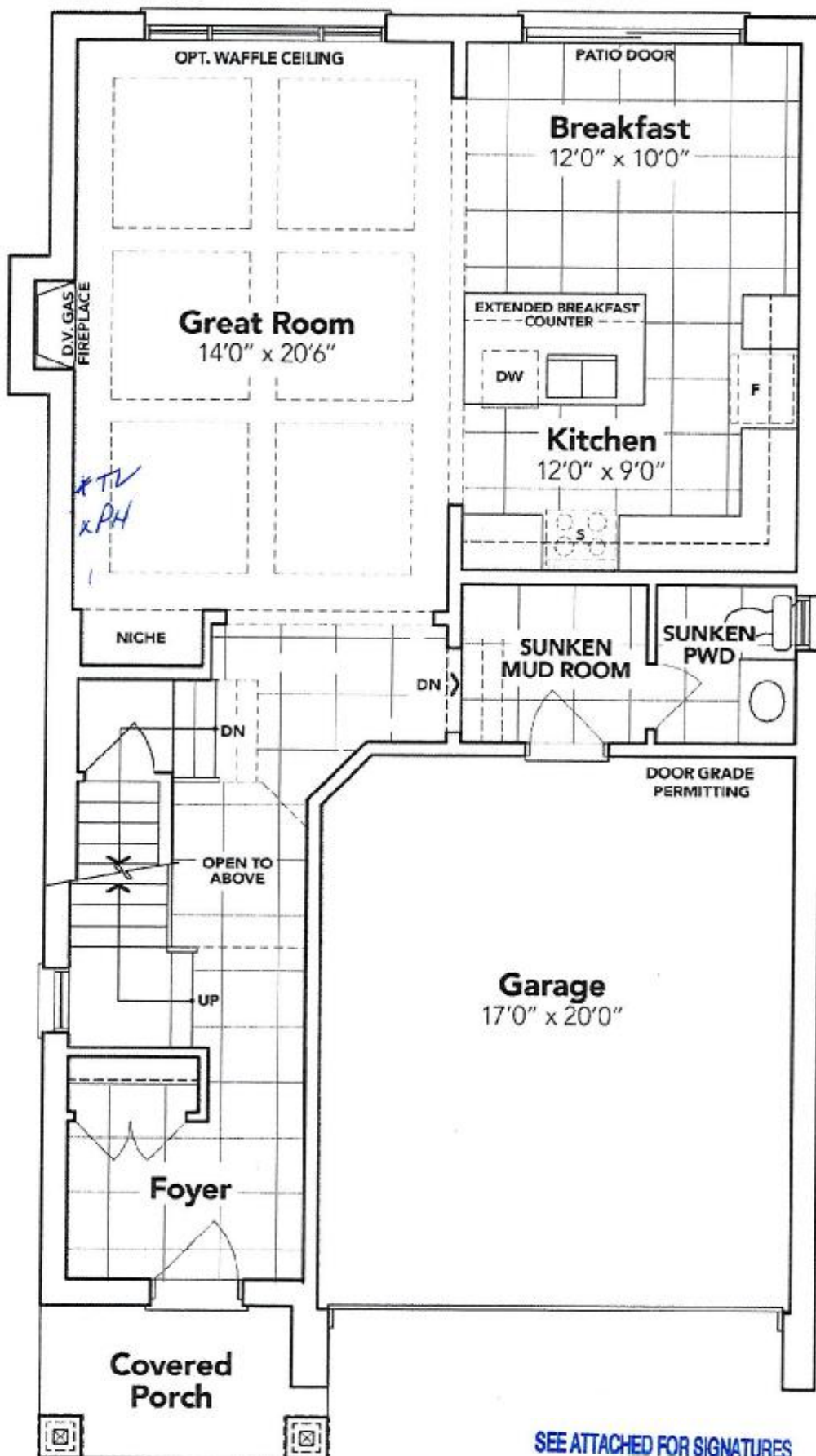

GROUND FLOOR EL. C

The floor plans and elevations shown are pre-construction plans and may be revised or improved as necessitated by architectural controls and the construction process. The measurements adhere to the rules and regulations of the TARION Warranty Corporation's official method for the calculation of floor area. Materials, specifications and floor plans are subject to change without notice. All house renderings are artist's concept only. Actual usable floor space may vary from the stated floor area. All options shown are upgrades. E. & O. E.

SCHEDULE "B-1"
Floor Plan

SB-65

Lot 65

Phase 5B

Model: James (3601) Elev C 4 Bed - 2+1 Bath
Standard

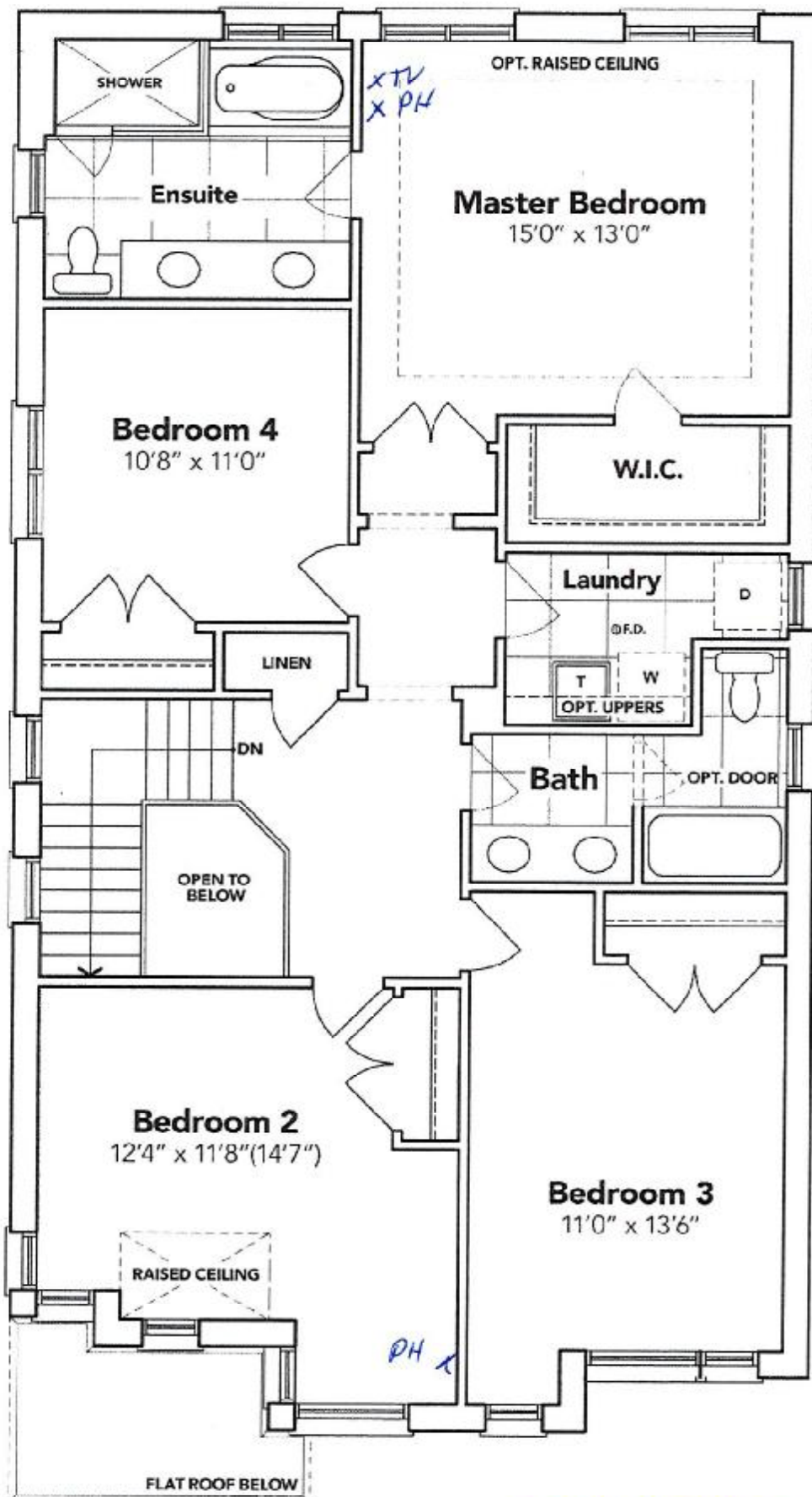

SEE ATTACHED FOR SIGNATURES

SECOND FLOOR EL. C

The floor plans and elevations shown are pre-construction plans and may be revised or improved as necessitated by architectural controls and the construction process. The measurements adhere to the rules and regulations of the TARION Warranty Corporation's official method for the calculation of floor area. Materials, specifications and floor plans are subject to change without notice. All house renderings are artist's concept only. Actual usable floor space may vary from the stated floor area. All options shown are upgrades. E. & O. E.

SCHEDULE "B-1"
Floor Plan

5B-65
Lot 65
Phase 5B
Model: James (3601) Elev C 4 Bed - 2+1 Bath
Standard

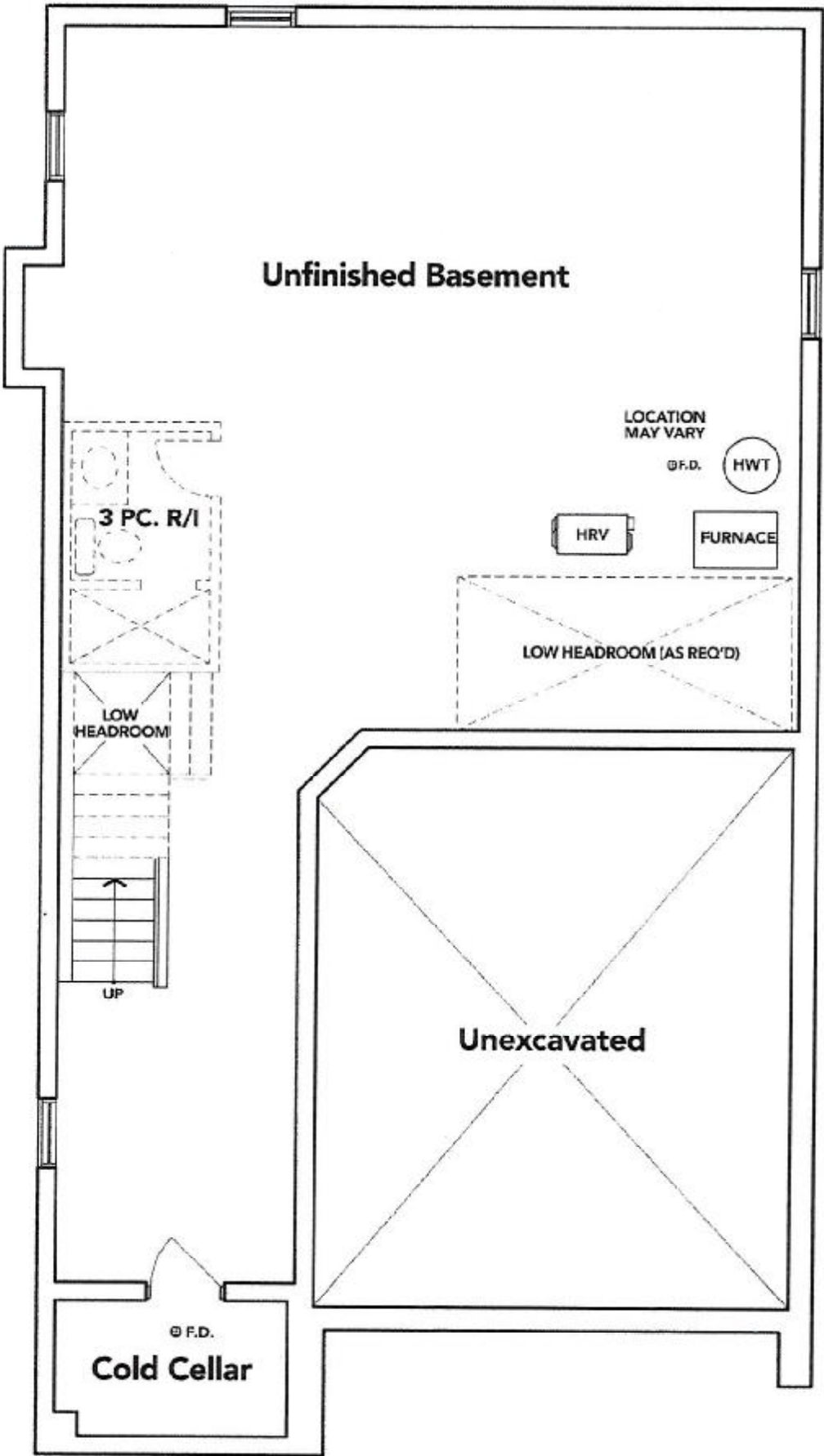

BASEMENT EL. C

 SEE ATTACHED FOR SIGNATURE

The floor plans and elevations shown are pre-construction plans and may be revised or improved as necessitated by architectural controls and the construction process. The measurements adhere to the rules and regulations of the TARION Warranty Corporation's official method for the calculation of floor area. Materials, specifications and floor plans are subject to change without notice. All house renderings are artist's concept only. Actual usable floor space may vary from the stated floor area. All options shown are upgrades. E. & O. E.