



CONSTRUCTION SUMMARY

KINGSMEN (THAMES) INC. / Havelock Corners (Kingsmen)

Lot/Unit: 37 Phase/Building: 5B Model/Floor Plan: Arthur (4205) Elev B 4 Bed - 4+1 Bath

CABINETRY HOOD FANS

Inv.6340	1 - To supply & install the HOOD FAN - COLLECTION (SCB51930) WALL MOUNT RANGE HOOD WITH BAFFLED GRILLS AND WITH 550 CFM FAN - 30 INCH in lieu of the standard stainless steel hood fan... see spec's	
Line 79724	Note:	
20Jul23 / 20Jul23		
Inv.6340	1 - To accomodate for the upgraded 30" chimney hood fan... see spec's	
Line 79725	Note:	
20Jul23 / 20Jul23		

ELECTRICAL

Inv.6340	1 - To supply & install the standard T.V. rough in in the great room and master bedroom... see sketch # 1 & # 2	
Line 79717	Note: Install the standard T.V. rough in at approx. 66" + - up from the floor centered + - to the F/P mantle in the great room.	
20Jul23 / 20Jul23		
Inv.6340	1 - To supply & install the standard Phone (CAT5) rough in in the great room, master bedroom and media niche area ... see sketch # 1 & # 2	
Line 79718	Note: Install the standard Phone (CAT 5) rough in at approx. 66" + - up from the floor centered + - to the F/P mantle in the great room.	
20Jul23 / 20Jul23		
Inv.6340	1 - To SUPPLY AND INSTALL AN ADDITIONAL BASIC RECEPTACLE (NOT DEDICATED) at approx. 66" + - up from the floor centered + - to the F/P mantle	
Line 79721	Note: in the great room... see sketch # 1	
20Jul23 / 20Jul23		
This is for a future wall mount T.V. NO CONDUIT PIPE HAS BEEN PURCHASED.		

HEATING AND AIR CONDITIONING

Inv.6340	1 - As per schedule "PE": Vendor to install capped gas line (Rough in only) at rear of home for future BBQ location. Location to be finalized at vendors sole discretion.	
Line 79715	Note:	
20Jul23 / 20Jul23		
Inv.6340	1 - As per schedule "PE": Vendor to supply & install air conditioning unit, sized accordingly, from vendors standard samples.	
Line 79716	Note:	
20Jul23 / 20Jul23		

MISCELLANEOUS

Inv.6340	1 - To supply & install the standard COFFERED CEILING in the dining room as per plan.	
Line 79719	Note:	
20Jul23 / 20Jul23		
Inv.6340	1 - Enlarge the wall slightly on great room side to accomodate the standard NF-08 F/P mantle.	
Line 79720	Note:	
20Jul23 / 20Jul23		



CONSTRUCTION SUMMARY

KINGSMEN (THAMES) INC. / Havelock Corners (Kingsmen)

Lot/Unit: 37 Phase/Building: 5B Model/Floor Plan: Arthur (4205) Elev B 4 Bed - 4+1 Bath

EXTRAS AS PER OFFER

5 FREE APPLIANCES ? STAINLESS STEEL FRONT - FRIDGE: STOVE AND DISHWASHER. WHITE WASHER AND DRYER (SUPPLIED ONLY, NOT INSTALLED, FROM BUILDERS STANDARD LINE). AN APPLIANCES VOUCHER WILL BE GIVEN BY OUR DECOR CONSULTANT AT THE TIME OF BOOKING YOUR COLOUR A <i>Worksheet</i> Note:	
VENDOR TO INSTALL CAPPED GAS LINE (ROUGH-IN ONLY) AT REAR OF HOME FOR FUTURE BBQ LOCATION. LOCATION TO BE FINALIZED AT VENDORS SOLE DISCRETION. <i>Worksheet</i> Note:	
VENDOR TO SUPPLY & INSTALL AIR CONDITIONING UNIT, SIZED ACCORDINGLY, FROM VENDORS STANDARD SAMPLES. <i>Worksheet</i> Note:	

Purchasers: AMIT BHANOT, & DIPTI BHANOT,

Property: 37 of Plan - Draft Approval SB17-03-08

Telephone Res. / Bus: /

Project: KINGSMEN (THAMES) INC.

Decor Advisor: Barbara Coccia

Model and Elevation: Arthur (4205) Elev B 4 Bed - 4+1 Bath

Layout Changes: ☐ Yes ☒ NoSketch Attached: ☒ Yes ☐ No

Exterior Colour Scheme:

1. Cabinetry	Style and Colour	Counter Top	Hardware
Kitchen / Breakfast	#3 Charleston 3DL Rain Cloud	#1, C/S # 9141 Ice Snow 3cm.	# 12881 Handle
Kitchen Island	#3 Charleston 3DL Rain Cloud	#1, C/S # 9141 Ice Snow 3cm.	# 12881 Handle
Laundry Room	/		
Powder Room	#3 Charleston 3DL Rain Cloud	# 6698-46 Paloma Polar	# 12881 Handle
Main Bathroom	/		
Master Ensuite Bathroom	#3 Charleston 3DL Orchid	# 4924-38 White Carrara	# 9671 Handle
Second Ensuite Bathroom (If Applicable)	#3 Charleston 3DL Rain Cloud	# 6698-46 Paloma Polar	# 9671 Handle
Ens. #3's bathroom	#3 Charleston 3DL Rain Cloud	# 6698-46 Paloma Polar	# 9671 Handle
Ens. #4's bathroom	#3 Charleston 3DL Rain Cloud	# 6698-46 Paloma Polar	# 9671 Handle

Appliances

Custom Size Fridge

☐ Yes ☒ No

Valance Lighting

☐ Yes ☒ No

Microwave / Range Hood

☐ Yes ☒ No

Cooktop / Rangetop

☐ Yes ☒ No

Built in Wall Oven

☐ Yes ☒ No

Slide-in Range

☐ Yes ☒ No

Comment

/

2. Flooring

	Selection
Foyer	13x13" Keaton Ice
Main Hall	/
Back Hall	/
Breakfast	13x13" Keaton Ice
Laundry Room	13x13" Piaggio Grey
Kitchen	13x13" Keaton Ice
Powder Room	13x13" Keaton Ice
Main Bathroom	Ens. #2's Bathroom: 13x13" Keaton Ice
Master Ensuite	13x13" Piaggio Grey
Bathroom (If Applicable)	Ens. #3's Bathroom: 13x13" Keaton Ice
Mud Room	13x13" Keaton Ice
Master ens. & Ens. #3's	Shower floor: 2x2" Ontario Snow White matte
Living Room	Ens. #4's Bathroom: 13x13" Keaton Ice
Dining Room	3 1/2" Elements Oak Strugeon
Family / Great Room	3 1/2" Elements Oak Strugeon
Den / Library / Study	3 1/2" Elements Oak Strugeon
Basement Landing (If Applies)	
Lower Landing (If Applicable)	3 1/2" Elements Oak Strugeon
Upper Landing	(if applicable) 3 1/2" Elements Oak Strugeon
Upper Hall	& Computer niche area: Modern Story 1, # 927 Morning Rain
Master Bedroom	Modern Story 1, # 927 Morning Rain
Bedroom #2	Modern Story 1, # 927 Morning Rain
Bedroom #3	Modern Story 1, # 927 Morning Rain
Bedroom #4	Modern Story 1, # 927 Morning Rain
Bedroom #5	/
Master ens. & Ens. #3's	Shower jamb: Anatolia marmilne Snow

Flooring Continued on Page 2

Initial:



Page 1 of 3

Purchasers: AMIT BHANOT, & DIPTI BHANOT,

Property: 37 of Plan - Draft Approval SB17-03-08

Telephone Res. / Bus: /

Project: KINGSMEN (THAMES) INC.

Decor Advisor: Barbara Coccia

Model and Elevation: Arthur (4205) Elev B 4 Bed - 4+1 Bath

2. Flooring - Continued -

Upgrade Underpad	Type	Area
	Standard	2nd. floor
Carpet on Stairs	Capped	Runner - *Upgrade
Comment	/	/

3. Plumbing Fixtures / Faucets

Kitchen	Standard	Second Ensuite	Standard	Powder Room	Standard
Master Ensuite	Standard			Other Room	/
Main Bathroom	/	Ens. #3 & #4's bathroom	Standard		

Comment

Still to install the standard under mount kitchen sink with the standard single hole kitchen faucet, NO PLATE.

4. Wall Tile

	Tile Selection	Listello	Insert	Insert Selection
Main Bathroom	/	<input type="checkbox"/>	<input type="checkbox"/>	
Master Ensuite				
Tub Deck	/	<input type="checkbox"/>	<input type="checkbox"/>	
Tub Apron	/	<input type="checkbox"/>	<input type="checkbox"/>	
Tub Surround	/	<input type="checkbox"/>	<input type="checkbox"/>	
Shower Stall	8X10" Weave White	<input type="checkbox"/>	<input type="checkbox"/>	
Second Ensuite	8x10" Ketaon Ice	<input type="checkbox"/>	<input type="checkbox"/>	
Ens. #3's bathroom	8x10" Ketaon Ice	<input type="checkbox"/>	<input type="checkbox"/>	
Ens. #4's bathroom	8x10" Ketaon Ice	<input type="checkbox"/>	<input type="checkbox"/>	
Kitchen Backsplash	/	<input type="checkbox"/>	<input type="checkbox"/>	
Complete Backsplash	/	<input type="checkbox"/>	<input type="checkbox"/>	
Comment	/			

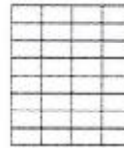

horizontal stacked

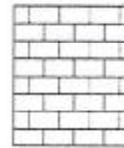

brick pattern



vertical stacked



diagonal/diamond

5. Fireplace

Living Room

Purchased ☐ As Per Plan ☐ N/A ☒

Family Room

Purchased ☐ As Per Plan ☐ N/A ☒

Other Room - Specify Study/Great

Purchased ☐ As Per Plan ☒ N/A ☐

Fireplace Type

Mantle Type

Over Mantle

Colour / Stain

Surround

Hearth

Comment

/

2 sided

NF-08 (both sides)

/

White

/

/

DB

DB

Initial:

Page 2 of 3

Purchasers: AMIT BHANOT, & DIPTI BHANOT,

Property: 37 of Plan - Draft Approval SB17-03-08

Telephone Res. / Bus: /

Project: KINGSMEN (THAMES) INC.

Decor Advisor: Barbara Coccia

Model and Elevation: Arthur (4205) Elev B 4 Bed - 4+1 Bath

6. Trim Carpentry

Door Hardware Standard handle

Interior Trim Standard

Comment

/

Interior Doors

☐ 2 Panel Arch Top

☒ 2 Panel Square Top

☐ 6 Panel

Initial for Door Style

DB AS

7. Railings and Pickets

Railing Package Standard Oak STRAIGHT picket package

Railing Colour Elements Strugeon

Picket Colour Elements Strugeon

Wood Stairs ☐ No ☒ Oak

Tread Colour Elements Strugeon

Comment

/

8. Plaster Mouldings and Medallions

Foyer /

Kitchen/Breakfast /

Main Hall /

Den/Library /

Living Room /

Lower Landing /

Dining Room /

Family Room /

Comment

/

9. Wall Paint

Kingsmen White

Smooth Ceilings

☐ First Floor

☐ First Floor incl. Second Floor Hall

☐ First and Second Floor

☒ Throughout

☐ Not Applicable

Trim Paint Kingsmen White

10. Additional Comments

/

11. Disclaimers and Notes

- Colours of all materials are as close as possible to builder's selection, but not necessarily identical due to variances in manufacturing.
- Any extras listed above are null and void unless accompanied by a separate invoice/amendment. Said invoice must be paid in full.
- The Purchaser acknowledges that after Interior Colour Selection form is signed and dated, no further changes will be permitted other than re-selection due to unavailability. Purchaser's Initials
- The Purchaser acknowledges reading and accepting the "Kingsmen Group Décor Centre Disclaimers" form. This document contains other miscellaneous disclaimers.

This Interior Colour Selection is final and approved by:

Purchaser:

Signature:

Date:

July 20/23

Signature:

Date:

20/7/23

Vendor:

KINGSMEN (THAMES) INC.

LOT 37
THAMES PH. 5B
SKETCH #1

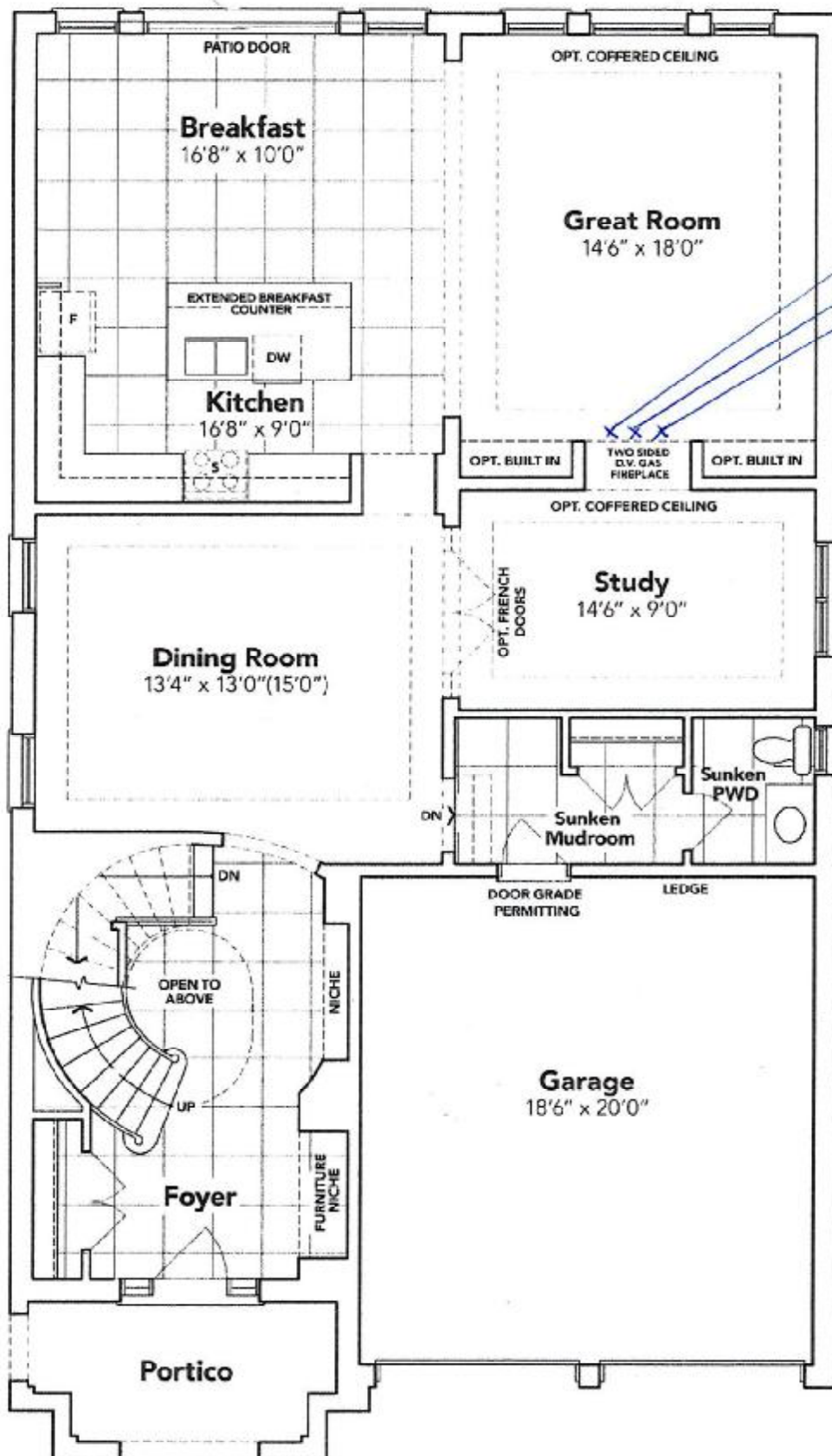

PH
TV & PH
all 3 items @
66" up from
floor.

GROUND FLOOR EL. B

The floor plans and elevations shown are pre-construction plans and may be revised or improved as necessitated by architectural controls and the construction process. The measurements adhere to the rules and regulations of the TARION Warranty Corporation's official method for the calculation of floor area. Materials, specifications and floor plans are subject to change without notice. All house renderings are artist's concept only. Actual usable floor space may vary from the stated floor area. All options shown are upgrades. E. & O. E.

[Signature]

[Signature]

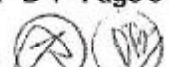

LOT 37
THAMES PH. 5B
SKETCH #2

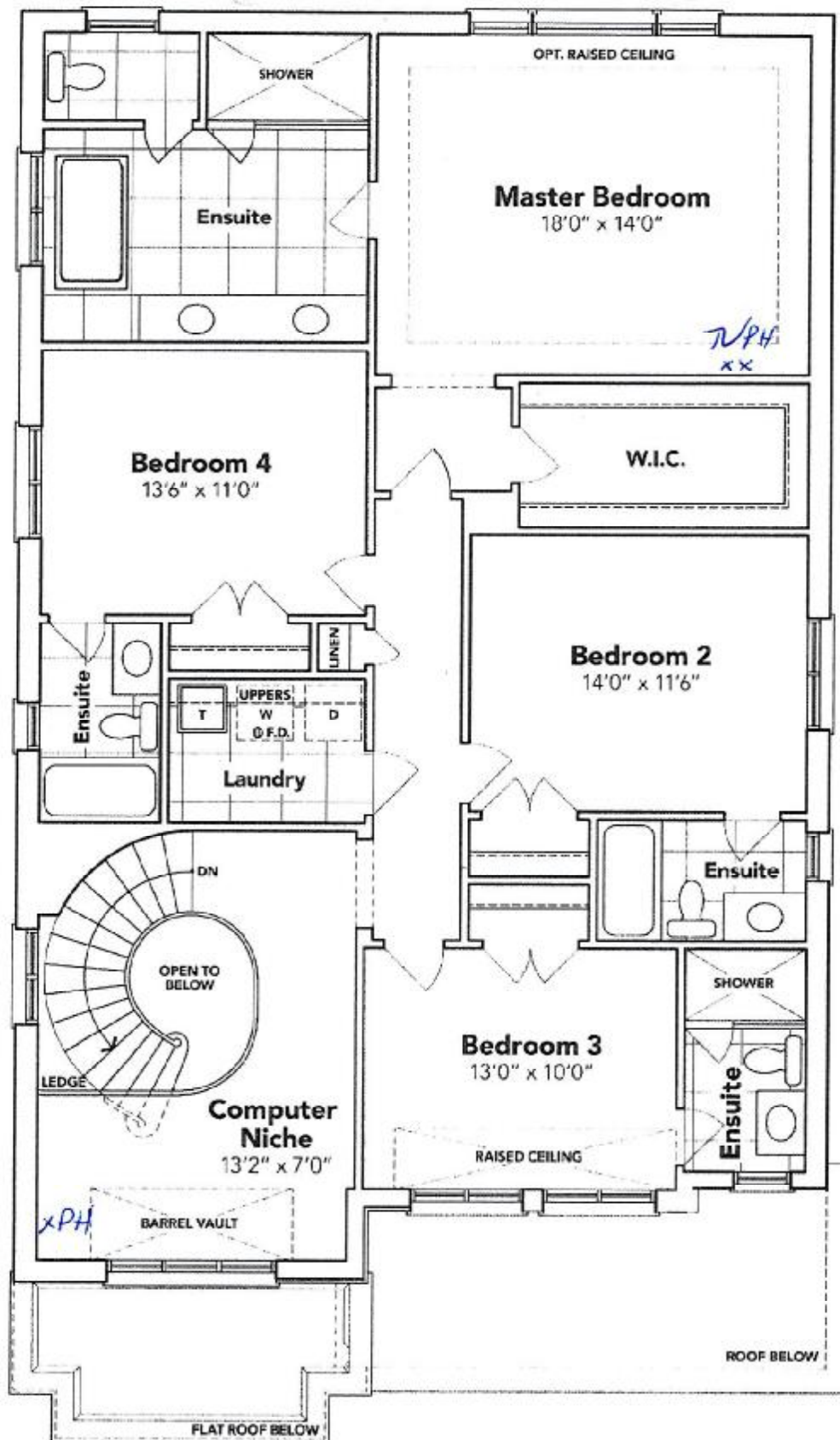

SECOND FLOOR EL. B

The floor plans and elevations shown are pre-construction plans and may be revised or improved as necessitated by architectural controls and the construction process. The measurements adhere to the rules and regulations of the TARIION Warranty Corporation's official method for the calculation of floor area. Materials, specifications and floor plans are subject to change without notice. All house renderings are artist's concept only. Actual usable floor space may vary from the stated floor area. All options shown are upgrades. E. & O. E.

SCHEDULE "B-1"
Floor Plan

Lot 37
Phase 5B
Model: Arthur (4205) Elev B 4 Bed - 4+1 Bath
Standard

LOT 37
THAMES PH. 5B
SKETCH #3

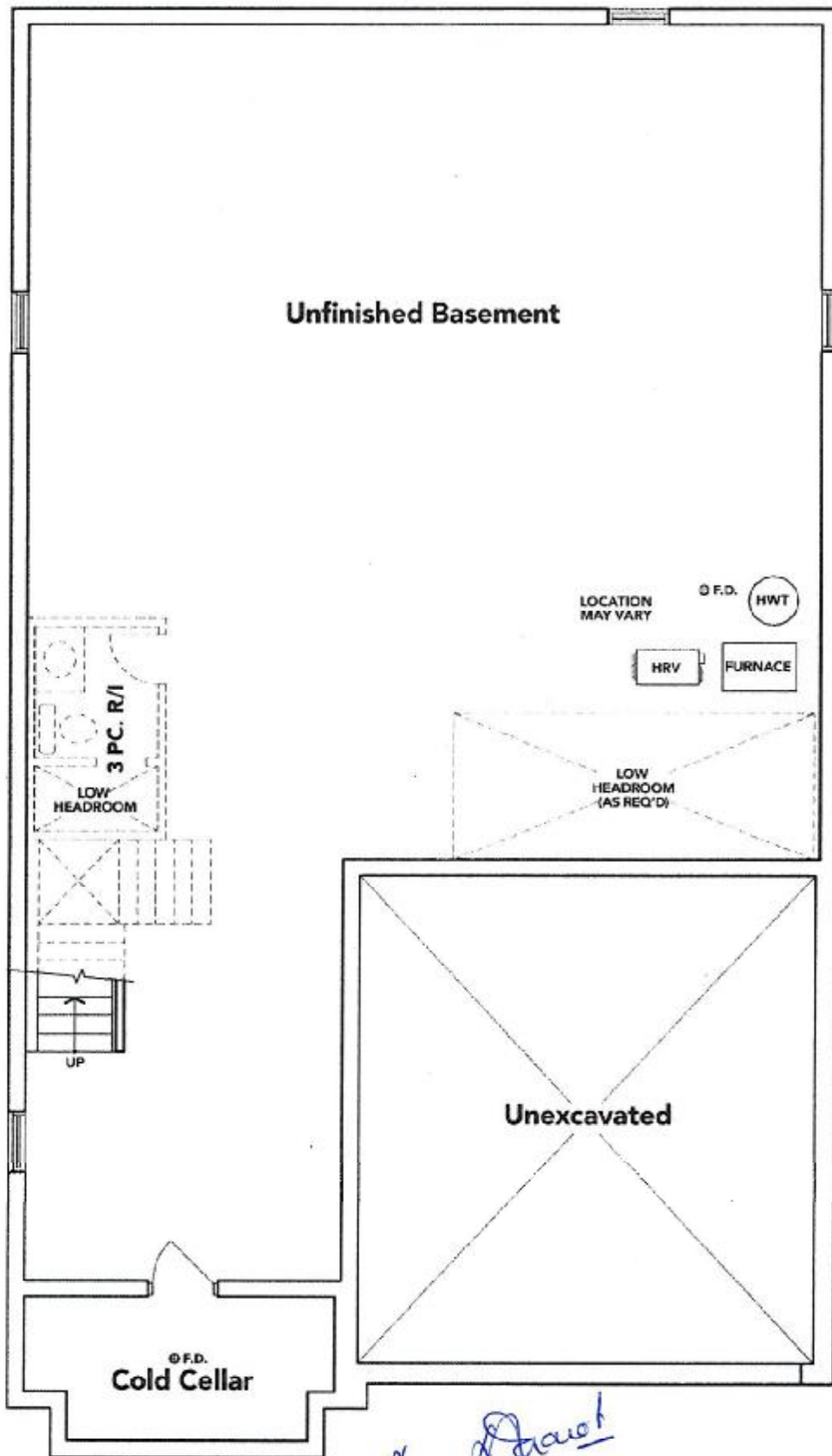

BASEMENT EL. B

The floor plans and elevations shown are pre-construction plans and may be revised or improved as necessitated by architectural controls and the construction process. The measurements adhere to the rules and regulations of the TARION Warranty Corporation's official method for the calculation of floor area. Materials, specifications and floor plans are subject to change without notice. All house renderings are artist's concept only. Actual usable floor space may vary from the stated floor area. All options shown are upgrades. E. & O. E.



5B-37

LOT 37 THAMES PH. 5B
RE: UPG. 30" CHIMNEY HOOD FAN

Specifications

Air Flow Volume: 550 CFM (300 CFM)
Electrical Connection: 120V/60Hz
Power Consumption: 300 Watts (200 Watts)
Current: 2.5 Amps (2.0 Amps)
Fan Speed: 1599 RPM (1350 RPM)
Finishes: Stainless Steel
Duct: 6" Round
Dimensions: Width: 29 5/8"/35 5/8"
Height: 45 1/2"
Depth: 19 1/4"
Noise Level: Min. 2 Sones
Max. 6 Sones (4 Sones)



Handwritten signature/initials



Ordering Model Chart

Model	Colour	Size	Filter	CFM
SCB51930	Stainless Steel	30"	Baffle	550
SCB51936	Stainless Steel	36"	Baffle	550
SCB31930	Stainless Steel	30"	Baffle	300
SCB31936	Stainless Steel	36"	Baffle	300

Notes

Cyclone®
Breathe Better