

KINGSMEN (THAMES) INC. / Havelock Corners (Kingsmen)

Lot/Unit: 22 Phase/Building: 5B Model/Floor Plan: Arthur (4205) Elev C 4 Bed - 4+1 Bath

CARPET

Inv.6304	1 - To supply & install the ESCAPE TO MAUI carpet to the second floor in lieu of the standard carpet... see colour chart for details.	
Line 79341	Note:	
15Jun23 / 15Jun23		

ELECTRICAL

Inv.6304	1 - To supply & install the standard T.V. rough in in the great room and master bedroom... see sketch # 1 & # 2	
Line 79332	Note: Install the standard T.V. rough in at approx. 66" + - up from the floor centered + - to the F/P mantle.	
15Jun23 / 15Jun23		
Inv.6304	1 - To supply & install the standard Phone (CAT5) rough in in the great room, master bedroom and coputer loft area ... see sketch # 1 & # 2	
Line 79333	Note: Install the standard CAT 5 rough in at approx. 66" + - up from the floor centered + - to the F/P mantle.	
15Jun23 / 15Jun23		
Inv.6304	1 - To SUPPLY AND INSTALL AN ADDITIONAL BASIC RECEPTACLE (NOT DEDICATED) at approx. 66" + - up from the floor centered + - to the F/P mantle	
Line 79334	Note: in the great room... ssee sketch # 1	
15Jun23 / 15Jun23		
This is for a future wall mount T.V. NO CONDUIT PIPE HAS BEEN PURCHASED.		

HEATING AND AIR CONDITIONING

Inv.6304	1 - As per schedule "PE": Vendor to install capped gas line (Rough in only) at rear of home for future BBQ location. Location to be finalized at vendors sole discretion.	
Line 79330	Note:	
15Jun23 / 15Jun23		
Inv.6304	1 - As per schedule "PE": Vendor to supply & install air conditioning unit, sized accordingly, from vendors standard samples.	
Line 79331	Note:	
15Jun23 / 15Jun23		

MISCELLANEOUS

Inv.6304	1 - To supply & install the standard COFFERED ceiling in the dining room area... see sketch # 1	
Line 79335	Note:	
15Jun23 / 15Jun23		
Inv.6304	1 - Enlarge wall slightly on GREAT ROOM side for the NF-08 standard mantle to fit properly.	
Line 79336	Note:	
15Jun23 / 15Jun23		

RAILING

Inv.6304	1 - To supply & install the RAILING - UPGRADE 1 - METAL HANDRAIL 3 INCH OVAL IN OAK - PICKETS STEEL ½ INCH SQUARE, PLAIN, WITH SHOES IN FLAT BLACK - POSTS 3½ INCH SQUARE, WITH CAP OAK IN OAK in lieu of the standard pickets and rails.	
Line 79342	Note:	
15Jun23 / 15Jun23		

KINGSMEN (THAMES) INC. / Havelock Corners (Kingsmen)

Lot/Unit: 22 Phase/Building: 5B Model/Floor Plan: Arthur (4205) Elev C 4 Bed - 4+1 Bath

TILE - FLOOR

Inv.6304	1 - To supply & install the UPGRADE 2 - FLOOR TILE - STACKED - FOYER TILE in lieu of the standard floor tiles... see colour chart for details...see sketch #1 for installation direction.	
Line 79337	Note:	
15Jun23 / 15Jun23		
Inv.6304	1 - To supply & install the UPGRADE 2 - FLOOR TILE - STACKED - MUD ROOM TILE in lieu of the standard floor tiles... see colour chart for details...see sketch #1 for installation direction.	
Line 79338	Note:	
15Jun23 / 15Jun23		
Inv.6304	1 - To supply & install the UPGRADE 2 - FLOOR TILE - STACKED - PWDER ROOM TILE in lieu of the standard floor tiles... see colour chart for details...see sketch #1 for installation direction.	
Line 79339	Note:	
15Jun23 / 15Jun23		
Inv.6304	1 - To supply & install the UPGRADE 2 - FLOOR TILE - STACKED - KITCHEN/BREAKFAST TILE in lieu of the standard floor tiles... see colour chart for details...see sketch #1 for installation direction.	
Line 79340	Note:	
15Jun23 / 15Jun23		

EXTRAS AS PER OFFER

5 FREE APPLIANCES ? STAINLESS STEEL FRONT - FRIDGE; STOVE AND DISHWASHER. WHITE WASHER AND DRYER (SUPPLIED ONLY, NOT INSTALLED, FROM BUILDERS STANDARD LINE). AN APPLIANCES VOUCHER WILL BE GIVEN BY OUR DECOR CONSULTANT AT THE TIME OF BOOKING YOUR COLOUR A <i>Worksheet</i> Note:	
5 FREE APPLIANCES – STAINLESS STEEL FRONT - FRIDGE; STOVE AND DISHWASHER. WHITE WASHER AND DRYER (SUPPLIED ONLY, NOT INSTALLED, FROM BUILDERS STANDARD LINE). AN APPLIANCES VOUCHER WILL BE GIVEN BY OUR DECOR CONSULTANT AT THE TIME OF BOOKING YOUR COLOUR A <i>Worksheet</i> Note:	
VENDOR TO INSTALL CAPPED GAS LINE (ROUGH-IN ONLY) AT REAR OF HOME FOR FUTURE BBQ LOCATION. LOCATION TO BE FINALIZED AT VENDORS SOLE DISCRETION. <i>Worksheet</i> Note:	
VENDOR TO SUPPLY & INSTALL AIR CONDITIONING UNIT, SIZED ACCORDINGLY, FROM VENDORS STANDARD SAMPLES. <i>Worksheet</i> Note:	

Purchaser:

TARIQ SAEED SHEIKH

Telephone Res. / Bus:

/

Decor Advisor:

Barbara Coccia

Property:

22 of Plan - Draft Approval SB17-03-08

Project:

KINGSMEN (THAMES) INC.

Model and Elevation:

Arthur (4205) Elev C 4 Bed - 4+1 Bath

Layout Changes: ☐ Yes ☒ No

Sketch Attached: ☒ Yes ☐ No

Exterior Colour Scheme:

1. Cabinetry	Style and Colour	Counter Top	Hardware
Kitchen / Breakfast	#3 Simcoe Orchid	#1, C/S # 3040 Cement 3cm.	# 135 Knob
Kitchen Island	#3 Simcoe Orchid	#1, C/S # 3040 Cement 3cm.	# 135 Knob
Laundry Room	/		
Powder Room	#3 Simcoe Navy Blue	#4987K-07 Leche Vesta	# 135 Knob
Main Bathroom	/		
Master Ensuite Bathroom	#3 Manchester Maple Espresso CL	# 6698-46 Paloma Polar	# 135 Knob
Second Ensuite Bathroom (If Applicable)	#3 Manchester Maple Shale Grey CL	# 6698-46 Paloma Polar	# 135 Knob
Ens. #3's bathroom	#3 Trinity LPL Free Spirit L580K	# 4971K-52 Bronzite	# 135 Knob
Ens. #4's bathroom	# Simcoe Rain Cloud	# 4926K-07 Black Alicante	# 135 Knob

Appliances

Custom Size Fridge

☐ Yes ☒ No

Cooktop / Rangetop

☐ Yes ☒ No

Valance Lighting

☐ Yes ☒ No

Built in Wall Oven

☐ Yes ☒ No

Microwave / Range Hood

☐ Yes ☒ No

Slide-in Range

☐ Yes ☒ No

Comment

2. Flooring

	Selection
Foyer	**12x24" Classic Carrara HD Porcelan STACKED
Main Hall	**12x24" Classic Carrara HD Porcelan STACKED
Back Hall	/
Breakfast	**12x24" Classic Carrara HD Porcelan STACKED
Laundry Room	13x13" Malena Carbon
Kitchen	**12x24" Classic Carrara HD Porcelan STACKED
Powder Room	**12x24" Classic Carrara HD Porcelan STACKED
Main Bathroom	Ens. #2's bathroom: 13x13" Piaggio White
Master Ensuite Bathroom (If Applicable)	13x13" Keaton Ice
Mud Room	Ens. #3's bathroom: 13x13" Keaton Carbon
Master & Ens. #3's	**12x24" Classic Carrara HD Porcelan STACKED
Living Room	Shower floor: 2x2" Ontario Snow White Matte
Dining Room	Ens. #4's Bathroom: 13x13" Piaggio Grey
Family / Great Room	3 1/2" Elements Oak Sturgeon
Den / Library / Study	3 1/2" Elements Oak Sturgeon
Basement Landing (If Applies)	
Lower Landing (If Applicable)	3 1/2" Elements Oak Sturgeon
Upper Landing	(if applicable) 3 1/2" Elements Oak Sturgeon
Upper Hall	**Escape to Maui # 89816 Pilgrim's Path
Master Bedroom	**Escape to Maui # 89816 Pilgrim's Path
Bedroom #2	**Escape to Maui # 89816 Pilgrim's Path
Bedroom #3	**Escape to Maui # 89816 Pilgrim's Path
Bedroom #4	**Escape to Maui # 89816 Pilgrim's Path
Bedroom #5	/
Master & Ens. #3's	Shower jamb: Anatolia Marmiline SNOW

SEE ATTACHED FOR SIGNATURES



Flooring Continued on Page 2

Initial:

Purchaser:

TARIQ SAEED SHEIKH

Telephone Res. / Bus:

/

Decor Advisor:

Barbara Coccia

2. Flooring - Continued -

Property: 22 of Plan - Draft Approval SB17-03-08

Project: KINGSMEN (THAMES) INC.

Model and Elevation: Arthur (4205) Elev C 4 Bed - 4+1 Bath

Upgrade Underpad	Type	Area
	Standard	2nd. Floor
Carpet on Stairs	Capped	Runner - *Upgrade
Comment	/	/

3. Plumbing Fixtures / Faucets

Kitchen	Standard	Second Ensuite	Standard	Powder Room	Standard
Master Ensuite	Standard			Other Room	/
Main Bathroom	/	Ens. #3 & #4's bathroom	Standard		

Comment

Still to instal the standard under mount kitchen sink with the standard single hole kitchen faucet NO PLATE.

4. Wall Tile

	Tile Selection	Listello	Insert	Insert Selection
Main Bathroom	/	<input type="checkbox"/>	<input type="checkbox"/>	
Master Ensuite				
Tub Deck	/	<input type="checkbox"/>	<input type="checkbox"/>	
Tub Apron	/	<input type="checkbox"/>	<input type="checkbox"/>	
Tub Surround	/	<input type="checkbox"/>		
Shower Stall	8X10" Keaton Carbon	<input type="checkbox"/>	<input type="checkbox"/>	
Second Ensuite	8x10" Malena Carbon	<input type="checkbox"/>	<input type="checkbox"/>	
Ens. #3's bathroom	8x10" Keaton Ice	<input type="checkbox"/>	<input type="checkbox"/>	
Ens. #4's bathroom	8x10" Malena Ice	<input type="checkbox"/>	<input type="checkbox"/>	
Kitchen Backsplash	/	<input type="checkbox"/>	<input type="checkbox"/>	
Complete Backsplash	/	<input type="checkbox"/>	<input type="checkbox"/>	

Comment

Install the standard 8x10" wall tiles on the 10" side stacked horizontally in ALL bathrooms where applicable.

horizontal stacked

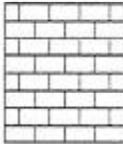
brick pattern

vertical stacked

diagonal/diamond

5. Fireplace

	Living Room			Family Room			Other Room - Specify Study/Great		
	Purchased	As Per Plan	N/A	Purchased	As Per Plan	N/A	Purchased	As Per Plan	N/A
	<input type="radio"/>	<input type="radio"/>	<input checked="" type="radio"/>	<input type="radio"/>	<input type="radio"/>	<input checked="" type="radio"/>	<input type="radio"/>	<input checked="" type="radio"/>	<input type="radio"/>
Fireplace Type							2 sided		
Mantle Type							NF-08 (both sides)		
Over Mantle							/		
Colour / Stain							White		
Surround							/		
Hearth							/		
Comment	/								

SEE ATTACHED FOR SIGNATURES



Initial: _____

Model and Elevation: Arthur (4205) Elev C 4 Bed - 4+1 Bath

SEE ATTACHED FOR SIGNATURE

Printed 2023-06-15 11:27:10

5B-22

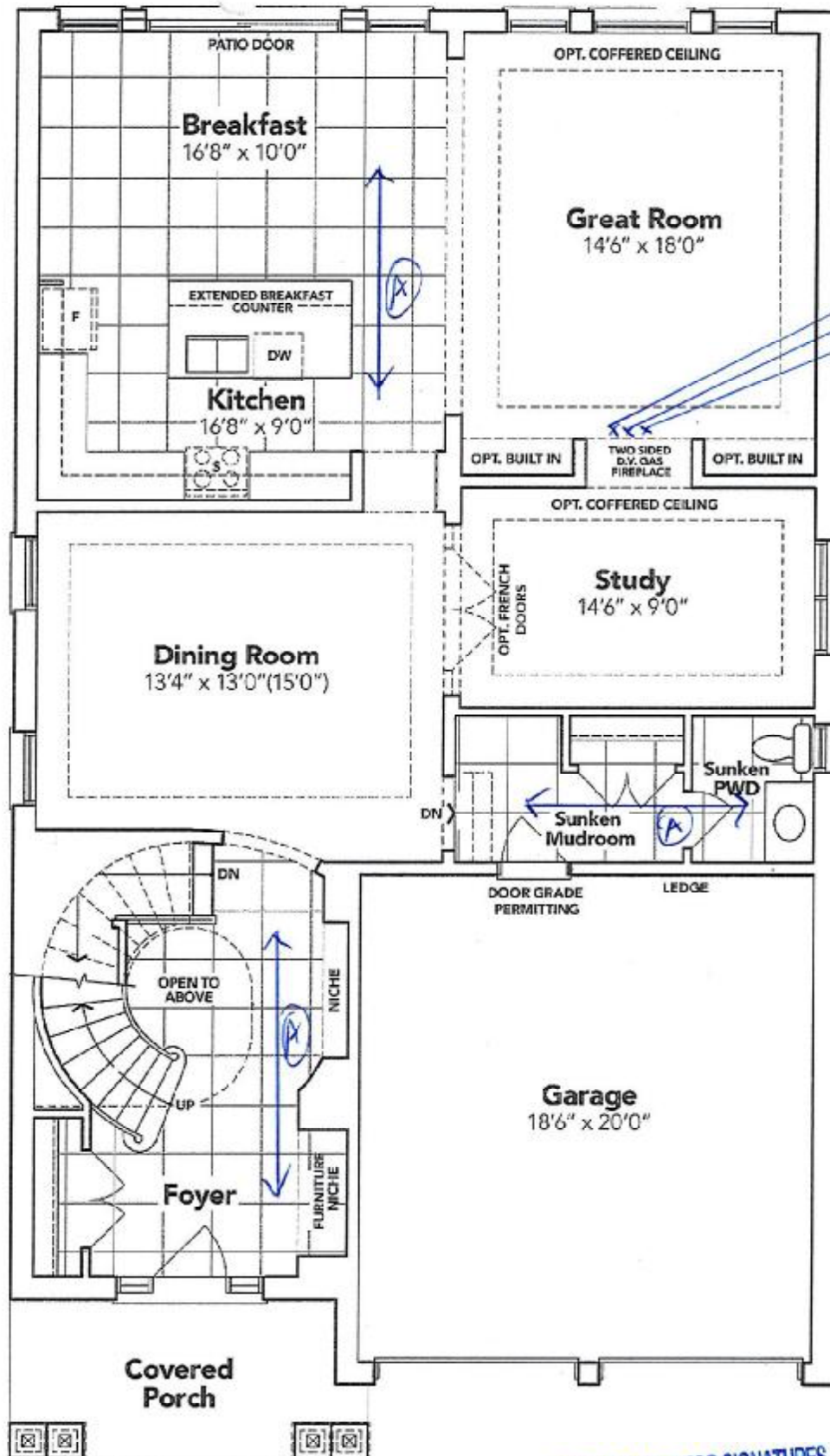

LOT 22
THAMES PH. 5B
SKETCH #1

PH
TV
all 3 items
@ 66" up
from floor.

12x24" VPG.
FLOOR TILE
INSTALLATION
DIRECTION.

SEE ATTACHED FOR SIGNATURES

GROUND FLOOR EL. C

The floor plans and elevations shown are pre-construction plans and may be revised or improved as necessitated by architectural controls and the construction process. The measurements adhere to the rules and regulations of the TARIION Warranty Corporation's official method for the calculation of floor area. Materials, specifications and floor plans are subject to change without notice. All house renderings are artist's concept only. Actual usable floor space may vary from the stated floor area. All options shown are upgrades. E. & O. E.

5B-22

LOT 22
THAMES PH. 5B
SKETCH #2

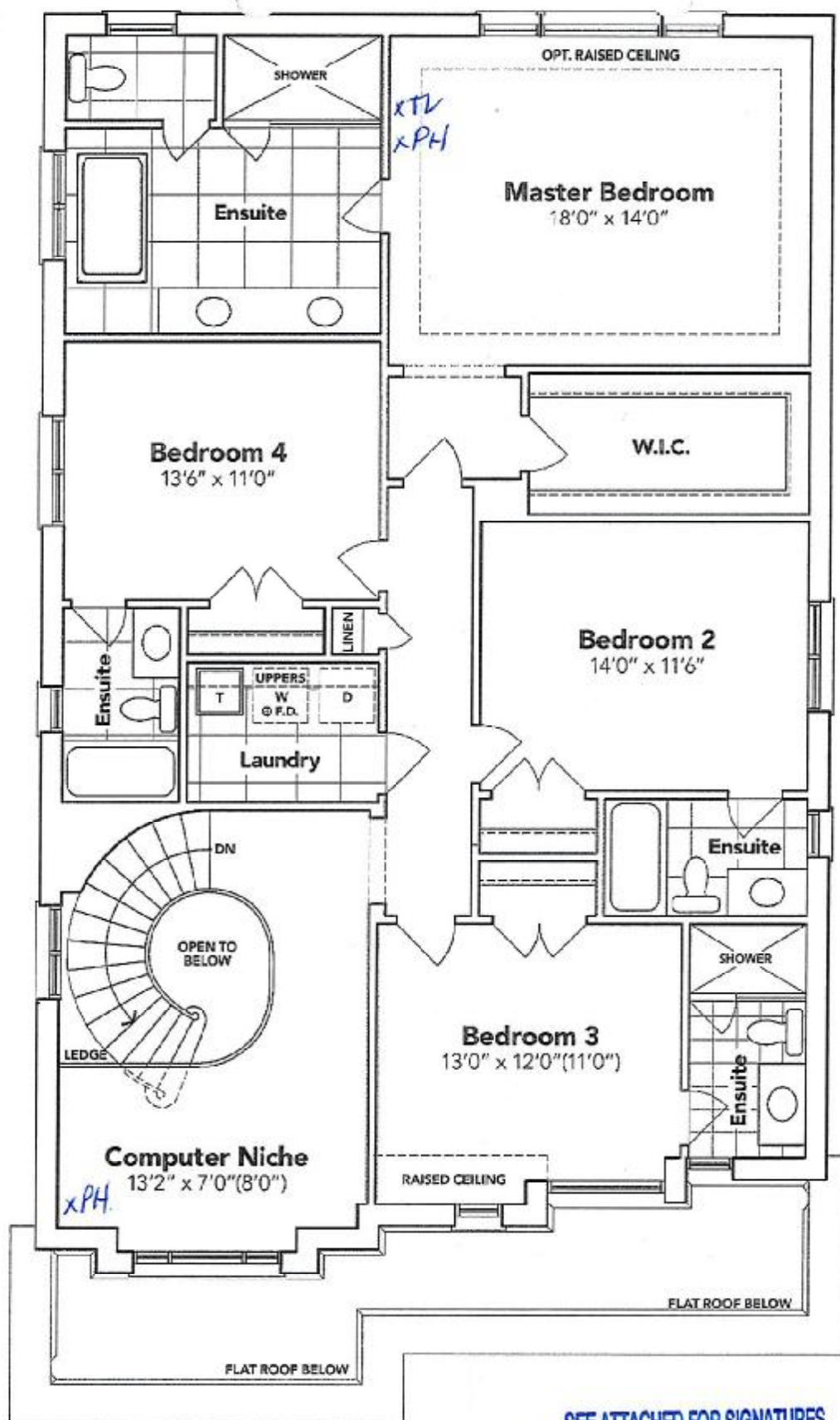

SECOND FLOOR EL. C

The floor plans and elevations shown are pre-construction plans and may be revised or improved as necessitated by architectural controls and the construction process. The measurements adhere to the rules and regulations of the TARION Warranty Corporation's official method for the calculation of floor area. Materials, specifications and floor plans are subject to change without notice. All house renderings are artist's concept only. Actual usable floor space may vary from the stated floor area. All options shown are upgrades. E. & O. E.



SCHEDULE "B-1"
Floor Plan

Lot 22
Phase 5B
Model: Arthur (4205) Elev C 4 Bed - 4+1 Bath
Standard

LOT 22
THAMES PH. 5B
SKETCH #3

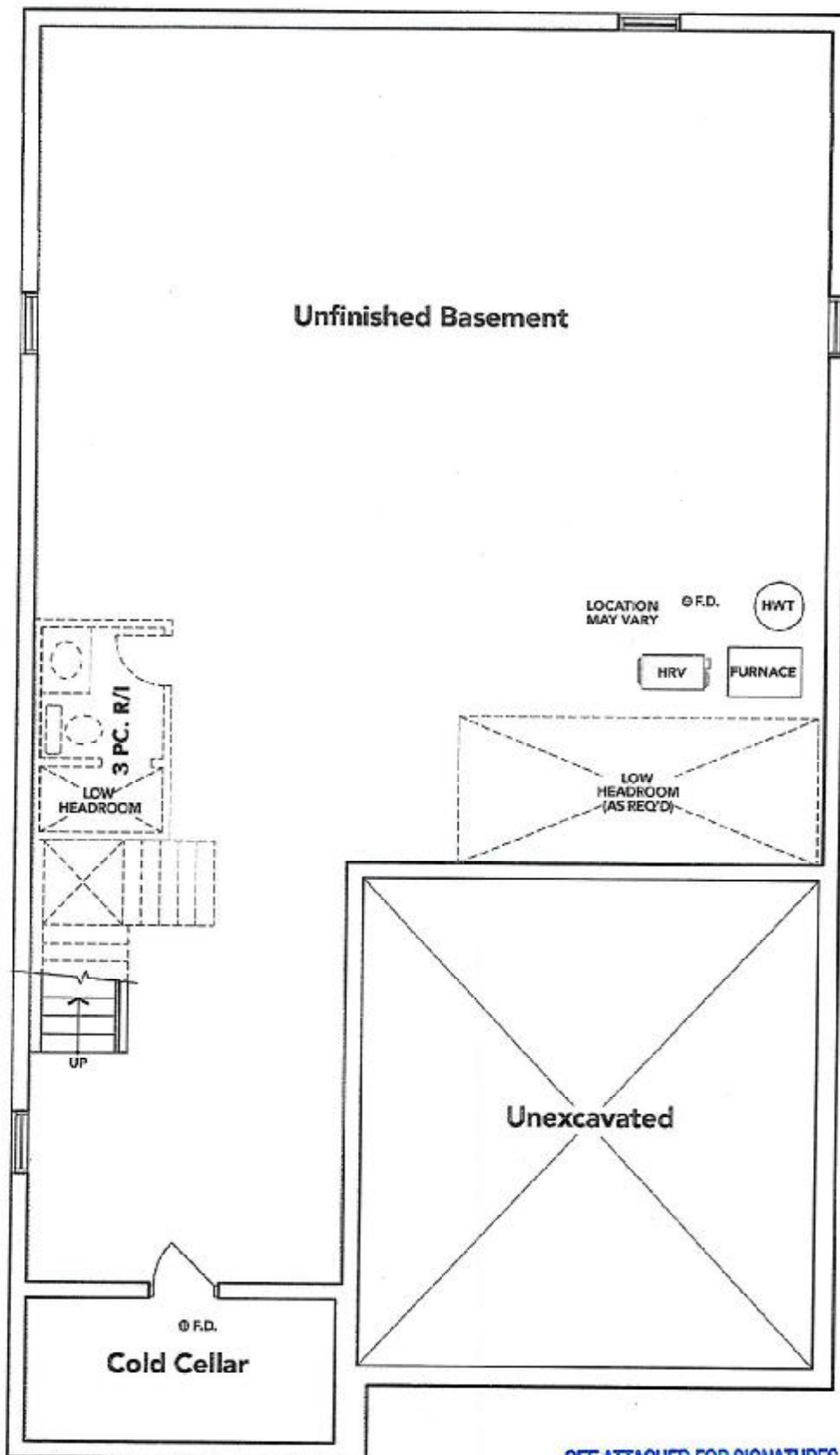

SEE ATTACHED FOR SIGNATURES

BASEMENT EL. C

The floor plans and elevations shown are pre-construction plans and may be revised or improved as necessitated by architectural controls and the construction process. The measurements adhere to the rules and regulations of the TARION Warranty Corporation's official method for the calculation of floor area. Materials, specifications and floor plans are subject to change without notice. All house renderings are artist's concept only. Actual usable floor space may vary from the stated floor area. All options shown are upgrades. E. & O. E.

