

KINGSMEN (THAMES) INC. / Havelock Corners (Kingsmen)

Lot/Unit: 96    Phase/Building: 5B    Model/Floor Plan: James (3601) Elev A 4 Bed - 2+1 Bath

ELECTRICAL

Inv.6193  Line 78386  26Apr23 / 1May23	1 - To supply & install the standard T.V. rough in in the great room and master bedroom... see sketch # 1 & # 2  Note:  	
Inv.6193  Line 78387  26Apr23 / 1May23	1 - To supply & install the standard Phone ( CAT5 ) rough in in the great room, master bedroom and Bedroom # 2 ... see sketch # 1 & # 2  Note:  	
Inv.6193  Line 78409  26Apr23 / 1May23	1 - To SUPPLY AND INSTALL EXTRA CEILING BOX ROUGH IN CAPPED (DOES NOT INCLUDE SWITCH) over the island in the kitchen... see sketch # 1  Note: This capped elec. will be connected to a sep. switch, switch sold sep.  	
Inv.6193  Line 78410  26Apr23 / 1May23	1 - To supply & install AN ADDITIONAL SINGLE POLE SWITCH connected to the upgraded capped elec. over the island in the kitchen.  Note:  	

HEATING AND AIR CONDITIONING

Inv.6193  Line 78384  26Apr23 / 1May23	1 - As per schedule "PE": Vendor to install capped gas line ( Rough in only ) at rear of home for future BBQ location. Location to be finalized at vendors sole discretion.  Note:  	
Inv.6193  Line 78385  26Apr23 / 1May23	1 - As per schedule "PE": Vendor to supply & install air conditioning unit, sized accordingly, from vendors standard samples.  Note:  	

EXTRAS AS PER OFFER

5 FREE APPLIANCES ? STAINLESS STEEL FRONT - FRIDGE: STOVE AND DISHWASHER. WHITE WASHER AND DRYER (SUPPLIED ONLY, NOT INSTALLED, FROM BUILDERS STANDARD LINE). AN APPLIANCES VOUCHER WILL BE GIVEN BY OUR DECOR CONSULTANT AT THE TIME OF BOOKING YOUR COLOUR A  Worksheet    Note:	
5 FREE APPLIANCES – STAINLESS STEEL FRONT - FRIDGE; STOVE AND DISHWASHER. WHITE WASHER AND DRYER (SUPPLIED ONLY, NOT INSTALLED, FROM BUILDERS STANDARD LINE). AN APPLIANCES VOUCHER WILL BE GIVEN BY OUR DECOR CONSULTANT AT THE TIME OF BOOKING YOUR COLOUR A  Worksheet    Note:	
VENDOR TO INSTALL CAPPED GAS LINE (ROUGH-IN ONLY) AT REAR OF HOME FOR FUTURE BBQ LOCATION. LOCATION TO BE FINALIZED AT VENDORS SOLE DISCRETION.  Worksheet    Note:	
VENDOR TO SUPPLY & INSTALL AIR CONDITIONING UNIT, SIZED ACCORDINGLY, FROM VENDORS STANDARD SAMPLES.  Worksheet    Note:	

MAY - 3 2023

Purchaser: SHARANDEEP KAUR TOOR

Property: 96 of Plan - Draft Approval SB17-03-08

Telephone Res. / Bus: /

Project: KINGSMEN (THAMES) INC.

Decor Advisor: Barbara Coccia

Model and Elevation: James (3601) Elev A 4 Bed - 2+1 Bath

Layout Changes: ☐ Yes ☒ No

Sketch Attached: ☒ Yes ☐ No

Exterior Colour Scheme:

### 1. Cabinetry

	Style and Colour	Counter Top	Hardware
Kitchen / Breakfast	#3 Muskoka Moonlight	#1, C/S # 9141 Ice Snow 3cm.	# 12881 Handle
Kitchen Island	#3 Muskoka Moonlight	#1, C/S # 9141 Ice Snow 3cm.	# 12881 Handle
Laundry Room	/		
Powder Room	#3 Muskoka Moonlight	# 1876K-52 Spring Carnival	# 135 Knob
Main Bathroom	#3 Charleston 3DL Orchid	# P-344-LM Inkushuk Grey	# 135 Knob
Master Ensuite Bathroom	#3 Charleston 3DL Orchid	# P-344-LM Inkushuk Grey	# 135 Knob
Second Ensuite Bathroom (If Applicable)	/		
	/		
	/		

### Appliances

#### Custom Size Fridge

☐ Yes ☒ No

#### Valance Lighting

☐ Yes ☒ No

#### Microwave / Range Hood

☐ Yes ☒ No

#### Cooktop / Rangetop

☐ Yes ☒ No

#### Built in Wall Oven

☐ Yes ☒ No

#### Slide-in Range

☐ Yes ☒ No

Comment

### 2. Flooring

#### Selection

Foyer	13 x13" Cinq White
Main Hall	13 x13" Cinq White
Back Hall	/
Breakfast	13 x13" Cinq White
Laundry Room	13 x13" Burlingstone Light Grey
Kitchen	13 x13" Cinq White
Powder Room	13 x13" Cinq White
Main Bathroom	13 x13" Burlingstone Light Grey
Master Ensuite	13 x13" Burlingstone Light Grey
Bathroom (If Applicable)	/
Mud Room	13 x13" Cinq White
Master ens. shower floor:	2x2" Ontario Snow White Matte
Living Room	/
Dining Room	/
Family / Great Room	3 1/2" Elements Oak Natural
Den / Library / Study	/
Basement Landing (If Applies)	
Lower Landing (If Applicable)	3 1/2" Elements Oak Natural
Upper Landing	( If applicable ) 3 1/2" Elements Oak Natural
Upper Hall	Modern Story 1, # 810 Rocky Top
Master Bedroom	Modern Story 1, # 810 Rocky Top
Bedroom #2	Modern Story 1, # 810 Rocky Top
Bedroom #3	Modern Story 1, # 810 Rocky Top
Bedroom #4	Modern Story 1, # 810 Rocky Top
Bedroom #5	/
Master ens. shower Jamb:	

CONFIRMED BY EMAIL

Flooring Continued on Page 2

Initial: 

Page 1 of 3

MAY - 3 2023

Purchaser: SHARANDEEP KAUR TOOR

Property: 96 of Plan - Draft Approval SB17-03-08

Telephone Res. / Bus: /

Project: KINGSMEN (THAMES) INC.

Decor Advisor: Barbara Coccia

Model and Elevation: James (3601) Elev A 4 Bed - 2+1 Bath

## 4. Flooring - Continued -

Upgrade Underpad	Type	Area
	Standard	2nd. Floor
Carpet on Stairs	Capped	Runner - *Upgrade
Comment	/	/
/		

## 3. Plumbing Fixtures / Faucets





Kitchen	Standard	Second Ensuite	/	Powder Room	Standard
Master Ensuite	Standard			Other Room	/
Main Bathroom	Standard		/		

## Comment

Still to install the standard top mount kitchen sink.

## 4. Wall Tile

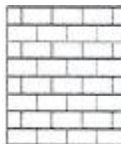
	Tile Selection	Listello	Insert	Insert Selection
Main Bathroom	8x10" Burlingstone White	<input type="checkbox"/>	<input type="checkbox"/>	
Master Ensuite				
Tub Deck	13x13" Burlingstone Light Grey	<input type="checkbox"/>	<input type="checkbox"/>	
Tub Apron	13x13" Burlingstone Light Grey	<input type="checkbox"/>	<input type="checkbox"/>	
Tub Surround	13x13" Burlingstone Light Grey	<input type="checkbox"/>		
Shower Stall	8x10" Burlingstone White	<input type="checkbox"/>	<input type="checkbox"/>	
Second Ensuite	/	<input type="checkbox"/>	<input type="checkbox"/>	
	/	<input type="checkbox"/>	<input type="checkbox"/>	
	/	<input type="checkbox"/>	<input type="checkbox"/>	
Kitchen Backsplash	/	<input type="checkbox"/>	<input type="checkbox"/>	
Complete Backsplash	/	<input type="checkbox"/>	<input type="checkbox"/>	
Comment	/			



horizontal stacked

brick pattern

vertical stacked

diagonal/diamond

## 5. Fireplace

## Living Room

Purchased ☐ As Per Plan ☐ N/A ☒

## Family Room

Purchased ☐ As Per Plan ☐ N/A ☒

## Other Room - Specify Great Room

Purchased ☐ As Per Plan ☒ N/A ☐

Fireplace Type

Mantle Type

Over Mantle

Colour / Stain

Surround

Hearth

Comment

		Front Facing
		NF-08
		/
		White
		/
		/

CONFIRMED BY EMAIL



Initial: \_\_\_\_\_

Page 2 of 3



Purchaser: SHARANDEEP KAUR TOOR

Property: 96 of Plan - Draft Approval SB17-03-08

Telephone Res. / Bus: /

Project: KINGSMEN (THAMES) INC.

Decor Advisor: Barbara Coccia

Model and Elevation: James (3601) Elev A 4 Bed - 2+1 Bath

### 6. Trim Carpentry

Door Hardware Standard Handle

Interior Trim Standard

Comment

/

#### Interior Doors

☐ 2 Panel Arch Top

☒ 2 Panel Square Top

☐ 6 Panel



Initial for Door Style



### 7. Railings and Pickets

Railing Package Standard Oak STRAIGHT picket package

Railing Colour Elements Natural

Picket Colour

Elements Natural

Wood Stairs ☐ No

☒ Oak

Tread Colour

Elements Natural

Comment

/

CONFIRMED BY EMAIL

### 8. Plaster Mouldings and Medallions

Foyer

/

Main Hall

/

Living Room

/

Dining Room

/

Family Room

/

Kitchen/Breakfast

/

Den/Library

/

Lower Landing

/

Comment

/

### 9. Wall Paint

Kingsmen White

#### Smooth Ceilings

☐ First Floor

☐ First Floor incl. Second Floor Hall

☐ First and Second Floor

☒ Throughout

☐ Not Applicable

Trim Paint Kingsmen White

### 10. Additional Comments

/

### 11. Disclaimers and Notes

- Colours of all materials are as close as possible to builder's selection, but not necessarily identical due to variances in manufacturing.
- Any extras listed above are null and void unless accompanied by a separate invoice/amendment. Said invoice must be paid in full.
- The Purchaser acknowledges that after Interior Colour Selection form is signed and dated, no further changes will be permitted other than re-selection due to unavailability. Purchaser's Initials
- The Purchaser acknowledges reading and accepting the "Kingsmen Group Décor Centre Disclaimers" form. This document contains other miscellaneous disclaimers.

This Interior Colour Selection is final and approved by:

Purchaser:

Signature:

CONFIRMED BY EMAIL

Date:

Vendor:

KINGSMEN (THAMES) INC.

CONFIRMED BY EMAIL

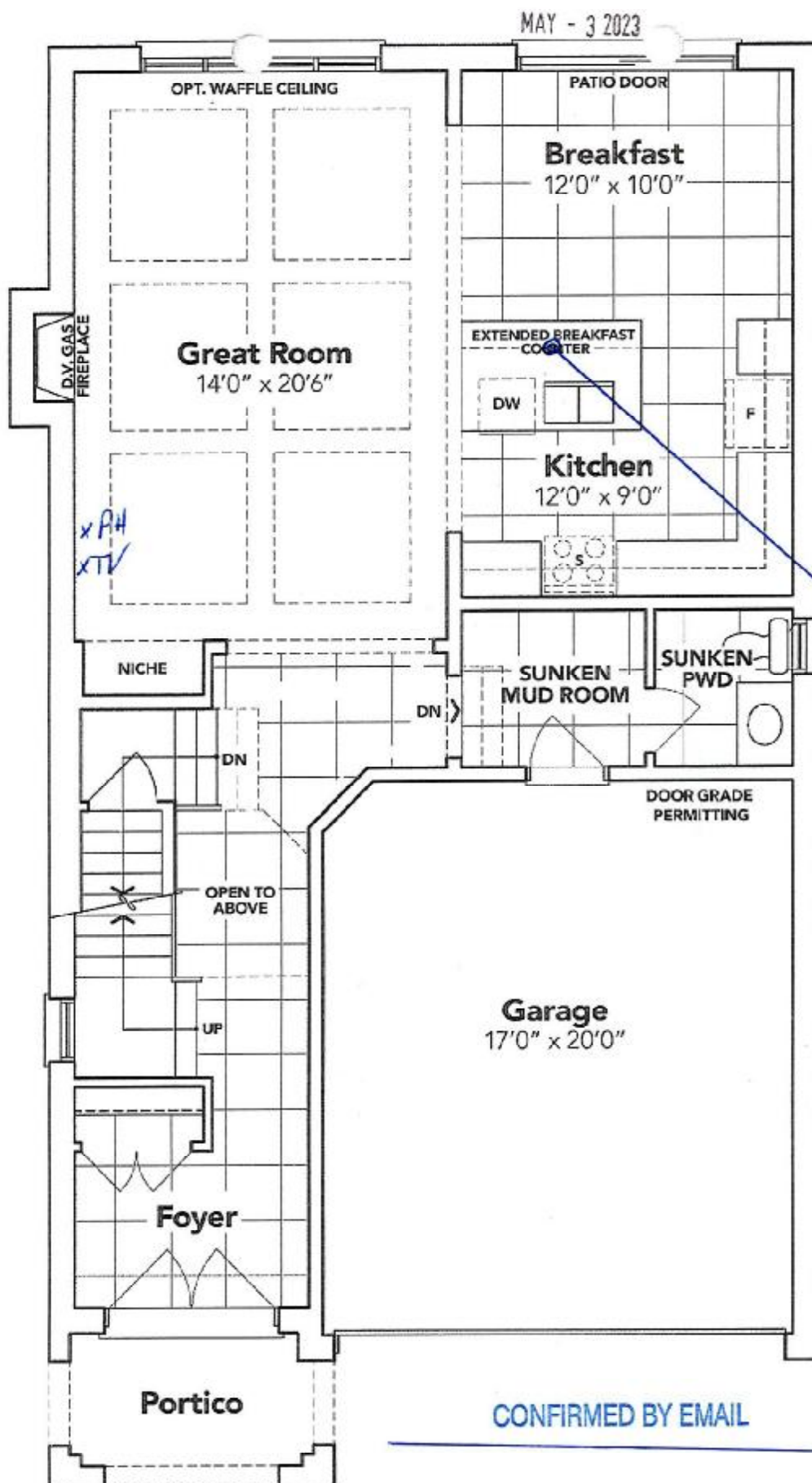

## GROUND FLOOR EL. A

The floor plans and elevations shown are pre-construction plans and may be revised or improved as necessitated by architectural controls and the construction process. The measurements adhere to the rules and regulations of the TARION Warranty Corporation's official method for the calculation of floor area. Materials, specifications and floor plans are subject to change without notice. All house renderings are artist's concept only. Actual usable floor space may vary from the stated floor area. All options shown are upgrades. E. & O. E.

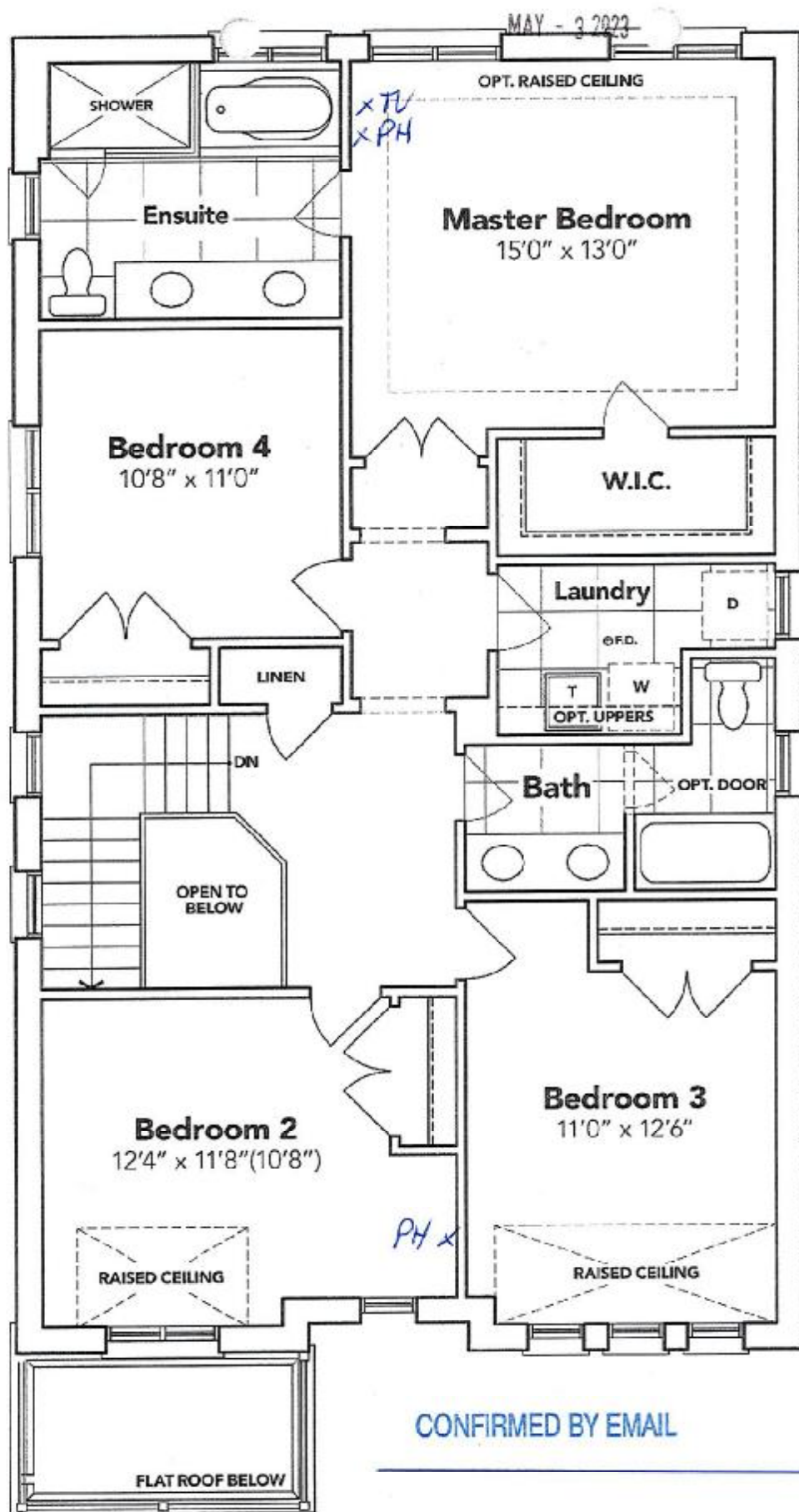

## SECOND FLOOR EL. A

The floor plans and elevations shown are pre-construction plans and may be revised or improved as necessitated by architectural controls and the construction process. The measurements adhere to the rules and regulations of the TARIION Warranty Corporation's official method for the calculation of floor area. Materials, specifications and floor plans are subject to change without notice. All house renderings are artist's concept only. Actual usable floor space may vary from the stated floor area. All options shown are upgrades. E. & O. E.



LOT 96  
THAMES PH. 5B  
SKETCH # 3

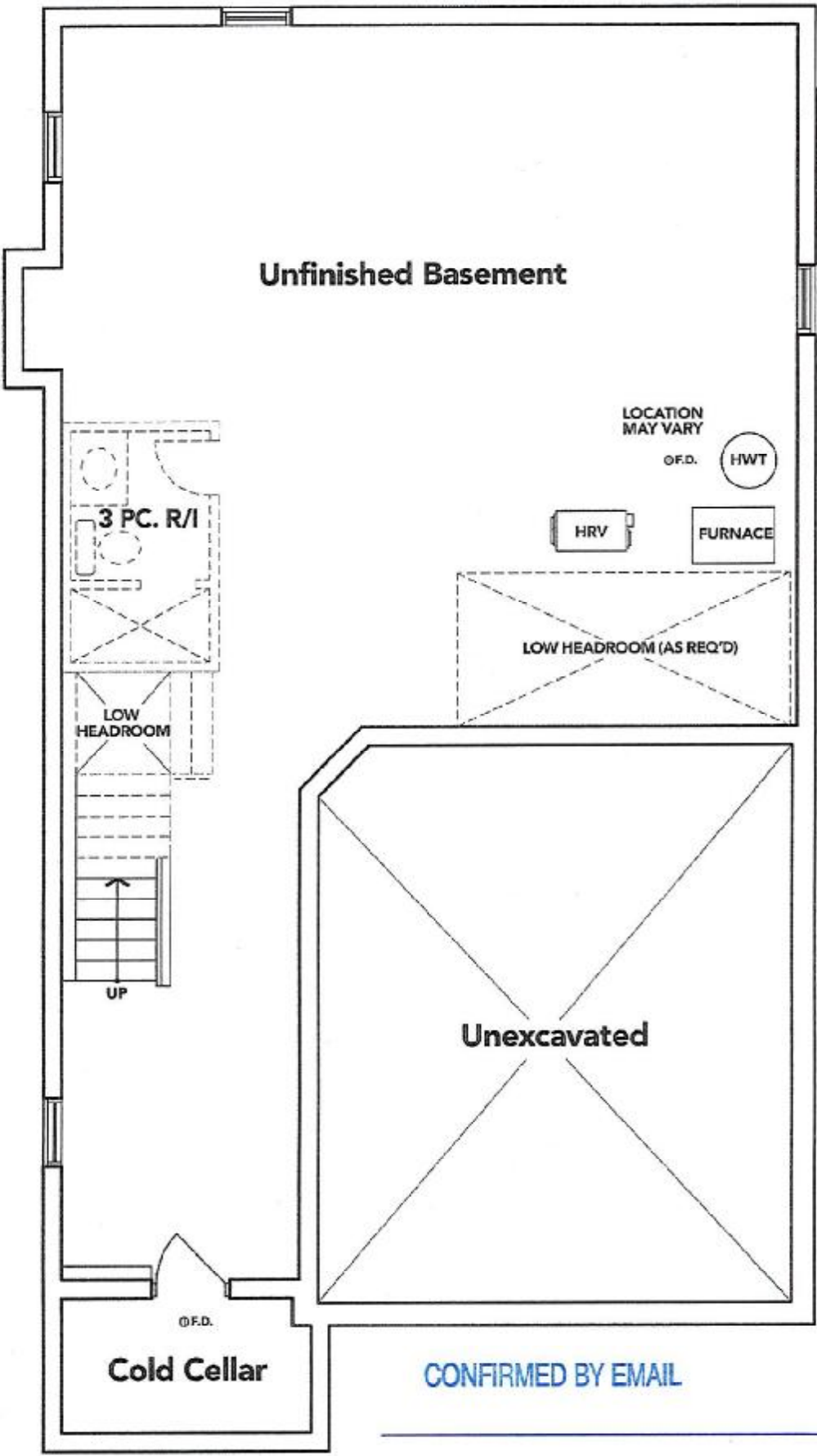

**BASEMENT EL. A**

The floor plans and elevations shown are pre-construction plans and may be revised or improved as necessitated by architectural controls and the construction process. The measurements adhere to the rules and regulations of the TARION Warranty Corporation's official method for the calculation of floor area. Materials, specifications and floor plans are subject to change without notice. All house renderings are artist's concept only. Actual usable floor space may vary from the stated floor area. All options shown are upgrades. E. & O. E.