

Lindsay 2017 Developments Inc. / Sugarwood

Lot/Unit: 44 Phase/Building: 1 Model/Floor Plan: Beaver Lake (4208) Elev A 4Bed 3.5Bath

CABINETRY APPLIANCE - FRIDGE

Inv.5962	1 - TO SUPPLY AND INSTALL 66CM DEEP FRIDGE ENCLOSURE - COUNTER DEPTH WITH NO WALLS - 2 66CM DEEP GABLES AND 1 66CM DEEP CABINET - THIS IS NOT A ZERO CLEARANCE ENCLOSURE. STANDARD HEIGHTS AND WIDTHS WILL BE USED. - CLASSIC SERIES.. SEE SKETCH #1	
Line 78473	Note:	
2Nov22 / 30Apr23		

ELECTRICAL

Inv.5962	1 - TO SUPPLY AND INSTALL THE STANDARD PHONE (CAT 5) ROUGH-IN, IN THE GREAT ROOM, MASTER BEDROOM AND BEDROOM #4.. SEE SKETCH #1	
Line 76424	Note:	
2Nov22 / 30Apr23		
Inv.5962	1 - TO SUPPLY AND INSTALL THE STANDARD TV ROUGH-IN, IN THE GREAT ROOM AND MASTER BEDROOM.. SEE SKETCH #1	
Line 78470	Note:	
2Nov22 / 30Apr23		
Inv.5962	1 - TO SUPPLY AND INSTALL AN ADDITIONAL BASIC RECEPTACLE (NOT DEDICATED) OVER THE F/P MANTLE AT APPROX. 66" UP FROM THE FLOOR NEXT TO THE STANDARD TV AND PHONE ROUGH-IN.. SEE SKETCH #1	
Line 78471	Note:	
2Nov22 / 30Apr23		
Inv.5962	1 - TO SUPPLY AND INSTALL EXTRA CEILING BOX ROUGH IN CAPPED (ON A SEP SWITCH) OVER THE BREAKFAST BAR IN THE KITCHEN.. SEE SKETCH #1	
Line 78472	Note:	
2Nov22 / 30Apr23		

HVAC

Inv.5962	1 - TO SUPPLY A GASLINE (ROUGH-IN ONLY) TO THE STOVE AREA INCLUDING 110V CODE REQUIREMENT	
Line 78475	Note:	
2Nov22 / 30Apr23		

MISCELLANEOUS

PLUMBING

Inv.5962	1 - TO SUPPLY AND INSTALL KITCHEN SINK - BLANCO QUATRUS U2 DBL UNDERMOUNT - MODEL 401247 IN THE KITCHEN IN LIEU OF THE STANDARD.. SEE COLOUR CHART	
Line 78479	Note:	
2Nov22 / 30Apr23		

TILE - BACKSPLASH

Inv.5962	1 - TO SUPPLY AND INSTALL LEVEL #1 TILE TO THE BACKSPLASH STACKED.. SEE COLOUR CHART FOR DETAILS	
Line 78480	Note:	
2Nov22 / 30Apr23		

Lindsay 2017 Developments Inc. / Sugarwood

Lot/Unit: 44 Phase/Building: 1 Model/Floor Plan: Beaver Lake (4208) Elev A 4Bed 3.5Bath

EXTRAS AS PER OFFER

Purchaser: CHETANKUMAR B PATEL

Property: 44 of Plan -

Telephone Res. / Bus: (705) 340-1345 /

Project: Lindsay 2017 Developments Inc.

Decor Advisor: Samantha Castelli

Model and Elevation: Beaver Lake (4208) Elev A 4Bed 3.5Bath

Layout Changes: ☐ Yes ☒ NoSketch Attached: ☒ Yes ☐ No

Exterior Colour Scheme:

1. Cabinetry

	Style and Colour	Counter Top	Hardware
Kitchen / Breakfast	#3 Charleston 3DL Orchid	#1 C/S #3040 CEMENT	12881 HANDLE
Kitchen Island	#3 Charleston 3DL Orchid	#1 C/S #3040 CEMENT	12881 HANDLE
Laundry Room	/	/	/
Powder Room	/	/	/
Main Bathroom	/	/	/
Master Ensuite Bathroom	#3 Charleston 3DL Orchid	White Carrra 4924-38	12881 HANDLE
Second Ensuite Bathroom (If Applicable)	/	/	/
ENS. 2	#3 Charleston 3DL RAIN CLOUD	Calcutta Marble 4925k-07	12881 HANDLE
SHARED BATHROOM	#3 Charleston 3DL RAIN CLOUD	Calcutta Marble 4925k-07	12881 HANDLE

Appliances

Custom Size Fridge

☐ Yes ☒ No

Valance Lighting

☐ Yes ☒ No

Microwave / Range Hood

☐ Yes ☒ No

Cooktop / Rangetop

☐ Yes ☒ No

Built in Wall Oven

☐ Yes ☒ No

Slide-in Range

☐ Yes ☒ No

Comment

REQD / RECEIVED

01-05-2023

2. Flooring

Selection

Foyer	13x13" Piaggio Grey
Main Hall	(including formal room) 3 1/2" ELEMENTS OAK NATURAL
Back Hall	/
Breakfast	13x13" Piaggio Grey
Laundry Room	13x13" Burlingstone White
Kitchen	13x13" Piaggio Grey
Powder Room	13x13" Piaggio Grey
Main Bathroom	SHARED BATHROOM: 13x13" Burlingstone White
Master Ensuite	13x13" Piaggio White
Bathroom (If Applicable)	2ND ENS.: 13x13" Burlingstone White
Mud Room	13x13" Piaggio Grey
Mas/Shared Shower Floor	2x2" Ontario Snow White Matte
Living Room	/
Dining Room	/
Family / Great Room	3 1/2" ELEMENTS OAK NATURAL
Den / Library / Study	/
Basement Landing (If Applies)	/
Lower Landing (If Applicable)	3 1/2" ELEMENTS OAK NATURAL
Upper Landing	3 1/2" ELEMENTS OAK NATURAL
Upper Hall	OPENING NIGHT: 03
Master Bedroom	OPENING NIGHT: 03
Bedroom #2	OPENING NIGHT: 03
Bedroom #3	OPENING NIGHT: 03
Bedroom #4	OPENING NIGHT: 03
Bedroom #5	/
Mas/Shared Shower Jamb	Anatolia Marmiline SNOW

Flooring Continued on Page 2

Initial: Cor.

Page 1 of 3

Purchaser: CHETANKUMAR B PATEL

Property: 44 of Plan -

Telephone Res. / Bus: (705) 340-1345 /

Project: Lindsay 2017 Developments Inc.

Decor Advisor: Samantha Castelli

Model and Elevation: Beaver Lake (4208) Elev A 4Bed 3.5Bath

2. Flooring - Continued -

Upgrade Underpad	Type	Area
	STANDARD	2ND FLOOR
Carpet on Stairs	Capped	Runner - *Upgrade
Comment		

3. Plumbing Fixtures / Faucets

Kitchen	STANDARD	Second Ensuite	STANDARD	Powder Room	STANDARD
Master Ensuite	STANDARD			Other Room	
Main Bathroom		SHARED BATHROOM	STANDARD		

Comment

NOTE: TO SUPPLY AND INSTALL THE UPGRADED UNDERMOUNT KITCHEN SINK WITH THE STANDARD FAUCET. TO SUPPLY AND INSTALL ALL STANDARD PLUMBING FIXTURES IN ALL BATHROOMS.

4. Wall Tile

	Tile Selection	Listello	Insert	Insert Selection
Main Bathroom	/	<input type="checkbox"/>	<input type="checkbox"/>	
Master Ensuite				
Tub Deck	/	<input type="checkbox"/>	<input type="checkbox"/>	
Tub Apron	/	<input type="checkbox"/>	<input type="checkbox"/>	
Tub Surround	/	<input type="checkbox"/>	<input type="checkbox"/>	
Shower Stall	8x10" Burlingstone Taupe	<input type="checkbox"/>	<input type="checkbox"/>	
Second Ensuite	8x10" Burlingstone Light Grey	<input type="checkbox"/>	<input type="checkbox"/>	
SHARED BATHROOM	8x10" Burlingstone Light Grey	<input type="checkbox"/>	<input type="checkbox"/>	
Kitchen Backsplash	*4x16" Soho Canvas White Glossy Press Hor. Stacked	<input type="checkbox"/>	<input type="checkbox"/>	
Complete Backsplash		<input type="checkbox"/>	<input type="checkbox"/>	

Comment

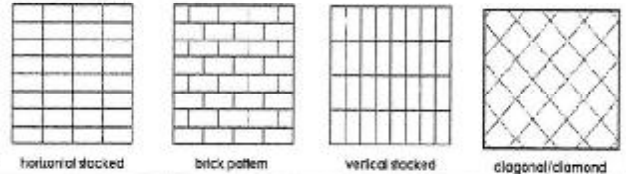

5. Fireplace

	Living Room			Family Room			Other Room - Specify GREAT ROOM		
	Purchased	As Per Plan	N/A	Purchased	As Per Plan	N/A	Purchased	As Per Plan	N/A
Fireplace Type	<input type="radio"/>	<input type="radio"/>	<input type="radio"/>	<input type="radio"/>	<input type="radio"/>	<input type="radio"/>	<input type="radio"/>	<input checked="" type="radio"/>	<input type="radio"/>
Mantle Type									
Over Mantle									
Colour / Stain									
Surround									
Hearth									
Comment									

FRONT FACING
NF-08
/ WHITE

initial: AS

Page 2 of 3

Purchaser: CHETANKUMAR B PATEL

Property: 44 of Plan -

Telephone Res. / Bus: (705) 340-1345 /

Project: Lindsay 2017 Developments Inc.

Decor Advisor: Samantha Castelli

Model and Elevation: Beaver Lake (4208) Elev A 4Bed 3.5Bath

6. Trim Carpentry

Door Hardware STANDARD HANDLE

Interior Trim STANDARD

Comment

Interior Doors

☐ 2 Panel Arch Top

☒ 2 Panel Square Top

☐ 6 Panel



Initial for Door Style CB

7. Railings and Pickets

Railing Package STANDARD TURNED PICKETS

Railing Colour ELEMENTS NATURAL

Picket Colour ELEMENTS NATURAL

Wood Stairs ☐ No ☒ Oak

Tread Colour ELEMENTS NATURAL

Comment

8. Plaster Mouldings and Medallions

Foyer

Main Hall

Living Room

Dining Room

Family Room

Comment

Kitchen/Breakfast

Den/Library

Lower Landing

9. Wall Paint

KINGSMEN WHITE

Smooth Ceilings ☐ First Floor

☐ First Floor incl. Second Floor Hall

☐ First and Second Floor

☒ Throughout

☐ Not Applicable

Trim Paint KINGSMEN WHITE

10. Additional Comments

REC'D / RECEIVED

01-05-2023

11. Disclaimers and Notes

- Colours of all materials are as close as possible to builder's selection, but not necessarily identical due to variances in manufacturing.
- Any extras listed above are null and void unless accompanied by a separate invoice/amendment. Said invoice must be paid in full.
- The Purchaser acknowledges that after Interior Colour Selection form is signed and dated, no further changes will be permitted other than re-selection due to unavailability. CB Purchaser's Initials
- The Purchaser acknowledges reading and accepting the "Kingsmen Group Décor Centre Disclaimers" form. This document contains other miscellaneous disclaimers.

This Interior Colour Selection is final and approved by:

Purchaser:

Signature: S. Patel Date: Apr 11 30/23

Vendor:

Lindsay 2017 Developments Inc.

May 2/23

SCHEDULE "B-1"
Floor Plan

Lindsey ph. 1 Lot 44

Lot 44
Phase 1
Model: Beaver Lake (4208) Elev A 4Bed 3.5Bath
Standard

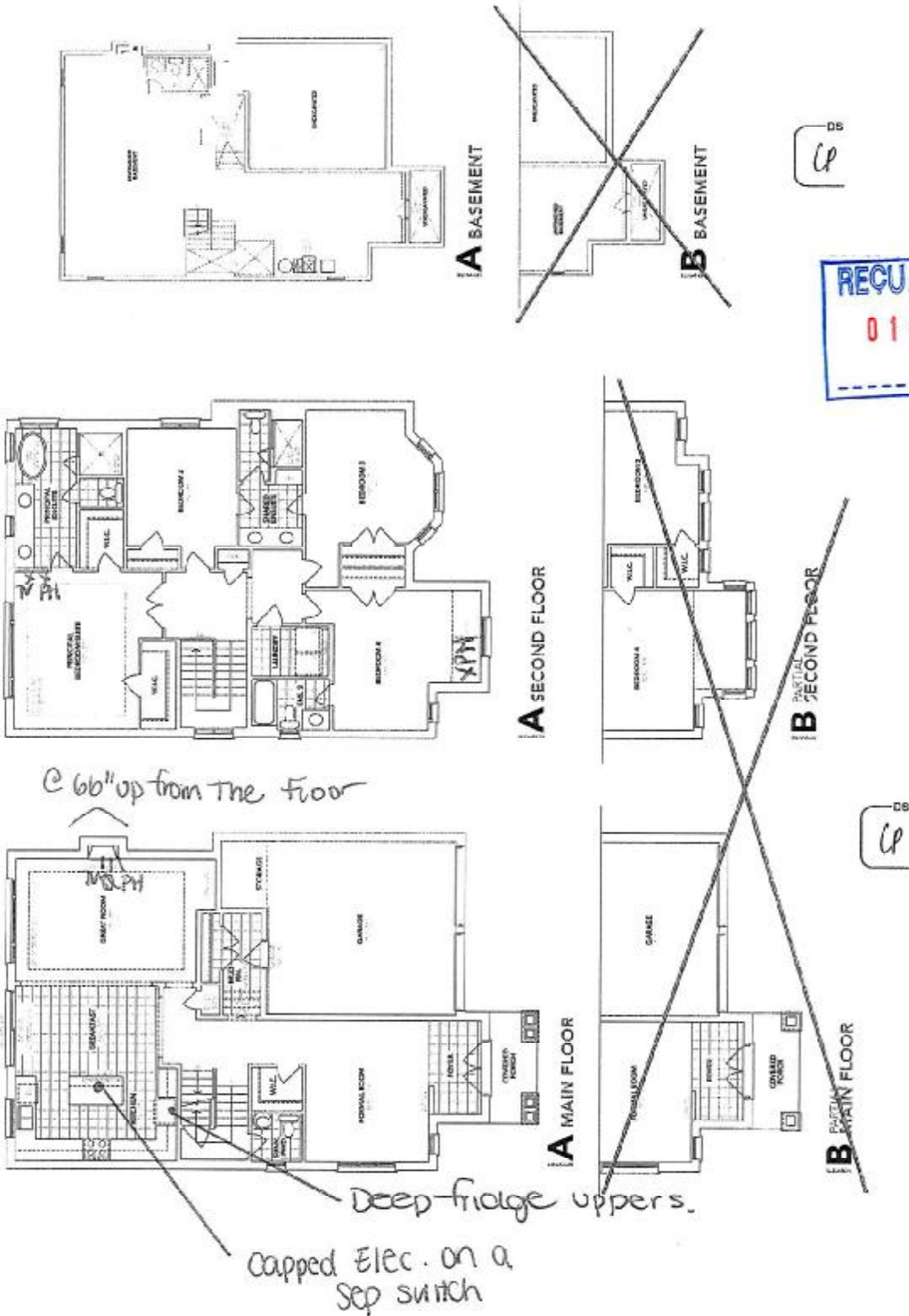

The floor plans and elevations shown are pre-construction plans and may be revised or improved as necessitated by architectural controls and the construction process. The measurements adhere to the rules and regulations of the TARIION Warranty Corporation's official method for the calculation of floor area. Materials, specifications and floor plans are subject to change without notice. All house renderings are artist's concept only. Actual usable floor space may vary from the stated floor area. All options shown are upgrades. E. & O. E.

Lindsay PH.1 Lot 44

LOT 44

LINDSAY PHASE 1

RE: UPG KITCHEN SINK

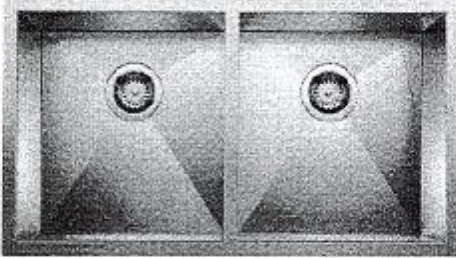

QUATRUS U 2

Stainless steel brushed finish SKU 401247

- 316L (18/10) stainless steel (abrasive)
- Installation instructions
- Cut-out template



203.