

KINGSMEN (THAMES) INC. / Havelock Corners (Kingsmen)

Lot/Unit: 183 Block 151 Phase/Building: 5B Model/Floor Plan: William (2603) Elev B1 4
Bed - 2+1 Bath

CABINETRY VANITY

Inv.6032	1 - To supply & install a VANITY BANK OF DRAWERS - in the master ensuite bathroom...see sketch # 2	
Line 77409	Note:	
23Jan23 / 2Mar23		

CARPET

Inv.6032	1 - To supply & install the ESCAPE TO MAUI carpet to the 2nd floor (where applicable) in lieu of the standard carpet... see colour chart for details.	
Line 77413	Note:	
23Jan23 / 2Mar23		

ELECTRICAL

Inv.6032	1 - To supply & install the standard T.V. rough in in the great room and master bedroom... see sketch # 1 & # 2	
Line 76974	Note: Install the standard T.V. rough in at approx. 66" + - up from the floor centered + - to the F/P mantle in the great room	
23Jan23 / 2Mar23		
Inv.6032	1 - To supply & install the standard Phone (CAT5) rough in in the great room, master bedroom and Bedroom 3 ... see sketch # 1 & # 2	
Line 76975	Note: Install the standard Phone (CAT 5) rough in at approx. 66" + - up from the floor centered + - to the F/P mantle in the great room.	
23Jan23 / 2Mar23		
Inv.6032	1 - To SUPPLY AND INSTALL AN ADDITIONAL BASIC RECEPTACLE (NOT DEDICATED) at approx. 66" + - up from the floor centered +- to the F/P mantle	
Line 77404	Note: in the great room...see sketch #1	
23Jan23 / 2Mar23		
This is for a future wall mount T.V. NO CONDUIT PIPE HAS BEEN PURCHASED		
Inv.6032	1 - To SUPPLY AND INSTALL EXTRA CEILING BOX ROUGH IN CAPPED (DOES NOT INCLUDE SWITCH) over the island in the kitchen...see sketch # 1	
Line 77405	Note: This capped elec. will be connected to a sep. switch. Switch sold sep.	
23Jan23 / 2Mar23		
Inv.6032	1 - To supply & install AN ADDITIONAL SINGLE POLE SWITCH connected to the upgraded capped elec. over the island in the kitchen.	
Line 77406	Note:	
23Jan23 / 2Mar23		

HARDWOOD

Inv.6032	1 - To supply & install the 3 1/2" Elements stained engineered oak flooring to the main floor and stair landing(s) where applicable in lieu of the standard 3 1/2" Elements natural engineered oak flooring... see colour chart for details.	
Line 77410	Note:	
23Jan23 / 2Mar23		

HEATING AND AIR CONDITIONING

Inv.6032	1 - As per schedule "PE": Vendor to install capped gas line (Rough in only) at rear of home for future BBQ location. Location to be finalized at vendors sole discretion.	
Line 76972	Note:	
23Jan23 / 2Mar23		

KINGSMEN (THAMES) INC. / Havelock Corners (Kingsmen)

Lot/Unit: 183 Block 151 Phase/Building: 5B Model/Floor Plan: William (2603) Elev B1 4
Bed - 2+1 Bath

Inv.6032	1 - As per schedule "PE": Vendor to supply & install air conditioning unit, sized accordingly, from vendors standard samples.	
Line 76973	Note:	
23Jan23 / 2Mar23		

PAINT AND DRYWALL

Inv.6032	1 - To supply & install the PAINT EXTRAS - STAIN RAILINGS WITH IRON PICKETS (INCLUDING STAIRS) ... see colour chart for details.	
Line 77412	Note:	
23Jan23 / 2Mar23		

PLUMBING

Inv.6032	1 - To supply & install a WATERLINE ROUGH-IN TO THE FRIDGE LOCATION (NO HOOK UP) in the kitchen.	
Line 77408	Note:	
23Jan23 / 2Mar23		

RAILING

Inv.6032	1 - To supply & install the RAILING - UPGRADE 1 - METAL HANDRAIL 3 INCH OVAL IN OAK - PICKETS STEEL ½ INCH SQUARE, PLAIN, WITH SHOES IN FLAT BLACK - POSTS 3½ INCH SQUARE, WITH CAP OAK IN OAK in lieu of the standard pickets and rails.	
Line 77411	Note:	
23Jan23 / 2Mar23		

EXTRAS AS PER OFFER

5 FREE APPLIANCES ? STAINLESS STEEL FRONT - FRIDGE: STOVE AND DISHWASHER. WHITE WASHER AND DRYER (SUPPLIED ONLY, NOT INSTALLED, FROM BUILDERS STANDARD LINE). AN APPLIANCES VOUCHER WILL BE GIVEN BY OUR DECOR CONSULTANT AT THE TIME OF BOOKING YOUR COLOUR A <i>Worksheet</i> Note:	
5 FREE APPLIANCES – STAINLESS STEEL FRONT - FRIDGE; STOVE AND DISHWASHER. WHITE WASHER AND DRYER (SUPPLIED ONLY, NOT INSTALLED, FROM BUILDERS STANDARD LINE). AN APPLIANCES VOUCHER WILL BE GIVEN BY OUR DECOR CONSULTANT AT THE TIME OF BOOKING YOUR COLOUR A <i>Worksheet</i> Note:	
VENDOR TO INSTALL CAPPED GAS LINE (ROUGH-IN ONLY) AT REAR OF HOME FOR FUTURE BBQ LOCATION. LOCATION TO BE FINALIZED AT VENDORS SOLE DISCRETION. <i>Worksheet</i> Note:	
VENDOR TO SUPPLY & INSTALL AIR CONDITIONING UNIT, SIZED ACCORDINGLY, FROM VENDORS STANDARD SAMPLES. <i>Worksheet</i> Note:	

Purchasers:

TARSEM,S DHILLON, & PRABHJOT DHILLON, Property:

183 Block 151 of Plan - Draft Approval SB

Telephone Res. / Bus:

/

Project:

KINGSMEN (THAMES) INC.

Decor Advisor:

Barbara Coccia

Model and Elevation:

William (2603) Elev B1 4 Bed - 2+1 Bath

Layout Changes:

☐ Yes ☒ No

Sketch Attached:

☒ Yes ☐ No

Exterior Colour Scheme:

1. Cabinetry	Style and Colour	Counter Top	Hardware
Kitchen / Breakfast	# 3 Trinity LPL First Class L583K	# 1 C/S # 9141 Ice Snow 3cm.	# 12881 Handle
Kitchen Island	# 3 Trinity LPL First Class L583K	# 1 C/S # 9141 Ice Snow 3cm.	# 12881 Handle
Laundry Room	/		
Powder Room	# 3 Trinity LPL First Class L583K	# 6698-46 Paloma Polar	# 9671 Handle
Main Bathroom	#2 Slab LPL Stainless	# 4924-38 White Carrara	# 9671 Handle
Master Ensuite Bathroom	#3 Charleston 3DL Orchid	# 4926K-07 Black Alicante	# 9671 Handle
Second Ensuite Bathroom (If Applicable)	/		
	/		
	/		

Appliances

Custom Size Fridge

☐ Yes ☒ No

Valance Lighting

☐ Yes ☒ No

Microwave / Range Hood

☐ Yes ☒ No

Cooktop / Rangetop

☐ Yes ☒ No

Built in Wall Oven

☐ Yes ☒ No

Slide-in Range

☐ Yes ☒ No

Comment

/

2. Flooring	Selection
Foyer	13 x13" Cinq White
Main Hall	** 3 1/2" Elements Oak Sturgeon
Back Hall	/
Breakfast	13 x13" Cinq White
Laundry Room	13 x13" Cinq Black
Kitchen	13 x13" Cinq White
Powder Room	(& small hallway infront of powder room) 13 x13" Cinq White
Main Bathroom	13 x13" Malena Ice
Master Ensuite	13 x13" Keaton Ice
Bathroom (If Applicable)	/
Mud Room	13 x13" Cinq White
Master ens. shower floor:	2x2" Ontario Snow White Matte
Living Room	/
Dining Room	** 3 1/2" Elements Oak Sturgeon
Family / Great Room	** 3 1/2" Elements Oak Sturgeon
Den / Library / Study	/
Basement Landing (If Applies)	
Lower Landing (If Applicable)	** 3 1/2" Elements Oak Sturgeon
Upper Landing	(If applicable) ** 3 1/2" Elements Oak Sturgeon
Upper Hall	** Escape to Maui # 89816 Pilgrim's Path
Master Bedroom	** Escape to Maui # 89816 Pilgrim's Path
Bedroom #2	** Escape to Maui # 89816 Pilgrim's Path
Bedroom #3	** Escape to Maui # 89816 Pilgrim's Path
Bedroom #4	** Escape to Maui # 89816 Pilgrim's Path
Bedroom #5	/
Master ens. shower jamb:	Anatolia Marmiline SNOW

SEE ATTACHED FOR SIGNATURES

Purchasers: TARSEM, S DHILLON, & PRABHJOT DHILLON, Property: 183 Block 151 of Plan - Draft Approval SB
Telephone Res. / Bus: / Project: KINGSMEN (THAMES) INC.
Decor Advisor: Barbara Coccia Model and Elevation: William (2603) Elev B1 4 Bed - 2+1 Bath
2. Flooring - Continued -

Table with 3 columns: Item, Type, Area. Rows include Upgrade Underpad, Carpet on Stairs, and Comment.

3. Plumbing Fixtures / Faucets

Table with 5 columns: Room, Type, Status, Room, Type. Rows include Kitchen, Master Ensuite, Main Bathroom, Powder Room, and Other Room.

Comment
Still to install the standard top mount kitchen sink.

4. Wall Tile

Table with 5 columns: Room, Tile Selection, Listello, Insert, Insert Selection. Rows include Main Bathroom, Master Ensuite, Tub Deck, Tub Apron, Tub Surround, Shower Stall, Second Ensuite, Kitchen Backsplash, and Complete Backsplash.

Comment

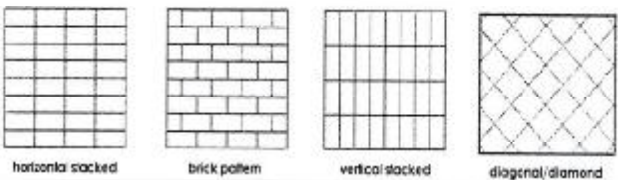

5. Fireplace

Table with 4 main sections: Living Room, Family Room, Other Room - Specify, and Great Room. Each section has options for Purchased, As Per Plan, and N/A, and fields for Fireplace Type, Mantle Type, Over Mantle, Colour / Stain, Surround, and Hearth.

SEE ATTACHED FOR SIGNATURES

Handwritten initials and signatures in red circles.

Initial: _____

Purchasers: TARSEM, S DHILLON, & PRABHJOT DHILLON, **Property:** 183 Block 151 of Plan - Draft Approval SB
Telephone Res. / Bus: / **Project:** KINGSMEN (THAMES) INC.
Decor Advisor: Barbara Coccia **Model and Elevation:** William (2603) Elev B1 4 Bed - 2+1 Bath

6. Trim Carpentry

Door Hardware Standard handle

Interior Trim Standard

Comment

/

Interior Doors

☐ 2 Panel Arch Top

☒ 2 Panel Square Top

☐ 6 Panel

Initial for Door Style

P.D.

P.D.

7. Railings and Pickets

Railing Package **1st. Upgrade Metal picket package

Railing Colour **Elements Sturgeon

Picket Colour **BLACK

Wood Stairs ☐ No ☒ Oak

Tread Colour **Elements Sturgeon

Comment

/

SEE ATTACHED FOR SIGNATURES

8. Plaster Mouldings and Medallions

Foyer /

Main Hall /

Living Room /

Dining Room /

Family Room /

Kitchen/Breakfast /

Den/Library /

Lower Landing /

Comment

/

9. Wall Paint

Kingsmen White

Smooth Ceilings

☐ First Floor

☐ First Floor incl. Second Floor Hall

☐ First and Second Floor

☒ Throughout

☐ Not Applicable

Trim Paint Kingsmen White

10. Additional Comments

/

11. Disclaimers and Notes

- Colours of all materials are as close as possible to builder's selection, but not necessarily identical due to variances in manufacturing.
- Any extras listed above are null and void unless accompanied by a separate invoice/amendment. Said invoice must be paid in full.
- The Purchaser acknowledges that after Interior Colour Selection form is signed and dated, no further changes will be permitted other than re-selection due to unavailability. **Purchaser's Initials** P.D.
- The Purchaser acknowledges reading and accepting the "Kingsmen Group Décor Centre Disclaimers" form. This document contains other miscellaneous disclaimers.

SEE ATTACHED FOR SIGNATURES

This Interior Colour Selection is final and approved by:

Purchaser:

Signature: P. Dhillon **Date:** MAR 2/2023

Signature: S. S. Dhillon **Date:** MAR 2/2023 **Vendor:**

KINGSMEN (THAMES) INC.

5B-Lot 183

LOT 183
BLOCK 151
THAMES PH. 5B
SKETCH # 1

all 3 items
@ 66" up
front floor

Lapped etc.
on a sep skirt



< P. Dillen -
< T.S. Dillen -
SEE ATTACHED FOR SIGNATURE
x

MAIN FLOOR EL. B1

The floor plans and elevations shown are pre-construction plans and may be revised or improved as necessitated by architectural controls and the construction process. The measurements adhere to the rules and regulations of the TARION Warranty Corporation's official method for the calculation of floor area. Materials, specifications and floor plans are subject to change without notice. All house renderings are artist's concept only. Actual usable floor space may vary from the stated floor area. All options shown are upgrades. E. & O. E.

5B-Lot 183

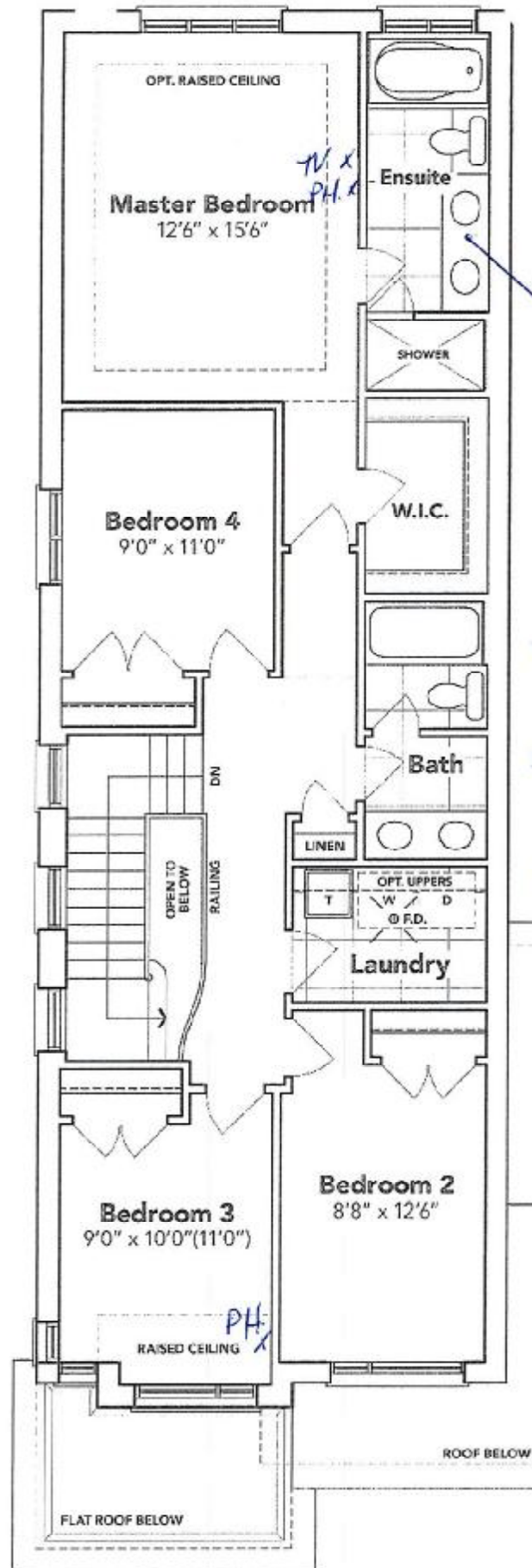

LOT 183
BLOCK 151
THAMES PH. 5B
SKETCH # 2

*Bank of
Dawson*

x P-Miller -

x T. Miller.

SEE ATTACHED FOR SIGNATURES

x

SECOND FLOOR EL. B1

The floor plans and elevations shown are pre-construction plans and may be revised or improved as necessitated by architectural controls and the construction process. The measurements adhere to the rules and regulations of the TARIION Warranty Corporation's official method for the calculation of floor area. Materials, specifications and floor plans are subject to change without notice. All house renderings are artist's concept only. Actual usable floor space may vary from the stated floor area. All options shown are upgrades. E. & O. E.

SCHEDULE "B-1"
Floor Plan

5B-183
 Townhouse No. 183 Block 151
 Phase 5B
 Model: William (2603) Elev B1 4 Bed - 2+1 Bath
 End - Standard

LOT 183
BLOCK 151
THAMES PH. 5B
SKETCH # 3

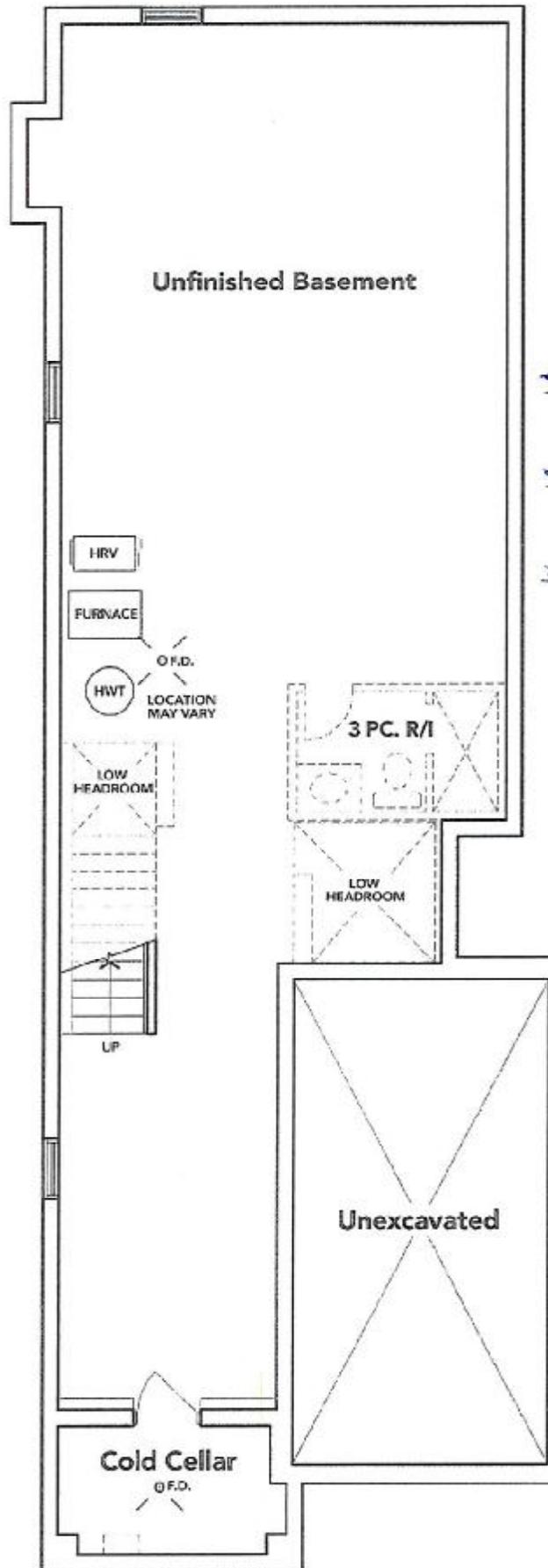

P. Miller
T.S. Miller
 SEE ATTACHED FOR SIGNATURES

BASEMENT EL. B1

The floor plans and elevations shown are pre-construction plans and may be revised or improved as necessitated by architectural controls and the construction process. The measurements adhere to the rules and regulations of the TARIION Warranty Corporation's official method for the calculation of floor area. Materials, specifications and floor plans are subject to change without notice. All house renderings are artist's concept only. Actual usable floor space may vary from the stated floor area. All options shown are upgrades. E. & O. E.