

Lindsay 2017 Developments Inc. / Sugarwood

Lot/Unit: 29 Phase/Building: 1 Model/Floor Plan: Talbot Lake (3703) Elev A 3Bed 2.5Bath

DOORS AND WINDOWS

ELECTRICAL

Inv.6097 Line 77454 5Mar23 / 5Mar23	1 - To supply and install the standard Phone (CAT 5) Rough-in, in the Great Room, Master Bedroom and Bedroom #3.. see sketch #3 and #4 Note:	
Inv.6097 Line 77455 5Mar23 / 5Mar23	1 - To supply and install the standard TV Rough-in, in the Great Room and Master Bedroomand.. see sketch #3 and #4 Note:	
Inv.6097 Line 77456 5Mar23 / 5Mar23	1 - To SUPPLY AND INSTALL AN ADDITIONAL BASIC RECEPTACLE (NOT DEDICATED) next to the standard Phone and TV rough-in, in the Great Room.. see sketch #3 Note:	
Inv.6097 Line 77457 5Mar23 / 5Mar23	2 - To SUPPLY AND INSTALL TWO ADDITIONAL BASIC RECEPTACLE (NOT DEDICATED) in the master bedroom.. see sketch #4 for details Note:	
Inv.6097 Line 77460 5Mar23 / 5Mar23	1 - To SUPPLY AND INSTALL TWO EXTRA CEILING BOX ROUGH IN CAPPED (ON A SEPARATE SWITCH) in the kitchen over the breakfast bar.. see sketch #3 Note:	
Inv.6097 Line 77466 5Mar23 / 5Mar23	1 - To teminate the central vacuum rough-in in the garage in lieu of the basement..the location of the rough-in in the garage is at the Vendors sole discretion Note:	

HARDWOOD

Inv.6097 Line 77468 5Mar23 / 5Mar23	1 - To supply and install 3 1/2" Elements Oak Natural to the upper hallway, in lieu of the standard carpet.. see colour chart for details Note:	
---	--	--

MISCELLANEOUS

PLUMBING

Inv.6097 Line 77461 5Mar23 / 5Mar23	1 - To supply a WATERLINE ROUGH-IN TO THE FRIDGE LOCATION (NO HOOK UP) Note:	
Inv.6097 Line 77462 5Mar23 / 5Mar23	1 - To supply and install KITCHEN SINK - BLANCO QUATRUS U2 UNDERMOUNT - MODEL 401247 in lieu of the standard sink.. see spec's Note:	

STAIRS AND RAILING

Lindsay 2017 Developments Inc. / Sugarwood

Lot/Unit: 29 Phase/Building: 1 Model/Floor Plan: Talbot Lake (3703) Elev A 3Bed 2.5Bath

Inv.6097	1 - To supply and install the straight oak pickets in lieu of the turned pickets.. see colour chart for details	
Line 77467	Note:	
5Mar23 / 5Mar23		

EXTRAS AS PER OFFER

Purchasers: NING ZHANG & LAMDUAN ZHANG

Property: 29 of Plan -

Telephone Res. / Bus: (647) 401-5589 /

Project: Lindsay 2017 Developments Inc.

Decor Advisor: Samantha Castelli

Model and Elevation: Talbot Lake (3703) Elev A 3Bed 2.5Bath

Layout Changes: ☐ Yes ☒ NoSketch Attached: ☒ Yes ☐ No

Exterior Colour Scheme:

1. Cabinetry

	Style and Colour	Counter Top	Hardware
Kitchen / Breakfast	#3 Charleston 3DL Orchid	#1 C/S #9141 Ice Snow	12881 Handle
Kitchen Island	#3 Charleston 3DL Orchid	#1 C/S #9141 Ice Snow	12881 Handle
Laundry Room	/	/	/
Powder Room	/	/	/
Main Bathroom	#2 Huron Ontario White	Paloma Polar 6698-46	9661 Handle
Master Ensuite Bathroom	#2 Huron Ontario White	Paloma Polar 6698-46	9661 Handle
Second Ensuite Bathroom (If Applicable)	/	/	/
	/	/	/
	/	/	/

Appliances

Custom Size Fridge

☐ Yes ☒ No

Valance Lighting

☐ Yes ☒ No

Microwave / Range Hood

☐ Yes ☒ No

Cooktop / Rangetop

☐ Yes ☒ No

Built in Wall Oven

☐ Yes ☒ No

Slide-in Range

☐ Yes ☒ No

Comment

2. Flooring

	Selection
Foyer	13x13" Malena Ice
Main Hall	3 1/2" Elements Oak Natural
Back Hall	/
Breakfast	3 1/2" Elements Oak Natural
Laundry Room	13x13" Malena Carbon
Kitchen	13x13" Malena Ice
Powder Room	13x13" Malena Ice
Main Bathroom	13x13" Malena Carbon
Master Ensuite Bathroom (If Applicable)	13x13" Malena Carbon
Mud Room	13x13" Malena Ice
Master Ens. Shower Floor	2x2" Ontario Snow White Matte
Living Room	/
Dining Room	/
Family / Great Room	3 1/2" Elements Oak Natural
Den / Library / Study	/
Basement Landing (If Applies)	
Lower Landing (If Applicable)	3 1/2" Elements Oak Natural
Upper Landing	3 1/2" Elements Oak Natural
Upper Hall	**3 1/2" Elements Oak Natural
Master Bedroom	Opening Night: 21
Bedroom #2	Opening Night: 21
Bedroom #3	Opening Night: 21
Bedroom #4	/
Bedroom #5	/
Master Ens. Shower Jamb	Anatolia Marmiline SNOW



Flooring Continued on Page 2

Initial:

Page 1 of 3

Purchasers: NING ZHANG & LAMDUAN ZHANG

Property: 29 of Plan -

Telephone Res. / Bus: (647) 401-5589 /

Project: Lindsay 2017 Developments Inc.

Decor Advisor: Samantha Castelli

Model and Elevation: Talbot Lake (3703) Elev A 3Bed 2.5Bath

2. Flooring - Continued -

Upgrade Underpad	Type	Area
	Standard	Master, Bedroom #2 and #3
Carpet on Stairs	Capped	Runner - *Upgrade
Comment		

3. Plumbing Fixtures / Faucets

Kitchen	Standard	Second Ensuite	/	Powder Room	Standard
Master Ensuite	Standard			Other Room	/
Main Bathroom	Standard		/		



Comment

To supply and install the standard faucet with the upgraded undermount sink in the kitchen. To supply and install all standard fixtures in all bathrooms.

4. Wall Tile

	Tile Selection	Listello	Insert	Insert Selection
Main Bathroom	8x10" Malena Ice	<input type="checkbox"/>	<input type="checkbox"/>	
Master Ensuite				
Tub Deck	/	<input type="checkbox"/>	<input type="checkbox"/>	
Tub Apron	/	<input type="checkbox"/>	<input type="checkbox"/>	
Tub Surround	/	<input type="checkbox"/>	<input type="checkbox"/>	
Shower Stall	8x10" Malena Ice	<input type="checkbox"/>	<input type="checkbox"/>	
Second Ensuite	/	<input type="checkbox"/>	<input type="checkbox"/>	
		<input type="checkbox"/>	<input type="checkbox"/>	
		<input type="checkbox"/>	<input type="checkbox"/>	
Kitchen Backsplash	/	<input type="checkbox"/>	<input type="checkbox"/>	
Complete Backsplash	/	<input type="checkbox"/>	<input type="checkbox"/>	

Comment

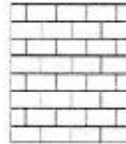
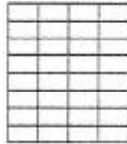

horizontal stacked brick pattern vertical stacked diagonal/diamond

5. Fireplace

	Living Room			Family Room			Other Room - Specify Great Room		
	Purchased	As Per Plan	N/A	Purchased	As Per Plan	N/A	Purchased	As Per Plan	N/A
Fireplace Type	<input type="radio"/>	<input type="radio"/>	<input type="radio"/>	<input type="radio"/>	<input type="radio"/>	<input type="radio"/>	<input type="radio"/>	<input checked="" type="radio"/>	<input type="radio"/>
Mantle Type							Front Facing		
Over Mantle							NF-08		
Colour / Stain							White		
Surround									
Hearth									
Comment									

REC'D / RECEIVED
06-03-2023

Initial: 

Page 2 of 3

Purchasers: NING ZHANG & LAMDUAN ZHANG

Property: 29 of Plan -

Telephone Res. / Bus: (647) 401-5589 /

Project: Lindsay 2017 Developments Inc.

Decor Advisor: Samantha Castelli

Model and Elevation: Talbot Lake (3703) Elev A 3Bed 2.5Bath

6. Trim Carpentry

Door Hardware

Interior Trim

Comment

Interior Doors

☐ 2 Panel Arch Top

☒ 2 Panel Square Top

☐ 6 Panel

Initial for Door Style

7. Railings and Pickets

Railing Package

Railing Colour

Picket Colour

Wood Stairs ☐ No ☒ Oak

Tread Colour

Comment

8. Plaster Mouldings and Medallions

Foyer

Main Hall

Living Room

Dining Room

Family Room

Kitchen/Breakfast

Den/Library

Lower Landing

Comment

9. Wall Paint

Smooth Ceilings ☐ First Floor
☐ First Floor incl. Second Floor Hall
☐ First and Second Floor
☒ Throughout
☐ Not Applicable

Trim Paint

10. Additional Comments

REC'D/RECEIVED

06-03-2023

11. Disclaimers and Notes

- Colours of all materials are as close as possible to builder's selection, but not necessarily identical due to variances in manufacturing.
- Any extras listed above are null and void unless accompanied by a separate invoice/amendment. Said invoice must be paid in full.
- The Purchaser acknowledges that after Interior Colour Selection form is signed and dated, no further changes will be permitted other than re-selection due to unavailability. NS Purchaser's Initials
- The Purchaser acknowledges reading and accepting the "Kingsmen Group Décor Centre Disclaimers" form. This document contains other miscellaneous disclaimers.

This Interior Colour Selection is final and approved by:

Purchaser:

Signature:

Date:

March-5-2023

Signature:

Date:

3/05/2023

Vendor:

Lindsay 2017 Developments Inc.

March 7/23

SCHEDULE "B-1"
Floor Plan

Lindsay PH-1 Lot 29
Lot 29
Phase 1
Model: Talbot Lake (3703) Elev A 3Bed 2.5Bath
Standard

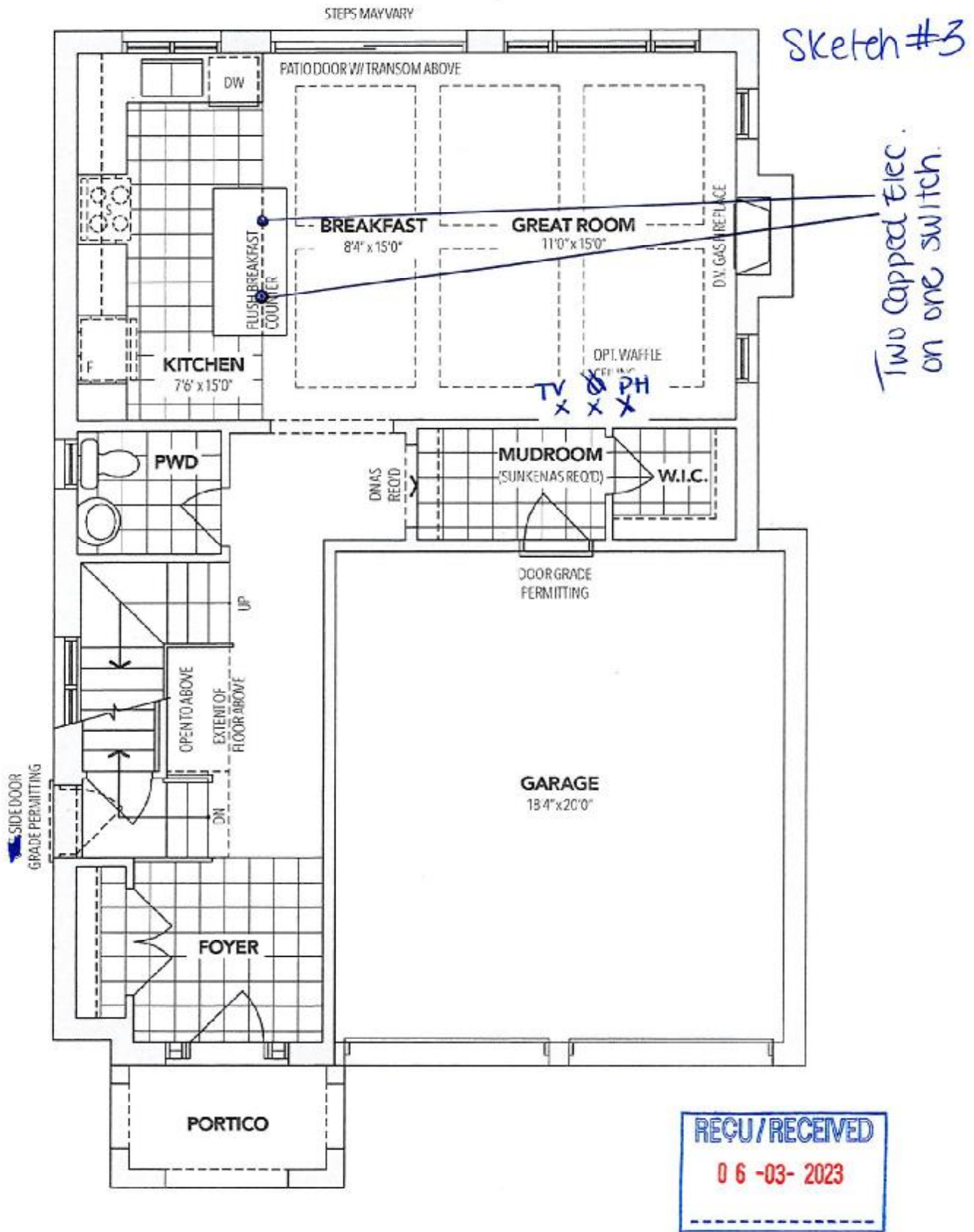

ELEVATION
A MAIN FLOOR

The floor plans and elevations shown are pre-construction plans and may be revised or improved as necessitated by architectural controls and the construction process. The measurements adhere to the rules and regulations of the TARIION Warranty Corporation's official method for the calculation of floor area. Materials, specifications and floor plans are subject to change without notice. All house renderings are artist's concept only. Actual usable floor space may vary from the stated floor area. All options shown are upgrades. E. & O. E.

SCHEDULE "B-1" - Page 1 of 3

SCHEDULE "B-1"
Floor Plan

Lindsay PH.1 Lot 29
Lot 29
Phase 1
Model: Talbot Lake (3703) Elev A 3Bed 2.5Bath
Standard

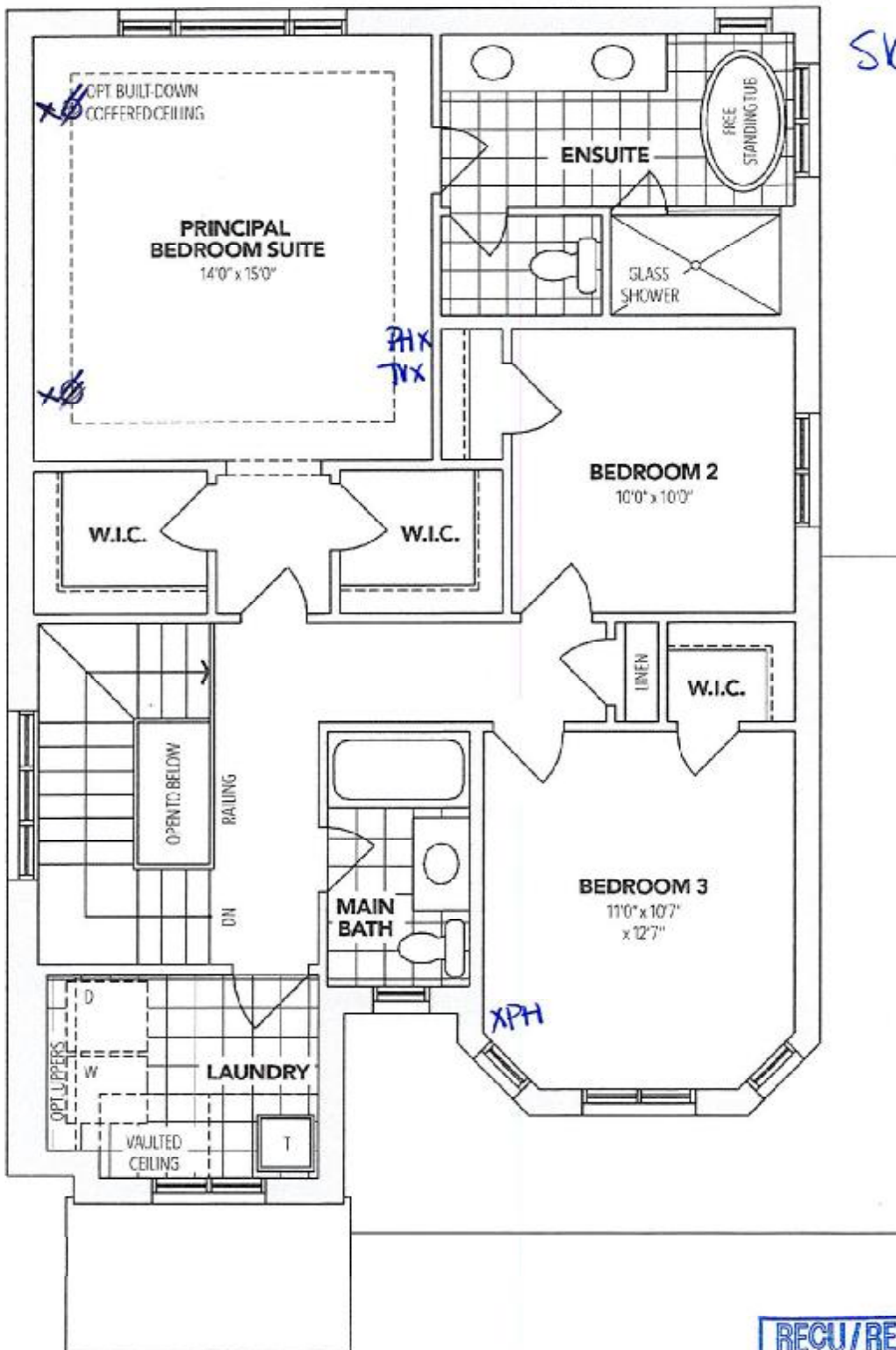

ELEVATION **A** SECOND FLOOR



The floor plans and elevations shown are pre-construction plans and may be revised or improved as necessitated by architectural controls and the construction process. The measurements adhere to the rules and regulations of the TARION Warranty Corporation's official method for the calculation of floor area. Materials, specifications and floor plans are subject to change without notice. All house renderings are artist's concept only. Actual usable floor space may vary from the stated floor area. All options shown are upgrades. E. & O. E.

SCHEDULE "B-1" - Page 2 of 3

SCHEDULE "B-1"
Floor Plan

Lindsay PH.1 Lot 29

Lot 29
Phase 1

Model: Talbot Lake (3703) Elev A 3Bed 2.5Bath
Standard

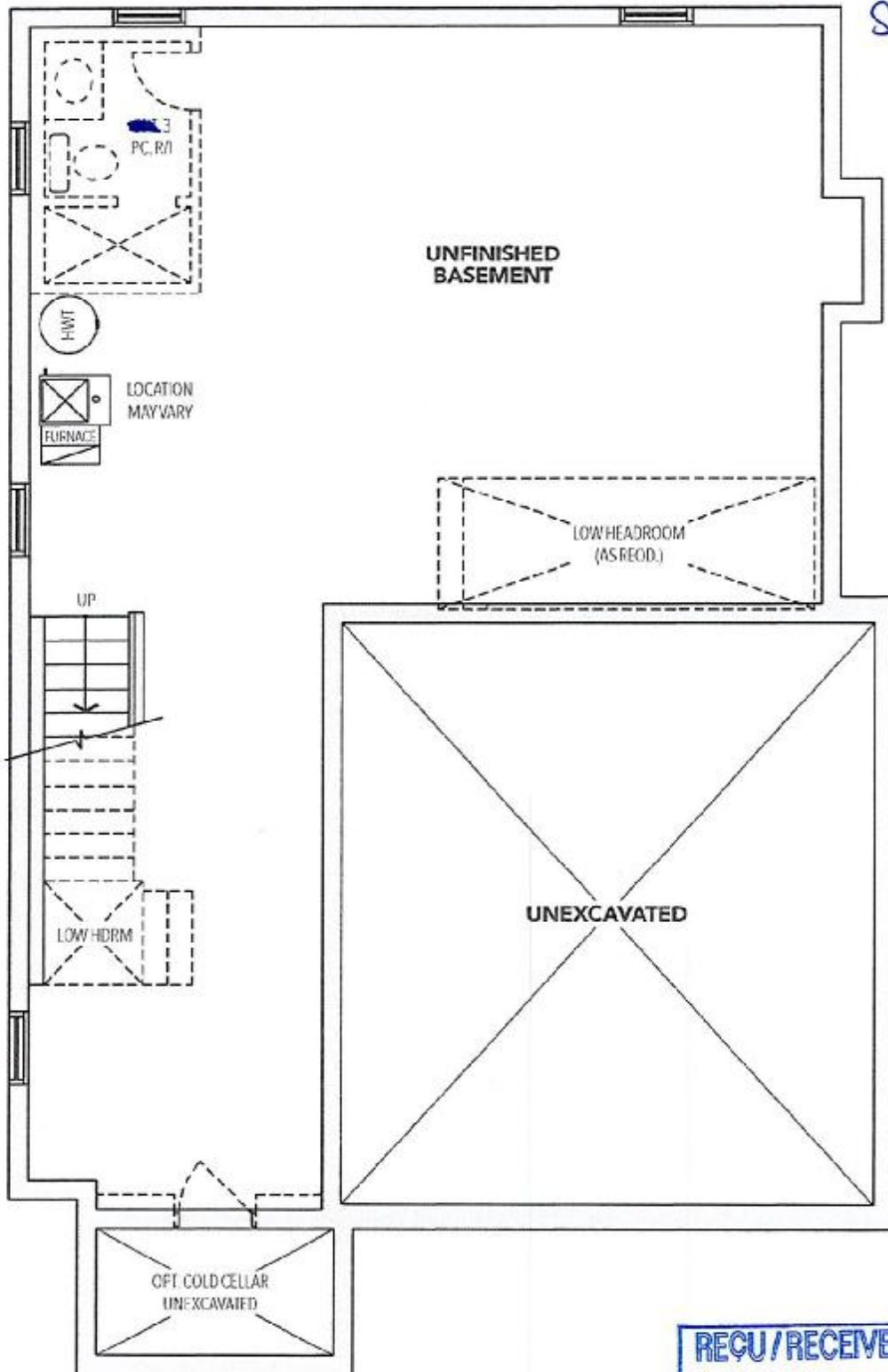

Sketch #5

ELEVATION
A BASEMENT



The floor plans and elevations shown are pre-construction plans and may be revised or improved as necessitated by architectural controls and the construction process. The measurements adhere to the rules and regulations of the TARION Warranty Corporation's official method for the calculation of floor area. Materials, specifications and floor plans are subject to change without notice. All house renderings are artist's concept only. Actual usable floor space may vary from the stated floor area. All options shown are upgrades. E. & O. E.

SCHEDULE "B-1" - Page 3 of 3

Lindsay PH 1
LOT 29.
RE: UPG. Kitchen
Sink.



BLANCO

Sink Specifications

Colour	SKU
brushed finish	401247

Design and planning tips

- Min cabinet size: 36 in (915 mm)
- Bowl Depth: 9 in (230.0 mm)

Specifications:

Installation clips, Sink template, Installation instructions, 3 1/2" (90 mm) stainless steel strainers

Depending on cabinet construction, a different cabinet size may be required. Consult the cabinet manufacturer.

QUATRUS U 2

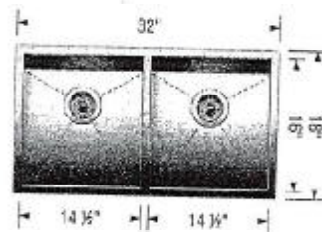

W.G. K.