

KINGSMEN (THAMES) INC. / Havelock Corners (Kingsmen)

Lot/Unit: 194 Block 152 Phase/Building: 5B Model/Floor Plan: William (2603) Elev B2 4
Bed - 2+1 Bath

ELECTRICAL

Inv.6050	1 - To supply & install the standard T.V. rough in in the great room and master bedroom... see sketch # 1 & # 2	
Line 77112	Note: Install the standard T.V. at approx. 66" + - up from the floor in the great room and master bedroom..	
2Feb23 / 8Feb23		
Inv.6050	1 - To supply & install the standard Phone (CAT5) rough in in the great room, master bedroom and Bedroom # 2 ... see sketch # 1 & # 2	
Line 77113	Note: Install the standard Phone (CAT 5) at approx. 66" + - up from the floor in the great room and master bedroom..	
2Feb23 / 8Feb23		
Inv.6050	1 - To SUPPLY AND INSTALL AN ADDITIONAL BASIC RECEPTACLE (NOT DEDICATED) at approx. 66" + - up from the floor centered + - to the F/P mantle	
Line 77143	Note: in the great room... see sketch # 1	
2Feb23 / 8Feb23	This is for a future wall mount T.V. NO CONDUIT PIPE HAS BEEN PURCHASED.	
Inv.6050	1 - To SUPPLY AND INSTALL AN ADDITIONAL BASIC RECEPTACLE (NOT DEDICATED) at approx. 66" + - up from the floor in the master bedroom...see sketch # 2	
Line 77144	Note: This is for a future wall mount T.V. NO CONDUIT PIPE HAS BEEN PURCHASED.	
2Feb23 / 8Feb23		
Inv.6050	1 - To SUPPLY AND INSTALL EXTRA CEILING BOX ROUGH IN CAPPED (DOES NOT INCLUDE SWITCH) over the island in the kitchen... see sketch # 1	
Line 77145	Note: This cap will be connected to a sep. switch, switch sold sep.	
2Feb23 / 8Feb23		
Inv.6050	1 - To supply & install AN ADDITIONAL SINGLE POLE SWITCH connected to the upgraded capped elec. over the island in the kitchen.	
Line 77146	Note:	
2Feb23 / 8Feb23		
Inv.6050	1 - Relocate the standard ceiling light from the upper stair landing to the O.T.B. area on the second floor... see sketch # 2	
Line 77147	Note:	
2Feb23 / 8Feb23		

HEATING AND AIR CONDITIONING

Inv.6050	1 - As per schedule "PE": Vendor to install capped gas line (Rough in only) at rear of home for future BBQ location. Location to be finalized at vendors sole discretion	
Line 77110	Note:	
2Feb23 / 8Feb23		
Inv.6050	1 - As per schedule "PE": Vendor to supply & install air conditioning unit, sized accordingly, from vendors standard samples	
Line 77111	Note:	
2Feb23 / 8Feb23		

PLUMBING

Inv.6050	1 - To supply & install the KITCHEN SINK - BLANCO QUATRUS U2 DBL UNDERMOUNT - MODEL 401247 in the kitchen in lieu of the standard top mount kitchen sink...see spec's	
Line 77148	Note: Still to install the standard single hole kitchen faucet... NO PLATE.	
2Feb23 / 8Feb23		

KINGSMEN (THAMES) INC. / Havelock Corners (Kingsmen)

Lot/Unit: 194 Block 152 Phase/Building: 5B Model/Floor Plan: William (2603) Elev B2 4
Bed - 2+1 Bath

TILE - WALL

Inv.6050	1 - To supply & install the UPGRADE 1 - BACKSPLASH TILE - - KITCHEN SPLASH TILE in a 70/30 + - off set horizontal pattern ... see colour chart for details.	
Line 77149	Note:	
2Feb23 / 8Feb23		

EXTRAS AS PER OFFER

5 FREE APPLIANCES – STAINLESS STEEL FRONT - FRIDGE; STOVE AND DISHWASHER. WHITE WASHER AND DRYER (SUPPLIED ONLY, NOT INSTALLED, FROM BUILDERS STANDARD LINE). AN APPLIANCES VOUCHER WILL BE GIVEN BY OUR DECOR CONSULTANT AT THE TIME OF BOOKING YOUR COLOUR A <i>Worksheet</i> Note:	
VENDOR TO INSTALL CAPPED GAS LINE (ROUGH-IN ONLY) AT REAR OF HOME FOR FUTURE BBQ LOCATION. LOCATION TO BE FINALIZED AT VENDORS SOLE DISCRETION. <i>Worksheet</i> Note:	
VENDOR TO SUPPLY & INSTALL AIR CONDITIONING UNIT, SIZED ACCORDINGLY, FROM VENDORS STANDARD SAMPLES. <i>Worksheet</i> Note:	

Purchaser: BALDEV, SINGH GILL,

Property: 194 Block 152 of Plan - Draft Approval SB

Telephone Res. / Bus: /

Project: KINGSMEN (THAMES) INC.

Decor Advisor: Barbara Coccia

Model and Elevation: William (2603) Elev B2 4 Bed - 2+1 Bath

Layout Changes: ☐ Yes ☒ NoSketch Attached: ☒ Yes ☐ No

Exterior Colour Scheme:

1. Cabinetry

	Style and Colour	Counter Top	Hardware
Kitchen / Breakfast	#3 Camden Maple Cashew CL	#1, C/S # 9141 Ice Snow 3cm.	# 12843 Handle
Kitchen Island	#3 Camden Maple Cashew CL	#1, C/S # 9141 Ice Snow 3cm.	# 12843 Handle
Laundry Room	/		
Powder Room	#3 Camden Maple Cashew CL	# 1876K-52 Spring Carnival	# 12843 Handle
Main Bathroom	#3 Charleston 3DL Orchid	# 6898-46 Paloma Polar	#135 Knob
Master Ensuite Bathroom	#3 Camden Maple Oyster CL	# 1876K-52 Spring Carnival	# 9661 Handle
Second Ensuite Bathroom (If Applicable)	/		
	/		
	/		

Appliances

Custom Size Fridge

☐ Yes ☒ No

Valance Lighting

☐ Yes ☒ No

Microwave / Range Hood

☐ Yes ☒ No

Cooktop / Rangetop

☐ Yes ☒ No

Built in Wall Oven

☐ Yes ☒ No

Slide-in Range

☐ Yes ☒ No

Comment

2. Flooring

	Selection
Foyer	13 x 13" Cinq White
Main Hall	3 1/2" Elements Oak Natural
Back Hall	/
Breakfast	13 x 13" Cinq White
Laundry Room	13 x 13" Cinq White
Kitchen	13 x 13" Cinq White
Powder Room	(& small hallway in front of powder room) 13 x 13" Cinq White
Main Bathroom	13 x 13" Cinq White
Master Ensuite	13 x 13" Cinq White
Bathroom (If Applicable)	/
Mud Room	13 x 13" Cinq White
Master ens. shower floor:	2x2" Ontario Snow White Matte
Living Room	/
Dining Room	3 1/2" Elements Oak Natural
Family / Great Room	3 1/2" Elements Oak Natural
Den / Library / Study	/
Basement Landing (If Applies)	
Lower Landing (If Applicable)	3 1/2" Elements Oak Natural
Upper Landing	(if applicable) 3 1/2" Elements Oak Natural
Upper Hall	Modern Story 1, # 720 Autumn Glow
Master Bedroom	Modern Story 1, # 720 Autumn Glow
Bedroom #2	Modern Story 1, # 720 Autumn Glow
Bedroom #3	Modern Story 1, # 720 Autumn Glow
Bedroom #4	Modern Story 1, # 720 Autumn Glow
Bedroom #5	/
Master ens. shower jamb:	Anatolia Marmiline SNOW

Flooring Continued on Page 2

Initial: 

Page 1 of 3

FEB 8 - 2023

Purchaser: BALDEV, SINGH GILL, **Property:** 194 Block 152 of Plan - Draft Approval SB
Telephone Res. / Bus: / **Project:** KINGSMEN (THAMES) INC.
Decor Advisor: Barbara Coccia **Model and Elevation:** William (2603) Elev B2 4 Bed - 2+1 Bath
2. Flooring - Continued -

Upgrade Underpad	Type	Area
	Standard	2nd. Floor
Carpet on Stairs	Capped	Runner - *Upgrade
Comment	/	/

3. Plumbing Fixtures / Faucets

Kitchen	Standard	Second Ensuite	/	Powder Room	Standard
Master Ensuite	Standard			Other Room	/
Main Bathroom	Standard				
Comment					
Purchaser has upgraded to an under mount kitchen sink... still to install the standard single hole kitchen faucet NO PLATE.					

4. Wall Tile

	Tile Selection	Listello	Insert	Insert Selection
Main Bathroom	8x10" Cinq White	<input type="checkbox"/>	<input type="checkbox"/>	
Master Ensuite				
Tub Deck	13 x 13" Cinq White	<input type="checkbox"/>	<input type="checkbox"/>	
Tub Apron	13 x 13" Cinq White	<input type="checkbox"/>	<input type="checkbox"/>	
Tub Surround	13 x 13" Cinq White	<input type="checkbox"/>	<input type="checkbox"/>	
Shower Stall	8x10" Cinq White	<input type="checkbox"/>	<input type="checkbox"/>	
Second Ensuite	/	<input type="checkbox"/>	<input type="checkbox"/>	
	/	<input type="checkbox"/>	<input type="checkbox"/>	
	/	<input type="checkbox"/>	<input type="checkbox"/>	
Kitchen Backsplash	**3x6" Marlow Glossy Dessert 70/30+- off set horizontal	<input type="checkbox"/>	<input type="checkbox"/>	
Complete Backsplash	/	<input type="checkbox"/>	<input type="checkbox"/>	
Comment				
/				



horizontal stacked

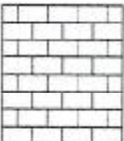

brick pattern



vertical stacked



diagonal diamond

5. Fireplace

	Living Room			Family Room			Other Room - Specify Great Room		
	Purchased	As Per Plan	N/A	Purchased	As Per Plan	N/A	Purchased	As Per Plan	N/A
Fireplace Type	<input type="radio"/>	<input type="radio"/>	<input checked="" type="radio"/>	<input type="radio"/>	<input type="radio"/>	<input checked="" type="radio"/>	<input type="radio"/>	<input checked="" type="radio"/>	<input type="radio"/>
Mantle Type									
Over Mantle									
Colour / Stain									
Surround									
Hearth									
Comment	/								



Initial: _____

Purchaser: BALDEV, SINGH GILL,

Property: 194 Block 152 of Plan - Draft Approval SB

Telephone Res. / Bus: /

Project: KINGSMEN (THAMES) INC.

Decor Advisor: Barbara Coccia

Model and Elevation: William (2603) Elev B2 4 Bed - 2+1 Bath

6. Trim Carpentry

Door Hardware Standard handle

Interior Trim Standard

Comment

/

Interior Doors

☐ 2 Panel Arch Top

☒ 2 Panel Square Top

☐ 6 Panel

Initial for Door Style



7. Railings and Pickets

Railing Package Standard Oak TURNED picket package

Railing Colour Elements Natural

Picket Colour Elements Natural

Wood Stairs ☐ No ☒ Oak

Tread Colour Elements Natural

Comment

/

8. Plaster Mouldings and Medallions

Foyer /

Main Hall /

Living Room /

Dining Room /

Family Room /

Kitchen/Breakfast /

Den/Library /

Lower Landing /

Comment

/

9. Wall Paint

Kingsmen White

Smooth Ceilings

☐ First Floor

☐ First Floor incl. Second Floor Hall

☐ First and Second Floor

☒ Throughout

☐ Not Applicable

Trim Paint Kingsmen White

10. Additional Comments

/

11. Disclaimers and Notes

- Colours of all materials are as close as possible to builder's selection, but not necessarily identical due to variances in manufacturing.
- Any extras listed above are null and void unless accompanied by a separate invoice/amendment. Said invoice must be paid in full.
- The Purchaser acknowledges that after Interior Colour Selection form is signed and dated, no further changes will be permitted other than re-selection due to unavailability. KS Purchaser's Initials
- The Purchaser acknowledges reading and accepting the "Kingsmen Group Décor Centre Disclaimers" form. This document contains other miscellaneous disclaimers.

This Interior Colour Selection is final and approved by:

Purchaser:

Signature: Baldev Singh Gill Date: Feb 08, 2023

Vendor:

KINGSMEN (THAMES) INC.

Feb 15/23

FEB 9 - 2023

SB-LOT 194

all 3 items
@ 66" up from
floor
✓ PH
✓ TV

LOT 194
BLOCK 152
THAMES PH. 5B
SKETCH # 1

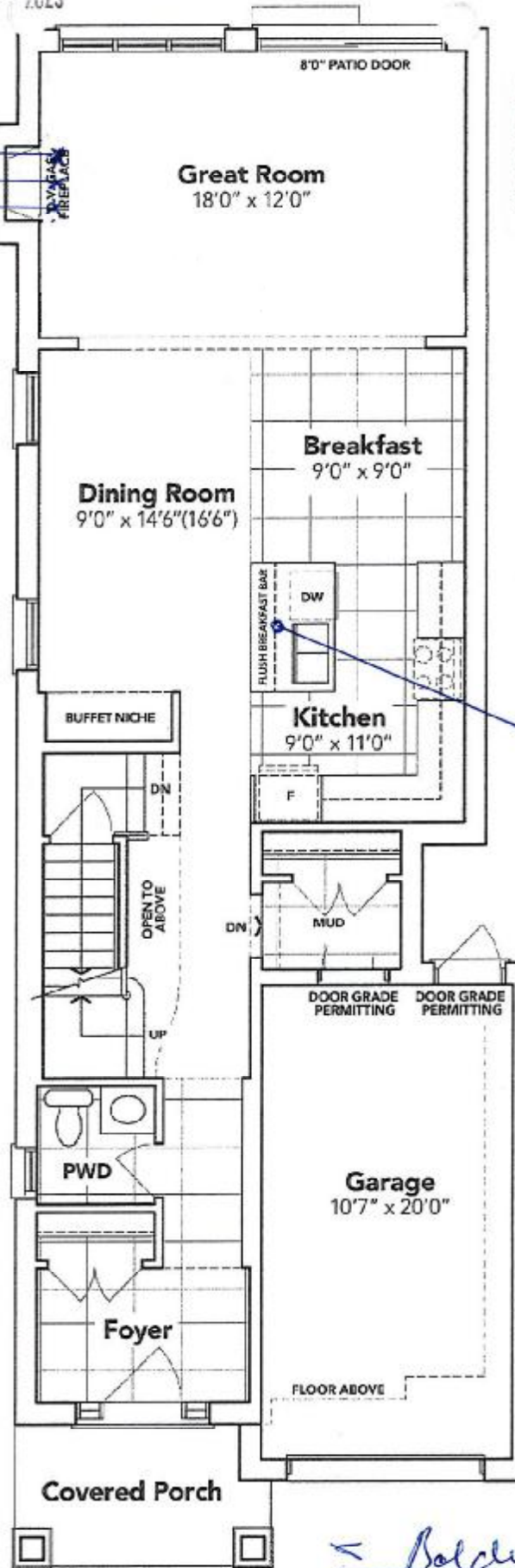

capped elec.
ma sep sink

Bolder Signs

MAIN FLOOR EL. B2A

The floor plans and elevations shown are pre-construction plans and may be revised or improved as necessitated by architectural controls and the construction process. The measurements adhere to the rules and regulations of the TARIION Warranty Corporation's official method for the calculation of floor area. Materials, specifications and floor plans are subject to change without notice. All house renderings are artist's concept only. Actual usable floor space may vary from the stated floor area. All options shown are upgrades. E. & O. E.

FEB 9 - 2023

SB-Lot 194

All 3 items @ 66" up from floor

LOT 194
BLOCK 152
THAMES PH. 5B
SKETCH # 2

Elevated w.r. light

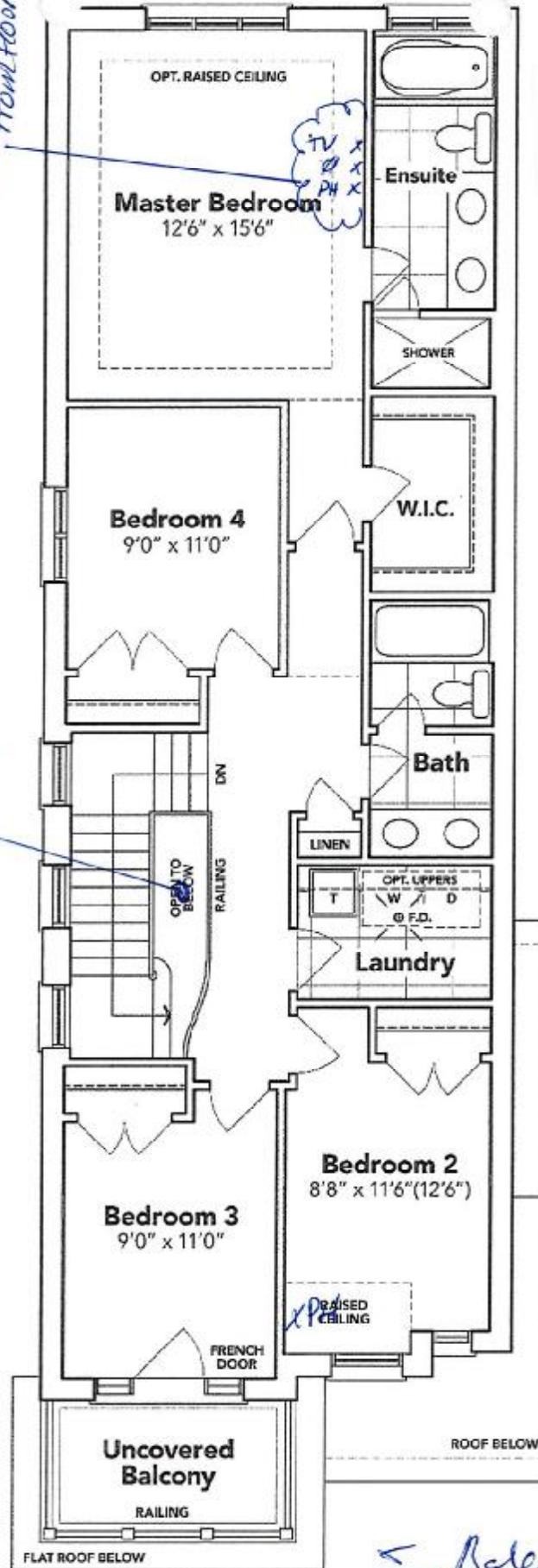

SECOND FLOOR EL. B2A

The floor plans and elevations shown are pre-construction plans and may be revised or improved as necessitated by architectural controls and the construction process. The measurements adhere to the rules and regulations of the TARIION Warranty Corporation's official method for the calculation of floor area. Materials, specifications and floor plans are subject to change without notice. All house renderings are artist's concept only. Actual usable floor space may vary from the stated floor area. All options shown are upgrades. E. & O. E.

RS

LOT 194
BLOCK 152
THAMES PH. 5B
SKETCH # 3

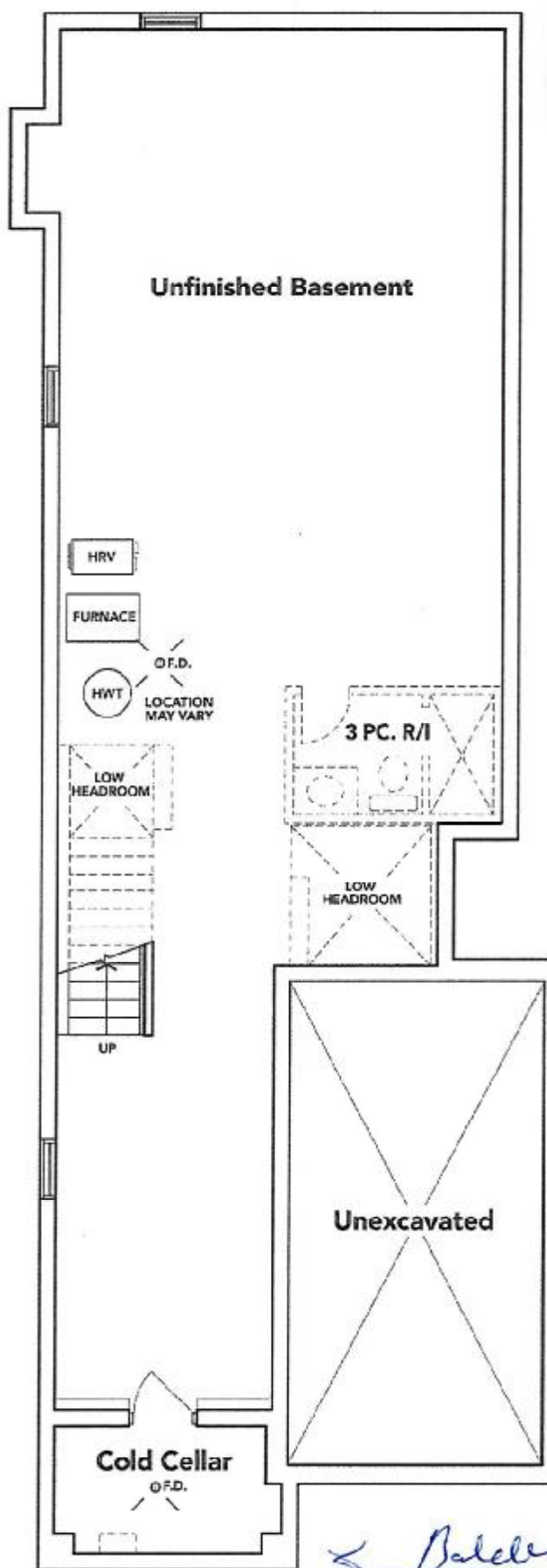

BASEMENT EL. B2A

The floor plans and elevations shown are pre-construction plans and may be revised or improved as necessitated by architectural controls and the construction process. The measurements adhere to the rules and regulations of the TARION Warranty Corporation's official method for the calculation of floor area. Materials, specifications and floor plans are subject to change without notice. All house renderings are artist's concept only. Actual usable floor space may vary from the stated floor area. All options shown are upgrades. E. & O. E.



FEB 9 - 2023

LOT 194 BLOCK 152

THAMES PH. 5B

RE: UPGRADED UNDER MOUNT KITCHEN
SINK

SB-194

BLANCO

Sink Specifications

Colour	SKU
brushed finish	401247

QUATRUS U 2

Design and planning tips

- Min cabinet size: 36 in (915 mm)
- Bowl Depth: 9 in (230.0 mm)

Specifications:

Installation clips, Sink template, Installation instructions, 3
1/2" (90 mm) stainless steel strainers

Depending on cabinet construction, a different cabinet
size may be required. Consult the cabinet manufacturer.

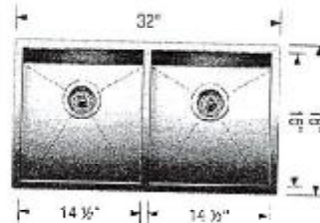

Golden Smith