

KINGSMEN (THAMES) INC. / Havelock Corners (Kingsmen)

Lot/Unit: 178 Block 150 Phase/Building: 5B Model/Floor Plan: William (2603) Elev B2 4
Bed - 2+1 Bath

CABINETRY MICROWAVE OVEN STOVE COOKTOP

Inv.6057	1 - To supply & install a WALL CABINET WITH SHELF FOR MICROWAVE - FINISHED INTERIOR - OPENING 24INCHESW X 13 3 - 4INCHESH X 17INCHESD - in the kitchen... see sketch # 1	
Line 77213	Note: The elec. outlet for this upgrade is sold sep.	
9Feb23 / 14Feb23		

CABINETRY VANITY

Inv.6057	1 - To supply & install the VANITY BANK OF DRAWERS - in the master ensuite bathroom...see sketch # 2	
Line 77215	Note:	
9Feb23 / 14Feb23		

CARPET

Inv.6057	1 - To supply & install the ESCAPE TO MAUI carpet to the 2nd. floor in lieu of the standard carpet...see colour chart for details.	
Line 77217	Note:	
9Feb23 / 14Feb23		

ELECTRICAL

Inv.6057	1 - To SUPPLY AND INSTALL AN ADDITIONAL BASIC RECEPTACLE (DEDICATED CIRCUIT AND INCLUDES ARC FAULT BREAKER) at the upgraded microwave shelf in the kitchen..	
Line 77214	Note: See sketch # 1	
9Feb23 / 14Feb23		
Inv.6057	1 - To supply & install the standard T.V. rough in in the great room and master bedroom... see sketch # 1 & # 2	
Line 77169	Note: Install the standard T.V. rough in at approx. 66" + - up from the floor centered + - to the F/P mantle in the great room.	
9Feb23 / 14Feb23		
Inv.6057	1 - To supply & install the standard Phone (CAT5) rough in in the great room, master bedroom and Bedroom #2 ... see sketch # 1 & # 2	
Line 77170	Note: Install the standard Phone (CAT 5) rough in at approx. 66" + - up from the floor centered + - to the F/P mantle in the great room.	
9Feb23 / 14Feb23		
Inv.6057	1 - To SUPPLY AND INSTALL AN ADDITIONAL BASIC RECEPTACLE (NOT DEDICATED) at approx. 66" + - up from the floor centered + - to the F/P mantle	
Line 77207	Note: in the great room..see sketch # 1	
9Feb23 / 14Feb23 This is for a future wall mount T.V. NO CONDUIT PIPE HAS BEEN PURCHASED.		
Inv.6057	1 - To SUPPLY AND INSTALL EXTRA CEILING BOX ROUGH IN CAPPED (DOES NOT INCLUDE SWITCH) over the island in the kitchen.. see sketch # 1	
Line 77208	Note: This capped elec. will be connected to a sep. switch, switch sold sep.	
9Feb23 / 14Feb23		
Inv.6057	1 - To supply & install AN ADDITIONAL SINGLE POLE SWITCH connected to the upgraded capped elec. over the island in the kitchen.	
Line 77209	Note:	
9Feb23 / 14Feb23		

FIREPLACE

KINGSMEN (THAMES) INC. / Havelock Corners (Kingsmen)

Lot/Unit: 178 Block 150 Phase/Building: 5B Model/Floor Plan: William (2603) Elev B2 4
Bed - 2+1 Bath

Inv.6057	1 - To supply & install a FIREPLACE FAN for the F/P in the great room.	
Line 77216	Note:	
9Feb23 / 14Feb23		

HEATING AND AIR CONDITIONING

Inv.6057	1 - As per schedule "PE": Vendor to install capped gas line (Rough in only) at rear of home for future BBQ location. Location to be finalized at vendors sole discretion.	
Line 77167	Note:	
9Feb23 / 14Feb23		

Inv.6057	1 - As per schedule "PE": Vendor to supply & install air conditioning unit, sized accordingly, from vendors standard samples.	
Line 77168	Note:	
9Feb23 / 14Feb23		

TILE - FLOOR

Inv.6057	1 - To supply & install the UPGRADE 1 - SHOWER FLOOR TILE - - ENSUITE SHOWER FLOOR TILE in lieu of the standard shower floor tile... see colour chart for details.	
Line 77218	Note:	
9Feb23 / 14Feb23		

EXTRAS AS PER OFFER

5 FREE APPLIANCES ? STAINLESS STEEL FRONT - FRIDGE: STOVE AND DISHWASHER. WHITE WASHER AND DRYER (SUPPLIED ONLY, NOT INSTALLED, FROM BUILDERS STANDARD LINE). AN APPLIANCES VOUCHER WILL BE GIVEN BY OUR DECOR CONSULTANT AT THE TIME OF BOOKING YOUR COLOUR A <i>Worksheet</i> Note:	
5 FREE APPLIANCES – STAINLESS STEEL FRONT - FRIDGE: STOVE AND DISHWASHER. WHITE WASHER AND DRYER (SUPPLIED ONLY, NOT INSTALLED, FROM BUILDERS STANDARD LINE). AN APPLIANCES VOUCHER WILL BE GIVEN BY OUR DECOR CONSULTANT AT THE TIME OF BOOKING YOUR COLOUR A <i>Worksheet</i> Note:	
VENDOR TO INSTALL CAPPED GAS LINE (ROUGH-IN ONLY) AT REAR OF HOME FOR FUTURE BBQ LOCATION. LOCATION TO BE FINALIZED AT VENDORS SOLE DISCRETION. <i>Worksheet</i> Note:	
VENDOR TO SUPPLY & INSTALL AIR CONDITIONING UNIT, SIZED ACCORDINGLY, FROM VENDORS STANDARD SAMPLES. <i>Worksheet</i> Note:	

FEB 15 2023

Purchaser: 11182498 CANADA CORP.

Property: 178 Block 150 of Plan - Draft Approval SB

Telephone Res. / Bus: /

Project: KINGSMEN (THAMES) INC.

Decor Advisor: Barbara Coccia

Model and Elevation: William (2603) Elev B2 4 Bed - 2+1 Bath

Layout Changes: ☐ Yes ☒ No

Sketch Attached: ☒ Yes ☐ No

Exterior Colour Scheme:

1. Cabinetry

	Style and Colour	Counter Top	Hardware
Kitchen / Breakfast	#2, Huron Ontario White	#1, C/S # 9141 Ice Snow 3cm.	# 12881 Handle
Kitchen Island	#2, Huron Ontario White	#1, C/S # 9141 Ice Snow 3cm.	# 12881 Handle
Laundry Room	/		
Powder Room	#2, Huron Ontario White	#6698-46 Paloma Polar	# 12881 Handle
Main Bathroom	#2, Huron Ontario White	#6698-46 Paloma Polar	# 12881 Handle
Master Ensuite Bathroom	#2, Huron Ontario White	#6698-46 Paloma Polar	# 12881 Handle
Second Ensuite Bathroom (If Applicable)	/		
	/		
	/		

Appliances

Custom Size Fridge

☐ Yes ☒ No

Valance Lighting

☐ Yes ☒ No

Microwave / Range Hood

☐ Yes ☒ No

Cooktop / Rangetop

☐ Yes ☒ No

Built in Wall Oven

☐ Yes ☒ No

Slide-in Range

☐ Yes ☒ No

Comment

/

2. Flooring

	Selection
Foyer	13 x 13" Keaton Ice
Main Hall	3 1/2" Elements Oak Natural
Back Hall	/
Breakfast	13 x 13" Keaton Ice
Laundry Room	13 x 13" Keaton Ice
Kitchen	13 x 13" Keaton Ice
Powder Room	(& small hallway in front of the hallway) 13 x 13" Keaton Ice
Main Bathroom	13 x 13" Keaton Ice
Master Ensuite	13 x 13" Keaton Ice
Bathroom (If Applicable)	
Mud Room	13 x 13" Keaton Ice
Master ens. shower floor:	**2x2" Ontario Tender Grey Matte
Living Room	/
Dining Room	3 1/2" Elements Oak Natural
Family / Great Room	3 1/2" Elements Oak Natural
Den / Library / Study	/
Basement Landing (If Applies)	
Lower Landing (If Applicable)	3 1/2" Elements Oak Natural
Upper Landing	(if applicable) 3 1/2" Elements Oak Natural
Upper Hall	** Escape to Maui # 14722 Macrame
Master Bedroom	** Escape to Maui # 14722 Macrame
Bedroom #2	** Escape to Maui # 14722 Macrame
Bedroom #3	** Escape to Maui # 14722 Macrame
Bedroom #4	** Escape to Maui # 14722 Macrame
Bedroom #5	/
Master ens. shower jamb:	Anatolia Marmiline SNOW

Flooring Continued on Page 2

Initial:

Page 1 of 3

Purchaser: 11182498 CANADA CORP.

FEB 15 2023

Property: 178 Block 150 of Plan - Draft Approval SB

Telephone Res. / Bus: /

Project: KINGSMEN (THAMES) INC.

Decor Advisor: Barbara Coccia

Model and Elevation: William (2603) Elev B2 4 Bed - 2+1 Bath

2. Flooring - Continued -

Upgrade Underpad	Type	Area
	Standard	2nd. Floor
Carpet on Stairs	Capped	Runner - *Upgrade
Comment	/	/

3. Plumbing Fixtures / Faucets

Kitchen	Standard	Second Ensuite	/	Powder Room	Standard
Master Ensuite	Standard			Other Room	/
Main Bathroom	Standard		/		

Comment

Still to install the standard top mount kitchen sink.

4. Wall Tile

	Tile Selection	Listello	Insert	Insert Selection
Main Bathroom	8x10" Keaton Ice	<input type="checkbox"/>	<input type="checkbox"/>	
Master Ensuite				
Tub Deck	13 x 13" Keaton Ice	<input type="checkbox"/>	<input type="checkbox"/>	
Tub Apron	13 x 13" Keaton Ice	<input type="checkbox"/>	<input type="checkbox"/>	
Tub Surround	13 x 13" Keaton Ice	<input type="checkbox"/>	<input type="checkbox"/>	
Shower Stall	8x10" Keaton Ice	<input type="checkbox"/>	<input type="checkbox"/>	
Second Ensuite	/	<input type="checkbox"/>	<input type="checkbox"/>	
	/	<input type="checkbox"/>	<input type="checkbox"/>	
	/	<input type="checkbox"/>	<input type="checkbox"/>	
Kitchen Backsplash	/	<input type="checkbox"/>	<input type="checkbox"/>	
Complete Backsplash	/	<input type="checkbox"/>	<input type="checkbox"/>	

Comment

Install the standard 8x10" wall tiles on the 10" side stacked horizontally in the bathrooms where applicable.



horizontal stacked

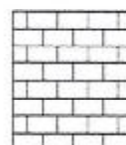

brick pattern



vertical stacked



diagonal/diamond

5. Fireplace

Living Room

Purchased ☐ As Per Plan ☐ N/A ☒

Family Room

Purchased ☐ As Per Plan ☐ N/A ☒

Other Room - Specify Great Room

Purchased ☐ As Per Plan ☒ N/A ☐

Fireplace Type

Mantle Type

Over Mantle

Colour / Stain

Surround

Hearth

Comment

/

Front Facing

NF-08

/

White

/

/

Initial:

DL

Page 2 of 3

FEB 15 2023

Purchaser: 11182498 CANADA CORP.

Property: 178 Block 150 of Plan - Draft Approval SB

Telephone Res. / Bus: /

Project: KINGSMEN (THAMES) INC.

Decor Advisor: Barbara Coccia

Model and Elevation: William (2603) Elev B2 4 Bed - 2+1 Bath

6. Trim Carpentry

Door Hardware Standard Handle

Interior Trim Standard

Comment

/

Interior Doors

☐ 2 Panel Arch Top

☒ 2 Panel Square Top

☐ 6 Panel

Initial for Door Style

OK

7. Railings and Pickets

Railing Package Standard oak STRAIGHT picket package

Railing Colour Elements Natural

Picket Colour Elements Natural

Wood Stairs ☐ No ☒ Oak

Tread Colour Elements Natural

Comment

/

8. Plaster Mouldings and Medallions

Foyer /

Main Hall /

Living Room /

Dining Room /

Family Room /

Kitchen/Breakfast /

Den/Library /

Lower Landing /

Comment

/

9. Wall Paint

Kingsmen White

Smooth Ceilings ☐ First Floor

☐ First Floor incl. Second Floor Hall

☐ First and Second Floor

☒ Throughout

☐ Not Applicable

Trim Paint Kingsmen White

10. Additional Comments

/

11. Disclaimers and Notes

- Colours of all materials are as close as possible to builder's selection, but not necessarily identical due to variances in manufacturing.
- Any extras listed above are null and void unless accompanied by a separate invoice/amendment. Said invoice must be paid in full.
- The Purchaser acknowledges that after Interior Colour Selection form is signed and dated, no further changes will be permitted other than re-selection due to unavailability.  Purchaser's Initials
- The Purchaser acknowledges reading and accepting the "Kingsmen Group Décor Centre Disclaimers" form. This document contains other miscellaneous disclaimers.

This Interior Colour Selection is final and approved by:

Purchaser:

Signature:  Date: 02/14/23

Vendor:



KINGSMEN (THAMES) INC.

Feb 15/23

Sketch #1.

all 3 items @
66"t up
from the
floor

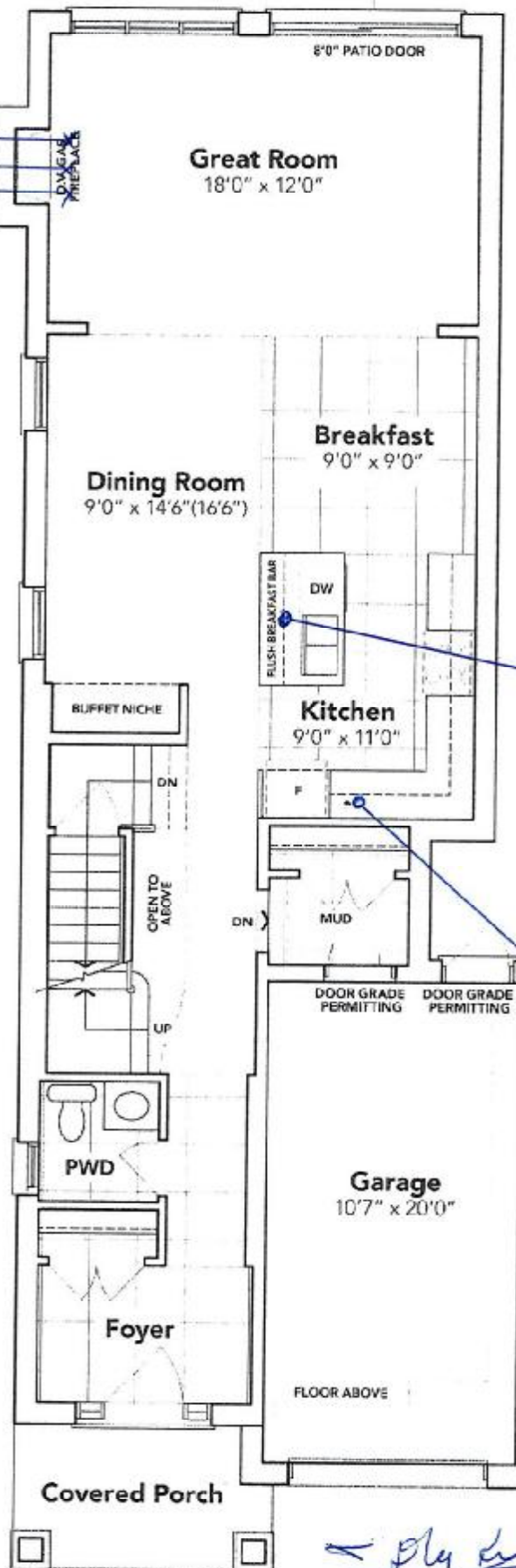

MAIN FLOOR EL. B2A

The floor plans and elevations shown are pre-construction plans and may be revised or improved as necessitated by architectural controls and the construction process. The measurements adhere to the rules and regulations of the TARION Warranty Corporation's official method for the calculation of floor area. Materials, specifications and floor plans are subject to change without notice. All house renderings are artist's concept only. Actual usable floor space may vary from the stated floor area. All options shown are upgrades. E. & O. E.

SCHEDULE "B-1"
Floor Plan

FEB 15 2023

5B-178
Townhouse No. 178 Block 150
Phase 5B
Model: William (2603) Elev B2 4 Bed - 2+1 Bath
End - Standard

Sketch #2

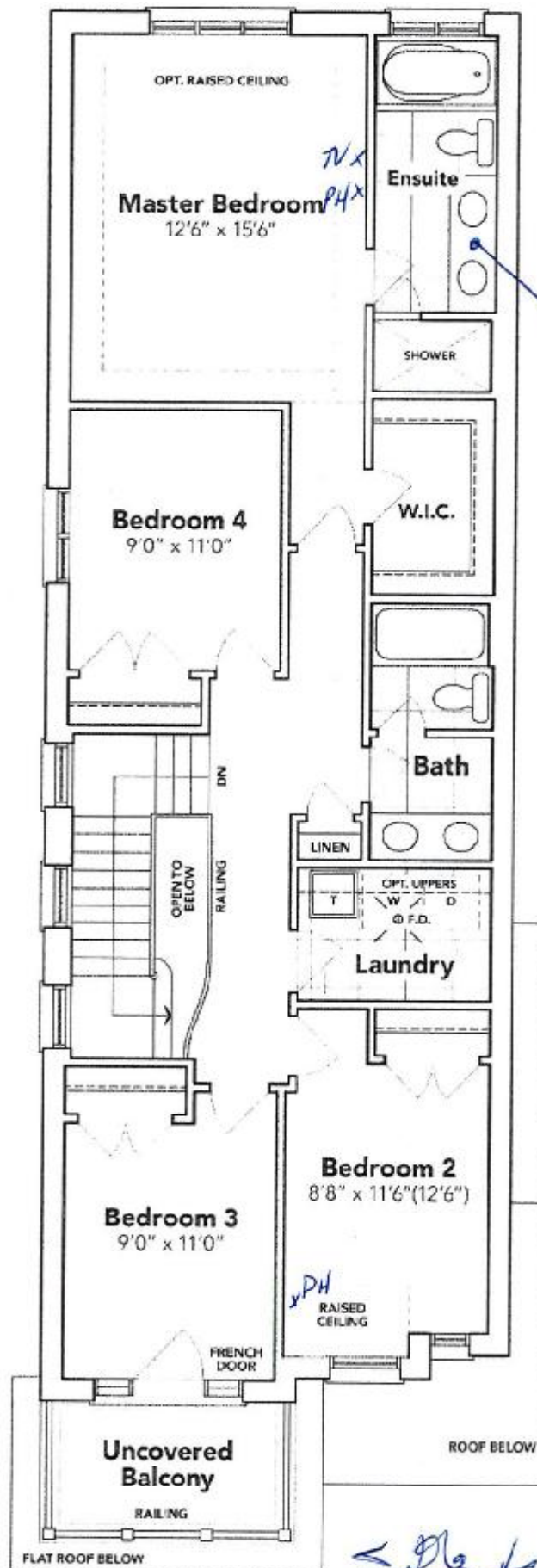

SECOND FLOOR EL. B2A

The floor plans and elevations shown are pre-construction plans and may be revised or improved as necessitated by architectural controls and the construction process. The measurements adhere to the rules and regulations of the TARION Warranty Corporation's official method for the calculation of floor area. Materials, specifications and floor plans are subject to change without notice. All house renderings are artist's concept only. Actual usable floor space may vary from the stated floor area. All options shown are upgrades. E. & O. E.

MS

SCHEDULE "B-1"
Floor Plan

FEB 15 2023

5B-178
Townhouse No. 178 Block 150
Phase 5B
Model: William (2603) Elev B2 4 Bed - 2+1 Bath
End - Standard

Sketch #3

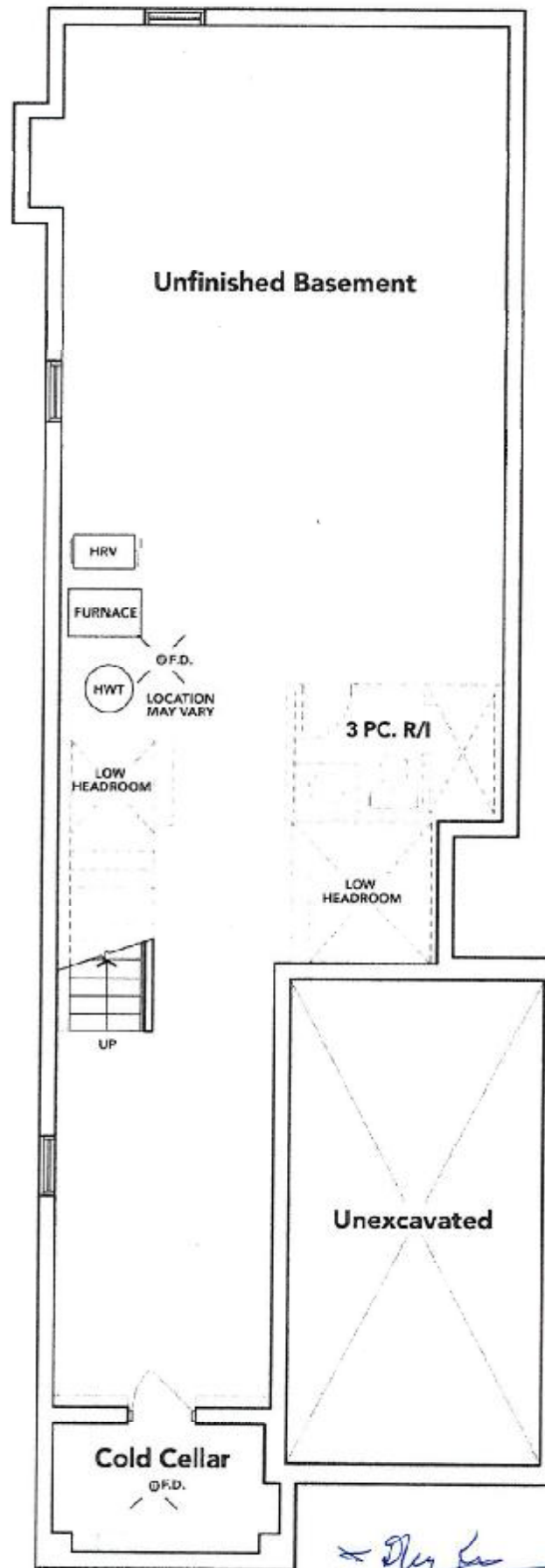

BASEMENT EL. B2A

The floor plans and elevations shown are pre-construction plans and may be revised or improved as necessitated by architectural controls and the construction process. The measurements adhere to the rules and regulations of the TARION Warranty Corporation's official method for the calculation of floor area. Materials, specifications and floor plans are subject to change without notice. All house renderings are artist's concept only. Actual usable floor space may vary from the stated floor area. All options shown are upgrades. E. & O. E.