

KINGSMEN (THAMES) INC. / Havelock Corners (Kingsmen)

Lot/Unit: 189 Block 152 Phase/Building: 5B Model/Floor Plan: William (2603) Elev B2 4
Bed - 2+1 Bath

ELECTRICAL

Inv.6048	1 - To supply & install the standard T.V. rough in in the great room and master bedroom... see sketch # 1 & # 2	
Line 77104	Note: Install the standard T.V. rough in at approx. 66" + - up from the floor centered + - to the F/P mantle in the great room.	
2Feb23 / 6Feb23		
Inv.6048	1 - To supply & install the standard Phone (CAT5) rough in in the great room, master bedroom and Bedroom 3 ... see sketch # 1 & # 2	
Line 77105	Note: Install the standard Phone (CAT 5) rough in at approx. 66" + - up from the floor centered + - to the F/P mantle in the great room.	
2Feb23 / 6Feb23		
Inv.6048	1 - To SUPPLY AND INSTALL AN ADDITIONAL BASIC RECEPTACLE (NOT DEDICATED) at approx. 66" + - up from the floor centered + - to the F/P mantle	
Line 77132	Note: in the great room... see sketch # 1	
2Feb23 / 6Feb23		
This is for a future wall mount T.V. NO CONDUIT PIPE HAS BEEN PURCHASED.		
Inv.6048	1 - To SUPPLY AND INSTALL EXTRA CEILING BOX ROUGH IN CAPPED (DOES NOT INCLUDE SWITCH) over the island in the kitchen... see sketch # 1	
Line 77133	Note: This capped elec. will be connected to a sep. switch switch sold sep.	
2Feb23 / 6Feb23		
Inv.6048	1 - To supply & install AN ADDITIONAL SINGLE POLE SWITCH connected to the upgraded capped elec. over the island in the kitchen.	
Line 77134	Note:	
2Feb23 / 6Feb23		
Inv.6048	1 - Relocate the standard ceiling light from the upper stair landing to the O.T.B. area on the second floor... see sketch # 2	
Line 77135	Note:	
2Feb23 / 6Feb23		

HEATING AND AIR CONDITIONING

Inv.6048	1 - As per schedule "PE": Vendor to install capped gas line (Rough in only) at rear of home for future BBQ location. Location to be finalized at vendors sole discretion.	
Line 77102	Note:	
2Feb23 / 6Feb23		
Inv.6048	1 - As per schedule "PE": Vendor to supply & install air conditioning unit, sized accordingly, from vendors standard samples.	
Line 77103	Note:	
2Feb23 / 6Feb23		



CONSTRUCTION SUMMARY

KINGSMEN (THAMES) INC. / Havelock Corners (Kingsmen)

Lot/Unit: 189 Block 152 Phase/Building: 5B Model/Floor Plan: William (2603) Elev B2 4
Bed - 2+1 Bath

EXTRAS AS PER OFFER

5 FREE APPLIANCES – STAINLESS STEEL FRONT - FRIDGE; STOVE AND DISHWASHER. WHITE WASHER AND DRYER (SUPPLIED ONLY, NOT INSTALLED, FROM BUILDERS STANDARD LINE). AN APPLIANCES VOUCHER WILL BE GIVEN BY OUR DECOR CONSULTANT AT THE TIME OF BOOKING YOUR COLOUR A <i>Worksheet</i> Note:	
VENDOR TO INSTALL CAPPED GAS LINE (ROUGH-IN ONLY) AT REAR OF HOME FOR FUTURE BBQ LOCATION. LOCATION TO BE FINALIZED AT VENDORS SOLE DISCRETION. <i>Worksheet</i> Note:	
VENDOR TO SUPPLY & INSTALL AIR CONDITIONING UNIT, SIZED ACCORDINGLY, FROM VENDORS STANDARD SAMPLES. <i>Worksheet</i> Note:	

FEB 6 - 2023

5B-189

Purchaser: ISHIKAALISHA K MROKE

Property: 189 Block 152 of Plan - Draft Approval SB

Telephone Res. / Bus: /

Project: KINGSMEN (THAMES) INC.

Decor Advisor: Barbara Coccia

Model and Elevation: William (2603) Elev B2 4 Bed - 2+1 Bath

Layout Changes: ☐ Yes ☒ NoSketch Attached: ☒ Yes ☐ No

Exterior Colour Scheme:

1. Cabinetry

	Style and Colour	Counter Top	Hardware
Kitchen / Breakfast	#3 Simcoe Navy Blue	#1, C/S # 9141 Ice Snow 3cm.	# 12881 Handle
Kitchen Island	#3 Simcoe Navy Blue	#1, C/S # 9141 Ice Snow 3cm.	# 12881 Handle
Laundry Room	/		
Powder Room	#3 Simcoe Navy Blue	# 6698-46 Paloma Polar	# 12881 Handle
Main Bathroom	#3 Simcoe Navy Blue	# 6698-46 Paloma Polar	# 12881 Handle
Master Ensuite Bathroom	#3 Simcoe Navy Blue	# 6698-46 Paloma Polar	# 12881 Handle
Second Ensuite Bathroom (If Applicable)	/		
	/		
	/		

Appliances

Custom Size Fridge

☐ Yes ☒ No

Valance Lighting

☐ Yes ☒ No

Microwave / Range Hood

☐ Yes ☒ No

Cooktop / Rangetop

☐ Yes ☒ No

Built in Wall Oven

☐ Yes ☒ No

Slide-in Range

☐ Yes ☒ No

Comment

/

2. Flooring

Selection

Foyer	13 x 13" Keaton Ice
Main Hall	3 1/2" Elements Oak Natural
Back Hall	/
Breakfast	13 x 13" Keaton Ice
Laundry Room	13 x 13" Keaton Ice
Kitchen	13 x 13" Keaton Ice
Powder Room	(& small hallway in front of powder room) 13 x 13" Keaton Ice
Main Bathroom	13 x 13" Keaton Ice
Master Ensuite	13 x 13" Keaton Ice
Bathroom (If Applicable)	/
Mud Room	13 x 13" Keaton Ice
Master ens. shower floor:	2x2" Ontario Snow White Matte
Living Room	/
Dining Room	3 1/2" Elements Oak Natural
Family / Great Room	3 1/2" Elements Oak Natural
Den / Library / Study	/
Basement Landing (If Applies)	
Lower Landing (If Applicable)	3 1/2" Elements Oak Natural
Upper Landing	(If applicable) 3 1/2" Elements Oak Natural
Upper Hall	Modern Story 1, # 809 Gondola
Master Bedroom	Modern Story 1, # 809 Gondola
Bedroom #2	Modern Story 1, # 809 Gondola
Bedroom #3	Modern Story 1, # 809 Gondola
Bedroom #4	Modern Story 1, # 809 Gondola
Bedroom #5	/
Master ens. shower Jamb :	Anatolia Marmiline SNOW

Flooring Continued on Page 2

Initial: _____

Page 1 of 3

FEB 6 - 2023

SB-189

Purchaser: ISHIKAALISHA K MROKE

Property: 189 Block 152 of Plan - Draft Approval SB

Telephone Res. / Bus: /

Project: KINGSMEN (THAMES) INC.

Decor Advisor: Barbara Coccia

Model and Elevation: William (2603) Elev B2 4 Bed - 2+1 Bath

2. Flooring - Continued -

Upgrade Underpad	Type	Area
	Standard	2nd. Floor
Carpet on Stairs	Capped	Runner - *Upgrade
Comment	/	/

3. Plumbing Fixtures / Faucets

Kitchen	Standard	Second Ensuite	/	Powder Room	Standard
Master Ensuite	Standard			Other Room	/
Main Bathroom	Standard				

Comment

Still to install the standard top mount kitchen sink.

4. Wall Tile

	Tile Selection	Listello	Insert	Insert Selection
Main Bathroom	8x10 " Keaton Ice	<input type="checkbox"/>	<input type="checkbox"/>	
Master Ensuite				
Tub Deck	13 x 13" Keaton Ice	<input type="checkbox"/>	<input type="checkbox"/>	
Tub Apron	13 x 13" Keaton Ice	<input type="checkbox"/>	<input type="checkbox"/>	
Tub Surround	13 x 13" Keaton Ice	<input type="checkbox"/>	<input type="checkbox"/>	
Shower Stall	8x10 " Keaton Ice	<input type="checkbox"/>	<input type="checkbox"/>	
Second Ensuite	/	<input type="checkbox"/>	<input type="checkbox"/>	
	/	<input type="checkbox"/>	<input type="checkbox"/>	
	/	<input type="checkbox"/>	<input type="checkbox"/>	
Kitchen Backsplash	/	<input type="checkbox"/>	<input type="checkbox"/>	
Complete Backsplash	/	<input type="checkbox"/>	<input type="checkbox"/>	
Comment	/			



horizontal stacked

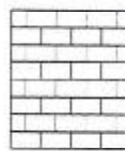

brick pattern



vertical stacked



diagonal/diamond

5. Fireplace

	Living Room			Family Room			Other Room - Specify Great Room		
	Purchased	As Per Plan	N/A	Purchased	As Per Plan	N/A	Purchased	As Per Plan	N/A
Fireplace Type	<input type="radio"/>	<input type="radio"/>	<input checked="" type="radio"/>	<input type="radio"/>	<input type="radio"/>	<input checked="" type="radio"/>	<input type="radio"/>	<input checked="" type="radio"/>	<input type="radio"/>
Mantle Type							Front Facing		
Over Mantle							NF-06		
Colour / Stain							/		
Surround							White		
Hearth							/		
Comment							/		

Initial:

Page 2 of 3

Purchaser: ISHIKAALISHA K MROKE

Property: 189 Block 152 of Plan - Draft Approval SB

Telephone Res. / Bus: /

Project: KINGSMEN (THAMES) INC.

Decor Advisor: Barbara Coccia

Model and Elevation: William (2603) Elev B2 4 Bed - 2+1 Bath

6. Trim Carpentry

Door Hardware Standard Handle

Interior Trim Standard

Comment

/

Interior Doors

☐ 2 Panel Arch Top

☒ 2 Panel Square Top

☐ 6 Panel

Initial for Door Style

7. Railings and Pickets

Railing Package Standard oak STRAIGHT picket package

Railing Colour Elements Natural

Picket Colour Elements Natural

Wood Stairs ☐ No ☒ Oak

Tread Colour Elements Natural

Comment

/

8. Plaster Mouldings and Medallions

Foyer /

Main Hall /

Living Room /

Dining Room /

Family Room /

Kitchen/Breakfast /

Den/Library /

Lower Landing /

Comment

/

9. Wall Paint

Kingsmen White

Smooth Ceilings

☐ First Floor

☐ First Floor incl. Second Floor Hall

☐ First and Second Floor

☒ Throughout

☐ Not Applicable

Trim Paint Kingsmen White

10. Additional Comments

/

11. Disclaimers and Notes

- Colours of all materials are as close as possible to builder's selection, but not necessarily identical due to variances in manufacturing.
- Any extras listed above are null and void unless accompanied by a separate invoice/amendment. Said invoice must be paid in full.
- The Purchaser acknowledges that after Interior Colour Selection form is signed and dated, no further changes will be permitted other than re-selection due to unavailability.  Purchaser's Initials
- The Purchaser acknowledges reading and accepting the "Kingsmen Group Décor Centre Disclaimers" form. This document contains other miscellaneous disclaimers.

This Interior Colour Selection is final and approved by:

Purchaser:

Signature:  Date: 06/02/2023

Vendor:



KINGSMEN (THAMES) INC.

FEB 6 - 2023

5B-LOT 189

All 3 items
66" up
from floor

✓ TV
✓ PH

LOT 189
BLOCK 152
THAMES PH. 5B
SKETCH # 1

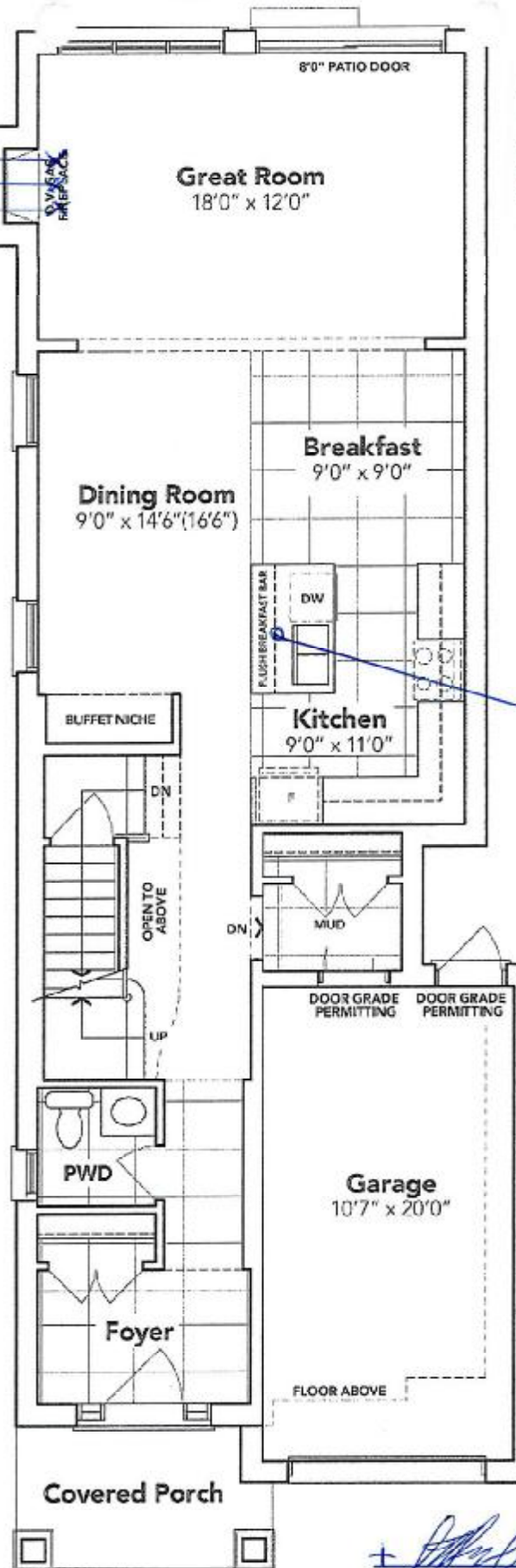

MAIN FLOOR EL. B2A

The floor plans and elevations shown are pre-construction plans and may be revised or improved as necessitated by architectural controls and the construction process. The measurements adhere to the rules and regulations of the TARIION Warranty Corporation's official method for the calculation of floor area. Materials, specifications and floor plans are subject to change without notice. All house renderings are artist's concept only. Actual usable floor space may vary from the stated floor area. All options shown are upgrades. E. & O. E.

FEB 6 - 2023

5B-LOFT 189

**LOT 189
BLOCK 152
THAMES PH. 5B
SKETCH # 2**

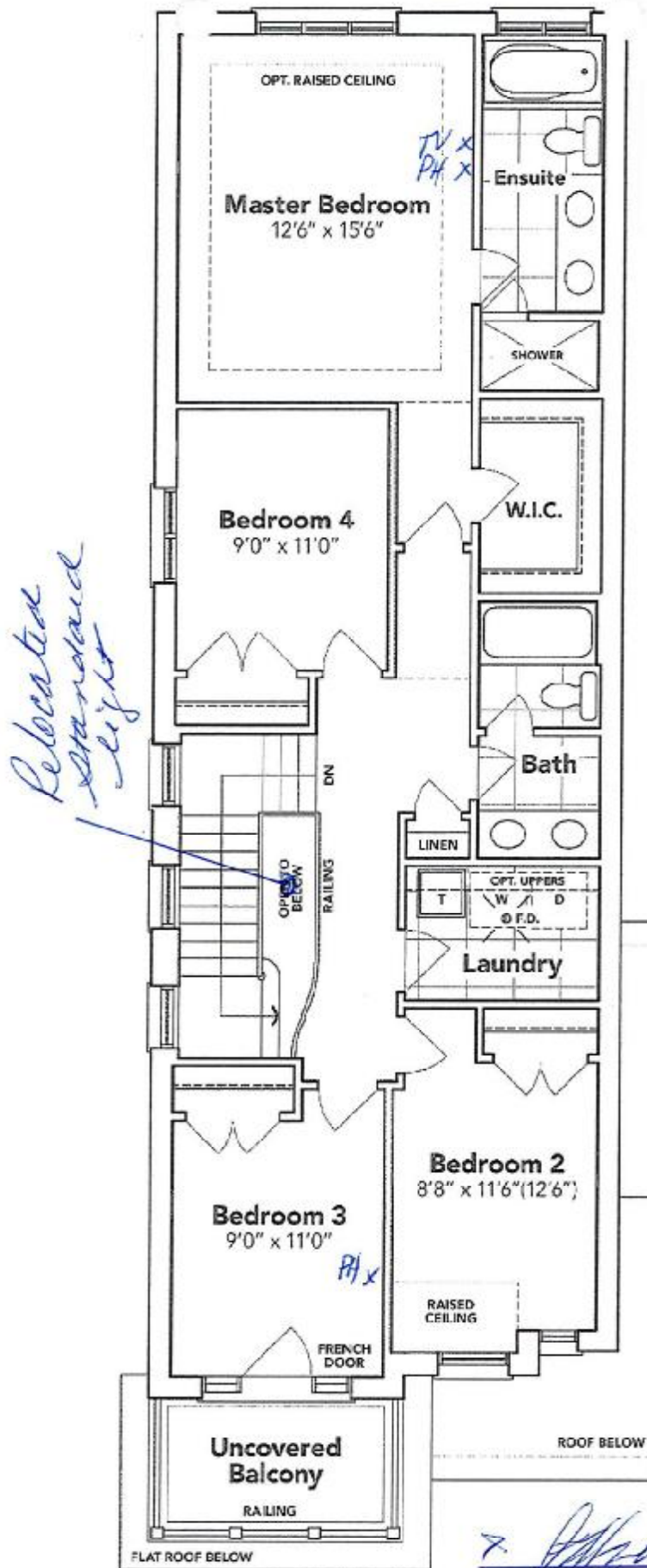

SECOND FLOOR EL. B2A

The floor plans and elevations shown are pre-construction plans and may be revised or improved as necessitated by architectural controls and the construction process. The measurements adhere to the rules and regulations of the TARION Warranty Corporation's official method for the calculation of floor area. Materials, specifications and floor plans are subject to change without notice. All house renderings are artist's concept only. Actual usable floor space may vary from the stated floor area. All options shown are upgrades. E. & O. E.

LOT 189
BLOCK 152
THAMES PH. 5B
SKETCH # 3

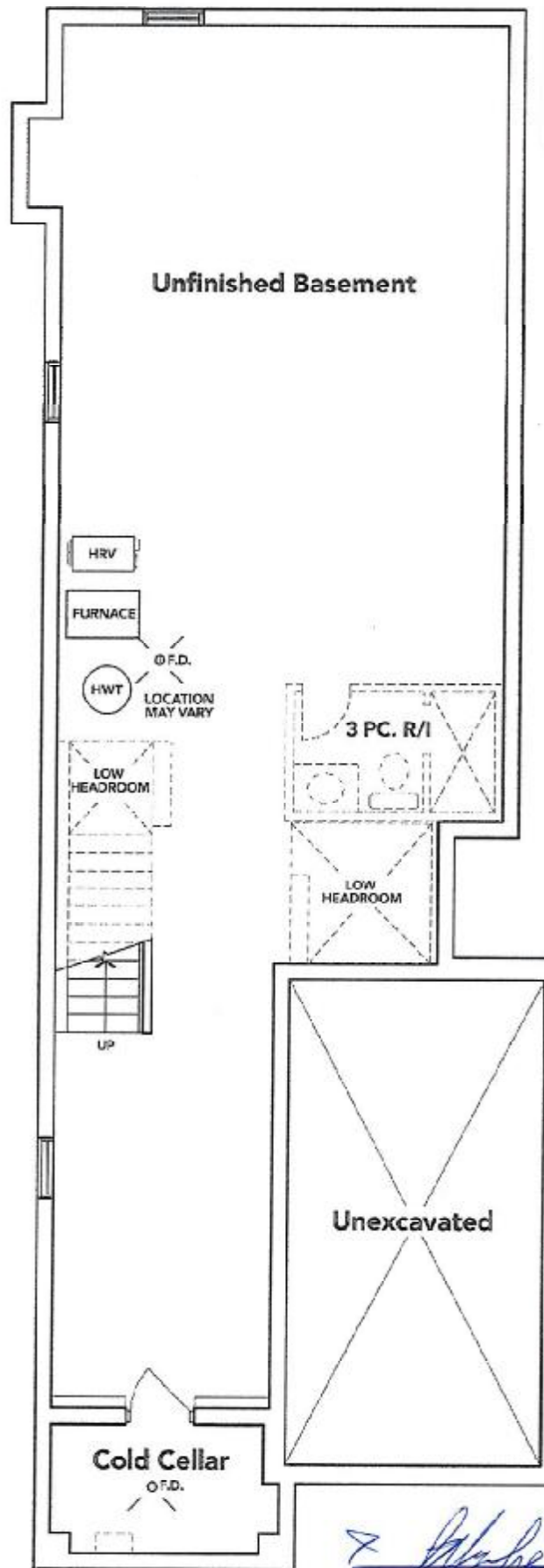

BASEMENT EL. B2A

The floor plans and elevations shown are pre-construction plans and may be revised or improved as necessitated by architectural controls and the construction process. The measurements adhere to the rules and regulations of the TARION Warranty Corporation's official method for the calculation of floor area. Materials, specifications and floor plans are subject to change without notice. All house renderings are artist's concept only. Actual usable floor space may vary from the stated floor area. All options shown are upgrades. E. & O. E.