

KINGSMEN (THAMES) INC. / Havelock Corners (Kingsmen)

Lot/Unit: 158 Phase/Building: 5A Model/Floor Plan: Andrew (3603) Elev C 4 Bed - 2+1 Bath

CARPET

Inv.5978	1 - To supply & install the ESCAPE TO MAUI carpet to the 2nd floor area in lieu of the standard carpet... see colour chart for details.	
Line 76551	Note:	
11Nov22 / 11Nov22		

COUNTER TOP

Inv.5978	1 - As per schedule "PE": Vendor to include level 1, 2cm. quartz in all bathrooms, as per plan, in lieu of the included laminated counter tops. Selections to be made from builders standard samples.	
Line 76543	Note:	
11Nov22 / 11Nov22		

ELECTRICAL

Inv.5978	1 - To supply & install the standard T.V. rough in in the great room and master bedroom...see sketch # 1 & # 2	
Line 76544	Note:	
11Nov22 / 11Nov22		
Inv.5978	1 - To supply & install the standard Phone (CAT 5) rough in in the great room, master bedroom & Bedroom # 4 ...see sketch # 1 & # 2	
Line 76545	Note:	
11Nov22 / 11Nov22		
Inv.5978	1 - To SUPPLY AND INSTALL CONDUIT FOR TV OVER THE FIREPLACE at approx. 66" + - up from the floor centered +- to the F/P mantle and terminated + - next to the standard T.V. and Phone (CAT 5) rough in in the great room...see sketch # 1	
Line 76546	Note: This is for a futue wall mount T.V.	
11Nov22 / 11Nov22		
Inv.5978	1 - To SUPPLY AND INSTALL AN ADDITIONAL BASIC RECEPTACLE (NOT DEDICATED) at approx. 66" + - up from the floor centered + - to the F/P mantle	
Line 76547	Note: in the great room... see sketch # 1	
11Nov22 / 11Nov22 This is for a futue wall mount T.V.		

HARDWOOD

Inv.5978	1 - To supply & install the 3 1/2" Elements stained engineered hardwood in lieu of the standard 3 1/2" Elements Natural hardwood to the main floor area and stair landings where applicable.. see colour chart for details.	
Line 76548	Note:	
11Nov22 / 11Nov22		

HEATING AND AIR CONDITIONING

Inv.5978	1 - As per schedule "PE": Vendor to install capped gas line (rough in only) at rear of home for future BBQ location. Location to be finalized at vendors sole discretion.	
Line 76541	Note:	
11Nov22 / 11Nov22		
Inv.5978	1 - As per schedule "PE": Vendor to supply & install air conditioning unit, sized accordingly, from vendors standard samples.	
Line 76542	Note:	
11Nov22 / 11Nov22		

KINGSMEN (THAMES) INC. / Havelock Corners (Kingsmen)

Lot/Unit: 158 Phase/Building: 5A Model/Floor Plan: Andrew (3603) Elev C 4 Bed - 2+1 Bath

PAINT AND DRYWALL

Inv. 5978	1 - To supply & install the PAINT EXTRAS - STAIN RAILINGS WITH IRON PICKETS (INCLUDING STAIRS) where applicable, see colour chart for details.	
Line 76550	Note:	
11Nov22 / 11Nov22		

RAILING

Inv. 5978	1 - To supply & install the RAILING - UPGRADE 1 - METAL HANDRAIL 3 INCH OVAL IN OAK - PICKETS STEEL ½ INCH SQUARE, PLAIN, WITH SHOES IN FLAT BLACK - POSTS 3½ INCH SQUARE, WITH CAP OAK IN OAK in lieu of the standard pickets and rails.	
Line 76549	Note:	
11Nov22 / 11Nov22		

EXTRAS AS PER OFFER

5 FREE APPLIANCES – STAINLESS STEEL FRONT - FRIDGE: STOVE AND DISHWASHER. WHITE WASHER AND DRYER (SUPPLIED ONLY, NOT INSTALLED, FROM BUILDERS STANDARD LINE). AN APPLIANCES VOUCHER WILL BE GIVEN BY OUR DECOR CONSULTANT AT THE TIME OF BOOKING YOUR COLOUR A <i>Worksheet</i> Note:	
VENDOR TO INSTALL CAPPED GAS LINE (ROUGH-IN ONLY) AT REAR OF HOME FOR FUTURE BBQ LOCATION. LOCATION TO BE FINALIZED AT VENDORS SOLE DISCRETION. <i>Worksheet</i> Note:	
VENDOR TO SUPPLY & INSTALL AIR CONDITIONING UNIT, SIZED ACCORDINGLY, FROM VENDORS STANDARD SAMPLES. <i>Worksheet</i> Note:	
VENDOR TO INCLUDE LEVEL 1, 2CM QUARTZ IN ALL BATHROOMS, AS PER PLAN, IN LIEU OF THE INCLUDED LAMINATE COUNTER TOPS. SELECTIONS TO BE MADE FROM BUILDERS STANDARD SAMPLES. <i>Worksheet</i> Note:	

Purchasers:AMIT SINGHAL & SONIYA SINGHAL

Property: 158 of Plan - Draft Approval SB17-03-08

Telephone Res. / Bus: /

Project: KINGSMEN (THAMES) INC.

Decor Advisor: Barbara Coccia

Model and Elevation: Andrew (3603) Elev C 4 Bed - 2+1 Bath

Layout Changes: ☐ Yes ☒ No

Sketch Attached: ☒ Yes ☐ No

Exterior Colour Scheme:

1. Cabinetry	Style and Colour	Counter Top	Hardware
Kitchen / Breakfast	#3 Charleston 3DL Orchid	#1, C/S # 3040 Cement 3cm.	#12881 Handle
Kitchen Island	#3 Charleston 3DL Orchid	#1, C/S # 3040 Cement 3cm.	#12881 Handle
Laundry Room	/		
Powder Room	#3 Charleston 3DL Orchid	#1, C/S # 3040 Cement 2cm.	#12881 Handle
Main Bathroom	#3 Charleston 3DL Orchid	#1, C/S # 3040 Cement 2cm.	#12881 Handle
Master Ensuite Bathroom	#3 Charleston 3DL Orchid	#1, C/S # 3040 Cement 2cm.	#12881 Handle
Second Ensuite Bathroom (If Applicable)	/		
	/		
	/		

Appliances

Custom Size Fridge
☐ Yes ☒ No

Cooktop / Rangetop
☐ Yes ☒ No

Valance Lighting
☐ Yes ☒ No

Built in Wall Oven
☐ Yes ☒ No

Microwave / Range Hood
☐ Yes ☒ No

Slide-in Range
☐ Yes ☒ No

Comment

/

2. Flooring	Selection
Foyer	13 x 13" Malena Ice
Main Hall	13 x 13" Malena Ice
Back Hall	/
Breakfast	/
Laundry Room	13 x 13" Malena Ice
Kitchen	13 x 13" Malena Ice
Powder Room	13 x 13" Malena Ice
Main Bathroom	13 x 13" Malena Ice
Master Ensuite	13 x 13" Malena Carbon
Bathroom (If Applicable)	/
Mud Room	13 x 13" Malena Ice
Master ens. shower floor:	2x2" Ontario Snow White Matte
Living Room	/
Dining Room	(Dinette) **3 1/2" Elements Oak Wolfhound
Family / Great Room	**3 1/2" Elements Oak Wolfhound
Den / Library / Study	/
Basement Landing (If Applies)	
Lower Landing (If Applicable)	**3 1/2" Elements Oak Wolfhound
Upper Landing	**3 1/2" Elements Oak Wolfhound
Upper Hall	** Escape to Maui # 89816 Pilgrim's Path
Master Bedroom	** Escape to Maui # 89816 Pilgrim's Path
Bedroom #2	** Escape to Maui # 89816 Pilgrim's Path
Bedroom #3	** Escape to Maui # 89816 Pilgrim's Path
Bedroom #4	** Escape to Maui # 89816 Pilgrim's Path
Bedroom #5	/
Master ens. shower floor:	Anatolia Marmiline SNOW

Flooring Continued on Page 2

Initial:

Purchasers: AMIT SINGHAL & SONIYA SINGHAL Property: 158 of Plan - Draft Approval SB17-03-08
Telephone Res. / Bus: / Project: KINGSMEN (THAMES) INC.
Decor Advisor: Barbara Coccia Model and Elevation: Andrew (3603) Elev C 4 Bed - 2+1 Bath
4. Flooring - Continued -

Upgrade Underpad	Type	Area
	Standard	2nd. Floor
Carpet on Stairs	Capped	Runner - *Upgrade
Comment	/	/

3. Plumbing Fixtures / Faucets

Kitchen	Standard	Second Ensuite	/	Powder Room	Standard
Master Ensuite	Standard			Other Room	/
Main Bathroom	Standard		/		
Comment	Still to install the standard top mount kitchen and bathroom sinks.				

4. Wall Tile

	Tile Selection	Listello	Insert	Insert Selection
Main Bathroom	8x10" Malena Carbon	<input type="checkbox"/>	<input type="checkbox"/>	
Master Ensuite				
Tub Deck	13 x 13" Malena Carbon	<input type="checkbox"/>	<input type="checkbox"/>	
Tub Apron	13 x 13" Malena Carbon	<input type="checkbox"/>	<input type="checkbox"/>	
Tub Surround	13 x 13" Malena Carbon	<input type="checkbox"/>	<input type="checkbox"/>	
Shower Stall	8x10" Malena Ice	<input type="checkbox"/>	<input type="checkbox"/>	
Second Ensuite	/	<input type="checkbox"/>	<input type="checkbox"/>	
	/	<input type="checkbox"/>	<input type="checkbox"/>	
	/	<input type="checkbox"/>	<input type="checkbox"/>	
Kitchen Backsplash	/	<input type="checkbox"/>	<input type="checkbox"/>	
Complete Backsplash	/	<input type="checkbox"/>	<input type="checkbox"/>	

Comment
Install the standard 8x10" wall tiles on the 10" side stacked horizontally in the bathrooms where applicable.



horizontal stacked brick pattern vertical stacked diagonal/diamond

5. Fireplace

	Living Room			Family Room			Other Room - Specify/Great Room		
	Purchased	As Per Plan	N/A	Purchased	As Per Plan	N/A	Purchased	As Per Plan	N/A
Fireplace Type	<input type="radio"/>	<input type="radio"/>	<input checked="" type="radio"/>	<input type="radio"/>	<input type="radio"/>	<input checked="" type="radio"/>	<input type="radio"/>	<input checked="" type="radio"/>	<input type="radio"/>
Mantle Type							Front Facing		
Over Mantle							NF-08		
Colour / Stain							/		
Surround							White		
Hearth							/		
Comment	/								

Initial:

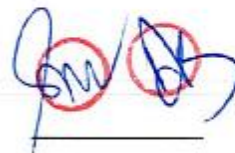

Purchasers: AMIT SINGHAL & SONIYA SINGHAL

Property: 158 of Plan - Draft Approval SB17-03-08

Telephone Res. / Bus: /

Project: KINGSMEN (THAMES) INC.

Decor Advisor: Barbara Coccia

Model and Elevation: Andrew (3603) Elev C 4 Bed - 2+1 Bath

6. Trim Carpentry

Door Hardware Standard Handle

Interior Trim Standard

Comment

/

Interior Doors

☐ 2 Panel Arch Top

☒ 2 Panel Square Top

☐ 6 Panel

Initial for Door Style

7. Railings and Pickets

Railing Package **Upg. 1 Metal Picket package

Railing Colour **Elements Wolfhound

Picket Colour BLACK

Wood Stairs ☐ No ☒ Oak

Tread Colour **Elements Wolfhound

Comment

/

8. Plaster Mouldings and Medallions

Foyer /

Main Hall /

Living Room /

Dining Room /

Family Room /

Kitchen/Breakfast /

Den/Library /

Lower Landing /

Comment

/

9. Wall Paint

Kingsmen White

Smooth Ceilings

☐ First Floor

☐ First Floor incl. Second Floor Hall

☐ First and Second Floor

☒ Throughout

☐ Not Applicable

Trim Paint Kingsmen White

10. Additional Comments

/

11. Disclaimers and Notes

- Colours of all materials are as close as possible to builder's selection, but not necessarily identical due to variances in manufacturing.
- Any extras listed above are null and void unless accompanied by a separate invoice/amendment. Said invoice must be paid in full.
- The Purchaser acknowledges that after Interior Colour Selection form is signed and dated, no further changes will be permitted other than re-selection due to unavailability. *[Signature]* Purchaser's Initials
- The Purchaser acknowledges reading and accepting the "Kingsmen Group Décor Centre Disclaimers" form. This document contains other miscellaneous disclaimers.

This Interior Colour Selection is final and approved by:

Purchaser:

Signature: *[Signature]*

Date: *Nov. 11-2022*

Signature: *[Signature]*

Date: *Nov 11, 2022*

Vendor: *[Signature]*

KINGSMEN (THAMES) INC.

Nov 11/22

Page 3 of 3

SCHEDULE "B-1"
Floor Plan

LOT 158
Phase 5A
Model: Andrew (3603) Elev C 4 Bed - 2+1 Bath
Standard

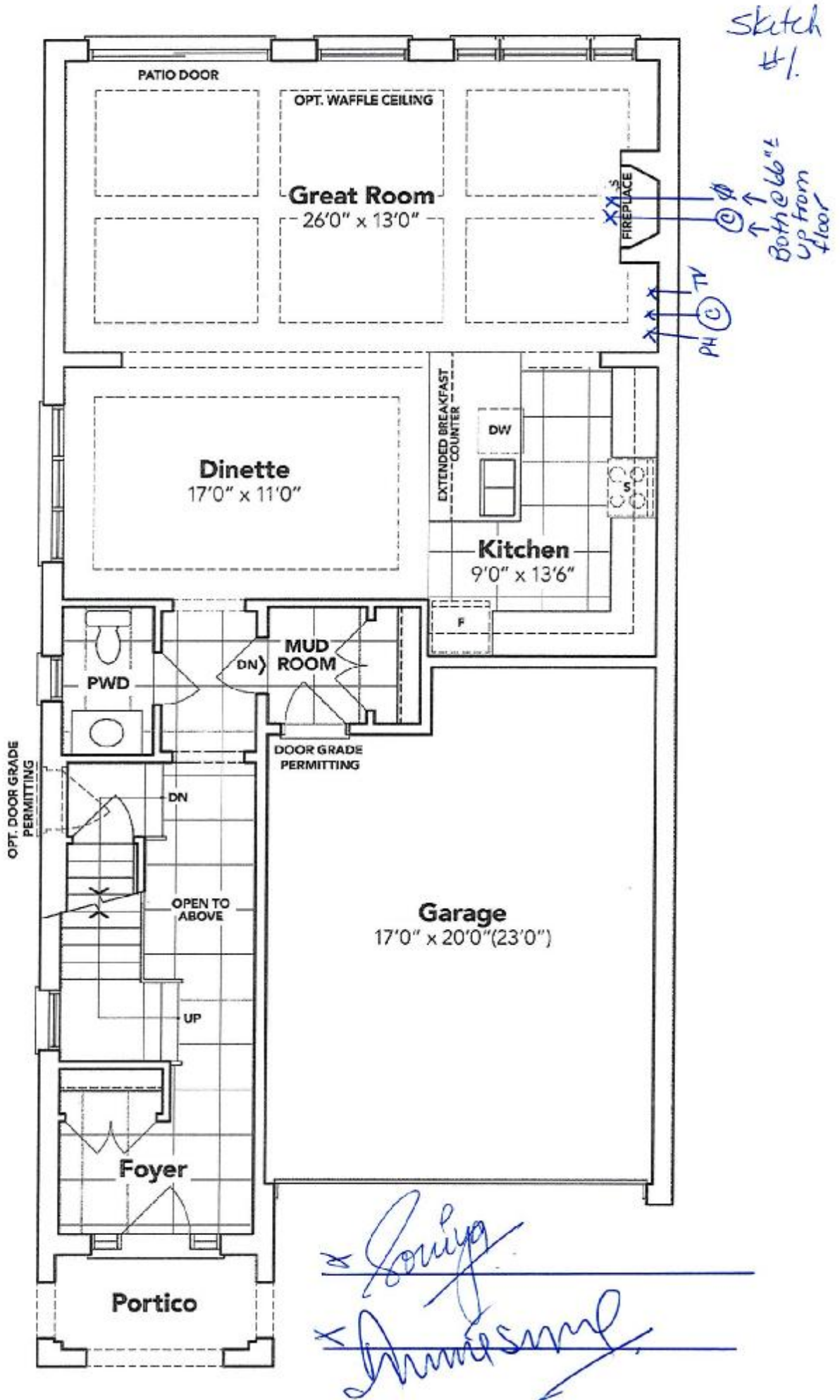

GROUND FLOOR EL. C

The floor plans and elevations shown are pre-construction plans and may be revised or improved as necessitated by architectural controls and the construction process. The measurements adhere to the rules and regulations of the TARION Warranty Corporation's official method for the calculation of floor area. Materials, specifications and floor plans are subject to change without notice. All house renderings are artist's concept only. Actual usable floor space may vary from the stated floor area. All options shown are upgrades. E. & O. E.

SCHEDULE "B-1" - Page 3 of 3

Initials: *[Handwritten]*

SCHEDULE "B-1"
Floor Plan

Lot 158
Phase 5A
Model: Andrew (3603) Elev C 4 Bed - 2+1 Bath
Standard

*Sketch
#2*

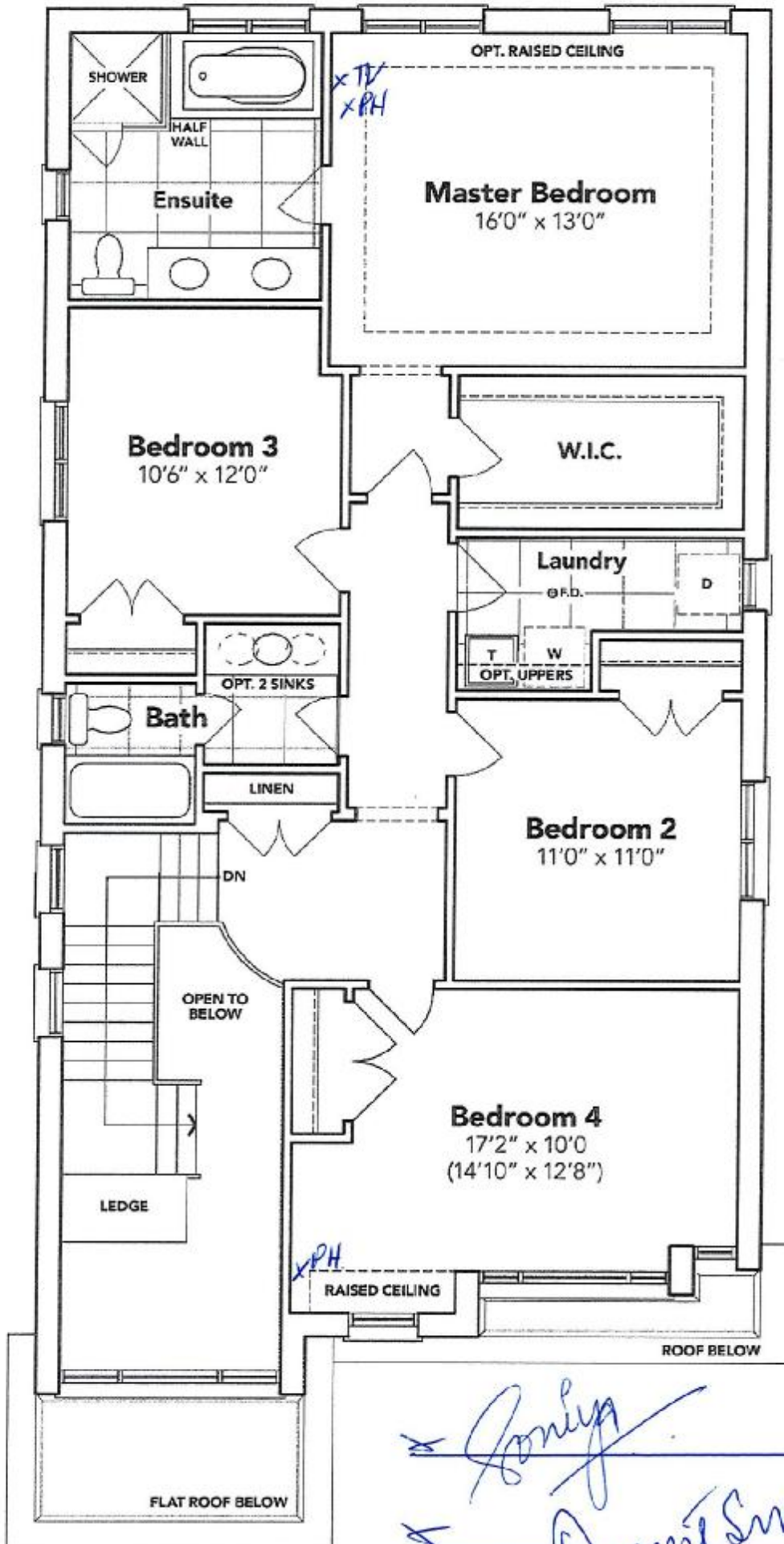

SECOND FLOOR EL. C

Conley
David Smith

The floor plans and elevations shown are pre-construction plans and may be revised or improved as necessitated by architectural controls and the construction process. The measurements adhere to the rules and regulations of the TARIION Warranty Corporation's official method for the calculation of floor area. Materials, specifications and floor plans are subject to change without notice. All house renderings are artist's concept only. Actual usable floor space may vary from the stated floor area. All options shown are upgrades. E. & O. E.

SCHEDULE "B-1" - Page 2 of 3

SCHEDULE "B-1"
Floor Plan

Lot 158
Phase 5A
Model: Andrew (3603) Elev C 4 Bed - 2+1 Bath
Standard

Sketch
#3

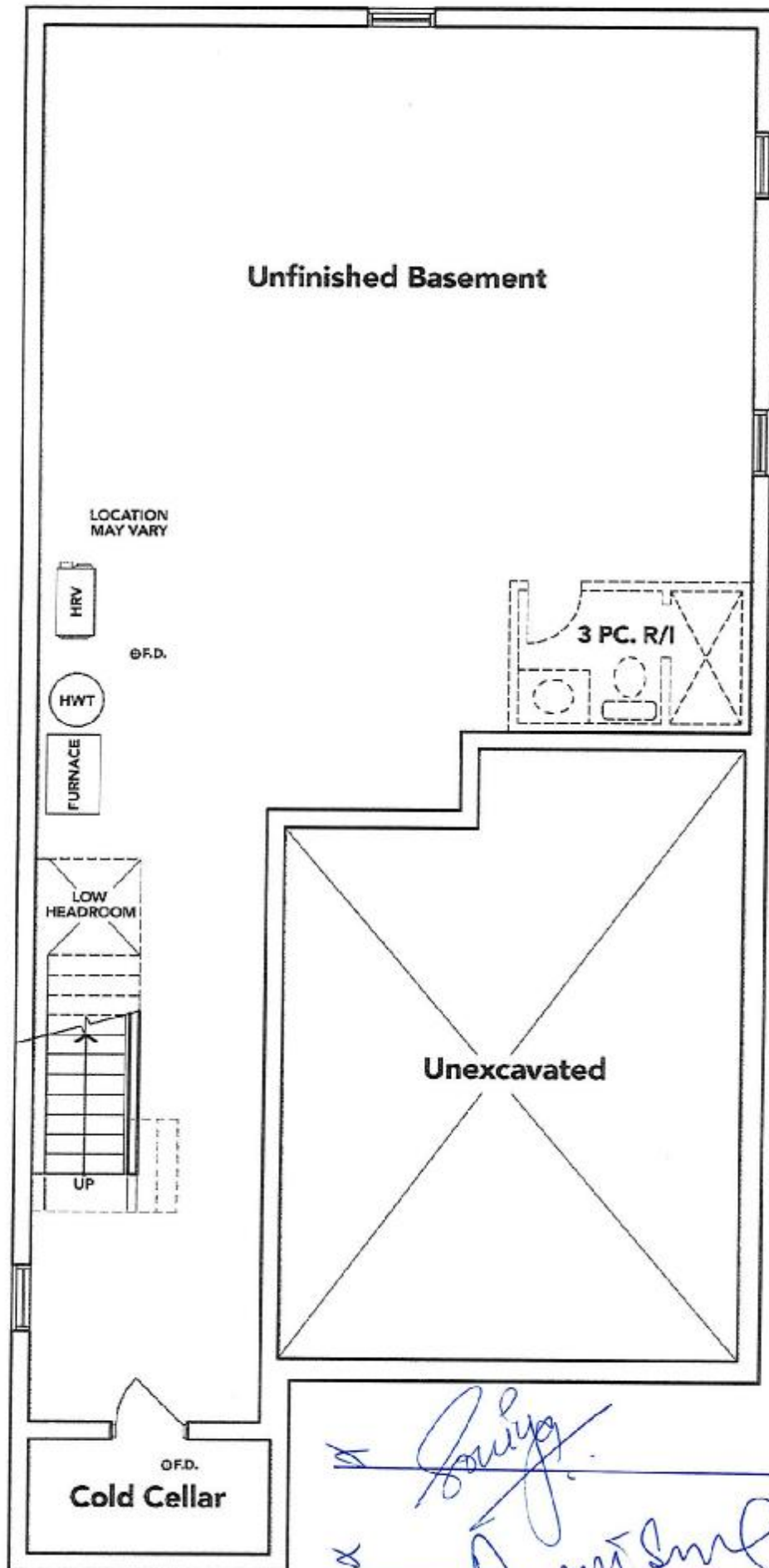

BASEMENT EL. C

The floor plans and elevations shown are pre-construction plans and may be revised or improved as necessitated by architectural controls and the construction process. The measurements adhere to the rules and regulations of the TARION Warranty Corporation's official method for the calculation of floor area. Materials, specifications and floor plans are subject to change without notice. All house renderings are artist's concept only. Actual usable floor space may vary from the stated floor area. All options shown are upgrades. E. & O. E.