

**KINGSMEN (THAMES) INC. / Havelock Corners (Kingsmen)**

**Lot/Unit: 4    Phase/Building: 5A    Model/Floor Plan: James (3601) Elev B 4 Bed - 2+1 Bath**

**COUNTER TOP**

Inv. <b>5975</b>	<b>1</b> - As per schedule "PE" : Vendor to incluhe level 1, 2cm. quartz in all bathrooms, as per plan, in lieu of the included laminate counter tops. Selections to be made from builders standard samples.	
Line <b>76517</b>	Note:	
9Nov22 / 10Nov22		

**ELECTRICAL**

Inv. <b>5975</b>	<b>1</b> - To supply & install the standard T.V. rough in in the great room & master bedroom..see sketch # 1 and # 2	
Line <b>76518</b>	Note: Install the standard T.V. rough in in at approx. 66" +- up from the floor centered + - to the F/P mantle in the great room.	
9Nov22 / 10Nov22		
Inv. <b>5975</b>	<b>1</b> - To supply & install the standard Phone (CAT 5) rough in in the great room, master bedroom and Bedroom # 2..see sketch # 1 and # 2	
Line <b>76519</b>	Note: Install the standard Phone ( CAT 5 ) rough in in at approx. 66" +- up from the floor centered + - to the F/P mantle in the great room.	
9Nov22 / 10Nov22		
Inv. <b>5975</b>	<b>1</b> - To SUPPLY AND INSTALL AN ADDITIONAL BASIC RECEPTACLE (NOT DEDICATED) at approx. 66" + - up from the floor centered + - to the F/P	
Line <b>76520</b>	Note: mantle in the great room... see sketch 1	
9Nov22 / 10Nov22                      This is for a future wall mount T.V. NO CONDUIT PIPE HAS BEEN PURCHASED.		
Inv. <b>5975</b>	<b>1</b> - To SUPPLY AND INSTALL EXTRA CEILING BOX ROUGH IN CAPPED (DOES NOT INCLUDE SWITCH) over the island in the kitchen... see sketch # 1	
Line <b>76521</b>	Note: This capped elec. will be connected to a sep. switch, switch sold sep.	
9Nov22 / 10Nov22		
Inv. <b>5975</b>	<b>1</b> - To supply & install AN ADDITIONAL SINGLE POLE SWITCH connected to the upgraded capped elec. over the island in the kitchen.	
Line <b>76522</b>	Note:	
9Nov22 / 10Nov22		
Inv. <b>5975</b>	<b>1</b> - Relocate the standard ceiling light from the upper stair landing to the O.T.B. area on the second floor..see sketch # 2	
Line <b>76524</b>	Note:	
9Nov22 / 10Nov22		

**HARDWOOD**

Inv. <b>5975</b>	<b>1</b> - To supply & install the 3 1/2" Elements stained oak engineered hardwood floor in lieu of the standard 3 1/2" Elements oak natural engineered hardwood floor to the main floor area and stair landings where applicable...see colour chart for details.	
Line <b>76529</b>	Note:	
9Nov22 / 10Nov22		
Inv. <b>5975</b>	<b>1</b> - To supply & install the 3 1/2" Elements stained oak engineered hardwood floor to the upper hallway in lieu of the standard carpet... see colour chart for details.	
Line <b>76532</b>	Note:	
9Nov22 / 10Nov22		

**HEATING AND AIR CONDITIONING**

KINGSMEN (THAMES) INC. / Havelock Corners (Kingsmen)

Lot/Unit: 4    Phase/Building: 5A    Model/Floor Plan: James (3601) Elev B 4 Bed - 2+1 Bath

Inv.5975	1 - As per schedule "PE" : Vendor to install capped gas line (rough in only) at rear of home for future BBQ location. Location to be finalized at vendors to be finalized at vendors sole discretion.	
Line 76514	Note:	
9Nov22 / 10Nov22		
Inv.5975	1 - As per schedule "PE" : Vendor to install capped gas line (rough in only) to kitchen in at stove location( as per plan ) to include 100As per schedule "PE" : Vendor to install capped gas line (rough in only) to include 110 V code requirement.	
Line 76515	Note:	
9Nov22 / 10Nov22		
Inv.5975	1 - As per schedule "PE" : Vendor to suply & install air conditioning unit, sized accordingly, from vendors standard standard samples.	
Line 76516	Note:	
9Nov22 / 10Nov22		

PAINT AND DRYWALL

Inv.5975	1 - To supply & install the PAINT EXTRAS - STAIN RAILINGS WITH IRON PICKETS (INCLUDING STAIRS) throughout the house where applicable... see colour chart for details.	
Line 76531	Note:	
9Nov22 / 10Nov22		

RAILING

Inv.5975	1 - To supply & install the RAILING - UPGRADE 1 - METAL HANDRAIL 3 INCH OVAL IN OAK - PICKETS STEEL ½ INCH SQUARE, PLAIN, WITH SHOES IN FLAT BLACK - POSTS 3½ INCH SQUARE, WITH CAP OAK IN OAK in lieu of the standard pickets and rails.	
Line 76530	Note:	
9Nov22 / 10Nov22		

EXTRAS AS PER OFFER

5 FREE APPLIANCES – STAINLESS STEEL FRONT - FRIDGE; STOVE AND DISHWASHER. WHITE WASHER AND DRYER (SUPPLIED ONLY, NOT INSTALLED, FROM BUILDERS STANDARD LINE). AN APPLIANCES VOUCHER WILL BE GIVEN BY OUR DECOR CONSULTANT AT THE TIME OF BOOKING YOUR COLOUR A <i>Worksheet</i> Note:	
VENDOR TO INSTALL CAPPED GAS LINE (ROUGH-IN ONLY) AT REAR OF HOME FOR FUTURE BBQ LOCATION. LOCATION TO BE FINALIZED AT VENDORS SOLE DISCRETION. <i>Worksheet</i> Note:	
VENDOR TO INSTALL GAS LINE (ROUGH-IN ONLY) TO KITCHEN IN AT STOVE LOCATION (AS PER PLAN) TO INCLUDE 110V CODE REQUIREMENT. <i>Worksheet</i> Note:	
VENDOR TO SUPPLY & INSTALL AIR CONDITIONING UNIT, SIZED ACCORDINGLY, FROM VENDORS STANDARD SAMPLES. <i>Worksheet</i> Note:	
VENDOR TO INCLUDE LEVEL 1, 2CM QUARTZ IN ALL BATHROOMS, AS PER PLAN, IN LIEU OF THE INCLUDED LAMINATE COUNTER TOPS. SELECTIONS TO BE MADE FROM BUILDERS STANDARD SAMPLES. <i>Worksheet</i> Note:	

**KINGSMEN (THAMES) INC. / Havelock Corners (Kingsmen)**

**Lot/Unit: 4    Phase/Building: 5A    Model/Floor Plan: James (3601) Elev B 4 Bed - 2+1 Bath**

Purchaser: SUMEET SINGH RANDHAWA

Property: 4 of Plan - Draft Approval SB17-03-08

Telephone Res. / Bus: /

Project: KINGSMEN (THAMES) INC.

Decor Advisor: Barbara Coccia

Model and Elevation: James (3601) Elev B 4 Bed - 2+1 Bath

Layout Changes: ☐ Yes ☒ No

Sketch Attached: ☒ Yes ☐ No

Exterior Colour Scheme:

1. Cabinetry	Style and Colour	Counter Top	Hardware
Kitchen / Breakfast	#3 Simcoe Orchid	#1, C/S # 3040 Cement 3cm.	#12881 Handle
Kitchen Island	#3 Simcoe Orchid	#1, C/S # 3040 Cement 3cm.	#12881 Handle
Laundry Room	/		
Powder Room	#3 Simcoe Orchid	#1, C/S # 3040 Cement 2cm.	#12881 Handle
Main Bathroom	#3 Simcoe Orchid	#1, C/S # 3040 Cement 2cm.	#12881 Handle
Master Ensuite Bathroom	#3 Simcoe Orchid	#1, C/S # 3040 Cement 2cm.	#12881 Handle
Second Ensuite Bathroom (If Applicable)	/		
	/		
	/		

Appliances	Custom Size Fridge <input type="radio"/> Yes <input checked="" type="radio"/> No	Valance Lighting <input type="radio"/> Yes <input checked="" type="radio"/> No	Microwave / Range Hood <input type="radio"/> Yes <input checked="" type="radio"/> No
	Cooktop / Rangetop <input type="radio"/> Yes <input checked="" type="radio"/> No	Built in Wall Oven <input type="radio"/> Yes <input checked="" type="radio"/> No	Slide-in Range <input type="radio"/> Yes <input checked="" type="radio"/> No
Comment			

## 2. Flooring

	Selection
Foyer	13 x 13" Malena Ice
Main Hall	13 x 13" Malena Ice
Back Hall	/
Breakfast	13 x 13" Malena Ice
Laundry Room	13 x 13" Malena Ice
Kitchen	13 x 13" Malena Ice
Powder Room	13 x 13" Malena Ice
Main Bathroom	13 x 13" Malena Ice
Master Ensuite	13 x 13" Malena Ice
Bathroom (If Applicable)	/
Mud Room	13 x 13" Malena Ice
Master ens. floor:	2x2" Ontario Snow White Matte
Living Room	/
Dining Room	/
Family / Great Room	**3 1/2" Elements Oak Strugeon
Den / Library / Study	/
Basement Landing (If Applies)	
Lower Landing (If Applicable)	**3 1/2" Elements Oak Strugeon
Upper Landing	(if applicable) **3 1/2" Elements Oak Strugeon
Upper Hall	**3 1/2" Elements Oak Strugeon
Master Bedroom	Modern Story 1, # 927 Morning Rain
Bedroom #2	Modern Story 1, # 927 Morning Rain
Bedroom #3	Modern Story 1, # 927 Morning Rain
Bedroom #4	Modern Story 1, # 927 Morning Rain
Bedroom #5	/
Master ens. Floor jamb:	Anatolia Marmiline SNOW



Flooring Continued on Page 2

SR

Initial:

Page 1 of 3

Purchaser: SUMEET SINGH RANDHAWA

Property: 4 of Plan - Draft Approval SB17-03-08

Telephone Res. / Bus: /

Project: KINGSMEN (THAMES) INC.

Decor Advisor: Barbara Coccia

Model and Elevation: James (3601) Elev B 4 Bed - 2+1 Bath

4. Flooring - Continued -

Upgrade Underpad	Type	Area
	Standard	Master bedroom, bedroom #2, #3 & #4
Carpet on Stairs	Capped	Runner - *Upgrade
Comment	/	/

### 3. Plumbing Fixtures / Faucets

Kitchen	Standard	Second Ensuite	/	Powder Room	Standard
Master Ensuite	Standard			Other Room	/
Main Bathroom	Standard		/		

Comment

Still to install the standard top mount kitchen and vanity sinks.

### 4. Wall Tile

	Tile Selection	Listello	Insert	Insert Selection
Main Bathroom	8x10" Clnq Grey	<input type="checkbox"/>	<input type="checkbox"/>	
Master Ensuite				
Tub Deck	13x13" Malena Ice	<input type="checkbox"/>	<input type="checkbox"/>	
Tub Apron	13x13" Malena Ice	<input type="checkbox"/>	<input type="checkbox"/>	
Tub Surround	13x13" Malena Ice	<input type="checkbox"/>	<input type="checkbox"/>	
Shower Stall	8x10" Clnq Grey	<input type="checkbox"/>	<input type="checkbox"/>	
Second Ensuite	/	<input type="checkbox"/>	<input type="checkbox"/>	
	/	<input type="checkbox"/>	<input type="checkbox"/>	
	/	<input type="checkbox"/>	<input type="checkbox"/>	
Kitchen Backsplash	/	<input type="checkbox"/>	<input type="checkbox"/>	
Complete Backsplash	/	<input type="checkbox"/>	<input type="checkbox"/>	
Comment	/			

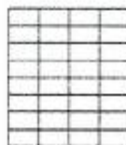

horizontal stacked



brick pattern



vertical stacked



diagonal/diamond

### 5. Fireplace

#### Living Room

Purchased ☐ As Per Plan ☐ N/A ☒

#### Family Room

Purchased ☐ As Per Plan ☐ N/A ☒

#### Other Room - Specify/Great room

Purchased ☐ As Per Plan ☒ N/A ☐

Fireplace Type

Mantle Type

Over Mantle

Colour / Stain

Surround

Hearth

Comment

/

RECEIVED

NOV 10 2022

Front Facing

NF-08

/

White

/

/

SR

Initial:

Page 2 of 3



Purchaser: SUMEET SINGH RANDHAWA

Property: 4 of Plan - Draft Approval SB17-03-08

Telephone Res. / Bus: /

Project: KINGSMEN (THAMES) INC.

Decor Advisor: Barbara Coccia

Model and Elevation: James (3601) Elev B 4 Bed - 2+1 Bath

### 6. Trim Carpentry

Door Hardware Standard Handle

Interior Trim Standard

Comment

/

#### Interior Doors

☐ 2 Panel Arch Top

☒ 2 Panel Square Top

☐ 6 Panel

Initial for Door Style

SR

### 7. Railings and Pickets

Railing Package \*\*#1 Metal picket package

Railing Colour \*\* Elements Sturgeon

Wood Stairs ☐ No ☒ Oak

Picket Colour BLACK

Tread Colour \*\* Elements Sturgeon

Comment

/

### 8. Plaster Mouldings and Medallions

Foyer /

Main Hall /

Living Room /

Dining Room /

Family Room /

Kitchen/Breakfast /

Den/Library /

Lower Landing /

Comment

/

### 9. Wall Paint

Kingsmen White

#### Smooth Ceilings

☐ First Floor

☐ First Floor incl. Second Floor Hall

☐ First and Second Floor

☒ Throughout

☐ Not Applicable

Trim Paint Kingsmen White

### 10. Additional Comments

/

RECEIVED

NOV 10 2022

### 11. Disclaimers and Notes

- Colours of all materials are as close as possible to builder's selection, but not necessarily identical due to variances in manufacturing.
- Any extras listed above are null and void unless accompanied by a separate invoice/amendment. Said invoice must be paid in full.
- The Purchaser acknowledges that after Interior Colour Selection form is signed and dated, no further changes will be permitted other than re-selection due to unavailability. SR Purchaser's Initials
- The Purchaser acknowledges reading and accepting the "Kingsmen Group Décor Centre Disclaimers" form. This document contains other miscellaneous disclaimers.

This Interior Colour Selection is final and approved by:

Purchaser:

Signature:

*[Signature]*

Date:

NOV 9, 2022

Vendor:

KINGSMEN (THAMES) INC.

NOV 11/22

SCHEDULE "B-1"  
Floor Plan

Lot 4  
Phase 5A  
Model: James (3601) Elev B 4 Bed - 2+1 Bath  
Standard

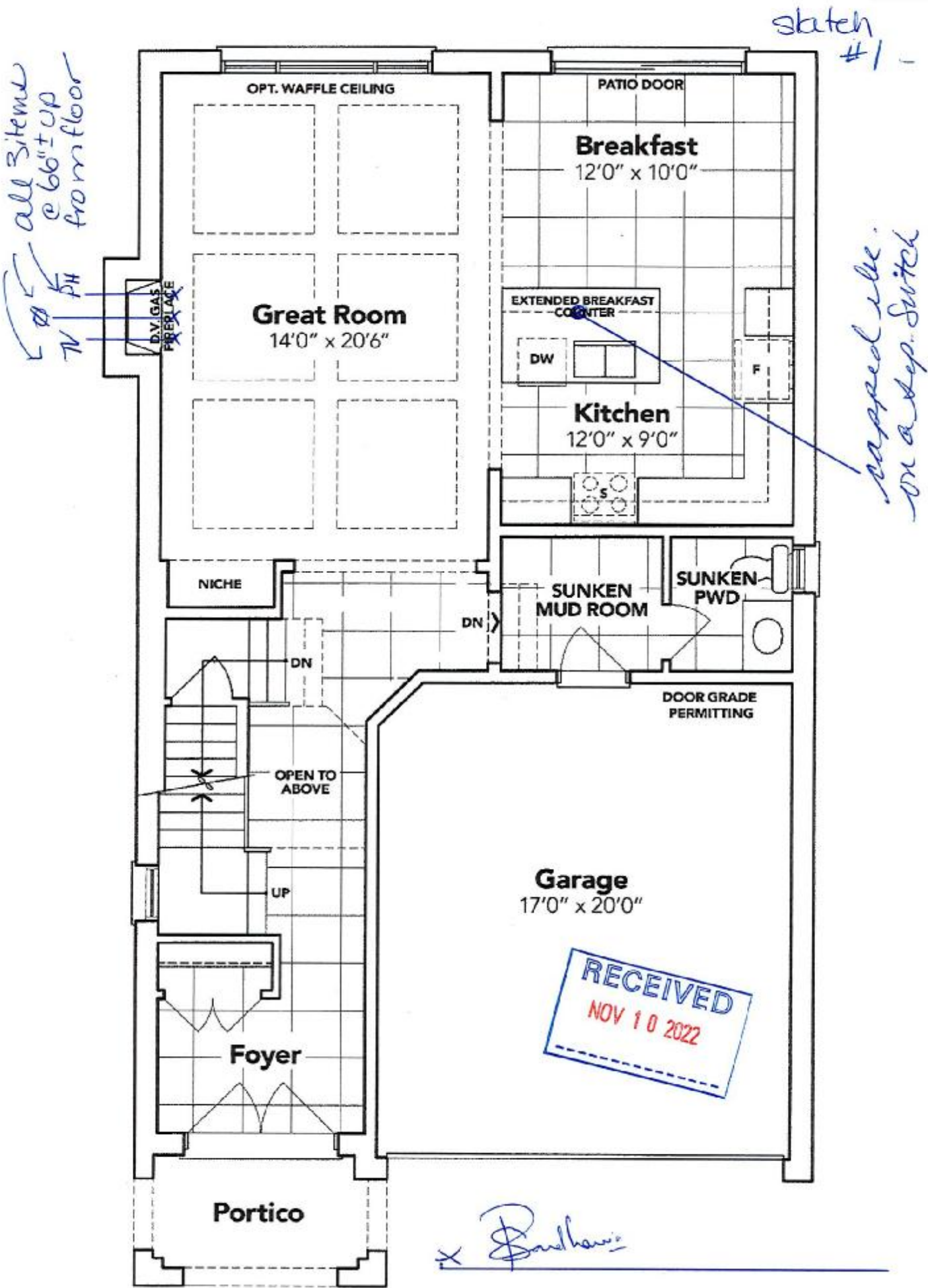

GROUND FLOOR EL. B

The floor plans and elevations shown are pre-construction plans and may be revised or improved as necessitated by architectural controls and the construction process. The measurements adhere to the rules and regulations of the TARIION Warranty Corporation's official method for the calculation of floor area. Materials, specifications and floor plans are subject to change without notice. All house renderings are artist's concept only. Actual usable floor space may vary from the stated floor area. All options shown are upgrades. E. & O. E.



**SCHEDULE "B-1"**  
**Floor Plan**

Lot 4  
Phase 5A  
Model: James (3601) Elev B 4 Bed - 2+1 Bath  
Standard

*Sketch #2*

*Relocated Std. Light.*

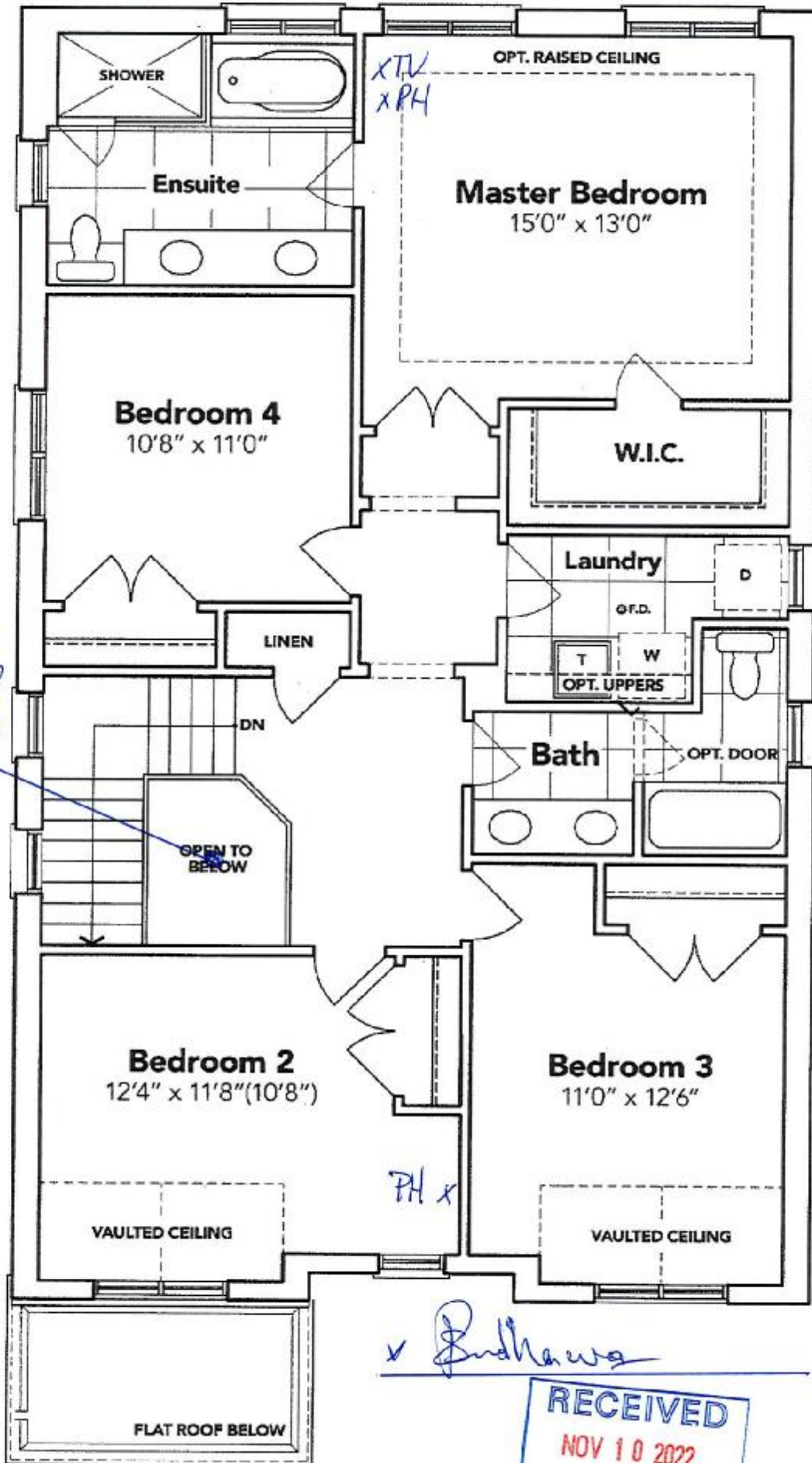

*x Budhawa*



**SECOND FLOOR EL. B**

The floor plans and elevations shown are pre-construction plans and may be revised or improved as necessitated by architectural controls and the construction process. The measurements adhere to the rules and regulations of the TARION Warranty Corporation's official method for the calculation of floor area. Materials, specifications and floor plans are subject to change without notice. All house renderings are artist's concept only. Actual usable floor space may vary from the stated floor area. All options shown are upgrades. E. & O. E.



**SCHEDULE "B-1"**  
**Floor Plan**

Lot 4  
Phase 5A  
Model: James (3601) Elev B 4 Bed - 2+1 Bath  
Standard

*Sketch #3*

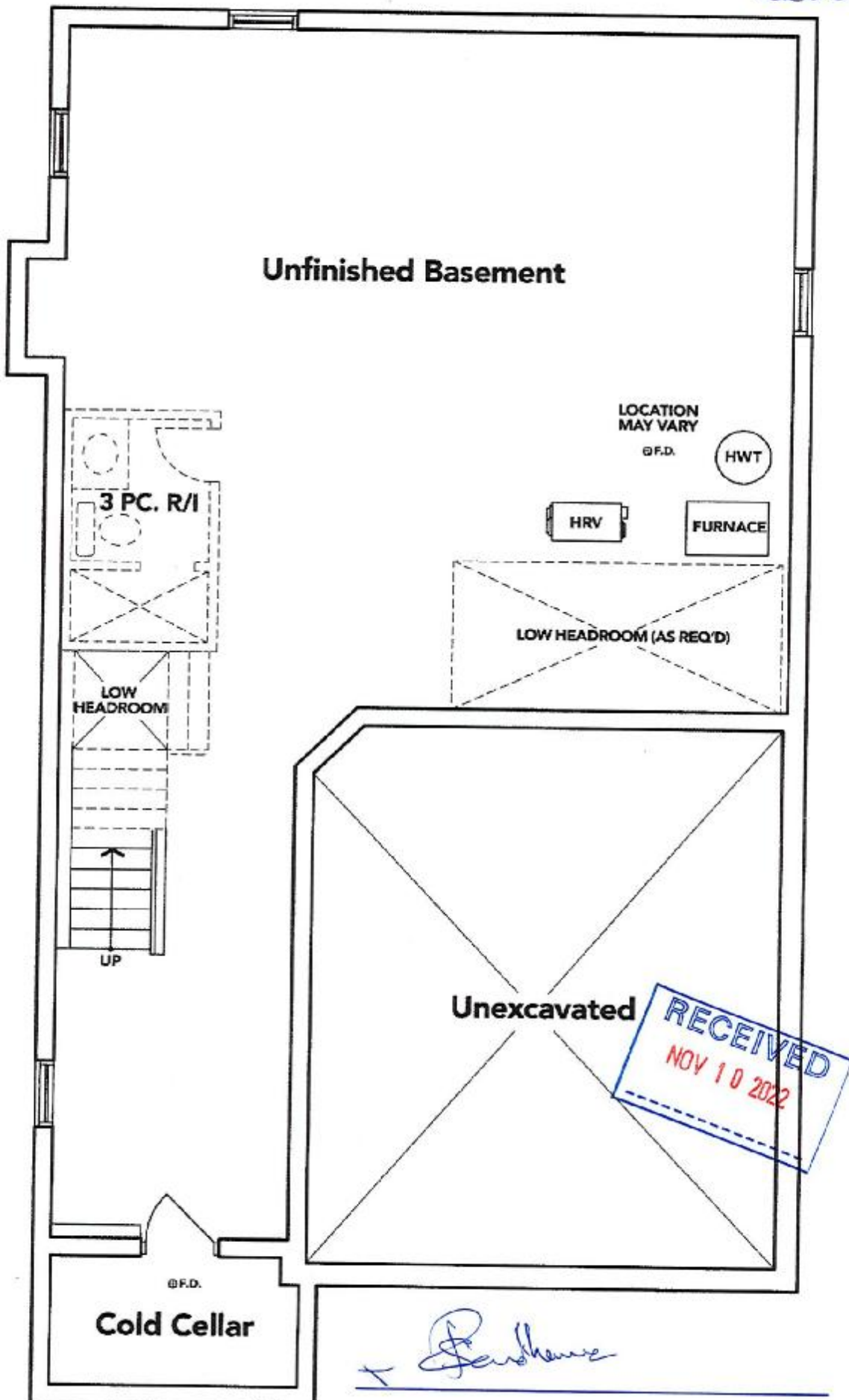

**BASEMENT EL. B**

The floor plans and elevations shown are pre-construction plans and may be revised or improved as necessitated by architectural controls and the construction process. The measurements adhere to the rules and regulations of the TARION Warranty Corporation's official method for the calculation of floor area. Materials, specifications and floor plans are subject to change without notice. All house renderings are artist's concept only. Actual usable floor space may vary from the stated floor area. All options shown are upgrades. E. & O. E.