

KINGSMEN (THAMES) INC. / Havelock Corners (Kingsmen)

Lot/Unit: 136 Phase/Building: 5A Model/Floor Plan: James (3601) Elev A 4 Bed - 2+1 Bath

COUNTER TOP

Inv. 5662	1 - As per schedule "PE": Vendor to include level 1, 2cm. quartz in all bathrooms, as per plan, in lieu of the included laminate counter tops. Selections to be made from builders standard samples.	
Line 74996	Note:	
29Jun22 / 13Oct22		

ELECTRICAL

Inv. 5662	1 - To supply & install the standard T.V. rough in in the great room and master bedroom...see sketch # 1 & # 2	
Line 74997	Note:	
29Jun22 / 13Oct22		
Inv. 5662	1 - To supply & install the standard Phone (CAT 5) rough in in the great room, master bedroom & bedroom #2 ...see sketch # 1 & # 2	
Line 74998	Note:	
29Jun22 / 13Oct22		

HEATING AND AIR CONDITIONING

Inv. 5662	1 - As per schedule "PE": Vendor to install capped gas line (rough in only) at rear of home for future BBQ location. Location to be finalzied at vendors sole discretion.	
Line 74993	Note:	
29Jun22 / 13Oct22		
Inv. 5662	1 - As per schedule "PE": Vendor to install capped gas line (rough in only) to kitchen in at stove location (as per plan) to include 110V code requirement.	
Line 74994	Note:	
29Jun22 / 13Oct22		
Inv. 5662	1 - As per schedule "PE": Vendor to supply & install air conditioning unit, sized accordingly, from vendors standard samples.	
Line 74995	Note:	
29Jun22 / 13Oct22		



CONSTRUCTION SUMMARY

KINGSMEN (THAMES) INC. / Havelock Corners (Kingsmen)

Lot/Unit: 136 Phase/Building: 5A Model/Floor Plan: James (3601) Elev A 4 Bed - 2+1 Bath

EXTRAS AS PER OFFER

5 FREE APPLIANCES – STAINLESS STEEL FRONT - FRIDGE: STOVE AND DISHWASHER. WHITE WASHER AND DRYER (SUPPLIED ONLY, NOT INSTALLED, FROM BUILDERS STANDARD LINE). AN APPLIANCES VOUCHER WILL BE GIVEN BY OUR DECOR CONSULTANT AT THE TIME OF BOOKING YOUR COLOUR A <i>Worksheet</i> Note:	
VENDOR TO INSTALL CAPPED GAS LINE (ROUGH-IN ONLY) AT REAR OF HOME FOR FUTURE BBQ LOCATION. LOCATION TO BE FINALIZED AT VENDORS SOLE DISCRETION. <i>Worksheet</i> Note:	
VENDOR TO INSTALL GAS LINE (ROUGH-IN ONLY) TO KITCHEN IN AT STOVE LOCATION (AS PER PLAN) TO INCLUDE 110V CODE REQUIREMENT. <i>Worksheet</i> Note:	
VENDOR TO SUPPLY & INSTALL AIR CONDITIONING UNIT, SIZED ACCORDINGLY, FROM VENDORS STANDARD SAMPLES. <i>Worksheet</i> Note:	
VENDOR TO INCLUDE LEVEL 1, 2CM QUARTZ IN ALL BATHROOMS, AS PER PLAN, IN LIEU OF THE INCLUDED LAMINATE COUNTER TOPS. SELECTIONS TO BE MADE FROM BUILDERS STANDARD SAMPLES. <i>Worksheet</i> Note:	

Purchaser: JUJHAR SINGH

Property: 136 of Plan - Draft Approval SB17-03-08

Telephone Res. / Bus: /

Project: KINGSMEN (THAMES) INC.

Decor Advisor: Barbara Coccia

Model and Elevation: James (3601) Elev A 4 Bed - 2+1 Bath

Layout Changes: ☐ Yes ☒ No

Sketch Attached: ☒ Yes ☐ No

Exterior Colour Scheme:

1. Cabinetry

	Style and Colour	Counter Top	Hardware
Kitchen / Breakfast	#3 Charleston 3DL Moonlight	#1 C/S # 9141 Ice Snow 3cm.	#12881 Handle
Kitchen Island	#3 Charleston 3DL Moonlight	#1 C/S # 9141 Ice Snow 3cm.	#12881 Handle
Laundry Room	/		
Powder Room	#3 Charleston 3DL Moonlight	#1 C/S # 9141 Ice Snow 2cm.	#12881 Handle
Main Bathroom	#3 Trinity Viva Weekend Getaway	#1 C/S # 3040 Cement 2cm.	# 12843 Handle
Master Ensuite Bathroom	#3 Trinity Viva Weekend Getaway	#1 C/S # 3040 Cement 2cm.	# 12843 Handle
Second Ensuite Bathroom (If Applicable)	/		
	/		
	/		

Appliances

Custom Size Fridge

☐ Yes ☒ No

Valance Lighting

☐ Yes ☒ No

Microwave / Range Hood

☐ Yes ☒ No

Cooktop / Rangetop

☐ Yes ☒ No

Built in Wall Oven

☐ Yes ☒ No

Slide-in Range

☐ Yes ☒ No

Comment

/

2. Flooring

	Selection
Foyer	13 x 13" Cinq Grey
Main Hall	13 x 13" Cinq Grey
Back Hall	/
Breakfast	13 x 13" Cinq Grey
Laundry Room	13 x 13" Cinq Black
Kitchen	13 x 13" Cinq Grey
Powder Room	13 x 13" Cinq Grey
Main Bathroom	13 x 13" Cinq Black
Master Ensuite	13 x 13" Cinq Black
Bathroom (If Applicable)	/
Mud Room	13 x 13" Cinq Grey
Master ens. shower floor:	2x2" Ontario Snow White Matte
Living Room	/
Dining Room	/
Family / Great Room	3 1/2" Elements Oak Natural
Den / Library / Study	/
Basement Landing (If Applies)	
Lower Landing (If Applicable)	3 1/2" Elements Oak Natural
Upper Landing	(if applicable) 3 1/2" Elements Oak Natural
Upper Hall	Modern Story 1, #966 Spellbound
Master Bedroom	Modern Story 1, #966 Spellbound
Bedroom #2	Modern Story 1, #966 Spellbound
Bedroom #3	Modern Story 1, #966 Spellbound
Bedroom #4	Modern Story 1, #966 Spellbound
Bedroom #5	/
Master ens. shower jamb:	Anatolia Marmiline IVORY



Flooring Continued on Page 2



Initial:

Page 1 of 3

Purchaser: JUJHAR SINGH

Telephone Res. / Bus: /

Decor Advisor: Barbara Coccia
 4. Flooring - Continued -

Property: 136 of Plan - Draft Approval SB17-03-08

Project: KINGSMEN (THAMES) INC.

Model and Elevation: James (3601) Elev A 4 Bed - 2+1 Bath

Upgrade Underpad	Type	Area
	Standard	2nd. Floor
Carpet on Stairs	Capped	Runner - *Upgrade
Comment	/	/
/		

3. Plumbing Fixtures / Faucets

Kitchen	Standard	Second Ensuite	/	Powder Room	Standard
Master Ensuite	Standard			Other Room	/
Main Bathroom	Standard				

Comment

Still to install the standard top mount kitchen and bathroom sinks.

4. Wall Tile

	Tile Selection	Listello	Insert	Insert Selection
Main Bathroom	8x10" Cinq White	<input type="checkbox"/>	<input type="checkbox"/>	
Master Ensuite				
Tub Deck	13 x 13" Cinq Black	<input type="checkbox"/>	<input type="checkbox"/>	
Tub Apron	13 x 13" Cinq Black	<input type="checkbox"/>	<input type="checkbox"/>	
Tub Surround	13 x 13" Cinq Black	<input type="checkbox"/>	<input type="checkbox"/>	
Shower Stall	8x10" Cinq White	<input type="checkbox"/>	<input type="checkbox"/>	
Second Ensuite	/	<input type="checkbox"/>	<input type="checkbox"/>	
	/	<input type="checkbox"/>	<input type="checkbox"/>	
	/	<input type="checkbox"/>	<input type="checkbox"/>	
Kitchen Backsplash	/	<input type="checkbox"/>	<input type="checkbox"/>	
Complete Backsplash	/	<input type="checkbox"/>	<input type="checkbox"/>	

Comment

Install the standard 8x10" wall tiles on the 10" side stacked horizontally in the bathrooms where applicable.

horizontal stacked

brick pattern

vertical stacked

diagonal/diamond

5. Fireplace

	Living Room			Family Room			Other Room - Specify Great room		
	Purchased	As Per Plan	N/A	Purchased	As Per Plan	N/A	Purchased	As Per Plan	N/A
	<input type="radio"/>	<input type="radio"/>	<input checked="" type="radio"/>	<input type="radio"/>	<input type="radio"/>	<input checked="" type="radio"/>	<input type="radio"/>	<input checked="" type="radio"/>	<input type="radio"/>
Fireplace Type							Front Facing		
Mantle Type							NF-08		
Over Mantle							/		
Colour / Stain							White		
Surround							/		
Hearth							/		
Comment									
/									

Purchaser: JUJHAR SINGH

Property: 136 of Plan - Draft Approval SB17-03-08

Telephone Res. / Bus: /

Project: KINGSMEN (THAMES) INC.

Decor Advisor: Barbara Coccia

Model and Elevation: James (3601) Elev A 4 Bed - 2+1 Bath

6. Trim Carpentry

Door Hardware Standard Handle

Interior Trim Standard

Comment

/

Interior Doors

☐ 2 Panel Arch Top

☒ 2 Panel Square Top

☐ 6 Panel



Initial for Door Style

2

7. Railings and Pickets

Railing Package Standard oak STRAIGHT picket package

Railing Colour Elements Natural

Picket Colour Elements Natural

Wood Stairs ☐ No ☒ Oak

Tread Colour Elements Natural

Comment

/

8. Plaster Mouldings and Medallions

Foyer /

Main Hall /

Living Room /

Dining Room /

Family Room /

Comment

/

Kitchen/Breakfast /

Den/Library /

Lower Landing /

/



9. Wall Paint

Kingsmen White

Smooth Ceilings ☐ First Floor

☐ First Floor incl. Second Floor Hall

☐ First and Second Floor

☒ Throughout

☐ Not Applicable

Trim Paint Kingsmen White

10. Additional Comments

/

11. Disclaimers and Notes

1) Colours of all materials are as close as possible to builder's selection, but not necessarily identical due to variances in manufacturing.

2) Any extras listed above are null and void unless accompanied by a separate invoice/amendment. Said invoice must be paid in full.

3) The Purchaser acknowledges that after Interior Colour Selection form is signed and dated, no further changes will be permitted other than re-selection due to unavailability. 2a Purchaser's Initials

4) The Purchaser acknowledges reading and accepting the "Kingsmen Group Décor Centre Disclaimers" form. This document contains other miscellaneous disclaimers.

This Interior Colour Selection is final and approved by:

Purchaser:

Signature: [Signature]

Date: 13/10/22

Vendor:

KINGSMEN (THAMES) INC.

Oct 17/22

SCHEDULE "B-1"
Floor Plan

LOT 138
Phase 5A
Model: James (3601) Elev A 4 Bed - 2+1 Bath
Standard

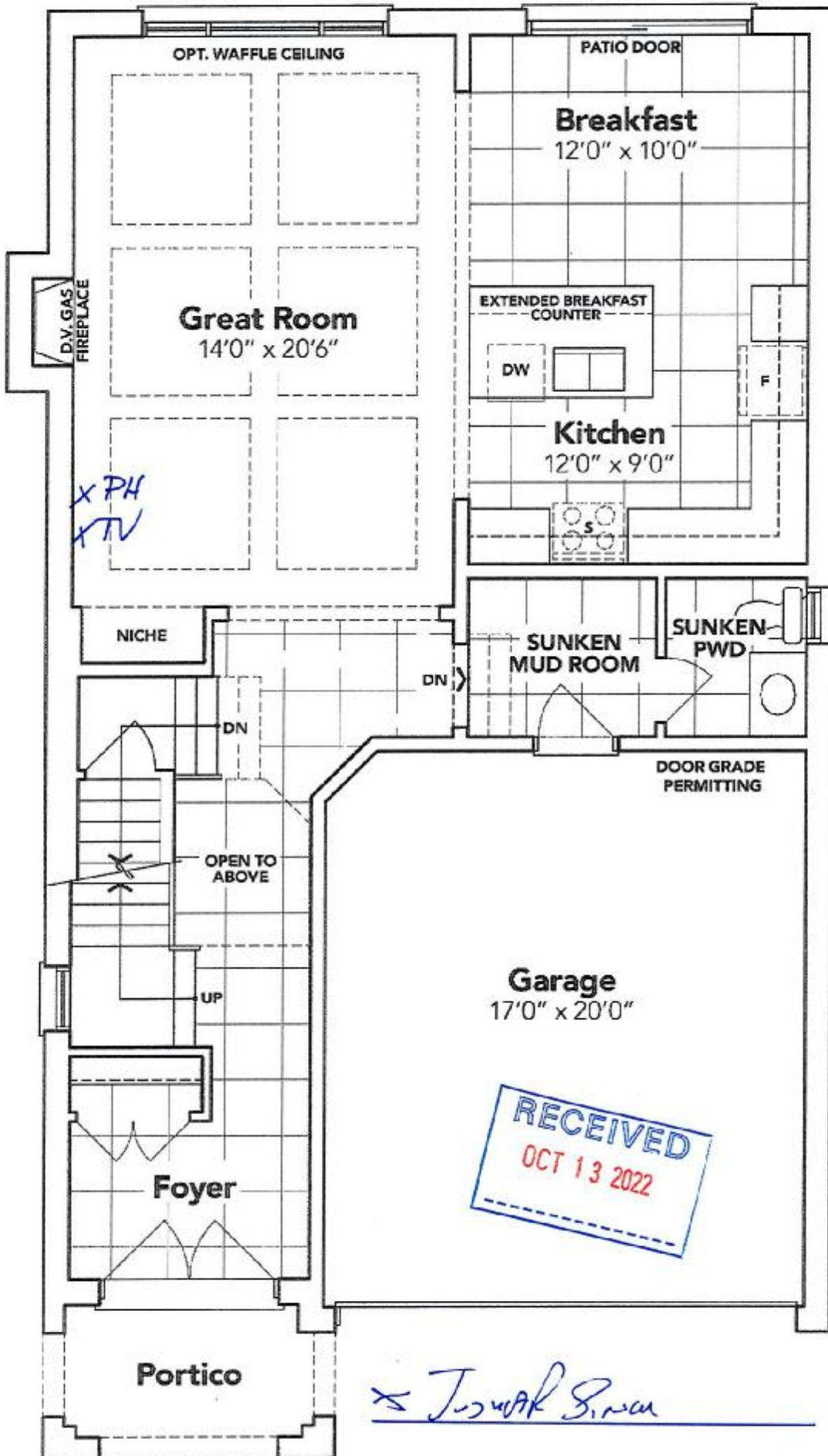

GROUND FLOOR EL. A

The floor plans and elevations shown are pre-construction plans and may be revised or improved as necessitated by architectural controls and the construction process. The measurements adhere to the rules and regulations of the TARIION Warranty Corporation's official method for the calculation of floor area. Materials, specifications and floor plans are subject to change without notice. All house renderings are artist's concept only. Actual usable floor space may vary from the stated floor area. All options shown are upgrades. E. & O. E.

SCHEDULE "B-1"
Floor Plan

Lot 136
Phase 5A
Model: James (3601) Elev A 4 Bed - 2+1 Bath
Standard

Sketch #2

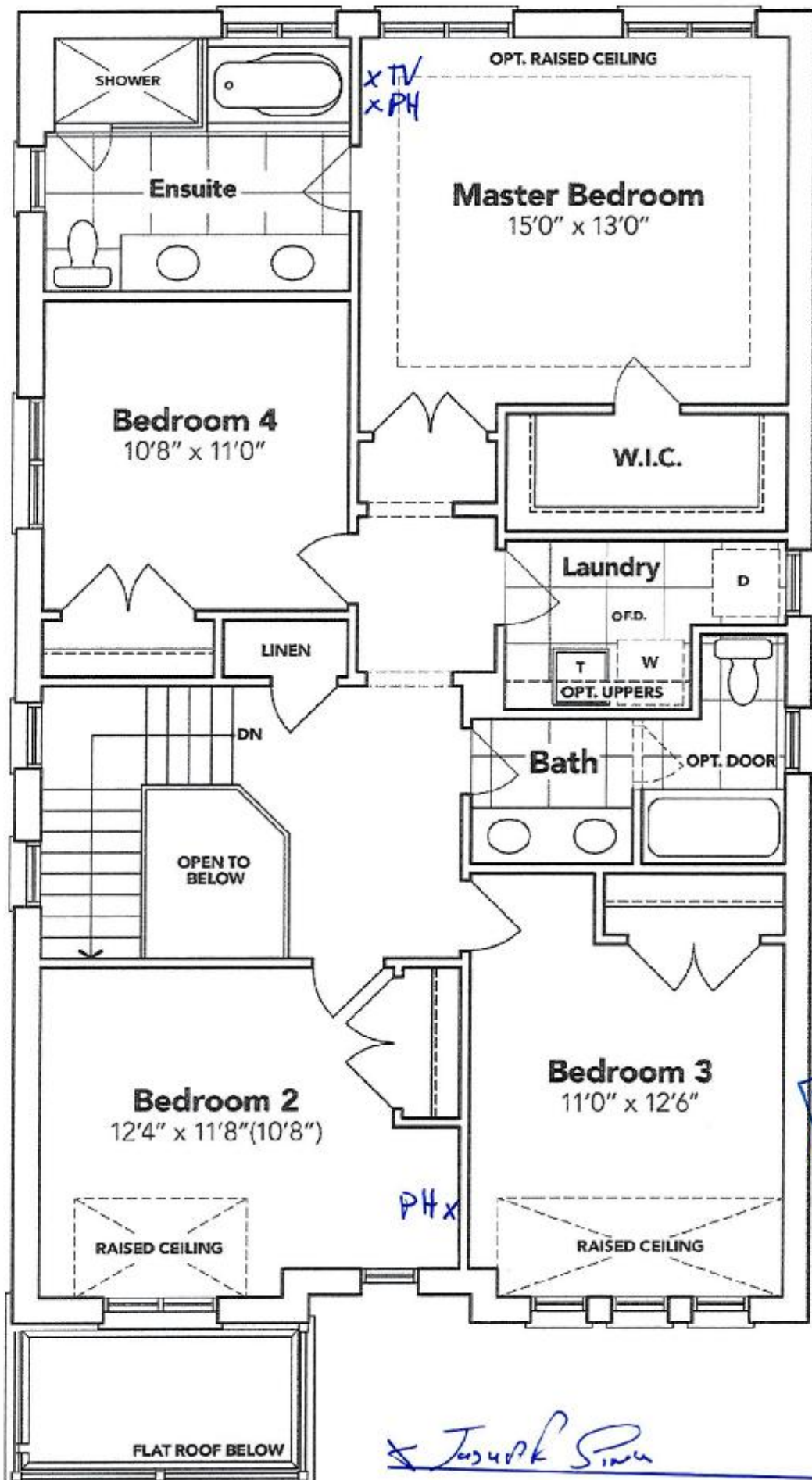

James P. Simon

SECOND FLOOR EL. A

The floor plans and elevations shown are pre-construction plans and may be revised or improved as necessitated by architectural controls and the construction process. The measurements adhere to the rules and regulations of the TARIION Warranty Corporation's official method for the calculation of floor area. Materials, specifications and floor plans are subject to change without notice. All house renderings are artist's concept only. Actual usable floor space may vary from the stated floor area. All options shown are upgrades. E. & O. E.

Lot: 136
Phase 5A
Model: James (3601) Elev A 4 Bed - 2+1 Bath
Standard

A. Jeyaraj Sinner

inMS_014.rpt 22Sep18