

**KINGSMEN (THAMES) INC. / Havelock Corners (Kingsmen)**

**Lot/Unit: 140    Phase/Building: 5A    Model/Floor Plan: James (3601) Elev A 4 Bed - 2+1 Bath**

**COUNTER TOP**

Inv. <b>5903</b>	<b>1</b> - As per schedule "PE": Vendor to include level 1, 2cm. quartz in all bathrooms, as per plan, in lieu of the included laminate counter tops. Selctions to be made from builders standard samples.	
Line <b>74900</b>	Note:	
6Oct22 / 6Oct22		

**ELECTRICAL**

Inv. <b>5903</b>	<b>1</b> - To supply & install the standard T.V. rough in in the great room and master bedroom... see sketch # 1 & # 2	
Line <b>74901</b>	Note:	
6Oct22 / 6Oct22		
Inv. <b>5903</b>	<b>1</b> - To supply & install the standard Phone (CAT 5 ) rough in in the great room, master bedroom & bedroom # 2 ... see sketch # 1 & # 2	
Line <b>74902</b>	Note:	
6Oct22 / 6Oct22		

**HEATING AND AIR CONDITIONING**

Inv. <b>5903</b>	<b>1</b> - As per schedule "PE": Vendor to install capped gas line ( rough in only ) at rear of home for future BBQ location. Location to be finalized at vendors sole discretion.	
Line <b>74898</b>	Note:	
6Oct22 / 6Oct22		
Inv. <b>5903</b>	<b>1</b> - As per schedule "PE": Vendor to supply & install air conditioning unit, sized accordingly, from vendors standard samples.	
Line <b>74899</b>	Note:	
6Oct22 / 6Oct22		

**EXTRAS AS PER OFFER**

5 FREE APPLIANCES – STAINLESS STEEL FRONT - FRIDGE: STOVE AND DISHWASHER. WHITE WASHER AND DRYER (SUPPLIED ONLY, NOT INSTALLED, FROM BUILDERS STANDARD LINE). AN APPLIANCES VOUCHER WILL BE GIVEN BY OUR DECOR CONSULTANT AT THE TIME OF BOOKING YOUR COLOUR A <i>Worksheet</i> Note:	
VENDOR TO INSTALL CAPPED GAS LINE (ROUGH-IN ONLY) AT REAR OF HOME FOR FUTURE BBQ LOCATION. LOCATION TO BE FINALIZED AT VENDORS SOLE DISCRETION. <i>Worksheet</i> Note:	
VENDOR TO SUPPLY & INSTALL AIR CONDITIONING UNIT, SIZED ACCORDINGLY, FROM VENDORS STANDARD SAMPLES. <i>Worksheet</i> Note:	
VENDOR TO INCLUDE LEVEL 1, 2CM QUARTZ IN ALL BATHROOMS, AS PER PLAN, IN LIEU OF THE INCLUDED LAMINATE COUNTER TOPS. SELECTIONS TO BE MADE FROM BUILDERS STANDARD SAMPLES. <i>Worksheet</i> Note:	

Purchaser: RAGHAV KUMAR

Property: 140 of Plan - Draft Approval SB17-03-08

Telephone Res. / Bus: /

Project: KINGSMEN (THAMES) INC.

Decor Advisor: Barbara Coccia

Model and Elevation: James (3601) Elev A 4 Bed - 2+1 Bath

Layout Changes: ☐ Yes ☒ No

Sketch Attached: ☒ Yes ☐ No

Exterior Colour Scheme:

1. Cabinetry

	Style and Colour	Counter Top	Hardware
Kitchen / Breakfast	#3 Manchester Maple Espresso	#1, C/S # 9141 Ice Snow 3cm.	#12881 Handle
Kitchen Island	#3 Manchester Maple Espresso	#1, C/S # 9141 Ice Snow 3cm.	#12881 Handle
Laundry Room	/		
Powder Room	#3 Manchester Maple Espresso	#1, C/S # 9141 Ice Snow 2cm.	#12881 Handle
Main Bathroom	#3 Manchester Maple Espresso	#1, C/S # 9141 Ice Snow 2cm.	#12881 Handle
Master Ensuite Bathroom	#3 Manchester Maple Espresso	#1, C/S # 9141 Ice Snow 2cm.	#12881 Handle
Second Ensuite Bathroom (If Applicable)	/		
	/		
	/		

Appliances

Custom Size Fridge

☐ Yes ☒ No

Valance Lighting

☐ Yes ☒ No

Microwave / Range Hood

☐ Yes ☒ No

Cooktop / Rangetop

☐ Yes ☒ No

Built in Wall Oven

☐ Yes ☒ No

Slide-in Range

☐ Yes ☒ No

Comment

2. Flooring

	Selection
Foyer	13 x13" Keaton Ice
Main Hall	13 x13" Keaton Ice
Back Hall	/
Breakfast	13 x13" Keaton Ice
Laundry Room	13 x13" Keaton Ice
Kitchen	13 x13" Keaton Ice
Powder Room	13 x13" Keaton Ice
Main Bathroom	13 x13" Keaton Ice
Master Ensuite	13 x13" Keaton Ice
Bathroom (If Applicable)	/
Mud Room	13 x13" Keaton Ice
Master ens. Shower floor:	2x2" Ontario Snow White Matte
Living Room	/
Dining Room	/
Family / Great Room	3 1/2" Elements Oak Natural
Den / Library / Study	/
Basement Landing (If Applies)	
Lower Landing (If Applicable)	3 1/2" Elements Oak Natural
Upper Landing	( If applicable ) 3 1/2" Elements Oak Natural
Upper Hall	Modern Story 1, # 808 Gondola
Master Bedroom	Modern Story 1, # 808 Gondola
Bedroom #2	Modern Story 1, # 808 Gondola
Bedroom #3	Modern Story 1, # 808 Gondola
Bedroom #4	Modern Story 1, # 808 Gondola
Bedroom #5	/
Master ens. shower jamb:	Anatolia Marmiline SNOW

RECEIVED

OCT 06 2022

SEE ATTACHED FOR SIGNATURES

Flooring Continued on Page 2

Initial: \_\_\_\_\_

Purchaser: RAGHAV KUMAR

Property: 140 of Plan - Draft Approval SB17-03-08

Telephone Res. / Bus: /

Project: KINGSMEN (THAMES) INC.

Decor Advisor: Barbara Coccia

Model and Elevation: James (3601) Elev A 4 Bed - 2+1 Bath

2. Flooring - Continued -

Upgrade Underpad	Type	Area
	Standard	2nd. floor
Carpet on Stairs	Capped	Runner - *Upgrade
Comment	/	//

### 3. Plumbing Fixtures / Faucets

Kitchen	Standard	Second Ensuite	/	Powder Room	Standard
Master Ensuite	Standard			Other Room	/
Main Bathroom	Standard				

#### Comment

Still to install the standard top mount kitchen and bathroom sinks.

### 4. Wall Tile

	Tile Selection	Listello	Insert	Insert Selection
Main Bathroom	8x10" Keaton Ice	<input type="checkbox"/>	<input type="checkbox"/>	
Master Ensuite				
Tub Deck	13 x13" Keaton Ice	<input type="checkbox"/>	<input type="checkbox"/>	
Tub Apron	13 x13" Keaton Ice	<input type="checkbox"/>	<input type="checkbox"/>	
Tub Surround	13 x13" Keaton Ice	<input type="checkbox"/>	<input type="checkbox"/>	
Shower Stall	8x10" Keaton Ice	<input type="checkbox"/>	<input type="checkbox"/>	
Second Ensuite	/	<input type="checkbox"/>	<input type="checkbox"/>	
	/	<input type="checkbox"/>	<input type="checkbox"/>	
	/	<input type="checkbox"/>	<input type="checkbox"/>	
Kitchen Backsplash	/	<input type="checkbox"/>	<input type="checkbox"/>	
Complete Backsplash	/	<input type="checkbox"/>	<input type="checkbox"/>	

#### Comment

Install the standard 8x10" wall tiles on the 10" side stacked horizontally in all bathrooms where applicable.

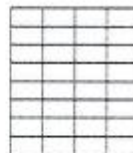

horizontal stacked



brick pattern



vertical stacked



diagonal/diamond

### 5. Fireplace

	Living Room			Family Room			Other Room - Specify Great Room		
	Purchased	As Per Plan	N/A	Purchased	As Per Plan	N/A	Purchased	As Per Plan	N/A
Fireplace Type	<input type="radio"/>	<input type="radio"/>	<input checked="" type="radio"/>	<input type="radio"/>	<input type="radio"/>	<input checked="" type="radio"/>	<input type="radio"/>	<input checked="" type="radio"/>	<input type="radio"/>
Mantle Type							Front Facing		
Over Mantle							NF-08		
Colour / Stain							/		
Surround							White		
Hearth							/		
Comment							/		

RECEIVED

OCT 06 2022

SEE ATTACHED FOR SIGNATURES

Initial:





Purchaser: RAGHAV KUMAR

Property: 140 of Plan - Draft Approval SB17-03-08

Telephone Res. / Bus: /

Project: KINGSMEN (THAMES) INC.

Decor Advisor: Barbara Coccia

Model and Elevation: James (3601) Elev A4 Bed - 2+1 Bath

### 6. Trim Carpentry

Door Hardware Standard Handle

Interior Trim Standard

Comment

/

#### Interior Doors

☐ 2 Panel Arch Top

☒ 2 Panel Square Top

☐ 6 Panel

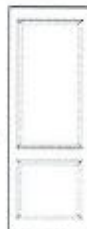

Initial for Door Style

### 7. Railings and Pickets

Railing Package Standard Oak STRAIGHT picket package

Railing Colour Elements Oak Natural

Picket Colour Elements Oak Natural

Wood Stairs ☐ No ☒ Oak

Tread Colour Elements Oak Natural

Comment

/

### 8. Plaster Mouldings and Medallions

Foyer

Main Hall

Living Room

Dining Room

Family Room

Kitchen/Breakfast

Den/Library

Lower Landing

Comment

/

### 9. Wall Paint

Kingsmen White

#### Smooth Ceilings

☐ First Floor

☐ First Floor incl. Second Floor Hall

☐ First and Second Floor

☒ Throughout

☐ Not Applicable

Trim Paint Kingsmen White

### 10. Additional Comments

/



### 11. Disclaimers and Notes

- Colours of all materials are as close as possible to builder's selection, but not necessarily identical due to variances in manufacturing.
- Any extras listed above are null and void unless accompanied by a separate invoice/amendment. Said invoice must be paid in full.
- The Purchaser acknowledges that after Interior Colour Selection form is signed and dated, no further changes will be permitted other than re-selection due to unavailability. Purchaser's Initials
- The Purchaser acknowledges reading and accepting the "Kingsmen Group Decor Centre Disclaimers" form. This document contains other miscellaneous disclaimers.

SEE ATTACHED FOR SIGNATURES

This Interior Colour Selection is final and approved by:

Purchaser:

Signature: Date:

Vendor:

KINGSMEN (THAMES) INC.

06/10/22

SCHEDULE "B-1"  
Floor Plan

Lot 140  
Phase 5A  
Model: James (3601) Elev A 4 Bed - 2+1 Bath  
Standard

Sketch #1

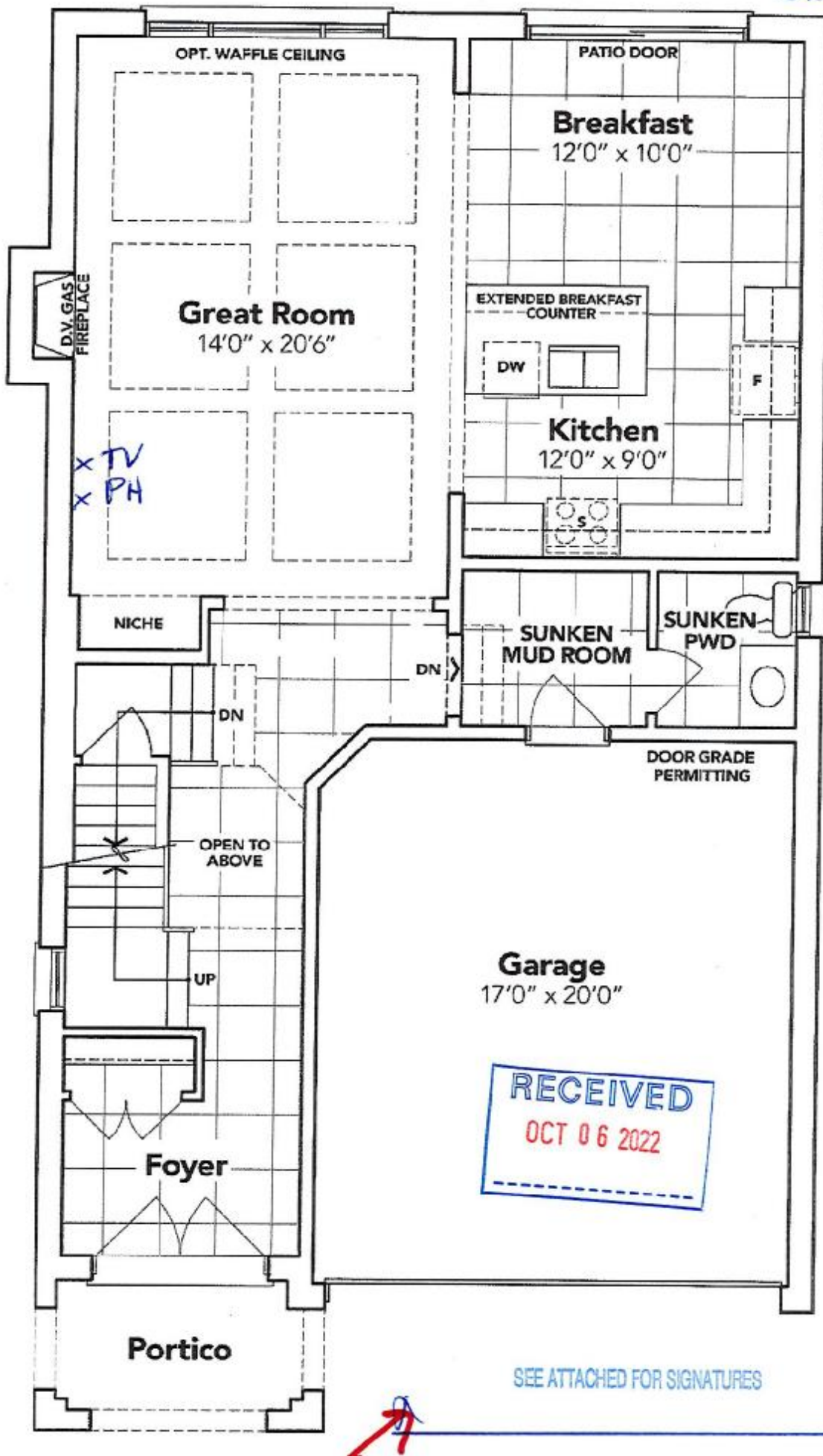

GROUND FLOOR EL. A

The floor plans and elevations shown are pre-construction plans and may be revised or improved as necessitated by architectural controls and the construction process. The measurements adhere to the rules and regulations of the TARIION Warranty Corporation's official method for the calculation of floor area. Materials, specifications and floor plans are subject to change without notice. All house renderings are artist's concept only. Actual usable floor space may vary from the stated floor area. All options shown are upgrades. E. & O. F.



**SCHEDULE "B-1"**  
**Floor Plan**

Lot 140  
Phase 5A  
Model: James (3601) Elev A 4 Bed - 2+1 Bath  
Standard

*Sketch #2*

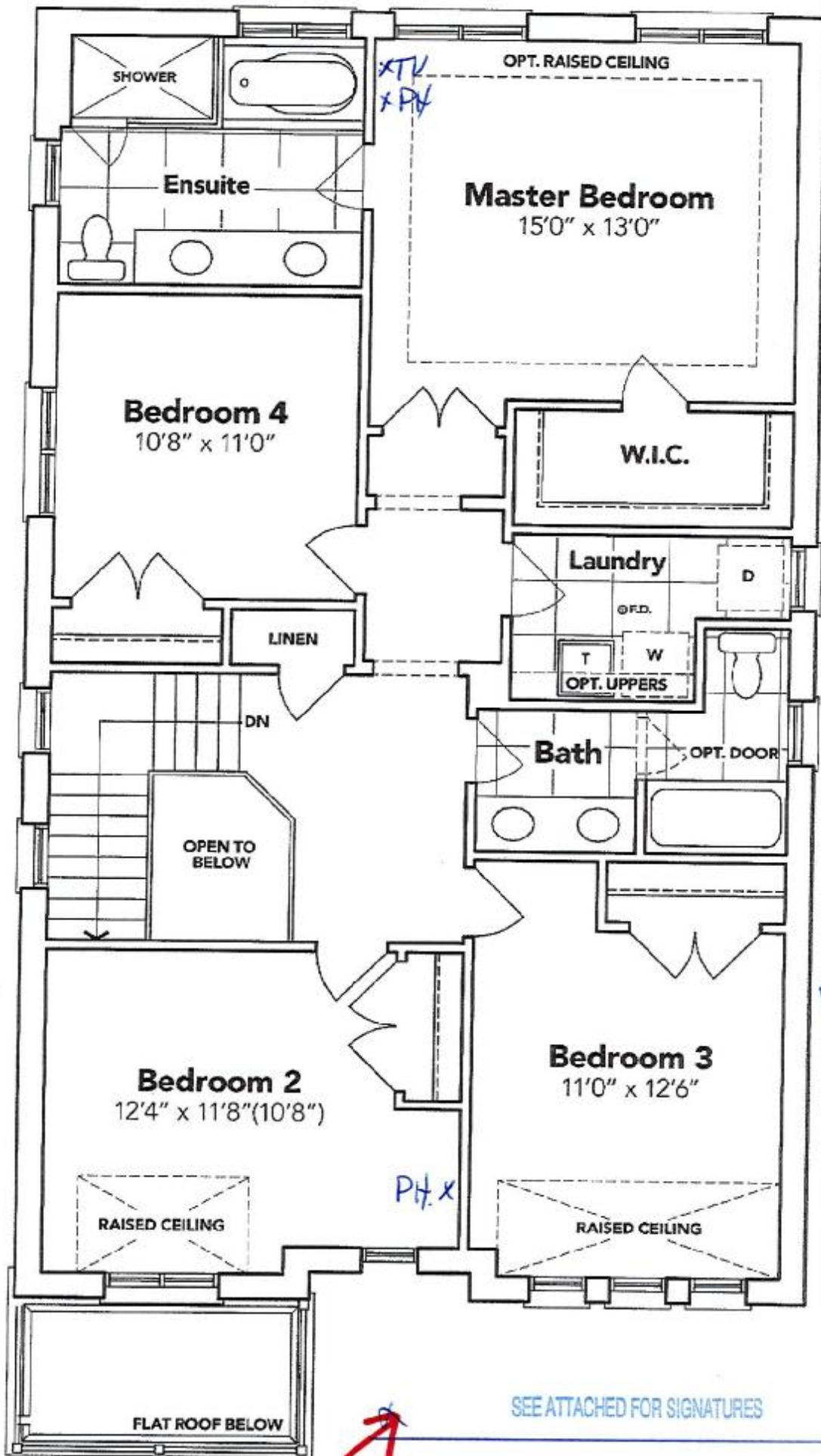

**RECEIVED**  
OCT 06 2022

SEE ATTACHED FOR SIGNATURES

**SECOND FLOOR EL. A**

The floor plans and elevations shown are pre-construction plans and may be revised or improved as necessitated by architectural controls and the construction process. The measurements adhere to the rules and regulations of the TARION Warranty Corporation's official method for the calculation of floor area. Materials, specifications and floor plans are subject to change without notice. All house renderings are artist's concept only. Actual usable floor space may vary from the stated floor area. All options shown are upgrades. E. & O. E.

**SCHEDULE "B-1"**  
**Floor Plan**

Lot 140  
Phase 5A  
Model: James (3601) Elev A 4 Bed - 2+1 Bath  
Standard

*sketch#3*

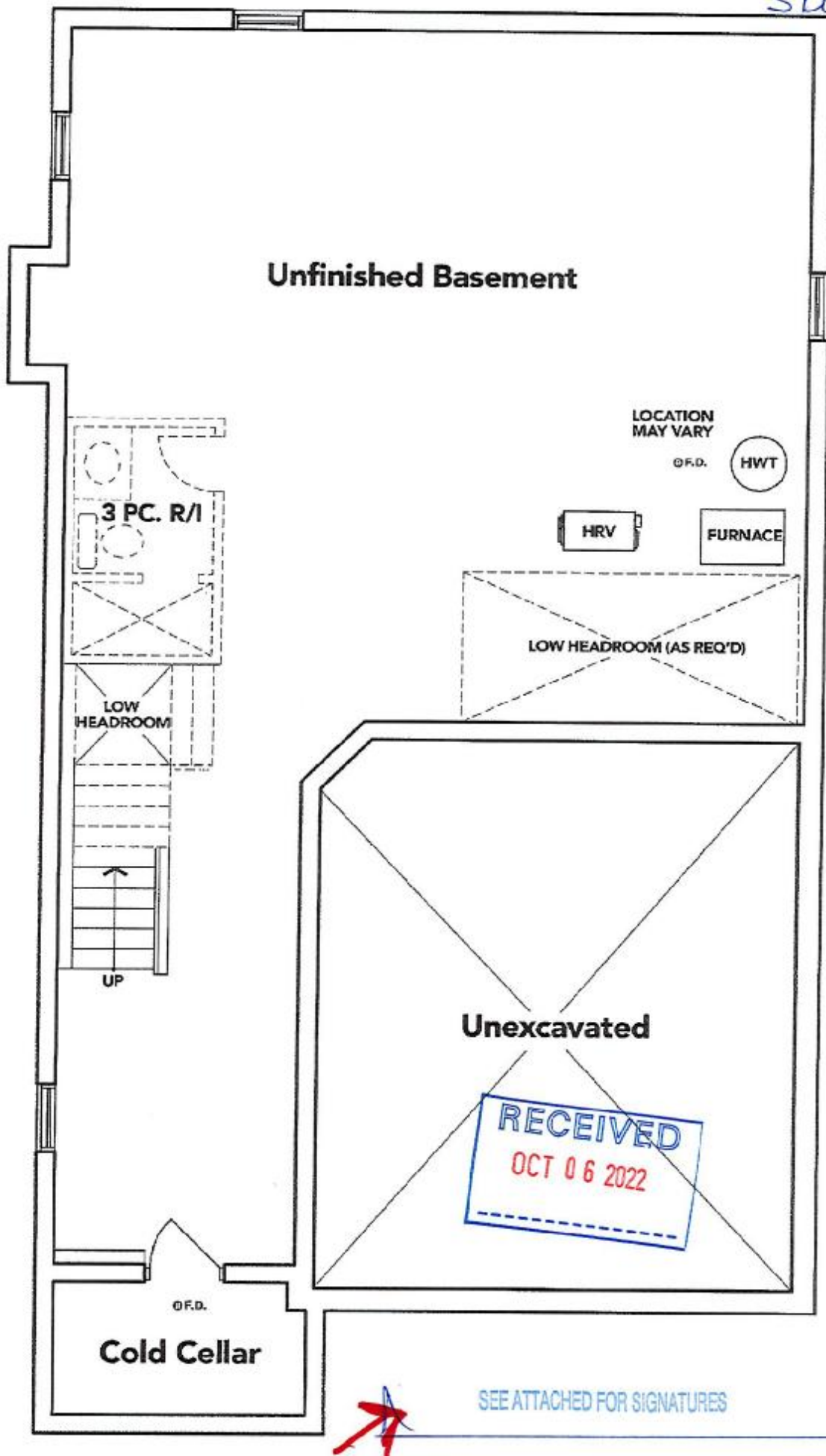

**BASEMENT EL. A**

The floor plans and elevations shown are pre-construction plans and may be revised or improved as necessitated by architectural controls and the construction process. The measurements adhere to the rules and regulations of the TARIION Warranty Corporation's official method for the calculation of floor area. Materials, specifications and floor plans are subject to change without notice. All house renderings are artist's concept only. Actual usable floor space may vary from the stated floor area. All options shown are upgrades. E. & O. E.