

KINGSMEN (THAMES) INC. / Havelock Corners (Kingsmen)

Lot/Unit: 129 Phase/Building: 5A Model/Floor Plan: James (3601) Elev A 4 Bed - 2+1 Bath

CABINETRY APPLIANCE - FRIDGE

Inv.5889	1 - Relocate the standard fridge opening in the kitchen.. see sketch # 1	
Line 74789	Note:	
30Sep22 / 30Sep22		
Inv.5889	1 - To supply & install the 66CM DEEP FRIDGE ENCLOSURE - COUNTER DEPTH WITH - 1 WALL - 1 66CM DEEP GABLE AND 1 66CM DEEP CABINET - THIS IS NOT A ZERO CLEARANCE ENCLOSURE. STANDARD HEIGHTS AND WIDTHS WILL BE USED. - in the kitchen..see sketch# 1	
Line 74790	Note:	
30Sep22 / 30Sep22		

CABINETRY MICROWAVE OVEN STOVE COOKTOP

Inv.5889	1 - To supply & install the COOKTOP CABINET WITH FALSE TOP DRAWER AND POTS AND PANS DRAWERS BELOW - SUPPLY SPECS in the kitchen... see sketch # 1	
Line 74775	Note:	
30Sep22 / 30Sep22		
Inv.5889	1 - To supply & install accomodations for the future BUILT-IN TALL APPLIANCE CABINET WITH DRAWER - S BELOW FOR PANEL-MOUNT - PROUD - OR TRIM KIT INSTALLATIONS - TRIM KIT REQUIRED - SUPPLY ALL SPECS AND INSTALLATION GUIDES - COUNTER DEPTH in the kitchen...	
Line 74776	Note: See sketch # 1	
30Sep22 / 30Sep22		NO FLUSH MOUNT ACCOMODATIONS.

CABINETRY VANITY

Inv.5889	2 - To supply & install ONE VANITY TOP DRAWER in the master ensuite AND ONE VANITY TOP DRAWER IN THE MAIN BATHROOM... see sketch # 2	
Line 74780	Note:	
30Sep22 / 30Sep22		

CABINETRY WALL AND HUTCH

Inv.5889	1 - To supply & install an UPPER ANGLE CORNER PER UNIT - in the ktichen... see sketch # 1	
Line 74779	Note:	
30Sep22 / 30Sep22		

COUNTER TOP

Inv.5889	1 - To supply & install accomodations to quartz countertop for the future 30" cook top in the kitchen... see sketch # 1 ... see spec's	
Line 74774	Note:	
30Sep22 / 30Sep22		
Inv.5889	1 - As per schedule "PE": Vendor to include level 1, 2cm. quartz in kitchen and all bathrooms, as per plan, in lieu of the included laminate counter tops. Selections to be made from builders standard samples.	
Line 74699	Note:	
30Sep22 / 30Sep22		

ELECTRICAL



CONSTRUCTION SUMMARY

KINGSMEN (THAMES) INC. / Havelock Corners (Kingsmen)

Lot/Unit: 129 Phase/Building: 5A Model/Floor Plan: James (3601) Elev A 4 Bed - 2+1 Bath

Inv.5889	1 - To supply & install the standard T.V. rough in in the great room and master bedroom... see sketch # 1 & # 2	
Line 74700	Note: Install the standard T.V. rough in at approx. 66" + - up from the floor centered + - to the F/P mantle.	
30Sep22 / 30Sep22		
Inv.5889	1 - To supply & install the standard Phone (CAT 5) rough in in the great room, master bedroom & bedroom # 2 ... see sketch # 1 & # 2	
Line 74701	Note: Install the standard Phone (CAT 5) rough in at approx. 66" + - up from the floor centered + - to the F/P mantle.	
30Sep22 / 30Sep22		
Inv.5889	1 - To SUPPLY AND INSTALL AN ADDITIONAL BASIC RECEPTACLE (NOT DEDICATED) at approx. 66" + - up from the floor centered + - to the F/P mantle	
Line 74765	Note: in the great room... see sketch # 1	
30Sep22 / 30Sep22 This is for a future wall mount T.V.		
Inv.5889	1 - To SUPPLY AND INSTALL CONDUIT FOR TV OVER THE FIREPLACE at approx. 66" + - up from the floor centered + - to the F/P mantle in the great room and TERMINATED TO BASEMENT CEILING	
Line 74766	Note:	
30Sep22 / 30Sep22		
Inv.5889	1 - To SUPPLY AND INSTALL EXTRA CEILING BOX ROUGH IN CAPPED (DOES NOT INCLUDE SWITCH) over the island in the kitchen... see sketch # 1	
Line 74768	Note: This capped elec. will be connected to a sep. switch, switch is sold sep.	
30Sep22 / 30Sep22		
Inv.5889	1 - To supply & install AN ADDITIONAL SINGLE POLE SWITCH connected to the upgraded capped elec. over the island in the kitchen.	
Line 74769	Note:	
30Sep22 / 30Sep22		
Inv.5889	1 - Relocate the standard ceiling light from the upper stair landing to the O.T.B. area on the second floor...see sketch # 2	
Line 74770	Note:	
30Sep22 / 30Sep22		
Inv.5889	1 - To SUPPLY AND INSTALL EXTRA 240 STOVE PLUG for the future built in wall oven/microwave combo in the kitchen.	
Line 74777	Note:	
30Sep22 / 30Sep22		

HEATING AND AIR CONDITIONING

Inv.5889	1 - To supply & install a capped gas line (rough in only) at stove location in the kitchen with the 110V elec. outlet, code requirement	
Line 74773	Note:	
30Sep22 / 30Sep22		
Inv.5889	1 - As per schedule "PE": Vendor to install capped gas line (rough in only) at rear of houme for future BBQ location. Location to be finalized at vendors sole discretion.	
Line 74697	Note:	
30Sep22 / 30Sep22		
Inv.5889	1 - As per schedule "PE": Vendor to supply & install air conditioning unit, sized accordingly, from vendors standard samples.	
Line 74698	Note:	
30Sep22 / 30Sep22		

KINGSMEN (THAMES) INC. / Havelock Corners (Kingsmen)

Lot/Unit: 129 Phase/Building: 5A Model/Floor Plan: James (3601) Elev A 4 Bed - 2+1 Bath

PLUMBING

Inv.5889	5 - To supply & install the VANITY SINK - CONTRAC CATENA UNDERMOUNT - MODEL 4210CIY in the powder room, master ensuite and main bathroom in lieu of the standard top mount vanity sinks... see spec's	
Line 74771	Note: Still to install the standard lav. faucets.	
30Sep22 / 30Sep22		
Inv.5889	1 - To supply & install the KITCHEN SINK - BLANCO QUATRUS U1 SUPER SINGLE UNDERMOUNT- MODEL 401248 in the kitchen in lieu of the standard top mount kitchen sink...see spec's	
Line 74772	Note: Still to install the std. single hole kitchen faucet NO PLATE.	
30Sep22 / 30Sep22		

TILE - FLOOR

Inv.5889	1 - To supply & install the UPGRADE 4 - FLOOR TILE - STACKED - FOYER TILE in lieu of the standard floor tile... see colour chart for details.	
Line 74781	Note:	
30Sep22 / 30Sep22		
Inv.5889	1 - To supply & install the UPGRADE 4 - FLOOR TILE - STACKED - MAIN FLOOR HALLWAY TILE in lieu of the standard floor tile... see colour chart for details.	
Line 74782	Note:	
30Sep22 / 30Sep22		
Inv.5889	1 - To supply & install the UPGRADE 4 - FLOOR TILE - STACKED - POWDER ROOM FLOOR TILE in lieu of the standard floor tile... see colour chart for details.	
Line 74783	Note:	
30Sep22 / 30Sep22		
Inv.5889	1 - To supply & install the UPGRADE 4 - FLOOR TILE - STACKED - MUD ROOM FLOOR TILE in lieu of the standard floor tile... see colour chart for details.	
Line 74784	Note:	
30Sep22 / 30Sep22		
Inv.5889	1 - To supply & install the UPGRADE 4 - FLOOR TILE - STACKED - KITCHEN/BREAKFAST ROOM FLOOR TILE in lieu of the standard floor tile... see colour chart for details.	
Line 74787	Note:	
30Sep22 / 30Sep22		
Inv.5889	1 - To supply & install the UPGRADE 1 - SHOWER FLOOR TILE - - ENSUITE SHOWER FLOOR TILE in lieu of the standard shower floor tiles... see colour chart for details.	
Line 74788	Note:	
30Sep22 / 30Sep22		



CONSTRUCTION SUMMARY

KINGSMEN (THAMES) INC. / Havelock Corners (Kingsmen)

Lot/Unit: 129 Phase/Building: 5A Model/Floor Plan: James (3601) Elev A 4 Bed - 2+1 Bath

EXTRAS AS PER OFFER

5 FREE APPLIANCES ? STAINLESS STEEL FRONT - FRIDGE: STOVE AND DISHWASHER. WHITE WASHER AND DRYER (SUPPLIED ONLY, NOT INSTALLED, FROM BUILDERS STANDARD LINE). AN APPLIANCES VOUCHER WILL BE GIVEN BY OUR DECOR CONSULTANT AT THE TIME OF BOOKING YOUR COLOUR A <i>Worksheet</i> Note:	
5 FREE APPLIANCES – STAINLESS STEEL FRONT - FRIDGE: STOVE AND DISHWASHER. WHITE WASHER AND DRYER (SUPPLIED ONLY, NOT INSTALLED, FROM BUILDERS STANDARD LINE). AN APPLIANCES VOUCHER WILL BE GIVEN BY OUR DECOR CONSULTANT AT THE TIME OF BOOKING YOUR COLOUR A <i>Worksheet</i> Note:	
VENDOR TO INSTALL CAPPED GAS LINE (ROUGH-IN ONLY) AT REAR OF HOME FOR FUTURE BBQ LOCATION. LOCATION TO BE FINALIZED AT VENDORS SOLE DISCRETION. <i>Worksheet</i> Note:	
VENDOR TO SUPPLY & INSTALL AIR CONDITIONING UNIT, SIZED ACCORDINGLY, FROM VENDORS STANDARD SAMPLES. <i>Worksheet</i> Note:	
VENDOR TO INCLUDE LEVEL 1, 2CM QUARTZ IN KITCHEN AND ALL BATHROOMS, AS PER PLAN, IN LIEU OF THE INCLUDED LAMINATE COUNTER TOPS. SELECTIONS TO BE MADE FROM BUILDERS STANDARD SAMPLES. <i>Worksheet</i> Note:	

Purchaser: PARAMVEER SINGH UPPAL
Telephone Res. / Bus: /
Decor Advisor: Barbara Coccia
Property: 129 of Plan - Draft Approval SB17-03-08
Project: KINGSMEN (THAMES) INC.
Model and Elevation: James (3601) Elev A 4 Bed - 2+1 Bath
Layout Changes: Yes No
Sketch Attached: Yes No
Exterior Colour Scheme:

1. Cabinetry
Table with 4 columns: Room, Style and Colour, Counter Top, Hardware. Rows include Kitchen / Breakfast, Kitchen Island, Laundry Room, Powder Room, Main Bathroom, Master Ensuite Bathroom, Second Ensuite Bathroom (If Applicable).

Appliances
Custom Size Fridge: Yes No
Valance Lighting: Yes No
Microwave / Range Hood: Yes No
Cooktop / Rangetop: Yes No
Built in Wall Oven: Yes No
Slide-in Range: Yes No
Comment:

2. Flooring

Table with 2 columns: Room, Selection. Rows include Foyer, Main Hall, Back Hall, Breakfast, Laundry Room, Kitchen, Powder Room, Main Bathroom, Master Ensuite, Bathroom (If Applicable), Mud Room, Master ens. shower floor, Living Room, Dining Room, Family / Great Room, Den / Library / Study, Basement Landing (If Applies), Lower Landing (If Applicable), Upper Landing, Upper Hall, Master Bedroom, Bedroom #2, Bedroom #3, Bedroom #4, Bedroom #5, Master ens. shower jamb.



Purchaser:PARAMVEER SINGH UPPAL

Telephone Res. / Bus: /

Decor Advisor:Barbara Coccia

2. Flooring - Continued -

Property: 129 of Plan - Draft Approval SB17-03-08

Project: KINGSMEN (THAMES) INC.



Model and Elevation: James (3601) Elev A 4 Bed - 2+1 Bath

Upgrade Underpad	Type	Area
	Standard	2nd. Floor
Carpet on Stairs	Capped	Runner - *Upgrade
Comment	/	/

3. Plumbing Fixtures / Faucets

Kitchen	Standard	Second Ensuite	/	Powder Room	Standard
Master Ensuite	Standard			Other Room	/
Main Bathroom	Standard		/		
Comment	Purchaser has upgraded to an under mount kitchen sink, still to install the standard single hole kitchen faucet, NO PLATE. Purchaser has upgraded to under mount sinks in ALL bathrooms, still to install the standard lav. faucets.				

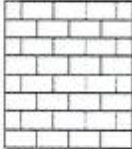
4. Wall Tile

	Tile Selection	Listello	Insert	Insert Selection
Main Bathroom	8x10" Malena Ice	<input type="checkbox"/>	<input type="checkbox"/>	
Master Ensuite				
Tub Deck	13 x13 " Malena Ice	<input type="checkbox"/>	<input type="checkbox"/>	
Tub Apron	13 x13 " Malena Ice	<input type="checkbox"/>	<input type="checkbox"/>	
Tub Surround	13 x13 " Malena Ice	<input type="checkbox"/>		
Shower Stall	8x10" Malena Carbon	<input type="checkbox"/>	<input type="checkbox"/>	
Second Ensuite	/	<input type="checkbox"/>	<input type="checkbox"/>	
	/	<input type="checkbox"/>	<input type="checkbox"/>	
	/	<input type="checkbox"/>	<input type="checkbox"/>	
Kitchen Backsplash	/	<input type="checkbox"/>	<input type="checkbox"/>	
Complete Backsplash	/	<input type="checkbox"/>	<input type="checkbox"/>	
Comment	<div><div> horizontal stacked</div><div> brick pattern</div><div> vertical stacked</div><div> diagonal/diamond</div></div>			

5. Fireplace

	Living Room			Family Room			Other Room - Specify Great Room		
	Purchased	As Per Plan	N/A	Purchased	As Per Plan	N/A	Purchased	As Per Plan	N/A
Fireplace Type	<input type="radio"/>	<input type="radio"/>	<input checked="" type="radio"/>	<input type="radio"/>	<input type="radio"/>	<input checked="" type="radio"/>	<input type="radio"/>	<input checked="" type="radio"/>	<input type="radio"/>
Mantle Type							Front Facing		
Over Mantle							NF-08		
Colour / Stain							/		
Surround							White		
Hearth							/		
Comment	/						/		

RECEIVED
OCT 03 2022



Purchaser: PARAMVEER SINGH UPPAL

Property: 129 of Plan - Draft Approval SB17-03-08

Telephone Res. / Bus: /

Project: KINGSMEN (THAMES) INC.

Decor Advisor: Barbara Coccia

Model and Elevation: James (3601) Elev A 4 Bed - 2+1 Bath

6. Trim Carpentry

Door Hardware Standard handle

Interior Trim Standard

Comment

/

Interior Doors

☐ 2 Panel Arch Top

☒ 2 Panel Square Top

☐ 6 Panel



Initial for Door Style

PSU

7. Railings and Pickets

Railing Package Standard oak STRAIGHT picket package

Railing Colour Elements natural

Picket Colour Elements natural

Wood Stairs ☐ No ☒ Oak

Tread Colour Elements natural

Comment

/

8. Plaster Mouldings and Medallions

Foyer /

Kitchen/Breakfast /

Main Hall /

Den/Library /

Living Room /

Lower Landing /

Dining Room /

Family Room /

Comment

/

9. Wall Paint

Kingsmen White

Smooth Ceilings ☐ First Floor

☐ First Floor incl. Second Floor Hall

☐ First and Second Floor

☒ Throughout

☐ Not Applicable

Trim Paint Kingsmen White

10. Additional Comments

/

RECEIVED

OCT 03 2022

11. Disclaimers and Notes

- Colours of all materials are as close as possible to builder's selection, but not necessarily identical due to variances in manufacturing.
- Any extras listed above are null and void unless accompanied by a separate invoice/amendment. Said invoice must be paid in full.
- The Purchaser acknowledges that after Interior Colour Selection form is signed and dated, no further changes will be permitted other than re-selection due to unavailability. PSU Purchaser's Initials
- The Purchaser acknowledges reading and accepting the "Kingsmen Group Décor Centre Disclaimers" form. This document contains other miscellaneous disclaimers.

This Interior Colour Selection is final and approved by:

Purchaser: Paramveer Singh Uppal Date: 9/30/2022

Signature: Paramveer Singh Uppal

Vendor:

KINGSMEN (THAMES) INC.

Oct 3/22

SCHEDULE "B-1"
Floor Plan

Lot 1:
Phase 1
Model: James (3601) Elev A 4 Bed - 2+1 Ba
Standar

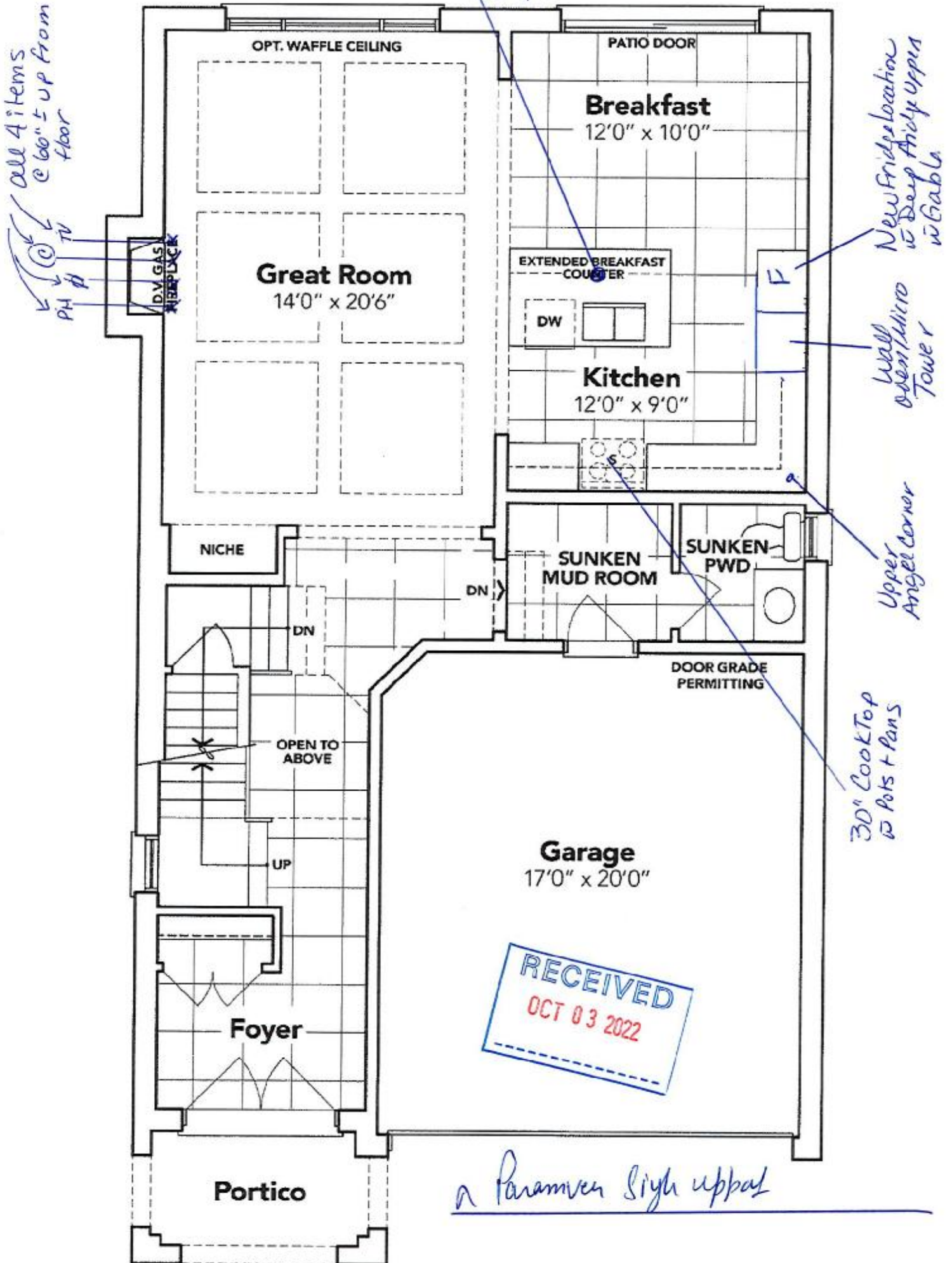

GROUND FLOOR EL. A

The floor plans and elevations shown are pre-construction plans and may be revised or improved as necessitated by architectural controls and the construction process. The measurements adhere to the rules and regulations of the TARIION Warranty Corporation's official method for the calculation of floor area. Materials, specifications and floor plans are subject to change without notice. All house renderings are artist's concept only. Actual usable floor space may vary from the stated floor area. All options shown are upgrades. E. & O. E.

Lot 12
Phase 5
Model: James (3601) Elev A 4 Bed - 2+1 Bat
Standar

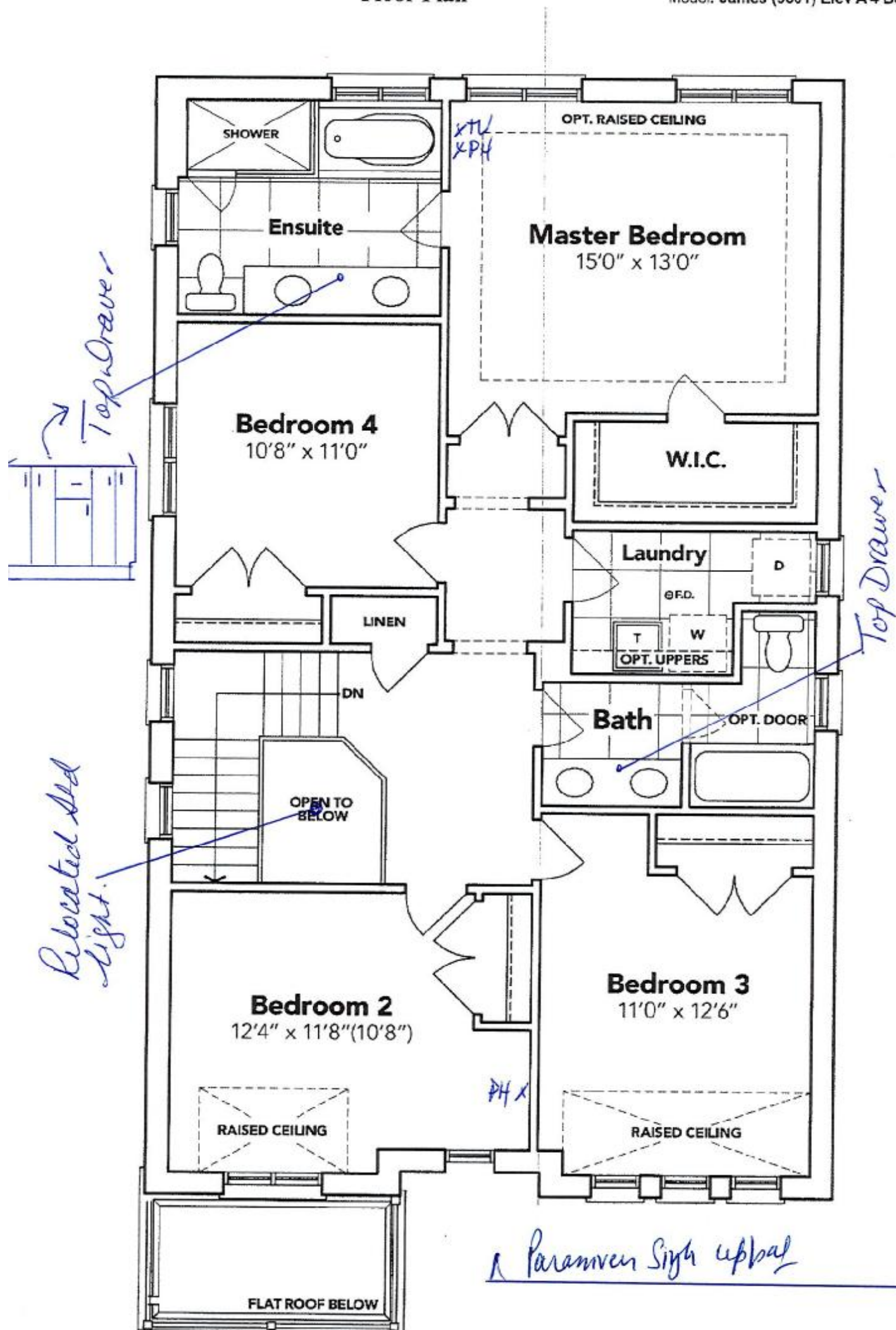

The floor plans and elevations shown are pre-construction plans and may be revised or improved as necessitated by architectural controls and the construction process. The measurements adhere to the rules and regulations of the TARION Warranty Corporation's official method for the calculation of floor area. Materials, specifications and floor plans are subject to change without notice. All house renderings are artist's concept only. Actual usable floor space may vary from the stated floor area. All options shown are upgrades.

Initials: *YJ*

SCHEDULE "B-1"
Floor Plan

Lot 1:
Phase 1
Model: James (3601) Elev A 4 Bed - 2+1 Ba
Standar

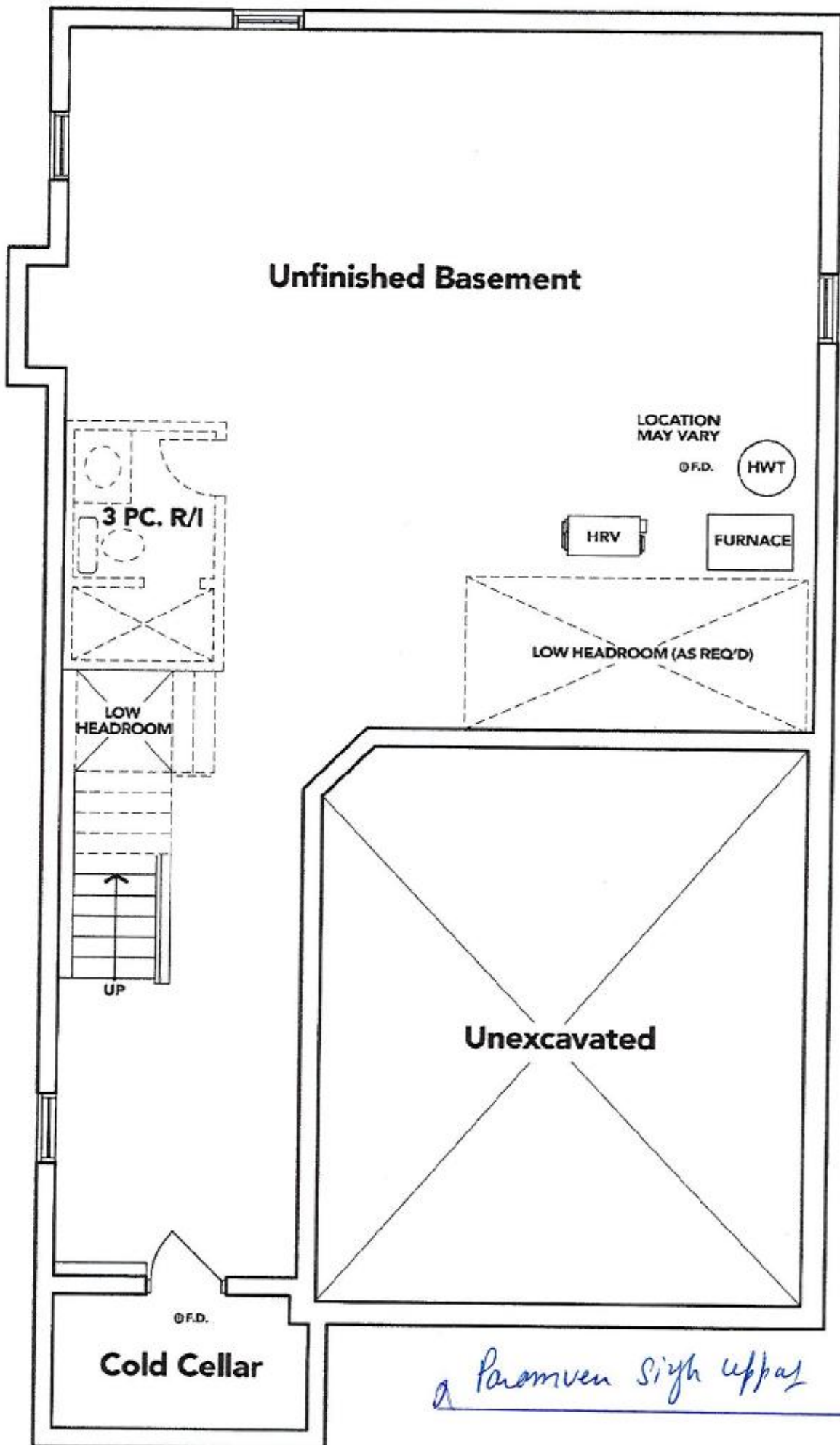

BASEMENT EL. A

The floor plans and elevations shown are pre-construction plans and may be revised or improved as necessitated by architectural controls and the construction process. The measurements adhere to the rules and regulations of the TARION Warranty Corporation's official method for the calculation of floor area. Materials, specifications and floor plans are subject to change without notice. All house renderings are artist's concept only. Actual usable floor space may vary from the stated floor area. All options shown are upgrades. E. & O. E.

BLANCO

Sink Specifications

Colour SKU
brushed finish 401248

Design and planning tips

- Min cabinet size: 36 in (915 mm)
- Bowl Depth: 9 in (230.0 mm)

Specifications:

Installation clips, Sink template, Installation instructions, 3 1/2" (90 mm) stainless steel strainer

Depending on cabinet construction, a different cabinet size may be required. Consult the cabinet manufacturer.

Codes/Standards: ASME A112.19.3-2017/ CSA B45.4-17

QUATRUS U 1 SUPER SINGLE

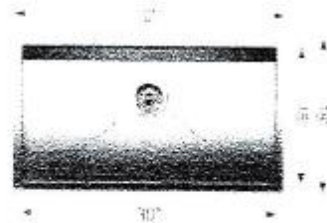

x Paraman Singh uppal

LOT 129 THAMES PH. 5 A
RE: UPG. UNDER MOUNT VANITY SINKS
IN **ALL** BATHROOMS

CATENA

RECTANGULAR UNDERMOUNT SINK

4210CIY Undermount Sink

PRODUCT SPECS:

- Vitreous enamel
- Fixed overflow hole
- Template and mounting hardware supplied

DIMENSIONS:

Outer:

510mm W x 390mm D x 190mm H

20" W x 15 1/2" D x 7 1/2" H

Inner:

450mm W x 340mm D x 140mm H

18" W x 13 1/4" D x 5 1/2" H

COMPLIANCE CERTIFICATIONS

Meets or exceeds the following:

- IAPMO CUPC
- ASME A112.9.2 / CSA B45.1
- IBC Section 3.8 Barrier Free design and CSA B651 Standard

SHIPPING

Cube 1.72

GW 22 lbs

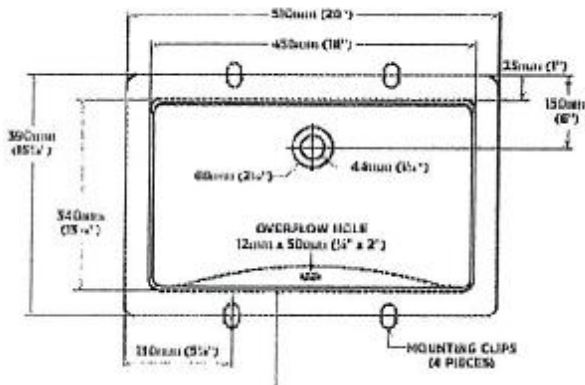

TO BE SPECIFIED

- 1" x 1"
- Soft VIT-10

NOTES: Dimensions of Catena are given in millimeters only. Values in inches are approximate and may vary by 1/8\"/>

Product is designed to comply with CSA B45.1 Barrier Free and IBC Section 3.8 Barrier Free design. Product is for use in residential and commercial applications. Product is not for use in public buildings. Product is not for use in public buildings. Product is not for use in public buildings.



Paramveer Singh Leppal

LOT 129 THAMES PH. 5 A
RE: FRIDGE SPEC'S
NO ROUGH IN WATER LINE HAS BEEN
PURCHASED.

Prepared by
Arshdeep Singh
arshdeepsg2011@gmail.com (437) 779-5400



23.8 cu. ft. 36" Counter-Depth French Door
Platinum Interior Refrigerator with PrintShield™
Finish

KRFC704FPS

Available Finishes/Colours

 KRFC704FBS
Black Stainless Steel with PrintShield™ Finish

 KRFC704FPS
Stainless Steel with PrintShield™ #0482 Finish

Dimensions	
Depth	31 1/2
Height	71 7/8
Width	35 13/16

Compatibility	
Works With	No

Controls	
Control Type	Electronic
Air Filter Indicator/Reset	Yes
Automatic Defrost	Yes
LCD Touch Screen	No
Control Location	Exterior Dispenser, Side Door

AHAM Volumes And Shelf Area	
Freezer Volume (Cu Ft)	5.30
Refrigerator Volume (Cu Ft)	17.50





Details	
Advance Foam Insulation	99.9% lower Global Warming Potential and Better Energy Performance
Cooling Type	Dual Evaporator
Counter Depth	Yes

Door Ajar/Open Alarm	Yes
Control Lockout	Yes
Max Cool/Fast Cool	Yes
Water Filter Indicator/Reset	Yes

Compatibility	
Connectivity	No

The largest capacity counter-depth refrigerator in its class features PrintShield™ finish to resist fingerprints outside and flexible storage options inside. A slide-away shelf retracts to fit tall items, and full-extension self-close crispers and custom temperature pantry let you store more and find it easily. Plus, the Preserva® Food Care System with Linear Compressor helps keep it all at the peak of freshness.

- Top Features
- Preserva® Food Care System with Linear Compressor
- Under-Shelf Prep Zone
- Slide-Away Shelf

- Manuals & Literature:
-  [Dimension Guide](#)  [Energy Guide](#)
-  [Use and Care Guide](#)  [Warranty Information](#)

x Paramveer Singh Upthal

KitchenAid®

Because Whirlpool Corporation policy includes a continuous commitment to improve our products, we reserve the right to change materials and specifications without notice. Dimensions are for planning purposes only. For complete details, see Installation Instructions packed with product. Specifications subject to change without notice.

LOT 129 THAMES PH. 5 A
RE: FRIDGE SPEC'S CON'T
NO ROUGH IN WATER LINE HAS BEEN
PURCHASED.

KitchenAid

French Door Bottom Mount Refrigerator with Ice Dispenser
(KRFC704F, KRFC604F)

PRODUCT DIMENSIONS

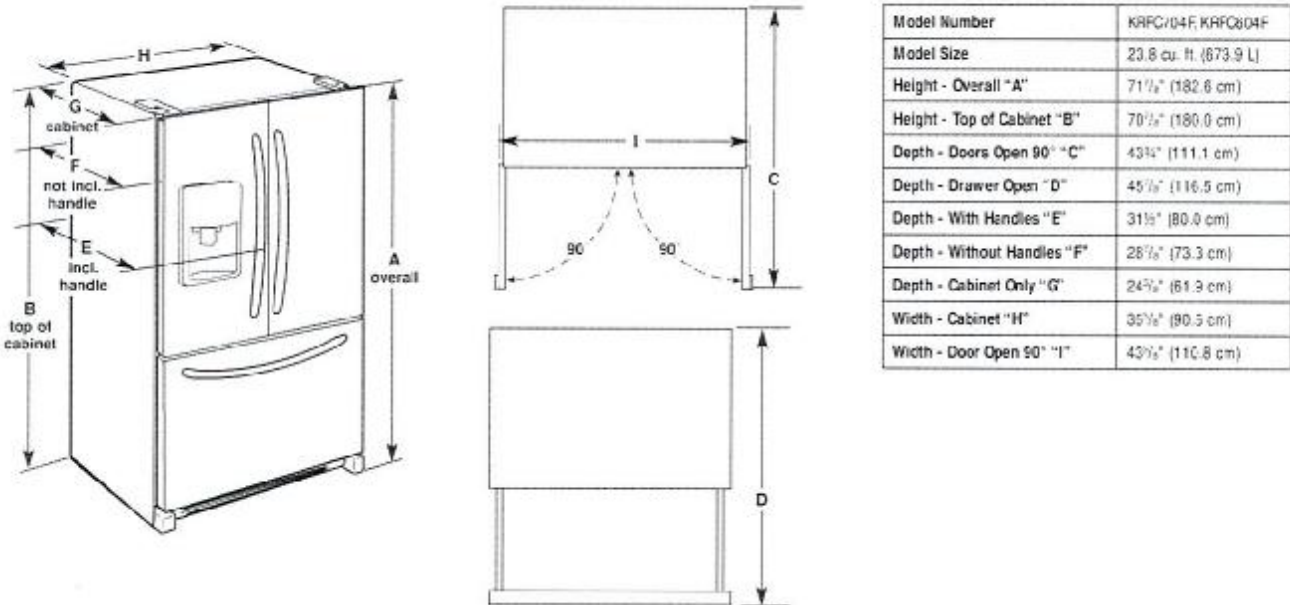

⚠ WARNING

Electrical Shock Hazard
Plug into a grounded 3 prong outlet.
Do not remove ground prong.
Do not use an adapter.
Do not use an extension cord.
Failure to follow these instructions can result in death, fire, or electrical shock.

A Paramen Sush up by

Electrical: A 115 V, 60 Hz., AC only, 15 or 20 A fused, grounded electrical supply is required. It is recommended that a separate circuit serving only your freezer be provided. Use an outlet that cannot be turned off by a switch. Do not use an extension cord.

Water: A cold water supply with water pressure between 35 and 120 psi (241 and 827 kPa) is required to operate the water dispenser and ice maker. If you have questions about your water pressure, call a licensed, qualified plumber.

NOTE: If the water pressure is less than what is required, the flow of water from the water dispenser could decrease or ice cubes could be hollow or irregular shaped.

Reverse Osmosis Water Supply

IMPORTANT: The pressure of the water supply coming out of a reverse osmosis system going to the water inlet valve of the refrigerator needs to be between 35 and 120 psi (241 and 827 kPa).

If a reverse osmosis water filtration system is connected to your home cold water supply, the water pressure to the reverse osmosis system needs to be a minimum of 40 to 60 psi (276 to 414 kPa).

LOT 129 THAMES PH. 5 A
RE: FRIDGE SPEC'S CONT
NO ROUGH IN WATER LINE HAS BEEN
PURCHASED.

KitchenAid® French Door Bottom Mount Refrigerator with Ice Dispenser

LOCATION REQUIREMENTS

⚠ WARNING



Explosion Hazard

Keep flammable materials and vapors, such as gasoline, away from refrigerator.

Failure to do so can result in death, explosion, or fire.

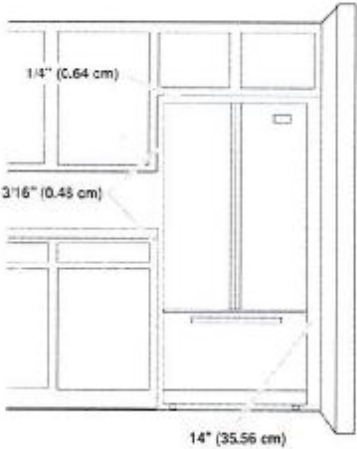

IMPORTANT: This refrigerator is designed for indoor and household use only.

To ensure proper ventilation for your refrigerator, allow for a 3/16" (0.48 cm) of space on each side and 1/4" (0.64 cm) space at the top. Allow for a 1" (2.54 cm) space behind the refrigerator. If your refrigerator has an ice maker, allow extra space at the back for the water line connections. When installing your refrigerator next to a fixed wall, leave a 14" (35.56 cm) minimum space between the refrigerator and wall to allow the door to swing open.

NOTE: This refrigerator is intended for use in a location where the temperature ranges from a minimum of 55°F (13°C) to a maximum of 110°F (43°C). The preferred room temperature range for optimum performance, which reduces electricity usage and provides superior cooling, is between 60°F (15°C) and 90°F (32°C). It is recommended that you do not install the refrigerator near a heat source, such as an oven or radiator.

α Paramon Sign uppld

Prepared by
Arshdeep Singh
arshdeepsg2011@gmail.com (437) 779-5400



30" Combination Wall Oven with Even-Heat™ True Convection (Lower Oven)

KOCE500ESS

Available Finishes/Colours

-  KOCE500EBL Black
-  KOCE500EWH White

KOCE500ESS
Stainless Steel

Dimensions	
Depth	27 1/8
Height	42 1/2
Width	30





Controls	
Control Type	Glass Touch Digital Display
Electronic Display Type	Digital

Exterior	
Door Removable	Yes
Door Release	Handle
Door Lock	Yes
Door Type	Metal & Glass
Flush Installation Approved	Yes
Oven Window Size	Extra Large
Handle Color	Stainless Steel
Handle Material	Metal

GDS	
isBaseUnit	true
isConsumerUnit	true
IsDispatchUnit	-
IsInvoiceUnit	true
IsOrderableUnit	true
Product Type	EA
UDEX	1100400623
GPC Code	10001950

This 30" Combination Wall Oven with Even-Heat™ True Convection provides consistent heating and even cooking. A unique bow-tie shaped design and convection fan helps ensure there are no burnt edges or under cooked centers. Its upper Microwave Convection Cooking Oven combines a 900 watt microwave with a 1600 watt convection element for high speed cooking. Bold design details are the perfect balance of elegance and functionality.

- Top Features
- Even-Heat™ True Convection Oven (lower oven)
- Microwave Convection Cooking (upper oven)
- Temperature Probe

- Manuals & Literature:
-  Dimension Guide
 -  Installation Guide
 -  Use and Care Guide
 -  Warranty Information

Controls	
Display Color	White

Features	
Sensor Cooking	Yes - Microwave
Language Conversion	English/French

Microwave Details	
Microwave Capacity (cu. ft.)	1.4

Arshdeep Singh Uppal

LOT 129 THAMES PH. 5 A
RE: BUILT IN WALL OVEN/MICRO.COMBO
CON'T
NO FLUSH MOUNT ACCOMDATIONS

KitchenAid® 27" (68.6 cm) and 30" (76.2 cm) Electric Built-In Microwave/Oven Combination

PRODUCT MODEL NUMBERS

KEM309E KOCE500E KOCE507E

ELECTRICAL CONNECTION

If codes permit and a separate ground wire is used, it is recommended that a qualified electrical installer determine that the ground path and the wire gauge are in accordance with local codes. Check with a qualified electrical installer if you are not sure the oven is properly grounded.

This oven must be connected to a grounded metal, permanent wiring system.

Be sure that the electrical connection and wire size are adequate and in conformance with the National Electrical Code, ANSI/NFPA 70-latest edition or CSA Standards C22.1-94, Canadian Electrical Code, Part 1 and C22.2 No. 0-M91-latest edition, and all local codes and ordinances.

To properly install your oven, you must determine the type of electrical connection you will be using and follow the instructions provided for it here.

- Oven must be connected to the proper electrical voltage and frequency as specified on the model/serial/rating plate. See the following illustration.

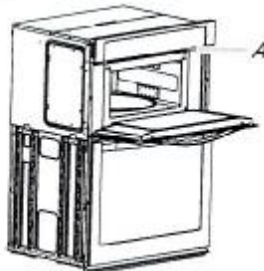

A. Model/serial/rating plate

- Models rated from 7.3 to 9.6 kW at 240 volts (5.4 to 7.4 kW at 208 volts) require a separate 40-amp circuit. Models rated at 4.8 kW and below at 240 volts (3.6 kW and below at 208 volts) require a separate 30-amp circuit.
- A circuit breaker is recommended.
- Connect directly to the fused disconnect (or circuit breaker box) through flexible, armored or nonmetallic sheathed, copper cable (with grounding wire). See "Make Electrical Connection" section.
- Flexible conduit from the oven should be connected directly to the junction box.
- Do not cut the conduit. The length of conduit provided is for serviceability of the oven.
- A UL listed or CSA approved conduit connector must be provided.
- If the house has aluminum wiring, follow the procedure below:
 1. Connect a section of solid copper wire to the pigtail leads.
 2. Connect the aluminum wiring to the added section of copper wire using special connectors and/or tools designed and UL listed for joining copper to aluminum.

Follow the electrical connector manufacturer's recommended procedure. Aluminum/copper connection must conform with local codes and industry accepted wiring practices.

For power requirements, refer to the following table.

Model	Voltage	Amperage (L1)*	Amperage (L2)*	Rating (W)
KOCE507E/KOCE500E	120/240	32	30	8000
KOCE507E/KOCE500E	120/208	30	28	6600

*Amperage values noted above are for information purposes only: the units are rated in watts.

PRODUCT DIMENSIONS

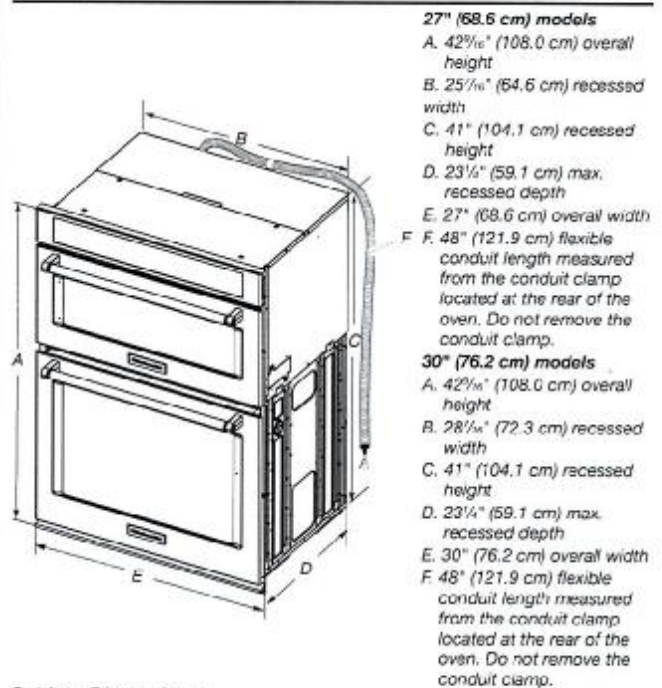

27" (68.6 cm) models

- A. 42⁵/₁₆" (108.0 cm) overall height
- B. 25⁵/₁₆" (64.6 cm) recessed width
- C. 41" (104.1 cm) recessed height
- D. 23¹/₄" (59.1 cm) max. recessed depth
- E. 27" (68.6 cm) overall width
- F. 48" (121.9 cm) flexible conduit length measured from the conduit clamp located at the rear of the oven. Do not remove the conduit clamp.

30" (76.2 cm) models

- A. 42⁵/₁₆" (108.0 cm) overall height
- B. 28⁵/₁₆" (72.3 cm) recessed width
- C. 41" (104.1 cm) recessed height
- D. 23¹/₄" (59.1 cm) max. recessed depth
- E. 30" (76.2 cm) overall width
- F. 48" (121.9 cm) flexible conduit length measured from the conduit clamp located at the rear of the oven. Do not remove the conduit clamp.

Cabinet Dimensions

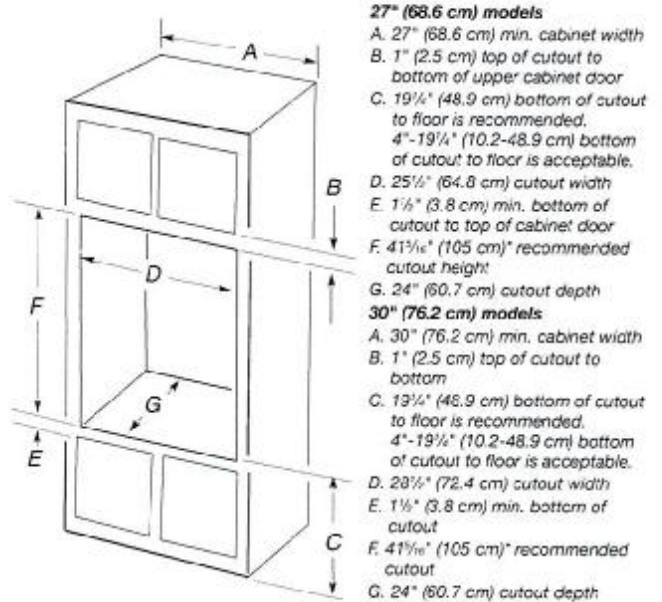

27" (68.6 cm) models

- A. 27" (68.6 cm) min. cabinet width
- B. 1" (2.5 cm) top of cutout to bottom of upper cabinet door
- C. 19¹/₄" (48.9 cm) bottom of cutout to floor is recommended. 4"-19¹/₄" (10.2-48.9 cm) bottom of cutout to floor is acceptable.
- D. 25¹/₂" (64.8 cm) cutout width
- E. 1¹/₂" (3.8 cm) min. bottom of cutout to top of cabinet door
- F. 41⁵/₁₆" (105 cm)* recommended cutout height
- G. 24" (60.7 cm) cutout depth

30" (76.2 cm) models

- A. 30" (76.2 cm) min. cabinet width
- B. 1" (2.5 cm) top of cutout to bottom
- C. 13¹/₄" (48.9 cm) bottom of cutout to floor is recommended. 4"-19¹/₄" (10.2-48.9 cm) bottom of cutout to floor is acceptable.
- D. 28¹/₂" (72.4 cm) cutout width
- E. 1¹/₂" (3.8 cm) min. bottom of cutout
- F. 41⁵/₁₆" (105 cm)* recommended cutout
- G. 24" (60.7 cm) cutout depth

* NOTE: The cabinet height can be between 41" (104.1 cm) and 41¹/₂" (105.6 cm) for microwave/oven combination.

2 Parameter Sign Update

Prepared by
Arshdeep Singh
arshdeepsg2011@gmail.com (437) 779-5400



30" 5-Burner Gas Cooktop with Griddle

KCGS950ESS

Available Finishes/Colours

KCGS950ESS
Stainless Steel

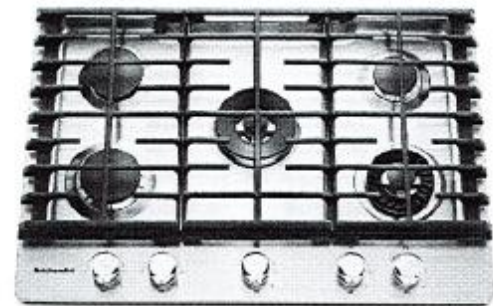

This 30-inch gas cooktop features the exclusive Even-Heat™ Torch Burner with a flame that evenly covers the bottom of cookware to ensure even heating. In addition to the exceptional performance, the cooktop has an enhanced design that includes the CookShield Finish to help protect the cooking surface, and lighted knobs that are a stylish way to let you know the cooktop is on.

Top Features

- 10,000 BTU Even-Heat™ Torch Burner
- 17K BTU Professional Dual Ring Burner
- Removable Griddle Included

Manuals & Literature:

- Dimension Guide
- Installation Guide
- Use and Care Guide
- Warranty Information

Dimensions

Depth	21
Height	3 11/16
Width	30

Controls

Control Location	Front
Control Type	Knobs
Infinite Heat Controls	Yes
Knob Color	Stainless Steel
Knob Type	Metal

Features

Automatic Pan Detection	No
-------------------------	----

Features

Digital Display	No
Downdraft Vent	No
Heating Element On Indicator Light	Yes
Hot Surface Indicator Light	No
Installs Over Built-In Oven	Yes
Griddle	Included
LP Convertible	Yes - Kit Included
Power Boost	No
Power Outage Compatible	Yes
Selection	Automatic Reignition, Lighted Knobs, Simmer

a Paramar Singh uphay

30" (76.2 CM) AND 36" (91.4 CM) GAS BUILT-IN COOKTOP

PRODUCT MODEL NUMBERS

KCGS350E	KCGS950E	MGC9530D	WCG75US0D
KCGS356E	KCGS956E	MGC9536D	WCG97US0D
KCGS550E	MGC7430D	WCG51US0D	WCG97US6D
KCGS556E	MGC7536D	WCG51US6D	

GAS SUPPLY REQUIREMENTS

Type of Gas

Natural Gas:

This cooktop is design-certified by CSA International for use with Natural gas or, after proper conversion, for use with LP gas.

- This cooktop is factory set for use with Natural gas. If converting to LP gas, see the "LP Gas Conversion" instructions provided in the package containing literature. The model/serial rating plate located on the underside of the cooktop base has information on the types of gas that can be used. If the types of gas listed do not include the type of gas available, check with the local gas supplier.

LP Gas Conversion:

Conversion must be done by a qualified service technician.

No attempt shall be made to convert the cooktop from the gas specified on the model/serial rating plate for use with a different gas without consulting the serving gas supplier. See the Gas Conversion instructions provided in the package containing literature.

Gas Supply Line

- Provide a gas supply line of 3/4" (1.9 cm) rigid pipe to the cooktop location. A smaller size pipe on longer runs may result in insufficient gas supply. Pipe-joint compounds that resist the action of LP gas must be used. Do not use TEFLON™ tape. With LP gas, piping or tubing size should be 1/2" minimum. Usually, LP gas suppliers determine the size and materials used in the system.

Flexible metal appliance connector:

- If local codes permit, use a 1/2" or 3/4" I.D. flexible stainless steel tubing gas connector, designed by CSA to connect the cooktop to the rigid gas supply line.



- A 1/2" male pipe thread is needed for connection to the female pipe threads of the inlet to the cooktop pressure regulator.
- Do not kink or damage the flexible metal tubing when moving the cooktop.

- Must include a shutoff valve:
The supply line must be equipped with a manual shutoff valve. This valve should be located in the same room but external to the cooktop opening, such as an adjacent cabinet. It must be accessible without removing the cooktop, and it should be in a location that allows ease of opening and closing. Do not block access to shutoff valve. The valve is for turning on or shutting off gas to the cooktop.

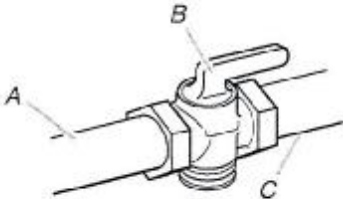

A. Gas supply line
B. Shutoff valve "open" position
C. To cooktop

TEFLON is a registered trademark of E.I. Du Pont De Nemours and Company.

ELECTRICAL REQUIREMENTS

- A 120 volt, 60 Hz, AC only, 15-amp, fused electrical circuit is required. A time-delay fuse or circuit breaker is also recommended. It is recommended that a separate circuit serving only this cooktop be provided.
- Electronic ignition systems operate within wide voltage limits, but proper grounding and polarity are necessary. Check that the outlet provides 120-volt power and is correctly grounded.

Paramur Singh Upahal

PRODUCT DIMENSIONS

KCGS550ESS and KCGS950ESS Models

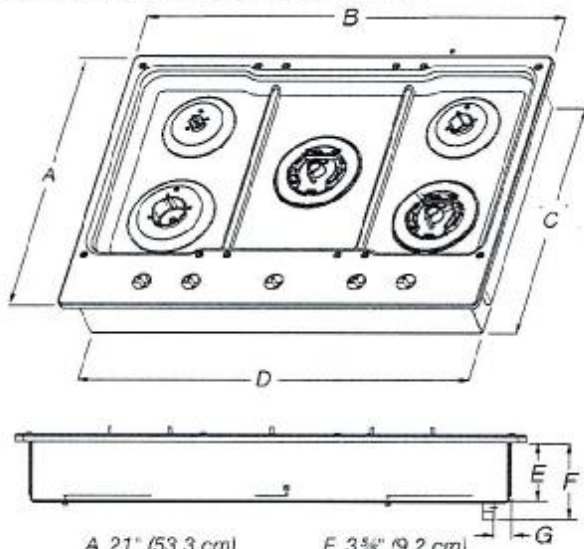

- A. 21" (53.3 cm)
- B. 30" (76.2 cm)
- C. 19 7/8" (49.2 cm)
- D. 28 7/8" (72.1 cm)
- E. 3 5/8" (9.2 cm)
- F. 4 1/8" (11.6 cm)
- G. 1 1/4" (3.4 cm)

KCGS556ESS and KCGS956ESS Models

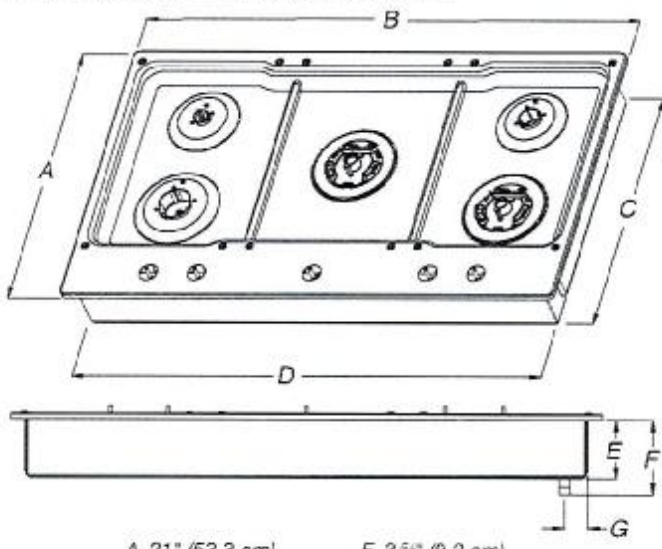

- A. 21" (53.3 cm)
- B. 36 1/4" (92.0 cm)
- C. 19 7/8" (49.2 cm)
- D. 34 7/8" (88.1 cm)
- E. 3 5/8" (9.2 cm)
- F. 4 1/8" (11.6 cm)
- G. 1 7/8" (3.6 cm)

All Other 30" (76.2 cm) Models

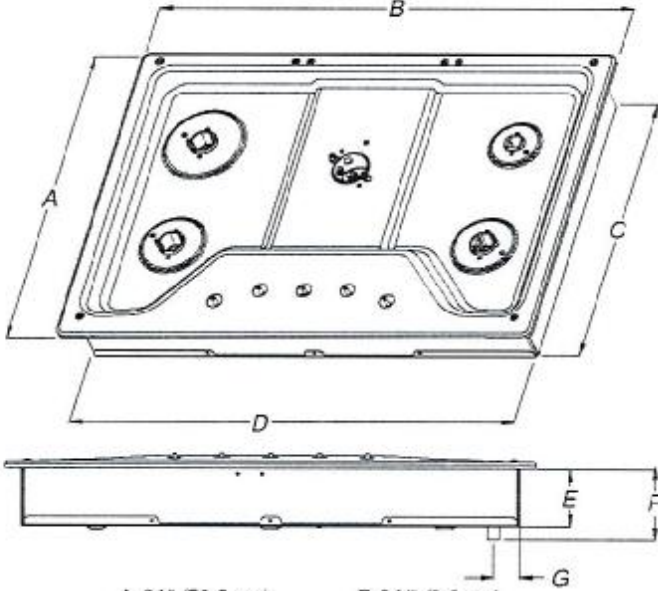

- A. 21" (53.3 cm)
- B. 30" (76.2 cm)
- C. 18 7/8" (48.0 cm)
- D. 28 7/8" (72.1 cm)
- E. 3 5/8" (8.6 cm)
- F. 4 1/8" (10.5 cm)
- G. 1 1/2" (3.8 cm)

All Other ~~30"~~ (91.4 cm) Models

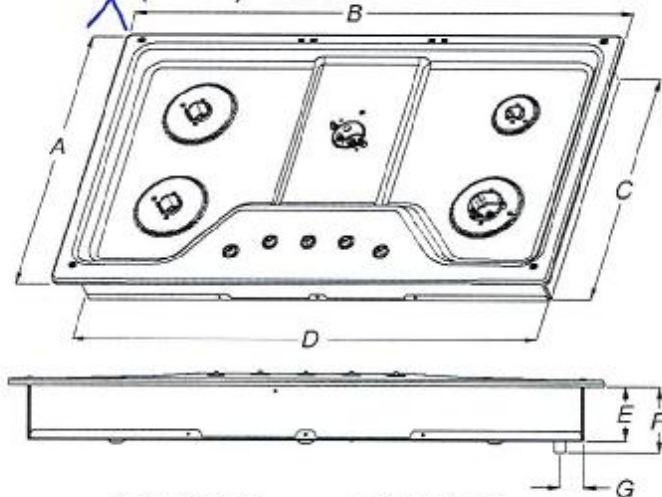

- A. 21" (53.3 cm)
- B. 36" (91.4 cm)
- C. 18 7/8" (48.0 cm)
- D. 33 1/4" (85.7 cm)
- E. 3 5/8" (8.6 cm)
- F. 4 1/8" (10.5 cm)
- G. 1 1/2" (3.8 cm)

2 Parameter Style Uphol

CABINET DIMENSIONS

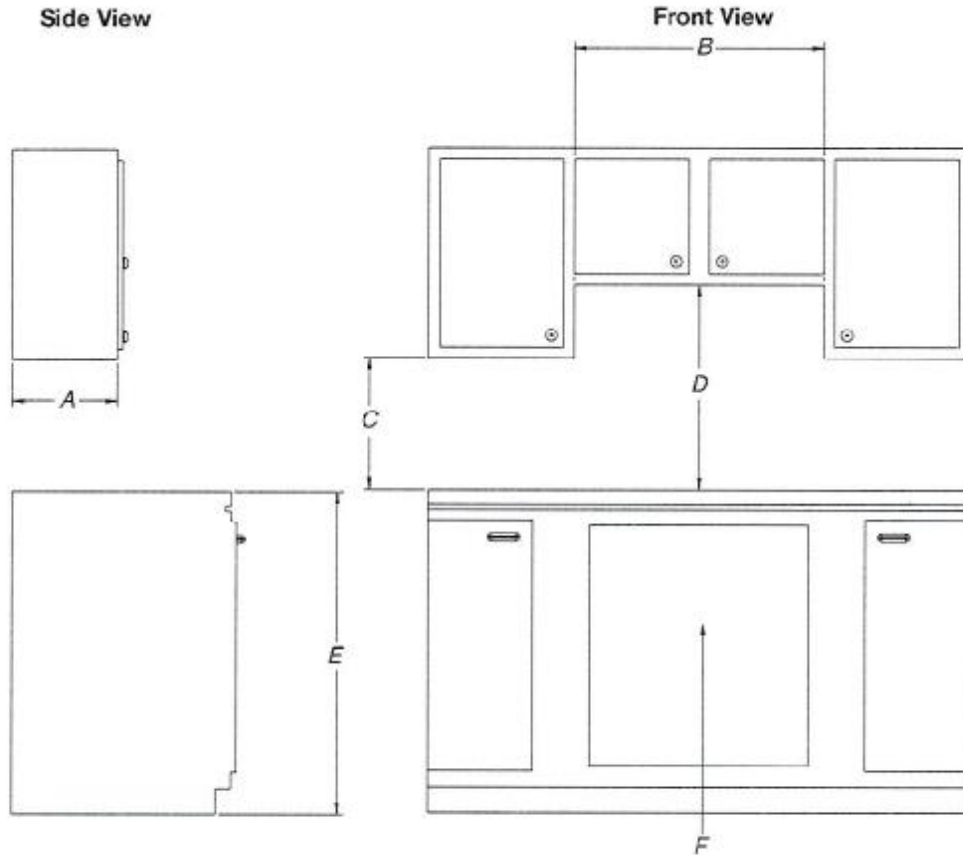

- A. 13" (33.0 cm) recommended upper cabinet depth.
- B. 30" (76.2 cm) for 30" models; 36" (91.4 cm) for 36" models.
- C. 18" (45.7 cm) minimum clearance from upper cabinet to countertop within minimum horizontal clearances to cooktop.
- D. 30" (76.2 cm) minimum clearance between top of cooktop platform and bottom of uncovered wood or metal cabinet. 24" (61 cm) minimum clearance if bottom of wood or metal cabinet is covered by not less than 1/4" (0.6 cm) flame retardant miliboard covered with not less than No. 28 MSG sheet steel, 0.015" (0.04 cm) stainless steel, or 0.024" (0.06 cm) aluminum or 0.020" (0.05 cm) copper.
- E. 36" (91.4 cm) top of countertop to floor.
- F. Gas line opening - Wall: anywhere 5" (12.7 cm) below underside of countertop. Cabinet floor: anywhere within 6" (15.2 cm) of rear wall is recommended.

Paramu Singh Upthal

x Paramveer Singh Uppal

CABINET DIMENSIONS (cont.)

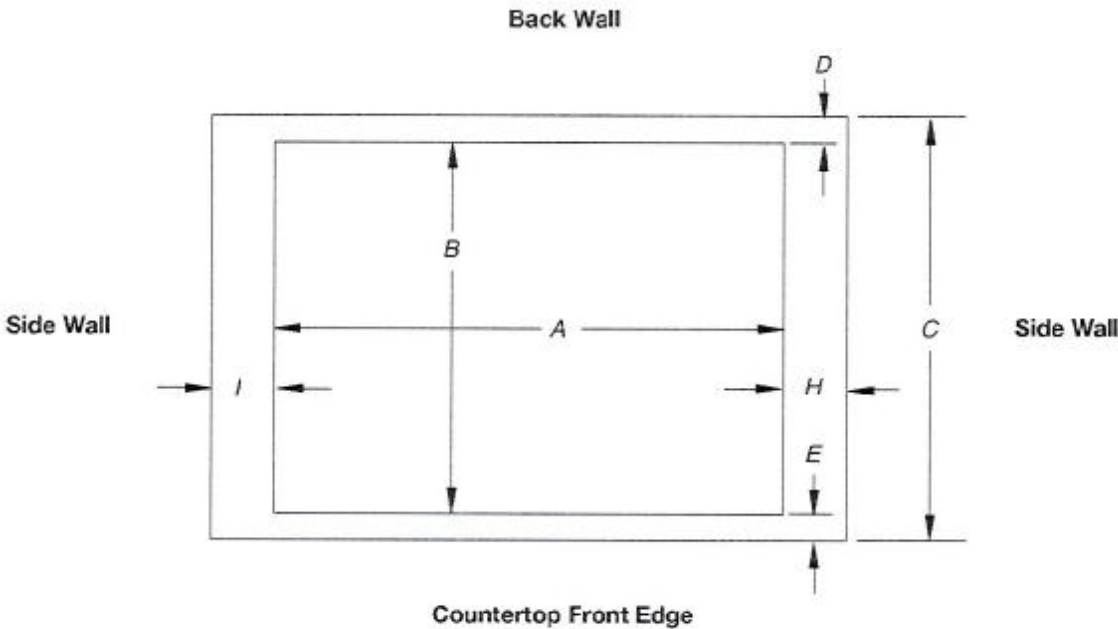

Cutout (Product Opening) Dimensions						
30" (76.2 cm) Models						
Models	A			B		
	Min	Recommended	Max	Min	Recommended	Max
KCGS550 and KCGS950	28 1/2" (72.4 cm)	28 7/8" (73.4 cm)	29 3/4" (74.3 cm)	19 1/2" (49.5 cm)	19 1/4" (50.2 cm)	20" (50.8 cm)
All Other 30" (76.2 cm) Models	28 1/2" (72.4 cm)	28 7/8" (73.4 cm)	29 3/4" (74.3 cm)	19" (48.3 cm)	19 1/2" (49.5 cm)	20" (50.8 cm)
36" (91.4 cm) Models						
KCGS556 and KCGS956	34 1/8" (88.4 cm)	35 3/8" (89.4 cm)	35 5/8" (90.3 cm)	19 1/2" (49.5 cm)	19 1/4" (50.2 cm)	20" (50.8 cm)
All Other 36" (91.4 cm) Models	33 7/8" (86.0 cm)	34 5/8" (87.0 cm)	35 1/4" (89.5 cm)	19" (48.3 cm)	19 1/2" (49.5 cm)	20" (50.8 cm)

Side Walls (Combustible Surfaces)	
Models	H and I
KCGS5 and KCGS9	H and I added together must be at least 48" (122.0 cm), with each side individually being at least 8" (20.3 cm).
KCGS350, KCGS356, MGC9536, WCG97US0, WCG97US6	H and I added together must be at least 48" (122.0 cm), with each side individually being at least 12" (30.5 cm).
All Other Models	Both have to be 8" (20.3 cm) or more.

Back Wall and Countertop Front Dimensions			
Models	C	D	E
KCGS550 and KCGS950	25" (63.5 cm)	2 7/8" (7.3 cm)	2 3/4" (6.9 cm)
All Other Models			3 1/8" (7.9 cm)

NOTES: After making the countertop cutout, some installations may require notching down the base cabinet side walls to clear the cooktop base. To avoid this modification, use a base cabinet with sidewalls wider than the cutout.

If cabinet has a drawer, a 4" (10.2 cm) depth clearance from the countertop to the top of the drawer (or other obstruction) in base cabinet is required. The drawer depth may need to be shortened to avoid interfering with the regulator.

IMPORTANT: If a built-in wall oven is to be installed below this cooktop, the grounded outlet and gas supply piping must be located in an adjacent cabinet.

This cooktop and its gas and electrical supply sources must be installed before the undercounter built-in wall oven is installed.