



CONSTRUCTION SUMMARY

KINGSMEN (THAMES) INC. / Havelock Corners (Kingsmen)

Lot/Unit: 118    Phase/Building: 5A    Model/Floor Plan: Edward (3602) Elev A 4 Bed - 2+1 Bath

COUNTER TOP

Inv.5882	1 - As per schedule "PE": Vendor to include level 1, 2cm. quartz in all bathrooms and kitchen, as per plan, in lieu of the included laminate counter tops. Selections to be made from builders standard samples.	
Line 74659	Note:	
29Sep22 / 29Sep22		

ELECTRICAL

Inv.5882	1 - To supply & install the standard T.V. rough in in the great room and master bedroom...see sketch # 1 & # 2	
Line 74660	Note:	
29Sep22 / 29Sep22		
Inv.5882	1 - To supply & install the standard Phone ( CAT 5 ) rough in in the great room, master bedroom & bedroom # 4 ...see sketch # 1 & # 2	
Line 74661	Note:	
29Sep22 / 29Sep22		
Inv.5882	1 - To SUPPLY AND INSTALL EXTRA CEILING BOX ROUGH IN CAPPED (DOES NOT INCLUDE SWITCH) over the island in the kitchen... see sketch # 1	
Line 74691	Note: This capped elec. will be connected to a sep. switch, switch is sold sep.	
29Sep22 / 29Sep22		
Inv.5882	1 - To supply & install AN ADDITIONAL SINGLE POLE SWITCH connected to the capped elec. over the island in the kitchen.	
Line 74692	Note:	
29Sep22 / 29Sep22		
Inv.5882	1 - Relcoate the standard ceiling light from the upper stair landing to the O.T.B. area on the second floor... see sketch # 2	
Line 74693	Note:	
29Sep22 / 29Sep22		

HEATING AND AIR CONDITIONING

Inv.5882	1 - As per schedule "PE": Vendor to install capped gas line (rough in only ) at rear of home for future BBQ location. Location to be finalzied at vendors sole discretion.	
Line 74657	Note:	
29Sep22 / 29Sep22		
Inv.5882	1 - As per schedule "PE": Vendor to supply & install air conditioning unit, sized accordingly, from vendors standard samples.	
Line 74658	Note:	
29Sep22 / 29Sep22		

PLUMBING

Inv.5882	5 - To supply & install the VANITY SINK - CONTRAC CATENA UNDERMOUNT - MODEL 4210CIY in the powder room, master ensuite and main bathroom in lieu of the standard top mount vanity sinks... see spec's	
Line 74694	Note: Still to install the standard lav. faucets.	
29Sep22 / 29Sep22		



CONSTRUCTION SUMMARY

KINGSMEN (THAMES) INC. / Havelock Corners (Kingsmen)

Lot/Unit: 118    Phase/Building: 5A    Model/Floor Plan: Edward (3602) Elev A 4 Bed - 2+1 Bath

EXTRAS AS PER OFFER

5 FREE APPLIANCES ? STAINLESS STEEL FRONT - FRIDGE: STOVE AND DISHWASHER. WHITE WASHER AND DRYER (SUPPLIED ONLY, NOT INSTALLED, FROM BUILDERS STANDARD LINE). AN APPLIANCES VOUCHER WILL BE GIVEN BY OUR DECOR CONSULTANT AT THE TIME OF BOOKING YOUR COLOUR A <i>Worksheet</i> Note:	
5 FREE APPLIANCES – STAINLESS STEEL FRONT - FRIDGE: STOVE AND DISHWASHER. WHITE WASHER AND DRYER (SUPPLIED ONLY, NOT INSTALLED, FROM BUILDERS STANDARD LINE). AN APPLIANCES VOUCHER WILL BE GIVEN BY OUR DECOR CONSULTANT AT THE TIME OF BOOKING YOUR COLOUR A <i>Worksheet</i> Note:	
VENDOR TO INSTALL CAPPED GAS LINE (ROUGH-IN ONLY) AT REAR OF HOME FOR FUTURE BBQ LOCATION.   LOCATION TO BE FINALIZED AT VENDORS SOLE DISCRETION. <i>Worksheet</i> Note:	
VENDOR TO SUPPLY & INSTALL AIR CONDITIONING UNIT, SIZED ACCORDINGLY, FROM VENDORS STANDARD SAMPLES. <i>Worksheet</i> Note:	
VENDOR TO INCLUDE LEVEL 1, 2CM QUARTZ IN ALL BATHROOMS, AS PER PLAN, IN LIEU OF THE INCLUDED LAMINATE COUNTER TOPS. SELECTIONS TO BE MADE FROM BUILDERS STANDARD SAMPLES. <i>Worksheet</i> Note:	

Purchasers: RANJEET SINGH VIRK & BALPREET KAUR GH

Property: 118 of Plan - Draft Approval SB17-03-08

Telephone Res. / Bus: /

Project: KINGSMEN (THAMES) INC.

Decor Advisor: Barbara Coccia

Model and Elevation: Edward (3602) Elev A 4 Bed - 2+1 Bath

Layout Changes: ☐ Yes ☒ No

Sketch Attached: ☒ Yes ☐ No

Exterior Colour Scheme:

1. Cabinetry

	Style and Colour	Counter Top	Hardware
Kitchen / Breakfast	#3, Simcoe Rain Cloud	#1, C/S # 9141 Ice Snow 3cm.	#12881 Handle
Kitchen Island	#3, Simcoe Rain Cloud	#1, C/S # 9141 Ice Snow 3cm.	#12881 Handle
Laundry Room	/		
Powder Room	#3, Simcoe Rain Cloud	#1, C/S # 9141 Ice Snow 2cm.	#12881 Handle
Main Bathroom	#3, Simcoe Rain Orchid	#1, C/S # 3040 Cement 2cm.	#135 Knob
Master Ensuite Bathroom	#3, Simcoe Rain Orchid	#1, C/S # 3040 Cement 2cm.	#135 Knob
Second Ensuite Bathroom (If Applicable)	/		
	/		
	/		

Appliances

Custom Size Fridge  
☐ Yes ☒ No

Cooktop / Rangetop  
☐ Yes ☒ No

Valance Lighting  
☐ Yes ☒ No

Built in Wall Oven  
☐ Yes ☒ No

Microwave / Range Hood  
☐ Yes ☒ No

Slide-in Range  
☐ Yes ☒ No

Comment

/

2. Flooring

	Selection
Foyer	13 x13" Malena Ice
Main Hall	3 1/2" Elements Oak Natural
Back Hall	/
Breakfast	13 x13" Malena Ice
Laundry Room	13 x13" Malena Ice
Kitchen	13 x13" Malena Ice
Powder Room	13 x13" Malena Ice
Main Bathroom	13 x13" Malena Ice
Master Ensuite	13 x13" Malena Carbon
Bathroom (If Applicable)	/
Mud Room	/
Master ens. shower floor:	2x2" Ontario Snow White Matte
Living Room	/
Dining Room	3 1/2" Elements Oak Natural
Family / Great Room	3 1/2" Elements Oak Natural
Den / Library / Study	/
Basement Landing (If Applies)	
Lower Landing (If Applicable)	3 1/2" Elements Oak Natural
Upper Landing	( if applicable ) 3 1/2" Elements Oak Natural
Upper Hall	Modern Story 1, # 945 Felt Hat
Master Bedroom	Modern Story 1, # 945 Felt Hat
Bedroom #2	Modern Story 1, # 945 Felt Hat
Bedroom #3	Modern Story 1, # 945 Felt Hat
Bedroom #4	Modern Story 1, # 945 Felt Hat
Bedroom #5	/
Master ens. Shower jamb:	Anatolia Marmiline SNOW

RECEIVED

OCT 03 2022

SEE ATTACHED FOR SIGNATURES

**Purchasers:** RANJEET SINGH VIRK & BALPREET KAUR GH  
**Telephone Res. / Bus:** /  
**Decor Advisor:** Barbara Coccia  
**Property:** 118 of Plan - Draft Approval SB17-03-08  
**Project:** KINGSMEN (THAMES) INC.  
**Model and Elevation:** Edward (3602) Elev A 4 Bed - 2+1 Bath  
**2. Flooring - Continued -**

Upgrade Underpad	Type	Area
	Standard	2nd. Floor
Carpet on Stairs	Capped	Runner - *Upgrade
Comment	/	/

### 3. Plumbing Fixtures / Faucets

Kitchen	Standard	Second Ensuite	/	Powder Room	Standard
Master Ensuite	Standard			Other Room	/
Main Bathroom	Standard				

#### Comment

Still to install the standard top mount kitchen sink with the standard kitchen faucet.  
Purchaser has upgraded to under mount vanity sinks in ALL bathrooms.

### 4. Wall Tile

	Tile Selection	Listello	Insert	Insert Selection
Main Bathroom	8x10" Malena Carbon	<input type="checkbox"/>	<input type="checkbox"/>	
Master Ensuite				
Tub Deck	13x13" Malena Carbon	<input type="checkbox"/>	<input type="checkbox"/>	
Tub Apron	13x13" Malena Carbon	<input type="checkbox"/>	<input type="checkbox"/>	
Tub Surround	13x13" Malena Carbon	<input type="checkbox"/>	<input type="checkbox"/>	
Shower Stall	8x10" Malena Ice	<input type="checkbox"/>	<input type="checkbox"/>	
Second Ensuite	/	<input type="checkbox"/>	<input type="checkbox"/>	
	/	<input type="checkbox"/>	<input type="checkbox"/>	
	/	<input type="checkbox"/>	<input type="checkbox"/>	
Kitchen Backsplash	/	<input type="checkbox"/>	<input type="checkbox"/>	
Complete Backsplash	/	<input type="checkbox"/>	<input type="checkbox"/>	



horizontal stacked

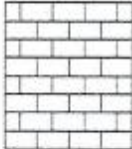

brick pattern



vertical stacked



diagonal/diamond

#### Comment

/

### 5. Fireplace

	Living Room			Family Room			Other Room - Specify			Great room
	Purchased	As Per Plan	N/A	Purchased	As Per Plan	N/A	Purchased	As Per Plan	N/A	
Fireplace Type	<input type="radio"/>	<input type="radio"/>	<input checked="" type="radio"/>	<input type="radio"/>	<input type="radio"/>	<input checked="" type="radio"/>	<input type="radio"/>	<input checked="" type="radio"/>	<input type="radio"/>	
Mantle Type										
Over Mantle										
Colour / Stain										
Surround										
Hearth										
Comment							Front Facing			
							NF-08			
							/			
							White			
							/			
							/			

RECEIVED

OCT 03 2022

SEE ATTACHED FOR SIGNATURES

Initial:







Purchasers: RANJEET SINGH VIRK & BALPREET KAUR GH-Property: 118 of Plan - Draft Approval SB17-03-08  
Telephone Res. / Bus: / Project: KINGSMEN (THAMES) INC.  
Decor Advisor: Barbara Coccia Model and Elevation: Edward (3602) Elev A 4 Bed - 2+1 Bath

## 6. Trim Carpentry

Door Hardware Standard Handle

Interior Trim Standard

Comment  
/

## Interior Doors

☐ 2 Panel Arch Top☒ 2 Panel Square Top☐ 6 Panel

Initial for Door Style

BG

## 7. Railings and Pickets

Railing Package Standard Oak STRAIGHT picket package

Railing Colour Elements Natural

Picket Colour

Elements Natural

Wood Stairs ☐ No ☒ Oak

Tread Colour

Elements Natural

Comment  
/

SEE ATTACHED FOR SIGNATURE

## 8. Plaster Mouldings and Medallions

Foyer /

Main Hall /

Living Room /

Dining Room /

Family Room /

Kitchen/Breakfast /

Den/Library /

Lower Landing /

Comment  
/

## 9. Wall Paint

Kingsmen White

Smooth Ceilings

☐ First Floor☐ First Floor incl. Second Floor Hall☐ First and Second Floor☒ Throughout☐ Not Applicable

Trim Paint Kingsmen White

10. Additional Comments  
/

RECEIVED

OCT 03 2022

## 11. Disclaimers and Notes

- Colours of all materials are as close as possible to builder's selection, but not necessarily identical due to variances in manufacturing.
- Any extras listed above are null and void unless accompanied by a separate invoice/amendment. Said invoice must be paid in full.
- The Purchaser acknowledges that after Interior Colour Selection form is signed and dated, no further changes will be permitted other than re-selection due to unavailability. Purchaser's Initials
- The Purchaser acknowledges reading and accepting the "Kingsmen Group Décor Centre Disclaimers" form. This document contains other miscellaneous disclaimers.

SEE ATTACHED FOR SIGNATURES

This Interior Colour Selection is final and approved by:

Purchaser:

Signature: Balpreet Date: 29 Sep 2022Signature: SEE ATTACHED FOR SIGNATURES

Date: \_\_\_\_\_

Vendor: W

KINGSMEN (THAMES) INC.

Oct 3/22

# SCHEDULE "B-1" Floor Plan

Lot 118  
Phase 5A  
Model: Edward (3602) Elev A 4 Bed - 2+1 Bath  
Standard

*Sketch #1*

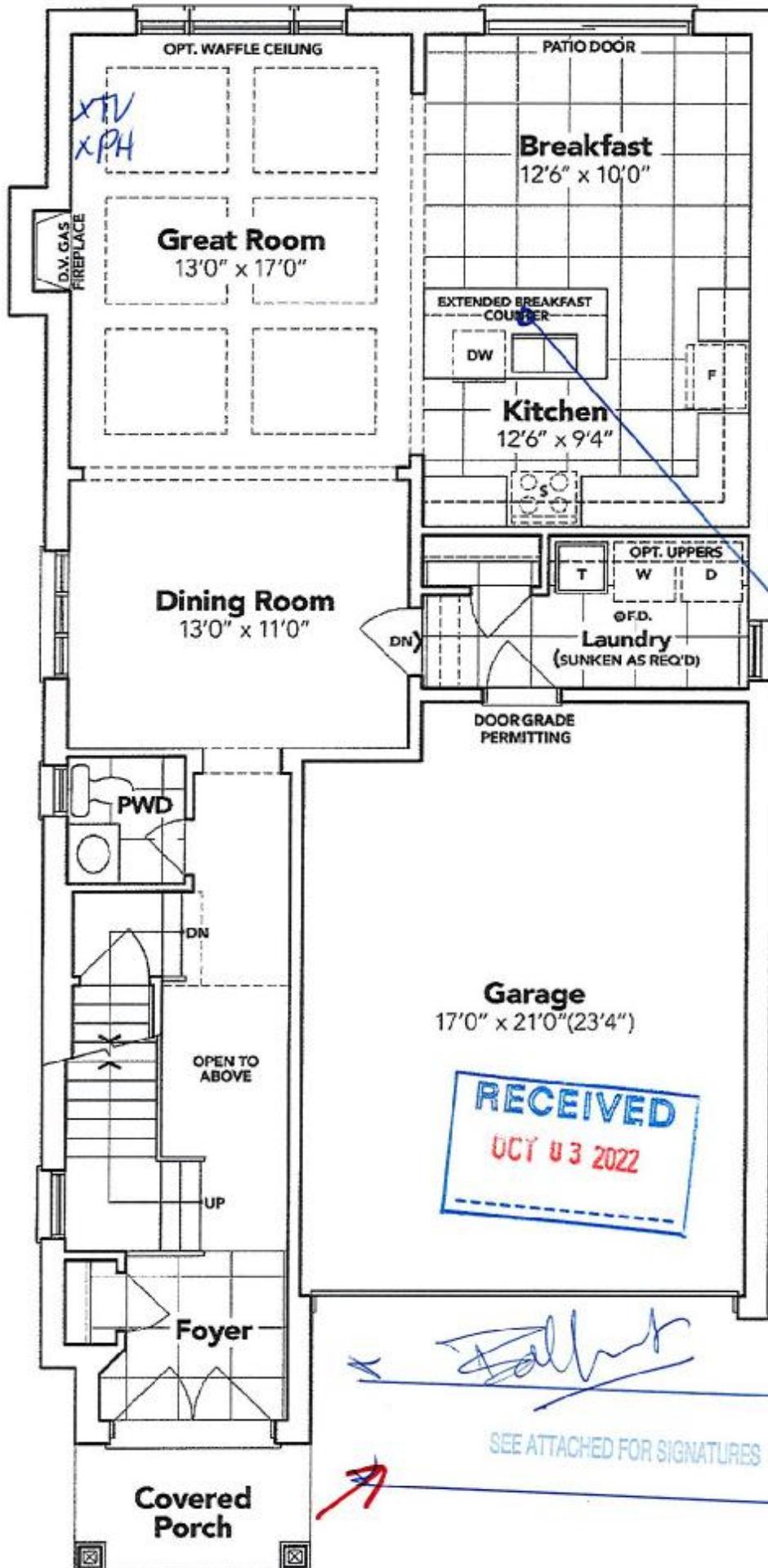

## GROUND FLOOR EL. A

The floor plans and elevations shown are pre-construction plans and may be revised or improved as necessitated by architectural controls and the construction process. The measurements adhere to the rules and regulations of the TARIION Warranty Corporation's official method for the calculation of floor area. Materials, specifications and floor plans are subject to change without notice. All house renderings are artist's concept only. Actual usable floor space may vary from the stated floor area. All options shown are upgrades, E. & O. E.



**SCHEDULE "B-1"**  
**Floor Plan**

Lot 118  
Phase 5A  
Model: Edward (3602) Elev A 4 Bed - 2+1 Bath  
Standard

Sketch  
#2

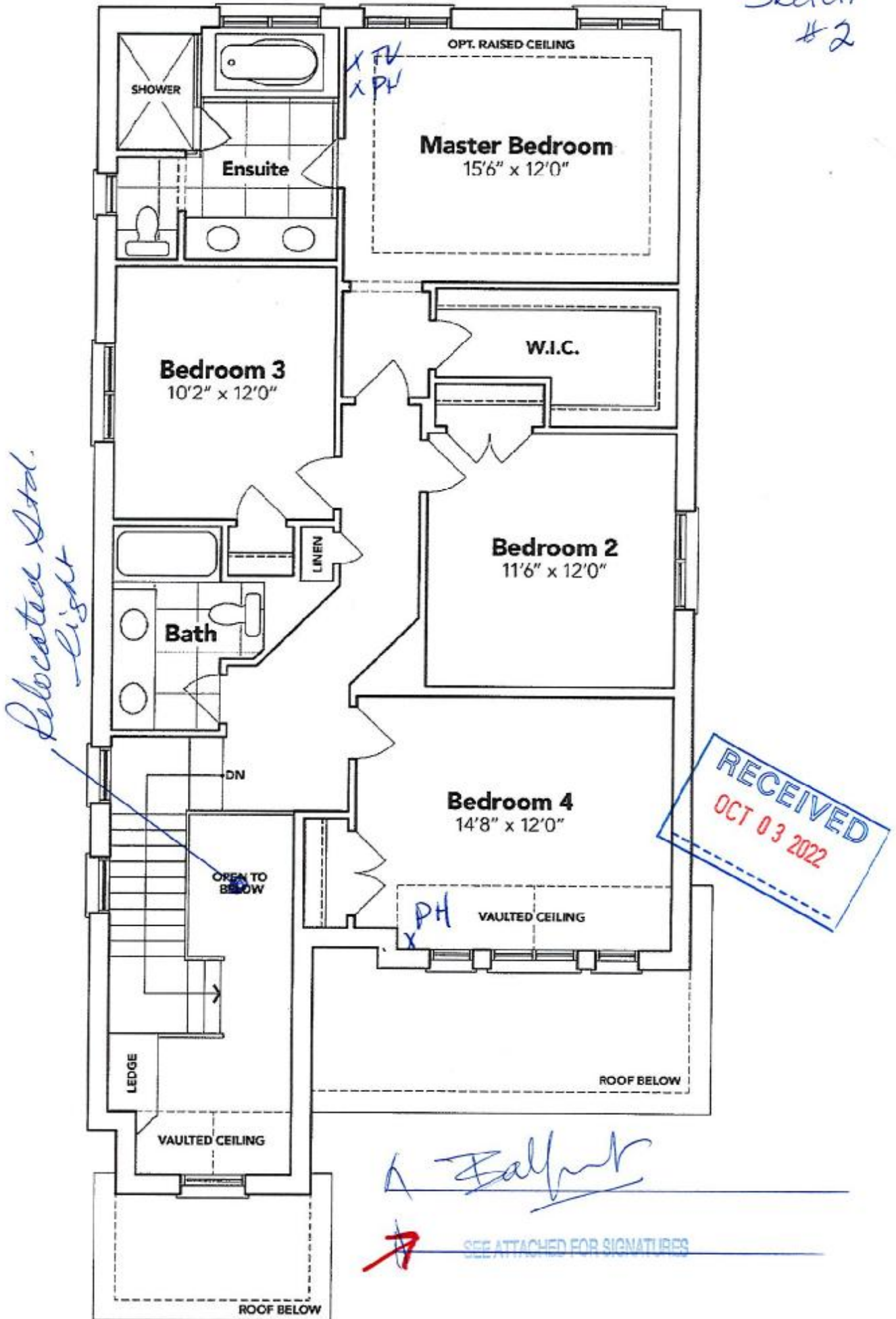

**SECOND FLOOR EL. A**

The floor plans and elevations shown are pre-construction plans and may be revised or improved as necessitated by architectural controls and the construction process. The measurements adhere to the rules and regulations of the TARION Warranty Corporation's official method for the calculation of floor area. Materials, specifications and floor plans are subject to change without notice. All house renderings are artist's concept only. Actual usable floor space may vary from the stated floor area. All options shown are upgrades. E. & O. E.

**SCHEDULE "B-1"**  
**Floor Plan**

Lot 118  
Phase 5A  
Model: Edward (3602) Elev A 4 Bed - 2+1 Bath  
Standard

*Sketch #3*

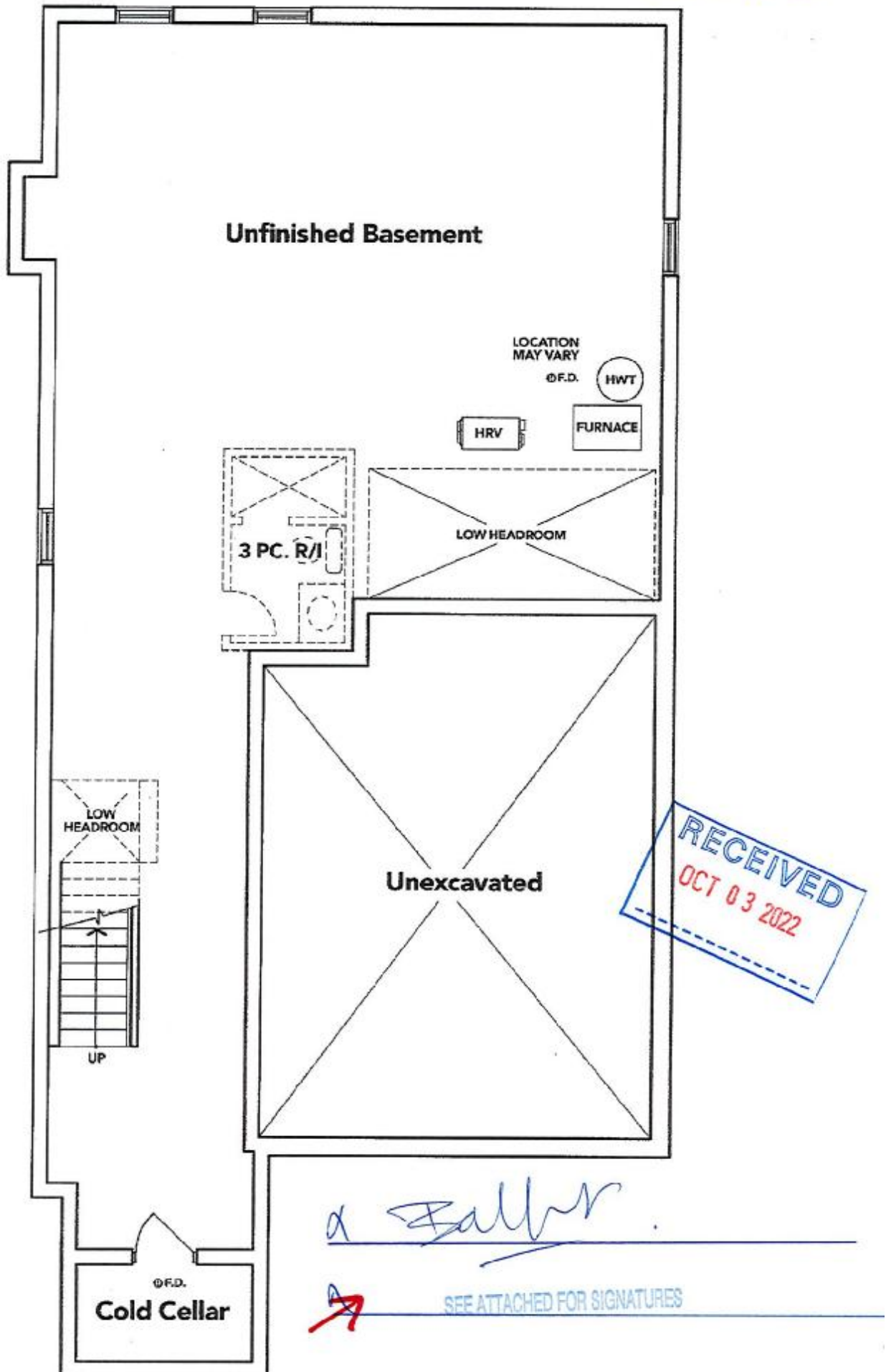

**BASEMENT EL. A**

The floor plans and elevations shown are pre-construction plans and may be revised or improved as necessitated by architectural controls and the construction process. The measurements adhere to the rules and regulations of the TARIION Warranty Corporation's official method for the calculation of floor area. Materials, specifications and floor plans are subject to change without notice. All house renderings are artist's concept only. Actual usable floor space may vary from the stated floor area. All options shown are upgrades. E. & O. E.



SEE ATTACHED FOR SIGNATURES