



CONSTRUCTION SUMMARY

KINGSMEN (THAMES) INC. / Havelock Corners (Kingsmen)

Lot/Unit: 87 Phase/Building: 5A Model/Floor Plan: James (3601) Elev C 4 Bed - 2+1 Bath

CABINETRY HOOD FANS

Inv.5850	1 - To ACCOMMODATE FOR MICROWAVE HOOD FAN COMBO - over the stove in the kitchen.	
Line 74328	Note: NO O.T.R. HAS BEEN PURCHASED, STILL TO INSTALL THE STANDARD STAINLESS STEEL HOOD FAN.	
16Sep22 / 16Sep22		

CABINETRY VANITY

Inv.5850	1 - To supply & install the VANITY BANK OF DRAWERS in the master ensuite... see sketch # 2	
Line 74329	Note:	
16Sep22 / 16Sep22		
Inv.5850	1 - To supply & install the VANITY BANK OF DRAWERS in the main bathroom... see sketch # 2	
Line 74330	Note:	
16Sep22 / 16Sep22		

COUNTER TOP

Inv.5850	1 - As per schedule "PE": Vendor to include level 1, 2cm. quartz in all bathrooms, as per plan, in lieu of the included laminate counter tops. Selections to be made from builders standard samples.	
Line 74292	Note:	
16Sep22 / 16Sep22		

ELECTRICAL

Inv.5850	1 - To supply & install the standard T.V. rough in in the great room and master bedroom... see sketch # 1 & # 2	
Line 74293	Note: Install the standard T.V. rough in at approx. 66" + - centered + - to the F/P mantle up from the floor in the great room...	
16Sep22 / 16Sep22		
Inv.5850	1 - To supply & install the standard Phone (CAT 5) rough in in the great room, master bedroom & bedroom #2 ... see sketch # 1 & # 2	
Line 74294	Note: Install the standard Phone (CAT 5) rough in at approx. 66" + - centered + - to the F/P mantle up from the floor in the great room...	
16Sep22 / 16Sep22		
Inv.5850	1 - To SUPPLY AND INSTALL AN ADDITIONAL BASIC RECEPTACLE (NOT DEDICATED) at appro. 66" + - up from the floor centered + - to the F/P mantle	
Line 74320	Note: in the great room... see sketch # 1	
16Sep22 / 16Sep22		
This is for a future wall mount T.V.		
NO CONDUIT PIPE HAS BEEN PURCHASED.		
Inv.5850	1 - To SUPPLY AND INSTALL EXTRA CEILING BOX ROUGH IN CAPPED (DOES NOT INCLUDE SWITCH) over the island in the kitchen... see sketch # 1	
Line 74322	Note: This capped elec. will be connected to a sep. switch, switch is sold sep.	
16Sep22 / 16Sep22		
Inv.5850	1 - To supply & install AN ADDITIONAL SINGLE POLE SWITCH connected to the upgraded capped elec. over the island in the kitchen.	
Line 74324	Note:	
16Sep22 / 16Sep22		

KINGSMEN (THAMES) INC. / Havelock Corners (Kingsmen)

Lot/Unit: 87 Phase/Building: 5A Model/Floor Plan: James (3601) Elev C 4 Bed - 2+1 Bath

Inv.5850	1 - Relocate the standard ceiling light from the upper stair landing to the O.T.B. area on the second floor... see sketch # 2	
Line 74326	Note:	
16Sep22 / 16Sep22		
Inv.5850	1 - To SUPPLY AND INSTALL AN ADDITIONAL BASIC RECEPTACLE (DEDICATED CIRCUIT AND INCLUDES ARC FAULT BREAKER) for the future O.T.R. in the kitchen...	
Line 74327	Note: NO O.T.R. HAS BEEN PURCHASED, STILL TO INSTALL THE STANDARD STAINLESS STEEL HOOD FAN.	
16Sep22 / 16Sep22		

HEATING AND AIR CONDITIONING

Inv.5850	1 - As per schedule "PE": Vendor to install capped gas ine (rough in only) at rear of home for future BBQ location. Location to be finalized at vendors sole discretion.	
Line 74290	Note:	
16Sep22 / 16Sep22		
Inv.5850	1 - As per schedule "PE": Vendor to supply & install air conditioning unit, sized accordingly, from vendors standard samples.	
Line 74291	Note:	
16Sep22 / 16Sep22		
Inv.5850	1 - To supply & install a HUMMIDIFIER to the furnace...	
Line 74337	Note:	
16Sep22 / 16Sep22		

PLUMBING

Inv.5850	3 - To supply & install VANITY SINK - CONTRAC CATENA UNDERMOUNT - MODEL 4210CIY in the powder room and master ensuite bathrooms ONLY in lieu of the standard top mount sinks... see spec's	
Line 74331	Note: Still to install the standard lav. faucets.	
16Sep22 / 16Sep22		

TRIM

Inv.5850	1 - To supply & intall the INTERIOR DOORS - UPGRADE TO LIVINGSTON HOLLOW CORE throughout the house where applicable in lieu of the standard interior doors.	
Line 74332	Note:	
16Sep22 / 16Sep22		

KINGSMEN (THAMES) INC. / Havelock Corners (Kingsmen)

Lot/Unit: 87 Phase/Building: 5A Model/Floor Plan: James (3601) Elev C 4 Bed - 2+1 Bath

EXTRAS AS PER OFFER

5 FREE APPLIANCES – STAINLESS STEEL FRONT - FRIDGE; STOVE AND DISHWASHER. WHITE WASHER AND DRYER (SUPPLIED ONLY, NOT INSTALLED, FROM BUILDERS STANDARD LINE). AN APPLIANCES VOUCHER WILL BE GIVEN BY OUR DECOR CONSULTANT AT THE TIME OF BOOKING YOUR COLOUR A <i>Worksheet</i> Note:	
VENDOR TO INSTALL CAPPED GAS LINE (ROUGH-IN ONLY) AT REAR OF HOME FOR FUTURE BBQ LOCATION. LOCATION TO BE FINALIZED AT VENDORS SOLE DISCRETION. <i>Worksheet</i> Note:	
VENDOR TO SUPPLY & INSTALL AIR CONDITIONING UNIT, SIZED ACCORDINGLY, FROM VENDORS STANDARD SAMPLES. <i>Worksheet</i> Note:	
VENDOR TO INCLUDE LEVEL 1, 2CM QUARTZ IN ALL BATHROOMS, AS PER PLAN, IN LIEU OF THE INCLUDED LAMINATE COUNTER TOPS. SELECTIONS TO BE MADE FROM BUILDERS STANDARD SAMPLES. <i>Worksheet</i> Note:	

5A-10+87



Purchaser: HASSAN FAROOQ

Property: 87 of Plan - Draft Approval SB17-03-08

Telephone Res. / Bus: /

Project: KINGSMEN (THAMES) INC.

Decor Advisor: Barbara Coccia

Model and Elevation: James (3601) Elev C 4 Bed - 2+1 Bath

Layout Changes: ☐ Yes ☒ NoSketch Attached: ☒ Yes ☐ No

Exterior Colour Scheme:

1. Cabinetry

	Style and Colour	Counter Top	Hardware
Kitchen / Breakfast	# 3 Simcoe Orchid	#1, C/S # 9141 Ice Snow 3cm.	# 9661 Handle
Kitchen Island	# 3 Simcoe Orchid	#1, C/S # 9141 Ice Snow 3cm.	# 9661 Handle
Laundry Room	/		
Powder Room	# 3 Simcoe Orchid	#1, C/S # 9141 Ice Snow 2cm.	#135 Knob
Main Bathroom	# 3 Simcoe Orchid	#1, C/S # 9141 Ice Snow 2cm.	#135 Knob
Master Ensuite Bathroom	# 3 Simcoe Orchid	#1, C/S # 3040 Cement 2cm.	#135 Knob
Second Ensuite Bathroom (If Applicable)	/		
	/		
	/		

Appliances

Custom Size Fridge

☐ Yes ☒ No

Valance Lighting

☐ Yes ☒ No

Microwave / Range Hood

☒ Yes ☐ No

Cooktop / Rangetop

☐ Yes ☒ No

Built in Wall Oven

☐ Yes ☒ No

Slide-in Range

☐ Yes ☒ No

Comment

/

2. Flooring

Selection

Foyer	13 x13" Cinq White
Main Hall	13 x13" Cinq White
Back Hall	/
Breakfast	13 x13" Cinq White
Laundry Room	13 x13" Malena Ice
Kitchen	13 x13" Cinq White
Powder Room	13 x13" Cinq White
Main Bathroom	13 x13" Malena Ice
Master Ensuite	13 x13" Malena Carbon
Bathroom (If Applicable)	/
Mud Room	13 x13" Cinq White
Master ens. shower floor	2x2" Ontario Snow White Matte
Living Room	/
Dining Room	/
Family / Great Room	3 1/2" Elements Oak Natural
Den / Library / Study	/
Basement Landing (If Applies)	
Lower Landing (If Applicable)	3 1/2" Elements Oak Natural
Upper Landing	(if applicable) 3 1/2" Elements Oak Natural
Upper Hall	Modern Story 1, # 927 Morning Rain
Master Bedroom	Modern Story 1, # 927 Morning Rain
Bedroom #2	Modern Story 1, # 927 Morning Rain
Bedroom #3	Modern Story 1, # 927 Morning Rain
Bedroom #4	Modern Story 1, # 927 Morning Rain
Bedroom #5	/
Master ens. shower jamb	Anatolia Marmiline SNOW



SEE ATTACHED FOR SIGNATURES

Flooring Continued on Page 2

Initial: 

Page 1 of 3

Purchaser: HASSAN FAROOQ

Property: 87 of Plan - Draft Approval SB17-03-08

Telephone Res. / Bus: /

Project: KINGSMEN (THAMES) INC.

Decor Advisor: Barbara Coccia

Model and Elevation: James (3601) Elev C 4 Bed - 2+1 Bath

2. Flooring - Continued -

Upgrade Underpad	Type	Area
	Standard	2nd. Floor
Carpet on Stairs	Capped	Runner - *Upgrade
Comment	/	/
/		

3. Plumbing Fixtures / Faucets

Kitchen	Standard	Second Ensuite	/	Powder Room	Standard
Master Ensuite	Standard			Other Room	/
Main Bathroom	Standard		/		



Comment

Still to install the standard top mount kitchen sink with the standard kitchen faucet.

Purchaser has upgraded to under mount vanity sinks for the powder room and master ensuite ONLY. Still to install the standard lav. faucets.

4. Wall Tile

	Tile Selection	Listello	Insert	Insert Selection
Main Bathroom	8x10" Malena Ice	<input type="checkbox"/>	<input type="checkbox"/>	
Master Ensuite				
Tub Deck	13 x13" Malena Carbon	<input type="checkbox"/>	<input type="checkbox"/>	
Tub Apron	13 x13" Malena Carbon	<input type="checkbox"/>	<input type="checkbox"/>	
Tub Surround	13 x13" Malena Carbon	<input type="checkbox"/>	<input type="checkbox"/>	
Shower Stall	8x10" Malena Carbon	<input type="checkbox"/>	<input type="checkbox"/>	
Second Ensuite	/	<input type="checkbox"/>	<input type="checkbox"/>	
	/	<input type="checkbox"/>	<input type="checkbox"/>	
	/	<input type="checkbox"/>	<input type="checkbox"/>	
Kitchen Backsplash	/	<input type="checkbox"/>	<input type="checkbox"/>	
Complete Backsplash	/	<input type="checkbox"/>	<input type="checkbox"/>	
Comment	/			

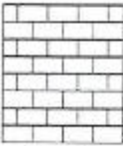
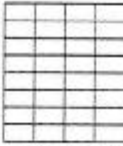

horizontal stacked brick pattern vertical stacked diagonal/diamond



5. Fireplace

	Living Room			Family Room			Other Room - Specify Great room		
	Purchased	As Per Plan	N/A	Purchased	As Per Plan	N/A	Purchased	As Per Plan	N/A
Fireplace Type	<input type="radio"/>	<input type="radio"/>	<input checked="" type="radio"/>	<input type="radio"/>	<input type="radio"/>	<input checked="" type="radio"/>	<input type="radio"/>	<input checked="" type="radio"/>	<input type="radio"/>
Mantle Type							Front Facing		
Over Mantle							NF-08		
Colour / Stain							/		
Surround							White		
Hearth							/		
Comment							/		

SEE ATTACHED FOR SIGNATURES

Initial: 

Page 2 of 3

Purchaser: HASSAN FAROOQ

Property: 87 of Plan - Draft Approval SB17-03-08

Telephone Res. / Bus: /

Project: KINGSMEN (THAMES) INC.

Decor Advisor: Barbara Coccia

Model and Elevation: James (3601) Elev C 4 Bed - 2+1 Bath

6. Trim Carpentry

Door Hardware

Interior Trim

Comment

**purchaser has upgraded the interior doors, see invoice for details.

Interior Doors

☐ 2 Panel Arch Top

☐ 2 Panel Square Top

☐ 6 Panel

SEE ATTACHED FOR SIGNATURES

Initial for Door Style

7. Railings and Pickets

Railing Package

SEE ATTACHED FOR SIGNATURES

Railing Colour

Picket Colour

Wood Stairs ☐ No ☒ Oak

Tread Colour

Comment

8. Plaster Mouldings and Medallions

Foyer

Kitchen/Breakfast

Main Hall

Den/Library

Living Room

Lower Landing

Dining Room

Family Room

Comment

9. Wall Paint

Kingsmen White

Smooth Ceilings

☐ First Floor

☐ First Floor incl. Second Floor Hall

☐ First and Second Floor

☒ Throughout

☐ Not Applicable

Trim Paint

10. Additional Comments



11. Disclaimers and Notes

- Colours of all materials are as close as possible to builder's selection, but not necessarily identical due to variances in manufacturing.
- Any extras listed above are null and void unless accompanied by a separate invoice/amendment. Said invoice must be paid in full.
- The Purchaser acknowledges that after Interior Colour Selection form is signed and dated, no further changes will be permitted other than re-selection due to unavailability. SEE ATTACHED FOR SIGNATURES
- The Purchaser acknowledges reading and accepting the "Kingsmen Group Décor Centre Disclaimers" form. This document contains other miscellaneous disclaimers.

This Interior Colour Selection is final and approved by:

Purchaser:

SEE ATTACHED FOR SIGNATURES

Signature:

Date:

Vendor:

KINGSMEN (THAMES) INC.

Sept 20/22

SCHEDULE "B-1"
Floor Plan

Lot 87
Phase 5A
Model: James (3601) Elev C 4 Bed • 2+1 Bath
Standard

Sketch
#1

all Biltmore
cell + up from
PH
TV

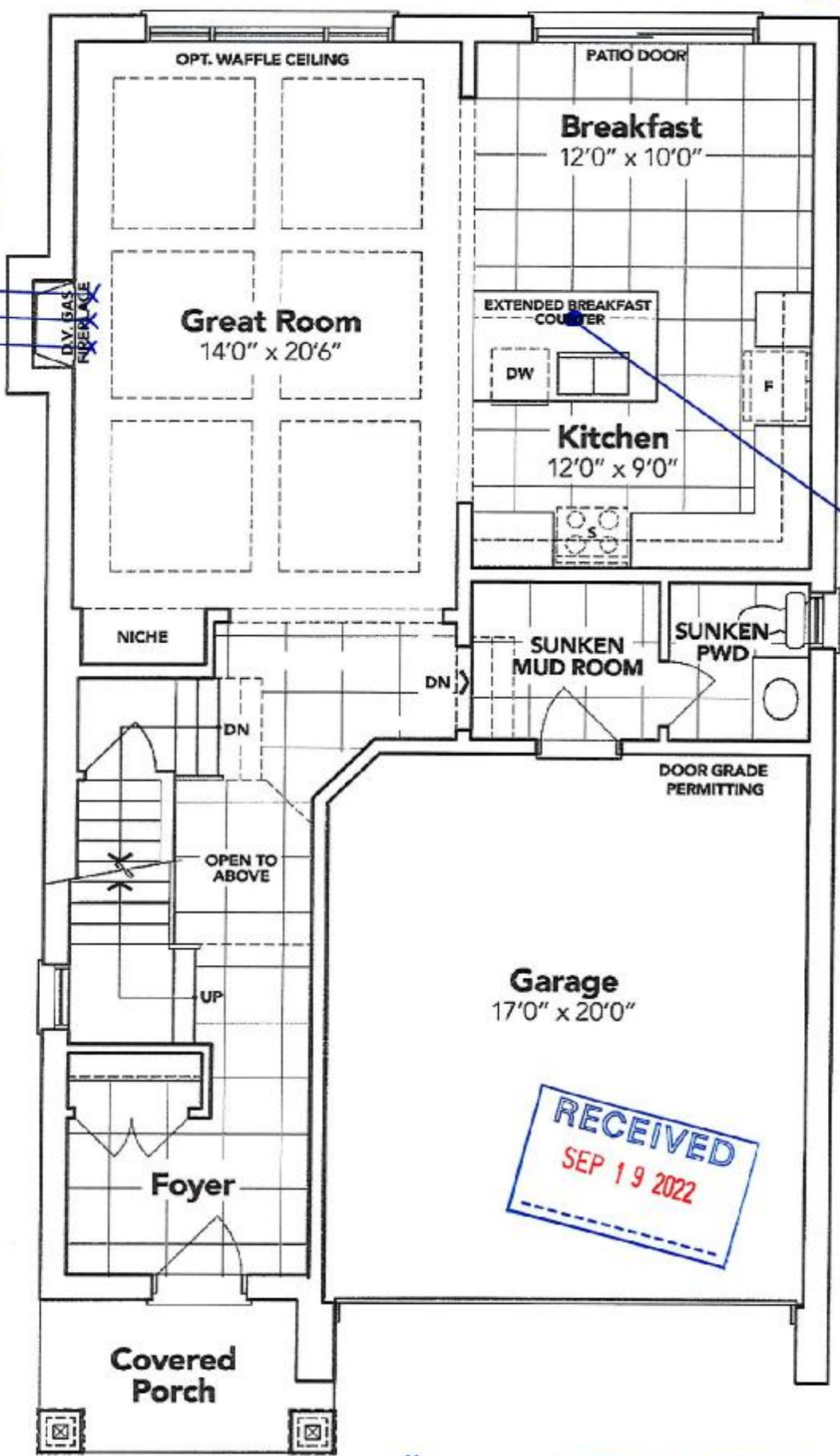

rapped elec. on
a sep. switch

R

SEE ATTACHED FOR SIGNATURES

GROUND FLOOR EL. C

The floor plans and elevations shown are pre-construction plans and may be revised or improved as necessitated by architectural controls and the construction process. The measurements adhere to the rules and regulations of the TARIION Warranty Corporation's official method for the calculation of floor area. Materials, specifications and floor plans are subject to change without notice. All house renderings are artist's concept only. Actual usable floor space may vary from the stated floor area. All options shown are upgrades. E. & O. E.

SCHEDULE "B-1"
Floor Plan

Lot 87
Phase 5A
Model: James (3601) Elev C 4 Bed - 2+1 Bath
Standard

Sketch #2

Back of Drawers

*Relocated
Stair Light*

Back of Drawers

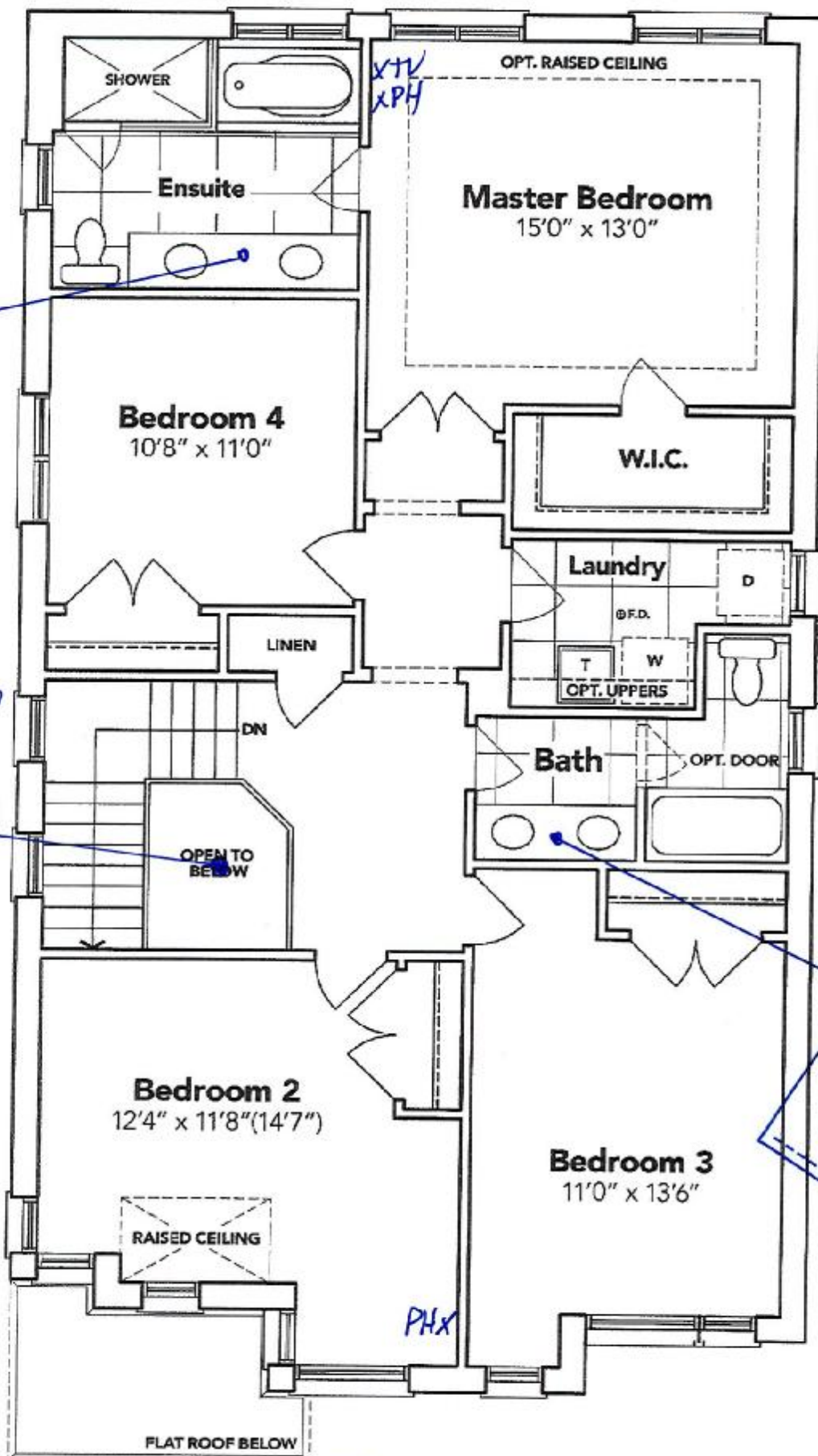

RECEIVED
SEP 19 2022

α SEE ATTACHED FOR SIGNATURES

SECOND FLOOR EL. C

The floor plans and elevations shown are pre-construction plans and may be revised or improved as necessitated by architectural controls and the construction process. The measurements adhere to the rules and regulations of the TARIION Warranty Corporation's official method for the calculation of floor area. Materials, specifications and floor plans are subject to change without notice. All house renderings are artist's concept only. Actual usable floor space may vary from the stated floor area. All options shown are upgrades. E. & O. E.

SCHEDULE "B-1"
Floor Plan

Lot 87
Phase 5A
Model: James (3601) Elev C 4 Bed - 2+1 Bath
Standard

sketch
#3

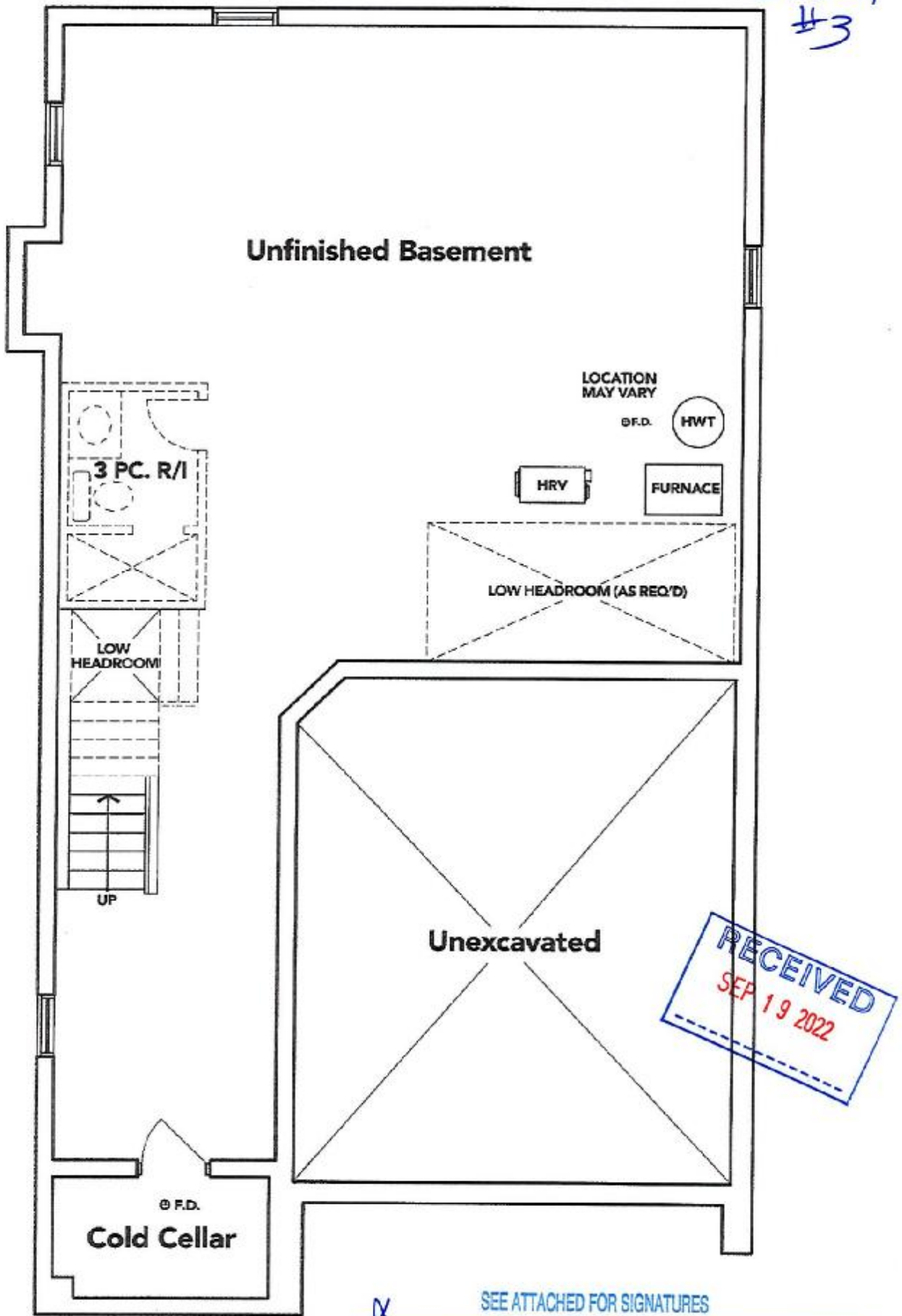

BASEMENT EL. C

The floor plans and elevations shown are pre-construction plans and may be revised or improved as necessitated by architectural controls and the construction process. The measurements adhere to the rules and regulations of the TARIION Warranty Corporation's official method for the calculation of floor area. Materials, specifications and floor plans are subject to change without notice. All house renderings are artist's concept only. Actual usable floor space may vary from the stated floor area. All options shown are upgrades. E. & O. E.

LOT 87 THAMES PH. 5 A
RE: UPGRADED UNDER MOUNT VANITY SINKS
FOR POWDER ROOM AND MASTER ENSUITE
ONLY.

CATENA
RECTANGULAR UNDERMOUNT SINK

4210C17 Undermount Sink

PRODUCT SPECS:

- White solid
- Front overflow hole
- Template and mounting hardware supplied

DIMENSIONS:

Outer:

510mm W x 390mm D x 160mm H
20" W x 15 1/2" D x 7 1/2" H

Inner:

450mm W x 340mm D x 100mm H
18" W x 14" D x 5 1/2" H

COMPLIANCE CERTIFICATIONS

- Meets or exceeds the following:
- IAPMO cUPC
 - ASME A112.19.2 / CSA B45.1
 - DBC Section 3.8 Barrier Free design and CSA B58 Standard

SHIPPING

Cases 1/22
GW 27 lbs

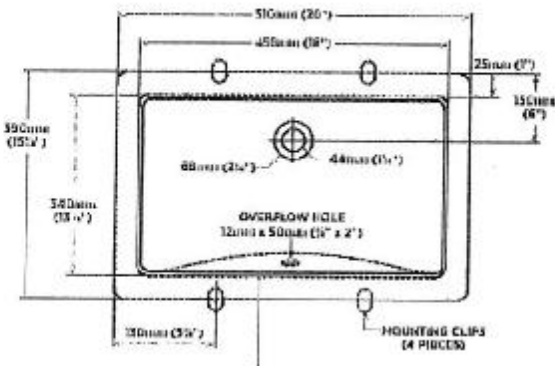

TO BE SPECIFIED

- Sink 171 to

NOTES: Dimensions of Catena rectangular undermount sink with overflow hole are as shown. All dimensions are in millimeters (mm) and inches (in). Dimensions are subject to change without notice. For more information, please contact the manufacturer. The manufacturer is not responsible for any damage or injury caused by the use of the product. The manufacturer is not responsible for any damage or injury caused by the use of the product. The manufacturer is not responsible for any damage or injury caused by the use of the product.

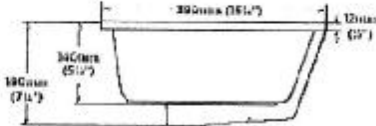

X

SEE ATTACHED FOR SIGNATURES

RECEIVED
SEP 19 2022