

Lindsay 2017 Developments Inc. / Sugarwood

**Lot/Unit: 123 Block 84 Phase/Building: 1 Model/Floor Plan: Balsam Lake(2003)Elev A Opt
Ensuite 3Bed 2.5Bath**

CABINETRY

Inv.5697	1 - To accomodate for the 30" chimney hoodfan...	
Line 72993	Note:	
8Aug22 / 17Aug22		
Inv.5697	1 - To supply and install deep fridge uppers in the kitchen.. see sketch #2	
Line 72994	Note:	
8Aug22 / 17Aug22		

COUNTER TOP

Inv.5697	1 - As per Schedule "PE": Quartz Kitchen countertops with undermount sink (as per plan-builders standard line)	
Line 72981	Note:	
8Aug22 / 17Aug22		

ELECTRICAL

Inv.5697	1 - To supply and install the standard T.V Rough-in, in the Great Room and Master Bedroom.. see sketch #2	
Line 72982	Note:	
8Aug22 / 17Aug22		
Inv.5697	1 - To supply and install the standard PHONE (CAT 5) Rough-in, in the Great Room, Master Bedroom and Bedroom #3.. see sketch #2	
Line 72983	Note:	
8Aug22 / 17Aug22		
Inv.5697	1 - To SUPPLY AND INSTALL EXTRA CEILING BOX ROUGH IN CAPPED (ON A SEP SWITCH) over the breakfast bar in the kitchen.. see sketch #2	
Line 72990	Note:	
8Aug22 / 17Aug22		
Inv.5697	1 - To SUPPLY AND INSTALL A CAPPED CEILING LIGHT BOX, WITH 3 WAY SWITCH in the open to below area.. see sketch #2	
Line 72991	Note:	
8Aug22 / 17Aug22		
Inv.5697	1 - To supply and install the UPGRADE CHIMNEY HOODFAN 30" SCB-722 STAINLESS in the kitchen in lieu of the standard.. see spec's	
Line 72992	Note:	
8Aug22 / 17Aug22		

HARDWOOD

Inv.5697	1 - To supply and install 3 1/2" elements oak natural hardwood to the main hallway in lieu of the standard carpet.. see colour chart for details	
Line 72995	Note:	
8Aug22 / 17Aug22		
Inv.5697	1 - To supply and install 3 1/2" elements oak natural hardwood to the GREAT ROOM in lieu of the standard carpet.. see colour chart for details	
Line 72996	Note:	
8Aug22 / 17Aug22		

Lindsay 2017 Developments Inc. / Sugarwood

**Lot/Unit: 123 Block 84 Phase/Building: 1 Model/Floor Plan: Balsam Lake(2003)Elev A Opt
Ensuite 3Bed 2.5Bath**

Inv.5697	1 - To supply and install 3 1/2" elements oak natural hardwood to the UPPER hallway in lieu of the standard carpet.. see colour chart for details	
Line 72997	Note:	
8Aug22 / 17Aug22		

HEATING AND AIR CONDITIONING

Inv.5697	1 - As per Schedule "PE": Central air conditioner (BUILDERS STANDARD LINE)	
Line 72979	Note:	
8Aug22 / 17Aug22		

MISCELLANEOUS

RAILING

Inv.5697	1 - To supply and install Upgrade #1: Metal Pickets in lieu of the standard.. see colour chart for details	
Line 73002	Note:	
8Aug22 / 17Aug22		

STAIRS AND RAILINGS

Inv.5697	1 - As per Schedule "PE": Oak Stairs (main floor to second floor) natural finish, as per plan-Builders standard line	
Line 72980	Note:	
8Aug22 / 17Aug22		

TILE

Inv.5697	1 - To supply and install upgrade #3 Floor Tile STACKED to the foyer in lieu of the standard.. see colour chart for details	
Line 72998	Note: SEE SKETCH #2 FOR TILE DIRECTION	
8Aug22 / 17Aug22		
Inv.5697	1 - To supply and install Upgrade #3 Floor Tile STACKED to the PWD in lieu of the standard.. see colour chart for details	
Line 72999	Note: SEE SKETCH #2 FOR TILE DIRECTION	
8Aug22 / 17Aug22		
Inv.5697	1 - To supply and install upgrade #3 Floor Tile STACKED to the KITCHEN AND BREAKFAST AREA in lieu of the standard.. see colour chart for details	
Line 73000	Note: SEE SKETCH #2 FOR TILE DIRECTION	
8Aug22 / 17Aug22		
Inv.5697	1 - To supply and install upgrade #3 FloorTile STACKED to the MASTER ENSUITE (Including the tub deck, surround and apron) in lieu of the standard.. see colour chart for details	
Line 73001	Note: SEE SKETCH #2 FOR TILE DIRECTION	
8Aug22 / 17Aug22		



CONSTRUCTION SUMMARY

Lindsay 2017 Developments Inc. / Sugarwood

Lot/Unit: 123 Block 84 Phase/Building: 1 Model/Floor Plan: Balsam Lake(2003)Elev A Opt
Ensuite 3Bed 2.5Bath
EXTRAS AS PER OFFER

CENTRAL AIR CONDITIONER (BUILDERS STANDARD LINE) <i>Worksheet</i> Note:	
5 APPLIANCE PACKAGE: STAINLESS STEEL FRIDGE, STOVE, BUILT-IN DISHWASHER: WHITE WASHER / DRYER (BUILDERS STANDARD LINE) <i>Worksheet</i> Note:	
OAK STAIRS (MAIN FLOOR TO SECOND FLOOR) NATURAL FINISH: AS PER PLAN - BUILDERS STANDARD LINE <i>Worksheet</i> Note:	
QUARTZ KITCHEN COUNTERTOPS WITH UNDERMOUNT SINK (AS PER PLAN - BUILDERS STANDARD LINE) <i>Worksheet</i> Note:	



INTERIOR COLOUR SCHEME

Lindsay PH-1 Lot 1V3

Purchasers: AMARDEEP SINGH & RAJWINDER KAUR SAN Property: 123 Block 84 of Plan -
Telephone Res. / Bus: (905) 693-2867 / Project: Lindsay 2017 Developments Inc.
Decor Advisor: Samantha Castelli Model and Elevation: Balsam Lake(2003)Elev A Opt Ensuite 3Be
Layout Changes: ☐ Yes ☒ No Sketch Attached: ☒ Yes ☐ No Exterior Colour Scheme:

1. Cabinetry

	Style and Colour	Counter Top	Hardware
Kitchen / Breakfast	#3 Simcoe Orchid	#1 C/S #9141 ICE SNOW	12281 HANDLE
Kitchen Island	#3 Simcoe Orchid	#1 C/S #9141 ICE SNOW	12281 HANDLE
Laundry Room			
Powder Room	#3 Simcoe Orchid	Paloma Polar 6698-46	12281 HANDLE
Main Bathroom	#3 Simcoe Orchid	Paloma Polar 6698-46	12281 HANDLE
Master Ensuite Bathroom	#3 Simcoe Orchid	Paloma Polar 6698-46	12281 HANDLE
Second Ensuite Bathroom (If Applicable)			

Appliances Custom Size Fridge Valance Lighting Microwave / Range Hood
☐ Yes ☒ No ☐ Yes ☒ No ☐ Yes ☒ No
Cooktop / Rangetop Built in Wall Oven Slide-in Range
☐ Yes ☒ No ☐ Yes ☒ No ☐ Yes ☒ No

Comment

2. Flooring

	Selection
Foyer	*UPG #3: 12x24" Mayfair Calacatta Oro HD Polished Rect. Por Tile STACKED
Main Hall	*3 1/2" Elements Oak Natural
Back Hall	
Breakfast	*UPG #3: 12x24" Mayfair Calacatta Oro HD Polished Rect. Por Tile STACKED
Laundry Room	
Kitchen	*UPG #3: 12x24" Mayfair Calacatta Oro HD Polished Rect. Por Tile STACKED
Powder Room	*UPG #3: 12x24" Mayfair Calacatta Oro HD Polished Rect. Por Tile STACKED
Main Bathroom	13x13" Keaton Ice
Master Ensuite	*UPG #3: 12x24" Mayfair Calacatta Oro HD Polished Rect. Por Tile STACKED
Bathroom (If Applicable)	
Mud Room	
Master Ensuite. SH/FL	2x2" Ontario Snow White Matte
Living Room	
Dining Room	
Family / Great Room	*3 1/2" Elements Oak Natural
Den / Library / Study	
Basement Landing (If Applies)	
Lower Landing (If Applicable)	
Upper Landing	*3 1/2" Elements Oak Natural
Upper Hall	**3 1/2" Elements Oak Natural
Master Bedroom	Modern Story 1: 809 Gondola
Bedroom #2	Modern Story 1: 809 Gondola
Bedroom #3	Modern Story 1: 809 Gondola
Bedroom #4	
Bedroom #5	
Master Ens. Shower Jamb	Anatolia Marmiline SNOW



Flooring Continued on Page 2

ASR KS

Initial:

Page 1 of 3

KINGSIIEN
GROUP INC.

INTERIOR COLOUR SCHEME

Lindsay ph.1 tot 123

Purchasers: AMARDEEP SINGH & RAJWINDER KAUR SAN **Property:** 123 Block 84 of Plan -
Telephone Res. / Bus: (905) 693-2867 / **Project:** Lindsay 2017 Developments Inc.
Decor Advisor: Samantha Castelli **Model and Elevation:** Balsam Lake(2003)Elev A Opt Ensuite 3Be
2. Flooring - Continued -

Upgrade Underpad	Type	Area
	STANDARD	Master, Bedroom #2 and #3
Carpet on Stairs	Capped	Runner - *Upgrade
Comment		

3. Plumbing Fixtures / Faucets

Kitchen	STANDARD	Second Ensuite	<input type="checkbox"/>	Powder Room	STANDARD
Master Ensuite	STANDARD			Other Room	<input type="checkbox"/>
Main Bathroom	STANDARD		<input type="checkbox"/>		



Comment

NOTE: To supply and install the standard undermount kitchen sink, with the standard faucet in the kitchen. To supply and install the standard topmount bathroom sinks, with the standard faucets in all bathrooms.

4. Wall Tile

	Tile Selection	Listello	Insert	Insert Selection
Main Bathroom	8x10" Keaton Ice	<input type="checkbox"/>	<input type="checkbox"/>	
Master Ensuite				
Tub Deck	12x24" Mayfair Calacatta Oro HD Polished Rect. Por Tile	<input type="checkbox"/>	<input type="checkbox"/>	
Tub Apron	12x24" Mayfair Calacatta Oro HD Polished Rect. Por Tile	<input type="checkbox"/>	<input type="checkbox"/>	
Tub Surround	12x24" Mayfair Calacatta Oro HD Polished Rect. Por Tile	<input type="checkbox"/>	<input type="checkbox"/>	
Shower Stall	8x10" Cinq Black	<input type="checkbox"/>	<input type="checkbox"/>	
Second Ensuite		<input type="checkbox"/>	<input type="checkbox"/>	
		<input type="checkbox"/>	<input type="checkbox"/>	
		<input type="checkbox"/>	<input type="checkbox"/>	
Kitchen Backsplash		<input type="checkbox"/>	<input type="checkbox"/>	
Complete Backsplash		<input type="checkbox"/>	<input type="checkbox"/>	

Comment

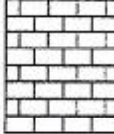
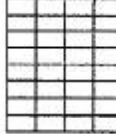

horizontal stacked brick pattern vertical stacked diagonal/diamond

5. Fireplace

	Living Room			Family Room			Other Room - Specify		
	Purchased	As Per Plan	N/A	Purchased	As Per Plan	N/A	Purchased	As Per Plan	N/A
Fireplace Type	<input type="radio"/>	<input type="radio"/>	<input checked="" type="radio"/>	<input type="radio"/>	<input type="radio"/>	<input checked="" type="radio"/>	<input type="radio"/>	<input type="radio"/>	<input checked="" type="radio"/>
Mantle Type									
Over Mantle									
Colour / Stain									
Surround									
Hearth									
Comment									

RECU/RECEIVED
23-08-2022

Initial: 

Page 2 of 3

KINGSMEN
GROUP INC.

INTERIOR COLOUR SCHEME

Lindsay PH.T Lot 123

Purchasers: AMARDEEP SINGH & RAJWINDER KAUR SAN **Property:** 123 Block 84 of Plan -
Telephone Res. / Bus: (905) 693-2867 / **Project:** Lindsay 2017 Developments Inc.
Decor Advisor: Samantha Castelli **Model and Elevation:** Balsam Lake(2003)Elev A Opt Ensuite 3Be

6. Trim Carpentry

Door Hardware Standard Handle

Interior Trim Standard

Comment

Interior Doors

☐ 2 Panel Arch Top☒ 2 Panel Square Top☐ 6 Panel

Initial for Door Style

7. Railings and Pickets

Railing Package *UPG #1: Metal Package

Railing Colour Elements Natural

Picket Colour Black Metal

Wood Stairs ☐ No ☒ Oak

Tread Colour Elements Natural

Comment

8. Plaster Mouldings and Medallions

Foyer

Main Hall

Living Room

Dining Room

Family Room

Kitchen/Breakfast

Den/Library

Lower Landing

Comment

9. Wall Paint

Kingsmen White

Smooth Ceilings

☐ First Floor☐ First Floor incl. Second Floor Hall☐ First and Second Floor☒ Throughout☐ Not Applicable

Trim Paint Kingsmen White

10. Additional Comments

REQ/RECEIVED

23-08-2022

11. Disclaimers and Notes

- Colours of all materials are as close as possible to builder's selection, but not necessarily identical due to variances in manufacturing.
- Any extras listed above are null and void unless accompanied by a separate invoice/amendment. Said invoice must be paid in full.
- The Purchaser acknowledges that after Interior Colour Selection form is signed and dated, no further changes will be permitted other than re-selection due to unavailability. AS Purchaser's Initials
- The Purchaser acknowledges reading and accepting the "Kingsmen Group Décor Centre Disclaimers" form. This document contains other miscellaneous disclaimers.

This Interior Colour Selection is final and approved by:

Purchaser: AS Date: 8/17/2022Signature: Amardeep Date: 8/18/2022

C246185A4B85436...

Signature: RKS Date: 8/18/2022

15467F8CF54049D...

Vendor:

Lindsay 2017 Developments Inc.

August 25/22

SUGARWOOD LOT 123 PH 1
RE: SKETCH #2

REC'D/RECEIVED
23-08-2022

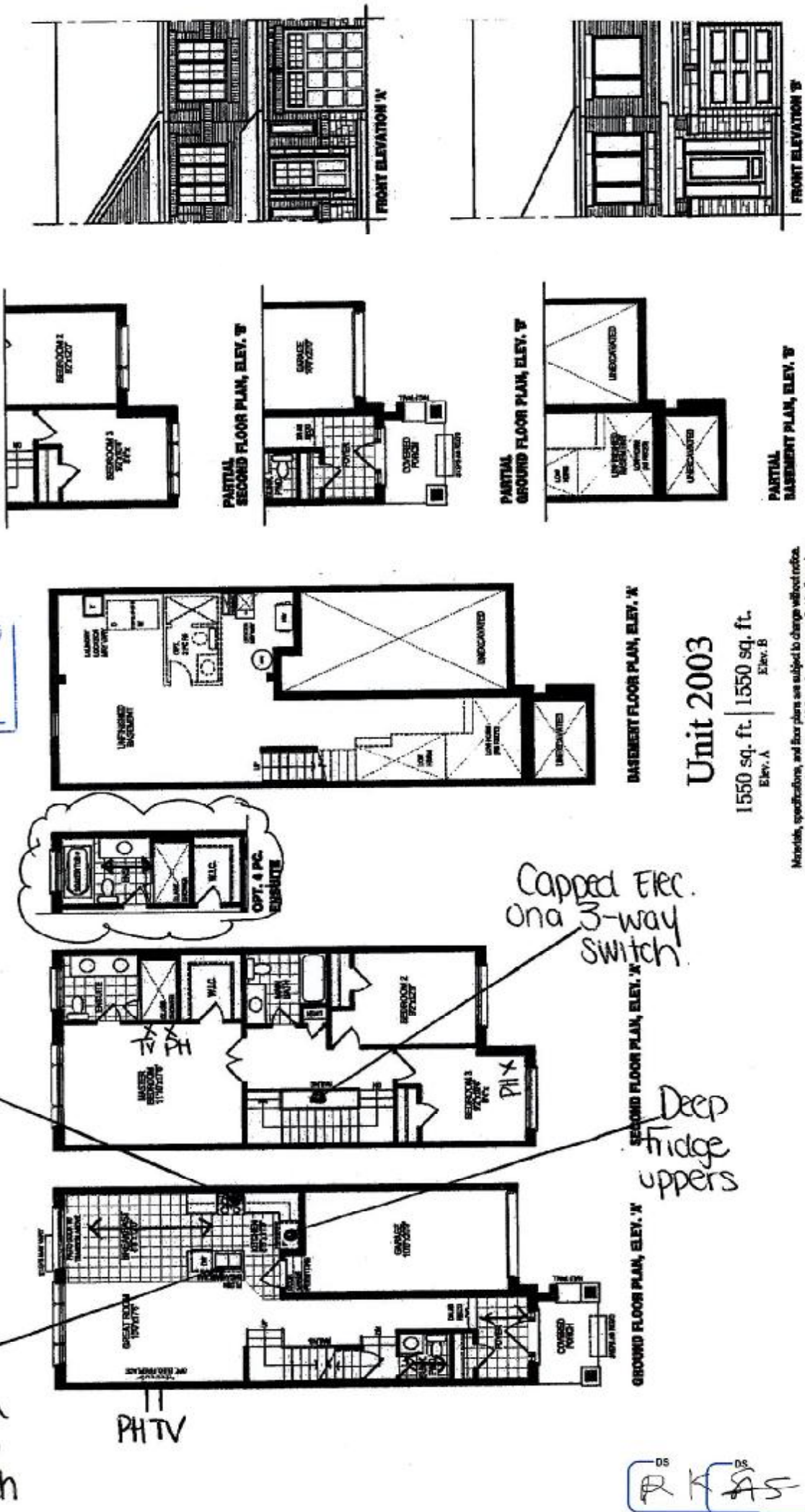

Materials, specifications, and floor plans are subject to change without notice. All renderings are artist conceptions. All floor plans are approximate dimensions. Actual usable floor space may vary from the stated floor area. F. & E.O.

The floor plans and elevations shown are pre-construction plans and may be revised or improved as needed during the construction process. The measurements adhere to the rules and regulations of the TARIION. Materials, specifications and floor plans are subject to change w

SUGARWOOD LOT 123 PH 1
RE: UPG HOODFAN

REQD/RECEIVED
23-08-2022

SCB-722 30" CHIMNEY HOODFAN
STAINLESS STEEL

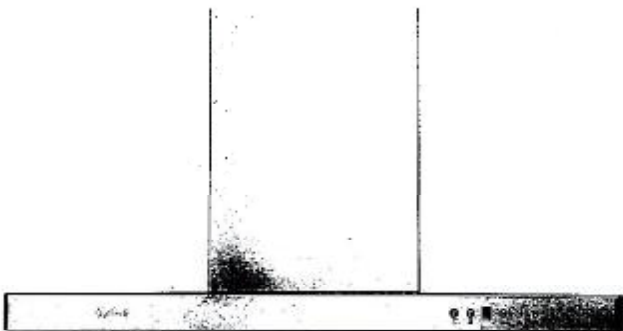

AS^{DS} RKS