

KINGSMEN (THAMES) INC. / Havelock Corners (Kingsmen)

Lot/Unit: 51 Phase/Building: 5A Model/Floor Plan: James (3601) Elev B 4 Bed - 2+1 Bath

CABINETRY VANITY

Inv.5693	1 - To supply & install a VANITY BANK OF DRAWERS - in the master ensuite bathroom... see sketch # 2	
Line 72957	Note:	
4Aug22 / 4Aug22		

Inv.5693	1 - To supply & install a VANITY BANK OF DRAWERS - in the main bathroom... see sketch # 2	
Line 72958	Note:	
4Aug22 / 4Aug22		

COUNTER TOP

Inv.5693	1 - As per schedule "PE": Vendor to include level 1, 2cm. quartz in all bathrooms, as per plan, in lieu of the included laminate counter tops. Selections to be made from builders standard samples.	
Line 72937	Note:	
4Aug22 / 4Aug22		

ELECTRICAL

Inv.5693	1 - To supply & install the standard T.V. rough in in the great room and master bedroom... see sketch # 1 & # 2	
Line 72938	Note: Install the standard T.V. rough in at approx. 66" + - up from the floor centered + - to the F/P mantle.	
4Aug22 / 4Aug22		

Inv.5693	1 - To supply & install the standard Phone (CAT 5) rough in in the great room, master bedroom & bedroom # 2 ... see sketch # 1 & # 2	
Line 72939	Note: Install the standard Phone (CAT 5) rough in at approx. 66" + - up from the floor centered + - to the F/P mantle.	
4Aug22 / 4Aug22		

Inv.5693	1 - To SUPPLY AND INSTALL AN ADDITIONAL BASIC RECEPTACLE (NOT DEDICATED) at approx. 66" + - up from the floor centered + - to the F/P mantle	
Line 72955	Note: in the great room... see sketch # 1	
4Aug22 / 4Aug22		
This is for a futue wall mount T.V.		
NO CONDUIT PIPE HAS BEEN PURCHASED.		

Inv.5693	1 - Relocate the standard ceiling light from the upper stair landing to the O.T.B. area on the second floor... see sketch # 2	
Line 72956	Note:	
4Aug22 / 4Aug22		

HEATING AND AIR CONDITIONING

Inv.5693	1 - As per schedule "PE": Vendor to install capped gas line (rough in only) at rear of house for future BBQ location. Location to be finalized at vendors sole discretion.	
Line 72935	Note:	
4Aug22 / 4Aug22		

Inv.5693	1 - As per schedule "PE": Vendor to supply & install air conditioning unit, sized accordingly, from vendors standard samples.	
Line 72936	Note:	
4Aug22 / 4Aug22		

MISCELLANEOUS

KINGSMEN (THAMES) INC. / Havelock Corners (Kingsmen)

Lot/Unit: 51 Phase/Building: 5A Model/Floor Plan: James (3601) Elev B 4 Bed - 2+1 Bath

PLUMBING

Inv.5693	1 - To supply & install the KITCHEN SINK - BLANCO QUATRUS U2 DBL UNDERMOUNT MODEL 401247 in the kitchen in lieu of the standard top mount kitchen sink... see spec's	
Line 72960	Note: Still to install the standard single hole kitchen faucet NO PLATE.	
4Aug22 / 4Aug22		
Inv.5693	5 - To supply & install the VANITY SINK - CONTRAC CATENA UNDERMOUNT - MODEL 4210CIY in the powder room, master ensuite and main bathroom in lieu of the standard top mount vanity sinks... see spec's	
Line 72962	Note: Still to install the standard lav. faucets.	
4Aug22 / 4Aug22		

EXTRAS AS PER OFFER

5 FREE APPLIANCES – STAINLESS STEEL FRONT - FRIDGE; STOVE AND DISHWASHER. WHITE WASHER AND DRYER (SUPPLIED ONLY, NOT INSTALLED, FROM BUILDERS STANDARD LINE). AN APPLIANCES VOUCHER WILL BE GIVEN BY OUR DECOR CONSULTANT AT THE TIME OF BOOKING YOUR COLOUR A <i>Worksheet</i> Note:	
VENDOR TO INSTALL CAPPED GAS LINE (ROUGH-IN ONLY) AT REAR OF HOME FOR FUTURE BBQ LOCATION. LOCATION TO BE FINALIZED AT VENDORS SOLE DISCRETION. <i>Worksheet</i> Note:	
VENDOR TO SUPPLY & INSTALL AIR CONDITIONING UNIT, SIZED ACCORDINGLY, FROM VENDORS STANDARD SAMPLES. <i>Worksheet</i> Note:	
VENDOR TO INCLUDE LEVEL 1, 2CM QUARTZ IN ALL BATHROOMS, AS PER PLAN, IN LIEU OF THE INCLUDED LAMINATE COUNTER TOPS. SELECTIONS TO BE MADE FROM BUILDERS STANDARD SAMPLES. <i>Worksheet</i> Note:	
VENDOR TO INSTALL GAS LINE (ROUGH-IN ONLY) TO KITCHEN IN AT STOVE LOCATION (AS PER PLAN) TO INCLUDE 110V CODE REQUIREMENT. <i>Worksheet</i> Note:	
VENDOR AGREES TO INCREASE THE SIZE OF THE FRONT DOOR TO 42 INCHES WIDE DOOR, WHICH WILL HAVE NO SIDE LIGHTS OR TRANSOM, AND THE DOOR WILL NOT HAVE A GLASS INSERT <i>Worksheet</i> Note:	

Purchaser: MALWINDER SINGH MANN

Property: 51 of Plan - Draft Approval SB17-03-08

Telephone Res. / Bus: /

Project: KINGSMEN (THAMES) INC.

Decor Advisor: Barbara Coccia

Model and Elevation: James (3601) Elev B 4 Bed - 2+1 Bath

Layout Changes: ☐ Yes ☒ No

Sketch Attached: ☒ Yes ☐ No

Exterior Colour Scheme:

1. Cabinetry

	Style and Colour	Counter Top	Hardware
Kitchen / Breakfast	#3 Simcoe Orchid	#1, C/S # 3040 Cement 3cm.	#12881 Handle
Kitchen Island	#3 Simcoe Orchid	#1, C/S # 3040 Cement 3cm.	#12881 Handle
Laundry Room	/		
Powder Room	#3 Simcoe Orchid	#1 C/S # 3040 Cement 2cm.	#12881 Handle
Main Bathroom	#3, Trinity Viva Weekend Getaway	#1, C/S # 9141 Ice Snow 2cm.	#9661 Handle
Master Ensuite Bathroom	#3 Simcoe Moonlight	#1, C/S # 9141 Ice Snow 2cm.	#9661 Handle
Second Ensuite Bathroom (If Applicable)	/		
	/		
	/		

Appliances

Custom Size Fridge

☐ Yes ☒ No

Valance Lighting

☐ Yes ☒ No

Microwave / Range Hood

☐ Yes ☒ No

Cooktop / Rangetop

☐ Yes ☒ No

Built in Wall Oven

☐ Yes ☒ No

Slide-in Range

☐ Yes ☒ No

Comment

/

2. Flooring

	Selection
Foyer	13 x 13" Malena Ice
Main Hall	13 x 13" Malena Ice
Back Hall	/
Breakfast	13 x 13" Malena Ice
Laundry Room	13 x 13" Cinq Grey
Kitchen	13 x 13" Malena Ice
Powder Room	13 x 13" Malena Ice
Main Bathroom	13 x 13" Cinq Grey
Master Ensuite	13 x 13" Keaton Ice
Bathroom (If Applicable)	/
Mud Room	13 x 13" Malena Ice
Master Ens. Shower floor	2x2" Ontario Snow White Matte
Living Room	/
Dining Room	/
Family / Great Room	3 1/2" Elements Oak Natural
Den / Library / Study	/
Basement Landing (If Applies)	
Lower Landing (If Applicable)	3 1/2" Elements Oak Natural
Upper Landing	(if applicable) 3 1/2" Elements Oak Natural
Upper Hall	Modern Story 1, # 927 Morning Rain
Master Bedroom	Modern Story 1, # 927 Morning Rain
Bedroom #2	Modern Story 1, # 927 Morning Rain
Bedroom #3	Modern Story 1, # 927 Morning Rain
Bedroom #4	Modern Story 1, # 927 Morning Rain
Bedroom #5	/
Master ens. shower jamb	Anatolia Marmilne SNOW



Flooring Continued on Page 2

Initial:

Page 1 of 3

Purchaser: MALWINDER SINGH MANN

Property: 51 of Plan - Draft Approval SB17-03-08

Telephone Res. / Bus: /

Project: KINGSMEN (THAMES) INC.

Decor Advisor: Barbara Coccia

Model and Elevation: James (3601) Elev B 4 Bed - 2+1 Bath

2. Flooring - Continued -

Upgrade Underpad	Type Standard	Area 2nd. Floor
Carpet on Stairs	Capped	Runner - *Upgrade
Comment	/	/

3. Plumbing Fixtures / Faucets

Kitchen	Standard	Second Ensuite	/	Powder Room	Standard
Master Ensuite	Standard			Other Room	/
Main Bathroom	Standard				

Comment

Purchaser has upgraded to an under mount kitchen sink, still to install the standard single hole kitchen faucet NO PLATE.
Purchaser has upgraded to under mount sinks in ALL bathrooms, still to install the standrd lav faucets.

4. Wall Tile

	Tile Selection	Listello	Insert	Insert Selection
Main Bathroom	8x10" Cinq Grey	<input type="checkbox"/>	<input type="checkbox"/>	
Master Ensuite				
Tub Deck	13 x13" Keaton Ice	<input type="checkbox"/>	<input type="checkbox"/>	
Tub Apron	13 x13" Keaton Ice	<input type="checkbox"/>	<input type="checkbox"/>	
Tub Surround	13 x13" Keaton Ice	<input type="checkbox"/>	<input type="checkbox"/>	
Shower Stall	8x10" Keaton Ice	<input type="checkbox"/>	<input type="checkbox"/>	
Second Ensuite	/	<input type="checkbox"/>	<input type="checkbox"/>	
	/	<input type="checkbox"/>	<input type="checkbox"/>	
	/	<input type="checkbox"/>	<input type="checkbox"/>	
Kitchen Backsplash	/	<input type="checkbox"/>	<input type="checkbox"/>	
Complete Backsplash	/	<input type="checkbox"/>	<input type="checkbox"/>	

Comment

/

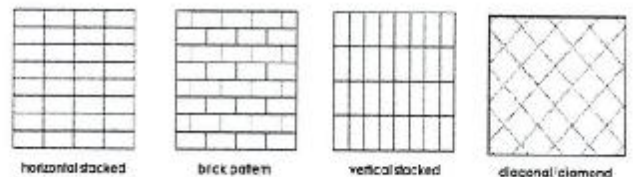

5. Fireplace

	Living Room			Family Room			Other Room - Specify Great room		
	Purchased	As Per Plan	N/A	Purchased	As Per Plan	N/A	Purchased	As Per Plan	N/A
Fireplace Type	<input type="radio"/>	<input type="radio"/>	<input checked="" type="radio"/>	<input type="radio"/>	<input type="radio"/>	<input checked="" type="radio"/>	<input type="radio"/>	<input checked="" type="radio"/>	<input type="radio"/>
Mantle Type							Front Facing		
Over Mantle							NF-08		
Colour / Stain							/		
Surround							White		
Hearth							/		
Comment							/		



Initial: 

Purchaser: MALWINDER SINGH MANN

Property: 51 of Plan - Draft Approval SB17-03-08

Telephone Res. / Bus: /

Project: KINGSMEN (THAMES) INC.

Decor Advisor: Barbara Coccia

Model and Elevation: James (3601) Elev B 4 Bed - 2+1 Bath

6. Trim Carpentry

Door Hardware Standard handle

Interior Trim Standard

Comment

/

Interior Doors

☐ 2 Panel Arch Top

☒ 2 Panel Square Top

☐ 6 Panel

Initial for Door Style



7. Railings and Pickets

Railing Package Standard Oak TURNED picket package

Railing Colour Elements Natural

Wood Stairs ☐ No ☒ Oak

Comment

/

Picket Colour Elements Natural

Tread Colour Elements Natural

8. Plaster Mouldings and Medallions

Foyer /

Main Hall /

Living Room /

Dining Room /

Family Room /

Comment

/

Kitchen/Breakfast /

Den/Library /

Lower Landing /

9. Wall Paint

Kingsmen White

Smooth Ceilings

☐ First Floor

☐ First Floor incl. Second Floor Hall

☐ First and Second Floor

☒ Throughout

☐ Not Applicable

Trim Paint Kingsmen White

10. Additional Comments

/



11. Disclaimers and Notes

- Colours of all materials are as close as possible to builder's selection, but not necessarily identical due to variances in manufacturing.
- Any extras listed above are null and void unless accompanied by a separate invoice/amendment. Said invoice must be paid in full.
- The Purchaser acknowledges that after Interior Colour Selection form is signed and dated, no further changes will be permitted other than re-selection due to unavailability. Purchaser's Initials
- The Purchaser acknowledges reading and accepting the "Kingsmen Group Décor Centre Disclaimers" form. This document contains other miscellaneous disclaimers.

This Interior Colour Selection is final and approved by:

Purchaser:

Signature: Mahinder Singh Mann **Date:** 08/04/22

Vendor:

KINGSMEN (THAMES) INC.

Aug 8/22

SCHEDULE "B-1"
Floor Plan

Lot 51
Phase 5A
Model: James (3601) Elev B 4 Bed - 2+1 Bath
Standard

Sketch #1

all items @
PH TV 66" up from floor

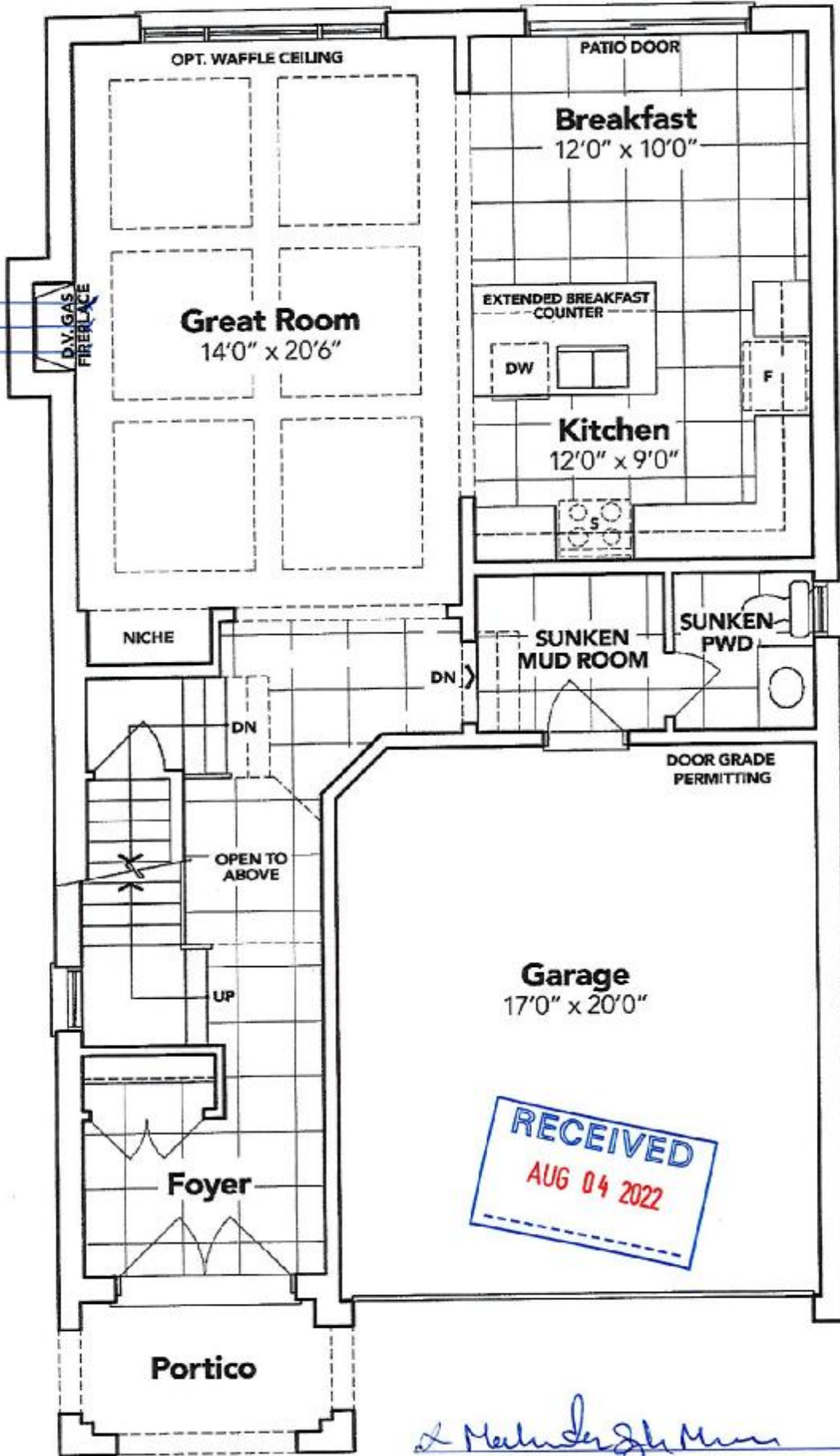

GROUND FLOOR EL. B

The floor plans and elevations shown are pre-construction plans and may be revised or improved as necessitated by architectural controls and the construction process. The measurements adhere to the rules and regulations of the TARION Warranty Corporation's official method for the calculation of floor area. Materials, specifications and floor plans are subject to change without notice. All house renderings are artist's concept only. Actual usable floor space may vary from the stated floor area. All options shown are upgrades. E. & O. E.

SCHEDULE "B-1"
Floor Plan

Lot 51
Phase 5A
Model: James (3601) Elev B 4 Bed - 2+1 Bath
Standard

Sketch #2

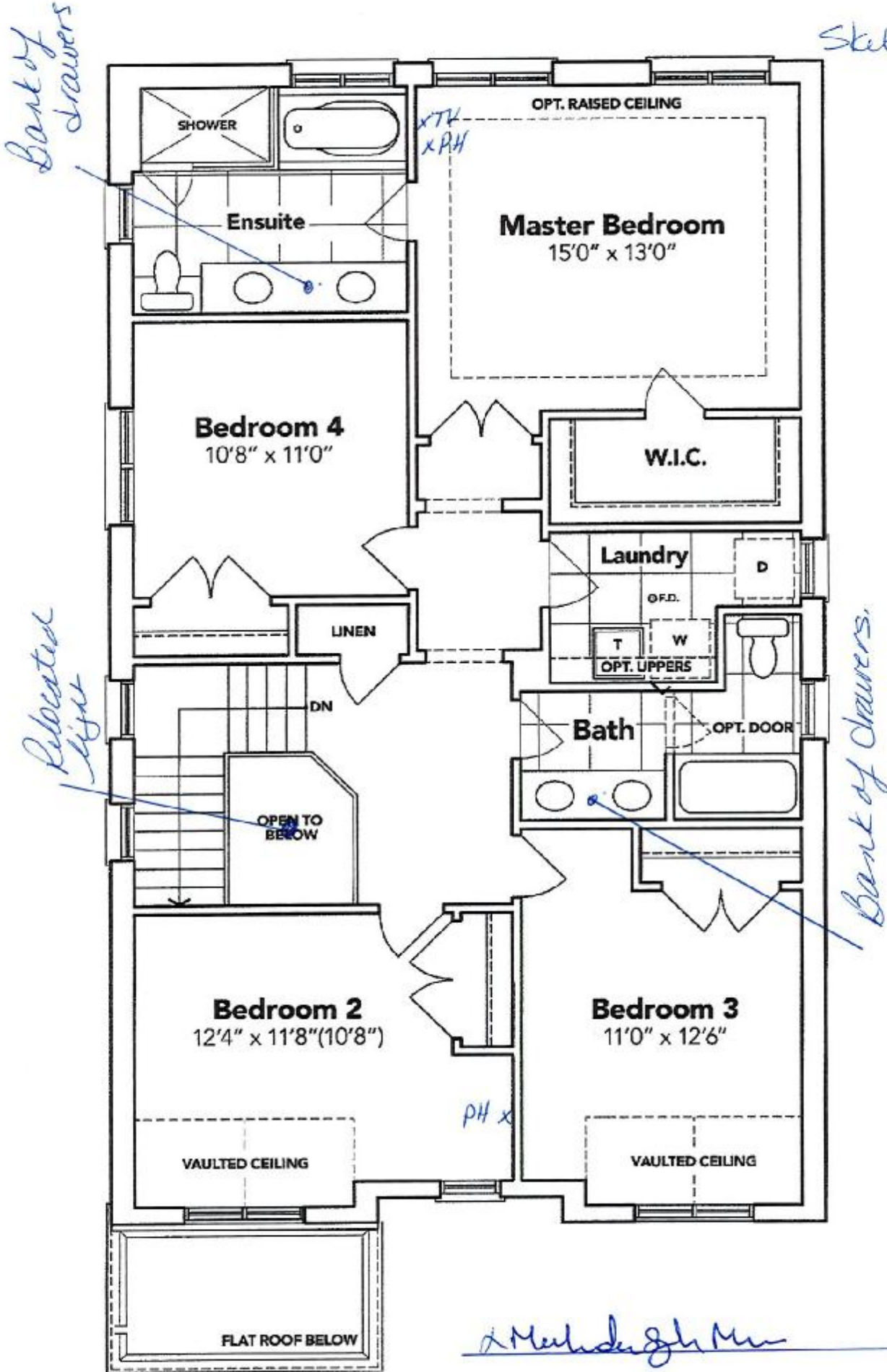

SECOND FLOOR EL. B

The floor plans and elevations shown are pre-construction plans and may be revised or improved as necessitated by architectural controls and the construction process. The measurements adhere to the rules and regulations of the TARION Warranty Corporation's official method for the calculation of floor area. Materials, specifications and floor plans are subject to change without notice. All house renderings are artist's concept only. Actual usable floor space may vary from the stated floor area. All options shown are upgrades. E. & O. E.

RECEIVED

AUG 04 2022

SCHEDULE "B-1" - Page 2 of 3

Initials: *(Signature)*

SCHEDULE "B-1"
Floor Plan

Lot 51
Phase 5A
Model: James (3601) Elev B 4 Bed - 2+1 Bath
Standard

Sketch #3

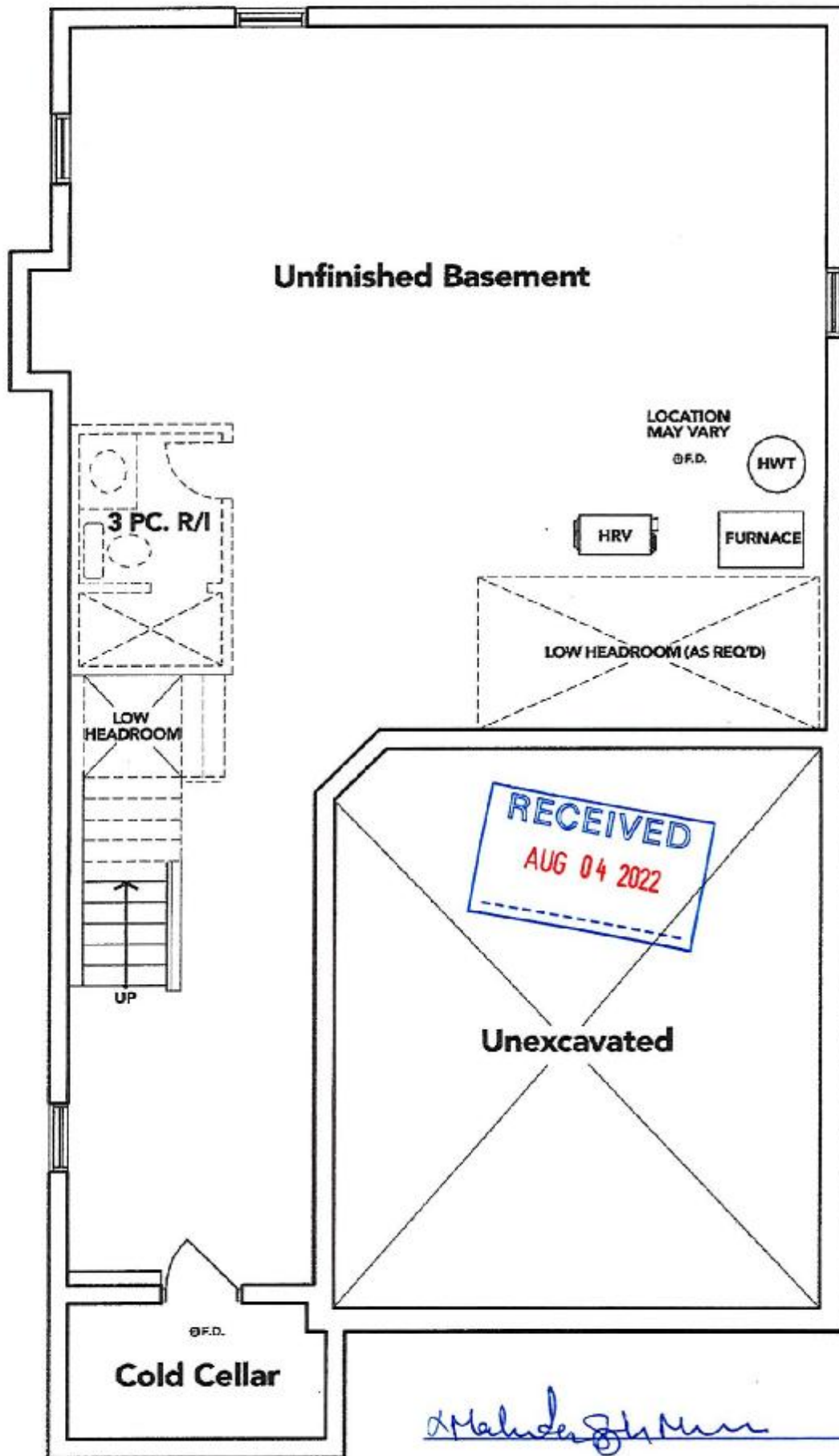

BASEMENT EL. B

The floor plans and elevations shown are pre-construction plans and may be revised or improved as necessitated by architectural controls and the construction process. The measurements adhere to the rules and regulations of the TARION Warranty Corporation's official method for the calculation of floor area. Materials, specifications and floor plans are subject to change without notice. All house renderings are artist's concept only. Actual usable floor space may vary from the stated floor area. All options shown are upgrades. E. & O. E.

LOT 51 THAMES PH. 5A
RE: UPGRADED UNDERMOUNT KITCHEN
SINK.

BLANCO

Sink Specifications

Colour	SKU
brushed finish	401247

QUATRUS U 2

Design and planning tips

- Min cabinet size: 36 in (915 mm)
- Bowl Depth: 9 in (230.0 mm)

Specifications:
Installation clips, Sink template, Installation instructions, 3
½" (90 mm) stainless steel strainers

Depending on cabinet construction, a different cabinet
size may be required. Consult the cabinet manufacturer.

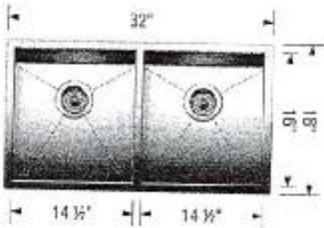

X. Mahdighani



LOT: 51 THAMES PH.5
RE: UPGRADED UNDERMOUNT SINKS
FOR ALL BATHROOMS

CATENA
RECTANGULAR UNDERMOUNT SINK

4210CIV Undermount Sink

PRODUCT SPECS:

- Vitreous china
- Front overflow hole
- Template and mounting hardware supplied

DIMENSIONS:

Outer:
510mm W x 390mm D x 190mm H
20" W x 15 1/4" D x 7 1/2" H
Inner:
458mm W x 340mm D x 140mm H
18" W x 13 1/4" D x 5 1/2" H

COMPLIANCE CERTIFICATIONS

Meets or exceeds the following:
- IAPMO cUPC
- ASME A12.19.2 / CSA B45.1
- OBC Section 3.8 Barrier Free design and CSA B55.1 Standard

SHIPPING

Cube 1.72
GW 27 lbs

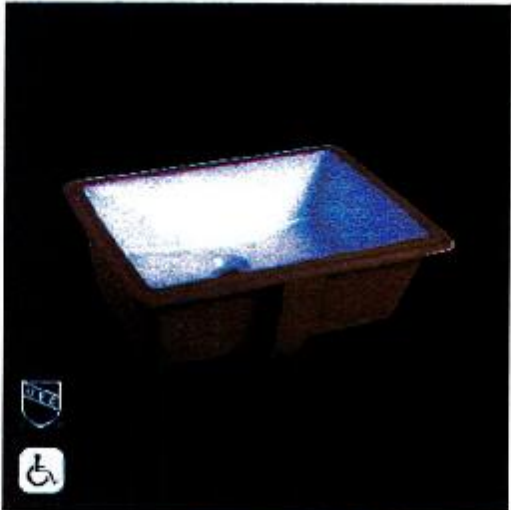
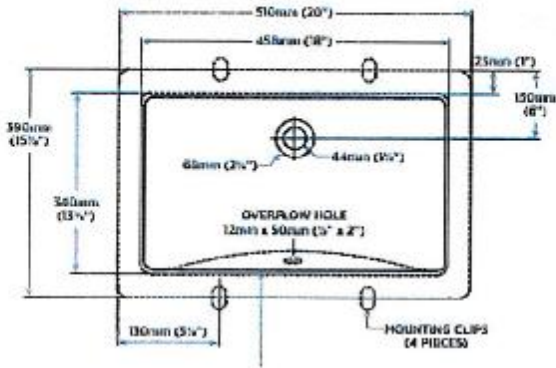

TO BE SPECIFIED
C/C/L
Soft 5\" x 10"

NOTES: Undermount of basins are normal and only vary with the range of dimensions established by ASME standard A12.19.2. These measurements are subject to change or clarification. Responsibility is reserved for use of supplements or revised pages.
Workouts are designed to comply with CSA B55.1 Standard and OBC Section 3.8 requirements. It shall be the responsibility of the customer to comply with the local accessibility codes and standards when installing the product.



Mahesh Ghosh

RECEIVED
AUG 04 2022