



CONSTRUCTION SUMMARY

KINGSMEN (THAMES) INC. / Havelock Corners (Kingsmen)

Lot/Unit: 64    Phase/Building: 5A    Model/Floor Plan: James (3601) Elev B 4 Bed - 2+1 Bath

COUNTER TOP

Inv.5688	1 - As per schedule "PE" : Vendor to include level 1, 2cm. quartz in all bathrooms, as per plan, in lieu of the inlcuded laminate counter tops. Selections to be made from builders standard samples.	
Line 72897	Note:	
2Aug22 / 2Aug22		

ELECTRICAL

Inv.5688	1 - To supply & install the standard T.V. rough in in the great room and master bedroom & Bedroom # 2 ...see sketch # 1 & # 2	
Line 72898	Note: Install the standard T.V. rough in at approx. 66" + - up from the floor centered to the F/P mantle.	
2Aug22 / 2Aug22		

Inv.5688	1 - To supply & install the standard Phone ( CAT 5 ) rough in in the great room, master bedroom & ...see sketch # 1 & # 2	
Line 72899	Note: Install the standard Phone ( CAT 5 ) rough in at approx. 66" + - up from the floor centered to the F/P mantle.	
2Aug22 / 2Aug22		

Inv.5688	1 - To SUPPLY AND INSTALL AN ADDITIONAL BASIC RECEPTACLE (NOT DEDICATED) at approx. 66" + - up from the floor centered + - to the F/P mantle	
Line 72905	Note: in the great room... see sketch # 1	
2Aug22 / 2Aug22		
This is for a futue wall mount T.V.		
NO CONDUIT PIPE HAS BEEN PURCHASED.		

Inv.5688	1 - to SUPPLY AND INSTALL EXTRA CEILING BOX ROUGH IN CAPPED (DOES NOT INCLUDE SWITCH) over the kitchen island area... see sketch # 1	
Line 72907	Note: This capped elec. will be connected to a sep. switch, switch sold sep.	
2Aug22 / 2Aug22		

Inv.5688	1 - To supply & install AN ADDITIONAL SINGLE POLE SWITCH connected to the capped ceiling elec. over the kitchen island.	
Line 72908	Note:	
2Aug22 / 2Aug22		

Inv.5688	1 - Relocate the standard ceiling light from the upper stair landing to the O.T.B. area on the second floor ... see sketch # 2	
Line 72909	Note:	
2Aug22 / 2Aug22		

HEATING AND AIR CONDITIONING

Inv.5688	1 - To supply & install a HUMMIDIFIER to the furnace...	
Line 72910	Note:	
2Aug22 / 2Aug22		

Inv.5688	1 - As per schedule "PE" : Vendor to install capped gas line ( rough in only ) at rear of home for future BBQ location. Location to be finalized at vendors sole discretion.	
Line 72894	Note:	
2Aug22 / 2Aug22		

Inv.5688	1 - As per schedule "PE" : Vendor to install gas line ( rough in only ) to kitchen in at stove location ( as per plan ) to include 110V code requirement.	
Line 72895	Note:	
2Aug22 / 2Aug22		



CONSTRUCTION SUMMARY

KINGSMEN (THAMES) INC. / Havelock Corners (Kingsmen)

Lot/Unit: 64    Phase/Building: 5A    Model/Floor Plan: James (3601) Elev B 4 Bed - 2+1 Bath

Inv.5688	1 - As per schedule "PE" : Vendor to supply & install air conditioning unit, sized accordingly, from vendors standard samples.	
Line 72896	Note:	
2Aug22 / 2Aug22		

EXTRAS AS PER OFFER

5 FREE APPLIANCES – STAINLESS STEEL FRONT - FRIDGE; STOVE AND DISHWASHER. WHITE WASHER AND DRYER (SUPPLIED ONLY, NOT INSTALLED, FROM BUILDERS STANDARD LINE). AN APPLIANCES VOUCHER WILL BE GIVEN BY OUR DECOR CONSULTANT AT THE TIME OF BOOKING YOUR COLOUR A <i>Worksheet</i> Note:	
VENDOR TO INSTALL CAPPED GAS LINE (ROUGH-IN ONLY) AT REAR OF HOME FOR FUTURE BBQ LOCATION.   LOCATION TO BE FINALIZED AT VENDORS SOLE DISCRETION. <i>Worksheet</i> Note:	
VENDOR TO INSTALL GAS LINE (ROUGH-IN ONLY) TO KITCHEN IN AT STOVE LOCATION (AS PER PLAN) TO INCLUDE 110V CODE REQUIREMENT. <i>Worksheet</i> Note:	
VENDOR TO SUPPLY & INSTALL AIR CONDITIONING UNIT, SIZED ACCORDINGLY, FROM VENDORS STANDARD SAMPLES. <i>Worksheet</i> Note:	
VENDOR TO INCLUDE LEVEL 1, 2CM QUARTZ IN ALL BATHROOMS, AS PER PLAN, IN LIEU OF THE INCLUDED LAMINATE COUNTER TOPS. SELECTIONS TO BE MADE FROM BUILDERS STANDARD SAMPLES. <i>Worksheet</i> Note:	

Purchasers: SHAMSHER SINGH BHANGU & NAVJOT SINGHProperty: 64 of Plan - Draft Approval SB17-03-08  
Telephone Res. / Bus: / Project: KINGSMEN (THAMES) INC.  
Decor Advisor: Barbara Coccia Model and Elevation: James (3601) Elev B 4 Bed - 2+1 Bath  
Layout Changes: ☐ Yes ☒ No Sketch Attached: ☒ Yes ☐ No Exterior Colour Scheme:

1. Cabinetry	Style and Colour	Counter Top	Hardware
Kitchen / Breakfast	#3, Charleston 3DL Orchid	#1, C/S # 9141 Ice Snow 3cm.	# 12881 Handle
Kitchen Island	#3, Charleston 3DL Orchid	#1, C/S # 9141 Ice Snow 3cm.	# 12881 Handle
Laundry Room	/		
Powder Room	#3, Charleston 3DL Orchid	#1, C/S # 9141 Ice Snow 2cm.	# 12881 Handle
Main Bathroom	#3, Charleston 3DL Orchid	#1, C/S # 9141 Ice Snow 2cm.	# 12881 Handle
Master Ensuite Bathroom	#3, Charleston 3DL Orchid	#1, C/S # 9141 Ice Snow 2cm.	# 12881 Handle
Second Ensuite Bathroom (If Applicable)	/		
	/		
	/		

Appliances	Custom Size Fridge <input type="radio"/> Yes <input checked="" type="radio"/> No	Valance Lighting <input type="radio"/> Yes <input checked="" type="radio"/> No	Microwave / Range Hood <input type="radio"/> Yes <input checked="" type="radio"/> No
	Cooktop / Rangetop <input type="radio"/> Yes <input checked="" type="radio"/> No	Built in Wall Oven <input type="radio"/> Yes <input checked="" type="radio"/> No	Slide-in Range <input type="radio"/> Yes <input checked="" type="radio"/> No
Comment			

2. Flooring	Selection
Foyer	13 x 13" Cinq White
Main Hall	13 x 13" Cinq White
Back Hall	/
Breakfast	13 x 13" Cinq White
Laundry Room	13 x 13" Cinq White
Kitchen	13 x 13" Cinq White
Powder Room	13 x 13" Cinq White
Main Bathroom	13 x 13" Cinq White
Master Ensuite	13 x 13" Cinq White
Bathroom (If Applicable)	/
Mud Room	13 x 13" Cinq White
Master ens. shower floor	2x 2" Ontario Snow White Matte
Living Room	/
Dining Room	/
Family / Great Room	3 1/2" Elements Oak Natural
Den / Library / Study	/
Basement Landing (If Applies)	
Lower Landing (If Applicable)	3 1/2" Elements Oak Natural
Upper Landing	( if applicable ) 3 1/2" Elements Oak Natural
Upper Hall	Modern Story 1, 827 Pefect Neutral
Master Bedroom	Modern Story 1, 827 Pefect Neutral
Bedroom #2	Modern Story 1, 827 Pefect Neutral
Bedroom #3	Modern Story 1, 827 Pefect Neutral
Bedroom #4	Modern Story 1, 827 Pefect Neutral
Bedroom #5	/
Master ens. shower jamb	Anatolia Marmiline SNOW

Flooring Continued on Page 2



Initial:  

Purchasers: SHAMSHER SINGH BHANGU & NAVJOT SINGH Property: 64 of Plan - Draft Approval SB17-03-08  
Telephone Res. / Bus: / Project: KINGSMEN (THAMES) INC.  
Decor Advisor: Barbara Coccia Model and Elevation: James (3601) Elev B 4 Bed - 2+1 Bath  
2. Flooring - Continued -

Upgrade Underpad	Type	Area
	Standard	2nd. floor
Carpet on Stairs	Capped	Runner - *Upgrade
Comment	/	/

## 3. Plumbing Fixtures / Faucets

Kitchen	Standard	Second Ensuite	/	Powder Room	Standard
Master Ensuite	Standard			Other Room	/
Main Bathroom	Standard		/		

## Comment

Still to install the standard top mount kitchen sink with the standard kitchen faucet.  
to install the standard top mount vanity sinks with the standard lav. faucets.

Still

## 4. Wall Tile

	Tile Selection	Listello	Insert	Insert Selection
Main Bathroom	8x10" Cinq White	<input type="checkbox"/>	<input type="checkbox"/>	
Master Ensuite				
Tub Deck	13 x 13" Cinq White	<input type="checkbox"/>	<input type="checkbox"/>	
Tub Apron	13 x 13" Cinq White	<input type="checkbox"/>	<input type="checkbox"/>	
Tub Surround	13 x 13" Cinq White	<input type="checkbox"/>	<input type="checkbox"/>	
Shower Stall	8x10" Cinq White	<input type="checkbox"/>	<input type="checkbox"/>	
Second Ensuite	/	<input type="checkbox"/>	<input type="checkbox"/>	
	/	<input type="checkbox"/>	<input type="checkbox"/>	
	/	<input type="checkbox"/>	<input type="checkbox"/>	
Kitchen Backsplash	/	<input type="checkbox"/>	<input type="checkbox"/>	
Complete Backsplash	/	<input type="checkbox"/>	<input type="checkbox"/>	

## Comment

Install the standard 8 x 10" wall tiles on the 10" side stacked horizontally in the bathrooms where applicable.



horizontal stacked



brick pattern



vertical stacked



diagonal diamond

## 5. Fireplace

	Living Room			Family Room			Other Room - Specify Great Room		
	Purchased	As Per Plan	N/A	Purchased	As Per Plan	N/A	Purchased	As Per Plan	N/A
Fireplace Type	<input type="radio"/>	<input type="radio"/>	<input checked="" type="radio"/>	<input type="radio"/>	<input type="radio"/>	<input checked="" type="radio"/>	<input type="radio"/>	<input checked="" type="radio"/>	<input type="radio"/>
Mantle Type									
Over Mantle									
Colour / Stain									
Surround									
Hearth									
Comment									



Initial:



Page 2 of 3

**Purchasers:** SHAMSHER SINGH BHANGU & NAVJOT SINGH **Property:** 64 of Plan - Draft Approval SB17-03-08  
**Telephone Res. / Bus:** / **Project:** KINGSMEN (THAMES) INC.  
**Decor Advisor:** Barbara Coccia **Model and Elevation:** James (3601) Elev B 4 Bed - 2+1 Bath

### 6. Trim Carpentry

**Door Hardware** Standard handle

**Interior Trim** Standard

**Comment**

/

#### Interior Doors

☐ 2 Panel Arch Top

☒ 2 Panel Square Top

☐ 6 Panel



Initial for Door Style

SB SH

### 7. Railings and Pickets

**Railing Package** Standard oak STRAIGHT picket package

**Railing Colour** Elements natural

**Picket Colour** Elements natural

**Wood Stairs** ☐ No ☒ Oak

**Tread Colour** Elements natural

**Comment**

/

### 8. Plaster Mouldings and Medallions

**Foyer** /

**Main Hall** /

**Living Room** /

**Dining Room** /

**Family Room** /

**Comment**

/

**Kitchen/Breakfast** /

**Den/Library** /

**Lower Landing** /

### 9. Wall Paint

Kingsmen White

#### Smooth Ceilings

☐ First Floor

☐ First Floor incl. Second Floor Hall

☐ First and Second Floor

☒ Throughout

☐ Not Applicable

**Trim Paint** Kingsmen White

### 10. Additional Comments

/

RECEIVED

AUG 02 2022

### 11. Disclaimers and Notes

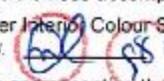
- Colours of all materials are as close as possible to builder's selection, but not necessarily identical due to variances in manufacturing.
- Any extras listed above are null and void unless accompanied by a separate invoice/amendment. Said invoice must be paid in full.
- The Purchaser acknowledges that after Interior Colour Selection form is signed and dated, no further changes will be permitted other than re-selection due to unavailability.  Purchaser's Initials
- The Purchaser acknowledges reading and accepting the "Kingsmen Group Décor Centre Disclaimers" form. This document contains other miscellaneous disclaimers.

This Interior Colour Selection is final and approved by:

**Purchaser:**

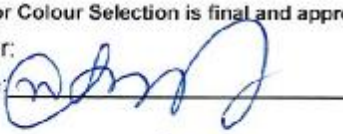
**Signature:** 

**Date:** August 01/2022

**Signature:** 

**Date:** Aug 02/2022

**Vendor:** 

KINGSMEN (THAMES) INC.

Aug 3/22

**SCHEDULE "B-1"**  
**Floor Plan**

Lot 64  
Phase 5A  
Model: James (3601) Elev B 4 Bed - 2+1 Bath  
Standard

*all items @ 66" ±  
the up from floor  
TV PH*

*Sketch #1  
apped elec. master  
Switch*

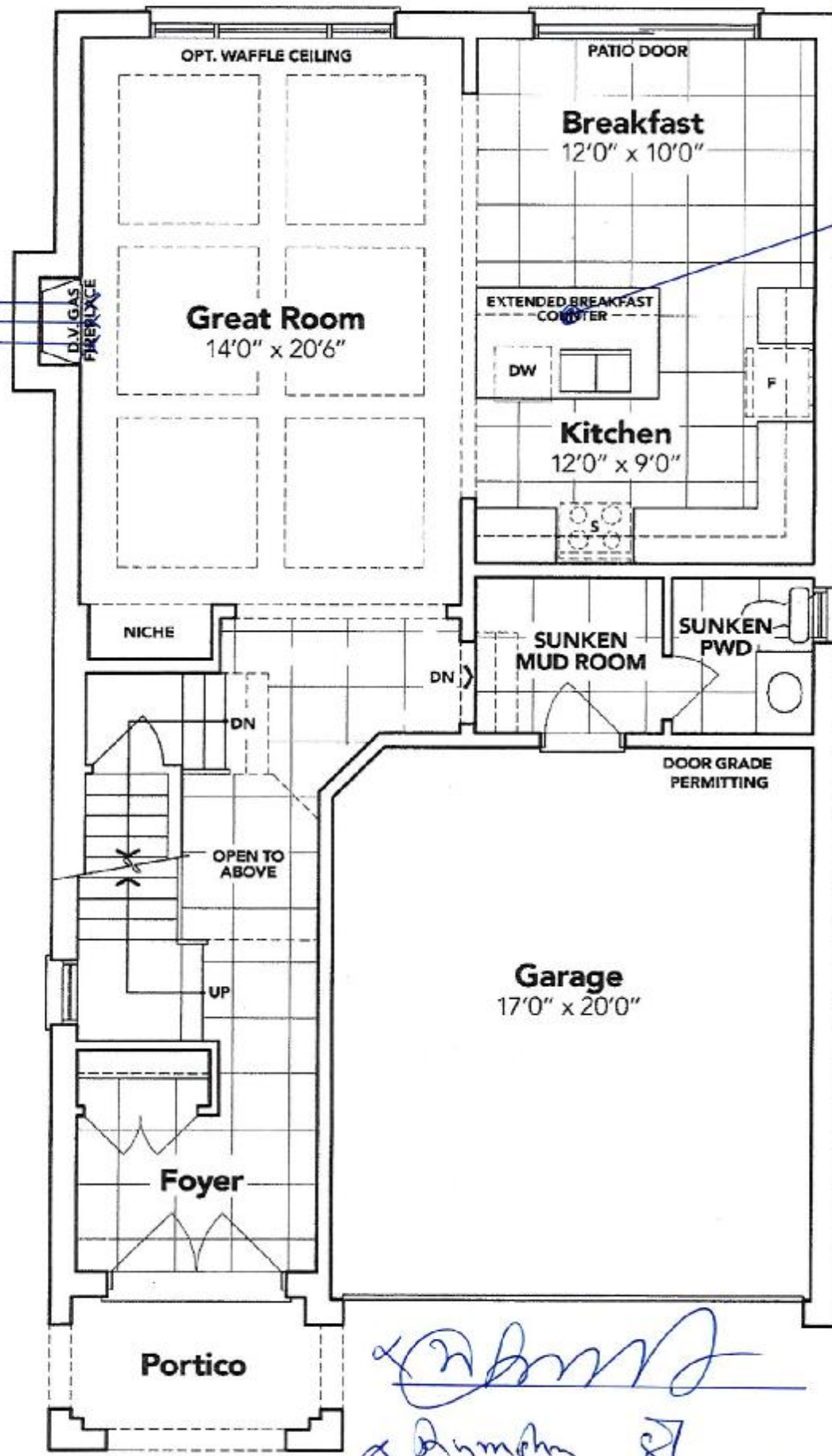

**GROUND FLOOR EL. B**

The floor plans and elevations shown are pre-construction plans and may be revised or improved as necessitated by architectural controls and the construction process. The measurements adhere to the rules and regulations of the TARION Warranty Corporation's official method for the calculation of floor area. Materials, specifications and floor plans are subject to change without notice. All house renderings are artist's concept only. Actual usable floor space may vary from the stated floor area. All options shown are upgrades. E. & O. E.

**RECEIVED**

**AUG 02 2022**

SCHEDULE "B-1" - Page 3 of 3

Initials

**SCHEDULE "B-1"**  
**Floor Plan**

Lot 64  
Phase 5A  
Model: James (3601) Elev B 4 Bed - 2+1 Bath  
Standard

Sketch  
#2

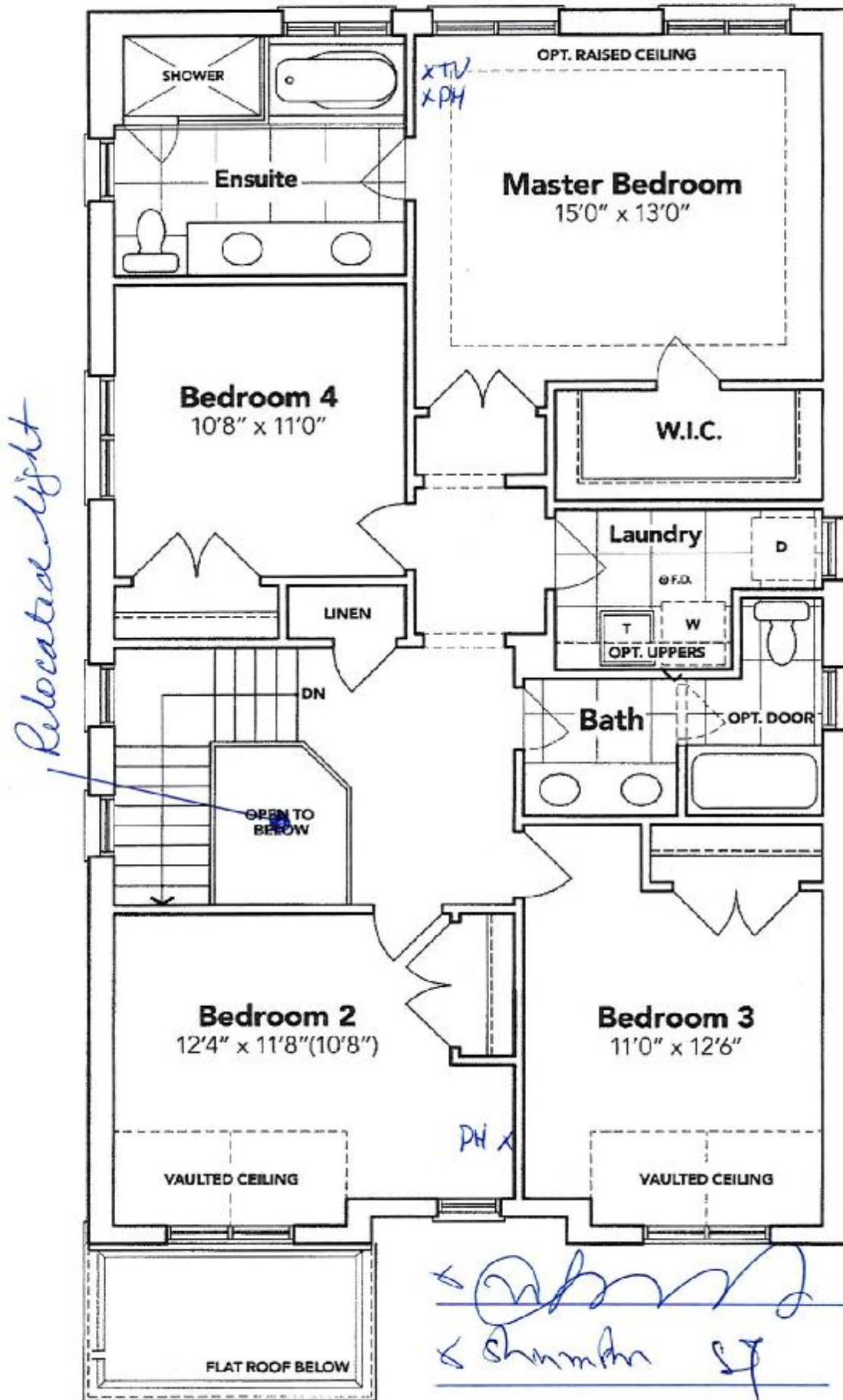

**SECOND FLOOR EL. B**

The floor plans and elevations shown are pre-construction plans and may be revised or improved as necessitated by architectural controls and the construction process. The measurements adhere to the rules and regulations of the TARIION Warranty Corporation's official method for the calculation of floor area. Materials, specifications and floor plans are subject to change without notice. All house renderings are artist's concept only. Actual usable floor space may vary from the stated floor area. All options shown are upgrades. E. & O. E.

**RECEIVED**

AUG 02 2022

SCHEDULE "B-1" - Page 2 of 3

Initials

SCHEDULE "B-1"  
Floor Plan

Lot 64  
Phase 5A  
Model: James (3601) Elev B 4 Bed - 2+1 Bath  
Standard

Sketch 4/

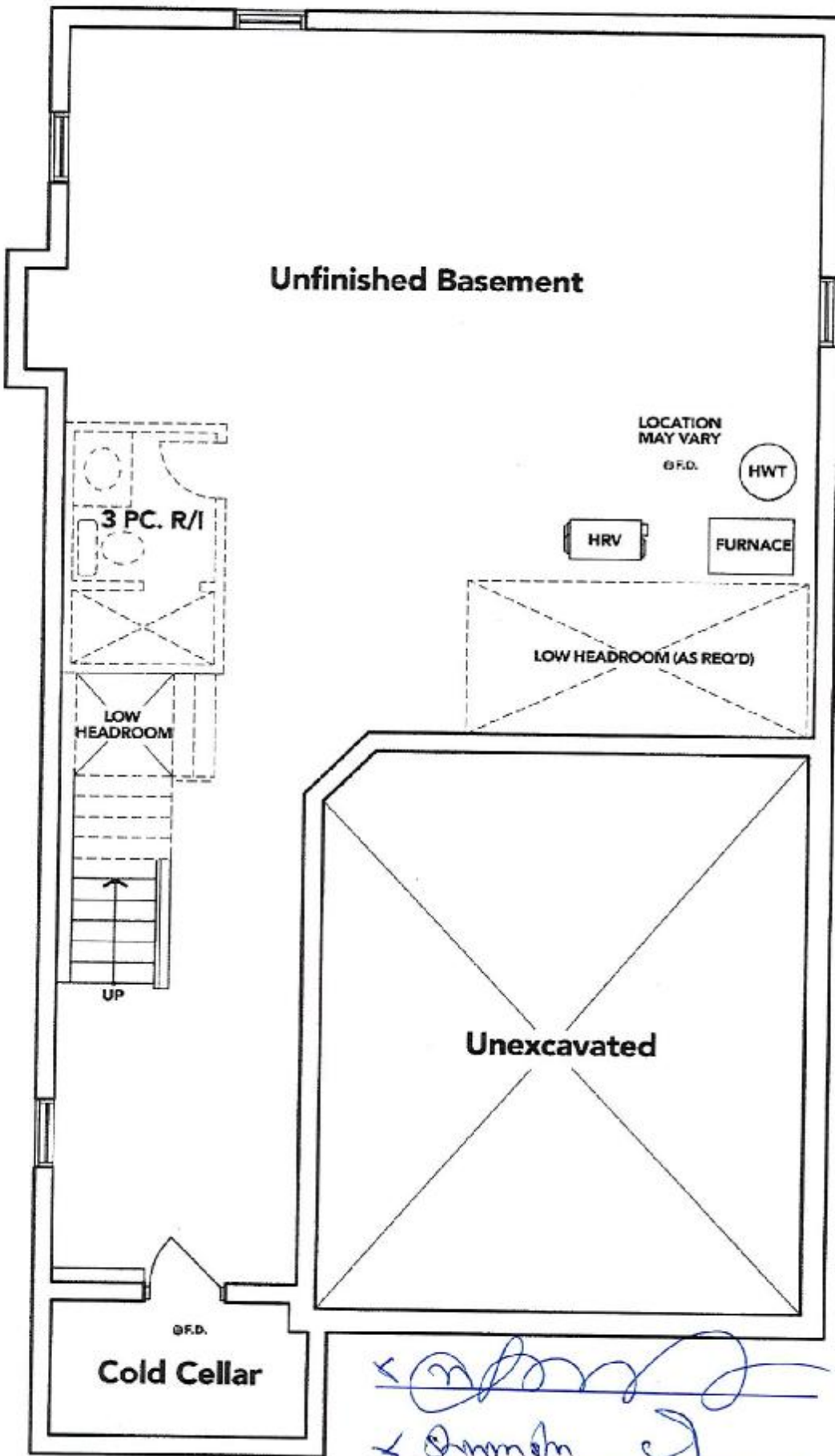

**BASEMENT EL. B**

The floor plans and elevations shown are pre-construction plans and may be revised or improved as necessitated by architectural controls and the construction process. The measurements adhere to the rules and regulations of the TARION Warranty Corporation's official method for the calculation of floor area. Materials, specifications and floor plans are subject to change without notice. All house renderings are artist's concept only. Actual usable floor space may vary from the stated floor area. All options shown are upgrades. E. & O. E.



SCHEDULE "B-1" Page 1 of 3

Initials: \_\_\_\_\_