

**KINGSMEN (THAMES) INC. / Havelock Corners (Kingsmen)**

**Lot/Unit: 95    Phase/Building: 5A    Model/Floor Plan: Spencer (4204) Elev C 4 Bed - 4+1 Bath**

**CABINETRY**

Inv.5687	1 - To accomodate for a 36" wide stove opening in lieu of the standard 30" stove opening in the kitchen.	
Line 72872	Note:	
28Jul22 / 28Jul22		

**CABINETRY ACCESSORIES**

Inv.5687	4 - To supply & install the LIGHT VALANCE - LIGHT VALANCE IS NOW APPROXIMATELY 2INCHES 50MM HIGH - in the kitchen.	
Line 72880	Note: Rough in wires on a sep. switch is sold sep.	
28Jul22 / 28Jul22		

**CABINETRY APPLIANCE - FRIDGE**

Inv.5687	1 - To supply & install the 66CM DEEP FRIDGE ENCLOSURE - COUNTER DEPTH WITH - 1 WALL - 1 66CM DEEP GABLE AND 1 66CM DEEP CABINET - STANDARD HEIGHTS AND WIDTHS WILL BE USED. .. see sketch # 1	
Line 72877	Note: See attached for frige spec's	
28Jul22 / 28Jul22		

**CABINETRY BASE CABINETS**

Inv.5687	1 - To supply & install the POTS & PANS DRAWER in the kitchen... see sketch # 1	
Line 72878	Note:	
28Jul22 / 28Jul22		
Inv.5687	1 - To supply & install the 45CM WIDE PULL-OUT DOOR BASE CABINET WASTE - RECYCLE CENTRE 2 35L BINS - AVAILABLE ONLY WITH 45CM WIDE CABINET - in the kitchen... see sketch # 1	
Line 72879	Note:	
28Jul22 / 28Jul22		
Inv.5687	1 - To install a different colour kitchen island in the kitchen... see colour chart for details..	
Line 72892	Note:	
28Jul22 / 28Jul22		

**CABINETRY HOOD FANS**

Inv.5687	1 - To supply & install the HOOD FAN - PRO COLLECTION (SCB72236) WALL MOUNT RANGE HOOD WITH 650 CFM FAN - 36 INCH in the kitchen in lieu of the standard 30" hood fan.... see spec's	
Line 72870	Note:	
28Jul22 / 28Jul22		
Inv.5687	1 - To accomdote for the upgraded 36" chimney hood fan.	
Line 72871	Note:	
28Jul22 / 28Jul22		

**CABINETRY MICROWAVE OVEN STOVE COOKTOP**

Inv.5687	1 - To supply & install accomodations for the future 36" COOKTOP CABINET WITH FALSE TOP DRAWER AND POTS AND PANS DRAWERS BELOW - SUPPLY SPECS in the kitchen... see spec's...see sketch #1	
Line 72874	Note:	
28Jul22 / 28Jul22		

**KINGSMEN (THAMES) INC. / Havelock Corners (Kingsmen)**

**Lot/Unit: 95    Phase/Building: 5A    Model/Floor Plan: Spencer (4204) Elev C 4 Bed - 4+1 Bath**

Inv.5687	1 - To supply & install acomodations for the future BUILT-IN TALL APPLIANCE CABINET WITH DRAWER - S BELOW FOR PANEL-MOUNT - PROUD - OR TRIM KIT INSTALLATIONS - TRIM KIT REQUIRED - SUPPLY ALL SPECS AND INSTALLATION GUIDES - COUNTER DEPTH - in the kitchen.	
Line 72875	Note: See spec's... see sketch # 1	
28Jul22 / 28Jul22		

**CABINETRY VANITY**

Inv.5687	1 - To supply & install a VANITY BANK OF DRAWERS in the master ensuite... see sketch # 2	
Line 72882	Note:	
28Jul22 / 28Jul22		
Inv.5687	1 - To INCREASE VANITY TO KITCHEN HEIGHT -- 90CM HIGH - MAINTAINS VANITY DEPTH - in the master ensuite bathroom in lieu of the standard height vanity.	
Line 72883	Note:	
28Jul22 / 28Jul22		

**COUNTER TOP**

Inv.5687	1 - To accomodate the quartz countertop in the kitchen for the future 36 cook top.	
Line 72873	Note:	
28Jul22 / 28Jul22		
Inv.5687	1 - As per schedule "PE": Vendor to include level 1, 2cm. quartz in all bathrooms, as per plan, in lieu of the inlcuded laminate counter tops. Selections to be made from builders standard samples.	
Line 72856	Note:	
28Jul22 / 28Jul22		

**COUNTER TOP - KITCHEN**

Inv.5687	1 - To supply & install the COUNTER TOP - KITCHEN - KITCHEN - 3CM COUNTER TOP - UPGRADE LEVEL 2 in lieu of the standard level 1 quartz countertop... see colour chart for details.	
Line 72890	Note:	
28Jul22 / 28Jul22		

**ELECTRICAL**

Inv.5687	1 - To supply & install rough in wires on a sep. switch for future lower valance lights in the kitchen.	
Line 72881	Note: NO LIGHTS HAVE BEEN PURCHASED.	
28Jul22 / 28Jul22                      Lower valance trim is sold sep.		
Inv.5687	1 - To supply & install the standard T.V. rough in in the great room and master bedroom... see sketch # 1 & # 2	
Line 72857	Note: Install the standard T.V. rough at approx. 66" + - up from the floor in both great room and master bedroom...	
28Jul22 / 28Jul22		
Inv.5687	1 - To supply & install the standard Phone ( CAT 5 ) rough in in the great room, master bedroom & Media Niche area on the second floor.. see sketch # 1 & # 2	
Line 72858	Note: Install the standard Phone ( CAT 5 ) rough at approx. 66" + - up from the floor in both great room and master bedroom...	
28Jul22 / 28Jul22		

**KINGSMEN (THAMES) INC. / Havelock Corners (Kingsmen)**

**Lot/Unit: 95    Phase/Building: 5A    Model/Floor Plan: Spencer (4204) Elev C 4 Bed - 4+1 Bath**

Inv. <b>5687</b>  <b>Line 72859</b>  28Jul22 / 28Jul22	<b>1 - To SUPPLY AND INSTALL AN ADDITIONAL BASIC RECEPTACLE (NOT DEDICATED)</b> at approx. 66 " +- up from the floor centered + - to the F/P mantle in the Note: Great room... see sketch #1  This is for a futue wall mount T.V.  NO CONDUIT PIPE HAS BEEN PURCHASED.	
Inv. <b>5687</b>  <b>Line 72860</b>  28Jul22 / 28Jul22	<b>1 - To SUPPLY AND INSTALL AN ADDITIONAL BASIC RECEPTACLE (NOT DEDICATED)</b> at approx. 66" + - up from the floor in the master bedroom...see sketch # 2 Note: Master bedroom ... see sketch #1  This is for a futue wall mount T.V.  NO CONDUIT PIPE HAS BEEN PURCHASED.	
Inv. <b>5687</b>  <b>Line 72861</b>  28Jul22 / 28Jul22	<b>1 - To SUPPLY AND INSTALL EXTRA CEILING BOX ROUGH IN CAPPED (DOES NOT INCLUDE SWITCH)</b> over the kitchen island in the kitchen... see sketch #1 Note: This cap will be connected to a sep. switch, switch sold sep.	
Inv. <b>5687</b>  <b>Line 72862</b>  28Jul22 / 28Jul22	<b>1 - To supply &amp; install AN ADDITIONAL SINGLE POLE SWITCH</b> connected to the upgraded ceiling capped elec. over the kitchen island in the kitchen. Note:	
Inv. <b>5687</b>  <b>Line 72863</b>  28Jul22 / 28Jul22	<b>1 - Relocate the standard ceiling light</b> from the upper stair landing to the O.T.B. area on the second floor... see sketch # 2 Note:	
Inv. <b>5687</b>  <b>Line 72876</b>  28Jul22 / 28Jul22	<b>1 - To SUPPLY AND INSTALL EXTRA 240 STOVE PLUG</b> for the future built in wall oven/microwave oven in the kitchen...see sketch # 1 Note:	

**HARDWOOD**

Inv. <b>5687</b>  <b>Line 72891</b>  28Jul22 / 28Jul22	<b>1 - To supply &amp; install the 3 1/2" Elements oak stained engineered hardwood floor</b> to the upper hallway area and media niche area in lieu of the standard carpet... see colour chart for details. Note:	
--	--	--

**HEATING AND AIR CONDITIONING**

Inv. <b>5687</b>  <b>Line 72854</b>  28Jul22 / 28Jul22	<b>1 - As per schedule "PE": Vendor to install capped gas line ( rough in only )</b> at rear of home for future BBQ location. Location to be finalized at vendors sole discretion. Note:	
Inv. <b>5687</b>  <b>Line 72855</b>  28Jul22 / 28Jul22	<b>1 - As per schedule "PE": Vendor to supply &amp; install air conditioning unit, sized accordingly,</b> from vendors standard samples. Note:	
Inv. <b>5687</b>  <b>Line 72864</b>  28Jul22 / 28Jul22	<b>1 - To supply &amp; install a capped gas rough in line</b> including a 110 V elec. outlet ( Code requirement ) at stove location in the kitchen. Note:	

KINGSMEN (THAMES) INC. / Havelock Corners (Kingsmen)

Lot/Unit: 95    Phase/Building: 5A    Model/Floor Plan: Spencer (4204) Elev C 4 Bed - 4+1 Bath

MISCELLANEOUS

PLUMBING

Inv.5687	1 - To supply & install a WATERLINE ROUGH-IN TO THE FRIDGE LOCATION (NO HOOK UP) in the kitchen.	
Line 72865	Note:	
28Jul22 / 28Jul22		
Inv.5687	6 - To supply & install the VANITY SINK - CONTRAC CATENA UNDERMOUNT - MODEL 4210CIY in the powder room, master ensuite, ens #2, #3 & # 4 in lieu of the standard top mount vanity sinks... see spec's	
Line 72867	Note: Still to install the standard lav faucets.	
28Jul22 / 28Jul22		
Inv.5687	1 - To supply & install the KITCHEN SINK - BLANCO QUATRUS U2 DBL UNDERMOUNT - MODEL 401247 in the kitchen in lieu of the standard under mount kitchen sink... see spec's	
Line 72868	Note: Still to install the standard single hole kitchen faucet NO PLATE.	
28Jul22 / 28Jul22		
Inv.5687	1 - To supply & insall the KITCHEN SOAP Dispencer - MOEN CHROME - MODEL 3942 in the kitchen... see spec's ... see sketch # 1 for installation location.	
Line 72869	Note:	
28Jul22 / 28Jul22		

TILE - FLOOR

Inv.5687	1 - To supply & install the UPGRADE 3 - FLOOR TILE - STACKED - FOYER TILE in lieu of the standard floor tiles... see colour chart for details.	
Line 72885	Note:	
28Jul22 / 28Jul22		
Inv.5687	1 - To supply & install the UPGRADE 3 - FLOOR TILE - STACKED -POWDER ROOM TILE in lieu of the standard floor tiles... see colour chart for details.	
Line 72886	Note:	
28Jul22 / 28Jul22		
Inv.5687	1 - To supply & install the UPGRADE 3 - FLOOR TILE -STACKED - MUD ROOM TILE in lieu of the standard floor tiles... see colour chart for details.	
Line 72887	Note:	
28Jul22 / 28Jul22		
Inv.5687	1 - To supply & install the UPGRADE 3 - FLOOR TILE -STACKED - KITCHEN/BREAKFAST TILE in lieu of the standard floor tiles... see colour chart for details.	
Line 72888	Note:	
28Jul22 / 28Jul22		



CONSTRUCTION SUMMARY

KINGSMEN (THAMES) INC. / Havelock Corners (Kingsmen)

Lot/Unit: 95    Phase/Building: 5A    Model/Floor Plan: Spencer (4204) Elev C 4 Bed - 4+1 Bath

EXTRAS AS PER OFFER

5 FREE APPLIANCES – STAINLESS STEEL FRONT - FRIDGE; STOVE AND DISHWASHER. WHITE WASHER AND DRYER (SUPPLIED ONLY, NOT INSTALLED, FROM BUILDERS STANDARD LINE). AN APPLIANCES VOUCHER WILL BE GIVEN BY OUR DECOR CONSULTANT AT THE TIME OF BOOKING YOUR COLOUR A <i>Worksheet</i> Note:	
VENDOR TO INSTALL CAPPED GAS LINE (ROUGH-IN ONLY) AT REAR OF HOME FOR FUTURE BBQ LOCATION.    LOCATION TO BE FINALIZED AT VENDORS SOLE DISCRETION. <i>Worksheet</i> Note:	
VENDOR TO SUPPLY & INSTALL AIR CONDITIONING UNIT, SIZED ACCORDINGLY, FROM VENDORS STANDARD SAMPLES. <i>Worksheet</i> Note:	
VENDOR TO INCLUDE LEVEL 1, 2CM QUARTZ IN ALL BATHROOMS, AS PER PLAN, IN LIEU OF THE INCLUDED LAMINATE COUNTER TOPS.    SELECTIONS TO BE MADE FROM BUILDERS STANDARD SAMPLES. <i>Worksheet</i> Note:	



Purchaser: AKALJOT SINGH

Property: 95 of Plan - Draft Approval SB17-03-08

Telephone Res. / Bus: /

Project: KINGSMEN (THAMES) INC.

Decor Advisor: Barbara Coccia

Model and Elevation: Spencer (4204) Elev C 4 Bed - 4+1 Bath

Layout Changes: ☐ Yes ☒ No

Sketch Attached: ☒ Yes ☐ No

Exterior Colour Scheme:

1. Cabinetry	Style and Colour	Counter Top	Hardware
Kitchen / Breakfast	#3 Simcoe Rain Cloud	**#2, H/S Whistler 3cm.	#12881 Handle
Kitchen Island	**#3 Simcoe Moonlight	**#2, H/S Whistler 3cm.	#12881 Handle
Laundry Room	/		
Powder Room	#3 Simcoe Moonlight	#1, C/S # 3040 Cement 2cm.	#12881 Handle
Main Bathroom	/		
Master Ensuite Bathroom	#3, Charleston 3DL Orchid	#1, C/S # 9141 Ice Snow 2cm.	#12881 Handle
Second Ensuite Bathroom (If Applicable)	#3, Charleston 3DL Orchid	#1, C/S # 3040 Cement 2cm.	#12881 Handle
Ens. #3's bathroom	#3, Charleston 3DL Orchid	#1, C/S # 3040 Cement 2cm.	#12881 Handle
Ens. #4's bathroom	#3, Charleston 3DL Orchid	#1, C/S # 3040 Cement 2cm.	#12881 Handle

Appliances

Custom Size Fridge

☒ Yes ☐ No

Valance Lighting

☒ Yes ☐ No

Microwave / Range Hood

☐ Yes ☒ No

Cooktop / Rangetop

☒ Yes ☐ No

Built in Wall Oven

☒ Yes ☐ No

Slide-in Range

☐ Yes ☒ No

Comment

## 2. Flooring

	Selection
Foyer	**12 x 24" Mayfair Statuario Venato HD Rec. Porcelain Matte STACKED
Main Hall	3 1/2" Elements Oak Strugeon
Back Hall	/
Breakfast	**12 x 24" Mayfair Statuario Venato HD Rec. Porcelain Matte STACKED
Laundry Room	13 x 13" Cinq Black
Kitchen	**12 x 24" Mayfair Statuario Venato HD Rec. Porcelain Matte STACKED
Powder Room	**12 x 24" Mayfair Statuario Venato HD Rec. Porcelain Matte STACKED
Main Bathroom	Ens. #2's bathroom: 13 x 13" Malena Ice
Master Ensuite	13 x 13" Malena Ivory
Bathroom (If Applicable)	Ens. #3's bathroom: 13 x 13" Malena Carbon
Mud Room	**12 x 24" Mayfair Statuario Venato HD Rec. Porcelain Matte STACKED
Ens. #4's bathroom:	13 x 13" Malena Carbon
Living Room	/
Dining Room	3 1/2" Elements Oak Strugeon
Family / Great Room	3 1/2" Elements Oak Strugeon
Den / Library / Study	/
Basement Landing (If Applies)	
Lower Landing (If Applicable)	3 1/2" Elements Oak Strugeon
Upper Landing	( if applicable ) 3 1/2" Elements Oak Strugeon
Upper Hall	**3 1/2" Elements Oak Strugeon ( Incl. media niche area )
Master Bedroom	Modern Story 1, 810 Rocky Top
Bedroom #2	Modern Story 1, 810 Rocky Top
Bedroom #3	Modern Story 1, 810 Rocky Top
Bedroom #4	Modern Story 1, 810 Rocky Top
Bedroom #5	Master ens. & Ens #2's shower floor: 2x2" Ontario Snow White
Master ens. & ens. #2's	Shower Jamb: Anatolia Marmiline SNOW

Flooring Continued on Page 2



Initial:

*Abdul J. Singh*

Purchaser:AKALJOT SINGH

Telephone Res. / Bus: /

Decor Advisor:Barbara Coccia

2. Flooring - Continued -

Property: 95 of Plan - Draft Approval SB17-03-08

Project: KINGSMEN (THAMES) INC.





Model and Elevation: Spencer (4204) Elev C 4 Bed - 4+1 Bath

Upgrade Underpad	Type	Area
	Standard	Master bedroom, bedroom # 2, # 3 & # 4
Carpet on Stairs	Capped	Runner - *Upgrade
Comment	/	/

3. Plumbing Fixtures / Faucets

Kitchen	Standard	Second Ensuite	Standard	Powder Room	Standard
Master Ensuite	Standard			Other Room	/
Main Bathroom	/	Ens. #3 & # 4's bathrooms	Standard		
Comment					
Purchaser has upgraded the under mount kitchen sink, still to install the standard single hole kitchen faucet.. NO PLATE. Purchaser has upgraded to under mount vanity sinks in ALL bathrooms, still to install the standard lav faucets.					

4. Wall Tile

	Tile Selection	Listello	Insert	Insert Selection
Main Bathroom	/	<input type="checkbox"/>	<input type="checkbox"/>	
Master Ensuite				
Tub Deck	/	<input type="checkbox"/>	<input type="checkbox"/>	
Tub Apron	/	<input type="checkbox"/>	<input type="checkbox"/>	
Tub Surround	/	<input type="checkbox"/>	<input type="checkbox"/>	
Shower Stall	8x10" Malena Ivory	<input type="checkbox"/>	<input type="checkbox"/>	
Second Ensuite	8x10" Malena Carbon	<input type="checkbox"/>	<input type="checkbox"/>	
Ens. #3's bathroom	8x10" Malena Ice	<input type="checkbox"/>	<input type="checkbox"/>	
Ens. #4's bathroom	8x10" Malena Ice	<input type="checkbox"/>	<input type="checkbox"/>	
Kitchen Backsplash	/	<input type="checkbox"/>	<input type="checkbox"/>	
Complete Backsplash	/	<input type="checkbox"/>	<input type="checkbox"/>	
Comment				
Install the standard 8x10" wall tiles on the 10 " side stacked horizontally in ALL bathrooms where applicable.				
<div><div> horizontal stacked</div><div> brick pattern</div><div> vertical stacked</div><div> diagonal/diamond</div></div>				

5. Fireplace

	Living Room			Family Room			Other Room - Specify Great Room		
	Purchased	As Per Plan	N/A	Purchased	As Per Plan	N/A	Purchased	As Per Plan	N/A
Fireplace Type	<input type="radio"/>	<input type="radio"/>	<input checked="" type="radio"/>	<input type="radio"/>	<input type="radio"/>	<input checked="" type="radio"/>	<input type="radio"/>	<input checked="" type="radio"/>	<input type="radio"/>
Mantle Type							Front Facing		
Over Mantle							NF-08		
Colour / Stain							/		
Surround							White		
Hearth							/		
Comment							/		



Initial: 



Purchaser: AKALJOT SINGH

Telephone Res. / Bus: /

Decor Advisor: Barbara Coccia

Property: 95 of Plan - Draft Approval SB17-03-08

Project: KINGSMEN (THAMES) INC.

Model and Elevation: Spencer (4204) Elev C 4 Bed - 4+1 Bath

### 6. Trim Carpentry

Door Hardware Standard handle

Interior Trim Standard

Comment

/

#### Interior Doors

☐ 2 Panel Arch Top

☒ 2 Panel Square Top

☐ 6 Panel

Initial for Door Style

AS

### 7. Railings and Pickets

Railing Package Standard Oak STRAIGHT picket package

Railing Colour Elements Sturgeon

Picket Colour Elements Sturgeon

Wood Stairs ☐ No ☒ Oak

Tread Colour Elements Sturgeon

Comment

/

### 8. Plaster Mouldings and Medallions

Foyer /

Main Hall /

Living Room /

Dining Room /

Family Room /

Kitchen/Breakfast /

Den/Library /

Lower Landing /

Comment

/

### 9. Wall Paint

Kingsmen White

Smooth Ceilings ☐ First Floor

☐ First Floor incl. Second Floor Hall

☐ First and Second Floor

☒ Throughout

☐ Not Applicable

Trim Paint Kingsmen White

### 10. Additional Comments

/

### 11. Disclaimers and Notes

- Colours of all materials are as close as possible to builder's selection, but not necessarily identical due to variances in manufacturing.
- Any extras listed above are null and void unless accompanied by a separate invoice/amendment. Said invoice must be paid in full.
- The Purchaser acknowledges that after Interior Colour Selection form is signed and dated, no further changes will be permitted other than re-selection due to unavailability. AS Purchaser's Initials
- The Purchaser acknowledges reading and accepting the "Kingsmen Group Décor Centre Disclaimers" form. This document contains other miscellaneous disclaimers.

This Interior Colour Selection is final and approved by:

Purchaser:

Signature: Akaljot Singh Date: 28/07/2022

RECEIVED

JUL 28 2022

Vendor:

KINGSMEN (THAMES) INC.

July 28/22

Page 3 of 3



**SCHEDULE "B-1"**  
**Floor Plan**

Lot 95  
Phase 5A  
Model: Spencer (4204) Elev C 4 Bed - 4+1 Bath  
Standard

Sketch #1

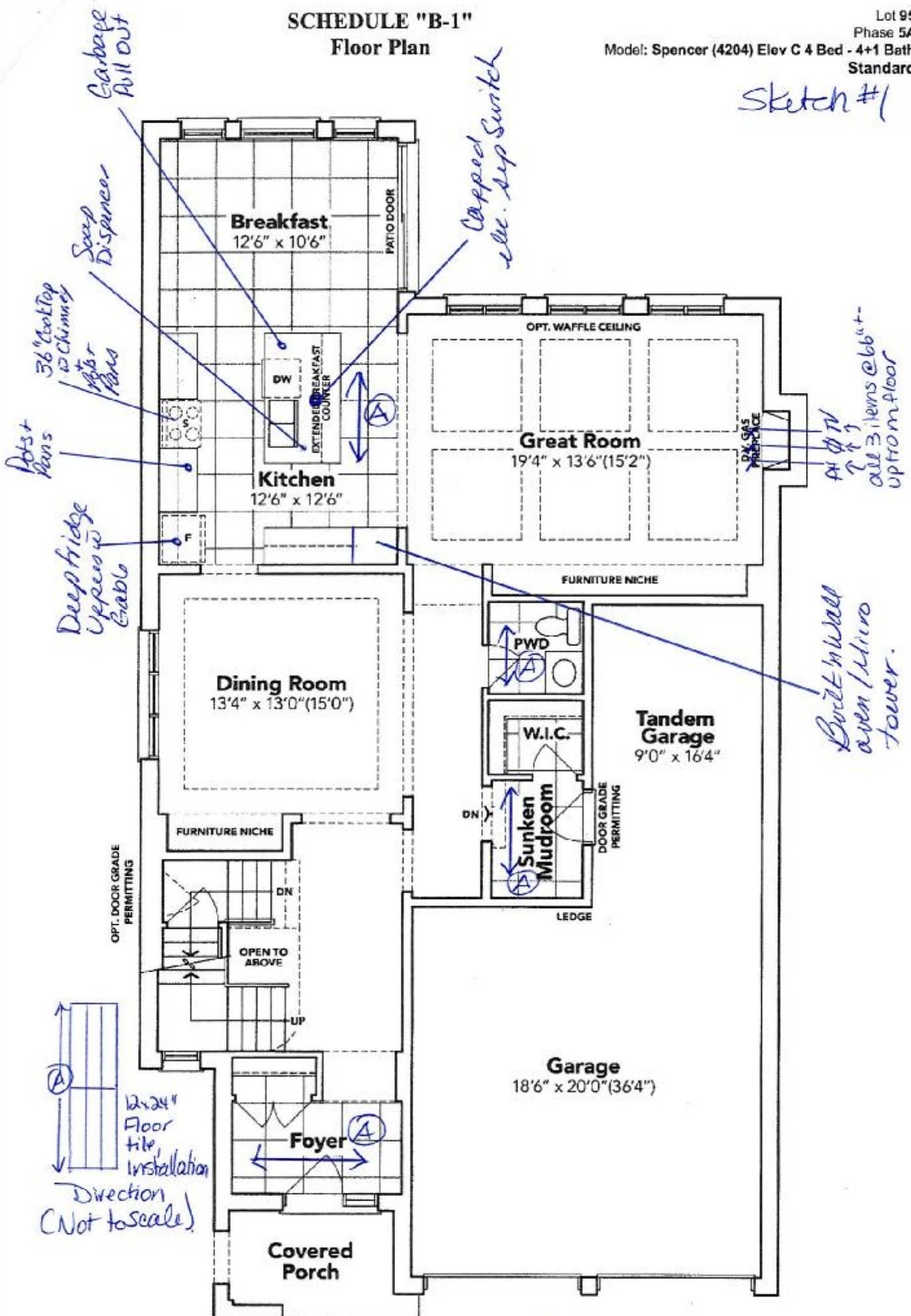

**GROUND FLOOR EL. C**

*A. Phallit Gm*

The floor plans and elevations shown are pre-construction plans and may be revised or improved as necessitated by architectural controls and the construction process. The measurements adhere to the rules and regulations of the TARION Warranty Corporation's official method for the calculation of floor area. Materials, specifications and floor plans are subject to change without notice. All house renderings are artist's concept only. Actual usable floor space may vary from the stated floor area. All options shown are upgrades. E. & O. E.

# SCHEDULE "B-1"

## Floor Plan

Lot 95  
Phase 5A  
Model: Spencer (4204) Elev C 4 Bed - 4+1 Bath  
Standard

Sketch  
#2

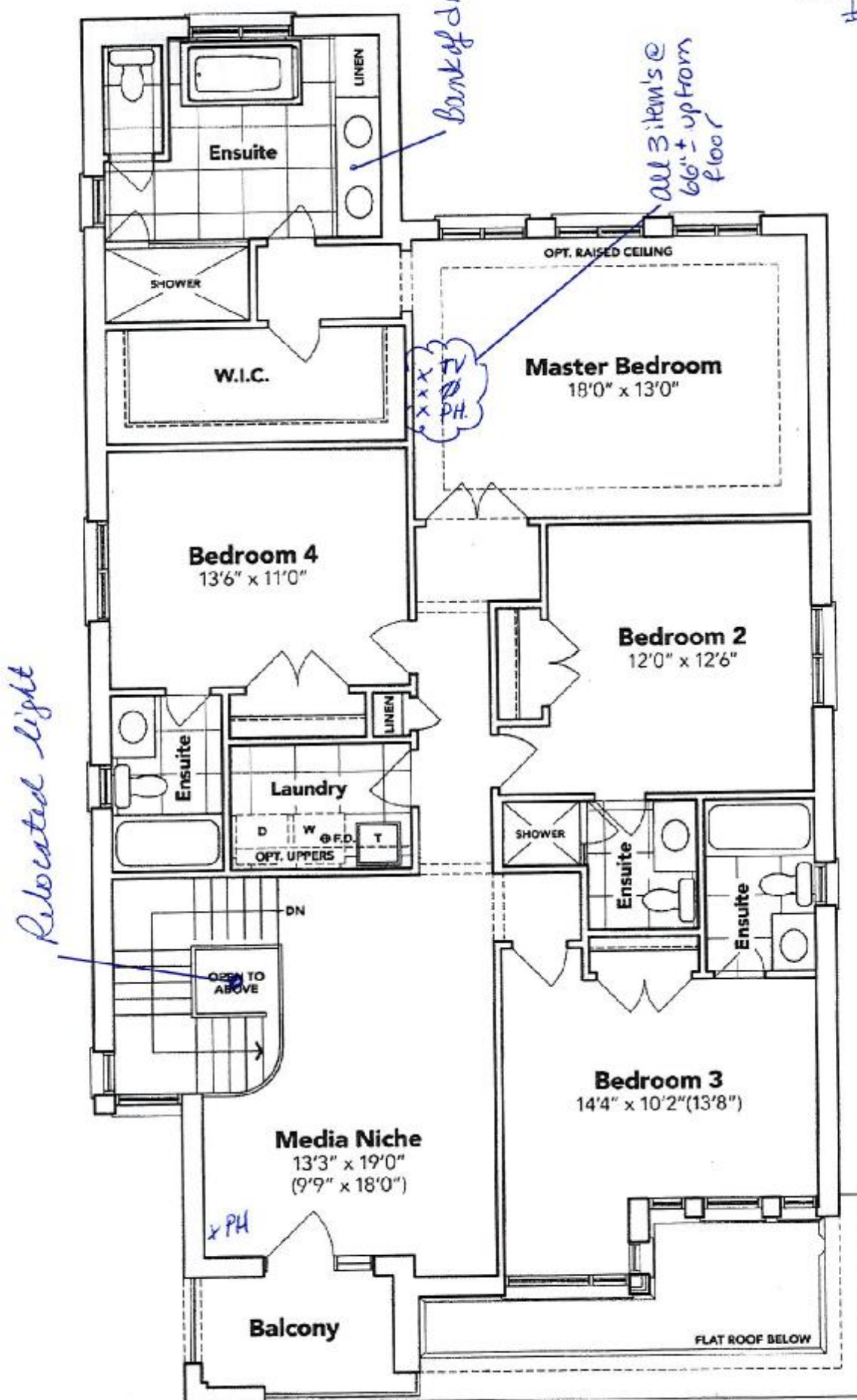

## SECOND FLOOR EL. C

*Handwritten signature/initials*

The floor plans and elevations shown are pre-construction plans and may be revised or improved as necessitated by architectural controls and the construction process. The measurements adhere to the rules and regulations of the TARION Warranty Corporation's official method for the calculation of floor area. Materials, specifications and floor plans are subject to change without notice. All house renderings are artist's concept only. Actual usable floor space may vary from the stated floor area. All options shown are upgrades. E. & O. E.

RECEIVED

JUL 28 2022

SCHEDULE "B-1" - Page 2 of 3

Initials: *Handwritten initials*



**SCHEDULE "B-1"**  
**Floor Plan**

Lot 95  
Phase 5A  
Model: Spencer (4204) Elev C 4 Bed - 4+1 Bath  
Standard

*Sketch  
#3*

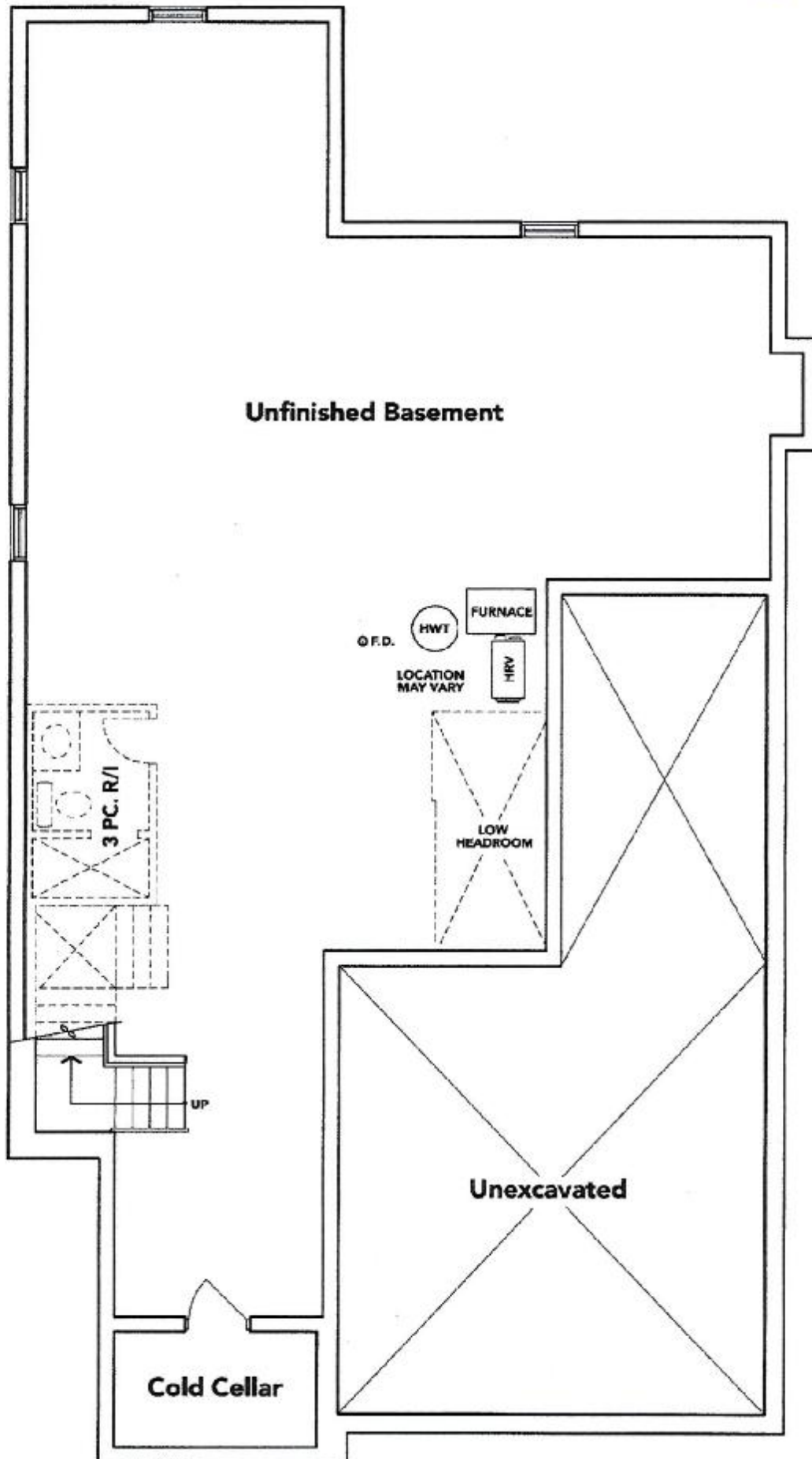

**BASEMENT EL. C**

*2 attached units*

The floor plans and elevations shown are pre-construction plans and may be revised or improved as necessitated by architectural controls and the construction process. The measurements adhere to the rules and regulations of the TARION Warranty Corporation's official method for the calculation of floor area. Materials, specifications and floor plans are subject to change without notice. All house renderings are artist's concept only. Actual usable floor space may vary from the stated floor area. All options shown are upgrades. E. & O. E.



SCHEDULE "B-1" - Page 1 of 3

Initials: \_\_\_\_\_

LOT: 95 THAMES PH. 5 A  
RE: FRIDGE SPEC'S

LG  
LFXC22596S

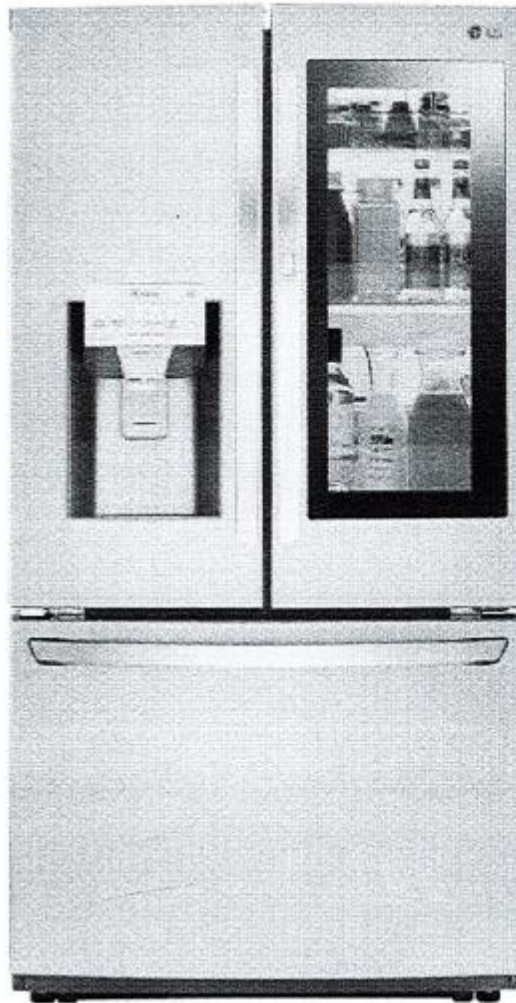

*A. Abdul Jot Sim*





*Handwritten signature*

14 INSTALLATION

Dimensions and Clearances

- Check the dimensions of the appliance and the installation path to ensure there is sufficient room to move the refrigerator through doors or narrow openings.
- If an opening is too narrow to fit the refrigerator through, the doors must be removed.
- The installation location chosen for the refrigerator should allow space behind the unit for connections and airflow and space in front to open the doors and drawers.
- Too small of a distance from adjacent items may result in lowered freezing capability and increased electricity consumption charges. Allow at least 24 inches (610 mm) in front of the refrigerator to open the doors, and at least 2 inches (50.8 mm) between the back of the refrigerator and the wall.

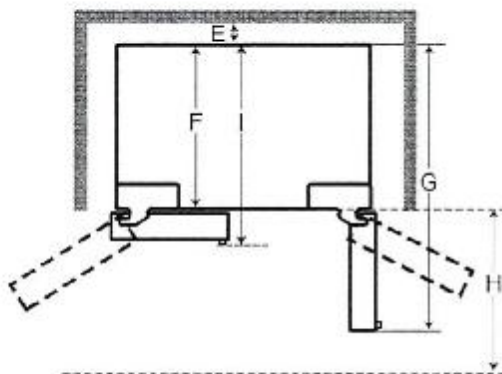
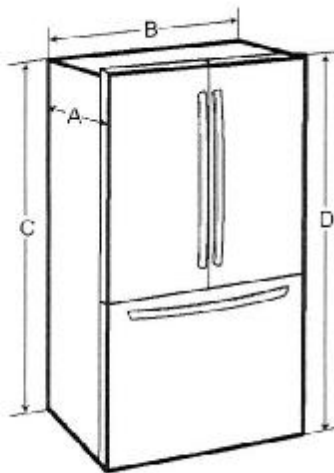

-	List	LFXS28596*/ LMXS28596*	LFXS26596*	LFXC22596*
A	Depth without handle	33 3/4" (857 mm)	32 3/8" (822 mm)	28 3/4" (728 mm)
B	Width	35 3/4" (908 mm)	35 3/4" (908 mm)	35 3/4" (908 mm)
C	Height to Top of Case	68 3/8" (1737 mm)	68 3/8" (1737 mm)	68 3/8" (1737 mm)
D	Height to Top of Hinge	69 3/4" (1772 mm)	69 3/4" (1772 mm)	69 3/4" (1772 mm)
E	Back Clearance	2" (50 mm)	2" (50 mm)	2" (50 mm)
F	Depth without Door	29 7/8" (759 mm)	28 1/2" (724 mm)	24 3/4" (630 mm)
G	Depth (Total with Door Open 90°)	48 1/2" (1232 mm)	47 1/8" (1197 mm)	43 1/2" (1103 mm)
H	Front Clearance	24" (610 mm)	24" (610 mm)	24" (610 mm)
I	Depth With handle	36 1/4" (921 mm)	34 7/8" (886 mm)	31 1/4" (792 mm)

RECEIVED  
JUL 28 2022

## 36" Gas Cooktop

800 Series – Stainless Steel NGM8658UC

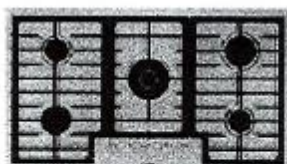

**NGM8658UC**  
Stainless Steel

Also available in:

Black w/Black Stainless  
Knobs

NGM8648UC

The 800 Series gas cooktop with FlameSelect® is a better way to cook with gas and delivers precision flame levels for consistent results.

### Features & Benefits

FlameSelect® offers 9 distinct power levels and delivers precision flame height every time for consistent, repeatable results.

Dual-ring power burner has 2 rings for low and high flame settings so you can go from simmer to sear with ease.

Dishwasher safe heavy-duty enameled cast iron grates makes cleanup simple and convenient.

OptiSim® burner offers more flame control at the lowest settings for precise simmering and melting.

Control knob with red LED light line indicates if burner is on and the burner's residual heat.

### General Properties

No. of burners	5
Knob color	Stainless Steel Appearance
Control location	Front-Center
Sealed burners	Yes
Valves	Five 9-Level Gas Valves
Ignition system	Electronic; Thermocouple Flame Monitor Control
Cooktop surface material	Stainless Steel
Grate material	Cast Iron
Grate features	Continuous Grates, Dishwasher Safe

### Element Performance

Total BTU load (NG / LP)	42,700 / 41,400
Power of front left burner (NG / LP)	3,400 / 3,400
Power of back left burner (NG / LP)	6,000 / 6,000
Power of center burner (NG / LP)	17,000 / 15,700
Power of back right burner (NG / LP)	10,300 / 10,300
Power of front right burner (NG / LP)	6,000 / 6,000



**FlameSelect**

### Technical Details

Circuit breaker	15 A
Volts	120 V
Frequency	60 Hz
Plug type	3-Prong
Power cord length	40"
Fuel type	Natural Gas (Factory Set)
Convertible to LP (kit required)	Yes

### Dimensions & Weight

Overall appliance dimensions (HxWxD)	3 3/4" x 37" x 21 1/4"
Required cutout size (HxWxD)	2" x 34 15/16" x 19 1/8"
Minimum distance from counter front	1 7/8"
Minimum distance from rear wall	3"
Net weight	46 lbs

### Accessories – Included

Included	LP Conversion Kit, OptiSim® Cap
----------	---------------------------------

### Accessories – Optional



**HEZ298102**  
Wok Ring



**HEZ9GR58UC**  
Griddle



*L. phat j. line*

\*To be fully ADA compliant, these units must be installed according to ADA guidelines. Please check current ADA requirements for guidance on installation.

**Accessories:** To purchase Bosch accessories, cleaners & parts please visit [www.bosch-home.com/us/store](http://www.bosch-home.com/us/store) or call 1-800-544-2904 (Mon to Fri 9 am to 6 pm PST, Sat 9 am to 3 pm PST).

**Notes:** All height, width and depth dimensions are shown in inches. BSH reserves the absolute and unrestricted right to change product materials and specifications, at any time, without notice. Consult the product's installation instructions for final dimensional data and other details prior to making cutout.

**Warranties:** Please see Use & Care manual or Bosch website for statement of limited warranty.

For more information on our entire line of products, go to [www.bosch-home.com/us](http://www.bosch-home.com/us) or call 1-800-944-2904

© BSH Home Appliances Corporation. All rights reserved. Bosch is a registered trademark of Robert Bosch GmbH.

36" Gas Cooktop

800 Series – Stainless Steel NGM8658UC



Important: Information is preliminary and should be used for planning purposes only.

Installation Details

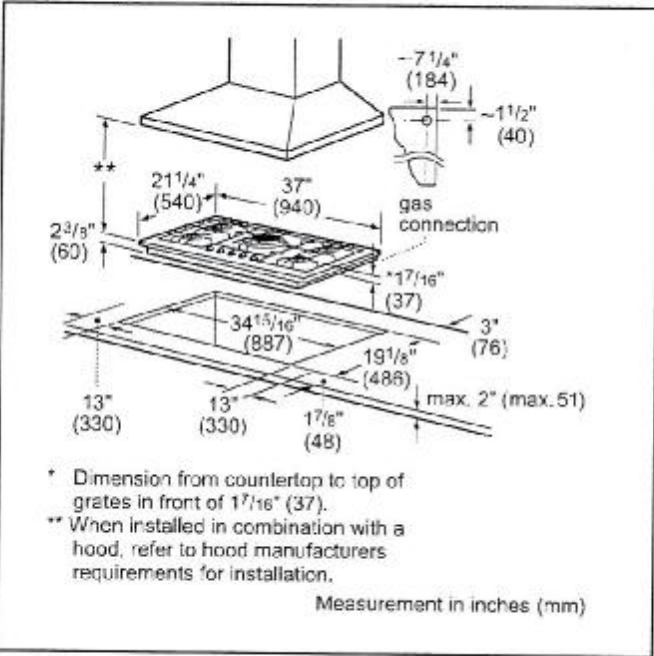

*x phal jot sine*



Accessories: To purchase Bosch accessories, cleaners & parts please visit [www.bosch-home.com/us/store](http://www.bosch-home.com/us/store) or call 1-800-944-2904 (Mon to Fri 5 am to 5 pm PST, Sat 6 am to 3 pm PST).  
Notes: All height, width and depth dimensions are shown in inches. BSH reserves the absolute and unrestricted right to change product materials and specifications, at any time, without notice. Consult the product's installation instructions for final dimensional data and other details prior to making cutout.  
Warranties: Please see Use & Care manual or Bosch website for statement of limited warranty.  
For more information on our entire line of products, go to [www.bosch-home.com/us](http://www.bosch-home.com/us) or call 1-800-944-2904.  
© BSH Home Appliances Corporation. All rights reserved. Bosch is a registered trademark of Robert Bosch GmbH.



## 36" Gas Cooktop

800 Series – Stainless Steel NGM8658UC



**BOSCH**  
Invented for life

Important: Information is preliminary and should be used for planning purposes only.

### Installation Details

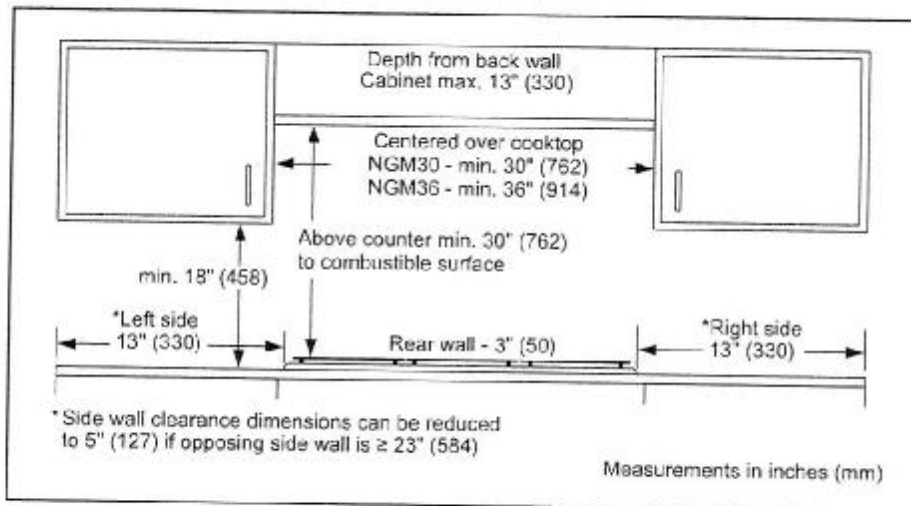

*as attached file*



LOT: 95 THAMES PH. 5 A  
RE: BUILT IN WALL OVEN/MICRO SPEC'S  
" NO FLUSH INSTALLATION "

*X Phalokin*

# HOME APPLIANCES

## LG COOKING

### LWC3063\_

#### Combi Wall Oven

1.7 cu.ft. Microwave (Speed Oven)

Infrared Heating™

4.7 cu.ft. Oven

Crisp Convection

Self+EasyClean

SmartThinQ® Technology

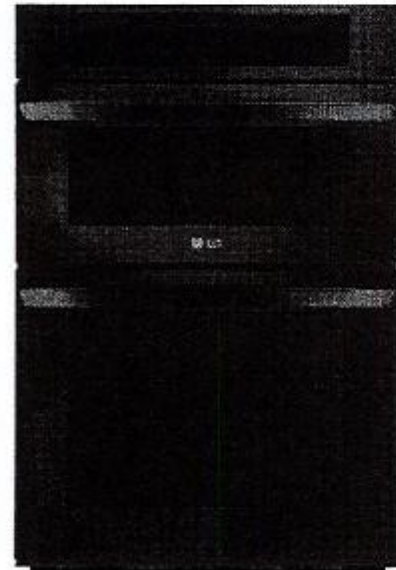

Enjoy new ways to control your home with LG smart appliances

- Start or stop your Oven remotely
- Set your Monitor Status from your smartphone
- Works with the LG SmartThinQ® app

SmartThinQ® works with the Google Assistant Alexa innot SIDECHEF

#### SUMMARY

Total Oven Capacity (cu. ft.)	6.4 (Upper & Lower)
Colors	Stainless Steel / Black Stainless Steel
<b>UPPER OVEN FEATURES</b>	
Capacity (cu.ft.)	1.7
Interior(Cavity) - Upper MWO / Lower Oven	Stainless / Enamel Coating
Microwave Power output	950W
Microwave mode power consumption	1650W
Convection Bake mode power consumption	1550W
Broil mode power consumption	1650W
Convection Element (W)	1500W (Sheath heater)
Broil Upper Element (W)	1200W + 700W (Miraclean heater) + 500W (Infrared Heating™)
Broil Lower Element (W)	375W (Miraclean heater)
Microwave	Yes
Convection Bake	Yes
Broil	Yes
Speed cook	Yes (TurboCook™)
- # of Defrost (4 Menu)	Meat / Poultry / Fish / Bread
- # of Sensor cook (9 Menu)	Beverage / Casserole / Chicken / Pasta / Pizza / Plate of Food / Rice / Soup / Vegetable
- # of Auto cook (28 Menu)	Bacon (regular sliced) / Bagels (frozen) / Baked potatoes (3-9oz/ea) / Browie / Cod Fillets (1 lb) / Corn dog (frozen) / Fresh vegetable / Frozen chicken wings / Frozen fries / Frozen chicken nuggets / Frozen pizza (square, crust) / Frozen soft pretzels / Frozen vegetable / Garlic bread (sliced, frozen) / Hamburger (1/2" thick) / Lamb chops (1/2" thick, 6-7oz) / Meat loaf (3" x 5") / Nachos / Oatmeal / Pork chops (1/2" thick, 6-7oz) / Quinoa / Rib eye steak (1" thick 14-15oz) / Rice / Salmon steak (1" thick) / Sausage / Sirloin steak (1" thick, 16-21oz) / Tenderloin / Vegetable-canned
- # of Soften (4 Menu)	Butter & Margarine / Cream Cheese / Ice Cream / Frozen Juice
- # of Melt (5 Menu)	Butter / Caramel / Cheese / Chocolate / Marshmallow
<b>LOWER OVEN FEATURES</b>	
Capacity (cu.ft.)	4.7
EasyClean®	Yes
Self Clean	Yes (3,4,5 hours)
Variable cleaning time	Yes (3,4,5 hours)
Variable broil	Yes (Full/Center / High/Med/Low)
Broil element	2,500 watts inner / 1,500 watts outer
Bake element	2,500 watts
Bake element type	Hicklen (8 pass)
# of rack position	5
12 hrs. shut-off	Yes
- # of light	3 (Halogen Lamp - 3 dimension lighting)
Convection conversion	Yes
- Convection element	Yes (2,000 watts Sheath heater)
Convection System/Mode/Cooking System	Conventional
Convection Fan	Dual Speed (High/Low)
Oven Cooking mode	ConvBake / ConRoast / Bake / Broil / Steam Bake / Steam Roast / Probe / more mode (Favorite/Menu/Proof)
Oven Control Features	Glass Touch (SmoothTouch™)
Door Lock	Yes

#### CONTROL

Oven Control Type	Glass Touch (SmoothTouch™)
Display	White VFD
Language	English / Spanish / French
Smart Function	Wi-Fi / Smart Buzzer
Clock	12 hr or 24 hr (option)
Kitchen Timer	Yes
Timed Cook	Yes
Temperature Unit of Measure	Fahrenheit / Celsius
Cooking Complete Reminder Volume	Beeper (1. Loud, 2. Low, 3. Mute)
<b>APPEARANCE</b>	
Available Colors	Stainless Steel / Black Stainless Steel
Handle/Knobs	Stainless Steel Finish (Aluminum) / Black Stainless Steel Finish (Aluminum)
Oven Door Feature	WideView™ Window
Scratch-Resistant	Yes
PrintProof™ Finish	Yes (Only Black Stainless Steel)

#### SmartThinQ® SMART FEATURES

SmartDiagnosis™	Yes
Wi-Fi Connectivity	Yes
Works with	Google Assistant and Amazon Alexa
SmartThinQ® with Innot and SideChef	Yes

#### DIMENSIONS/CLEARANCES/WEIGHT

Shipping Weight (lbs)	244 lbs
Product Weight (lbs)	194 lbs
Product (W x H x D)	29 3/4" x 43 13/16" x 24 1/2"
Cut-out (W x H x D)	28 1/2" x 43 8/19" x 23 1/2"
Overall Depth (in) - including handle	26 7/8"
Actual Depth with Door Open (Upper) (in)	37.1"
Actual Depth with Door Open (Lower) (in)	45.7"
Oven Interior Dimensions (Upper) (in) (W x H x D)	20 8/11" x 8 9/25" x 17 5/13"
Oven Interior Dimensions (Lower) (in) (W x H x D)	24 1/2" x 17 5/8" x 18 7/9"
Carton Dimensions (in) (W x H x D)	33" x 30" x 50"

#### POWER/RATINGS

Amp at 240V	32.5A
kW at 240V	7.8kW
Requirements	120 / 240 VAC 120 / 208 VAC

#### ACCESSORIES

Glass Tray(Upper)	Yes
Metal Tray(Upper)	Yes
Rack(Upper)	Yes
Broiler pan & Grid	Yes
Sliding Rack	1
Heavy Duty Rack	2
Meat probe	Yes
Scouring Pad	Yes

#### WARRANTY

Parts & Labor	1 Year
---------------	--------

#### UPC CODES

LWC3063ST (Stainless Steel)	048231039810
LWC3063BD (Black Stainless Steel)	0482311339827



LOT: 95 THAMES PH. 5 A  
RE: BUILT IN WALL OVEN/MICRO SPEC'S  
CONT  
" NO FLUSH INSTALLATION "

*✓ Abdul ASim*

## HOME APPLIANCES

## LG COOKING

# LWC3063\_

## Combi Wall Oven

## QUICK INSTALL & CLEARANCES

For full installation directions/clearances please refer to the corresponding User Manual and Installation Guide.

### DIMENSIONS / CLEARANCES / WEIGHT

Product Dimensions (in) (W x H x D)	29 3/4" x 43 13/16" x 24 1/2"
Cut-out (W x H x D)	28 1/2" x 43 8/19" x 23 1/2"
Overall Depth (in) - including handle	26 7/8"
Actual Depth with Door Open (Upper) (in)	32.1"
Actual Depth with Door Open (Lower) (in)	45.7"
Oven Interior Dimensions (Upper) (in) (W x H x D)	20 0/11" x 9 9/25" x 17 5/13"
Oven Interior Dimensions (Lower) (in) (W x H x D)	24 1/2" x 17 5/8" x 18 7/8"
Carton Dimensions (in) (W x H x D)	33" x 30" x 50"
<b>POWER RATINGS</b>	
Amp at 240V	32.5A
kW at 240V	7.8kW
Requirements	120 / 240 VAC, 120 / 208 VAC

### INSTALLATION REQUIREMENTS

- The cabinet base platform must be able to support 202 lbs (91.65 kg) for a Microwave Combination Wall Oven. If the cabinet does not have a solid bottom, two braces or runners must be installed level with the bottom of the cutout to support the weight of the oven. Make sure the base is level, and the front of the cabinet is square. If the cabinet base is not level, the oven racks will tend to slide out when opening the door.
- If marks, blemishes or the cutout opening are visible above the installed oven, it may be necessary to add wood shims under the runners and front trim until the marks or opening are covered.
- If the cabinet does not have a front frame and the sides are less than 3/4" (1.9 cm) thick, shim both sides equally to establish the cutout width.
- The junction box must be flush with the rear wall of the cabinet as shown below.
- Allow at least a 23" clearance for the door depth when it is open.
- Kitchen cabinets in contact with the oven must be heat resistant up to 194°F (90°C), and fronts of nearby units up to at least 158°F (70°C).

### CUTOUT DIMENSIONS

- Cabinet Width: 30" (762 mm)
- Recommended Minimum Cutout Location from Floor: 12" (3048 mm)
- Cutout Depth: 23 1/2" Min. (595 mm)
- Cutout Width: 28 1/2" Min. (723 mm)  
28 5/8" Max. (727 mm)
- Cutout Height: 43 7/16" Min. (1103 mm)  
43 1/2" Max. (1105 mm)

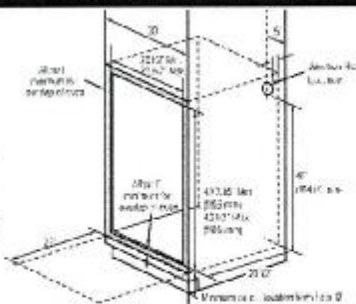

### PRODUCT DIMENSIONS

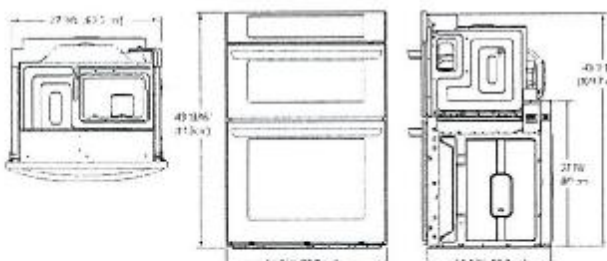

### ELECTRICAL CONNECTIONS

- Be sure the wall oven is installed and grounded properly by a qualified installer or service technician.
- This wall oven must be electrically grounded in accordance with local codes or, in their absence, with the National Electrical Code ANSI/NFPA No. 70- latest edition in United States, or with CSA Standard C22.1-1982 and C22.2 No.01982 (or latest edition), Canadian Electrical Code, Part 1, and all local codes and ordinances.
- This wall oven must be supplied with the proper voltage and frequency, and connected to an individual, properly grounded branch circuit, protected by a circuit breaker or fuse. For the circuit breaker or fuse required by this model, see the rating plate to find the wattage consumption and refer to the table below to get the circuit breaker or fuse amperage.
- A Microwave Combination Wall Oven can consume up to 7,800 W at 240 VAC. A 50 Amp circuit breaker with wire gauge #8 AWG must be used.
- Do Not ground to a gas pipe.
- Do Not have a fuse in the neutral or grounding circuit.
- A UL-listed conduit connector must be provided at the junction box.
- Prepare the electrical connection as follows:**
- Turn off the circuit breaker or remove fuses to the oven branch circuit.
- With the oven positioned directly in front of the cabinet opening, connect the flexible conduit to the electrical junction box as shown below. Position the conduit in such a manner that it will lie on top of the oven in a natural loop when the oven is installed.
- If local codes permit connection of the frame grounding conductor to the neutral (white) wire, follow the instructions for a 3-wire circuit connection.
- If used in mobile homes or new construction, or a recreational vehicle, or local codes do not permit connection of the frame grounding conductor to the neutral (white) wire, follow the instructions for a 4-wire circuit connection.

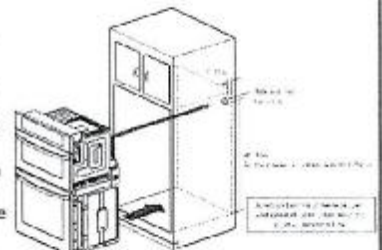

### INSTALL THE OVEN

- Install the oven into the cabinet as follows:**
- Slide the oven into the opening.
  - Loop (do not tie) a 36" (91 cm) string around the conduit before the oven is slid into place. Lay the string over the top of the oven and use it to keep the conduit from falling behind the oven.
  - Lift oven into cabinet cutout using the oven opening as a grip. Carefully push against the oven front frame. Do not push against outside edges.
  - While sliding the oven back, pull the string so that the conduit lies on the top of the oven in a natural loop.
  - When you are sure the conduit is out of the way, slide the oven 3/4 way back into the opening. Remove the string by pulling on one end of the loop.
- Secure the oven.
  - Using the mounting holes on the oven side trim as a guide, drill pilot holes for screws provided. (For securing the Combi Oven, use a minimum of 4 screws, one on each side in both the upper and lower ovens.)
  - Secure the oven to the cabinet with screws provided. If the cabinet is particle board, you must use 3/4" particle board screws. These may be purchased at any hardware store.
- Install the metal bottom trim.
  - Place the metal bottom trim centered over the pre-drilled mounting holes on the lower base.
  - Using 3 screws provided, secure the bottom trim to the bottom edge of the cabinet.
- Reinstall the oven door.

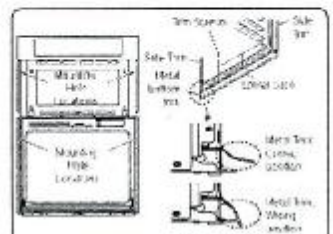

LOT: 95 THAMES PH. 5 A  
RE: 36" CHIMNEY HOOD FAN

*X Baffle Fan*

Specifications

Air Flow Volume: 650 CFM  
Electrical Connection: 120V/60Hz  
Power Consumption: 240 Watts  
Current: 2.0 Amps  
Fan Speed: 1599 RPM  
Finishes: Stainless Steel  
Duct: 6" Round  
Knock-out: 6" Round - Top Only  
Dimensions: Width: 30"/36"  
Height: 44 1/2"  
Depth: 19 3/4"  
Noise Level: Min. 2 Sones  
Max. 7 Sones



SCB722 - Baffle Filter



Ordering Model Chart

Model	Colour	Knock-out	Duct	Size	Filter	CFM
SCB72230	Stainless Steel	6"	6" Round	30"	Baffle	650
SCB72236	Stainless Steel	6"	6" Round	36"	Baffle	650

Notes

\_\_\_\_\_

\_\_\_\_\_

\_\_\_\_\_

\_\_\_\_\_

\_\_\_\_\_

\_\_\_\_\_





LOT: 95 THAMES PH. 5 A  
RE: UPGRADED KITCHEN UNDER MOUNT  
SINK AND SOAP DISPENSER

*Application*

**BLANCO**

Sink Specifications

Colour	SKU
brushed finish	401247

Design and planning tips

- Min cabinet size: 36 in ( 915 mm )
- Bowl Depth: 9 in ( 230.0 mm )

Specifications:  
Installation clips, Sink template, Installation instructions, 3  
½" (90 mm) stainless steel strainers

Depending on cabinet construction, a different cabinet  
size may be required. Consult the cabinet manufacturer.

QUATRUS U 2

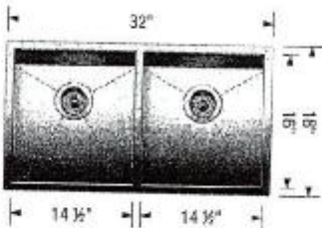

**Soap or Lotion Dispensers**

Traditional Transitional Modern

However you define your faucet's style,  
you can assure a coordinated look with Moen soap dispensers.



Transitional Soap or  
Lotion Dispenser  
Model 3942 *GIROME*

KITCHEN



LOT: 95 THAMES PH. 5 A  
RE: UPGRADED UNDER MOUNT SINKS  
FOR ALL BATHROOMS

CATENA  
RECTANGULAR UNDERMOUNT SINK

4210CIV Undermount Sink

PRODUCT SPECS:

- Vitreous China
- Front overflow hole
- Template and mounting hardware supplied

DIMENSIONS:

Outer:

510mm W x 390mm D x 190mm H  
20" W x 15 1/4" D x 7 1/2" H

Inner:

458mm W x 340mm D x 140mm H  
18" W x 13 1/4" D x 5 1/2" H

COMPLIANCE CERTIFICATIONS

Meets or exceeds the following:

- IAPMO cUPC
- ASME A112.19.2 / CSA B45.1
- OBC Section 3.8 Barrier Free design and CSA B651 Standard

SHIPPING

Cube 1.72  
GW 27 lbs

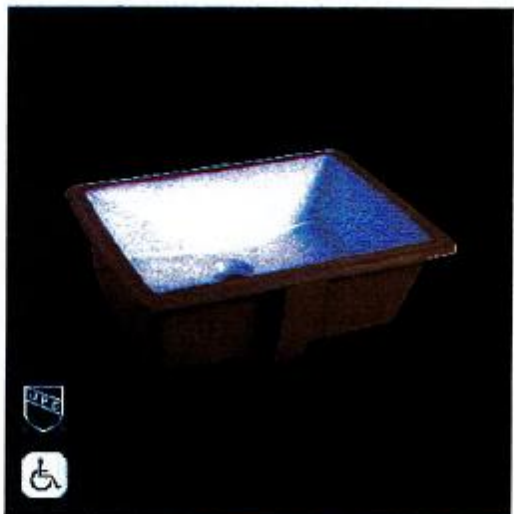
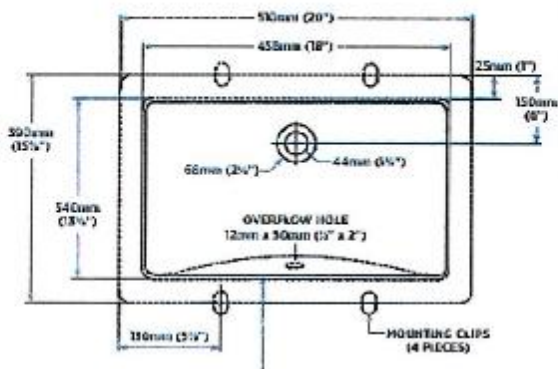

TO BE SPECIFIED

- Color
- Soft 10" to 12"

NOTES: Dimensions of fixtures are correct and may vary within the range of tolerances established by ASTM standard A82.512. These measurements are subject to change or cancellation. No responsibility is assumed for use of a dimensional or material change. Products are designed to comply with CSA and ASME standards and OBC barrier-free requirements. It is the responsibility of the installer to comply with the local accessibility code and standards when installing the product.

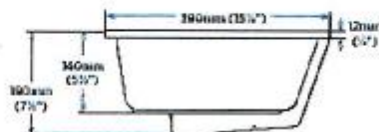

*Athal 2016*