

KINGSMEN (THAMES) INC. / Havelock Corners (Kingsmen)

Lot/Unit: 172 Phase/Building: 5A Model/Floor Plan: Louis (4203) Elev B 4 Bed - 4+1 Bath

CABINETRY APPLIANCE - FRIDGE

Inv.5665	1 - To supply & install the 66CM DEEP FRIDGE ENCLOSURE - COUNTER DEPTH WITH NO WALLS - 2 66CM DEEP GABLES AND 1 66CM DEEP CABINET - THIS IS NOT A ZERO CLEARANCE ENCLOSURE. STANDARD HEIGHTS AND WIDTHS WILL BE USED. - in the kitchen... see sketch # 1	
Line 72403	Note:	
4Jul22 / 19Jul22		

CABINETRY HOOD FANS

Inv.5665	1 - To increase the stove opening to 36" in lieu of the standard 30" stove opening.	
Line 72738	Note:	
4Jul22 / 19Jul22		

CABINETRY MICROWAVE OVEN STOVE COOKTOP

Inv.5665	1 - To supply & install accomodations for the 36" COOKTOP CABINET WITH FALSE TOP DRAWER AND POTS AND PANS DRAWERS BELOW - SUPPLY SPECS -see sketch # 1	
Line 72733	Note:	
4Jul22 / 19Jul22		
Inv.5665	1 - To supply & install accomodations for a BUILT-IN TALL APPLIANCE CABINET WITH DRAWER - S BELOW FOR PANEL-MOUNT - PROUD - OR TRIM KIT INSTALLATIONS - TRIM KIT REQUIRED - SUPPLY ALL SPECS AND INSTALLATION GUIDES - COUNTER DEPTH in the kitchen... see spec's.	
Line 72734	Note: See sketch # 1	
4Jul22 / 19Jul22		

CABINETRY VANITY

Inv.5665	1 - To supply & install a VANITY BANK OF DRAWERS - in the master ensuite bathroom... see sketch # 2	
Line 72408	Note:	
4Jul22 / 19Jul22		

CARPET

Inv.5665	1 - To supply & install the upgraded Escape to Maui carpet to the master bedroom, bedroom # 2, # 3 and # 4 in lieu of the standard carpet... see colour chart for details.	
Line 72419	Note:	
4Jul22 / 19Jul22		

COUNTER TOP

Inv.5665	1 - To accomodate the quartz countertop in the kitchen for the future 36" Cook top ... see spec's.... see sketch # 12	
Line 72731	Note:	
4Jul22 / 19Jul22		
Inv.5665	1 - As per schedule "PE": Vendor to include level 1, 2cm. quartz in all bathrooms, as per plan, in lieu of the included laminate counter tops. Selections to be made from builders standard samples.	
Line 72395	Note:	
4Jul22 / 19Jul22		

ELECTRICAL

KINGSMEN (THAMES) INC. / Havelock Corners (Kingsmen)

Lot/Unit: 172 Phase/Building: 5A Model/Floor Plan: Louis (4203) Elev B 4 Bed - 4+1 Bath

Inv.5665	1 - To supply & install the standard T.V. rough in in the great room and master bedroom... see sketch # 1 & # 2	
Line 72396	Note: Install the standard T.V rough in at approx. 66" + - up from the floor centered + - to the F/p mantle in the great room.	
4Jul22 / 19Jul22		
Inv.5665	1 - To supply & install the standard Phone (CAT 5) rough in in the great room , master bedroom and bedroom # 4.. see sketch # 1 & # 2	
Line 72397	Note: Install the standard Phone (CAT 5) rough in at approx. 66" + - up from the floor centered + - to the F/p mantle in the great room.	
4Jul22 / 19Jul22		
Inv.5665	1 - To SUPPLY AND INSTALL AN ADDITIONAL BASIC RECEPTACLE (NOT DEDICATED) at approx. 66" + - up from the floor centered + - to the F/P mantle	
Line 72398	Note: In the great room... see sketch # 1	
4Jul22 / 19Jul22		
This is for a future wall mount T.V.		
NO CONDUIT PIPE HAS BEEN PURCHASED.		
Inv.5665	1 - To SUPPLY AND INSTALL EXTRA 240 STOVE PLUG for the future built in wall oven/microwave combo... see spec's... see sketch # 1	
Line 72735	Note:	
4Jul22 / 19Jul22		
Inv.5665	1 - To supply & install a 36" stainless steel reg. style hood fan in lieu of the standard 30" stainless steel hood fan in the kitchen.	
Line 72737	Note:	
4Jul22 / 19Jul22		

HARDWOOD

Inv.5665	1 - To supply & install the 3 1/2" Elements Oak Engineered stained hardwood to the upper hallway area in lieu of the standard carpet... see colour chart for details.	
Line 72418	Note:	
4Jul22 / 19Jul22		

HEATING AND AIR CONDITIONING

Inv.5665	1 - To supply & install a capped gas line rough in with a 110V elec. outlet for the future Gas cook top in the kitchen... see spec's	
Line 72732	Note:	
4Jul22 / 19Jul22		
Inv.5665	1 - As per schedule "PE": Vendor to install capped gas line (rough in only) at rear of home for future BBQ location. Location to be finialized at vendors sole discretion.	
Line 72393	Note:	
4Jul22 / 19Jul22		
Inv.5665	1 - As per schedule "PE": Vendor to supply & install air conditioning unit, sized accordingly, from vendors standard samples.	
Line 72394	Note:	
4Jul22 / 19Jul22		

MISCELLANEOUS

PLUMBING

KINGSMEN (THAMES) INC. / Havelock Corners (Kingsmen)

Lot/Unit: 172 Phase/Building: 5A Model/Floor Plan: Louis (4203) Elev B 4 Bed - 4+1 Bath

Inv.5665	1 - To supply & install the WATERLINE ROUGH-IN TO THE FRIDGE LOCATION (NO HOOK UP) in the kitchen..	
Line 72402	Note:	
4Jul22 / 19Jul22		
Inv.5665	1 - To supply & install th MIROLIN BROOKE free standing tub in the master ensuite in lieu of the standard free standing tub... see spec's	
Line 72410	Note:	
4Jul22 / 19Jul22		
Inv.5665	6 - To supply & install the VANITY SINK - CONTRAC CATENA UNDERMOUNT - MODEL 4210CIY in the powder room, master bedroom, ensuite # 2 # 3 & # 4's bathroom in lieu of the standard top mount vanity sinks...see spec's	
Line 72411	Note: Still to install the standard lav. faucets.	
4Jul22 / 19Jul22		

TILE - FLOOR

Inv.5665	1 - To supply & install the UPGRADE 4 - FLOOR TILE - STACKED - FOYER TILE area in lieu of the standard floor tiles...see colour chart for details.	
Line 72413	Note:	
4Jul22 / 19Jul22		
Inv.5665	1 - To supply & install the UPGRADE 4 - FLOOR TILE - STACKED - POWDER ROOM TILE area in lieu of the standard floor tiles...see colour chart for details.	
Line 72414	Note:	
4Jul22 / 19Jul22		
Inv.5665	1 - To supply & install the UPGRADE 4 - FLOOR TILE - STACKED - KITCHEN/BREAKFAST TILE area in lieu of the standard floor tiles...see colour chart for details.	
Line 72415	Note: (to include the pantry area)	
4Jul22 / 19Jul22		
Inv.5665	1 - To supply & install the UPGRADE 4 - FLOOR TILE - STACKED - MUD ROOM TILE area in lieu of the standard floor tiles...see colour chart for details.	
Line 72416	Note:	
4Jul22 / 19Jul22		

TRIM

Inv.5665	1 - To supply & install a reg. style interior door with trim, to entrance from kitchen to pantry area ... see sketch # 1	
Line 72739	Note:	
4Jul22 / 19Jul22		

KINGSMEN (THAMES) INC. / Havelock Corners (Kingsmen)

Lot/Unit: 172 Phase/Building: 5A Model/Floor Plan: Louis (4203) Elev B 4 Bed - 4+1 Bath

EXTRAS AS PER OFFER

5 FREE APPLIANCES – STAINLESS STEEL FRONT - FRIDGE: STOVE AND DISHWASHER. WHITE WASHER AND DRYER (SUPPLIED ONLY, NOT INSTALLED, FROM BUILDERS STANDARD LINE). AN APPLIANCES VOUCHER WILL BE GIVEN BY OUR DECOR CONSULTANT AT THE TIME OF BOOKING YOUR COLOUR A <i>Worksheet</i> Note:	
VENDOR TO INSTALL CAPPED GAS LINE (ROUGH-IN ONLY) AT REAR OF HOME FOR FUTURE BBQ LOCATION. LOCATION TO BE FINALIZED AT VENDORS SOLE DISCRETION. <i>Worksheet</i> Note:	
VENDOR TO SUPPLY & INSTALL AIR CONDITIONING UNIT, SIZED ACCORDINGLY, FROM VENDORS STANDARD SAMPLES. <i>Worksheet</i> Note:	
VENDOR TO INCLUDE LEVEL 1, 2CM QUARTZ IN ALL BATHROOMS, AS PER PLAN, IN LIEU OF THE INCLUDED LAMINATE COUNTER TOPS. SELECTIONS TO BE MADE FROM BUILDERS STANDARD SAMPLES. <i>Worksheet</i> Note:	

Purchasers: KARANJOT SINGH & DHANVEER KAUR CHAH **Property:** 172 of Plan - Draft Approval SB17-03-08
Telephone Res. / Bus: / **Project:** KINGSMEN (THAMES) INC.
Decor Advisor: Barbara Coccia **Model and Elevation:** Louis (4203) Elev B 4 Bed - 4+1 Bath
Layout Changes: ☐ Yes ☒ No **Sketch Attached:** ☒ Yes ☐ No **Exterior Colour Scheme:**

1. Cabinetry

	Style and Colour	Counter Top	Hardware
Kitchen / Breakfast	#3, Camden Maple Oyster CL	#1, C/S # 9141 Ice Snow 3cm.	#12881 Handle
Kitchen Island	#3, Camden Maple Oyster CL	#1, C/S # 9141 Ice Snow 3cm.	#12881 Handle
Laundry Room	/		
Powder Room	#3, Camden Maple Oyster CL	#1, C/S # 9141 Ice Snow 2cm.	#12881 Handle
Main Bathroom	/		
Master Ensuite Bathroom	#3, Charleston 3DL Orchid	#1, C/S # 9141 Ice Snow 2cm.	# 9661 Handle
Second Ensuite Bathroom (If Applicable)	#3, Charleston 3DL Orchid	#1, C/S # 9141 Ice Snow 2cm.	# 9661 Handle
Ensuite # 3 bahroom	#3, Charleston 3DL Moonlight	#1, C/S # 9141 Ice Snow 2cm.	# 9661 Handle
Ensuite # 4 bahroom	#3, Charleston 3DL Moonlight	#1, C/S # 9141 Ice Snow 2cm.	# 9661 Handle

Appliances

Custom Size Fridge

☐ Yes ☒ No

Cooktop / Rangetop

☒ Yes ☐ No

Valance Lighting

☐ Yes ☒ No

Built in Wall Oven

☒ Yes ☐ No

Microwave / Range Hood

☐ Yes ☒ No

Slide-in Range

☐ Yes ☒ No

Comment

/

2. Flooring

Selection

Foyer	**24 x24" Mayfair Stella Argento Polished HD Rec. Porcelain STACKED
Main Hall	3 1/2" Elements Oak Talon
Back Hall	/
Breakfast	**24 x24" Mayfair Stella Argento Polished HD Rec. Porcelain STACKED (incl. the pantry area)
Laundry Room	13 x 13" Cinq White
Kitchen	**24 x24" Mayfair Stella Argento Polished HD Rec. Porcelain STACKED
Powder Room	**24 x24" Mayfair Stella Argento Polished HD Rec. Porcelain STACKED
Main Bathroom	/
Master Ensuite	13 x 13" Cinq White
Bathroom (If Applicable)	ENS. # 2's Bathroom: 13 x 13" Cinq White
Mud Room	**24 x24" Mayfair Stella Argento Polished HD Rec. Porcelain STACKED
Ens. #3 & #4 bathrooms	13 x 13" Cinq White
Living Room	(Sitting Room) 3 1/2" Elements Oak Talon
Dining Room	/
Family / Great Room	3 1/2" Elements Oak Talon
Den / Library / Study	/
Basement Landing (If Applies)	
Lower Landing (If Applicable)	3 1/2" Elements Oak Talon
Upper Landing	3 1/2" Elements Oak Talon
Upper Hall	**3 1/2" Elements Oak Talon
Master Bedroom	**Escape to Maui # 16847 Honesty
Bedroom #2	**Escape to Maui # 16847 Honesty
Bedroom #3	**Escape to Maui # 16847 Honesty
Bedroom #4	**Escape to Maui # 16847 Honesty
Bedroom #5	/
Mas. # Ens# 2 bathroms	Shower floor: 2x2" Ontario Snow White Matte JAMB/SILL: Anatolia marmiline SNOW



Flooring Continued on Page 2

Initial:

Page 1 of 3

Purchasers: KARANJOT SINGH & DHANVEER KAUR CHAH **Property:** 172 of Plan - Draft Approval SB17-03-08
Telephone Res. / Bus: / **Project:** KINGSMEN (THAMES) INC.
Decor Advisor: Barbara Coccia **Model and Elevation:** Louis (4203) Elev B 4 Bed - 4+1 Bath
 2. Flooring - Continued -

Upgrade Underpad	Type Standard	Area Master bedroom, bedroom #2, #3 & #4
Carpet on Stairs	Capped	Runner - *Upgrade
Comment	/	/

3. Plumbing Fixtures / Faucets

Kitchen	Standard	Second Ensuite	Standard	Powder Room	Standard
Master Ensuite	Standard			Other Room	/
Main Bathroom	/	#3 & #4 ensuite's	Standard		

Comment
 Still to install the standard under mount kitchen sink with the standard single hole kitchen faucet NO PLATE
 Purchaser has upgraded to under mount vanity sinks in ALL bathrooms, still to install the standard lav. faucets.

4. Wall Tile

	Tile Selection	Listello	Insert	Insert Selection
Main Bathroom	/	<input type="checkbox"/>	<input type="checkbox"/>	
Master Ensuite				
Tub Deck	/	<input type="checkbox"/>	<input type="checkbox"/>	
Tub Apron	/	<input type="checkbox"/>	<input type="checkbox"/>	
Tub Surround	/	<input type="checkbox"/>	<input type="checkbox"/>	
Shower Stall	8x10" Cinq White	<input type="checkbox"/>	<input type="checkbox"/>	
Second Ensuite	8x10" Cinq White	<input type="checkbox"/>	<input type="checkbox"/>	
Ensuite # 3 bathroom	8x10" Cinq White	<input type="checkbox"/>	<input type="checkbox"/>	
Ensuite # 3 bathroom	8x10" Cinq White	<input type="checkbox"/>	<input type="checkbox"/>	
Kitchen Backsplash	/	<input type="checkbox"/>	<input type="checkbox"/>	
Complete Backsplash	/	<input type="checkbox"/>	<input type="checkbox"/>	

Comment
 /

horizontal stacked brick pattern vertical stacked diagonal/diamond

5. Fireplace

	Living Room			Family Room			Other Room - Specify Great Room		
	Purchased	As Per Plan	N/A	Purchased	As Per Plan	N/A	Purchased	As Per Plan	N/A
Fireplace Type	<input type="radio"/>	<input type="radio"/>	<input checked="" type="radio"/>	<input type="radio"/>	<input type="radio"/>	<input checked="" type="radio"/>	<input type="radio"/>	<input checked="" type="radio"/>	<input type="radio"/>
Mantle Type							Front Facing		
Over Mantle							NF-8		
Colour / Stain							/		
Surround							White		
Hearth							/		
Comment							/		



Purchasers: KARANJOT SINGH & DHANVEER KAUR CHAH Property: 172 of Plan - Draft Approval SB17-03-08
 Telephone Res. / Bus: / Project: KINGSMEN (THAMES) INC.
 Decor Advisor: Barbara Coccia Model and Elevation: Louis (4203) Elev B 4 Bed - 4+1 Bath

6. Trim Carpentry

Door Hardware Standard handle

Interior Trim Standard

Comment

/

Interior Doors

☐ 2 Panel Arch Top

☒ 2 Panel Square Top

☐ 6 Panel

Initial for Door Style

DC

7. Railings and Pickets

Railing Package Standard oak TURNED picket package

Railing Colour Elements Talon

Wood Stairs ☐ No ☒ Oak

Comment

/

Picket Colour Elements Talon

Tread Colour Elements Talon

8. Plaster Mouldings and Medallions

Foyer /

Main Hall /

Living Room /

Dining Room /

Family Room /

Comment

/

Kitchen/Breakfast /

Den/Library /

Lower Landing /

/

9. Wall Paint

Kingsmen White

Smooth Ceilings

☐ First Floor

☐ First Floor incl. Second Floor Hall

☐ First and Second Floor

☒ Throughout

☐ Not Applicable

Trim Paint Kingsmen White

10. Additional Comments

/

RECEIVED

JUL 19 2022

11. Disclaimers and Notes

- Colours of all materials are as close as possible to builder's selection, but not necessarily identical due to variances in manufacturing.
- Any extras listed above are null and void unless accompanied by a separate invoice/amendment. Said invoice must be paid in full.
- The Purchaser acknowledges that after Interior Colour Selection form is signed and dated, no further changes will be permitted other than re-selection due to unavailability. DC
- The Purchaser acknowledges reading and accepting the "Kingsmen Group Décor Centre Disclaimers" form. This document contains other miscellaneous disclaimers.

This Interior Colour Selection is final and approved by:

Purchaser:

Signature: D. Chahal

Date: July 14/2022

Signature: Karanjot Singh

Date:

Vendor:

KINGSMEN (THAMES) INC.

SCHEDULE "B-1"
Floor Plan

Lot 172
Phase 5A
Model: Louis (4203) Elev B 4 Bed - 4+1 Bath
Standard

Sketch #1

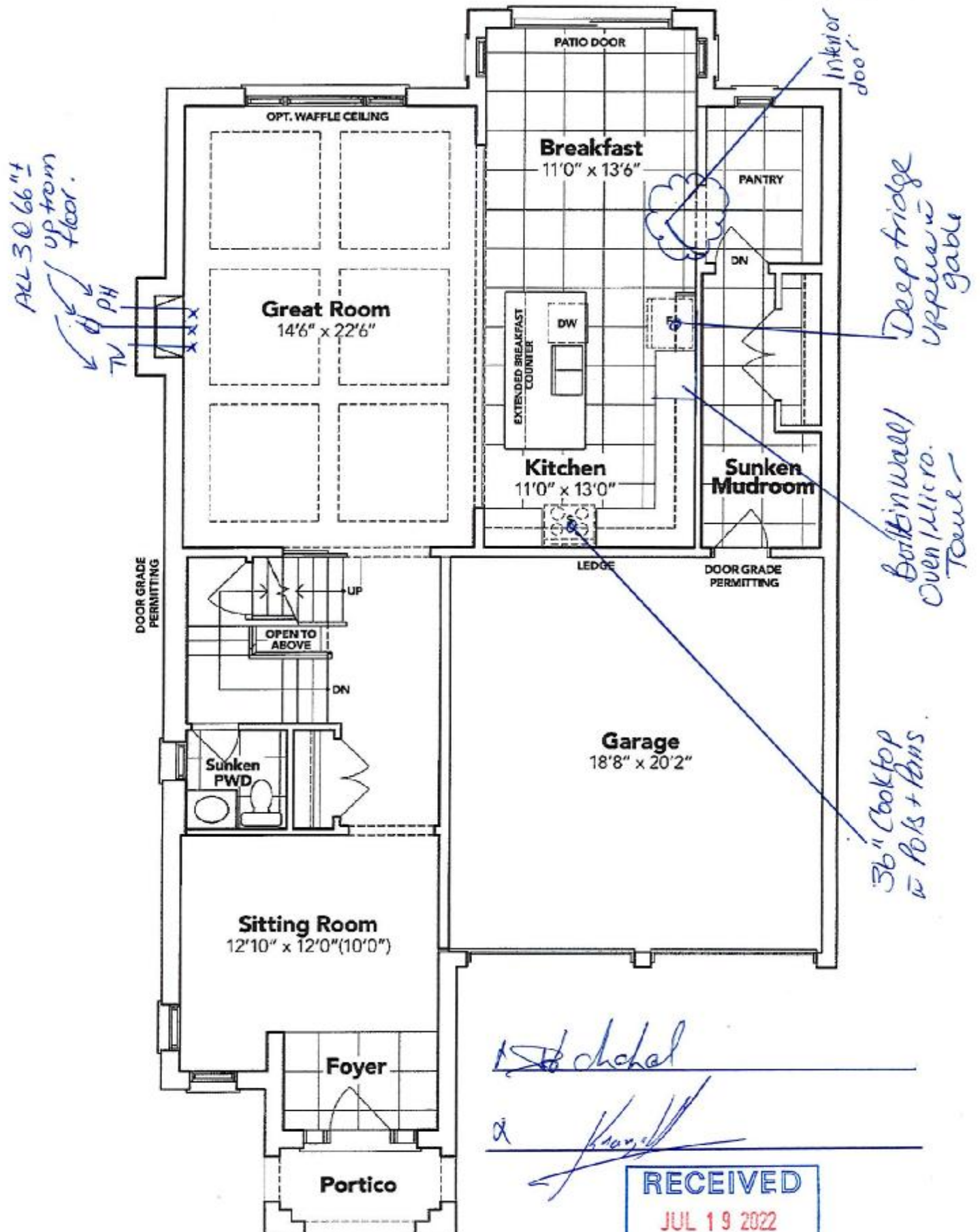

GROUND FLOOR EL. B

The floor plans and elevations shown are pre-construction plans and may be revised or improved as necessitated by architectural controls and the construction process. The measurements adhere to the rules and regulations of the TARIION Warranty Corporation's official method for the calculation of floor area. Materials, specifications and floor plans are subject to change without notice. All house renderings are artist's concept only. Actual usable floor space may vary from the stated floor area. All options shown are upgrades. E. & O. E.

SCHEDULE "B-1"
Floor Plan

Lot 172
Phase 5A
Model: Louis (4203) Elev B 4 Bed - 4+1 Bath
Standard

Sketch #2

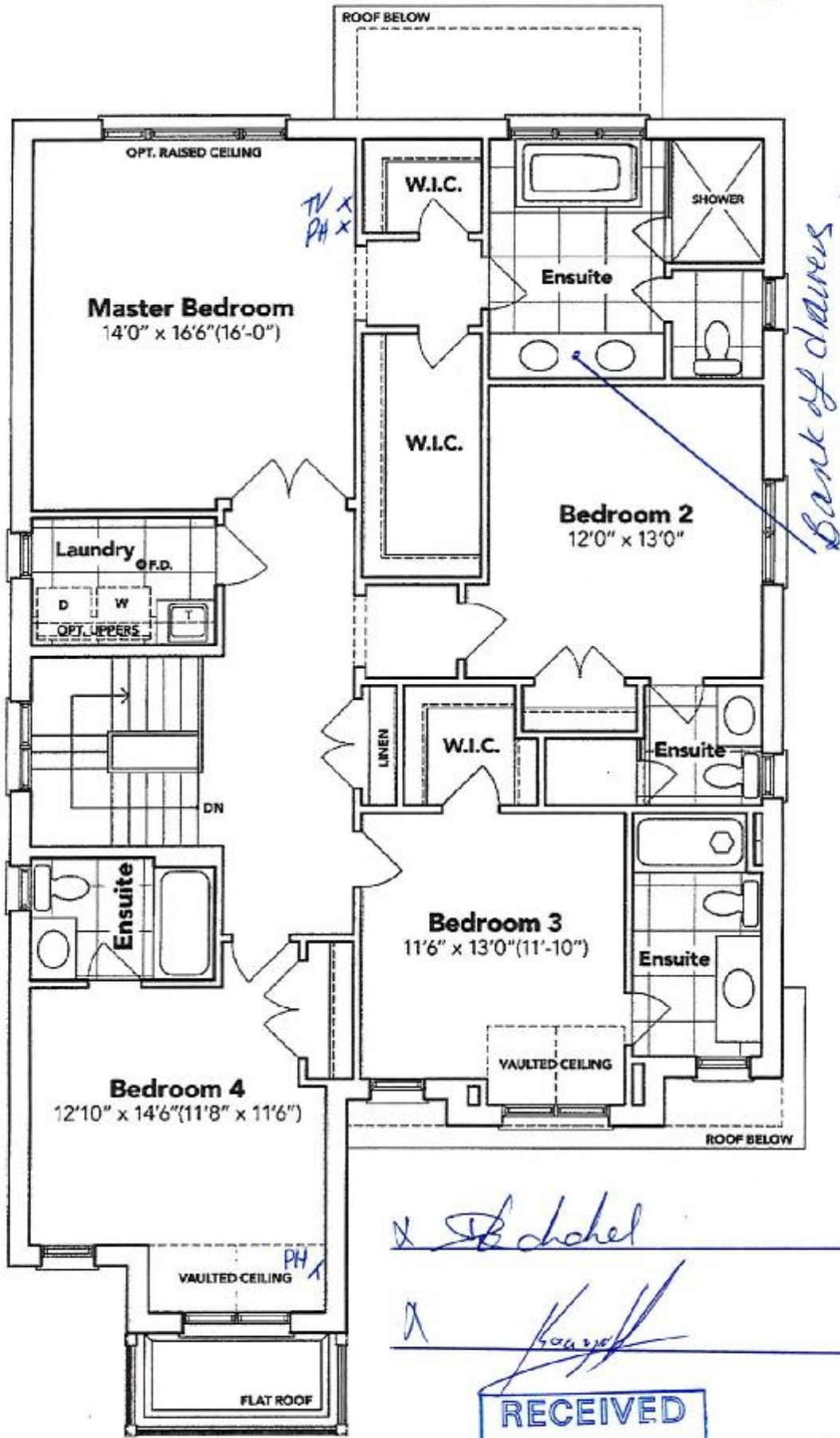

SECOND FLOOR EL. B

The floor plans and elevations shown are pre-construction plans and may be revised or improved as necessitated by architectural controls and the construction process. The measurements adhere to the rules and regulations of the TARION Warranty Corporation's official method for the calculation of floor area. Materials, specifications and floor plans are subject to change without notice. All house renderings are artist's concept only. Actual usable floor space may vary from the stated floor area. All options shown are upgrades. E. & O. E.

SCHEDULE "B-1"
Floor Plan

Lot 172
Phase 5A
Model: Louis (4203) Elev B 4 Bed - 4+1 Bath
Standard

Sketch #3

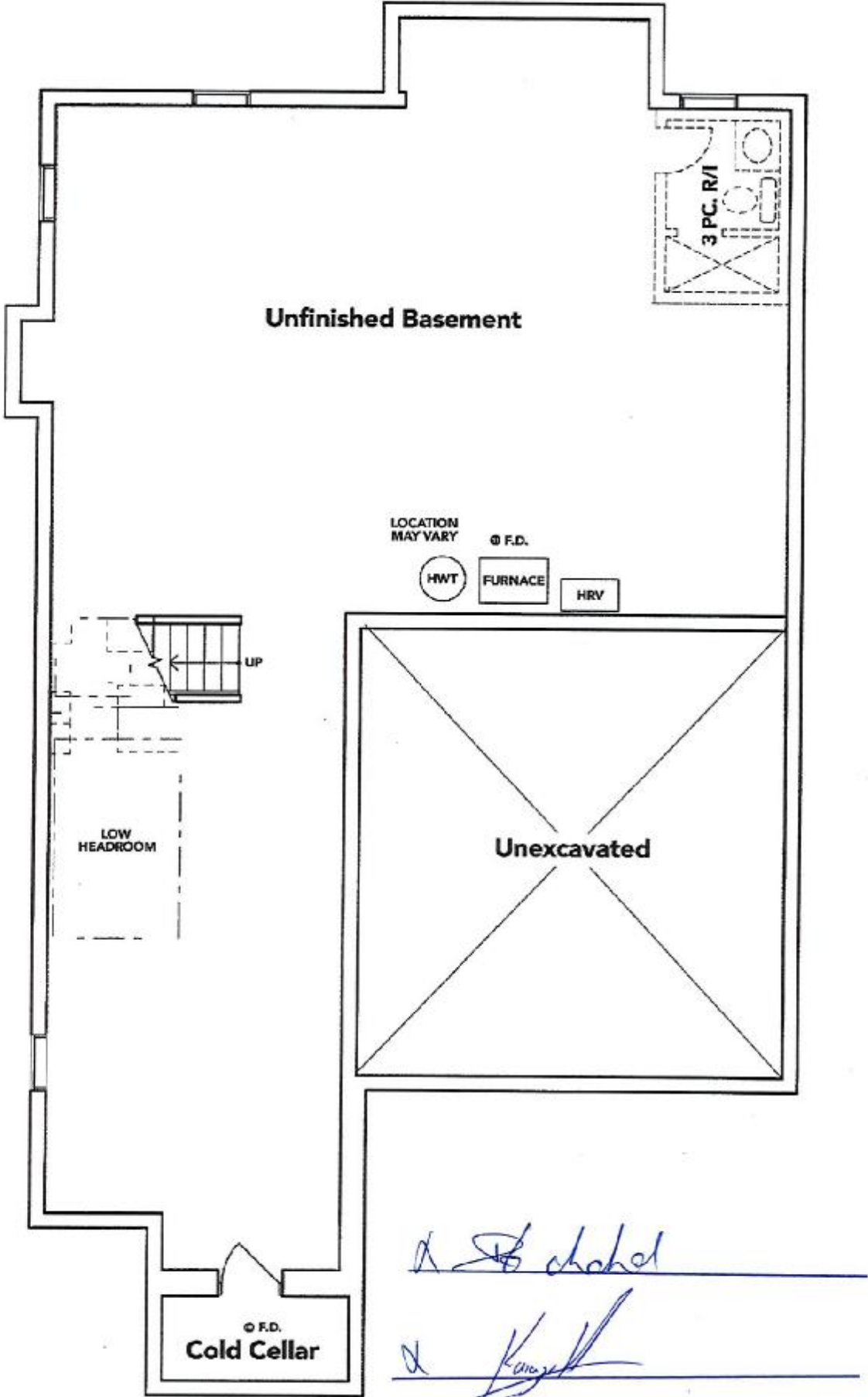

BASEMENT EL. B

The floor plans and elevations shown are pre-construction plans and may be revised or improved as necessitated by architectural controls and the construction process. The measurements adhere to the rules and regulations of the TARJON Warranty Corporation's official method for the calculation of floor area. Materials, specifications and floor plans are subject to change without notice. All house renderings are artist's concept only. Actual usable floor space may vary from the stated floor area. All options shown are upgrades. E. & O. E.

RECEIVED
JUL 19 2022

SCHEDULE "B-1" - Page 1 of 3
Initials:  

LOT: 172 THAMES PH. 5 A
RE: UPGRADED FREE STANDING TUB
FOR MASTER ENSUITE.

Free Standing Tub

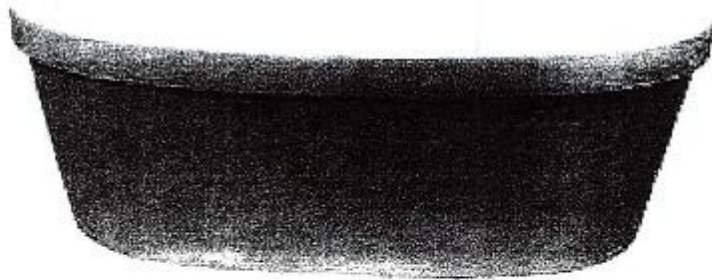

Mirolin Brooke CF2002
68x36x23

- Acrylic Bath
- 2PC Construction
- End Drain Application
- F2 Drain Assembly

 **mirolin**

Handwritten signature

Handwritten signature



LOT: 172 THAMES PH. 5 A
RE: UPGRADED UNDER MOUNT VANITY
SINKS FOR ALL BATHROOMS

CATENA
RECTANGULAR UNDERMOUNT SINK

4210CIV Undermount Sink

PRODUCT SPECS:	COMPLIANCE CERTIFICATIONS
- Vitreous china	Meets or exceeds the following:
- Front overflow hole	- IAPMO cUPC
- Template and mounting hardware supplied	- ASME A112.19.2 / CSA B45.1
	- DBC Section 3.8 Barrier Free design and CSA B651 Standard
DIMENSIONS:	SHIPPING
Outer:	Cube 1.72
510mm W x 390mm D x 190mm H	GW 27 lbs
20" W x 15 1/4" D x 7 1/2" H	
Inner:	
458mm W x 340mm D x 140mm H	
18" W x 13 1/4" D x 5 1/2" H	

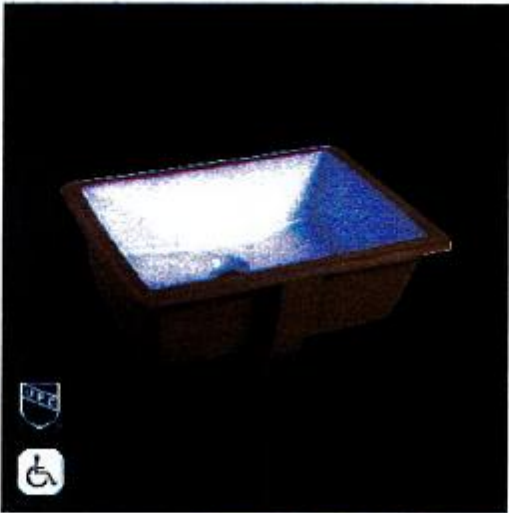
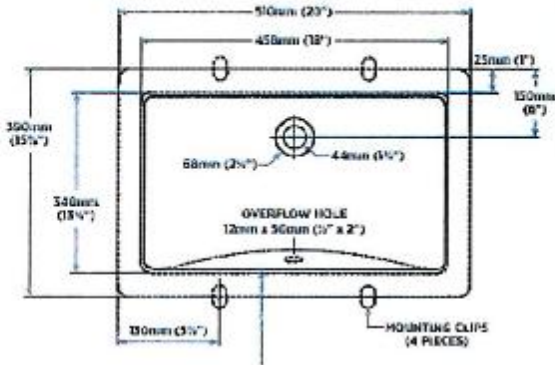

TO BE SPECIFIED
CUBIC
Soft W-12

NOTES: Dimensions of tubular are nominal and may vary within the range of dimensions established by ASME STANDARD A112.19.2. These measurements are subject to change or revision as technology or materials change. The use of separate or other pages is required for the use of separate or other pages.

Products are designed to comply with ASME STANDARD and DBC Barrier Free requirements. It shall be the responsibility of the installer to comply with the local accessibility codes and standards prior to installing the product.



x JB chahal

✓ [Signature]

LOT 172 THAMES PH. 5 A
RE: 36" GAS COOK TOP SPEC'S

FRIGIDAIRE
GALLERY



Built-In Cooktops

FGGC3645Q S/B

36" Gas

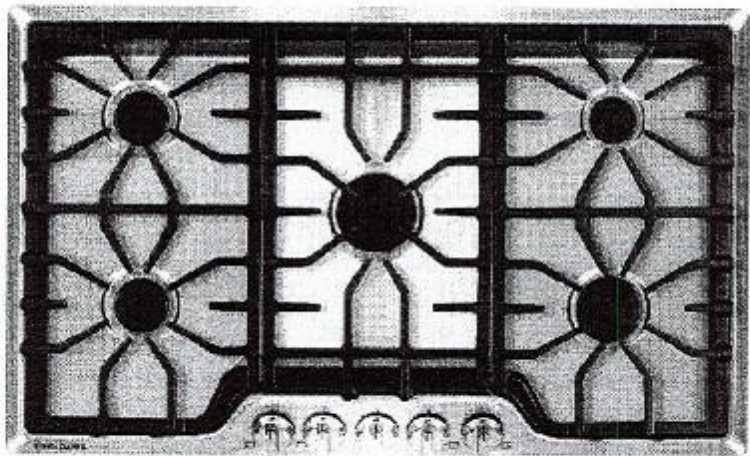

Product Dimensions

Width	36"
Depth	21-3/4"
Height	5"

More Easy-To-Use Features

Electronic Pilotless Ignition

LP Gas Conversion Option

Available in:



Burners	BTU
Right Front	12,000
Right Rear	5,000
Left Front	9,500
Left Rear	9,500
Centre	4,500 - 18,000

Signature Features

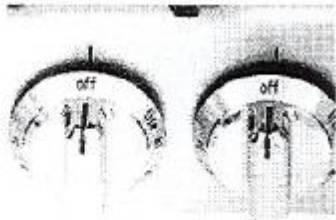

Express-Select® Controls
Easily go from warm to boil.

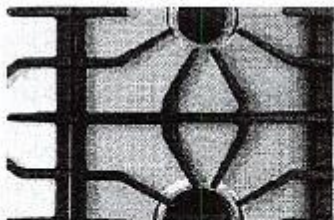

Continuous Grates
Continuous grates make it easy to move heavy pots and pans between burners without lifting.



Approved Over Frigidaire® Electric Wall Ovens
Cooktops are approved for installation above any of our Single Electric Wall Ovens.

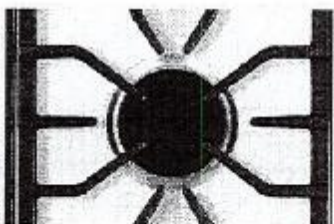

Low Simmer Burner
Perfect for delicate foods and sauces.

A. St. John

A. St. John

FRIGIDAIRE
GALLERY

Built-In Cooktops

FGGC3645Q S/B 36" Gas

Features	
Controls	Express-Select®
Surface Type	Stainless Steel Recessed (S), Colour-Coordinated Recessed (B)
Sealed Gas Burners	Yes
Grates	Continuous Cast Iron w/Black Matte Finish
Right Front Burner (BTU)	12,000
Right Rear Burner (BTU)	5,000
Left Front Burner (BTU)	9,500
Left Rear Burner (BTU)	9,500
Centre Burner (BTU)	450 - 18,000
Control Location	Front
Knob Colour	Stainless (S), Colour-Coordinated (B)
Knob Type	Cast Metal (S), Plastic (B)
Specifications	
Power Supply Connection Location	Right Rear
Gas Supply Connection Location	Right Rear
LP Gas Conversion Kit	Included
Voltage Rating	120V/60 Hz/15A
Amps @ 120 Volts	1.0
Minimum Circuit Required (Amps)	15
Approved for Electric Single Wall Oven Combination Installation†	Yes
Shipping Weight (Approx.)	60 Lbs.

Cooktops are approved for installation above any of our Electric Single Wall Ovens.

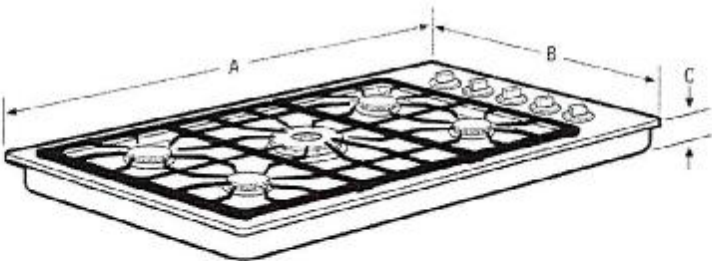

NOTE: For planning purposes only. Always consult local and national electric and gas codes. Refer to Product Installation Guide for detailed installation instructions on the web at frigidaire.ca.



Product Dimensions		Cutout Dimensions	
A-Width	36"	Width (Min.)/(Max.)	33-7/8"/34-1/4"
B-Depth	21-3/4"	Depth (Min.)/(Max.)	19-1/4"/19-3/4"
C-Height	5"	Height	8"

Grate Coordinated Installation not available

[Handwritten signature: A. St. Michel]
[Handwritten signature: X. Long]

Accessories information available on the web at frigidaire.ca

LOT 172 THAMES PH. 5 A
RE: BUILT IN WALL OVEN/MICRO SPEC'S
" NO FLUSH INSTALLATION "

[Signature]

[Signature]

HOME APPLIANCES

LG COOKING

LWC3063_

Combi Wall Oven

1.7 cu.ft. Microwave (Speed Oven)

Infrared Heating™

4.7 cu.ft. Oven

True Convection

Steam Cooking

Self+EasyClean

SmartThinQ® Technology



Enjoy new ways to control your home with LG smart appliances

- Start or stop your Oven remotely
- Set your Monitor Status from your smartphone
- Works with the LG SmartThinQ® app

SmartThinQ®

works with the Google Assistant

Alexa

innot

SIDECHIEF

SUMMARY

Total Oven Capacity (cu. ft.) 6.4 (Upper & Lower)
Colors Stainless Steel / Black Stainless Steel

UPPER OVEN FEATURES

Capacity (cu. ft.) 1.7
Interior (Cavity) - Upper M/WC / Lower Oven Stainless / Enamel Coating
Microwave Power output 950W
Microwave mode power consumption 1650W
Convection Bake mode power consumption 1600W
Broil mode power consumption 1300W
Convection Element (W) 1500W (Sheath heater)
Broil Upper Element (W) 1200W (500W + 700W)
Broil Lower Element (W) 775W
Microwave Yes
Convection Bake Yes
Broil Yes
Speed Cook Yes
• # of Defrost (4 Menu)
• # of Sensor cook (9 Menu)
• # of Auto cook (7 Menu)
• # of Soften (1 Menu)
• # of Melt (5 Menu)

LOWER OVEN FEATURES

Capacity (cu. ft.) 4.7
EasyClean® Yes
Self Clean Yes (3,4,5 hours)
Variable cleaning time Yes (3,4,5 hours)
Variable broil Yes (Full, Center / High, Med, Low)
Broil element 2,500 watts inner / 1,500 watts outer
Bake element 2,500 watts
Bake element type Hidden (8 pass)
• # of rack position 5
12 hrs. shut-off Yes
• # of light 2 (Halogen Lamp)
Convection conversion Yes
Convection element Yes (2,000 watts Sheath heater)
Convection System/Mode/Cooking System True Convection
Convection Fan Single Speed
Oven Cooking mode Combi Bake / Combi Roast / Bake / Broil / Steam Bake / Steam Roast / Probe / more mode (Fovolt / WavyProof)
Oven Control Features Glass Touch (SmoothTouch™)
Door Lock Yes

CONTROL

Oven Control Type Glass Touch (SmoothTouch™)
Display White V-D
Language English / Spanish / French
Smart Function Wi-Fi / Smart Buzzer
Clock 12 hr or 24 hr (option)
Kitchen Timer Yes
Timed Cook Yes
Temperature Unit of Measure Fahrenheit / Celsius
Cooking Complete Reminder Volume Buzzer (1 Low, 2 Low, 3 Mute)
Sabbath Mode Yes
APPEARANCE
Available Colors Stainless Steel / Black Stainless Steel
Handle/Knobs Stainless Steel Finish (Aluminum)
Black Stainless Steel Finish (Aluminum)
Oven Door Feature WideView™ Window
Scratch-Resistant Yes
PrintProof™ Finish Yes (Black Stainless Steel Only)

SmartThinQ® SMART FEATURES

SmartDiagnosis™ Yes
Wi-Fi Connectivity Yes
Works with Google Assistant and Amazon Alexa
SmartThinQ® with Innot and SideChef Yes

DIMENSIONS/CLEARANCES/WEIGHT

Shipping Weight (lbs) 264 lbs
Product Weight (lbs) 194 lbs
Product (W x H x D) 29 3/4" x 43 9/11" x 24 1/7"
Cut-out (W x H x D) 28 1/2" x 43 7/16" x 23 1/2"
Overall Depth (in) - including handle 26 7/8"
Oven Interior Dimensions (Upper) (in) (W x H x D) 20 8/11" x 8 9/25" x 17 5/13"
Oven Interior Dimensions (Lower) (in) (W x H x D) 24 1/2" x 17 5/8" x 18 1/8"
Cabinet Dimensions (in) (W x H x D) 33" x 30" x 50"

POWER/RATINGS

Max. Amp load 40A
Rating 7.8kW
Requirements 120 / 240 VAC, 120 / 208 VAC

ACCESSORIES

Glass Tray(Upper) Yes
Metal Tray(Upper) Yes
Rack(Upper) Yes
Broiler pan & Grid Yes
Gliding Rack Yes
Heavy Duty Rack 2
Meat probe Yes
Searing Pan Yes

WARRANTY

Parts & Labor 1 Year

UPC CODES

LWC3063ST (Stainless Steel) 048231335810
LWC30630D (Black Stainless Steel) 048231335827

LOT 172 THAMES PH. 5 A
RE: BUILT IN WALL OVEN/MICRO SPEC'S
CON'T
" NO FLUSH INSTALLATION "

Handwritten signature: A. Schabel

Handwritten signature: [illegible]

HOME APPLIANCES

LG COOKING

LWC3063_
Combi Wall Oven

QUICK INSTALL & CLEARANCES

For full installation directions/clearances please refer to the corresponding User Manual and Installation Guide.

DIMENSIONS / CLEARANCES / WEIGHT

Product Dimensions (in) (W x H x D)	29 3/4" x 43 5/11" x 24 1/2"
Cutout (W x H x D)	28 1/2" x 43 1/16" x 23 1/2"
Overall Depth (in) - including handle	26 7/8"
Actual Depth with Door Open (Upper) (in)	37.1"
Actual Depth with Door Open (Lower) (in)	45.7"
Oven Interior Dimensions (Upper) (in) (W x H x D)	20 9/11" x 6 9/25" x 17 5/13"
Oven Interior Dimensions (Lower) (in) (W x H x D)	24 1/2" x 17 5/8" x 18 7/8"
Carton Dimensions (in) (W x H x D)	33" x 30" x 53"
POWER RATINGS	
Max. Amps (in)	40A
Rating	7.8kW
Requirements	120 / 240 VAC, 120 / 208 VAC

INSTALLATION REQUIREMENTS

- The cabinet base platform must be able to support 202 lbs (91.65 kg) for a Microwave Combination Wall Oven. If the cabinet does not have a solid bottom, two braces or runners must be installed level with the bottom of the cutout to support the weight of the oven. Make sure the base is level and the front of the cabinet is square. If the cabinet base is not level, the oven racks will tend to slide out when opening the door.
- If marks, blemishes or the cutout opening are visible above the installed oven, it may be necessary to add wood shims under the runners and front trim until the marks or opening are covered.
- If the cabinet does not have a front frame and the sides are less than 3/4" (1.9 cm) thick, shim both sides equally to establish the cutout width.
- The junction box must be flush with the rear wall of the cabinet as shown below.
- Allow at least a 23" clearance for the door depth when it is open.
- Kitchen cabinets in contact with the oven must be heat resistant up to 194°F (90°C), and fronts of nearby units up to at least 158°F (70°C).

CUTOUT DIMENSIONS

- Cabinet Width: 30" (762 mm)
- Recommended Minimum Cutout Location from Floor: 12" (304.8 mm)
- Cutout Depth: 23 1/2" Min. (596.9 mm)
- Cutout Width: 28 1/2" Min. (723.9 mm)
28 5/8" Max. (727 mm)
- Cutout Height: 43 7/16" Min. (1103 mm)
43 1/2" Max. (1105 mm)

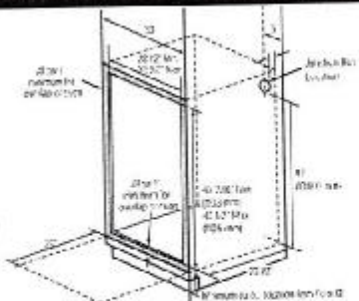

PRODUCT DIMENSIONS

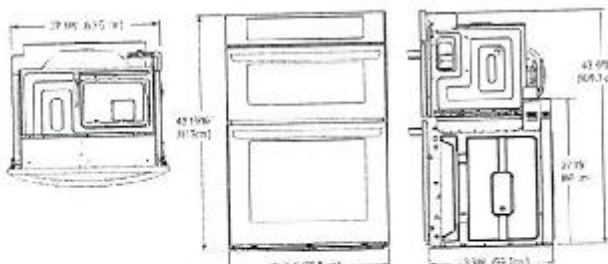

ELECTRICAL CONNECTIONS

- Be sure the wall oven is installed and grounded properly by a qualified installer or service technician.
- This wall oven must be electrically grounded in accordance with local codes or, in their absence, with the National Electrical Code ANSI/NFPA No. 70- latest edition in United States, or with CSA Standard C22.1-1967 and C22.2 No. 01987 (or latest edition), Canadian Electrical Code, Part 1, and all local codes and ordinances.
- This wall oven must be supplied with the proper voltage and frequency, and connected to an individual, properly grounded branch circuit, protected by a circuit breaker or fuse. For the circuit breaker or fuse required by this model, see the rating plate to find the wattage consumption and refer to the table below to get the circuit breaker or fuse amperage.
- A Microwave Combination Wall Oven can consume up to 7,800 W at 240 VAC. A 50 Amp circuit breaker with wire gauge #3 AWG must be used.
- Do Not ground to a gas pipe.
- Do Not have a fuse in the neutral or grounding circuit.
- A U.L.-listed conduit connector must be provided at the junction box.
- Prepare the electrical connection as follows:**
- Turn off the circuit breaker or remove fuses to the oven branch circuit.
- With the oven positioned directly in front of the cabinet opening, connect the flexible conduit to the electrical junction box as shown below. Position the conduit in such a manner that it will lie on top of the oven in a natural loop when the oven is installed.
- If local codes permit connection of the frame grounding conductor to the neutral (white) wire, follow the instructions for a 3-wire circuit connection.
- If used in mobile homes or new construction, or a recreational vehicle, or local codes do not permit connection of the frame grounding conductor to the neutral (white) wire, follow the instructions for a 4-wire circuit connection.

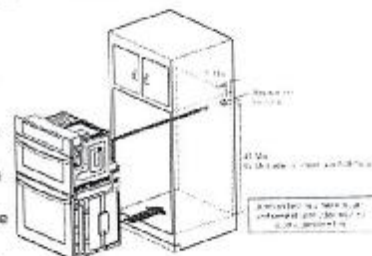

INSTALL THE OVEN

- Install the oven into the cabinet as follows:**
- Slide the oven into the opening.
 - Loop (do not tie) a 36" (91 cm) string around the conduit before the oven is slid into place. Lay the string over the top of the oven and use it to keep the conduit from falling behind the oven.
 - Lift oven into cabinet cutout using the oven opening as a grip. Carefully push against the oven front frame. Do not push against outside edges.
 - While sliding the oven back, pull the string so that the conduit lies on the top of the oven in a natural loop.
 - When you are sure the conduit is out of the way, slide the oven 3/4 way back into the opening. Remove the string by pulling on one end of the loop.
- Secure the oven.
 - Using the mounting holes on the oven side trim as a guide, drill pilot holes for screws provided. (For securing the Combi Oven, use a minimum of 4 screws, one on each side in both the upper and lower ovens.)
 - Secure the oven to the cabinet with screws provided. If the cabinet is particle board, you must use 3/4" particle board screws. These may be purchased at any hardware store.
- Install the metal bottom trim.
 - Place the metal bottom trim centered over the pre-drilled mounting holes on the lower base.
 - Using 3 screws provided, secure the bottom trim to the bottom edge of the cabinet.
- Reinstall the oven door.

