

Kingsmen (Islington) Inc. / 9560 Islington

Lot/Unit: L149 Block 4 Phase/Building: 1 Model/Floor Plan: The Florence - 3 Bed (C1-3B)

CABINETRY VANITY

Inv.5602	3 - To supply a INCREASE VANITY TO KITCHEN HEIGHT - 90CM HIGH - MAINTAINS VANITY DEPTH - CLASSIC SERIES to the Master, Main and PWD..	
Line 72299	Note:	
10May22 / 16Jun22		

COUNTER TOP - KITCHEN

Inv.5602	1 - To supply and install COUNTER TOP - KITCHEN - KITCHEN - 3CM QUARTZ COUNTER TOP - UPGRADE LEVEL 3.. see colour chart for details	
Line 72214	Note:	
10May22 / 16Jun22		

COUNTER TOP - VANITY

Inv.5602	1 - To supply and install COUNTER TOP - VANITY - POWDER ROOM - 2CM QUARTZ COUNTER TOP - UPGRADE LEVEL 3.. see colour chart for details	
Line 72215	Note:	
10May22 / 16Jun22		
Inv.5602	1 - To supply and install COUNTER TOP - VANITY - MAIN BATHROOM - 2CM QUARTZ COUNTER TOP - UPGRADE LEVEL 3 see colour chart for details	
Line 72216	Note:	
10May22 / 16Jun22		
Inv.5602	1 - To supply and install COUNTER TOP - VANITY - MASTER ENSUITE - 2CM QUARTZ COUNTER TOP - UPGRADE LEVEL 3.. see colour chart for details	
Line 72217	Note:	
10May22 / 16Jun22		

ELECTRICAL

HARDWOOD

Inv.5602	1 - To supply and install HARDWOOD - BEDROOM 2 - STANDARD FLOOR IN NON STANDARD AREAS.. see colour chart	
Line 72227	Note:	
10May22 / 16Jun22		
Inv.5602	1 - To supply and install HARDWOOD - MASTER BEDROOM - STANDARD FLOOR IN NON STANDARD AREAS.. see colour chart for details	
Line 72228	Note:	
10May22 / 16Jun22		
Inv.5602	1 - To supply and install HARDWOOD - BEDROOM 3 - STANDARD FLOOR IN NON STANDARD AREAS... see colour chart for details	
Line 72229	Note:	
10May22 / 16Jun22		

MISCELLANEOUS

Inv.5602	1 - INTERIOR FINISHES SELECTED 05/10/2022	
Line 71410	Note:	
10May22 / 16Jun22		

Kingsmen (Islington) Inc. / 9560 Islington

Lot/Unit: L149 Block 4 Phase/Building: 1 Model/Floor Plan: The Florence - 3 Bed (C1-3B)

PLUMBING

Inv.5602	1 - To supply and install QUATRUS SUPER SINGLE MODEL 401248 in the kitchen.. see spec's	
Line 72225	Note: STILL TO INSTALL THE STANDARD FAUCET	
10May22 / 16Jun22		
Inv.5602	3 - To supply and install the CONTRAC CATENA MODEL 4201CIY IN ALL BATHROOMS.. see spec's	
Line 72226	Note: STILL TO INSTALL THE STANDARD FAUCETS	
10May22 / 16Jun22		

TILE - FLOOR

Inv.5602	1 - To supply and install UPGRADE 3 - FLOOR TILE - - POWDER ROOM TILE STACKED.. see colour chart for details	
Line 72218	Note: SEE SKETCH #3 FOR TILE DIRECTION	
10May22 / 16Jun22		
Inv.5602	1 - To supply and install UPGRADE 3 - FLOOR TILE - - MAIN BATHROOM TILE STACKED.. see colour chart for details	
Line 72219	Note: SEE SKETCH #4 FOR TILE DIRECTION	
10May22 / 16Jun22		
Inv.5602	1 - To supply and install UPGRADE 3 - FLOOR TILE - - MASTER ENSUITE TILE STACKED.. see colour chart for details	
Line 72220	Note: SEE SKETCH #4 FOR TILE DIRECTION	
10May22 / 16Jun22		
Inv.5602	1 - To supply and install UPGRADE 1 - FLOOR TILE - - MASTER ENSUITE SHOWER FLOOR TILE.. see colour chart for details	
Line 72221	Note:	
10May22 / 16Jun22		

TILE - WALL

Inv.5602	1 - To supply and install UPGRADE 1 - WALL TILE - STACKED HORIZONTALLY- MASTER ENSUITE SHOWER WALL TILE.. see colour chart for details	
Line 72222	Note:	
10May22 / 16Jun22		
Inv.5602	1 - To supply and install UPGRADE 1 - WALL TILE - STACKED HORIZONTALLY- MAIN BATHROOM WALL TILE.. see colour chart for details	
Line 72223	Note:	
10May22 / 16Jun22		
Inv.5602	1 - To supply and install UPGRADE 2 - BACKSPLASH - STACKED HORIZONALLY - BACKSPLASH TILE.. see colour chart for details	
Line 72224	Note:	
10May22 / 16Jun22		

EXTRAS AS PER OFFER

MISC

Kingsmen (Islington) Inc. / 9560 Islington

Lot/Unit: L149 Block 4 Phase/Building: 1 Model/Floor Plan: The Florence - 3 Bed (C1-3B)

Purchaser: Inventory Unit 149-9560

Property: L149 Block 4 of Plan -
Project: Kingsmen (Islington) Inc.

Telephone Res. / Bus: /

Decor Advisor: Barbara Coccia

Model and Elevation: The Florence - 3 Bed (C1-3B)

Layout Changes: ☐ Yes ☒ No Sketch Attached: ☒ Yes ☐ No Exterior Colour Scheme:

1. Cabinetry	Style and Colour	Counter Top	Hardware
Kitchen / Breakfast	Trinity DHGL Arctico Gloss MWP	*Upg3: C/S 1141 Pure White 3cm	135 KNOB
Kitchen Island	Trinity DHGL Arctico Gloss MWP	*Upg3: C/S 1141 Pure White 3cm	135 KNOB
Laundry Room	/	/	/
Powder Room	Trinity DHGL Arctico Gloss MWP	*Upg3: C/S 1141 Pure White 2cm	135 KNOB
Main Bathroom	#3 Charleston 3DL Moonlight	*Upg3: C/S 1141 Pure White 2cm	135 KNOB
Master Ensuite Bathroom	#3 Charleston 3DL Moonlight	*Upg3: C/S 1141 Pure White 2cm	135 KNOB
Second Ensuite Bathroom (If Applicable)	/	/	/

Appliances

Custom Size Fridge

☐ Yes ☒ No

Valance Lighting

☐ Yes ☒ No

Microwave / Range Hood

☐ Yes ☒ No

Comment

Cooktop / Rangetop

☐ Yes ☒ No

Built in Wall Oven

☐ Yes ☒ No

Slide-in Range

☐ Yes ☒ No

2. Flooring

	Selection
	/
Main Hall	/
Back Hall	/
Breakfast	/
Laundry Room	13x13" Cinq Grey
Kitchen	5" Elements Brushed Oak Stonecrop
Powder Room	*UPG #3: 12x24" Mayfair Suave Bianco HD Rectified Porcelain Tile STACKED
Main Bathroom	*UPG #3: 12x24" Mayfair Suave Bianco HD Rectified Porcelain Tile STACKED
Master Ensuite	*UPG #3: 12x24" Mayfair Suave Bianco HD Rectified Porcelain Tile STACKED
Bathroom (If Applicable)	/
Mud Room	/
Master Ensuite SH/FL	**2x2" Mayfair Suave Bianco HD Basketweave Porcelain Mosaics
Living Room	5" Elements Brushed Oak Stonecrop
Dining Room	5" Elements Brushed Oak Stonecrop
Family / Great Room	/
Den / Library / Study	5" Elements Brushed Oak Stonecrop
Basement Landing (If Applies)	5" Elements Brushed Oak Stonecrop
Lower Landing (If Applicable)	5" Elements Brushed Oak Stonecrop
Upper Landing	5" Elements Brushed Oak Stonecrop
Upper Hall	LOWER HALLWAY- 5" Elements Brushed Oak Stonecrop
Master Bedroom	5" Elements Brushed Oak Stonecrop
Bedroom #2	5" Elements Brushed Oak Stonecrop
Bedroom #3	5" Elements Brushed Oak Stonecrop
Bedroom #4	/
Bedroom #5	/
Master Ensuite SH Jamb	Anatolia Marmiline SNOW



Flooring Continued on Page 2

Initial: _____

Purchaser: Inventory Unit-149-9560

Property: L149 Block 4 of Plan -

Telephone Res. / Bus: /

Project: Kingsmen (Islington) Inc.

Decor Advisor: Barbara Coccia

Model and Elevation: The Florence - 3 Bed (C1-3B)

2. Flooring - Continued -

Upgrade Underpad	Type	Area
	/	/
Carpet on Stairs	Capped	Runner - *Upgrade
Comment	/	/

3. Plumbing Fixtures / Faucets

Kitchen	STANDARD	Second Ensuite	/	Powder Room	STANDARD
Master Ensuite	STANDARD			Other Room	/
Main Bathroom	STANDARD				

Comment

NOTE: To supply and install the standard kitchen faucet, with the upgraded undermount sink. To supply and install upgraded undermount sinks in all bathrooms, with the standard faucets.

4. Wall Tile

	Tile Selection	Listello	Insert	Insert Selection
Main Bathroom	*UPG #1: 3x12" Mayfair Glossy Smoke STACKED	<input type="checkbox"/>	<input type="checkbox"/>	
Master Ensuite				
Tub Deck	/	<input type="checkbox"/>	<input type="checkbox"/>	
Tub Apron	/	<input type="checkbox"/>	<input type="checkbox"/>	
Tub Surround	/	<input type="checkbox"/>		
Shower Stall	*UPG #1: 3x12" Mayfair Glossy Smoke STACKED	<input type="checkbox"/>	<input type="checkbox"/>	
Second Ensuite	/	<input type="checkbox"/>	<input type="checkbox"/>	
	/	<input type="checkbox"/>	<input type="checkbox"/>	
Kitchen Backsplash	*UPG #1: 3x6" Mayfair Glossy Cloud STACKED	<input type="checkbox"/>	<input type="checkbox"/>	
Complete Backsplash	/	<input type="checkbox"/>	<input type="checkbox"/>	

Comment

NOTE: TO SUPPLY AND INSTALL ALL WALL TILES ON THE 12" /6" STACKED HORIZONTALLY

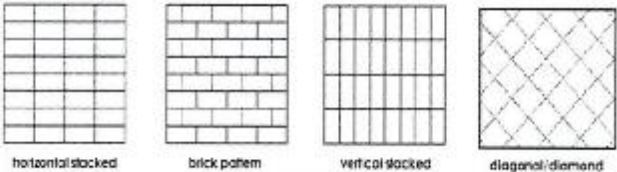

5. Fireplace

	Living Room			Family Room			Other Room - Specify		
	Purchased	As Per Plan	N/A	Purchased	As Per Plan	N/A	Purchased	As Per Plan	N/A
Fireplace Type	<input type="radio"/>	<input type="radio"/>	<input checked="" type="radio"/>	<input type="radio"/>	<input type="radio"/>	<input checked="" type="radio"/>	<input type="radio"/>	<input type="radio"/>	<input checked="" type="radio"/>
Mantle Type									
Over Mantle									
Colour / Stain									
Surround									
Hearth									

Comment



Initial: _____

Purchaser: Inventory Unit 149 - 9560
 Telephone Res. / Bus: /

Property: L149 Block 4 of Plan -
 Project: Kingsmen (Islington) Inc.
 Model and Elevation: The Florence - 3 Bed (C1-3B)

Decor Advisor: Barbara Coccia

6. Trim Carpentry

Door Hardware STANDARD HANDLE

Interior Trim STANDARD

Comment /

Interior Doors

☐ 2 Panel Arch Top

☒ 2 Panel Square Top

☐ 6 Panel



Initial for Door Style _____

7. Railings and Pickets

Railing Package Standard Metal Picket Package

Railing Colour Elements Stonecrop

Wood Stairs ☐ No ☒ Oak

Comment /

Picket Colour Black Metal

Tread Colour Elements Stonecrop

8. Plaster Mouldings and Medallions

Foyer / /

Main Hall / /

Living Room / /

Dining Room / /

Family Room / /

Comment /

Kitchen/Breakfast / /

Den/Library / //

Lower Landing / /

/ /

9. Wall Paint

Kingsmen White

Smooth Ceilings ☐ First Floor

☐ First Floor incl. Second Floor Hall

☐ First and Second Floor

☒ Throughout

☐ Not Applicable

Trim Paint Kingsmen White

10. Additional Comments

11. Disclaimers and Notes

- Colours of all materials are as close as possible to builder's selection, but not necessarily identical due to variances in manufacturing.
- Any extras listed above are null and void unless accompanied by a separate invoice/amendment. Said invoice must be paid in full.
- The Purchaser acknowledges that after Interior Colour Selection form is signed and dated, no further changes will be permitted other than re-selection due to unavailability. _____ Purchaser's Initials
- The Purchaser acknowledges reading and accepting the "Kingsmen Group Décor Centre Disclaimers" form. This document contains other miscellaneous disclaimers.

This Interior Colour Selection is final and approved by:

Purchaser:

Signature: _____ Date: _____



Vendor:

Kingsmen (Islington) Inc.

June 16/22

9560 ISLINGTON: UNIT L149 (BLK 4)
RE: SKETCH #3

OPTIONAL C1 THE FLORENCE
COURTYARD COLLECTION

1685 SQ. FT.
PATIO 273 SQ. FT.
3 BED, 3 + 1 BATH

9560
ISLINGTON

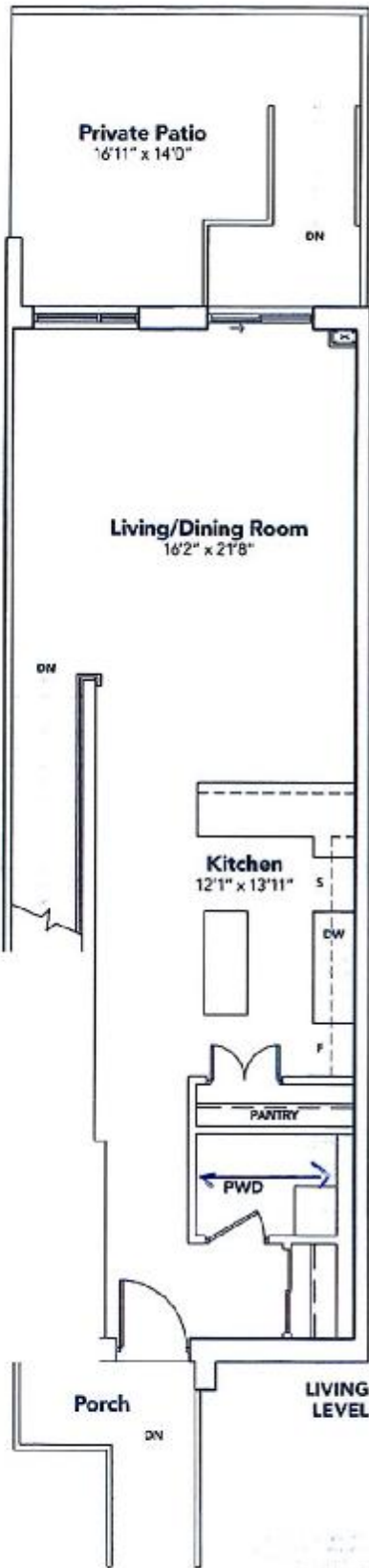

③

④

①

BLOCK 4

②

KINGS/11EN

RECEIVED
JUN 16 2022

9560 ISLINGTON: UNIT L149 (BLK 4)
RE: SKETCH #4

OPTIONAL **C1** THE FLORENCE
COURTYARD COLLECTION

1685 SQ. FT.
RATIO 273 SQ. FT.
3 BED + 2 + 1 BATH

9560
ISLINGTON

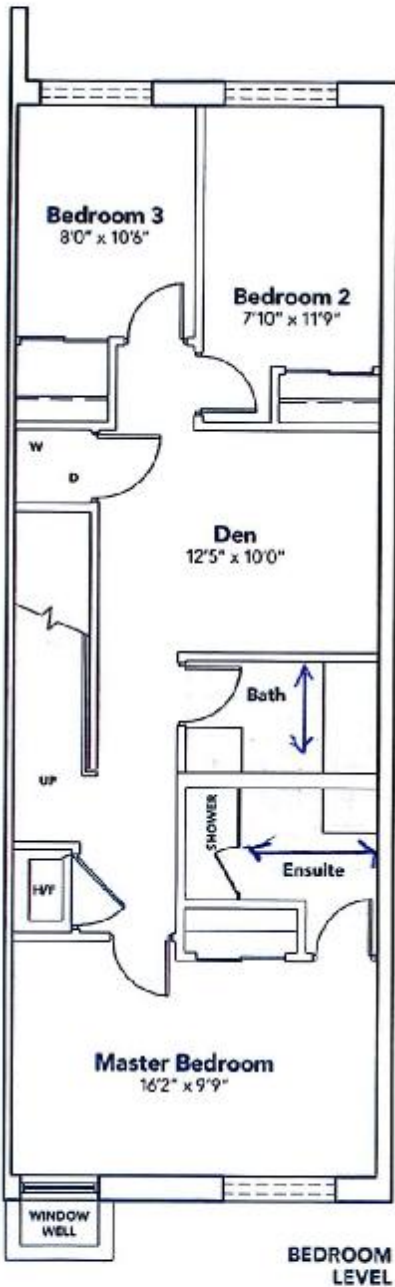

KINGSIIEN

RECEIVED
JUN 16 2022

BLANCO

Sink Specifications

Colour SKU
brushed finish 401248

Design and planning tips

- Min cabinet size: 36 in (915 mm)
- Bowl Depth: 9 in (230.0 mm)

Specifications:

Installation clips, Sink template, Installation instructions, 3 ½" (90 mm) stainless steel strainer

Depending on cabinet construction, a different cabinet size may be required. Consult the cabinet manufacturer.

Codes/Standards: ASME A112.19.3-2017/ CSA B45.4-17

9560 ISLINGTON: UNIT L149 (BLK 4)
RE: UPG. KITCHEN SINK

QUATRUS U 1 SUPER SINGLE

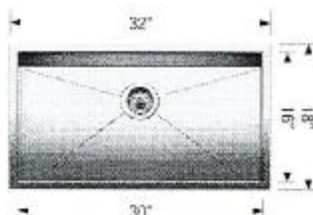

Optional Accessories

Elevated Grid 406346
Workstation 406344
CapFlow Strainer Cover 517666
Ash Cutting Board 406345
Sink Grid 402125

Warranty

Limited lifetime warranty on all sinks and faucets. One-year warranty on all accessories and soap dispensers.

Code/Standards Compliance

BLANCO sinks and faucets are third-party tested and certified to CSA, cUPC, ANSI/ASME, IAPMO and NSF standards and listed by applicable certification bodies. For more information on individual product listings, contact our office or listing organization.



Need support? Learn more by watching our sink & faucet How-to videos:

<https://www.blanco.com/ca-en/support/how-to-videos/how-to-videos-for-sinks/>



BLANCO Canada Inc
100 Corporation Drive
Brampton ON L6S 6B5

Tel & Fax

Tel: 905-494-2400 Toll free: 1-877-425-2626

Fax: 905-494-2425 Toll free: 1-877-825-2626

While BLANCO strives to provide accurate information, all images and dimensions in this document are intended for reference only and are subject to change at any time without notice. This document is not intended for use as an installation guide. For technical installation details, refer to installation instructions provided with the product. BLANCO assumes no responsibility for the use of superseded or voided specifications.

RECEIVED

JUN 16 2022

9560 ISLINGTON: UNIT L149 (BLK 4)
RE: UPG. BATHROOM SINKS

CATENA
RECTANGULAR UNDERMOUNT SINK

4210C1Y Undermount Sink

PRODUCT SPECS:

- Vitreous china
- Front overflow hole
- Template and mounting hardware supplied

DIMENSIONS:

Outer:
510mm W x 390mm D x 190mm H
20" W x 15 1/2" D x 7 1/2" H
Inner:
458mm W x 340mm D x 140mm H
18" W x 13 1/4" D x 5 1/2" H

COMPLIANCE CERTIFICATIONS

Meets or exceeds the following:
- IAPMO cUPC
- ASME A112.19.2 / CSA B45.1
- OBC Section 3.8 Barrier Free design and CSA B651 Standard

SHIPPING

Cube 1.72
GW 27 lbs

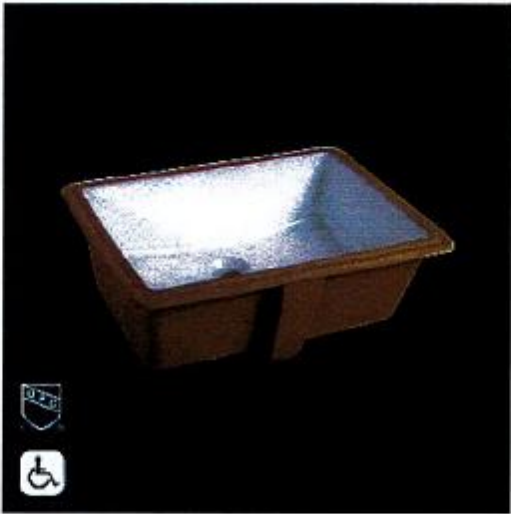
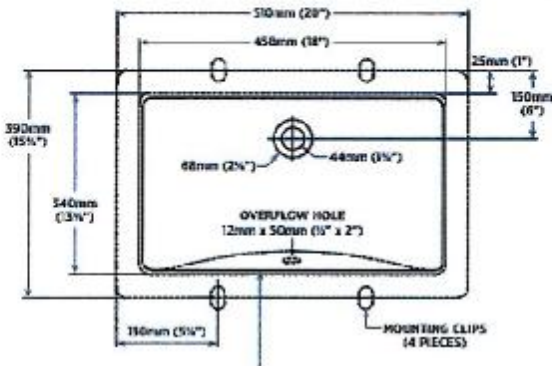

TO BE SPECIFIED

- Color: ☐ Soft White

NOTES: Dimensions of features are nominal and may vary within the range of tolerances established by ASME standard A112.19.2. These measurements are subject to change in production. No responsibility is assumed for use of equipment or material not specified.

Products are designed to comply with CSA B651 Standard and OBC barrier-free requirements. It shall be the responsibility of the installer to comply with the local disability codes and standards prior to installing the product.



RECEIVED
JUN 16 2022