

KINGSMEN (THAMES) INC. / Havelock Corners (Kingsmen)

Lot/Unit: 13 Phase/Building: 5A Model/Floor Plan: James (3601) Elev B 4 Bed - 2+1 Bath

COUNTER TOP

Inv.5636	1 - As per schedule "PE": Vendor to include level 1, 2cm. quartz in all bathrooms, as per plan, in lieu of the included laminate counter tops. Selections to be made from builders standard samples.	
Line 71940	Note:	
31May22 / 1Jun22		

ELECTRICAL

Inv.5636	1 - To supply & install the standard T.V. rough in in the great room and master bedroom... see sketch # 1 & # 2	
Line 71970	Note: Install the standard Phone T.V. rough in at approx. 66" + - up from the floor centered + - to the F/P mantle in the great room.	
31May22 / 1Jun22		
THIS IS FOR A FUTURE WALL MOUNT T.V.		
Inv.5636	1 - To supply & install the standard Phone (CAT 5) rough in in the great room, master bedroom & bedroom #2... see sketch # 1 & # 2	
Line 71971	Note: Install the standard Phone (CAT 5) at approx. 66" + - up from the floor centered + - to the F/P mantle in the great room.	
31May22 / 1Jun22		
THIS IS FOR A FUTURE WALL MOUNT T.V.		
Inv.5636	1 - To SUPPLY AND INSTALL AN ADDITIONAL BASIC RECEPTACLE (NOT DEDICATED) at approx. 66" + - up from the floor centered + - to the F/P mantle	
Line 71972	Note: in the great room.... see sketch # 1	
31May22 / 1Jun22		
THIS IS FOR A FUTURE WALL MOUNT T.V. " NO CONDUIT PIPE HAS BEEN PURCHASED"		

HEATING AND AIR CONDITIONING

Inv.5636	1 - As per schedule "PE": Vendor to install capped gas line (rough in only) at rear of houme for future BBQ location. Location to be finalized at vendors sole discretion.	
Line 71938	Note:	
31May22 / 1Jun22		
Inv.5636	1 - As per schedule "PE": Vendor to supply & install air conditioning unit, sized accordingly, from vendors standard samples.	
Line 71939	Note:	
31May22 / 1Jun22		



CONSTRUCTION SUMMARY

KINGSMEN (THAMES) INC. / Havelock Corners (Kingsmen)

Lot/Unit: 13 Phase/Building: 5A Model/Floor Plan: James (3601) Elev B 4 Bed - 2+1 Bath

EXTRAS AS PER OFFER

5 FREE APPLIANCES – STAINLESS STEEL FRONT - FRIDGE: STOVE AND DISHWASHER. WHITE WASHER AND DRYER (SUPPLIED ONLY, NOT INSTALLED, FROM BUILDERS STANDARD LINE). AN APPLIANCES VOUCHER WILL BE GIVEN BY OUR DECOR CONSULTANT AT THE TIME OF BOOKING YOUR COLOUR A <i>Worksheet</i> Note:	
VENDOR TO INSTALL CAPPED GAS LINE (ROUGH-IN ONLY) AT REAR OF HOME FOR FUTURE BBQ LOCATION. LOCATION TO BE FINALIZED AT VENDORS SOLE DISCRETION. <i>Worksheet</i> Note:	
VENDOR TO SUPPLY & INSTALL AIR CONDITIONING UNIT, SIZED ACCORDINGLY, FROM VENDORS STANDARD SAMPLES. <i>Worksheet</i> Note:	
VENDOR TO INCLUDE LEVEL 1, 2CM QUARTZ IN ALL BATHROOMS, AS PER PLAN, IN LIEU OF THE INCLUDED LAMINATE COUNTER TOPS. SELECTIONS TO BE MADE FROM BUILDERS STANDARD SAMPLES. <i>Worksheet</i> Note:	

Purchasers: NARESH KUMAR VERMA & INDERJIT SINGH **Property:** 13 of Plan - Draft Approval SB17-03-08
Telephone Res. / Bus: (647) 766-8683 / **Project:** KINGSMEN (THAMES) INC.
Decor Advisor: Barbara Coccia **Model and Elevation:** James (3601) Elev B 4 Bed - 2+1 Bath
Layout Changes: ☐ Yes ☒ No **Sketch Attached:** ☒ Yes ☐ No **Exterior Colour Scheme:** _____

1. Cabinetry	Style and Colour	Counter Top	Hardware
Kitchen / Breakfast	#3 Simcoe Rain Cloud	#1, C/S # 3040 Cement 3cm.	# 9661 Handle
Kitchen Island	#3 Simcoe Rain Cloud	#1, C/S # 3040 Cement 3cm.	# 9661 Handle
Laundry Room	/		
Powder Room	#3 Simcoe Rain Cloud	#1, C/S # 3040 Cement 2cm.	# 9661 Handle
Main Bathroom	#3, Charleston 3DL Moonlight	#1, C/S # 6041 Nordic Loft 2cm.	# 9661 Handle
Master Ensuite Bathroom	#3, Charleston 3DL Moonlight	#1, C/S # 9141 Ice Snow 2cm.	# 9661 Handle
Second Ensuite Bathroom (If Applicable)	/		
	/		
	/		

Appliances **Custom Size Fridge** ☐ Yes ☒ No **Valance Lighting** ☐ Yes ☒ No **Microwave / Range Hood** ☐ Yes ☒ No
Cooktop / Rangetop ☐ Yes ☒ No **Built in Wall Oven** ☐ Yes ☒ No **Slide-in Range** ☐ Yes ☒ No
Comment /

2. Flooring

	Selection
Foyer	13 x 13" Malena Ice
Main Hall	13 x 13" Malena Ice
Back Hall	/
Breakfast	13 x 13" Malena Ice
Laundry Room	13 x 13" Keaton Ice
Kitchen	13 x 13" Malena Ice
Powder Room	13 x 13" Malena Ice
Main Bathroom	13 x 13" Keaton Ice
Master Ensuite	13 x 13" Malena Ice
Bathroom (If Applicable)	/
Mud Room	13 x 13" Malena Ice
Master Ens. shower floor	2x2" Ontario Snow White Matte
Living Room	/
Dining Room	/
Family / Great Room	3 1/2" Elements Oak Natural
Den / Library / Study	/
Basement Landing (If Applies)	
Lower Landing (If Applicable)	3 1/2" Elements Oak Natural
Upper Landing	3 1/2" Elements Oak Natural
Upper Hall	Modern Story 1, # 945 Felt Hat
Master Bedroom	Modern Story 1, # 945 Felt Hat
Bedroom #2	Modern Story 1, # 945 Felt Hat
Bedroom #3	Modern Story 1, # 945 Felt Hat
Bedroom #4	Modern Story 1, # 945 Felt Hat
Bedroom #5	/
Master Ens. Shower jamb	Anatolia marmiline SNOW



SEE ATTACHED FOR SIGNATURES

Flooring Continued on Page 2

Initial:  

Page 1 of 3

Purchasers: NARESH KUMAR VERMA & INDERJIT SINGH **Property:** 13 of Plan - Draft Approval SB17-03-08
Telephone Res. / Bus: (647) 766-8683 / **Project:** KINGSMEN (THAMES) INC.
Decor Advisor: Barbara Coccia **Model and Elevation:** James (3601) Elev B 4 Bed - 2+1 Bath
 2. Flooring - Continued -

Upgrade Underpad	Type	Area
	Standard	2nd. Floor
Carpet on Stairs	Capped	Runner - *Upgrade
Comment	/	/

3. Plumbing Fixtures / Faucets

Kitchen	Standard	Second Ensuite	/	Powder Room	Standard
Master Ensuite	Standard			Other Room	/
Main Bathroom	Standard		/		

Comment

Still to install the standard top mount kitchen sink with the standard kitchen faucet.
 to install the standard top mount vanity sinks with the standard lav. faucets in all bathrooms.

Still

4. Wall Tile

	Tile Selection	Listello	Insert	Insert Selection
Main Bathroom	8x10" Keaton Ice	<input type="checkbox"/>	<input type="checkbox"/>	
Master Ensuite				
Tub Deck	13 x 13" Malena Ice	<input type="checkbox"/>	<input type="checkbox"/>	
Tub Apron	13 x 13" Malena Ice	<input type="checkbox"/>	<input type="checkbox"/>	
Tub Surround	13 x 13" Malena Ice	<input type="checkbox"/>	<input type="checkbox"/>	
Shower Stall	8x10" Malena Carbon	<input type="checkbox"/>	<input type="checkbox"/>	
Second Ensuite	/	<input type="checkbox"/>	<input type="checkbox"/>	
	/	<input type="checkbox"/>	<input type="checkbox"/>	
	/	<input type="checkbox"/>	<input type="checkbox"/>	
Kitchen Backsplash	/	<input type="checkbox"/>	<input type="checkbox"/>	
Complete Backsplash	/	<input type="checkbox"/>	<input type="checkbox"/>	

Comment

Install the standard 8x10" wall tiles on the 10" side stacked horizontally where applicable.



horizontal stacked



brick pattern



vertical stacked



diagonal/diamond

5. Fireplace

Living Room

Purchased ☐ As Per Plan ☐ N/A ☒

Family Room

Purchased ☐ As Per Plan ☐ N/A ☒

Other Room - Specify Great Room

Purchased ☐ As Per Plan ☒ N/A ☐

Fireplace Type

Mantle Type

Over Mantle

Colour / Stain

Surround

Hearth

Comment

/

RECEIVED

JUN 02 2022

Front Facing

NF-08

/

White

/

/

SEE ATTACHED FOR SIGNATURES

Initial:

Purchasers: NARESH KUMAR VERMA & INDERJIT SINGH **Property:** 13 of Plan - Draft Approval SB17-03-08
Telephone Res. / Bus: (647) 766-8683 / **Project:** KINGSMEN (THAMES) INC.
Decor Advisor: Barbara Coccia **Model and Elevation:** James (3601) Elev B 4 Bed - 2+1 Bath

6. Trim Carpentry

Door Hardware Standard Handle

Interior Trim Standard

Comment

/

Interior Doors

☐ 2 Panel Arch Top

☒ 2 Panel Square Top

☐ 6 Panel

Initial for Door Style

NT

7. Railings and Pickets

Railing Package Standard Oak STRAIGHT picket package

Railing Colour Elements Natural

Wood Stairs ☐ No ☒ Oak

Picket Colour Elements Natural

Tread Colour Elements Natural

Comment

/

SEE ATTACHED FOR SIGNATURES

8. Plaster Mouldings and Medallions

Foyer /

Main Hall /

Living Room /

Dining Room /

Family Room /

Kitchen/Breakfast /

Den/Library /

Lower Landing /

Comment

/

9. Wall Paint

Kingsmen White

Smooth Ceilings ☐ First Floor

☐ First Floor incl. Second Floor Hall

☐ First and Second Floor

☒ Throughout

☐ Not Applicable

Trim Paint Kingsmen White

10. Additional Comments

/

RECEIVED

JUN 02 2022

11. Disclaimers and Notes

- Colours of all materials are as close as possible to builder's selection, but not necessarily identical due to variances in manufacturing.
- Any extras listed above are null and void unless accompanied by a separate invoice/amendment. Said invoice must be paid in full.
- The Purchaser acknowledges that after Interior Colour Selection form is signed and dated, no further changes will be permitted other than re-selection due to unavailability. Purchaser's Initials
- The Purchaser acknowledges reading and accepting the "Kingsmen Group Décor Color Disclaimers" and this document contains other miscellaneous disclaimers.

This Interior Colour Selection is final and approved by:

Purchaser:

Signature: Naresh Kumar Verma

Date:

June 1-2022

Signature:

Date:

SEE ATTACHED FOR SIGNATURES

Vendor:

KINGSMEN (THAMES) INC.

June 2/22

Page 3 of 3

@66" + up from
floor.

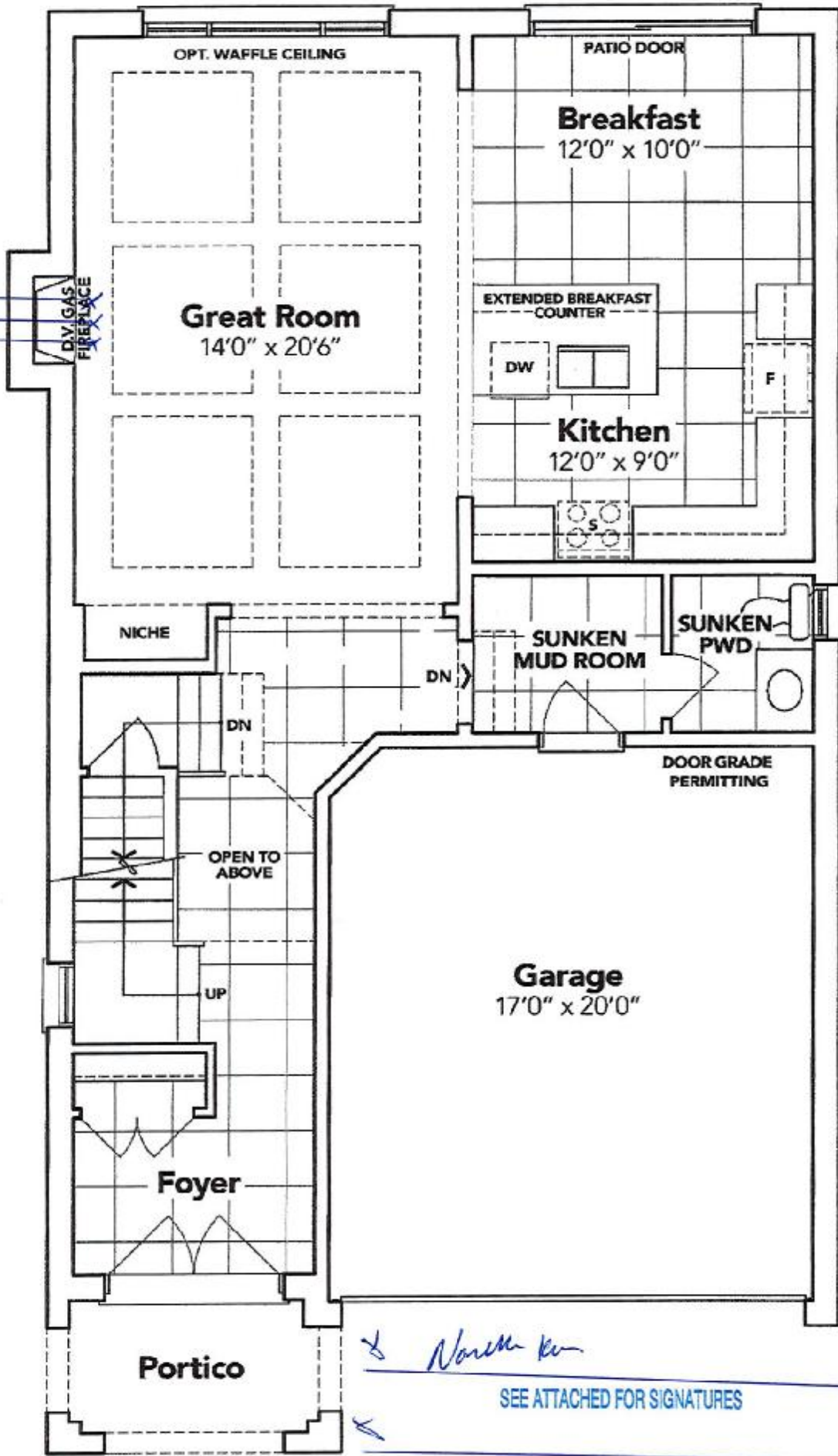

GROUND FLOOR EL. B

The floor plans and elevations shown are pre-construction plans and may be revised or improved as necessitated by architectural controls and the construction process. The measurements adhere to the rules and regulations of the TARION Warranty Corporation's official method for the calculation of floor area. Materials, specifications and floor plans are subject to change without notice. All house renderings are artist's concept only. Actual usable floor space may vary from the stated floor area. All options shown are upgrades. B. & O. E.

RECEIVED
JUN 02 2022

SCHEDULE "B-1"
Floor Plan

Phase 5A
Model: James (3601) Elev B 4 Bed - 2+1 Bath
Standard

LOT: 13 THAMES PH. 5 A, SKETCH # 2

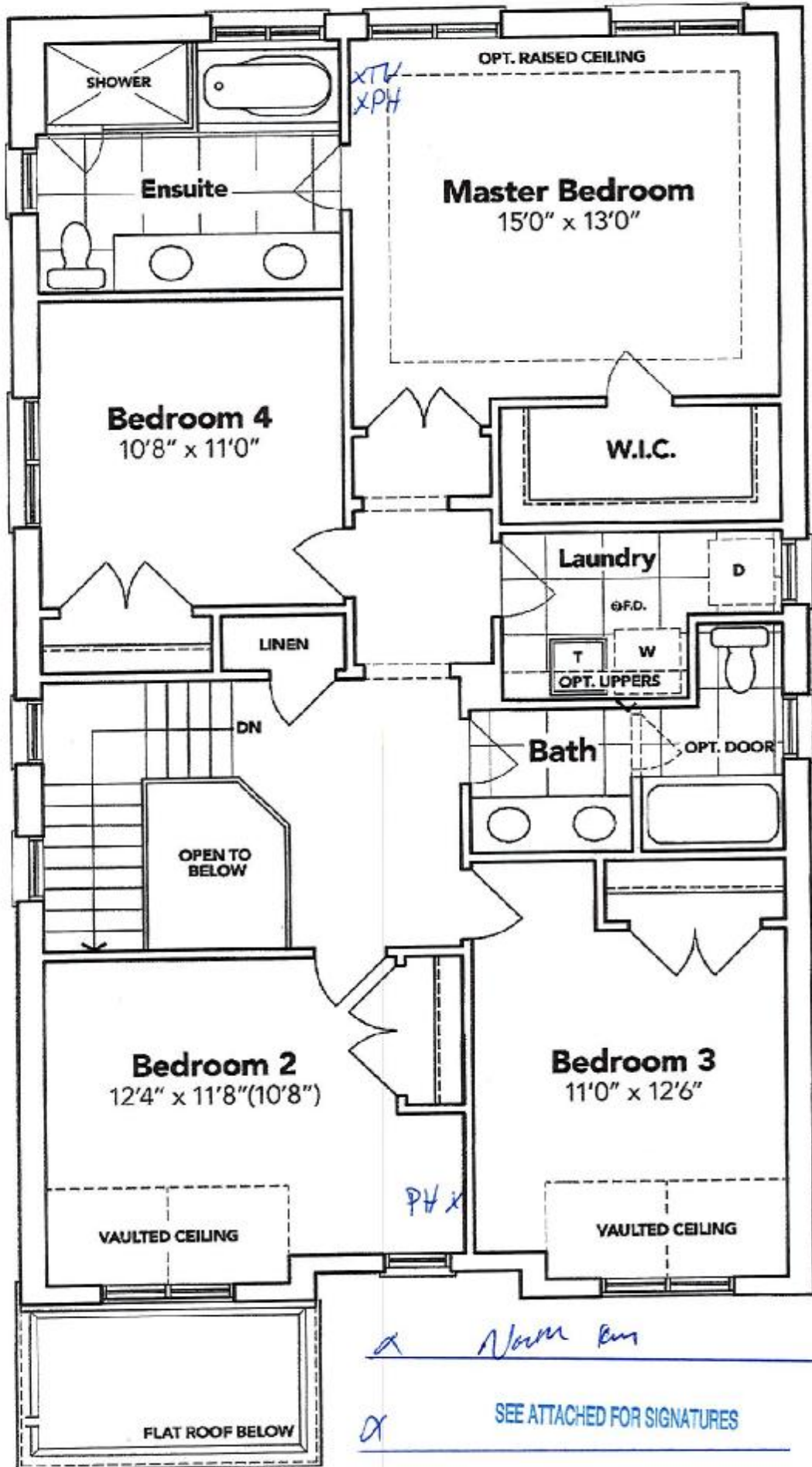

SECOND FLOOR EL. B

The floor plans and elevations shown are pre-construction plans and may be revised or improved as necessitated by architectural controls and the construction process. The measurements adhere to the rules and regulations of the TARIION Warranty Corporation's official method for the calculation of floor area. Materials, specifications and floor plans are subject to change without notice. All house renderings are artist's concept only. Actual usable floor space may vary from the stated floor area. All options shown are upgrades. L. & O. E.

RECEIVED
JUN 02 2022

SCHEDULE "B-1" - Page 2 of 3

Initials: _____

LOT: 13 THAMES PH. 5 A, SKETCH # 3

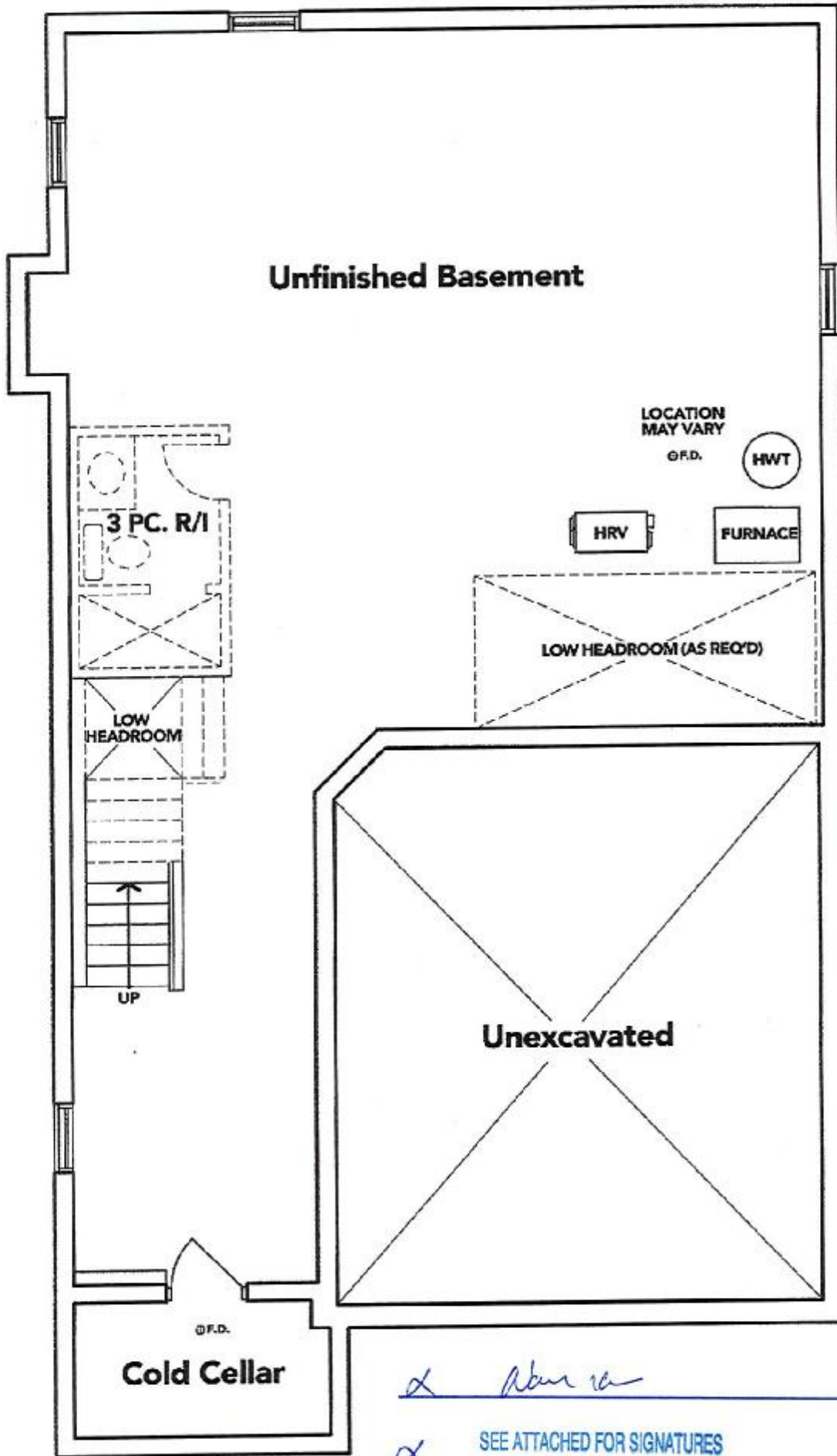

BASEMENT EL. B

The floor plans and elevations shown are pre-construction plans and may be revised or improved as necessitated by architectural controls and the construction process. The measurements adhere to the rules and regulations of the TARION Warranty Corporation's official method for the calculation of floor area. Materials, specifications and floor plans are subject to change without notice. All house renderings are artist's concept only. Actual usable floor space may vary from the stated floor area. All options shown are upgrades. E. & O. E.

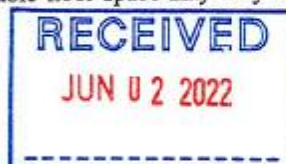

SCHEDULE "B-1" - Page 1 of 3

Initials: 