

KINGSMEN (THAMES) INC. / Havelock Corners (Kingsmen)

Lot/Unit: 19    Phase/Building: 5A    Model/Floor Plan: Edward (3602) Elev C 4 Bed - 2+1 Bath

CABINETRY VANITY

Inv.5629	1 - To supply & install a VANITY BANK OF DRAWERS - in the master ensuite.... see sketch # 2	
Line 71857	Note:	
26May22 / 26May22		
Inv.5629	1 - To supply & install a VANITY BANK OF DRAWERS - in the main bathroom .... see sketch # 2	
Line 71858	Note:	
26May22 / 26May22		

COUNTER TOP

Inv.5629	1 - As per schedule "PE": Vendor to include level 1, 2cm. quartz in all bathrooms, as per plan, in lieu of the included laminate counter tops. Selections to be made from builders standard samples.	
Line 71844	Note:	
26May22 / 26May22		

ELECTRICAL

Inv.5629	1 - To supply & install the standard T.V. rough in in the great room and master bedroom... see sketch # 1 & # 2	
Line 71848	Note: Install the standard T.V. rough in in the great room at approx. 66" + - up from the floor centered + - to the F/P mantle.	
26May22 / 26May22		
Inv.5629	1 - To supply & install the standard Phone ( CAT 5 ) rough in in the great room, master bedroom and bedroom # 4 .. see sketch # 1 & # 2	
Line 71849	Note: Install the standard Phine ( CAT 5 ) rough in in the great room at approx. 66" + - up from the floor centered + - to the F/P mantle.	
26May22 / 26May22		
Inv.5629	1 - To SUPPLY AND INSTALL AN ADDITIONAL BASIC RECEPTACLE (NOT DEDICATED) a approx. 66" + - up from the floor centerd + - to the F/P mantle in the	
Line 71850	Note: great room... see sketch # 1	
26May22 / 26May22                      THIS IS FOR A FUTURE WALL MOUNT T.V. " NO CONDUIT HAS BEEN PURCHASED "		
Inv.5629	1 - To SUPPLY AND INSTALL EXTRA CEILING BOX ROUGH IN CAPPED (DOES NOT INCLUDE SWITCH) over the kitchen island area... see sketch # 1	
Line 71852	Note: This capped elec. will be connected to a sep. switch, switch sold sep.	
26May22 / 26May22		
Inv.5629	1 - To supply & install AN ADDITIONAL SINGLE POLE SWITCH connected to the upgraded capped elec. over the kitchen island area.	
Line 71853	Note:	
26May22 / 26May22		
Inv.5629	1 - Relocate the standard ceiling light from the upper stair case landing to the O.T.B. area on the second floor... see skech # 2	
Line 71854	Note:	
26May22 / 26May22		

HARDWOOD

**KINGSMEN (THAMES) INC. / Havelock Corners (Kingsmen)**

**Lot/Unit: 19    Phase/Building: 5A    Model/Floor Plan: Edward (3602) Elev C 4 Bed - 2+1 Bath**

Inv.5629	1 - To supply & install the 3 1/2" Elements Engineered hardwood stained floors to the main floor area and stair landings where applicable in lieu of the standard Engineered hardwood... see colour chart for details.	
Line 71863	Note:	
26May22 / 26May22		
Inv.5629	1 - To supply & install the 3 1/2" Elements Engineered hardwood stained floors to the upper hallway area where applicable in lieu of the standard carpet ... see colour chart for details.	
Line 71864	Note:	
26May22 / 26May22		

**HEATING AND AIR CONDITIONING**

Inv.5629	1 - As per schedule "PE": Vendor to install capped gas line (rough in only) at rear of home for future BBQ location. Location to be finalized at vendor sole discretion.	
Line 71842	Note:	
26May22 / 26May22		
Inv.5629	1 - As per schedule "PE": Vendor to supply & install air conditioning unit, sized accordingly, from vendors standard samples.	
Line 71843	Note:	
26May22 / 26May22		

**MISCELLANEOUS**

**PAINT AND DRYWALL**

Inv.5629	1 - To PAINT EXTRAS - STAIN STAIRS (EXCLUDING RAILINGS) (PER FLIGHT - OAK)... see colour chart for details.	
Line 71865	Note:	
26May22 / 26May22		
Inv.5629	1 - To PAINT EXTRAS - STAIN RAILINGS AND PICKETS (PER FLIGHT)... see colour chart for details.	
Line 71866	Note:	
26May22 / 26May22		

**PLUMBING**

Inv.5629	1 - To supply & install the BLANCO QUATRUS U1 Super single under mount kitchen sink model 401248 in lieu of the standard top mount kitchen sink...see spec's	
Line 71855	Note: Still to install the standard single hole kitchen faucet NO PLATE.	
26May22 / 26May22		
Inv.5629	5 - To supply & install the VANITY SINK - CONTRAC CATENA UNDERMOUNT - MODEL 4210CIY in the powder room, master ensuit and main bathroom in lieu of the standard top mount vanity sinks... see spec's	
Line 71856	Note: Still to install the standard lav. faucets.	
26May22 / 26May22		

**TILE - FLOOR**

Inv.5629	1 - To supply & install the UPGRADE 4 - FLOOR TILE -STACKED - FOYER TILE in lieu of the standard tile... see colour chart for details.	
Line 71859	Note:	
26May22 / 26May22		

KINGSMEN (THAMES) INC. / Havelock Corners (Kingsmen)

Lot/Unit: 19    Phase/Building: 5A    Model/Floor Plan: Edward (3602) Elev C 4 Bed - 2+1 Bath

Inv.5629	1 - To supply & install the UPGRADE 4 - FLOOR TILE -STACKED - POWDER ROOM TILE in lieu of the standard tile... see colour chart for details.	
Line 71860	Note:	
26May22 / 26May22		
Inv.5629	1 - To supply & install the UPGRADE 4 - FLOOR TILE -STACKED - LAUNDRY ROOM TILE in lieu of the standard tile... see colour chart for details.	
Line 71861	Note:	
26May22 / 26May22		
Inv.5629	1 - To supply & install the UPGRADE 4 - FLOOR TILE -STACKED - KITCHEN/BREAKFAST TILE in lieu of the standard tile... see colour chart for details.	
Line 71862	Note:	
26May22 / 26May22		

EXTRAS AS PER OFFER

5 FREE APPLIANCES – STAINLESS STEEL FRONT - FRIDGE: STOVE AND DISHWASHER. WHITE WASHER AND DRYER (SUPPLIED ONLY, NOT INSTALLED, FROM BUILDERS STANDARD LINE). AN APPLIANCES VOUCHER WILL BE GIVEN BY OUR DECOR CONSULTANT AT THE TIME OF BOOKING YOUR COLOUR A <i>Worksheet</i> Note:	
VENDOR TO INSTALL CAPPED GAS LINE (ROUGH-IN ONLY) AT REAR OF HOME FOR FUTURE BBQ LOCATION. LOCATION TO BE FINALIZED AT VENDORS SOLE DISCRETION. <i>Worksheet</i> Note:	
VENDOR TO SUPPLY & INSTALL AIR CONDITIONING UNIT, SIZED ACCORDINGLY, FROM VENDORS STANDARD SAMPLES. <i>Worksheet</i> Note:	
VENDOR TO INCLUDE LEVEL 1, 2CM QUARTZ IN ALL BATHROOMS, AS PER PLAN, IN LIEU OF THE INCLUDED LAMINATE COUNTER TOPS. SELECTIONS TO BE MADE FROM BUILDERS STANDARD SAMPLES. <i>Worksheet</i> Note:	

**Purchaser:** JAGDEEP KAUR RANDHAWA  
**Telephone Res. / Bus:** (647) 619-6061 / (647) 997-6061  
**Decor Advisor:** Barbara Coccia

**Property:** 19 of Plan - Draft Approval SB17-03-08

**Project:** KINGSMEN (THAMES) INC.

**Model and Elevation:** Edward (3602) Elev C 4 Bed - 2+1 Bath

**Layout Changes:** ☐ Yes ☒ No

**Sketch Attached:** ☒ Yes ☐ No

**Exterior Colour Scheme:**

### 1. Cabinetry

	Style and Colour	Counter Top	Hardware
Kitchen / Breakfast	#3, Simcoe Orchid	#1, C/S # 3040 Cement 3cm.	# 12881 Handle
Kitchen Island	#3, Simcoe Orchid	#1, C/S # 3040 Cement 3cm.	# 12881 Handle
Laundry Room	/		
Powder Room	#3, Simcoe Rain Cloud	#1, C/S # 9141 Ice Snow 2cm.	# 12881 Handle
Main Bathroom	#3, Simcoe Rain Cloud	#1, C/S # 9141 Ice Snow 2cm.	# 12881 Handle
Master Ensuite Bathroom	#3, Simcoe Orchid	#1, C/S # 9141 Ice Snow 2cm.	# 12881 Handle
Second Ensuite Bathroom (If Applicable)	/		
	/		
	/		

**Appliances**

**Custom Size Fridge**

☐ Yes ☒ No

**Valance Lighting**

☐ Yes ☒ No

**Microwave / Range Hood**

☐ Yes ☒ No

**Cooktop / Rangetop**

☐ Yes ☒ No

**Built in Wall Oven**

☐ Yes ☒ No

**Slide-in Range**

☐ Yes ☒ No

**Comment**

/

### 2. Flooring

#### Selection

Foyer	**Upg. 4. 24 x24" Mayfair Volakas Grigio HD Polished Rec. Porcelain STACKED
Main Hall	**3 1/2" Elements Oak Sturgeon
Back Hall	/
Breakfast	/
Laundry Room	**Upg. 4. 24 x24" Mayfair Volakas Grigio HD Polished Rec. Porcelain STACKED
Kitchen	**Upg. 4. 24 x24" Mayfair Volakas Grigio HD Polished Rec. Porcelain STACKED
Powder Room	**Upg. 4. 24 x24" Mayfair Volakas Grigio HD Polished Rec. Porcelain STACKED
Main Bathroom	13x13" Bellina Grey
Master Ensuite	13 x 13" Malena Ice
Bathroom (If Applicable)	/
Mud Room	/
Master Ens. Shower floor	2x2" Ontario Snow White Matte
Living Room	/
Dining Room	**3 1/2" Elements Oak Sturgeon
Family / Great Room	**3 1/2" Elements Oak Sturgeon
Den / Library / Study	/
Basement Landing (If Applies)	
Lower Landing (If Applicable)	**3 1/2" Elements Oak Sturgeon
Upper Landing	**3 1/2" Elements Oak Sturgeon
Upper Hall	**3 1/2" Elements Oak Sturgeon
Master Bedroom	Modern Story 1, # 810 Rocky Top
Bedroom #2	Modern Story 1, # 810 Rocky Top
Bedroom #3	Modern Story 1, # 810 Rocky Top
Bedroom #4	Modern Story 1, # 810 Rocky Top
Bedroom #5	/
Master ens. shower jamb	Anatolia marmiline SNOW



Flooring Continued on Page 2

Initial: \_\_\_\_\_

Page 1 of 3



**Purchaser:** JAGDEEP KAUR RANDHAWA  
**Telephone Res. / Bus:** (647) 619-6061 / (647) 997-6061  
**Decor Advisor:** Barbara Coccia  
**2. Flooring - Continued -**

**Property:** 19 of Plan - Draft Approval SB17-03-08  
**Project:** KINGSMEN (THAMES) INC.  
**Model and Elevation:** Edward (3602) Elev C 4 Bed - 2+1 Bath

Upgrade Underpad	Type Standard	Area Master bedroom, bedroom # 2, #3 & # 4
Carpet on Stairs	Capped	Runner - *Upgrade
Comment /	/	/

### 3. Plumbing Fixtures / Faucets

Kitchen	Standard	Second Ensuite	/	Powder Room	Standard
Master Ensuite	Standard			Other Room	/
Main Bathroom	Standard		/		

#### Comment

Purchaser has upgraded to an under mount kitchen sink, still to install the standard single hole kitchen faucet NO PLATE.  
Purchaser has upgraded to under mount sinks in all bathrooms, still to install the standard lav. faucets.

### 4. Wall Tile

	Tile Selection	Listello	Insert	Insert Selection
Main Bathroom	8x10" Bellina Grey	<input type="checkbox"/>	<input type="checkbox"/>	
Master Ensuite				
Tub Deck	13 x13" Malena Ice	<input type="checkbox"/>	<input type="checkbox"/>	
Tub Apron	13 x13" Malena Ice	<input type="checkbox"/>	<input type="checkbox"/>	
Tub Surround	13 x13" Malena Ice	<input type="checkbox"/>	<input type="checkbox"/>	
Shower Stall	8x10" Malena Ice	<input type="checkbox"/>	<input type="checkbox"/>	
Second Ensuite	/	<input type="checkbox"/>	<input type="checkbox"/>	
	/	<input type="checkbox"/>	<input type="checkbox"/>	
	/	<input type="checkbox"/>	<input type="checkbox"/>	
Kitchen Backsplash	/	<input type="checkbox"/>	<input type="checkbox"/>	
Complete Backsplash	/	<input type="checkbox"/>	<input type="checkbox"/>	

#### Comment

/

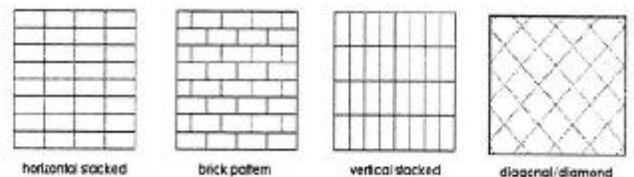

### 5. Fireplace

#### Living Room

Purchased ☐ As Per Plan ☐ N/A ☒

#### Family Room

Purchased ☐ As Per Plan ☐ N/A ☒

#### Other Room - Specify Great room

Purchased ☐ As Per Plan ☒ N/A ☐

Fireplace Type  
Mantle Type  
Over Mantle  
Colour / Stain  
Surround  
Hearth  
Comment  
/

Front Facing  
NF-08  
/  
White  
/  
/

RECEIVED  
MAY 27 2022



Initial: \_\_\_\_\_

**Purchaser:** JAGDEEP KAUR RANDHAWA  
**Telephone Res. / Bus:** (647) 619-6061 / (647) 997-6061  
**Decor Advisor:** Barbara Coccia

**Property:** 19 of Plan - Draft Approval SB17-03-08  
**Project:** KINGSMEN (THAMES) INC.  
**Model and Elevation:** Edward (3602) Elev C 4 Bed - 2+1 Bath

### 6. Trim Carpentry

**Door Hardware** Standard Handle

**Interior Trim** Standard

**Comment**

/

#### Interior Doors

☐ 2 Panel Arch Top

☒ 2 Panel Square Top

☐ 6 Panel

Initial for Door Style

jk

### 7. Railings and Pickets

**Railing Package** Standard Oak STRAIGHT Picket package

**Railing Colour** \*\*Elements Strugeon

**Picket Colour** \*\*Elements Strugeon

**Wood Stairs** ☐ No ☒ Oak

**Tread Colour** \*\*Elements Strugeon

**Comment**

/

### 8. Plaster Mouldings and Medallions

**Foyer** /

**Kitchen/Breakfast** /

**Main Hall** /

**Den/Library** /

**Living Room** /

**Lower Landing** /

**Dining Room** /

**Family Room** /

**Comment**

/

### 9. Wall Paint

Kingsmen White

#### Smooth Ceilings

☐ First Floor

☐ First Floor incl. Second Floor Hall

☐ First and Second Floor

☒ Throughout

☐ Not Applicable

**Trim Paint** Kingsmen White

### 10. Additional Comments

/

RECEIVED

MAY 27 2022

### 11. Disclaimers and Notes

- Colours of all materials are as close as possible to builder's selection, but not necessarily identical due to variances in manufacturing.
- Any extras listed above are null and void unless accompanied by a separate invoice/amendment. Said invoice must be paid in full.
- The Purchaser acknowledges that after Interior Colour Selection form is signed and dated, no further changes will be permitted other than re-selection due to unavailability. jk Purchaser's Initials
- The Purchaser acknowledges reading and accepting the "Kingsmen Group Décor Centre Disclaimers" form. This document contains other miscellaneous disclaimers.

This Interior Colour Selection is final and approved by:

**Purchaser:**

**Signature:** Jagdeep Kaur Randhawa **Date:** 26 May 2022

**Vendor:**

KINGSMEN (THAMES) INC.

May 30/22

**SCHEDULE "B-1"**  
**Floor Plan**

Lot 19  
Phase 5A  
Model: Edward (3602) Elev C 4 Bed - 2+1 Bath  
Standard

*sketch #1*

*all 3 @ 66" +  
up from floor*

*capped elec  
sep switch*

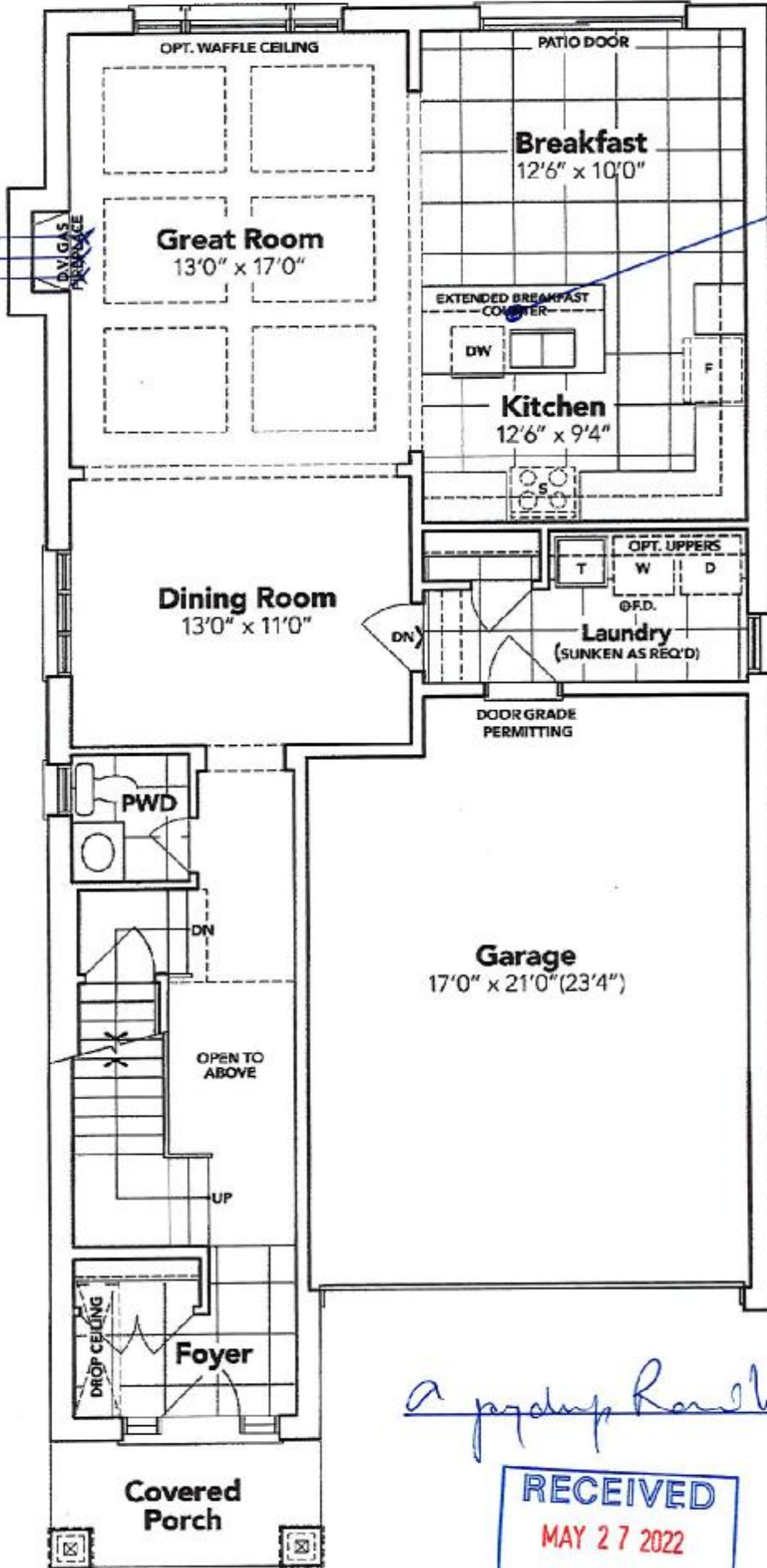

*a prairie rancher*



**GROUND FLOOR EL. C**

The floor plans and elevations shown are pre-construction plans and may be revised or improved as necessitated by architectural controls and the construction process. The measurements adhere to the rules and regulations of the TARION Warranty Corporation's official method for the calculation of floor area. Materials, specifications and floor plans are subject to change without notice. All house renderings are artist's concept only. Actual usable floor space may vary from the stated floor area. All options shown are upgrades. E. & O. E.



**SCHEDULE "B-1"**  
**Floor Plan**

Lot 19  
Phase 5A  
Model: Edward (3602) Elev C 4 Bed - 2+1 Bath  
Standard

*Sketch #2*

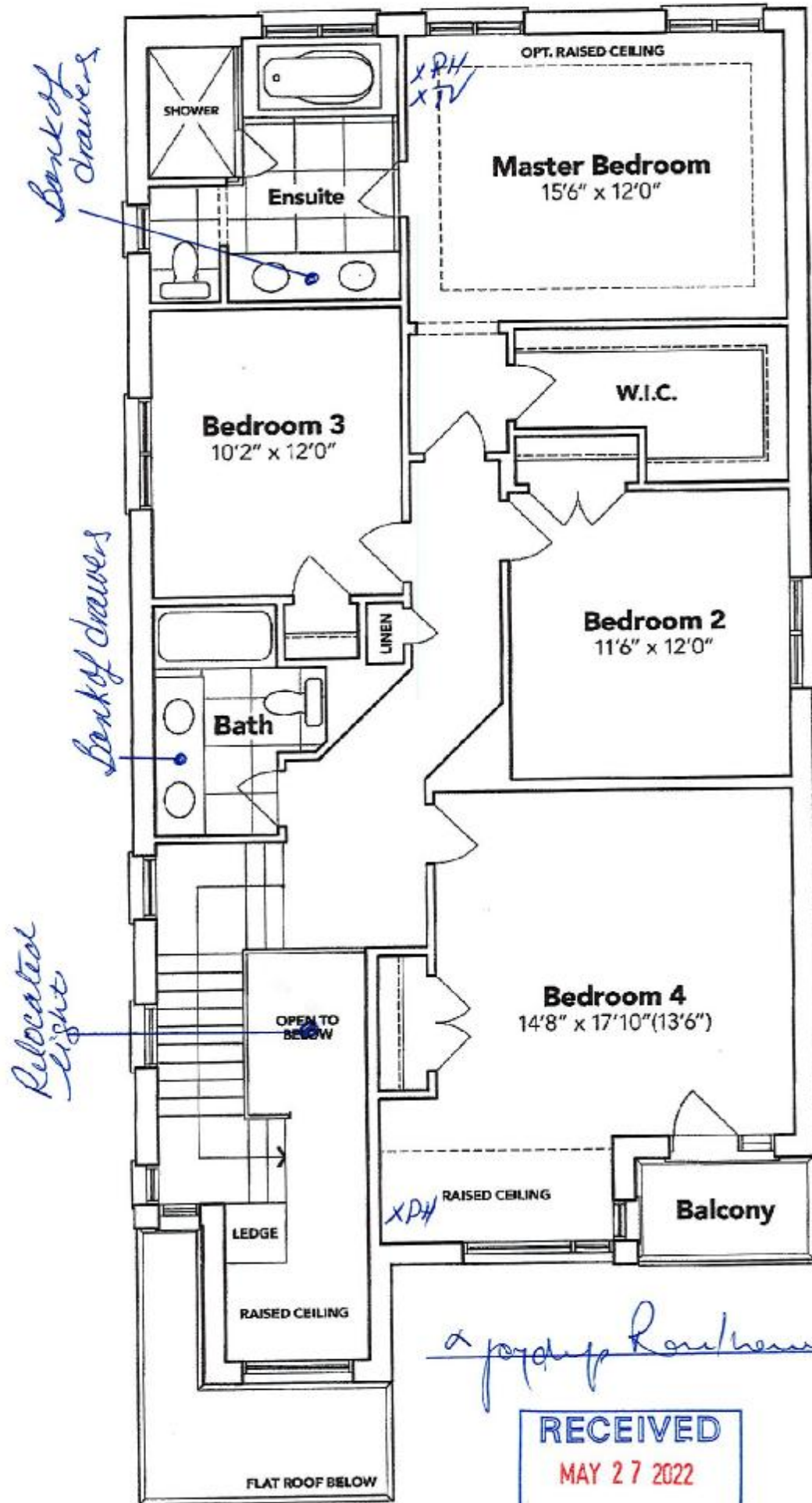

**SECOND FLOOR EL. C**

The floor plans and elevations shown are pre-construction plans and may be revised or improved as necessitated by architectural controls and the construction process. The measurements adhere to the rules and regulations of the TARIION Warranty Corporation's official method for the calculation of floor area. Materials, specifications and floor plans are subject to change without notice. All house renderings are artist's concept only. Actual usable floor space may vary from the stated floor area. All options shown are upgrades. E. & O. E.





Lot 19  
Phase 5A  
Model: Edward (3602) Elev C 4 Bed - 2+1 Bath  
Standard

Sketch  
#3

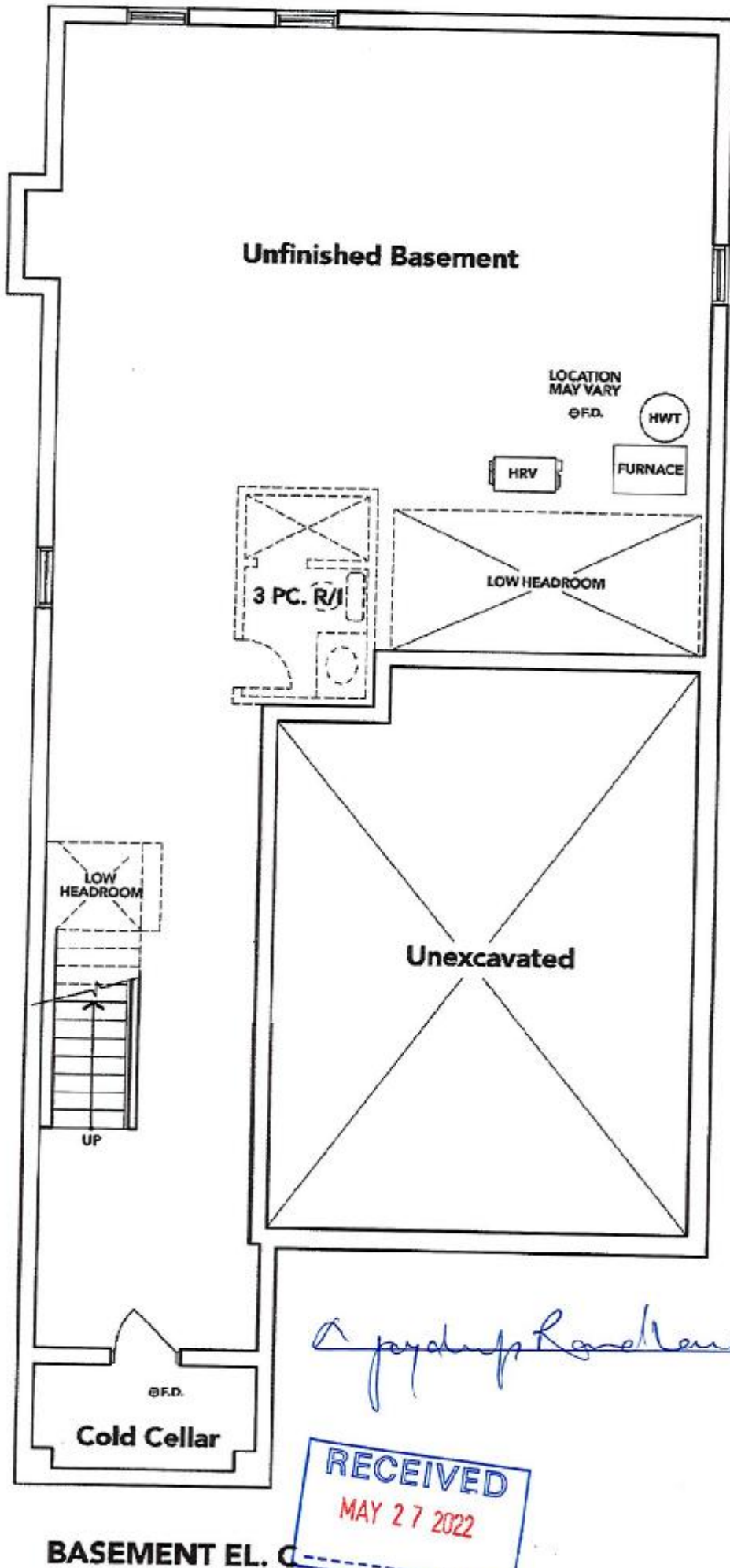

The floor plans and elevations shown are pre-construction plans and may be revised or improved as necessitated by architectural controls and the construction process. The measurements adhere to the rules and regulations of the TARIION Warranty Corporation's official method for the calculation of floor area. Materials, specifications and floor plans are subject to change without notice. All house renderings are artist's concept only. Actual usable floor space may vary from the stated floor area. All options shown are upgrades.

LOT 19 THAMES PH. 5 A  
RE: UPGRADE UNDER MOUNT KITCHEN  
SINK



QUATRUS U1  
SUPER SINGLE

© 2000 Blackwell Science Ltd, *Journal of Internal Medicine* 247: 399–404

 $\text{ZnO} \cdot x\text{H}_2\text{SO}_4$  (0.049–5.6 g) (0.04–0.2 mm), dry at 70°C.

Estadística (1994) es el estudio de los datos.

HPLC chromatograms of content in each of the fractions and so forth.

Three units to follow

Answer:  $\frac{1}{2}$

Model #401248

A psychrometer

**BLANCO**

LOT 19 THAMES PH. 5 A  
RE: UPGRADE UNDER MOUNT SINKS  
FOR ALL BATHROOMS

CATENA  
RECTANGULAR UNDERMOUNT SINK  
4210CIY Undermount Sink

PRODUCT SPECS:  
- Vitreous china  
- Front overflow hole  
- Template and mounting hardware supplied

DIMENSIONS:  
Outer:  
510mm W x 390mm D x 190mm H  
20" W x 15 1/2" D x 7 1/2" H  
Inner:  
458mm W x 340mm D x 140mm H  
18" W x 13 1/4" D x 5 1/2" H

COMPLIANCE CERTIFICATIONS  
Meets or exceeds the following:  
- IAPMO cUPC  
- ASME A112.19.2 / CSA B45.1  
- OBC Section 3.8 Barrier Free design and CSA B651 Standard

SHIPPING  
Cube 1.72  
GW 27 lbs

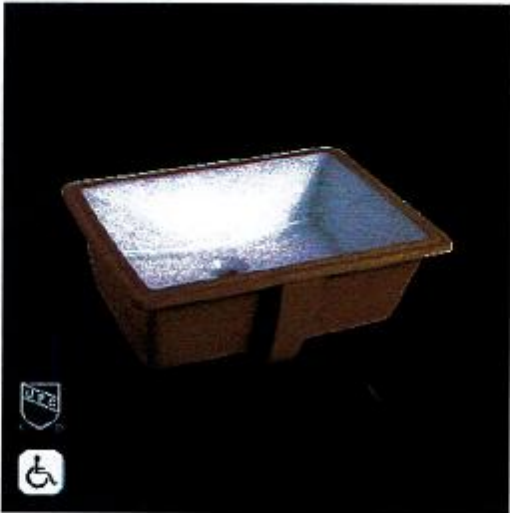
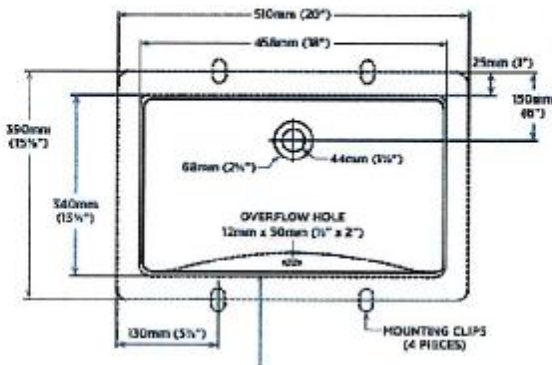

TO BE SPECIFIED  
Color:  
■ Soft White

NOTES: Dimensions of fixtures are nominal and may vary within the range of tolerances established by ASME standard A112.19.2. These measurements are subject to change without notice. No responsibility is assumed for use of superseded or revised pages.  
Products are designed to comply with CSA B651 Standard and OBC barrier-free requirements. It shall be the responsibility of the installer to comply with the local disability codes and standards prior to installing the product.



*Alfred R. Rasmussen*

RECEIVED  
MAY 27 2022