

KINGSMEN (THAMES) INC. / Havelock Corners (Kingsmen)

**Lot/Unit: 261 BLOCK 194 Phase/Building: 5A Model/Floor Plan: Richard (2602) Elev B1 3
Bed - 2+1 Bath**

CABINETRY

Inv.5335 Line 69355 28Jan22 / 28Jan22	1 - To accomodate for 30" chimney hoodfan Note: 	
Inv.5335 Line 69369 28Jan22 / 28Jan22	2 - To supply & install TWO DUMMY DOORS one on each short end of the kitchen island... see see sketch # 1 Note: 	
Inv.5335 Line 69379 28Jan22 / 28Jan22	1 - Purchaser has upgraded the kitchen sink, see spec's attached. Note: 	

CABINETRY APPLIANCE - FRIDGE

Inv.5335 Line 69367 28Jan22 / 28Jan22	1 - To supply and install 66CM DEEP FRIDGE ENCLOSURE - COUNTER DEPTH WITH NO WALLS - 2 66CM DEEP GABLES AND 1 66CM DEEP CABINET - THIS IS NOT A ZERO CLEARANCE ENCLOSURE. STANDARD HEIGHTS AND WIDTHS WILL BE USED. - CLASSIC SERIES.. see sketch #1 Note: 	
---	---	--

CABINETRY HOOD FANS

Inv.5335 Line 69354 28Jan22 / 28Jan22	1 - To supply and install HOOD FAN - PRO COLLECTION (SCB72230) WALL MOUNT RANGE HOOD WITH 650 CFM FAN - 30 INCH in lieu of the standard.. see spec's Note: 	
---	---	--

CABINETRY VANITY

Inv.5335 Line 69370 28Jan22 / 28Jan22	1 - To supply and install a VANITY LOWER DRAWER- CLASSIC SERIES in the PWD.. see sketch #1 Note: 	
Inv.5335 Line 69371 28Jan22 / 28Jan22	1 - To supply and install a VANITY BANK OF DRAWERS - CLASSIC SERIES in the Master Ensuite.. see sketch #2 Note: 	
Inv.5335 Line 69372 28Jan22 / 28Jan22	2 - To supply and install TWO VANITY TOP DRAWER - CLASSIC SERIES in the Main Bathroom.. see sketch 2 Note: 	

COUNTER TOP

Inv.5335 Line 69348 28Jan22 / 28Jan22	1 - As per Schedule "PE": Vendor to include level , 2cm quartz in all bathrooms, as per plan, in lieu of the included laminate counter tops. Selections to be made from builders standard samples. Note: 	
---	---	--

ELECTRICAL

KINGSMEN (THAMES) INC. / Havelock Corners (Kingsmen)

**Lot/Unit: 261 BLOCK 194 Phase/Building: 5A Model/Floor Plan: Richard (2602) Elev B1 3
Bed - 2+1 Bath**

Inv.5335	1 - To supply and install the standard T.V Rough-in, in the Great Room and Master Bedroom... see sketch #1 and #2	
Line 69350	Note:	
28Jan22 / 28Jan22		
Inv.5335	1 - To supply and install the standard Phone (CAT 5) Rough-in, in the Great Room, Master Bedroom and Bedroom #3... see sketch #1 and #2	
Line 69351	Note:	
28Jan22 / 28Jan22		
Inv.5335	1 - To SUPPLY AND INSTALL AN ADDITIONAL BASIC RECEPTACLE (NOT DEDICATED) centered +- at approx. 66" up from the floor over the F/P Mantle in the Great Room.. see sketch #1	
Line 69352	Note: THIS IS FOR FUTURE WALL MOUNT T.V	
28Jan22 / 28Jan22		
Inv.5335	1 - To SUPPLY AND INSTALL CONDUIT FOR TV OVER THE FIREPLACE in the GREAT ROOM next to +- the UPG electrical outlet – TERMINATED IN SAME ROOM next to the standard Phone and T.V rough-in.. see sketch #1	
Line 69353	Note: THIS IS FOR FUTURE WALL MOUNT TV	
28Jan22 / 28Jan22		
Inv.5335	1 - To relocate the standard light in the Great Room.. see sketch #1	
Line 69357	Note:	
28Jan22 / 28Jan22		
Inv.5335	1 - To SUPPLY AND INSTALL EXTRA CEILING BOX ROUGH IN CAPPED (ON A SEPARATE SWITCH) in the Great Room.. see sketch #1	
Line 69358	Note:	
28Jan22 / 28Jan22		
Inv.5335	1 - To SUPPLY AND INSTALL EXTRA CEILING BOX ROUGH IN CAPPED (ON A SEPARATE SWITCH) over the breakfast bar in the kitchen.. see sketch #1	
Line 69359	Note:	
28Jan22 / 28Jan22		
Inv.5335	1 - To SUPPLY AND INSTALL A CAPPED CEILING LIGHT BOX, WITH 3 WAY over the open to below area.. see sketch #2	
Line 69360	Note:	
28Jan22 / 28Jan22		

HARDWOOD

Inv.5335	1 - To supply the upgraded stain to the main floor hardwood, in lieu of the standard natural stain.. see colour chart for details	
Line 69373	Note:	
28Jan22 / 28Jan22		
Inv.5335	1 - To supply and install 3 1/2" elements stained hardwood to the second floor upper hallway in lieu of the standard carpet.. see colour chart for details	
Line 69376	Note:	
28Jan22 / 28Jan22		

HEATING AND AIR CONDITIONING

KINGSMEN (THAMES) INC. / Havelock Corners (Kingsmen)

**Lot/Unit: 261 BLOCK 194 Phase/Building: 5A Model/Floor Plan: Richard (2602) Elev B1 3
Bed - 2+1 Bath**

Inv.5335	1 - As per Schedule "PE": Vendor to supply and install air conditioning unit, sized accordingly from Vendors standard samples.	
Line 69347	Note:	
28Jan22 / 28Jan22		

HVAC

Inv.5335	1 - As per Schedule "PE": Vendor to install capped gas line (Rough-in ONLY) at rear of home for future BBQ Location. Location to be finalized at Vendors sole discretion.	
Line 69346	Note:	
28Jan22 / 28Jan22		

MISCELLANEOUS

PAINT AND DRYWALL

Inv.5335	1 - To PAINT EXTRAS - STAIN RAILINGS WITH IRON PICKETS (INCLUDING STAIRS) in lieu of the standard natural, see colout chart for details.	
Line 69374	Note:	
28Jan22 / 28Jan22		

PLUMBING

Inv.5335	1 - To supply and instal Vichy CHROME MODEL #6710 in the POWDER ROOM BATHROOM ONLY, in lieu of the standard.. see spec's	
Line 69362	Note:	
28Jan22 / 28Jan22		
Inv.5335	1 - To supply a WATERLINE ROUGH-IN TO THE FRIDGE LOCATION (NO HOOK UP)	
Line 69363	Note:	
28Jan22 / 28Jan22		
Inv.5335	1 - To supply and install VANITY SINK - CONTRAC CATENA UNDERMOUNT - MODEL 4210CIY in the POWDER ROOM BATHROOM ONY.. see spec's	
Line 69364	Note: Purchaser has upgraded the faucet, see sep. upgrade	
28Jan22 / 28Jan22		
Inv.5335	1 - To supply & instal lthe KITCHEN SINK - BLANCO QUATRUS U2 UNDERMOUNT - MODEL 401247 in the kitchen in lieu of the standard top mount kitchen sink... see spec's	
Line 69366	Note: Still to install the standard single hole kitchen faucet NO PLATE	
28Jan22 / 28Jan22		

RAILING

Inv.5335	1 - RAILING - UPGRADE 1 - METAL HANDRAIL 3 INCH OVAL IN OAK - PICKETS STEEL ½ INCH SQUARE, PLAIN, WITH SHOES IN FLAT BLACK - POSTS 3½ INCH SQUARE, WITH CAP OAK IN OAK	
Line 69375	Note:	
28Jan22 / 28Jan22		



CONSTRUCTION SUMMARY

KINGSMEN (THAMES) INC. / Havelock Corners (Kingsmen)

Lot/Unit: 261 BLOCK 194 Phase/Building: 5A Model/Floor Plan: Richard (2602) Elev B1 3
Bed - 2+1 Bath

EXTRAS AS PER OFFER

CAPPING

PLAN

REFERAL

UPGRADES

5 FREE APPLIANCES–STAINLESS STEEL FRONT-FRIDGE; STOVE AND DISHWASHER.WHITE WASHER AND DRYER (SUPPLIED ONLY,NOT INSTALLED, FROM BUILDERS STANDARD LINE).AN APPLIANCES VOUCHER WILL BE GIVEN BY OUR DECOR CONSULTANT AT THE TIME OF BOOKING YOUR COLOUR APPT <i>Worksheet</i> Note:	
VENDOR TO INSTALL CAPPED GAS LINE (ROUGH-IN ONLY) AT REAR OF HOME FOR FUTURE BBQ LOCATION. LOCATION TO BE FINALIZED AT VENDORS SOLE DISCRETION. <i>Worksheet</i> Note:	
VENDOR TO SUPPLY & INSTALL AIR CONDITIONING UNIT, SIZED ACCORDINGLY, FROM VENDORS STANDARD SAMPLES. <i>Worksheet</i> Note:	
VENDOR TO INCLUDE LEVEL 1, 2CM QUARTZ IN ALL BATHROOMS, AS PER PLAN, IN LIEU OF THE INCLUDED LAMINATE COUNTER TOPS. SELECTIONS TO BE MADE FROM BUILDERS STANDARD SAMPLES. <i>Worksheet</i> Note:	

Purchaser: HARPREET KAUR SEKHON Property: 261 BLOCK 194 of Plan - Draft Approval S
Telephone Res. / Bus: / Project: KINGSMEN (THAMES) INC.
Decor Advisor: Barbara Coccia Model and Elevation: Richard (2602) Elev B1 3 Bed - 2+1 Bath
Layout Changes: ☐ Yes ☒ No Sketch Attached: ☒ Yes ☐ No Exterior Colour Scheme:

1. Cabinetry	Style and Colour	Counter Top	Hardware
Kitchen / Breakfast	#3 Manchester Maple Shale Grey CL	#1 C/S #9141 Ice Snow 3cm	12881 Handle
Kitchen Island	#3 Manchester Maple Shale Grey CL	#1 C/S #9141 Ice Snow 3cm	12881 Handle
Laundry Room	/	/	/
Powder Room	#3 Manchester Maple Shale Grey CL	#1 C/S #9141 Ice Snow 2cm	12881 Handle
Main Bathroom	#3 Simcoe Orchid	#1 C/S #3040 Cement 2cm	12881 Handle
Master Ensuite Bathroom	#3 Manchester Maple Shale Grey CL	#1 C/S #9141 Ice Snow 2cm	12881 Handle
Second Ensuite Bathroom (If Applicable)	/	/	/

Appliances	Custom Size Fridge <input type="radio"/> Yes <input checked="" type="radio"/> No	Valance Lighting <input type="radio"/> Yes <input checked="" type="radio"/> No	Microwave / Range Hood <input type="radio"/> Yes <input checked="" type="radio"/> No
	Cooktop / Rangetop <input type="radio"/> Yes <input checked="" type="radio"/> No	Built in Wall Oven <input type="radio"/> Yes <input checked="" type="radio"/> No	Slide-in Range <input type="radio"/> Yes <input checked="" type="radio"/> No
Comment			

2. Flooring	Selection
Foyer	13x13" Keaton Ice
Main Hall	13x13" Keaton Ice
Back Hall	/
Breakfast	/
Laundry Room	13x13" Malena Ice
Kitchen	13x13" Keaton Ice
Powder Room	13x13" Keaton Ice
Main Bathroom	13x13" Malena Ice
Master Ensuite	13x13" Bellina Grey
Bathroom (If Applicable)	/
Mud Room	13x13" Keaton Ice
Master Ens. SH/FL	2x2" Ontario Snow White Matte
Living Room	/
Dining Room	(Dinette)13x13" Keaton Ice
Family / Great Room	3 1/2" Elements Oak Sturgeon
Den / Library / Study	/
Basement Landing (If Applies)	
Lower Landing (If Applicable)	3 1/2" Elements Oak Sturgeon
Upper Landing	3 1/2" Elements Oak Sturgeon
Upper Hall	*3 1/2" Elements Oak Sturgeon
Master Bedroom	Modern Story : 827 Perfect Neutral
Bedroom #2	Modern Story : 827 Perfect Neutral
Bedroom #3	Modern Story : 827 Perfect Neutral
Bedroom #4	/
Bedroom #5	/
Master Ens. SH/FL	Anatolia Marmiline SNOW



Purchaser: HARPREET KAUR SEKHON

Property: 261 BLOCK 194 of Plan - Draft Approval S

Telephone Res. / Bus: /

Project: KINGSMEN (THAMES) INC.

Decor Advisor: Barbara Coccia

Model and Elevation: Richard (2602) Elev B1 3 Bed - 2+1 Bath

2. Flooring - Continued -

Upgrade Underpad	Type STANDARD	Area Master Bedroom, Bedroom #2 and #3
Carpet on Stairs	Capped /	Runner - *Upgrade /
Comment	/	

3. Plumbing Fixtures / Faucets

Kitchen	STANDRAD	Second Ensuite	/	Powder Room	UPGRADE
Master Ensuite	STANDRAD			Other Room	/
Main Bathroom	STANDRAD	/	/		

Comment

NOTE: To supply and install the upg undermount kitchen sink, with the standard faucet. To supply and install the upgraded undermount sinks and faucets in the PWD ONLY. To supply and install the standard topmount sink and standard faucet in the Master and Main Bathroom.

4. Wall Tile

	Tile Selection	Listello	Insert	Insert Selection
Main Bathroom	8x10" Malena Ice	<input type="checkbox"/>	<input type="checkbox"/>	
Master Ensuite				
Tub Deck	13x13" Bellina Grey	<input type="checkbox"/>	<input type="checkbox"/>	
Tub Apron	13x13" Bellina Grey	<input type="checkbox"/>	<input type="checkbox"/>	
Tub Surround	13x13" Bellina Grey	<input type="checkbox"/>	<input type="checkbox"/>	
Shower Stall	8x10" Bellina Grey	<input type="checkbox"/>	<input type="checkbox"/>	
Second Ensuite	/	<input type="checkbox"/>	<input type="checkbox"/>	
	/	<input type="checkbox"/>	<input type="checkbox"/>	
	/	<input type="checkbox"/>	<input type="checkbox"/>	
Kitchen Backsplash	/	<input type="checkbox"/>	<input type="checkbox"/>	
Complete Backsplash	/	<input type="checkbox"/>	<input type="checkbox"/>	

Comment

NOTE: To supply and install the wall tiles in the Main and Master Ensuite on the 10" side horizontally stacked.

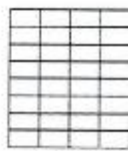

horizontal stacked

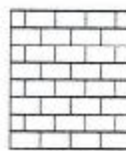

brick pattern



vertical stacked



diagonal/diamond

5. Fireplace

	Living Room			Family Room			Other Room - Specify/Greatroom		
	Purchased	As Per Plan	N/A	Purchased	As Per Plan	N/A	Purchased	As Per Plan	N/A
Fireplace Type	<input type="radio"/>	<input type="radio"/>	<input type="radio"/>	<input type="radio"/>	<input type="radio"/>	<input type="radio"/>	<input type="radio"/>	<input type="radio"/>	<input checked="" type="radio"/>
Mantle Type							Front Facing		
Over Mantle							NF-08		
Colour / Stain							/		
Surround							White		
Hearth							/		
Comment	/								

Initial: 

Page 2 of 3

Purchaser: HARPREET KAUR SEKHON

Property: 261 BLOCK 194 of Plan - Draft Approval S

Telephone Res. / Bus: /

Project: KINGSMEN (THAMES) INC.

Decor Advisor: Barbara Coccia

Model and Elevation: Richard (2602) Elev B1 3 Bed - 2+1 Bath

6. Trim Carpentry

Door Hardware Standard Handle

Interior Trim Standard

Comment

/

Interior Doors

☐ 2 Panel Arch Top

☒ 2 Panel Square Top

☐ 6 Panel



Initial for Door Style

HS

7. Railings and Pickets

Railing Package *UPG #1 Metal Package

Railing Colour *Elements Sturgeon

Picket Colour Black

Wood Stairs ☐ No ☒ Oak

Tread Colour *Elements Sturgeon

Comment

/

8. Plaster Mouldings and Medallions

Foyer / /

Main Hall / /

Living Room / /

Dining Room / /

Family Room / /

Kitchen/Breakfast / /

Den/Library / /

Lower Landing / /

/ /

Comment

/

9. Wall Paint

Kingsmen White

Smooth Ceilings

☐ First Floor

☐ First Floor incl. Second Floor Hall

☐ First and Second Floor

☒ Throughout

☐ Not Applicable

Trim Paint Kingsmen White

10. Additional Comments

/

11. Disclaimers and Notes

- Colours of all materials are as close as possible to builder's selection, but not necessarily identical due to variances in manufacturing.
- Any extras listed above are null and void unless accompanied by a separate invoice/amendment. Said invoice must be paid in full.
- The Purchaser acknowledges that after Interior Colour Selection form is signed and dated, no further changes will be permitted other than re-selection due to unavailability. HS Purchaser's Initials
- The Purchaser acknowledges reading and accepting the "Kingsmen Group Décor Centre Disclaimers" form. This document contains other miscellaneous disclaimers.

This Interior Colour Selection is final and approved by:

Purchaser:

Signature: Harpreet Sekhon Date: Jan. 28/2022

Vendor

KINGSMEN (THAMES) INC.

Jan 28/22

RECEIVED

JAN 28 2022

SCHEDULE "B-1" Floor Plan

Townhouse No. 261 BLOCK 194
Phase 5A
Model: Richard (2602) Elev B1 3 Bed - 2+1 Bath
Interior - Standard

SKETCH #1

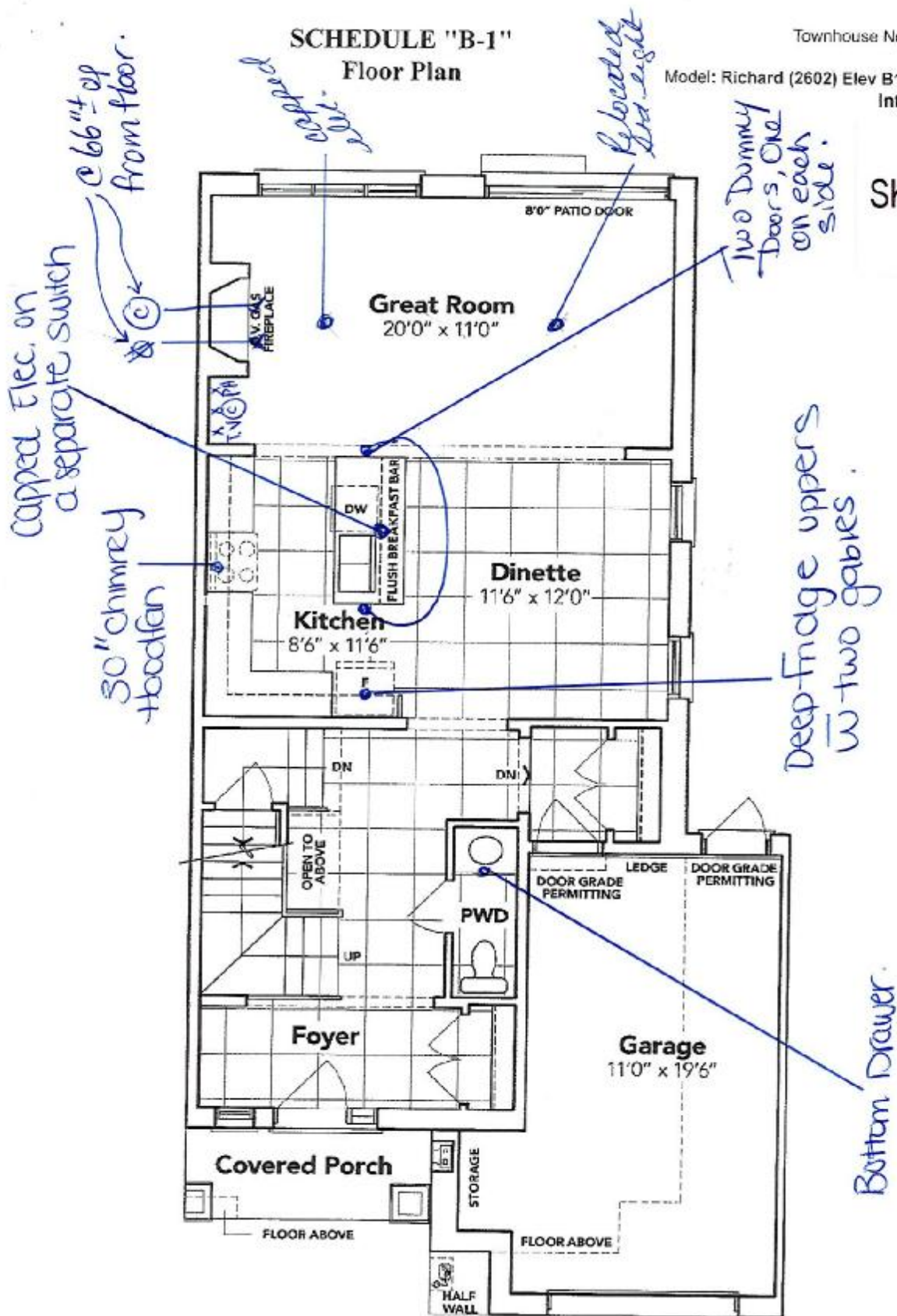

MAIN FLOOR EL. B1

Handwritten signature: Karsten Repler

The floor plans and elevations shown are pre-construction plans and may be revised or improved as necessitated by architectural controls and the construction process. The measurements adhere to the rules and regulations of the TARION Warranty Corporation's official method for the calculation of floor area. Materials, specifications and floor plans are subject to change without notice. All house renderings are artist's concept only. Actual usable floor space may vary from the stated floor area. All options shown are upgrades. E. & O. E.

SCHEDULE "B-1"
Floor Plan

Townhouse No. 261 BLOCK 194
Phase 5A
Model: Richard (2602) Elev B1 3 Bed - 2+1 Bath
Interior - Standard

SKETCH #2

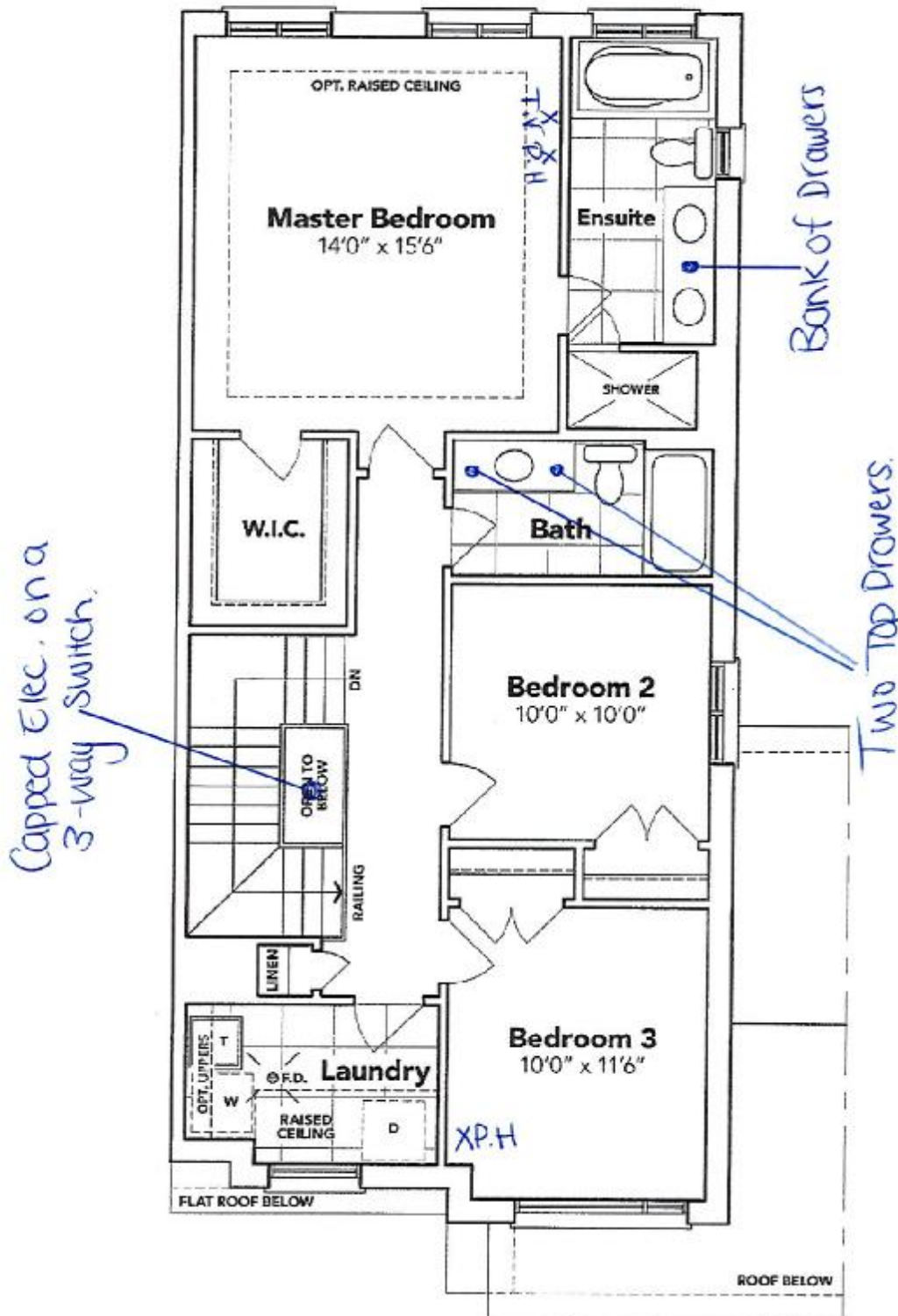

SECOND FLOOR EL. B1 + *Frankie Deppin*

The floor plans and elevations shown are pre-construction plans and may be revised or improved as necessitated by architectural controls and the construction process. The measurements adhere to the rules and regulations of the TARION Warranty Corporation's official method for the calculation of floor area. Materials, specifications and floor plans are subject to change without notice. All house renderings are artist's concept only. Actual usable floor space may vary from the stated floor area. All options shown are upgrades. E. & O. E.

SCHEDULE "B-1"
Floor Plan

Townhouse No. 261 BLOCK 194
Phase 5A
Model: Richard (2602) Elev B1 3 Bed - 2+1 Bath
Interior - Standard

SKETCH #3

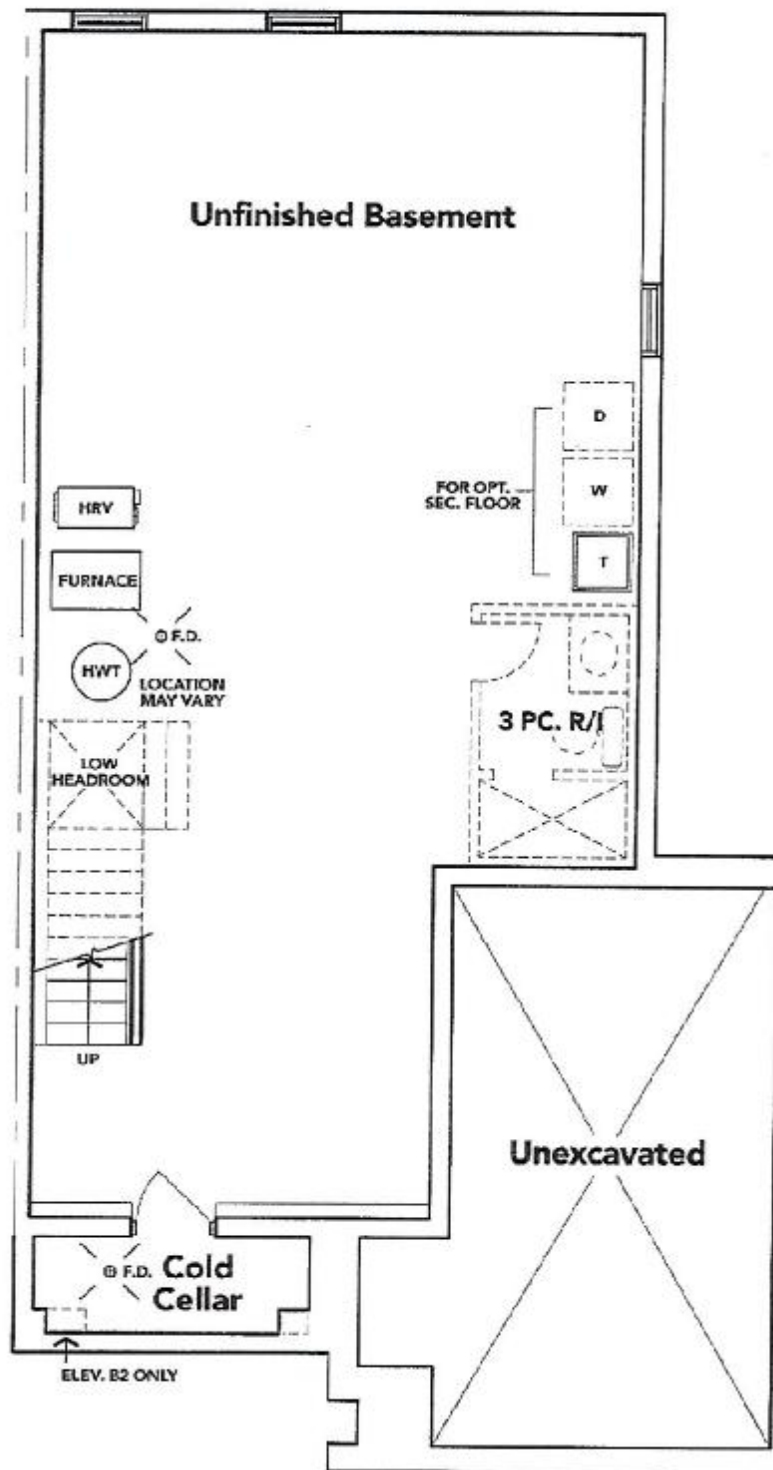

BASEMENT EL. B1

Handwritten signature: Haupt Reher

The floor plans and elevations shown are pre-construction plans and may be revised or improved as necessitated by architectural controls and the construction process. The measurements adhere to the rules and regulations of the TARION Warranty Corporation's official method for the calculation of floor area. Materials, specifications and floor plans are subject to change without notice. All house renderings are artist's concept only. Actual usable floor space may vary from the stated floor area. All options shown are upgrades. E. & O. E.

SCHEDULE "B-1" - Page 1 of 3

THAMES 5A: LOT 261 (BLK 194)
RE: 30" CHIMNEY HOODFAN

Specifications

Air Flow Volume: 650 CFM
Electrical Connection: 120V/60Hz
Power Consumption: 240 Watts
Current: 2.0 Amps
Fan Speed: 1599 RPM
Finishes: Stainless Steel
Duct: 6" Round
Knock-out: 6" Round - Top Only
Dimensions: Width: 30"/36"
Height: 44 1/2"
Depth: 19 3/4"
Noise Level: Min. 2 Sones
Max. 7 Sones



SCB722 - Baffle Filter



Ordering Model Chart

Model	Colour	Knock-out	Duct	Size	Filter	CFM
SCB72230	Stainless Steel	6"	6" Round	30"	Baffle	650
SCB72236	Stainless Steel	6"	6" Round	36"	Baffle	650

Notes

+ Hard Deck



THAMES 5A: LOT 261 (BLK 194)
RE: UPG KITCHEN SINK

BLANCO

Sink Specifications

Colour	SKU
brushed finish	401247

QUATRUS U 2

Design and planning tips

- Min cabinet size: 36 in (915 mm)
- Bowl Depth: 9 in (230.0 mm)

Specifications:

Installation clips, Sink template, Installation instructions, 3
1/2" (90 mm) stainless steel strainers

Depending on cabinet construction, a different cabinet
size may be required. Consult the cabinet manufacturer.

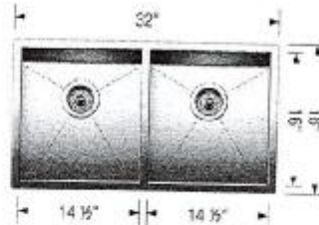

+ H. H. H. H. H.

THAMES 5A: LOT 261 (BLK 194)
RE: UPG *PWD. SINK*

CATENA
RECTANGULAR UNDERMOUNT SINK

4210CIY Undermount Sink

PRODUCT SPECS:

- Vitreous china
- Front overflow hole
- Template and mounting hardware supplied

DIMENSIONS:

Outer:

510mm W x 390mm D x 190mm H
20" W x 15 1/2" D x 7 1/2" H

Inner:

450mm W x 340mm D x 140mm H
18" W x 13 1/4" D x 5 1/2" H

COMPLIANCE CERTIFICATIONS

Meets or exceeds the following:

- IAPMO CUPC
- ASME A112.19.2 / CSA B451
- OBC Section 3.8 Barrier Free design and CSA B651 Standard

SHIPPING

Cube 1.32
GW 27 lbs

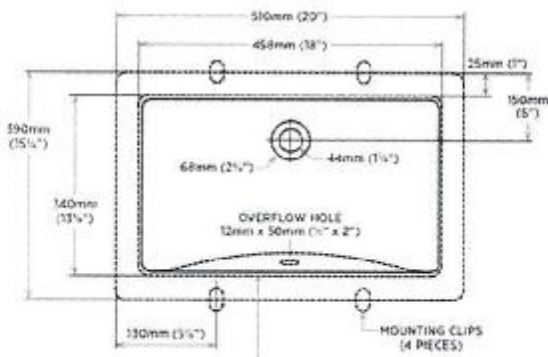

TO BE SPECIFIED

Colour
■ Soft White

NOTES: Dimensions of fixtures are nominal and may vary within the range of tolerances established by ASME standard B19.1. These measurements are subject to change or cancellation. No responsibility is assumed for use of reproduced or copied pages. Products are designed to comply with CSA B65 Standard and OBC barrier-free requirements. It shall be the responsibility of the installer to comply with the local building codes and standards prior to installing the product.

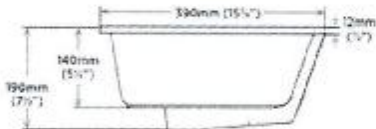

CONTRAC CATENA MODEL 4210CIY UNDERMOUNT SINK

x Harshit Lekhan

THAMES 5A: LOT 261 (BLK 194)
RE: UPG PWD FAUCET

Vichy™

Traditional | Transitional | Modern

*With its cylindrical shapes, contoured edges and slim handle,
Vichy gives modern style a soft touch.*

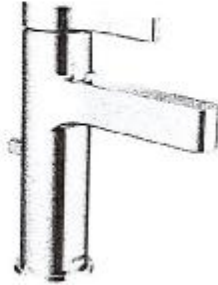

**Single Handle Lav Faucet
with Lift Rod Drain**

Model 6710

8 Haupt Lephan