

KINGSMEN (THAMES) INC. / Havelock Corners (Kingsmen)

**Lot/Unit: 258 BLOCK 193 Phase/Building: 5A Model/Floor Plan: William (2603) Elev B2 4
Bed - 2+1 Bath**

CARPET

Inv.5255	1 - To supply & install the upgraded carpet in the master bedroom, bedroom #2, #3 & # 4 in lieu of the standard carpet... see colour chart for details.	
Line 68743	Note:	
4Jan22 / 20Jan22		

COUNTER TOP - VANITY

Inv.5255	1 - To supply & install the COUNTER TOP - VANITY - POWDER ROOM - 2CM COUNTER TOP - UPGRADE LEVEL 1 in lieu of the standard laminate countertop.	
Line 68740	Note:	
4Jan22 / 20Jan22		

ELECTRICAL

Inv.5255	1 - To supply & install the standard T.V. rough in in the great room and master bedroom... see sketch # 1 & # 2	
Line 68731	Note:	
4Jan22 / 20Jan22		
Inv.5255	1 - To supply & install the standard Phone (CAT 5) rough in in the great room, master bedroom & bedroom# 3... see sketch #1 & # 2	
Line 68732	Note:	
4Jan22 / 20Jan22		
Inv.5255	1 - To SUPPLY AND INSTALL A CAPPED CEILING LIGHT BOX, WITH 3 WAY SWITCH in the open to below area on the seconf floor... see sketch # 2	
Line 68733	Note:	
4Jan22 / 20Jan22		

HARDWOOD

Inv.5255	1 - To supply & install the 3 1/2" Elements oak natural in the upper hallway in lieu of the stanard carpet... see colour chart for details.	
Line 68742	Note:	
4Jan22 / 20Jan22		

HEATING AND AIR CONDITIONING

Inv.5255	1 - As per schedule "PE": Vendor to install capped gas line (rough in only) at rear of home for future BBQ location. Location to be finalized at vendors sole discretion.	
Line 68691	Note:	
4Jan22 / 20Jan22		
Inv.5255	1 - As per schedule "PE": Vendor to supply & install air conditioning unit, sized accordingly, from vendors standard samples.	
Line 68692	Note:	
4Jan22 / 20Jan22		

MISCELLANEOUS

PLUMBING

KINGSMEN (THAMES) INC. / Havelock Corners (Kingsmen)

Lot/Unit: 258 BLOCK 193 Phase/Building: 5A Model/Floor Plan: William (2603) Elev B2 4
Bed - 2+1 Bath

Inv.5255	1 - To supply & install the VANITY SINK - CONTRAC CATENA UNDERMOUNT - MODEL 4210CIY in the powder room ... in lieu of the standard sink.	
Line 68741	Note:	
4Jan22 / 20Jan22		
Inv.5255	1 - To supply & install the KITCHEN SINK - BLANCO QUATRUS U2 DBL UNDERMOUNT MODEL 401247 in lieu of the standard kitchen sink... see spec's	
Line 68734	Note: Still to intall the standard single hole kitchen faucet " NO PLATE "	
4Jan22 / 20Jan22		
Inv.5255	1 - To supply & install the KITCHEN SOAP DISPENCER - MOEN CHROME - MODEL 3942 in the kitchen... see sketch #1 ... see spec's.	
Line 68735	Note:	
4Jan22 / 20Jan22		

TILE - FLOOR

Inv.5255	1 - To supply & install the UPGRADE 4 - FLOOR TILE - STACKED - FOYER TILE in lieu of the standard floor tiles.	
Line 68736	Note:	
4Jan22 / 20Jan22		
Inv.5255	1 - To supply & install the UPGRADE 4 - FLOOR TILE - STACKED - KITCHEN/BREAKFAST TILE in lieu of the standard floor tiles.	
Line 68737	Note:	
4Jan22 / 20Jan22		
Inv.5255	1 - To supply & install the UPGRADE 4 - FLOOR TILE - STACKED - POWDER ROOM TILE in lieu of the standard floor tiles.	
Line 68738	Note:	
4Jan22 / 20Jan22		
Inv.5255	1 - To supply & install the UPGRADE 4 - FLOOR TILE - STACKED - MUD ROOM TILE in lieu of the standard floor tiles.	
Line 68739	Note:	
4Jan22 / 20Jan22		

EXTRAS AS PER OFFER

CAPPING

REFERAL

UPGRADES

5 FREE APPLIANCES–STAINLESS STEEL FRONT-FRIDGE; STOVE AND DISHWASHER. WHITE WASHER-DRYER (SUPPLIED ONLY, NOT INSTALLED,FROM BUILDERS STANDARD LINE). AN APPLIANCES VOUCHER WILL BE GIVEN BY OUR DECOR CONSULTANT AT THE TIME OF BOOKING YOUR COLOUR APPTMENT. <i>Worksheet</i> Note:	
VENDOR TO INSTALL CAPPED GAS LINE (ROUGH-IN ONLY) AT REAR OF HOME FOR FUTURE BBQ LOCATION. LOCATION TO BE FINALIZED AT VENDORS SOLE DISCRETION. <i>Worksheet</i> Note:	
VENDOR TO SUPPLY & INSTALL AIR CONDITIONING UNIT, SIZED ACCORDINGLY, FROM VENDORS STANDARD SAMPLES. <i>Worksheet</i> Note:	

KINGSMEN (THAMES) INC. / Havelock Corners (Kingsmen)

**Lot/Unit: 258 BLOCK 193 Phase/Building: 5A Model/Floor Plan: William (2603) Elev B2 4
Bed - 2+1 Bath**

Purchasers: HARDEV SINGH & BALVINDER SINGH SANDH **Property:** 258 BLOCK 193 of Plan - Draft Approval S
Telephone Res. / Bus: (416) 875-0865 / **Project:** KINGSMEN (THAMES) INC.
Decor Advisor: Barbara Coccia **Model and Elevation:** William (2603) Elev B2 4 Bed - 2+1 Bath
Layout Changes: ☐ Yes ☒ No **Sketch Attached:** ☒ Yes ☐ No **Exterior Colour Scheme:** _____

1. Cabinetry

	Style and Colour	Counter Top	Hardware
Kitchen / Breakfast	#3 Simcoe Orchid	#1, C/S # 3040 Cement 3cm.	135 Knob
Kitchen Island	#3 Simcoe Orchid	#1, C/S # 3040 Cement 3cm.	135 Knob
Laundry Room	/		
Powder Room	#3 Simcoe Moonlight	#1, C/S # 9141 Ice Snow 2cm.	135 Knob
Main Bathroom	#3 Simcoe Orchid	Inukshuk Carbon P-346-LM	135 Knob
Master Ensuite Bathroom	#3 Simcoe Orchid	Inukshuk Grey P-344-LM	135 Knob
Second Ensuite Bathroom (If Applicable)	/		
	/		
	/		

Appliances

Custom Size Fridge

☐ Yes ☒ No

Valance Lighting

☐ Yes ☒ No

Microwave / Range Hood

☐ Yes ☒ No

Cooktop / Rangetop

☐ Yes ☒ No

Built in Wall Oven

☐ Yes ☒ No

Slide-in Range

☐ Yes ☒ No

Comment

/

2. Flooring

Selection

Foyer	**Upg.4, 24 x24" Mayfair Clacatta ORO HD polished Rect. Porcelain Tile Stacked
Main Hall	3 1/2" Elements Oak Natural
Back Hall	(infront of powder room)**Upg.4, 24 x24" Mayfair Clacatta ORO HD polished Rect. Porcelain STACKED
Breakfast	**Upg.4, 24 x24" Mayfair Clacatta ORO HD polished Rect. Porcelain Tile Stacked
Laundry Room	13x13" Keaton Ice
Kitchen	**Upg.4, 24 x24" Mayfair Clacatta ORO HD polished Rect. Porcelain Tile Stacked
Powder Room	**Upg.4, 24 x24" Mayfair Clacatta ORO HD polished Rect. Porcelain Tile Stacked
Main Bathroom	13 x13" Keaton Carbon
Master Ensuite	13 x13" Keaton Ice
Bathroom (If Applicable)	/
Mud Room	**Upg.4, 24 x24" Mayfair Clacatta ORO HD polished Rect. Porcelain Tile Stacked
Master ens. shower floor	2x2" Ontario Snow White Matte
Living Room	/
Dining Room	3 1/2" Elements Oak Natural
Family / Great Room	3 1/2" Elements Oak Natural
Den / Library / Study	/
Basement Landing (If Applies)	
Lower Landing (If Applicable)	3 1/2" Elements Oak Natural
Upper Landing	3 1/2" Elements Oak Natural
Upper Hall	**3 1/2" Elements Oak Natural
Master Bedroom	**Escape to Maui: 14722 Macrame
Bedroom #2	**Escape to Maui: 14722 Macrame
Bedroom #3	**Escape to Maui: 14722 Macrame
Bedroom #4	**Escape to Maui: 14722 Macrame
Bedroom #5	/
Master Ens, shower jamb	Anatolia Marmiline SNOW

SEE ATTACHED FOR SIGNATURES



Flooring Continued on Page 2

Initial: _____

Page 1 of 3

Purchasers: HARDEV SINGH & BALVINDER SINGH SANDH. **Property:** 258 BLOCK 193 of Plan - Draft Approval S
Telephone Res. / Bus: (416) 875-0865 / **Project:** KINGSMEN (THAMES) INC.
Decor Advisor: Barbara Coccia **Model and Elevation:** William (2603) Elev B2 4 Bed - 2+1 Bath

2. Flooring - Continued -

Upgrade Underpad	Type	Area
	Standard	Master Bedroom, Bedroom #2 #3 & #4
Carpet on Stairs	Capped	Runner - *Upgrade
Comment	/	/

3. Plumbing Fixtures / Faucets

Kitchen	Standard	Second Ensuite	/	Powder Room	Standard
Master Ensuite	Standard			Other Room	/
Main Bathroom	Standard		/		

Comment

The kitchen sink has been upgraded to undermount, still to install the std. single hole kitchen faucet "NO PLATE". Powder room sink has been upgraded to undermount, still to install the std. lav faucet. To supply & install the standard top mount sinks in the master ensuite and main bathroom, still to install the std. lav. faucets.

4. Wall Tile

	Tile Selection	Listello	Insert	Insert Selection
Main Bathroom	8 x 10" Keaton Ice	<input type="checkbox"/>	<input type="checkbox"/>	
Master Ensuite				
Tub Deck	13 x 13" Keton Ice	<input type="checkbox"/>	<input type="checkbox"/>	
Tub Apron	13 x 13" Keton Ice	<input type="checkbox"/>	<input type="checkbox"/>	
Tub Surround	13 x 13" Keton Ice	<input type="checkbox"/>	<input type="checkbox"/>	
Shower Stall	8 x 10" Keaton Carbon	<input type="checkbox"/>	<input type="checkbox"/>	
Second Ensuite	/	<input type="checkbox"/>	<input type="checkbox"/>	
	/	<input type="checkbox"/>	<input type="checkbox"/>	
	/	<input type="checkbox"/>	<input type="checkbox"/>	
Kitchen Backsplash	/	<input type="checkbox"/>	<input type="checkbox"/>	
Complete Backsplash	/	<input type="checkbox"/>	<input type="checkbox"/>	

Comment

To install the standard 8 x 10" wall tiles on the 10" side stacked horizontally in the main and master ensuite where applicable.

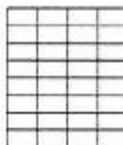

horizontal stacked



brick pattern



vertical stacked



diagonal/diamond

5. Fireplace

Living Room

Purchased ☐ As Per Plan ☐ N/A ☒

Family Room

Purchased ☐ As Per Plan ☐ N/A ☒

Other Room - Specify Great Room

Purchased ☐ As Per Plan ☒ N/A ☐

Fireplace Type

Mantle Type

Over Mantle

Colour / Stain

Surround

Hearth

Comment

Front Facing

NF-08

/

White

/

/

SEE ATTACHED FOR SIGNATURES

Initial:

Initial:

Page 2 of 3

Purchasers: HARDEV SINGH & BALVINDER SINGH SANDH. **Property:** 258 BLOCK 193 of Plan - Draft Approval S
Telephone Res. / Bus: (416) 875-0865 / **Project:** KINGSMEN (THAMES) INC.
Decor Advisor: Barbara Coccia **Model and Elevation:** William (2603) Elev B2 4 Bed - 2+1 Bath

6. Trim Carpentry

Door Hardware Standard Handle

Interior Trim standard

Comment

Interior Doors

- ☐ 2 Panel Arch Top
☒ 2 Panel Square Top
☐ 6 Panel

Initial for Door Style

7. Railings and Pickets

Railing Package Standard Oak STRAIGHT Picket package

Railing Colour Elements Natural

Picket Colour Elements Natural

Wood Stairs ☐ No ☒ Oak

Tread Colour Elements Natural

Comment

8. Plaster Mouldings and Medallions

Foyer	/		Kitchen/Breakfast	/	
Main Hall	/		Den/Library	/	
Living Room	/		Lower Landing	/	
Dining Room	/			/	
Family Room	/			/	

Comment

9. Wall Paint

Kingsmen White

- Smooth Ceilings** ☐ First Floor
☐ First Floor incl. Second Floor Hall
☐ First and Second Floor
☒ Throughout
☐ Not Applicable

Trim Paint Kingsmen White

10. Additional Comments

11. Disclaimers and Notes

- Colours of all materials are as close as possible to builder's selection, but not necessarily identical due to variances in manufacturing.
- Any extras listed above are null and void unless accompanied by a separate invoice/amendment. Said invoice must be paid in full.
- The Purchaser acknowledges that after Interior Colour Selection form is signed and dated, no further changes will be permitted other than re-selection due to unavailability. Purchaser's Initials
- The Purchaser acknowledges reading and accepting the "Kingsmen Group Décor Centre Disclaimers" form. This document contains other miscellaneous disclaimers.

This Interior Colour Selection is final and approved by:

Purchaser: SEE ATTACHED FOR SIGNATURES
Signature:  **Date:** _____

Signature:  **Date:** _____

Vendor: 
KINGSMEN (THAMES) INC.

RECEIVED

JAN 24 2022

Jan 24, 22 Page 3 of 3

SCHEDULE "B-1"
Floor Plan

Townhouse No. 258 BLOCK 193
Phase 5A
Model: William (2603) Elev B2 4 Bed - 2+1 Bath
End - Standard

Sketch #1

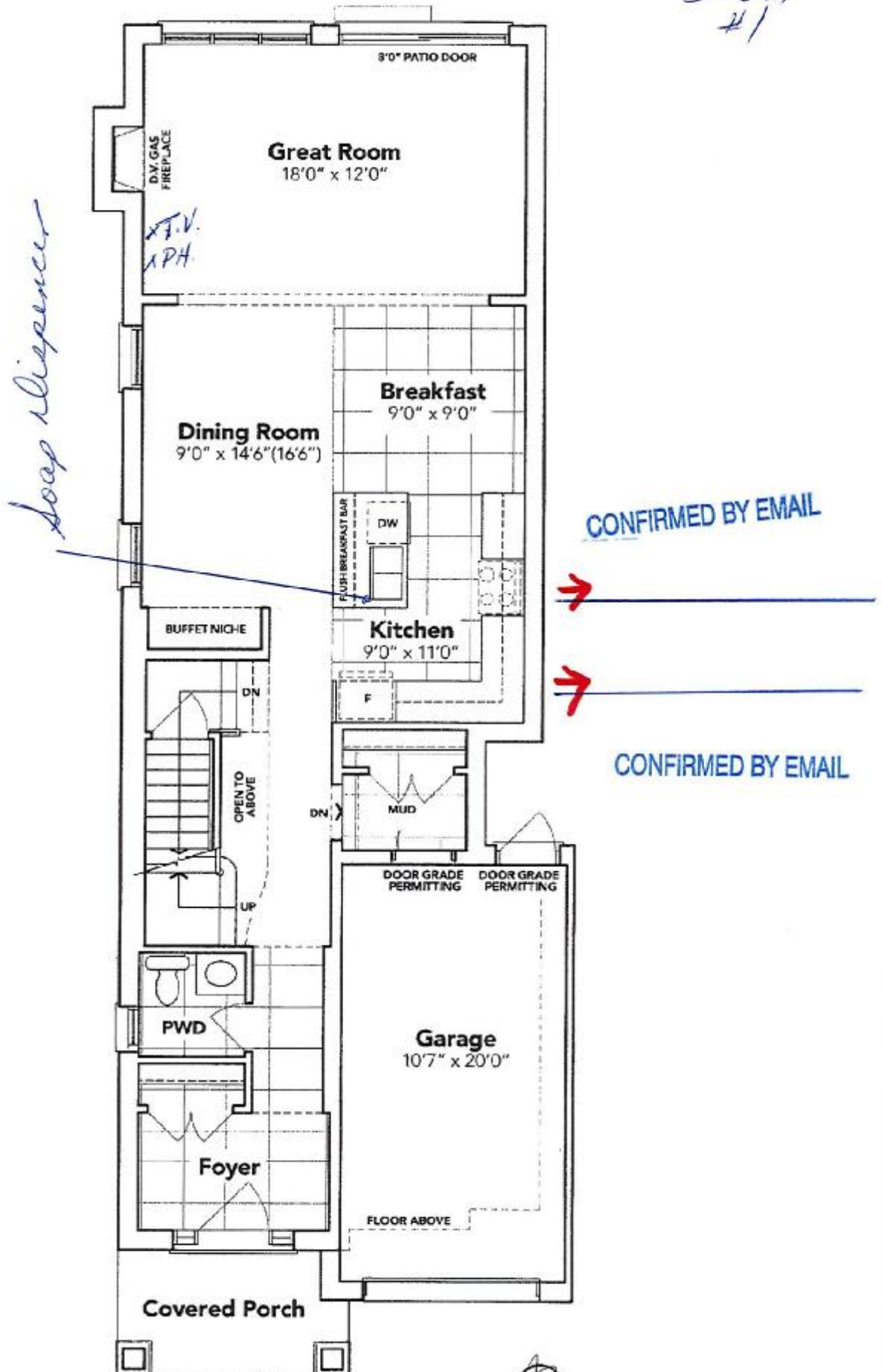

MAIN FLOOR EL. B2A

The floor plans and elevations shown are pre-construction plans and may be revised or improved as necessitated by architectural controls and the construction process. The measurements adhere to the rules and regulations of the TARIION Warranty Corporation's official method for the calculation of floor area. Materials, specifications and floor plans are subject to change without notice. All house renderings are artist's concept only. Actual usable floor space may vary from the stated floor area. All options shown are upgrades. E. & O. E.

Floor Plan

Phase 5A

Model: William (2603) Elev B2 4 Bed - 2+1 Bath
End - Standard

Sketch #2

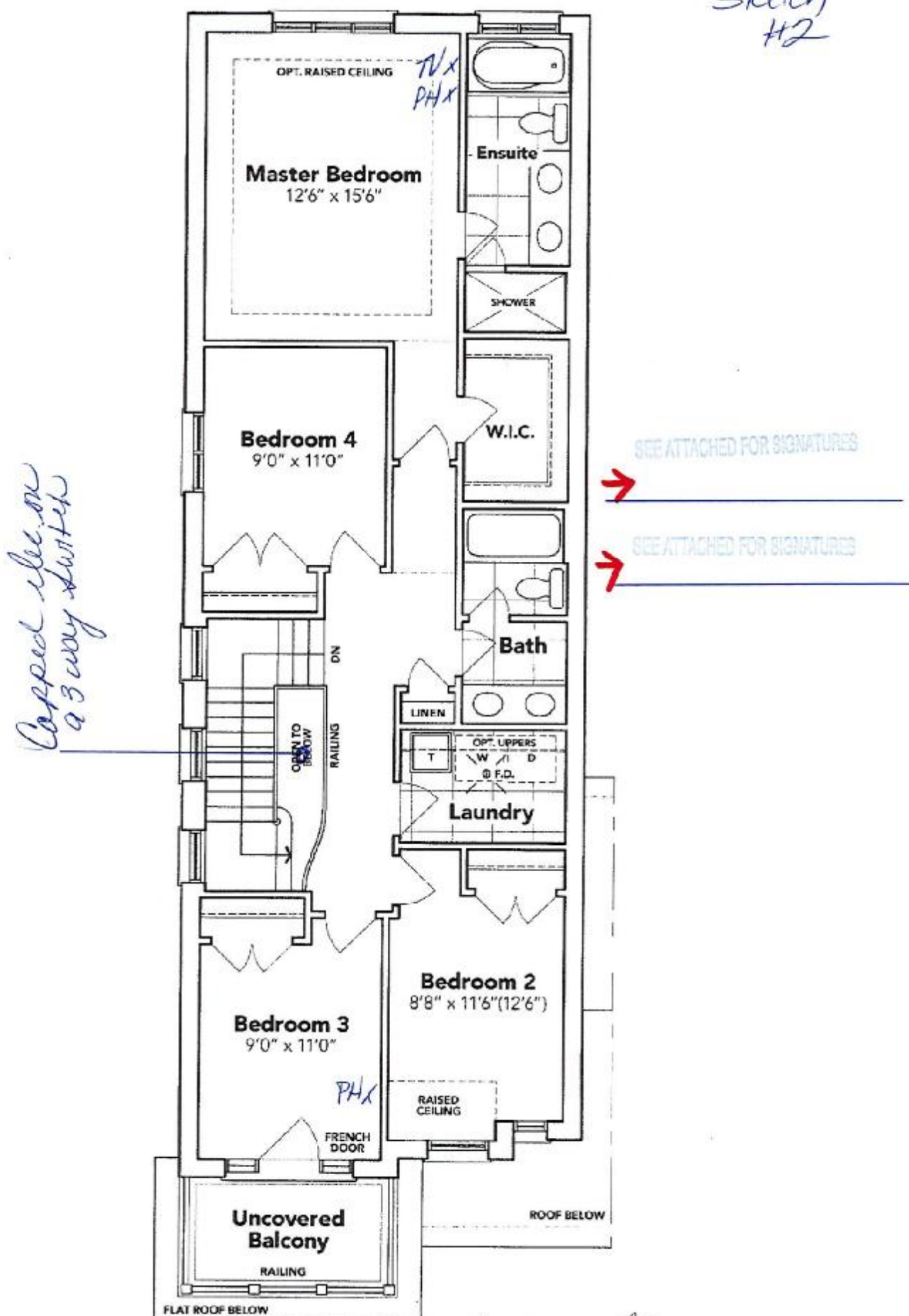

SECOND FLOOR EL. B2A

The floor plans and elevations shown are pre-construction plans and may be revised or improved as necessitated by architectural controls and the construction process. The measurements adhere to the rules and regulations of the TARIION Warranty Corporation's official method for the calculation of floor area. Materials, specifications and floor plans are subject to change without notice. All house renderings are artist's concept only. Actual usable floor space may vary from the stated floor area. All options shown are upgrades. E. & O. E.

SCHEDULE "B-1"
Floor Plan

Townhouse No. 258 BLOCK 193
Phase 5A
Model: William (2603) Elev B2 4 Bed - 2+1 Bath
End - Standard

*sketch
#3*

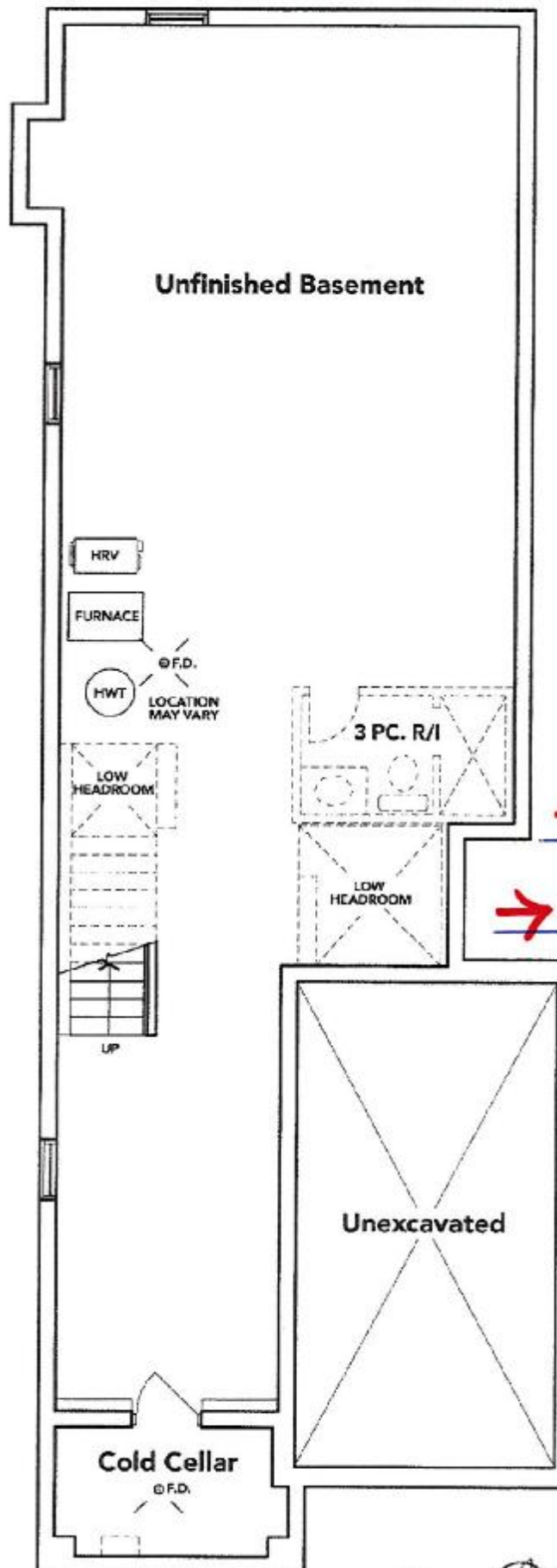

BASEMENT EL. B2A

The floor plans and elevations shown are pre-construction plans and may be revised or improved as necessitated by architectural controls and the construction process. The measurements adhere to the rules and regulations of the TARIION Warranty Corporation's official method for the calculation of floor area. Materials, specifications and floor plans are subject to change without notice. All house renderings are artist's concept only. Actual usable floor space may vary from the stated floor area. All options shown are upgrades. E. & O. E.

SCHEDULE "B-1" - Page 1 of 3

(Handwritten initials and signatures)



LOT: 258 THAMES PH. 5 A

RE: UNDER MOUNT SINK FOR KITCHEN

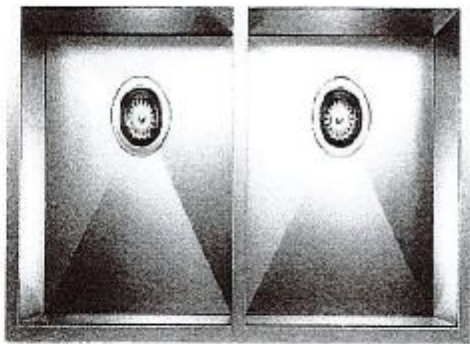

QUATRUS U 2

- German engineered with 304 series 18-gauge stainless steel
- Zinc-nickel coating: 1000000 corrosion protection
- Double bowl configuration for easy multi-tasking
- 18/10 chrome-plated overflow for exceptional looks, durability and strength
- Undermount installation
- Minimum cabinet size: 36"

Model #401247



SEE ATTACHED FOR SIGNATURES



SEE ATTACHED FOR SIGNATURES

BLANCO



LOT: 258 THAMES PH. 5 A

RE: UNDER MOUNT SINK FOR POWDER
ROOM

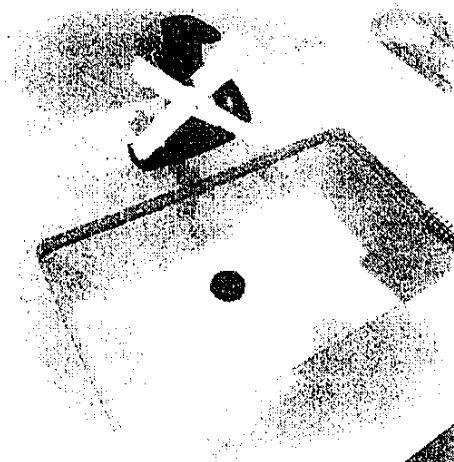
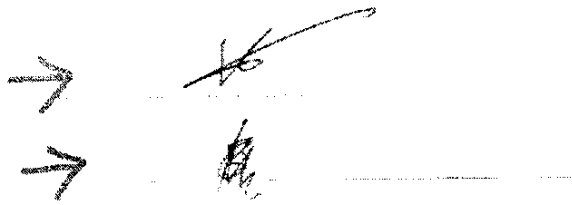

DISPLAY ITEMS

Sink (Item 9)
Contrac Catena Undermount
Model 4210CIY



LOT: 258 THAMES PH. 5 A

RE: SOAP DISPENSER FOR KITCHEN



SEE ATTACHED FOR SIGNATURES



SEE ATTACHED FOR SIGNATURES



Transitional Soap or
Lotion Dispenser

Model 3942

KINGSIIEN
GROUP INC.

LOT: 258 THAMES PH. 5 A

RE: UNDER MOUNT SINK FOR POWDER
ROOM

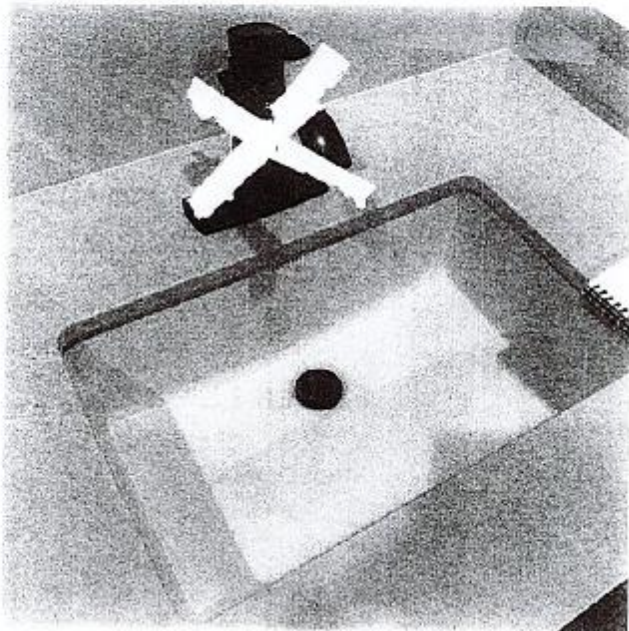

DISPLAY ITEMS

Sink (Item 9)

Contrac Catena Undermount
Model 4210CIY



LOT: 258 THAMES PH. 5 A
RE: UNDER MOUNT SINK FOR KITCHEN

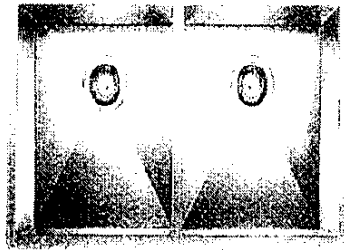

QUATRUS U 2

Quattrus U 2 is a high quality undermount sink made of stainless steel.
It is made of 16 gauge stainless steel and is available in two finishes:
Brushed stainless steel and polished stainless steel.
It is available in two sizes: 30 inch and 33 inch.
It is available in two colors: stainless steel and brushed stainless steel.
It is available in two finishes: brushed stainless steel and polished stainless steel.

Model R401247

→

→

QUATRUS U 2