

KINGSMEN (THAMES) INC. / Havelock Corners (Kingsmen)

**Lot/Unit: 199 BLOCK 182 Phase/Building: 5A Model/Floor Plan: George (2603) Elev B1 4
Bed - 2+1 Bath**

CABINETRY HOOD FANS

Inv.5185	1 - To ACCOMMODATE FOR MICROWAVE HOOD FAN COMBO - PURCHASER MUST SUPPLY SPECS - CLASSIC SERIES... still to install the standard stainless steel hood fan.	
Line 68095	Note: NO O.T.R. HAS BEEN PURCHASED	
19Nov21 / 9Dec21		

ELECTRICAL

Inv.5185	1 - To SUPPLY AND INSTALL AN ADDITIONAL BASIC RECEPTACLE (DEDICATED CIRCUIT AND INCLUDES ARC FAULT BREAKER) for the future O.T.R above the stove in the	
Line 68096	Note: Kitchen.. still to install the standard stainless steel hood fan	
19Nov21 / 9Dec21 NO O.T.R. HAS BEEN PURCHASED		
Inv.5185	1 - To supply & install the std. T.V. rough in in the great room and master bedroom... see sketch # 1 & # 2	
Line 68078	Note:	
19Nov21 / 9Dec21		
Inv.5185	1 - To supply & install the standard Phone (CAT 5) rough in in the great room, master bedroom and bedroom # 3.. see sketvh # 1 & # 2	
Line 68079	Note:	
19Nov21 / 9Dec21		
Inv.5185	1 - To SUPPLY AND INSTALL CONDUIT FOR TV OVER THE FIREPLACE –at approx. 66" + - up from the the floor and TERMINATED next to + - the stadnard T.V. and Phone (CAT 5) rough in the great room...see skech # 1	
Line 68081	Note:	
19Nov21 / 9Dec21		
Inv.5185	1 - To SUPPLY AND INSTALL AN ADDITIONAL BASIC RECEPTACLE (NOT DEDICATED) at approx. 66" + - up from the floor centered + - to the F/P mantle in the great	
Line 68082	Note: room... see sketch # 1	
19Nov21 / 9Dec21		
Inv.5185	1 - Relocate the standard ceiling light in the kitchen over to the breakfast bar area... see sketch # 1	
Line 68083	Note:	
19Nov21 / 9Dec21		
Inv.5185	1 - To supply & install FOUR LED pot lights in the kitchen on a sep. switch... see sketch # 1	
Line 68084	Note:	
19Nov21 / 9Dec21		
Inv.5185	1 - To supply & install FOUR LED pot lights in the dining room on a sep. switch... see sketch # 1	
Line 68085	Note: STILL TO INSTALL THE STANDARD CEILING LIGHT IN THE DINING ROOM, ON ITS OWN SWITCH.	
19Nov21 / 9Dec21		
Inv.5185	1 - To supply & install SIX LED pot lights in the great room, have these pot lights connected to the standard switch... see sketch # 1	
Line 68086	Note: DO NOT SUPPLY OR INSTALL THE STANDARD LIGHT IN THE GREAT ROOM, LEAVE THE SWITCH, HAVE SWITCH CONNECTED TO THE UPGRADED SIX POT LIGHTS.	
19Nov21 / 9Dec21		

KINGSMEN (THAMES) INC. / Havelock Corners (Kingsmen)

Lot/Unit: 199 BLOCK 182 Phase/Building: 5A Model/Floor Plan: George (2603) Elev B1 4
 Bed - 2+1 Bath

Inv.5185	1 - To SUPPLY AND INSTALL A CAPPED CEILING LIGHT BOX, WITH 3 WAY SWITCH at the O.T.B area on the second floor ... see sketch # 2	
Line 68087	Note:	
19Nov21 / 9Dec21		
Inv.5185	1 - To supply & install FIVE LED pot lights to the upper hallway area, have these pot lights connected to the standard switch... see sketch # 2	
Line 68088	Note: DO NOT SUPPLY OR INSTALL ANY UPPER HALLWAY LIGHTS, LEAVE THE STANDARD SWITCH, HAVE SWITCH CONNECTED TO THE UPGRADED POT LIGHTS.	
19Nov21 / 9Dec21		

HARDWOOD

Inv.5185	1 - To supply & install the 3 1/2" Elements Oak Natural to the upper hallway in lieu of the standard carpet...	
Line 68092	Note:	
19Nov21 / 9Dec21		

HEATING AND AIR CONDITIONING

Inv.5185	1 - As per schedule "PE": Vendor to install capped gas line (Rough in only) at rear of home for future BBQ location. Location to be finalized at Vendors sole discretion.	
Line 68073	Note:	
19Nov21 / 9Dec21		
Inv.5185	1 - As per schedule "PE": Vendor to supply & install air conditioning unit, sized accordingly, from vendors standard samples.	
Line 68074	Note:	
19Nov21 / 9Dec21		

MISCELLANEOUS

Inv.5185	1 - Purchaser has selected their upgrades and interior finishes via ZOOM "virutal" MEETING link on Nov. 19, 2021.	
Line 68097	Note:	
19Nov21 / 9Dec21		

PLUMBING

Inv.5185	1 - To supply & install the KITCHEN SINK - BLANCO QUATRUS U2 DBL UNDERMOUNT - MODEL 401247 in the kitchen in lieu of the standard top mount kitchen sink... see spec's	
Line 68091	Note: STILL TO INSTALL THE STD. SINGLE HOLE KITCHEN FAUCET, NO PLATE.	
19Nov21 / 9Dec21		

TILE - WALL

Inv.5185	1 - To supply & install the UPGRADE 1 - BACKSPLASH TILE - - KITCHEN SPLASH TILE in a 70/30 off set Horizontal pattern... see colour chart for details... see sketch # 1	
Line 68093	Note:	
19Nov21 / 9Dec21		



CONSTRUCTION SUMMARY

KINGSMEN (THAMES) INC. / Havelock Corners (Kingsmen)

Lot/Unit: 199 BLOCK 182 Phase/Building: 5A Model/Floor Plan: George (2603) Elev B1 4
Bed - 2+1 Bath

EXTRAS AS PER OFFER

5 FREE APPLIANCES – STAINLESS STEEL FRONT - FRIDGE: STOVE AND DISHWASHER. WHITE WASHER AND DRYER (SUPPLIED ONLY, NOT INSTALLED, FROM BUILDERS STANDARD LINE). AN APPLIANCES VOUCHER WILL BE GIVEN BY OUR DECOR CONSULTANT AT THE TIME OF BOOKING YOUR COLOUR A <i>Worksheet</i> Note:	
VENDOR TO INSTALL CAPPED GAS LINE (ROUGH-IN ONLY) AT REAR OF HOME FOR FUTURE BBQ LOCATION. LOCATION TO BE FINALIZED AT VENDORS SOLE DISCRETION. <i>Worksheet</i> Note:	
VENDOR TO SUPPLY & INSTALL AIR CONDITIONING UNIT, SIZED ACCORDINGLY, FROM VENDORS STANDARD SAMPLES. <i>Worksheet</i> Note:	



Purchasers: EMMANUEL OWUSU & JACLYN MARIE OWUS Property: 199 BLOCK 182 of Plan - Draft Approval S
Telephone Res. / Bus: / Project: KINGSMEN (THAMES) INC.
Decor Advisor: Barbara Coccia Model and Elevation: George (2603) Elev B1 4 Bed - 2+1 Bath
Layout Changes: ☐ Yes ☒ No Sketch Attached: ☒ Yes ☐ No Exterior Colour Scheme:

1. Cabinetry	Style and Colour	Counter Top	Hardware
Kitchen / Breakfast	#3 Simcoe Orchid	#1, C/S # 9141 Ice Snow 3cm.	#12881 Handle
Kitchen Island	#3 Simcoe Orchid	#1, C/S # 9141 Ice Snow 3cm.	#12881 Handle
Laundry Room	/		
Powder Room	#3 Simcoe Orchid	Calcatta Marble 4925K-07	#12881 Handle
Main Bathroom	#3 Simcoe Orchid	Calcatta Marble 4925K-07	#12881 Handle
Master Ensuite Bathroom	#3 Simcoe Orchid	Calcatta Marble 4925K-07	#12881 Handle
Second Ensuite Bathroom (If Applicable)	/		
	/		
	/		

Appliances	Custom Size Fridge <input type="radio"/> Yes <input checked="" type="radio"/> No	Valance Lighting <input type="radio"/> Yes <input checked="" type="radio"/> No	Microwave / Range Hood <input checked="" type="radio"/> Yes <input type="radio"/> No
	Cooktop / Rangetop <input type="radio"/> Yes <input checked="" type="radio"/> No	Built in Wall Oven <input type="radio"/> Yes <input checked="" type="radio"/> No	Slide-in Range <input type="radio"/> Yes <input checked="" type="radio"/> No
Comment	<input type="text"/>		

2. Flooring	Selection
Foyer	13 x13" Keaton Ice
Main Hall	3 1/2" Elements Oak Natural
Back Hall	(small hallway infront of powder room) 13 x13" Keaton Ice
Breakfast	13 x13" Keaton Ice
Laundry Room	13 x13" Keaton Ice
Kitchen	13 x13" Keaton Ice
Powder Room	13 x13" Keaton Ice
Main Bathroom	13 x13" Keaton Ice
Master Ensuite	13 x13" Keaton Ice
Bathroom (If Applicable)	/
Mud Room	13 x13" Keaton Ice
Master Ens. Shower Floor	2 x2" Ontario Snow White Matte
Living Room	/
Dining Room	3 1/2" Elements Oak Natural
Family / Great Room	3 1/2" Elements Oak Natural
Den / Library / Study	/
Basement Landing (If Applies)	
Lower Landing (If Applicable)	3 1/2" Elements Oak Natural
Upper Landing	3 1/2" Elements Oak Natural
Upper Hall	**3 1/2" Elements Oak Natural
Master Bedroom	Modern Story 1, # 808 Dawn
Bedroom #2	Modern Story 1, # 808 Dawn
Bedroom #3	Modern Story 1, # 808 Dawn
Bedroom #4	Modern Story 1, # 808 Dawn
Bedroom #5	/
Master Ens. Shower jamb	Anatolia Marmiline SNOW

SEE ATTACHED FOR SIGNATURES

Initial:  

Purchasers: EMMANUEL OWUSU & JACLYN MARIE OWUS Property: 199 BLOCK 182 of Plan - Draft Approval S
Telephone Res. / Bus: / Project: KINGSMEN (THAMES) INC.
Decor Advisor: Barbara Coccia Model and Elevation: George (2603) Elev B1 4 Bed - 2+1 Bath
4. Flooring - Continued -

Upgrade Underpad	Type	Area
	Standard	Master Bedroom, bedroom #2, #3 & #4
Carpet on Stairs	Capped	Runner - *Upgrade
Comment	/	/

3. Plumbing Fixtures / Faucets

Kitchen	Standard	Second Ensuite	/	Powder Room	Standard
Master Ensuite	Standard			Other Room	/
Main Bathroom	Standard				
Comment	Purchaser has upgraded to an undermount kitchen sink, still to install the standard single hole kitchen faucet, NO PLATE. Still to install the standard top mount vanity sinks with standard lav. faucets.				

4. Wall Tile

	Tile Selection	Listello	Insert	Insert Selection
Main Bathroom	8 x 10" Keaton Ice	<input type="checkbox"/>	<input type="checkbox"/>	
Master Ensuite				
Tub Deck	13 x13" Keaton Ice	<input type="checkbox"/>	<input type="checkbox"/>	
Tub Apron	13 x13" Keaton Ice	<input type="checkbox"/>	<input type="checkbox"/>	
Tub Surround	13 x13" Keaton Ice	<input type="checkbox"/>	<input type="checkbox"/>	
Shower Stall	8 x 10" Keaton Ice	<input type="checkbox"/>	<input type="checkbox"/>	
Second Ensuite	/	<input type="checkbox"/>	<input type="checkbox"/>	
	/	<input type="checkbox"/>	<input type="checkbox"/>	
	/	<input type="checkbox"/>	<input type="checkbox"/>	
Kitchen Backsplash	**4x16"Soho Canvas White Glossy Press,70/30 off set	<input type="checkbox"/>	<input type="checkbox"/>	
Complete Backsplash	/	<input type="checkbox"/>	<input type="checkbox"/>	
Comment	To install the kitchen backsplash tile in a 70/30 + - off set brick pattern horizontally.			

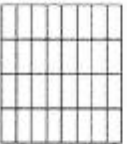
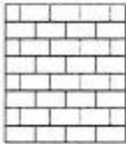
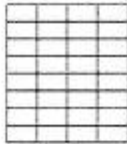

horizontal stacked brick pattern vertical stacked diagonal/diamond

5. Fireplace

	Living Room			Family Room			Other Room - Specify Great Room		
	Purchased	As Per Plan	N/A	Purchased	As Per Plan	N/A	Purchased	As Per Plan	N/A
Fireplace Type	<input type="radio"/>	<input type="radio"/>	<input checked="" type="radio"/>	<input type="radio"/>	<input type="radio"/>	<input checked="" type="radio"/>	<input type="radio"/>	<input checked="" type="radio"/>	<input type="radio"/>
Mantle Type							Front Facing		
Over Mantle							NF-08		
Colour / Stain							/		
Surround							White		
Hearth							/		
Comment	/						/		

SEE ATTACHED FOR SIGNATURES



Initial:

6. Trim Carpentry

☐ 6 PanelInitial for Door Style

Trim Paint Kingsmen White

Jan 4, 2022

SCHEDULE "B-1"
Floor Plan

Townhouse No. 199 BLOCK 182

Phase 5A

Model: George (2603) Elev B1 4 Bed - 2+1 Bath

End Alternate - Standard

Sketch #1

*Both approx.
66" up from floor*

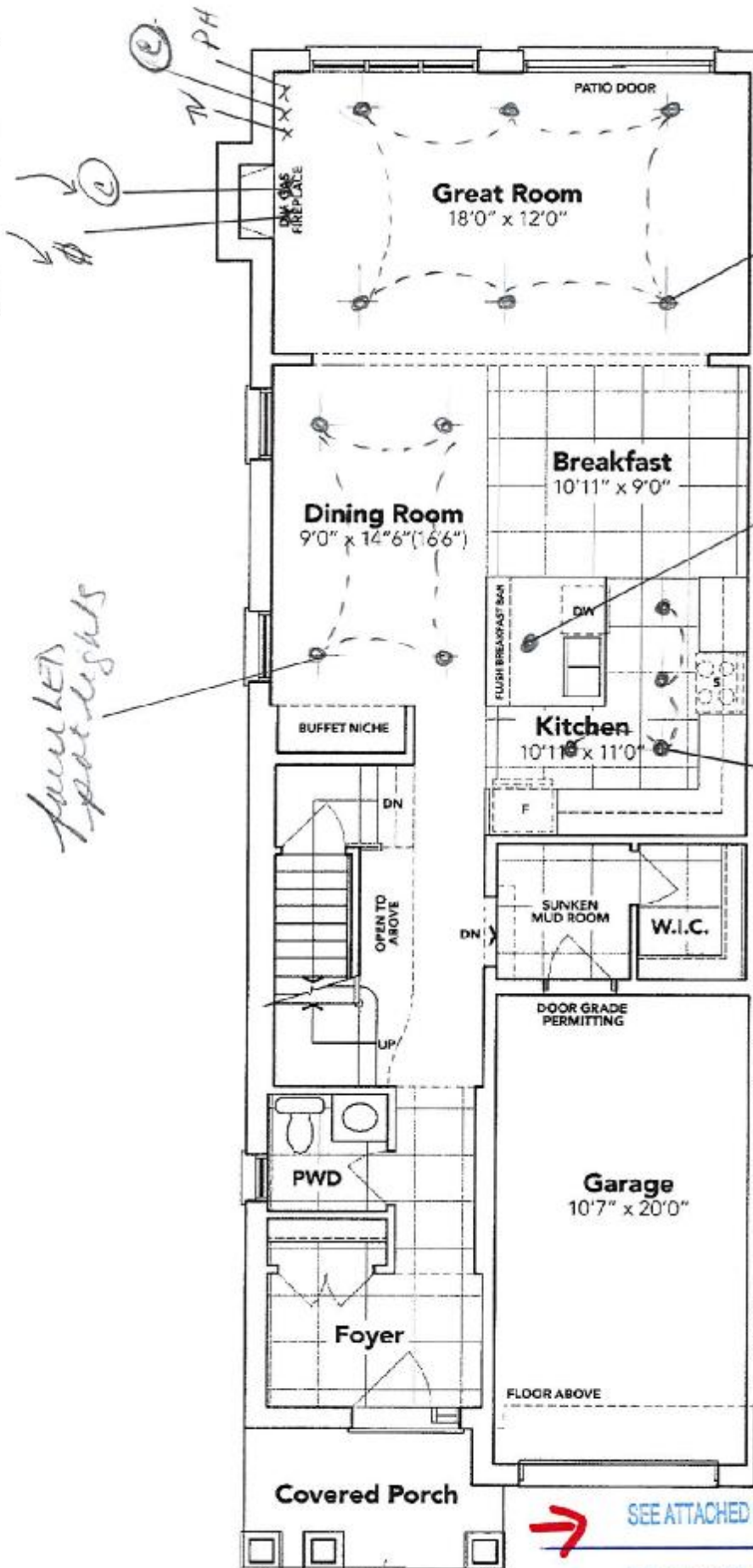

*Relocated
star light*

*four LED
pot lights*

*six LED
pot lights*

*four LED
pot lights*

*70/30± OFF
set Buck
pattern Kit.
Backsplash
NOT TO SCALE.*

MAIN FLOOR EL. B1

SEE ATTACHED FOR SIGNATURES

SEE ATTACHED FOR SIGNATURES

The floor plans and elevations shown are pre-construction plans and may be revised or improved as necessitated by architectural controls and the construction process. The measurements adhere to the rules and regulations of the TARIION Warranty Corporation's official method for the calculation of floor area. Materials, specifications and floor plans are subject to change without notice. All house renderings are artist's concept only. Actual usable floor space may vary from the stated floor area. All options shown are upgrades. E. & O. E.

Townhouse No. 109 BLOCK 152
Phase 5A
Model: George (2503) Elev B1 4 Bed - 2+1 Bath
End Alternate - Standard

Sketch #1

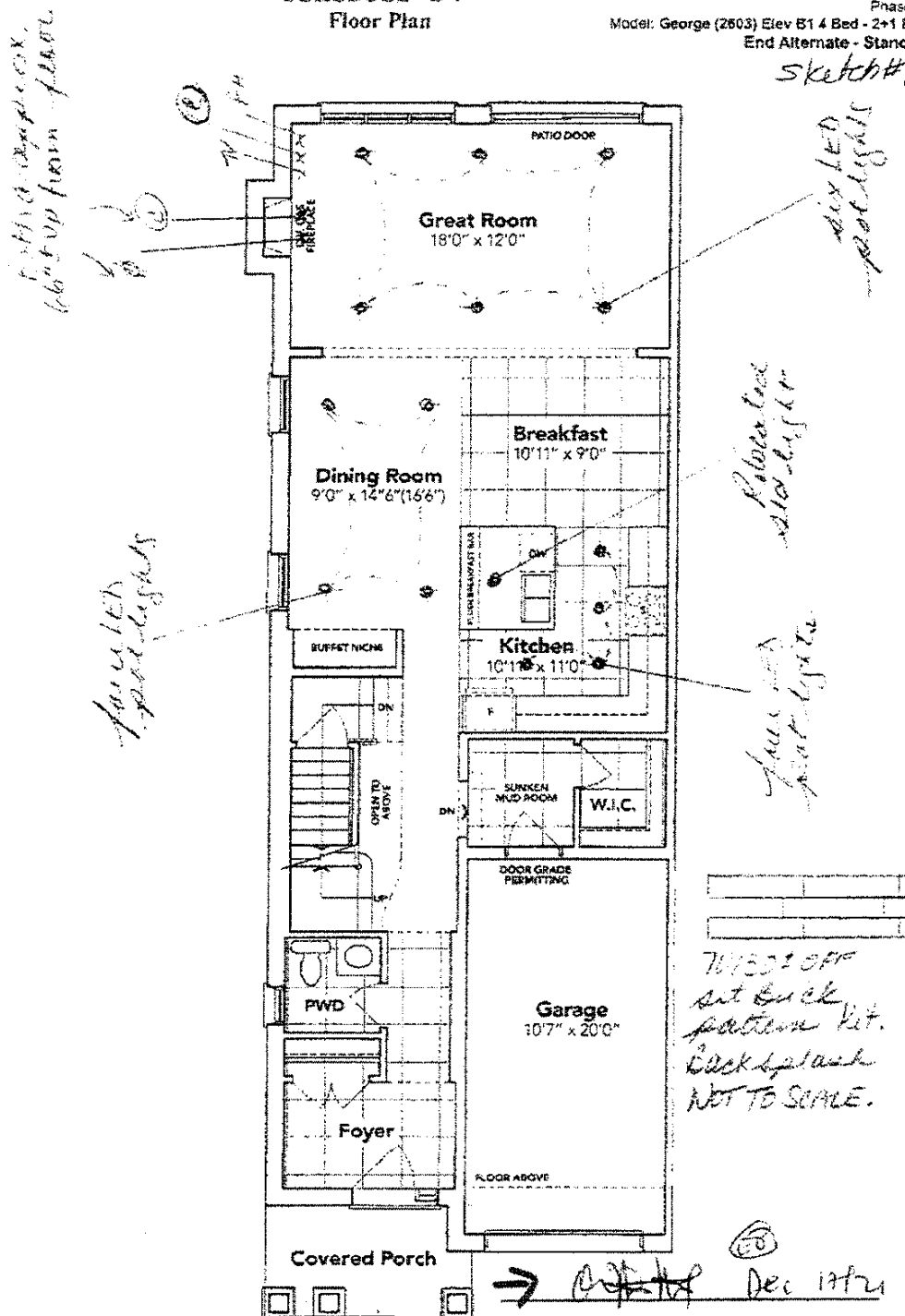

MAIN FLOOR EL. B1

The floor plans and elevations shown are pre-construction plans and may be revised or improved as necessitated by architectural controls and the construction process. The measurements adhere to the rules and regulations of the TARRION Warranty Corporation's official method for the calculation of floor area. Materials, specifications and floor plans are subject to change without notice. All house renderings are artist's concept only. Actual usable floor space may vary from the stated floor area. All options shown are upgrades. E. & O. E.

ကလေးများအတွက်

SCHEDULE "B-1"
Floor Plan

Townhouse No. 199 BLOCK 182
Phase 5A
Model: George (2603) Elev B1 4 Bed - 2+1 Bath
End Alternate - Standard

Sketch #2

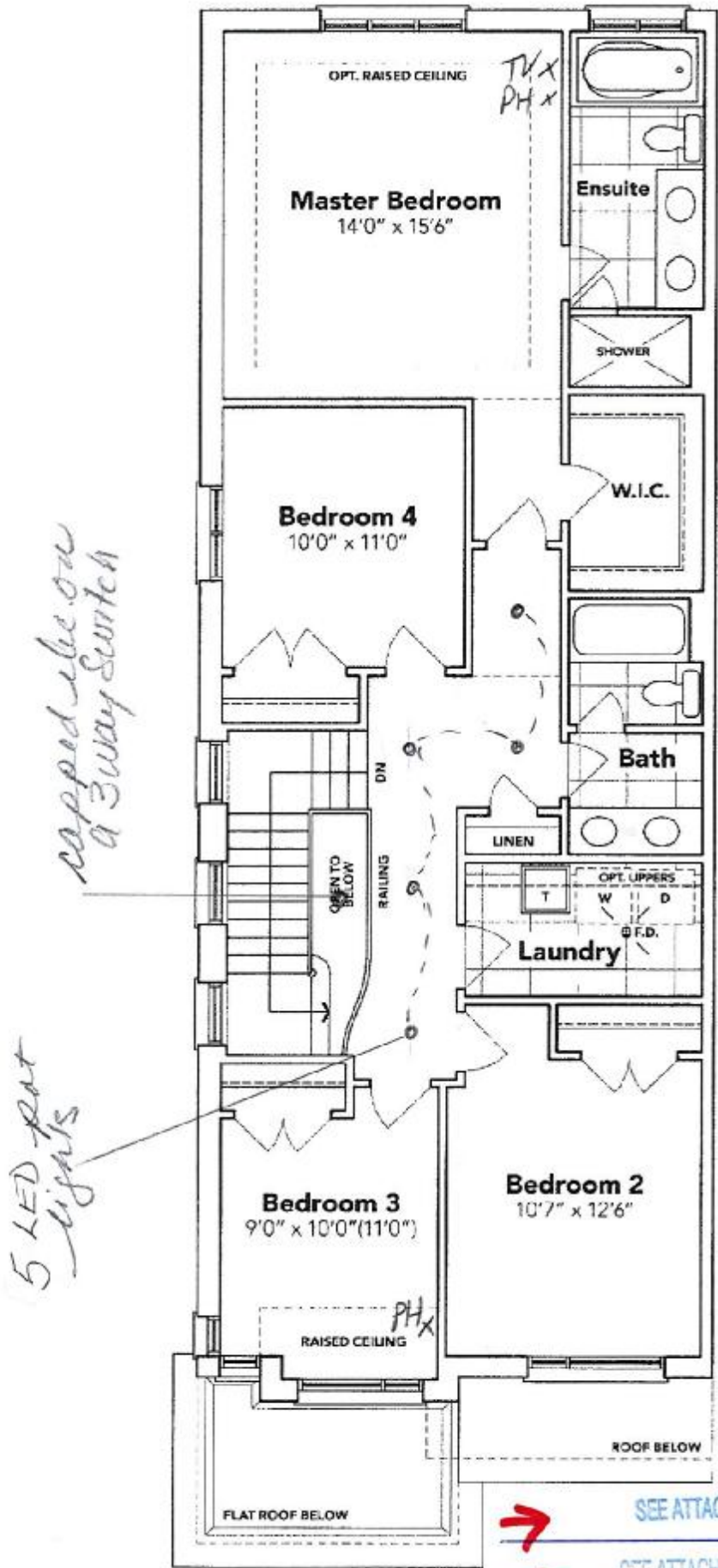

SECOND FLOOR EL. B1

SEE ATTACHED FOR SIGNATURES

SEE ATTACHED FOR SIGNATURES

The floor plans and elevations shown are pre-construction plans and may be revised or improved as necessitated by architectural controls and the construction process. The measurements adhere to the rules and regulations of the IARION Warranty Corporation's official method for the calculation of floor area. Materials, specifications and floor plans are subject to change without notice. All house renderings are artist's concept only. Actual usable floor space may vary from the stated floor area. All options shown are upgrades. E. & O. E.

SCHEDULE "B-1"
Floor Plan

Townhouse No. 189 BLOCK 182
Phase 5A
Model: George (2603) Elev B1 4 Bed - 2+1 Bath
End Alternate - Standard

Sketch #2

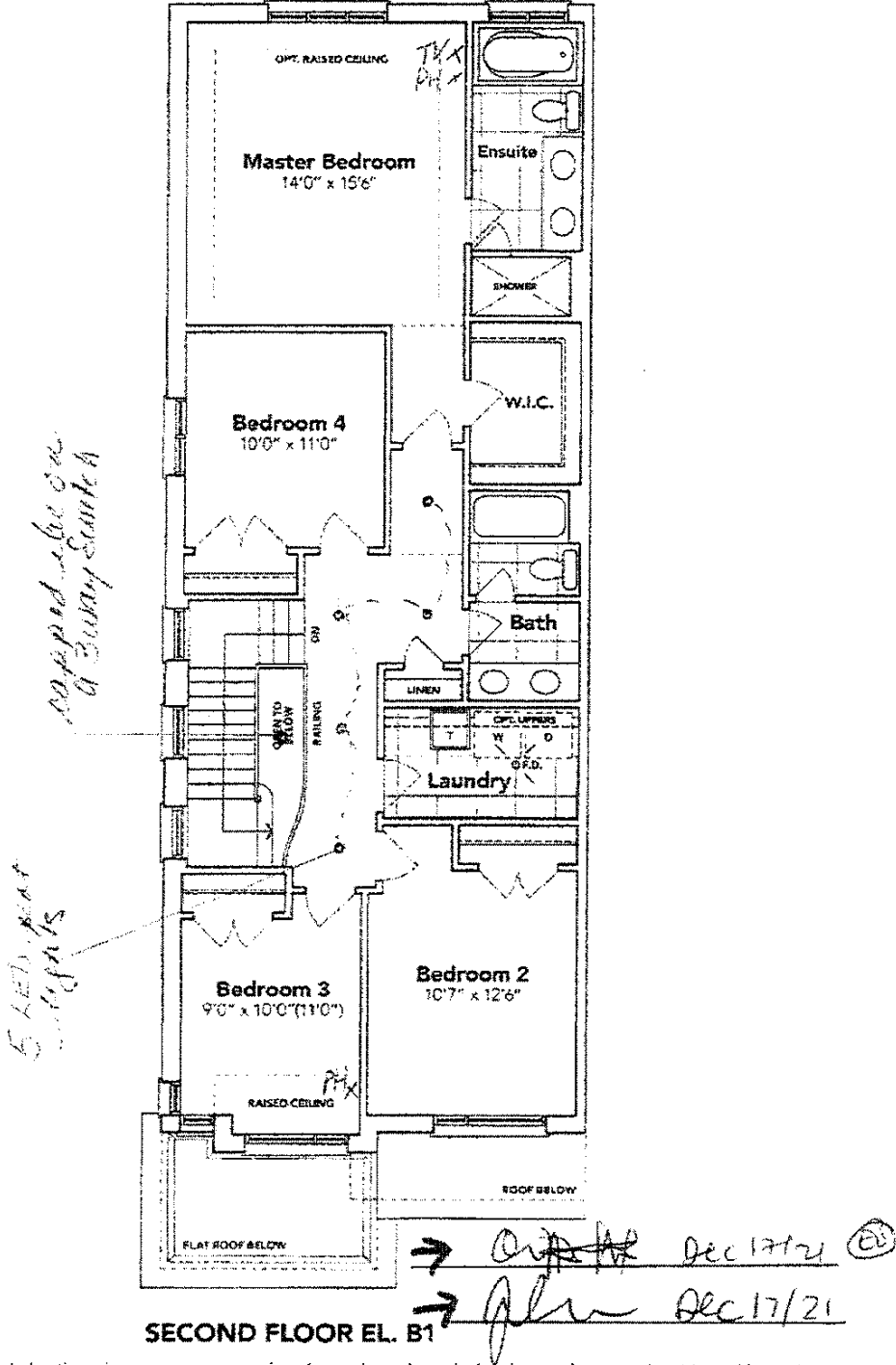

SECOND FLOOR EL. B1

The floor plans and elevations shown are pre-construction plans and may be revised or improved as necessitated by architectural controls and the construction process. The measurements adhere to the rules and regulations of the TARIION Warranty Corporation's official method for the calculation of floor area. Materials, specifications and floor plans are subject to change without notice. All house renderings are artist's concept only. Actual usable floor space may vary from the stated floor area. All options shown are upgrades, E. & O. E.



SCHEDULE "B-1"
Floor Plan

Townhouse No. 199 BLOCK 182
Phase 5A
Model: George (2603) Elev B1 4 Bed - 2+1 Bath
End Alternate - Standard

sketch #3

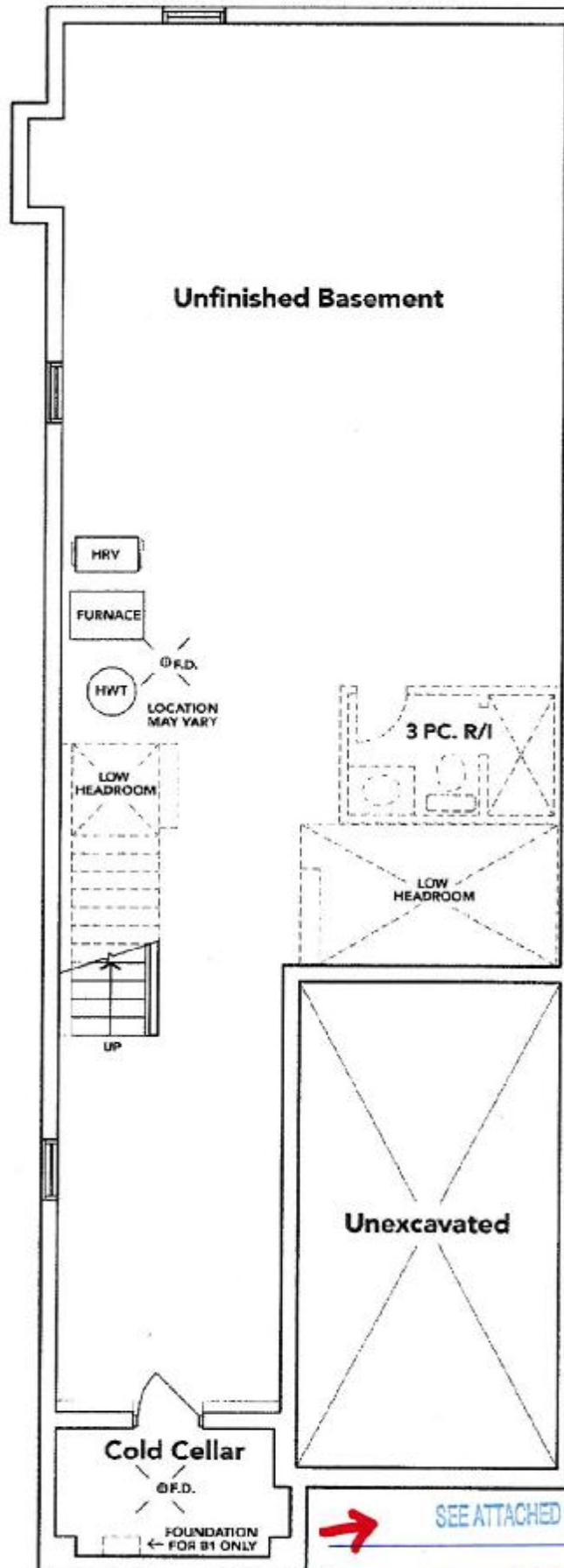

SEE ATTACHED FOR SIGNATURES

SEE ATTACHED FOR SIGNATURES

BASEMENT EL. B1

The floor plans and elevations shown are pre-construction plans and may be revised or improved as necessitated by architectural controls and the construction process. The measurements adhere to the rules and regulations of the TARION Warranty Corporation's official method for the calculation of floor area. Materials, specifications and floor plans are subject to change without notice. All house renderings are artist's concept only. Actual usable floor space may vary from the stated floor area. All options shown are upgrades. E. & O. E.

SCHEDULE "B-1"
Floor Plan

Townhouse No. 199 BLOCK 182
Phase 5A
Model: George (2603) Elev B1 4 Bed - 2+1 Bath
End Alternate - Standard
Sketch #3

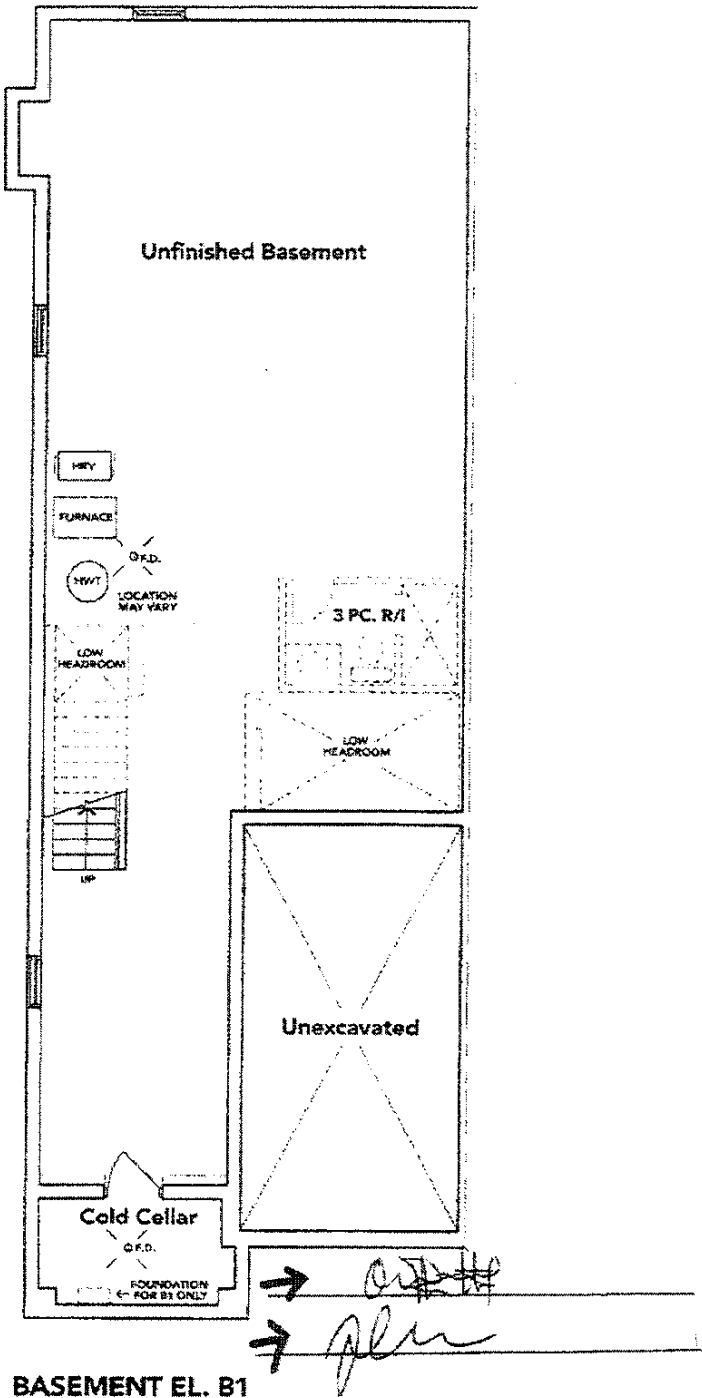

BASEMENT EL. B1

The floor plans and elevations shown are pre-construction plans and may be revised or improved as necessitated by architectural controls and the construction process. The measurements adhere to the rules and regulations of the TARION Warranty Corporation's official method for the calculation of floor area. Materials, specifications and floor plans are subject to change without notice. All house renderings are artist's concept only. Actual usable floor space may vary from the stated floor area. All options shown are upgrades. E. & O. E.

LOT: 199

THAMES PHASE 5A
RE: UPGRADED UNDER MOUNT KITCHEN SINK

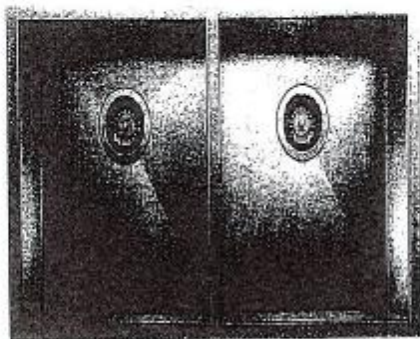

QUATRUS U2

MODEL: 401247

- Dimpled design with 304 series, 16-gauge stainless steel
- Zero-radius corners; X-joint drain grooves
- Double bowl configuration for easy multi-tasking
- 18/10 chrome-nickel content for exceptional luster, durability and strength
- Undermount installation
- Minimum cabinet size: 30"

SEE ATTACHED FOR SIGNATURES

SEE ATTACHED FOR SIGNATURES



LOT: 199

THAMES PHASE 5A
RE: UPGRADED UNDER MOUNT KITCHEN SINK

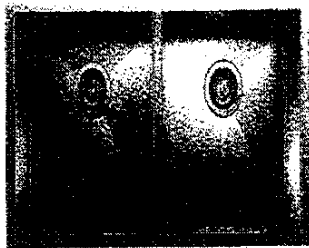

QUATRUS U2

MODEL 401247

Custom engineered for 24" depth, 17" wide undermount

100% solid stainless steel, 3-year warranty

Double bowl configuration for easy multitasking

100% stainless steel construction for long-term value, durability and strength

Double bowl configuration

Minimum cabinet size 30"

→ ~~QW~~ → ~~pl~~