



CONSTRUCTION SUMMARY

KINGSMEN (THAMES) INC. / Havelock Corners (Kingsmen)

Lot/Unit: 182 BLOCK 179 Phase/Building: 5A Model/Floor Plan: Charles (2603) Elev B2 4
Bed - 2+1 Bath

COUNTER TOP

Inv.5081	1 - As Per Schedule "PE": Vendor to include level 1, 3cm quartz in the kitchen, as per plan, in lieu of the included laminate counter tops. Selections to be made from builders standard samples.	
Line 67659	Note:	
11Aug21 / 26Oct21		

ELECTRICAL

Inv.5081	1 - To supply and install the standard T.V Rough-in, in the Great Room and Master Bedroom.. see sketch #1 and #2	
Line 67660	Note:	
11Aug21 / 26Oct21		
Inv.5081	1 - To supply and install the Phone (CAT 5) in the Great Room, Master Bedroom and Bedroom #3.. see sketch #1 and #2	
Line 67661	Note:	
11Aug21 / 26Oct21		
Inv.5081	1 - To SUPPLY AND INSTALL EXTRA CEILING BOX ROUGH IN CAPPED (ON A SEPARATE SWITCH) in the kitchen over the breakfast bar.. see sketch #1	
Line 67662	Note:	
11Aug21 / 26Oct21		
Inv.5081	1 - To SUPPLY AND INSTALL A CAPPED CEILING LIGHT BOX, WITH 3 WAY SWITCH in the open to below area.. see sketch #2	
Line 67664	Note:	
11Aug21 / 26Oct21		

HEATING AND AIR CONDITIONING

Inv.5081	1 - As per schedule "PE": Vendor to supply and install air conditioning unit, sized accordingly from Vendor's standard samples	
Line 67658	Note:	
11Aug21 / 26Oct21		

HVAC

Inv.5081	1 - As per Schedule "PE": Vendor to install capped gas line (ROUGH-IN ONLY) at rear of the home for future BBQ location. Location to be finalized at the Vendors sole discretion.	
Line 67657	Note:	
11Aug21 / 26Oct21		

MISCELLANEOUS

Inv.5081	1 - INTERIOR FINISHES HAVE BEEN SELECTED OCT 26,2021	
Line 67666	Note:	
11Aug21 / 26Oct21		



CONSTRUCTION SUMMARY

KINGSMEN (THAMES) INC. / Havelock Corners (Kingsmen)

Lot/Unit: 182 BLOCK 179 Phase/Building: 5A Model/Floor Plan: Charles (2603) Elev B2 4
Bed - 2+1 Bath

EXTRAS AS PER OFFER

5 FREE APPLIANCES – STAINLESS STEEL FRONT - FRIDGE: STOVE AND DISHWASHER. WHITE WASHER AND DRYER (SUPPLIED ONLY, NOT INSTALLED, FROM BUILDERS STANDARD LINE). AN APPLIANCES VOUCHER WILL BE GIVEN BY OUR DECOR CONSULTANT AT THE TIME OF BOOKING YOUR COLOUR A <i>Worksheet</i> Note:	
VENDOR TO INSTALL CAPPED GAS LINE (ROUGH-IN ONLY) AT REAR OF HOME FOR FUTURE BBQ LOCATION. LOCATION TO BE FINALIZED AT VENDORS SOLE DISCRETION. <i>Worksheet</i> Note:	
VENDOR TO SUPPLY & INSTALL AIR CONDITIONING UNIT, SIZED ACCORDINGLY, FROM VENDORS STANDARD SAMPLES. <i>Worksheet</i> Note:	
VENDOR TO INCLUDE LEVEL 1, 2CM QUARTZ IN THE KITCHEN, AS PER PLAN, IN LIEU OF THE INCLUDED LAMINATE COUNTER TOPS. SELECTIONS TO BE MADE FROM BUILDERS STANDARD SAMPLES. <i>Worksheet</i> Note:	

Purchaser: GEETA PANT

Property: 182 BLOCK 179 of Plan - Draft Approval S

Telephone Res. / Bus: /

Project: KINGSMEN (THAMES) INC.

Decor Advisor: Barbara Coccia

Model and Elevation: Charles (2603) Elev B2 4 Bed - 2+1 Bath

Layout Changes: ☐ Yes ☒ No

Sketch Attached: ☒ Yes ☐ No

Exterior Colour Scheme:

1. Cabinetry

	Style and Colour	Counter Top	Hardware
Kitchen / Breakfast	#3 Simcoe Orchid	#1 C/S #3040 Cement 3cm	12881 Handle
Kitchen Island	#3 Simcoe Orchid	#1 C/S #3040 Cement 3cm	12881 Handle
Laundry Room	/	/	/
Powder Room	#3 Simcoe Orchid	Inukshuk Carbon P-346-LM	12881 Handle
Main Bathroom	#3 Simcoe Moonlight	Calcutta Marble 4925K-07	12881 Handle
Master Ensuite Bathroom	#2 Slab LPL Stainless	Black Alicante 4926K-07	12881 Handle
Second Ensuite Bathroom (If Applicable)	/	/	/
	/	/	/
	/	/	/

Appliances

Custom Size Fridge

☐ Yes ☒ No

Valance Lighting

☐ Yes ☒ No

Microwave / Range Hood

☐ Yes ☒ No

Cooktop / Rangetop

☐ Yes ☒ No

Built in Wall Oven

☐ Yes ☒ No

Slide-in Range

☐ Yes ☒ No

Comment

/

2. Flooring

Selection

Foyer	13x13" Malena Ice
Main Hall	3 1/2" Elements Oak Natural
Back Hall	(infront of powder room) - 13x13" Malena Ice
Breakfast	13x13" Malena Ice
Laundry Room	13x13" Keaton Ice
Kitchen	13x13" Malena Ice
Powder Room	13x13" Malena Ice
Main Bathroom	13x13" Keaton Ice
Master Ensuite	13x13" Cinq Black
Bathroom (If Applicable)	/
Mud Room	13x13" Malena Ice
Ens. shower floor	2x2" Ontario Snow White Matte
Living Room	/
Dining Room	3 1/2" Elements Oak Natural
Family / Great Room	3 1/2" Elements Oak Natural
Den / Library / Study	/
Basement Landing (If Applies)	
Lower Landing (If Applicable)	3 1/2" Elements Oak Natural
Upper Landing	3 1/2" Elements Oak Natural
Upper Hall	Stylish Story 1:929 Mink
Master Bedroom	Stylish Story 1:929 Mink
Bedroom #2	Stylish Story 1:929 Mink
Bedroom #3	Stylish Story 1:929 Mink
Bedroom #4	Stylish Story 1:929 Mink
Bedroom #5	/
Master ens. shower sill	Anatolia Marmiline SNOW

Flooring Continued on Page 2

Initial: 

Page 1 of 3

Purchaser: GEETA PANT

Property: 182 BLOCK 179 of Plan - Draft Approval S

Telephone Res. / Bus: /

Project: KINGSMEN (THAMES) INC.

Decor Advisor: Barbara Coccia

Model and Elevation: Charles (2603) Elev B2 4 Bed - 2+1 Bath

2. Flooring - Continued -

Upgrade Underpad	Type STANDARD	Area 2ND FLOOR
Carpet on Stairs	Capped	Runner - *Upgrade
Comment	/	/

3. Plumbing Fixtures / Faucets

Kitchen	STANDARD	Second Ensuite	/	Powder Room	STANDARD
Master Ensuite	STANDARD			Other Room	/
Main Bathroom	STANDARD		/		

Comment

NOTE: To supply and install the standard TOPMOUNT kitchen sink.. still to install the standard faucet. To supply and install all standard topmount sinks in all bathrooms.. still to supply and install the standard faucets.

4. Wall Tile

	Tile Selection	Listello	Insert	Insert Selection
Main Bathroom	8x10" Cinq Black	<input type="checkbox"/>	<input type="checkbox"/>	
Master Ensuite				
Tub Deck	13x13" Cinq Black	<input type="checkbox"/>	<input type="checkbox"/>	
Tub Apron	13x13" Cinq Black	<input type="checkbox"/>	<input type="checkbox"/>	
Tub Surround	13x13" Cinq Black	<input type="checkbox"/>	<input type="checkbox"/>	
Shower Stall	8x10" Keaton Ice	<input type="checkbox"/>	<input type="checkbox"/>	
Second Ensuite	/	<input type="checkbox"/>	<input type="checkbox"/>	
	/	<input type="checkbox"/>	<input type="checkbox"/>	
	/	<input type="checkbox"/>	<input type="checkbox"/>	
Kitchen Backsplash	/	<input type="checkbox"/>	<input type="checkbox"/>	
Complete Backsplash	/	<input type="checkbox"/>	<input type="checkbox"/>	

Comment

NOTE: To supply and install all wall tiles in the Master and Main Ensuite on the 10" side horizontally stacked, where applicable.



horizontal stacked

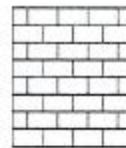

brick pattern

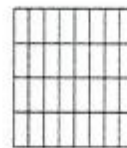

vertical stacked



diagonal/diamond

5. Fireplace

Living Room

Purchased ☐ As Per Plan ☐ N/A ☒

Family Room

Purchased ☐ As Per Plan ☐ N/A ☒

Other Room - Specify Great Room

Purchased ☐ As Per Plan ☒ N/A ☐

Fireplace Type			Front Facing
Mantle Type			NF-08
Over Mantle			/
Colour / Stain			White
Surround			/
Hearth			/

Comment

Initial: 

Purchaser: GEETA PANT
Telephone Res. / Bus: /
Decor Advisor: Barbara Coccia

Property: 182 BLOCK 179 of Plan - Draft Approval S
Project: KINGSMEN (THAMES) INC.
Model and Elevation: Charles (2603) Elev B2 4 Bed - 2+1 Bath

6. Trim Carpentry

Door Hardware Standard Handle

Interior Trim Standard

Comment

Interior Doors

☐ 2 Panel Arch Top

☒ 2 Panel Square Top

☐ 6 Panel



Initial for Door Style GP

7. Railings and Pickets

Railing Package Standard Straight Oak Package

Railing Colour Elements Natural

Picket Colour Elements Natural

Wood Stairs ☐ No ☒ Oak

Tread Colour Elements Natural

Comment

8. Plaster Mouldings and Medallions

Foyer

Main Hall

Living Room

Dining Room

Family Room

Kitchen/Breakfast

Den/Library

Lower Landing

Comment

9. Wall Paint

Kingsmen White

Smooth Ceilings

☐ First Floor

☐ First Floor incl. Second Floor Hall

☐ First and Second Floor

☒ Throughout

☐ Not Applicable

Trim Paint Kingsmen White

10. Additional Comments

11. Disclaimers and Notes

- Colours of all materials are as close as possible to builder's selection, but not necessarily identical due to variances in manufacturing.
- Any extras listed above are null and void unless accompanied by a separate invoice/amendment. Said invoice must be paid in full.
- The Purchaser acknowledges that after Interior Colour Selection form is signed and dated, no further changes will be permitted other than re-selection due to unavailability. GP Purchaser's Initials
- The Purchaser acknowledges reading and accepting the "Kingsmen Group Décor Centre Disclaimers" form. This document contains other miscellaneous disclaimers.

This Interior Colour Selection is final and approved by:

Purchaser:

Signature: [Signature] **Date:** 10/

Vendor:

KINGSMEN (THAMES) INC.

Nov 1st, 2021

SCHEDULE "B-1"
Floor Plan

Townhouse No. 182 BLOCK 179
Phase 5A
Model: Charles (2603) Elev B2 4 Bed - 2+1 Bath
Corner - Standard

Sketch #1

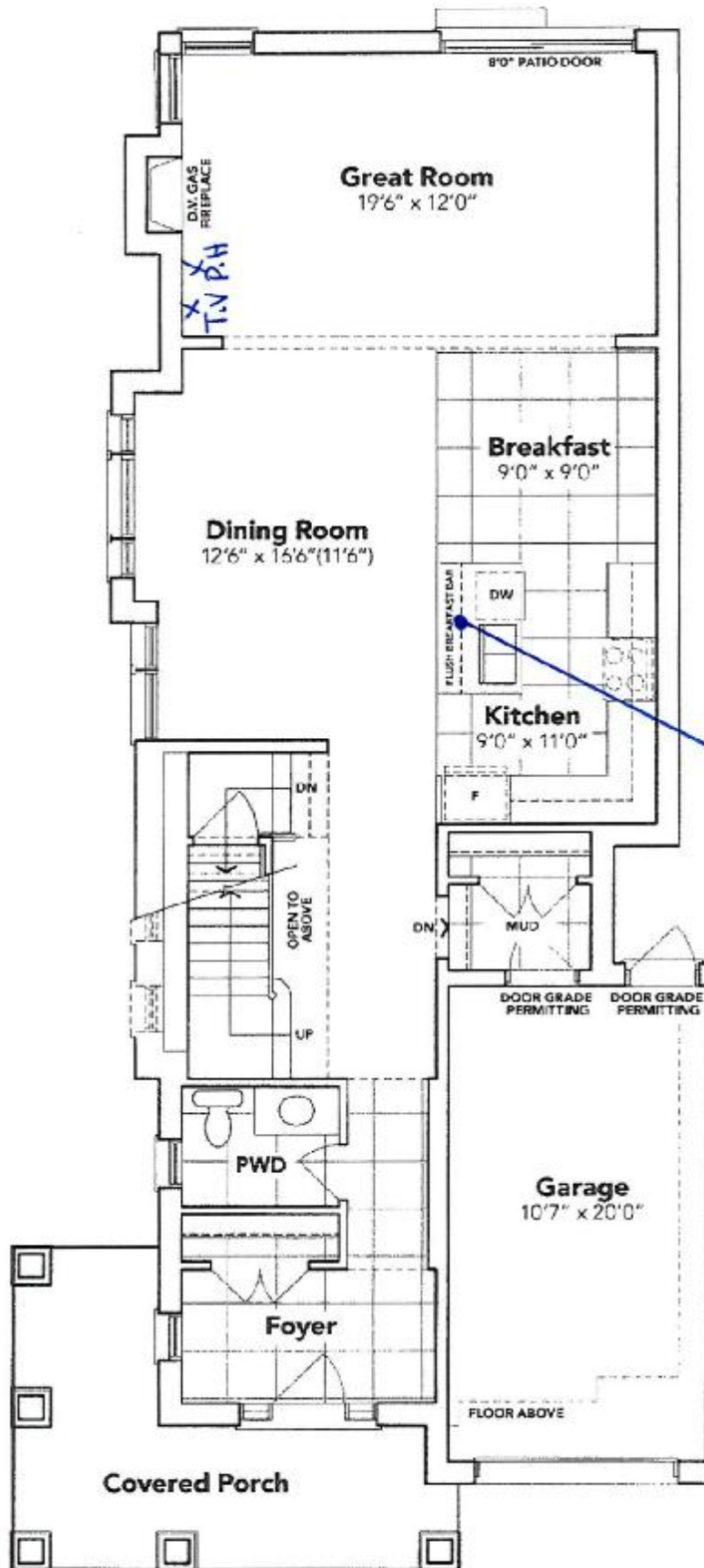

MAIN FLOOR EL. B2

The floor plans and elevations shown are pre-construction plans and may be revised or improved as necessitated by architectural controls and the construction process. The measurements adhere to the rules and regulations of the TARIION Warranty Corporation's official method for the calculation of floor area. Materials, specifications and floor plans are subject to change without notice. All house renderings are artist's concept only. Actual usable floor space may vary from the stated floor area. All options shown are upgrades. E. & O. E.

SCHEDULE "B-1"
Floor Plan

Townhouse No. 182 BLOCK 179
Phase 5A
Model: Charles (2603) Elev B2 4 Bed - 2+1 Bath
Corner - Standard

Sketch #2

Capped Elec. on a 3-way switch.

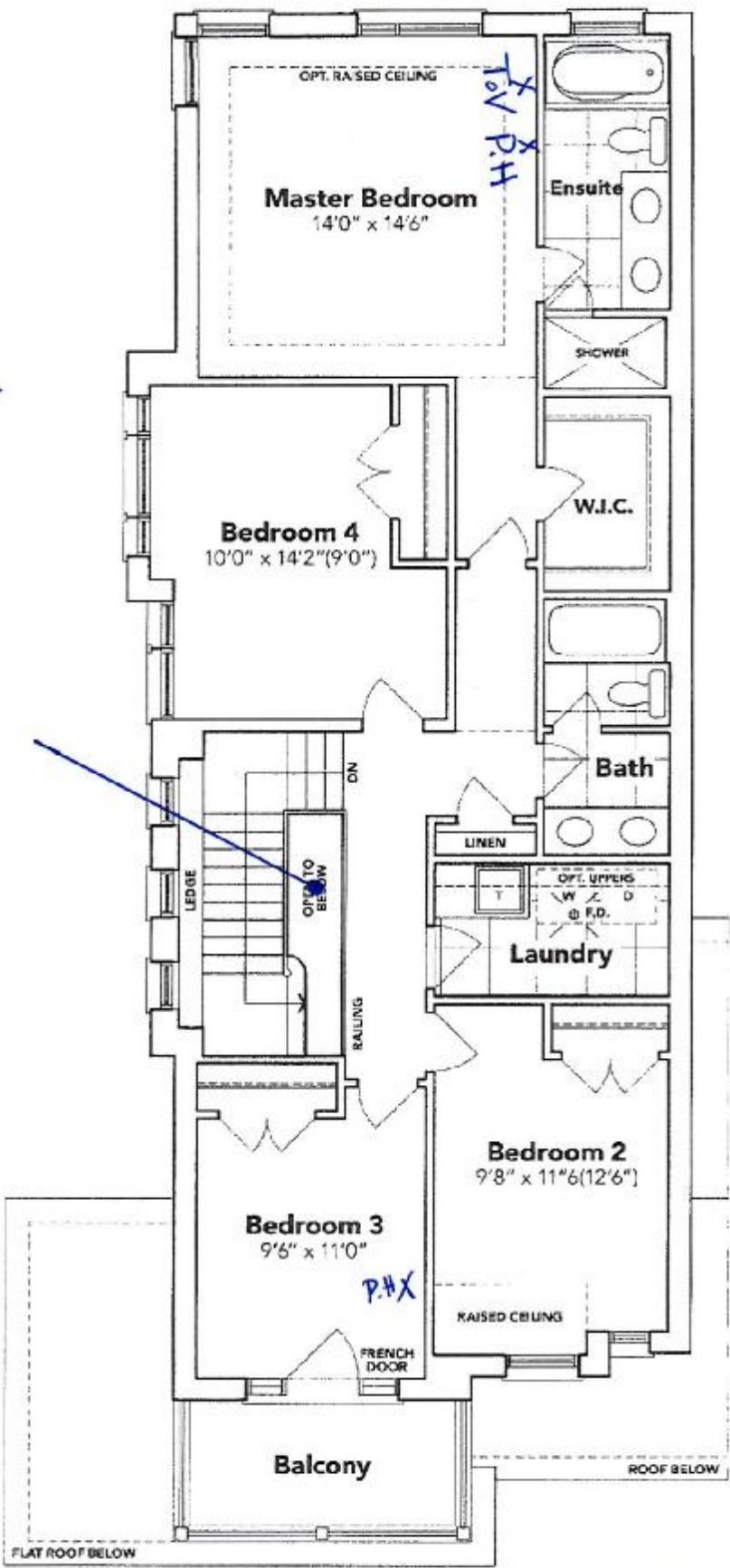

SECOND FLOOR EL. B2 +

The floor plans and elevations shown are pre-construction plans and may be revised or improved as necessitated by architectural controls and the construction process. The measurements adhere to the rules and regulations of the TARION Warranty Corporation's official method for the calculation of floor area. Materials, specifications and floor plans are subject to change without notice. All house renderings are artist's concept only. Actual usable floor space may vary from the stated floor area. All options shown are upgrades, E. & O. E.

SCHEDULE "B-1"
Floor Plan

Townhouse No. 182 BLOCK 179
Phase 5A
Model: Charles (2603) Elev B2 4 Bed - 2+1 Bath
Corner - Standard

Sketch #3

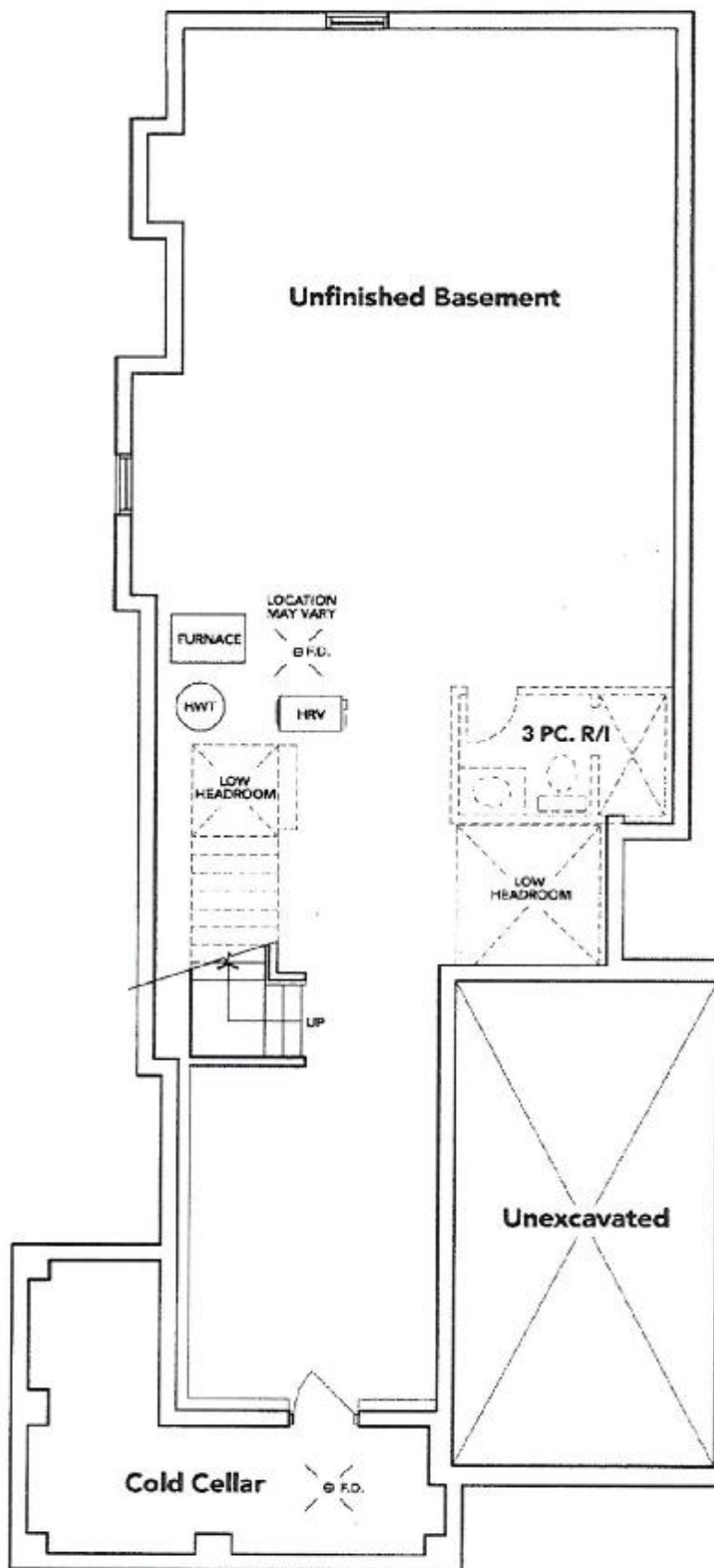

BASEMENT EL. B2

The floor plans and elevations shown are pre-construction plans and may be revised or improved as necessitated by architectural controls and the construction process. The measurements adhere to the rules and regulations of the TARION Warranty Corporation's official method for the calculation of floor area. Materials, specifications and floor plans are subject to change without notice. All house renderings are artist's concept only. Actual usable floor space may vary from the stated floor area. All options shown are upgrades. E. & O. E.