

KINGSMEN (THAMES) INC. / Havelock Corners (Kingsmen)

**Lot/Unit: 247 BLOCK 192 Phase/Building: 5A Model/Floor Plan: William (2603) Elev B1 4
Bed - 2+1 Bath**

CABINETRY APPLIANCE - FRIDGE

Inv.5237	1 - To supply & install the 66CM DEEP FRIDGE ENCLOSURE - COUNTER DEPTH WITH NO WALLS - 2 66CM DEEP GABLES AND 1 66CM DEEP CABINET - THIS IS NOT A ZERO CLEARANCE ENCLOSURE. STANDARD HEIGHTS AND WIDTHS WILL BE USED. - CLASSIC SERIES in the kitchen...	
Line 68626	Note: See sketch # 1	
15Dec21 / 15Dec21		

ELECTRICAL

Inv.5237	1 - To supply & install the standard T.V. rough in in the great room and master bedroom... see sketch # 1 & # 2	
Line 68623	Note: Install the standard T.V. rough in in the great room at approx. 66" + - up from the floor centered + - to the F/P mantle.	
15Dec21 / 15Dec21		
Inv.5237	1 - To supply & install the standard Phone (CAT 5) rough in in the great room, master bedroom and bedroom #3... see sketch #1 & # 2	
Line 68624	Note: Install the standard Phone (CAT 5) . rough in in the great room at approx. 66" + - up from the floor centered + - to the F/P mantle.	
15Dec21 / 15Dec21		
Inv.5237	1 - To SUPPLY AND INSTALL AN ADDITIONAL BASIC RECEPTACLE (NOT DEDICATED) at approx. 66" + - up from the floor centered to theF/Pmantle in the great room...	
Line 68625	Note: See sketch # 1	
15Dec21 / 15Dec21 THIS IS FOR A FUTURE WALL MOUNT T.V.		

HEATING AND AIR CONDITIONING

Inv.5237	1 - As per schedule "PE": Vendor to install capped gas line (rough in only) at rear of home for future BBQ locaion. Location to be finalized at vendors sole discretion.	
Line 68608	Note:	
15Dec21 / 15Dec21		
Inv.5237	1 - As per schedule "PE": Vendor to supply & install air conditioning unit, sized accordingly, from vendors standard samples.	
Line 68609	Note:	
15Dec21 / 15Dec21		

MISCELLANEOUS

Inv.5237	1 - Purchasers selected their interior finishes on Dec. 15, 2021 via ZOOM Virtual meeting link	
Line 68627	Note:	
15Dec21 / 15Dec21		



CONSTRUCTION SUMMARY

KINGSMEN (THAMES) INC. / Havelock Corners (Kingsmen)

Lot/Unit: 247 BLOCK 192 Phase/Building: 5A Model/Floor Plan: William (2603) Elev B1 4
Bed - 2+1 Bath

EXTRAS AS PER OFFER

5 FREE APPLIANCES ? STAINLESS STEEL FRONT - FRIDGE: STOVE AND DISHWASHER. WHITE WASHER AND DRYER (SUPPLIED ONLY, NOT INSTALLED, FROM BUILDERS STANDARD LINE). AN APPLIANCES VOUCHER WILL BE GIVEN BY OUR DECOR CONSULTANT AT THE TIME OF BOOKING YOUR COLOUR A <i>Worksheet</i> Note:	
VENDOR TO INSTALL CAPPED GAS LINE (ROUGH-IN ONLY) AT REAR OF HOME FOR FUTURE BBQ LOCATION. LOCATION TO BE FINALIZED AT VENDORS SOLE DISCRETION. <i>Worksheet</i> Note:	
VENDOR TO SUPPLY & INSTALL AIR CONDITIONING UNIT, SIZED ACCORDINGLY, FROM VENDORS STANDARD SAMPLES. <i>Worksheet</i> Note:	

Purchaser: KIRANJEET KAUR CHATHA **Property:** 247 BLOCK 192 of Plan - Draft Approval 5
Telephone Res. / Bus: (416) 399-6063 / **Project:** KINGSMEN (THAMES) INC.
Decor Advisor: Barbara Coccia **Model and Elevation:** William (2603) Elev B1 4 Bed - 2+1 Bath
Layout Changes: ☐ Yes ☒ No **Sketch Attached:** ☒ Yes ☐ No **Exterior Colour Scheme:**

1. Cabinetry	Style and Colour	Counter Top	Hardware
Kitchen / Breakfast	#3 Simcoe Orchid	#1, C/S #9141 Ice Snow 3cm.	#12881 Handle
Kitchen Island	#3 Simcoe Orchid	#1, C/S #9141 Ice Snow 3cm.	#12881 Handle
Laundry Room	/		
Powder Room	#3 Simcoe Orchid	6698-46 Paloma Polar	#12881 Handle
Main Bathroom	#3 Simcoe Orchid	4924-38 White Carrara	#12881 Handle
Master Ensuite Bathroom	#3 Simcoe Orchid	4925K-07 Calcutta Marble	#12881 Handle
Second Ensuite Bathroom (If Applicable)	/		
	/		
	/		

Appliances	Custom Size Fridge	Valance Lighting	Microwave / Range Hood
	<input type="radio"/> Yes <input checked="" type="radio"/> No	<input type="radio"/> Yes <input checked="" type="radio"/> No	<input type="radio"/> Yes <input checked="" type="radio"/> No
	Cooktop / Rangetop	Built in Wall Oven	Slide-in Range
Comment	<input type="radio"/> Yes <input checked="" type="radio"/> No	<input type="radio"/> Yes <input checked="" type="radio"/> No	<input type="radio"/> Yes <input checked="" type="radio"/> No
/			

2. Flooring	Selection
Foyer	13 x 13" Keaton Ice
Main Hall	3 1/2" Elements oak Natural
Back Hall	(in front of powder room) 13 x 13" Keaton Ice
Breakfast	13 x 13" Keaton Ice
Laundry Room	13 x 13" Keaton Ice
Kitchen	13 x 13" Keaton Ice
Powder Room	13 x 13" Keaton Ice
Main Bathroom	13 x 13" Malena Carbon
Master Ensuite	13 x 13" Keaton Ice
Bathroom (If Applicable)	/
Mud Room	13 x 13" Keaton Ice
Master Ens Shower Floor	22" Ontario Snow White Matte
Living Room	/
Dining Room	3 1/2" Elements oak Natural
Family / Great Room	3 1/2" Elements oak Natural
Den / Library / Study	/
Basement Landing (If Applies)	
Lower Landing (If Applicable)	3 1/2" Elements oak Natural
Upper Landing	3 1/2" Elements oak Natural
Upper Hall	Modern Story 1, # 717 Nomad
Master Bedroom	Modern Story 1, # 717 Nomad
Bedroom #2	Modern Story 1, # 717 Nomad
Bedroom #3	Modern Story 1, # 717 Nomad
Bedroom #4	Modern Story 1, # 717 Nomad
Bedroom #5	/
Master Ens. shower jamb	Anatolia Marmiline SNOW

SEE ATTACHED FOR SIGNATURES



Flooring Continued on Page 2

Initial: _____

Page 1 of 3

Purchaser: KIRANJEET KAUR CHATHA

Property: 247 BLOCK 192 of Plan - Draft Approval 5

Telephone Res. / Bus: (416) 399-8063 /

Project: KINGSMEN (THAMES) INC.

Decor Advisor: Barbara Coccia

Model and Elevation: William (2603) Elev B1 4 Bed - 2+1 Bath

2. Flooring - Continued -

Upgrade Underpad	Type Standard	Area 2nd. Floor
Carpet on Stairs	Capped	Runner - *Upgrade
Comment	/	/

3. Plumbing Fixtures / Faucets

Kitchen	Standard	Second Ensuite	/	Powder Room	Standard
Master Ensuite	Standard			Other Room	/
Main Bathroom	Standard				

Comment

Still to install the standard top mount kitchen sink with the standard kitchen faucet. Still to install the standard top mount vanity sinks and standard lav faucets in all bathrooms.

4. Wall Tile

	Tile Selection	Listello	Insert	Insert Selection
Main Bathroom	8 x 10" Malena Carbon	<input type="checkbox"/>	<input type="checkbox"/>	
Master Ensuite				
Tub Deck	13 x13" Keaton Ice	<input type="checkbox"/>	<input type="checkbox"/>	
Tub Apron	13 x13" Keaton Ice	<input type="checkbox"/>	<input type="checkbox"/>	
Tub Surround	13 x13" Keaton Ice	<input type="checkbox"/>	<input type="checkbox"/>	
Shower Stall	8x10" Keaton Ice	<input type="checkbox"/>	<input type="checkbox"/>	
Second Ensuite	/	<input type="checkbox"/>	<input type="checkbox"/>	
	/	<input type="checkbox"/>	<input type="checkbox"/>	
	/	<input type="checkbox"/>	<input type="checkbox"/>	
Kitchen Backsplash	/	<input type="checkbox"/>	<input type="checkbox"/>	
Complete Backsplash	/	<input type="checkbox"/>	<input type="checkbox"/>	

Comment

Install the standard 8 X 10" wall tile on the 10" stacked horizontally in the main and master ensuite where applicable.



horizontal stacked



brick pattern



vertical stacked



diagonal/diamond

5. Fireplace

	Living Room			Family Room			Other Room - Specify/Great Room		
	Purchased	As Per Plan	N/A	Purchased	As Per Plan	N/A	Purchased	As Per Plan	N/A
Fireplace Type	<input type="radio"/>	<input type="radio"/>	<input checked="" type="radio"/>	<input type="radio"/>	<input type="radio"/>	<input checked="" type="radio"/>	<input type="radio"/>	<input checked="" type="radio"/>	<input type="radio"/>
Mantle Type									
Over Mantle									
Colour / Stain									
Surround									
Hearth									

Comment

/

SEE ATTACHED FOR SIGNATURES



Initial: _____

Purchaser: KIRANJEET KAUR CHATHA

Telephone Res. / Bus: (416) 399-6063 /

Decor Advisor: Barbara Coccia

Property: 247 BLOCK 192 of Plan - Draft Approval S

Project: KINGSMEN (THAMES) INC.

Model and Elevation: William (2603) Elev B1 4 Bed - 2+1 Bath

6. Trim Carpentry

Door Hardware Standard handle

Interior Trim Standard

Comment

Interior Doors

☐ 2 Panel Arch Top

☒ 2 Panel Square Top

☐ 6 Panel

Initial for Door Style

7. Railings and Pickets

Railing Package Standard Oak STRIAGHT picket package

Railing Colour Elements Natural

Wood Stairs ☐ No ☒ Oak

Picket Colour Elements Natural

Tread Colour Elements Natural

Comment

SEE ATTACHED FOR SIGNATURES

8. Plaster Mouldings and Medallions

Foyer

Main Hall

Living Room

Dining Room

Family Room

Kitchen/Breakfast

Den/Library

Lower Landing

Comment

9. Wall Paint

Kingsmen White

Smooth Ceilings ☐ First Floor

☐ First Floor incl. Second Floor Hall

☐ First and Second Floor

☒ Throughout

☐ Not Applicable

Trim Paint Kingsmen White

10. Additional Comments

11. Disclaimers and Notes

- Colours of all materials are as close as possible to builder's selection, but not necessarily identical due to variances in manufacturing.
- Any extras listed above are null and void unless accompanied by a separate invoice/amendment. Said invoice must be paid in full.
- The Purchaser acknowledges that after Interior Colour Selection form is signed and dated, no further changes will be permitted other than re-selection due to unavailability. Purchaser's Initials
- The Purchaser acknowledges reading and accepting the "Kingsmen Group Décor Centre Disclaimers" form. This document contains other miscellaneous disclaimers.

This Interior Colour Selection is final and approved by:

Purchaser:

Signature:

Date:

Vendor:

KINGSMEN (THAMES) INC

Dec 20/21

SCHEDULE "B-1"
Floor Plan

Townhouse No. 247 BLOCK 192
Phase 5A
Model: William (2603) Elev B1 4 Bed - 2+1 Bath
End - Standard

*All 3 items @
66"± up from floor*

sketch #1

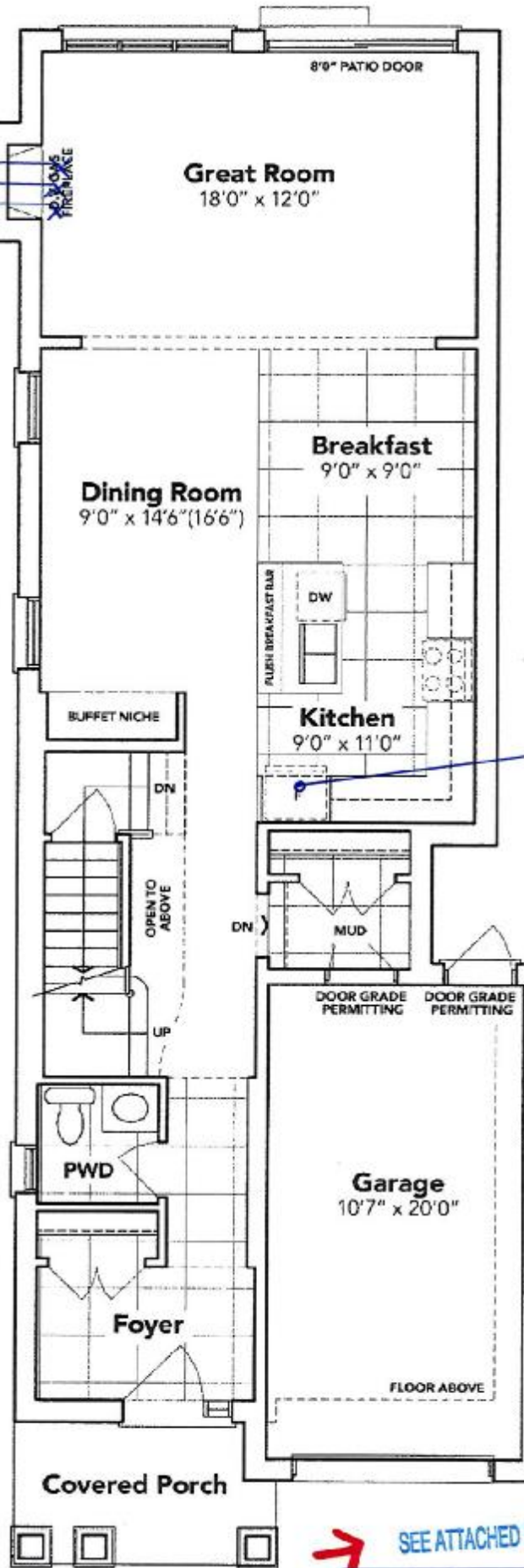

MAIN FLOOR EL. B1

The floor plans and elevations shown are pre-construction plans and may be revised or improved as necessitated by architectural controls and the construction process. The measurements adhere to the rules and regulations of the TARIION Warranty Corporation's official method for the calculation of floor area. Materials, specifications and floor plans are subject to change without notice. All house renderings are artist's concept only. Actual usable floor space may vary from the stated floor area. All options shown are upgrades. E. & O. E.

SCHEDULE "B-1"
Floor Plan

Townhouse No. 247 BLOCK 192
Phase 5A
Model: William (2603) Elev B1 4 Bed - 2+1 Bath
End - Standard

Sketch #2

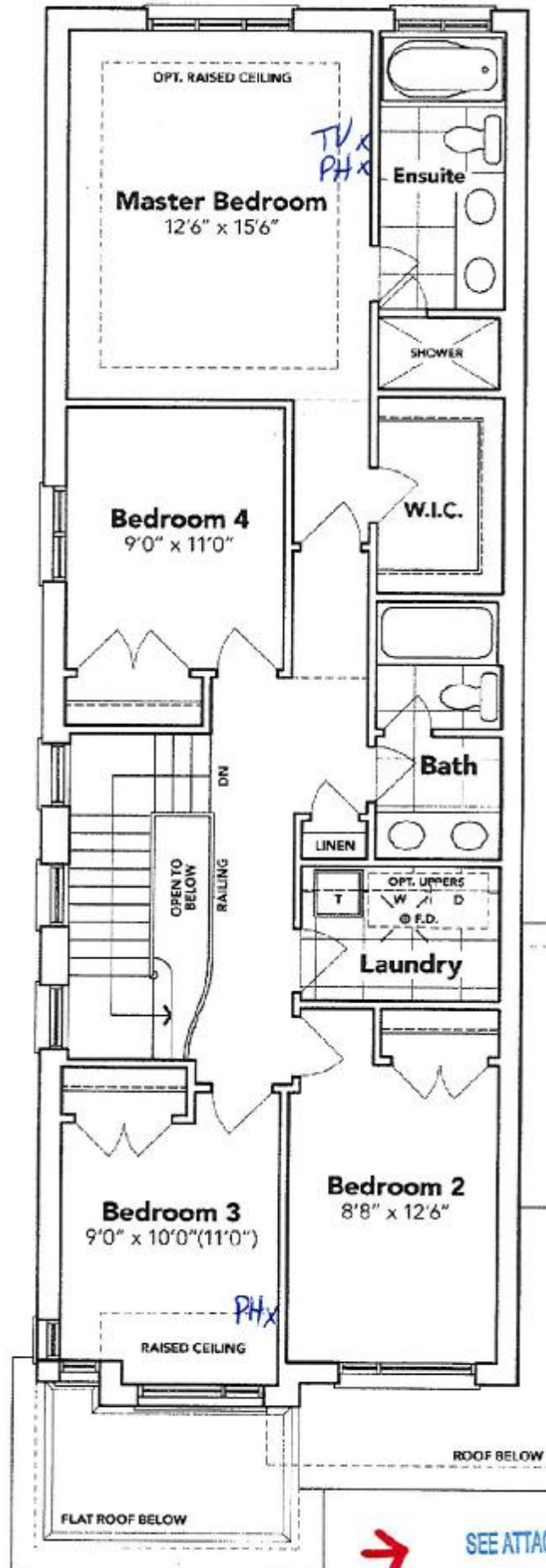

SEE ATTACHED FOR SIGNATURES

SECOND FLOOR EL. B1

The floor plans and elevations shown are pre-construction plans and may be revised or improved as necessitated by architectural controls and the construction process. The measurements adhere to the rules and regulations of the TARIION Warranty Corporation's official method for the calculation of floor area. Materials, specifications and floor plans are subject to change without notice. All house renderings are artist's concept only. Actual usable floor space may vary from the stated floor area. All options shown are upgrades. E. & O. E.

SCHEDULE "B-1"
Floor Plan

Townhouse No. 247 BLOCK 192
Phase 5A
Model: William (2603) Elev B1 4 Bed - 2+1 Bath
End - Standard

Sketch #3

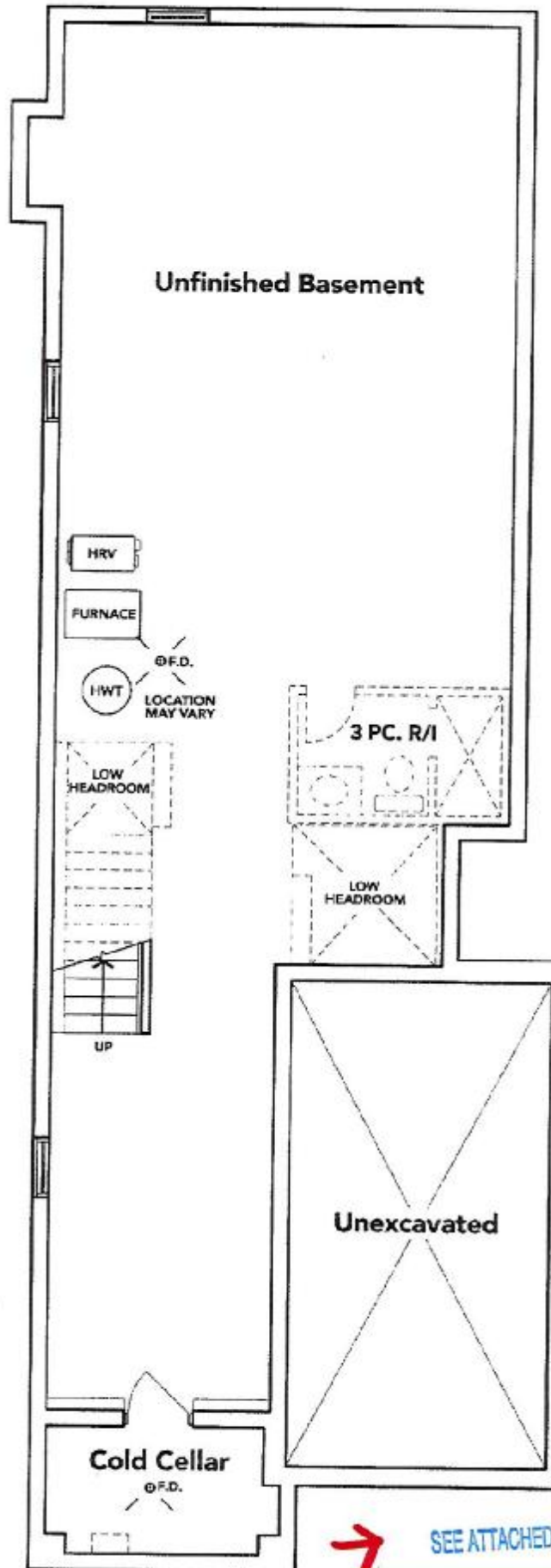

BASEMENT EL. B1

The floor plans and elevations shown are pre-construction plans and may be revised or improved as necessitated by architectural controls and the construction process. The measurements adhere to the rules and regulations of the TARIION Warranty Corporation's official method for the calculation of floor area. Materials, specifications and floor plans are subject to change without notice. All house renderings are artist's concept only. Actual usable floor space may vary from the stated floor area. All options shown are upgrades. E. & O. E.