

KINGSMEN (THAMES) INC. / Havelock Corners (Kingsmen)

Lot/Unit: 230 BLOCK 189    Phase/Building: 5A    Model/Floor Plan: William (2603) Elev B1 4  
Bed - 2+1 Bath

ELECTRICAL

Inv.5191	1 - To supply & install the standard t.v. rough in in the great room and master bedroom... see sketch # 1 & # 2	
Line 68133	Note:	
23Nov21 / 23Nov21		
Inv.5191	1 - To supply & install the standard Phone ( CAT 5 ) rough in in the great room, master bedroom and bedroom # 3 ... see sketch # 1 & # 2	
Line 68134	Note:	
23Nov21 / 23Nov21		

HEATING AND AIR CONDITIONING

Inv.5191	1 - As per schedule "PE": Vendor to install capped gas line ( rough in only ) at rear of home for future BBQ location. Location to be finalzied at vendors sole discretion.	
Line 68129	Note:	
23Nov21 / 23Nov21		
Inv.5191	1 - As per schedule "PE": Vendor to supply & install air conditioning unit, sized accordingly, from vendors standard samples.	
Line 68130	Note:	
23Nov21 / 23Nov21		

MISCELLANEOUS

Inv.5191	1 - Purchaser selected their interior finishes on Nov. 23, 2021	
	Purchaser has delcined recommendations by design consultant with their interior finishes selected, Purchaser takes full responsibility.	
Line 68135	Note:	
23Nov21 / 23Nov21		

EXTRAS AS PER OFFER

5 FREE APPLIANCES – STAINLESS STEEL FRONT - FRIDGE: STOVE AND DISHWASHER. WHITE WASHER AND DRYER (SUPPLIED ONLY, NOT INSTALLED, FROM BUILDERS STANDARD LINE). AN APPLIANCES VOUCHER WILL BE GIVEN BY OUR DECOR CONSULTANT AT THE TIME OF BOOKING YOUR COLOUR A <i>Worksheet</i> Note:		
VENDOR TO INSTALL CAPPED GAS LINE (ROUGH-IN ONLY) AT REAR OF HOME FOR FUTURE BBQ LOCATION.    LOCATION TO BE FINALIZED AT VENDORS SOLE DISCRETION. <i>Worksheet</i> Note:		
VENDOR TO SUPPLY & INSTALL AIR CONDITIONING UNIT, SIZED ACCORDINGLY, FROM VENDORS STANDARD SAMPLES. <i>Worksheet</i> Note:		

Purchaser: AZIZ AHMAD

Property: 230 BLOCK 189 of Plan - Draft Approval S

Telephone Res. / Bus: /

Project: KINGSMEN (THAMES) INC.

Decor Advisor: Barbara Coccia

Model and Elevation: William (2603) Elev B1 4 Bed - 2+1 Bath

Layout Changes: ☐ Yes ☒ No

Sketch Attached: ☒ Yes ☐ No

Exterior Colour Scheme:

### 1. Cabinetry

	Style and Colour	Counter Top	Hardware
Kitchen / Breakfast	# 3 Manchester Maple Porcini CL	#1, C/S # 9141 Ice Snow 3cm.	# 9661 handle
Kitchen Island	# 3 Manchester Maple Porcini CL	#1, C/S # 9141 Ice Snow 3cm.	# 9661 handle
Laundry Room	/		
Powder Room	# 3 Manchester Maple Porcini CL	Cipollino Bianco 1881K-52	#135 Knob
Main Bathroom	#3 Charleston 3DL Moonlight	Leche Vesta 4987K-07	#181 Knob
Master Ensuite Bathroom	#3 Slab LPL Meringue	4957K-22 Mocha Fantastico	#135 Knob
Second Ensuite Bathroom (If Applicable)	/		
	/		
	/		

### Appliances

Custom Size Fridge

☐ Yes ☒ No

Valance Lighting

☐ Yes ☒ No

Microwave / Range Hood

☐ Yes ☒ No

Cooktop / Rangetop

☐ Yes ☒ No

Built in Wall Oven

☐ Yes ☒ No

Slide-in Range

☐ Yes ☒ No

Comment

/

### 2. Flooring

#### Selection

Foyer	13 x 13" Cinq Cream
Main Hall	3 1/2" Elements oak Natural
Back Hall	( small hall in front of powder room) 13 x13 Cinq Cream
Breakfast	13 x 13" Cinq Cream
Laundry Room	13 x 13" Cinq Grey
Kitchen	13 x 13" Cinq Cream
Powder Room	13 x 13" Cinq Cream
Main Bathroom	13 x 13" Cinq Grey
Master Ensuite	13 x13" Keaton Carbon
Bathroom (If Applicable)	/
Mud Room	13 x 13" Cinq Cream
Master Ens. Shower Floor	2x2" Ontario Snow White Matte
Living Room	/
Dining Room	3 1/2" Elements oak Natural
Family / Great Room	3 1/2" Elements oak Natural
Den / Library / Study	/
Basement Landing (If Applies)	
Lower Landing (If Applicable)	3 1/2" Elements oak Natural
Upper Landing	3 1/2" Elements oak Natural
Upper Hall	Modern Story 1, # 777 Gold Coast
Master Bedroom	Modern Story 1, # 777 Gold Coast
Bedroom #2	Modern Story 1, # 777 Gold Coast
Bedroom #3	Modern Story 1, # 777 Gold Coast
Bedroom #4	Modern Story 1, # 777 Gold Coast
Bedroom #5	/
Master ens. shower jamb	Anatolia Marmiline SNOW

Flooring Continued on Page 2

Initial:

Page 1 of 3

Purchaser: AZIZ AHMAD      Property: 230 BLOCK 189 of Plan - Draft Approval S  
Telephone Res. / Bus: /      Project: KINGSMEN (THAMES) INC.  
Decor Advisor: Barbara Coccia      Model and Elevation: William (2603) Elev B1 4 Bed - 2+1 Bath

2. Flooring - Continued -





Upgrade Underpad	Type	Area
	Standard	2nd. floor
Carpet on Stairs	Capped	Runner - *Upgrade
Comment	/	/

3. Plumbing Fixtures / Faucets

Kitchen	Standard	Second Ensuite	/	Powder Room	Standard
Master Ensuite	Standard			Other Room	/
Main Bathroom	Standard		/		
Comment	Still to install the standard top mount kitchen sink with the standard kitchen faucet.... still to install the standard top mount vanity sinks with standard lav. faucets.				

4. Wall Tile

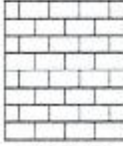
	Tile Selection	Listello	Insert	Insert Selection
Main Bathroom	8 x 10" Cinq Grey	<input type="checkbox"/>	<input type="checkbox"/>	
Master Ensuite				
Tub Deck	13 x 13" Keaton Carbon	<input type="checkbox"/>	<input type="checkbox"/>	
Tub Apron	13 x 13" Keaton Carbon	<input type="checkbox"/>	<input type="checkbox"/>	
Tub Surround	13 x 13" Keaton Carbon	<input type="checkbox"/>	<input type="checkbox"/>	
Shower Stall	8 x 10" Keaton Carbon	<input type="checkbox"/>	<input type="checkbox"/>	
Second Ensuite	/	<input type="checkbox"/>	<input type="checkbox"/>	
	/	<input type="checkbox"/>	<input type="checkbox"/>	
	/	<input type="checkbox"/>	<input type="checkbox"/>	
Kitchen Backsplash	/	<input type="checkbox"/>	<input type="checkbox"/>	
Complete Backsplash	/	<input type="checkbox"/>	<input type="checkbox"/>	
Comment	Install the standard 8 x 10" wall tiles on the 10" side stacked horizontally where applicable for the main and master bathrooms.			



horizontal stacked      brick pattern      vertical stacked      diagonal/diamond

5. Fireplace

	Living Room			Family Room			Other Room - Specify Great Room		
	Purchased	As Per Plan	N/A	Purchased	As Per Plan	N/A	Purchased	As Per Plan	N/A
Fireplace Type	<input type="radio"/>	<input type="radio"/>	<input checked="" type="radio"/>	<input type="radio"/>	<input type="radio"/>	<input checked="" type="radio"/>	<input type="radio"/>	<input checked="" type="radio"/>	<input type="radio"/>
Mantle Type							Front Facing		
Over Mantle							NF-08		
Colour / Stain							/		
Surround							White		
Hearth							/		
Comment	/								

Initial:





**Purchaser:** AZIZ AHMAD  
**Telephone Res. / Bus:** /  
**Decor Advisor:** Barbara Coccia

**Property:** 230 BLOCK 189 of Plan - Draft Approval S  
**Project:** KINGSMEN (THAMES) INC.  
**Model and Elevation:** William (2603) Elev B1 4 Bed - 2+1 Bath

### 6. Trim Carpentry

**Door Hardware** Standard handle

**Interior Trim** Standard

**Comment**

/

#### Interior Doors

☐ 2 Panel Arch Top

☒ 2 Panel Square Top

☐ 6 Panel



Initial for Door Style

*[Signature]*

### 7. Railings and Pickets

**Railing Package** Standard Oak Turned Pickets

**Railing Colour** Elements natural

**Picket Colour** Elements natural

**Wood Stairs** ☐ No ☒ Oak

**Tread Colour** Elements natural

**Comment**

/

### 8. Plaster Mouldings and Medallions

**Foyer** /

**Kitchen/Breakfast** /

**Main Hall** /

**Den/Library** /

**Living Room** /

**Lower Landing** /

**Dining Room** /

/

**Family Room** /

**Comment**

/

### 9. Wall Paint

Kingsmen White

#### Smooth Ceilings

☐ First Floor

☐ First Floor incl. Second Floor Hall

☐ First and Second Floor

☒ Throughout

☐ Not Applicable

**Trim Paint** Kingsmen White

### 10. Additional Comments

/

### 11. Disclaimers and Notes

- Colours of all materials are as close as possible to builder's selection, but not necessarily identical due to variances in manufacturing.
- Any extras listed above are null and void unless accompanied by a separate invoice/amendment. Said invoice must be paid in full.
- The Purchaser acknowledges that after Interior Colour Selection form is signed and dated, no further changes will be permitted other than re-selection due to unavailability. *[Signature]* Purchaser's Initials
- The Purchaser acknowledges reading and accepting the "Kingsmen Group Décor Centre Disclaimers" form. This document contains other miscellaneous disclaimers.

This Interior Colour Selection is final and approved by:

**Purchaser:**

**Signature** *[Signature]* **Date:** 19/12/21

**Vendor:**

KINGSMEN (THAMES) INC.

Nov 23/21

**SCHEDULE "B-1"**  
**Floor Plan**

Townhouse No. 230 BLOCK 189  
Phase 5A  
Model: William (2603) Elev B1 4 Bed - 2+1 Bath  
End - Standard

*Sketch #1*



**MAIN FLOOR EL. B1**

The floor plans and elevations shown are pre-construction plans and may be revised or improved as necessitated by architectural controls and the construction process. The measurements adhere to the rules and regulations of the TARIION Warranty Corporation's official method for the calculation of floor area. Materials, specifications and floor plans are subject to change without notice. All house renderings are artist's concept only. Actual usable floor space may vary from the stated floor area. All options shown are upgrades. E. & O. E.

**SCHEDULE "B-1"**  
**Floor Plan**

Townhouse No. 230 BLOCK 189  
Phase 5A  
Model: William (2603) Elev B1 4 Bed - 2+1 Bath  
End - Standard

Sketch #2

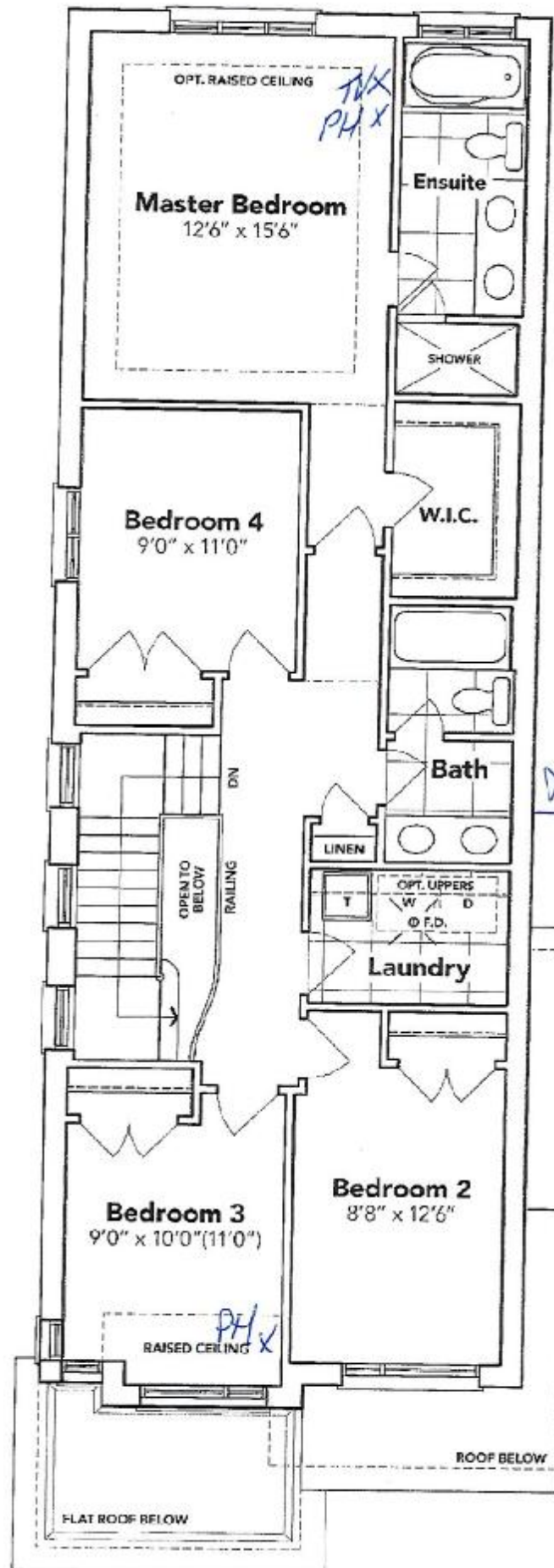

**SECOND FLOOR EL. B1**

The floor plans and elevations shown are pre-construction plans and may be revised or improved as necessitated by architectural controls and the construction process. The measurements adhere to the rules and regulations of the TARIION Warranty Corporation's official method for the calculation of floor area. Materials, specifications and floor plans are subject to change without notice. All house renderings are artist's concept only. Actual usable floor space may vary from the stated floor area. All options shown are upgrades, E. & O. E.



**SCHEDULE "B-1"**  
**Floor Plan**

Townhouse No. 230 BLOCK 189  
Phase 5A  
Model: William (2603) Elev B1 4 Bed - 2+1 Bath  
End - Standard

*Sketch #3*

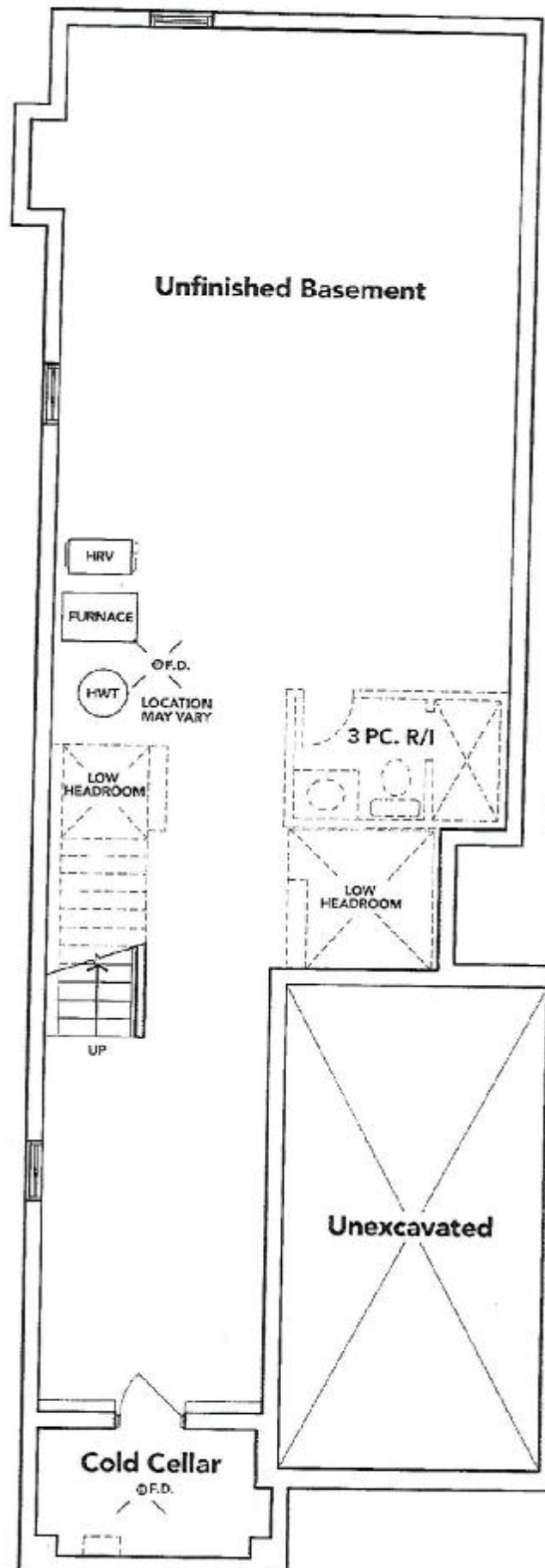

**BASEMENT EL. B1**

The floor plans and elevations shown are pre-construction plans and may be revised or improved as necessitated by architectural controls and the construction process. The measurements adhere to the rules and regulations of the TARIION Warranty Corporation's official method for the calculation of floor area. Materials, specifications and floor plans are subject to change without notice. All house renderings are artist's concept only. Actual usable floor space may vary from the stated floor area. All options shown are upgrades. E. & O. E.