

KINGSMEN (THAMES) INC. / Havelock Corners (Kingsmen)

Lot/Unit: 216 BLOCK 186 Phase/Building: 5A Model/Floor Plan: Richard (2602) Elev B2
Opt 4 Bed - 2+1 Bath

CABINETRY BASE CABINETS

| | | |
|-----------------|---|--|
| Inv.5165 | 1 - To supply & install a different colour kitchen island ... see colour chart for details. | |
| Line 67865 | Note: | |
| 9Nov21 / 9Nov21 | | |

CARPET

| | | |
|-----------------|---|--|
| Inv.5165 | 1 - To supply & install the upgraded ESCAPE TO MAUI carpet in the master bedroom, bedroom # 2, #3 & #4 in lieu of the standard carpet...see colour chart for details. | |
| Line 67867 | Note: | |
| 9Nov21 / 9Nov21 | | |

COUNTER TOP

| | | |
|-----------------|--|--|
| Inv.5165 | 1 - As per schedule "PE": Vendor to include level 1, 2cm. quartz in all bathrooms, as per plan, in lieu of the included lamiante counter tops. Selections to be made from builders standard samples. | |
| Line 67860 | Note: | |
| 9Nov21 / 9Nov21 | | |

ELECTRICAL

| | | |
|-----------------|--|--|
| Inv.5165 | 1 - To supply & install the standard T.V. rough in in the great room and master bedroom... see sketch # 1 & # 2 | |
| Line 67861 | Note: | |
| 9Nov21 / 9Nov21 | | |
| Inv.5165 | 1 - To supply & install the standard Phone (CAT 5) rough in in the great room, master bedroom and bedroom # 4.. see sketch # 1 & # 2 | |
| Line 67862 | Note: | |
| 9Nov21 / 9Nov21 | | |
| Inv.5165 | 1 - To supply & install a capped rough in electrical over the breakfast bar in the kitchen on sep. switch... see sketch # 1 | |
| Line 67863 | Note: | |
| 9Nov21 / 9Nov21 | | |

HARDWOOD

| | | |
|-----------------|---|--|
| Inv.5165 | 1 - To supply & install the 3 1/2" Elements Oak Natural to the upper hallway area in lieu of the std. carpet... | |
| Line 67866 | Note: | |
| 9Nov21 / 9Nov21 | | |

HEATING AND AIR CONDITIONING

| | | |
|-----------------|---|--|
| Inv.5165 | 1 - As per schedule "PE": Vendor to install capped gas line (rough in only) at rear of home for future BBQ location. Location to be finalized at vendors sole discretion. | |
| Line 67858 | Note: | |
| 9Nov21 / 9Nov21 | | |
| Inv.5165 | 1 - As per schedule "PE": Vendor to supply & install air conditioning unit, sized accordingly, from vendors standard samples. | |
| Line 67859 | Note: | |
| 9Nov21 / 9Nov21 | | |

KINGSMEN (THAMES) INC. / Havelock Corners (Kingsmen)

**Lot/Unit: 216 BLOCK 186 Phase/Building: 5A Model/Floor Plan: Richard (2602) Elev B2
Opt 4 Bed - 2+1 Bath**

MISCELLANEOUS

| | | |
|-----------------|---|--|
| Inv.5165 | 1 - Purchaser selected their interior finishes on Nov. 9, 2021. | |
| Line 67868 | Note: | |
| 9Nov21 / 9Nov21 | | |

PLUMBING

| | | |
|-----------------|---|--|
| Inv.5165 | 4 - To supply & install the VANITY SINK - CONTRAC CATENA UNDERMOUNT - MODEL 4210CIY in the powder room, master ensuite and main bathroom in lieu of the standard top mount vanity sinks... see spec's | |
| Line 67864 | Note: STILL TO INSTALL THE STANDARD LAV. FAUCETS. | |
| 9Nov21 / 9Nov21 | | |

EXTRAS AS PER OFFER

| | | |
|--|--|--|
| PURCHASER ACKNOWLEDGES THAT THEY WERE REFERRED BY A REALTOR AND THAT SUCH REALTOR WILL BE COMPENSATED IN ACCORDANCE WITH THE TERMS AND CONDITIONS OF SCHEDULE ?R? ATTACHED HERETO. <i>Worksheet</i> Note: | | |
| 5 FREE APPLIANCES ? STAINLESS STEEL FRONT - FRIDGE: STOVE AND DISHWASHER. WHITE WASHER AND DRYER (SUPPLIED ONLY, NOT INSTALLED, FROM BUILDERS STANDARD LINE). AN APPLIANCES VOUCHER WILL BE GIVEN BY OUR DECOR CONSULTANT AT THE TIME OF BOOKING YOUR COLOUR A <i>Worksheet</i> Note: | | |
| 5 FREE APPLIANCES – STAINLESS STEEL FRONT - FRIDGE: STOVE AND DISHWASHER. WHITE WASHER AND DRYER (SUPPLIED ONLY, NOT INSTALLED, FROM BUILDERS STANDARD LINE). AN APPLIANCES VOUCHER WILL BE GIVEN BY OUR DECOR CONSULTANT AT THE TIME OF BOOKING YOUR COLOUR A <i>Worksheet</i> Note: | | |
| VENDOR TO INSTALL CAPPED GAS LINE (ROUGH-IN ONLY) AT REAR OF HOME FOR FUTURE BBQ LOCATION. LOCATION TO BE FINALIZED AT VENDORS SOLE DISCRETION. <i>Worksheet</i> Note: | | |
| VENDOR TO SUPPLY & INSTALL AIR CONDITIONING UNIT, SIZED ACCORDINGLY, FROM VENDORS STANDARD SAMPLES. <i>Worksheet</i> Note: | | |
| VENDOR TO INCLUDE LEVEL 1, 2CM QUARTZ IN ALL BATHROOMS, AS PER PLAN, IN LIEU OF THE INCLUDED LAMINATE COUNTER TOPS. SELECTIONS TO BE MADE FROM BUILDERS STANDARD SAMPLES. <i>Worksheet</i> Note: | | |

Purchaser: INMAR KHEDER

Property: 216 BLOCK 186 of Plan - Draft Approval S

Telephone Res. / Bus: (226) 582-8023 /

Project: KINGSMEN (THAMES) INC.

Decor Advisor: Barbara Coccia

Model and Elevation: Richard (2602) Elev B2 Opt 4 Bed - 2+1 Ba

Layout Changes: ☐ Yes ☒ No

Sketch Attached: ☒ Yes ☐ No

Exterior Colour Scheme:

1. Cabinetry

| | Style and Colour | Counter Top | Hardware |
|---|-------------------------------|------------------------------|----------------|
| Kitchen / Breakfast | #3 Charleston 3DL Orchid | #1, C/S # 9141 Ice Snow 3cm. | # 12881 Handle |
| Kitchen Island | **#3 Charleston 3DL Navy Blue | #1, C/S # 9141 Ice Snow 3cm. | # 12881 Handle |
| Laundry Room | / | | |
| Powder Room | #3 Charleston 3DL Orchid | #1, C/S # 9141 Ice Snow 2cm. | # 12881 Handle |
| Main Bathroom | #3 Charleston 3DL Orchid | #1, C/S # 3040 Cement 2cm. | # 12881 Handle |
| Master Ensuite Bathroom | #3 Charleston 3DL Orchid | #1, C/S # 3040 Cement 2cm. | # 12881 Handle |
| Second Ensuite Bathroom (If Applicable) | / | | |
| | / | | |
| | / | | |

Appliances

Custom Size Fridge

☐ Yes ☒ No

Valance Lighting

☐ Yes ☒ No

Microwave / Range Hood

☐ Yes ☒ No

Cooktop / Rangetop

☐ Yes ☒ No

Built in Wall Oven

☐ Yes ☒ No

Slide-in Range

☐ Yes ☒ No

Comment

/

2. Flooring

| | Selection |
|-------------------------------|--|
| Foyer | 13 x 13" Cinq Black |
| Main Hall | 13 x 13" Cinq Black |
| Back Hall | / |
| Breakfast | (DINETTE) 13 x 13" Cinq Black |
| Laundry Room | 13 x 13" Cinq Black |
| Kitchen | 13 x 13" Cinq Black |
| Powder Room | 13 x 13" Cinq Black |
| Main Bathroom | 13 x 13" Cinq Black |
| Master Ensuite | 13 x 13" Cinq Black |
| Bathroom (If Applicable) | / |
| Mud Room | 13 x 13" Cinq Black |
| Master Ens. Shower floor | 2x2" Ontario Snow White Matte |
| Living Room | / |
| Dining Room | / |
| Family / Great Room | 3 1/2" Elements Oak Natural |
| Den / Library / Study | / |
| Basement Landing (If Applies) | / |
| Lower Landing (If Applicable) | 3 1/2" Elements Oak Natural |
| Upper Landing | 3 1/2" Elements Oak Natural |
| Upper Hall | ***3 1/2" Elements Oak Natural |
| Master Bedroom | ***Escape to Maui Pilgrims Path #89816 |
| Bedroom #2 | ***Escape to Maui Pilgrims Path #89816 |
| Bedroom #3 | ***Escape to Maui Pilgrims Path #89816 |
| Bedroom #4 | ***Escape to Maui Pilgrims Path #89816 |
| Bedroom #5 | / |
| Master Ens. Shower Jamb | Anatolia Marmiline SNOW |

SEE ATTACHED FOR SIGNATURES



Flooring Continued on Page 2

Initial: _____

Page 1 of 3

Purchaser: INMAR KHEDER

Property: 216 BLOCK 186 of Plan - Draft Approval S

Telephone Res. / Bus: (226) 582-8023 /

Project: KINGSMEN (THAMES) INC.

Decor Advisor: Barbara Coccia

Model and Elevation: Richard (2602) Elev B2 Opt 4 Bed - 2+1 B

2. Flooring - Continued -

| Upgrade Underpad | Type | Area |
|------------------|----------|------------------------------------|
| | Standard | Master bedroom, bedroom #2,#3 & 34 |
| Carpet on Stairs | Capped | Runner - *Upgrade |
| Comment | / | / |

3. Plumbing Fixtures / Faucets

| | | | | | |
|----------------|----------|----------------|---|-------------|----------|
| Kitchen | Standard | Second Ensuite | / | Powder Room | Standard |
| Master Ensuite | Standard | | | Other Room | / |
| Main Bathroom | Standard | | | | |

Comment

NOTE: To supply & install the standard top mount kitchen sink with the standrd kitchen faucet. Purchaser has upgraded to under mount sinks in all bathrooms, still to install the std. lav. faucets.

4. Wall Tile

| | Tile Selection | Listello | Insert | Insert Selection |
|---------------------|---------------------|--------------------------|--------------------------|------------------|
| Main Bathroom | 8 x 10" Cinq Black | <input type="checkbox"/> | <input type="checkbox"/> | |
| Master Ensuite | | | | |
| Tub Deck | 13 x 13" Cinq Black | <input type="checkbox"/> | <input type="checkbox"/> | |
| Tub Apron | 13 x 13" Cinq Black | <input type="checkbox"/> | <input type="checkbox"/> | |
| Tub Surround | 13 x 13" Cinq Black | <input type="checkbox"/> | <input type="checkbox"/> | |
| Shower Stall | 8 x 10" Cinq Black | <input type="checkbox"/> | <input type="checkbox"/> | |
| Second Ensuite | / | <input type="checkbox"/> | <input type="checkbox"/> | |
| | / | <input type="checkbox"/> | <input type="checkbox"/> | |
| | / | <input type="checkbox"/> | <input type="checkbox"/> | |
| Kitchen Backsplash | / | <input type="checkbox"/> | <input type="checkbox"/> | |
| Complete Backsplash | / | <input type="checkbox"/> | <input type="checkbox"/> | |

Comment

Install the standard 8 x 10" wall tiles on the 10" side horizontally stacked where applicable in the master ensuite and main bathroom.



horizontal stacked



brick pattern

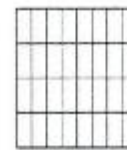

vertical stacked



diagonal/diamond

5. Fireplace

Living Room

Purchased ☐ As Per Plan ☐ N/A ☒

Family Room

Purchased ☐ As Per Plan ☐ N/A ☒

Other Room - Specify Great Room

Purchased ☐ As Per Plan ☐ N/A ☒

Fireplace Type

Mantle Type

Over Mantle

Colour / Stain

Surround

Hearth

Comment

/

SEE ATTACHED FOR SIGNATURES



Initial: _____

Page 2 of 3

Purchaser: INMAR KHEDER

Property: 216 BLOCK 186 of Plan - Draft Approval S

Telephone Res. / Bus: (226) 582-8023 /

Project: KINGSMEN (THAMES) INC.

Decor Advisor: Barbara Coccia

Model and Elevation: Richard (2602) Elev B2 Opt 4 Bed - 2+1 Ba

6. Trim Carpentry

Door Hardware Standard Handle

Interior Trim Standard

Comment

/

Interior Doors

☐ 2 Panel Arch Top

☒ 2 Panel Square Top

☐ 6 Panel



Initial for Door Style

7. Railings and Pickets

Railing Package Standard oak STRAIGHT pickets

Railing Colour Elements Natural

Picket Colour Elements Natural

Wood Stairs ☐ No ☒ Oak

Tread Colour Elements Natural

Comment

/

SEE ATTACHED FOR SIGNATURES

8. Plaster Mouldings and Medallions

Foyer /

Main Hall /

Living Room /

Dining Room /

Family Room /

Kitchen/Breakfast /

Den/Library /

Lower Landing /

Comment

/

9. Wall Paint

KINGSMEN WHITE

Smooth Ceilings

☐ First Floor

☐ First Floor incl. Second Floor Hall

☐ First and Second Floor

☒ Throughout

☐ Not Applicable

Trim Paint KINGSMEN WHITE

10. Additional Comments

/

11. Disclaimers and Notes

- Colours of all materials are as close as possible to builder's selection, but not necessarily identical due to variances in manufacturing.
- Any extras listed above are null and void unless accompanied by a separate invoice/amendment. Said invoice must be paid in full.
- The Purchaser acknowledges that after Interior Colour Selection form is signed and dated, no further changes will be permitted other than re-selection due to unavailability. Purchaser's Initials **SEE ATTACHED FOR SIGNATURES**
- The Purchaser acknowledges reading and accepting the "Kingsmen Group Décor Centre Disclaimers" form. This document contains other miscellaneous disclaimers.

This Interior Colour Selection is final and approved by:

Purchaser:

SEE ATTACHED FOR SIGNATURES

Signature: _____ Date: _____

Vendor:

KINGSMEN (THAMES) INC.

Nov 12/21

Townhouse No. 216 BLOCK 186
Phase 5A
Model: Richard (2602) Elev B2 Opt 4 Bed - 2+1 Bath
Interior - Optional Plan

Capped elec. on a sep. switch

Great Room
20'0" x 11'0"
8'0" PATIO DOOR
D.V. GAS FIREPLACE
x P H
x T J

Dinette
11'6" x 12'0"
DW
FLUSH BREAKFAST BAR
F

Kitchen
8'6" x 11'6"
DN
UP
OPEN TO ABOVE

Foyer
PWD
STORAGE
FLOOR ABOVE
HALF WALL

Garage
11'0" x 19'6"
LEDGE
DOOR GRADE PERMITTING
DOOR GRADE PERMITTING

Covered Porch

SEE ATTACHED FOR SIGNATURES

The floor plans and elevations shown are pre-construction plans and may be revised or improved as necessitated by architectural controls and the construction process. The measurements adhere to the rules and regulations of the LARION Warranty Corporation's official method for the calculation of floor area. Materials, specifications and floor plans are subject to change without notice. All house renderings are artist's concept only. Actual usable floor space may vary from the stated floor area. All options shown are upgrades.

SCHEDULE "B-1"
Floor Plan

Townhouse No. 216 BLOCK 186
Phase 5A
Model: Richard (2602) Elev B2 Opt 4 Bed - 2+1 Bath
Interior - Optional Plan

Sketch #2

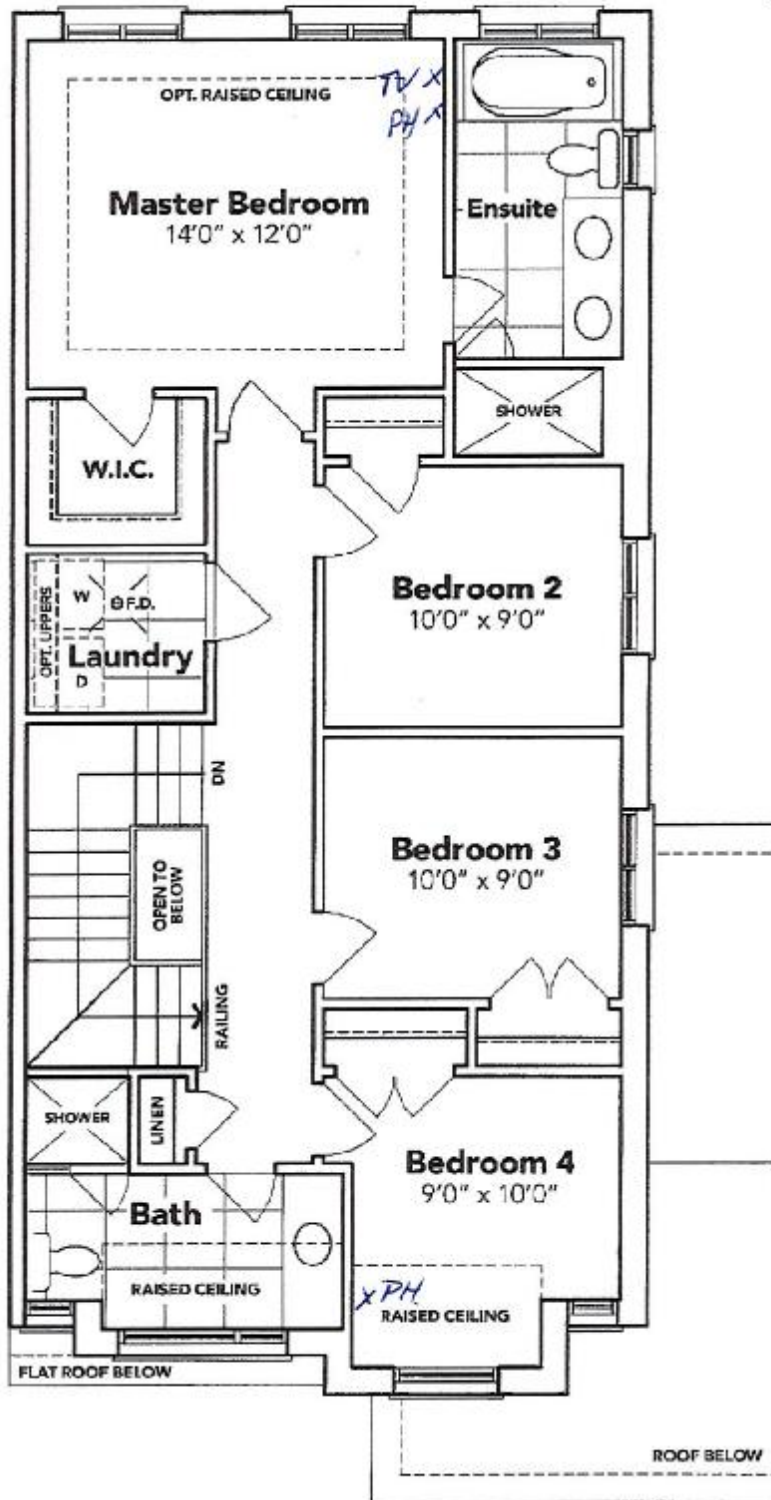

SEE ATTACHED FOR SIGNATURES

OPT. SECOND FLOOR EL. B2A

The floor plans and elevations shown are pre-construction plans and may be revised or improved as necessitated by architectural controls and the construction process. The measurements adhere to the rules and regulations of the TARION Warranty Corporation's official method for the calculation of floor area. Materials, specifications and floor plans are subject to change without notice. All house renderings are artist's concept only. Actual usable floor space may vary from the stated floor area. All options shown are upgrades. E. & O. E.

SCHEDULE "B-1" - Page 2 of 3

Initials: *I. K.*

SCHEDULE "B-1"
Floor Plan

Townhouse No. 216 BLOCK 186
Phase 5A
Model: Richard (2602) Elev B2 Opt 4 Bed - 2+1 Bath
Interior - Optional Plan

Sketch
#3

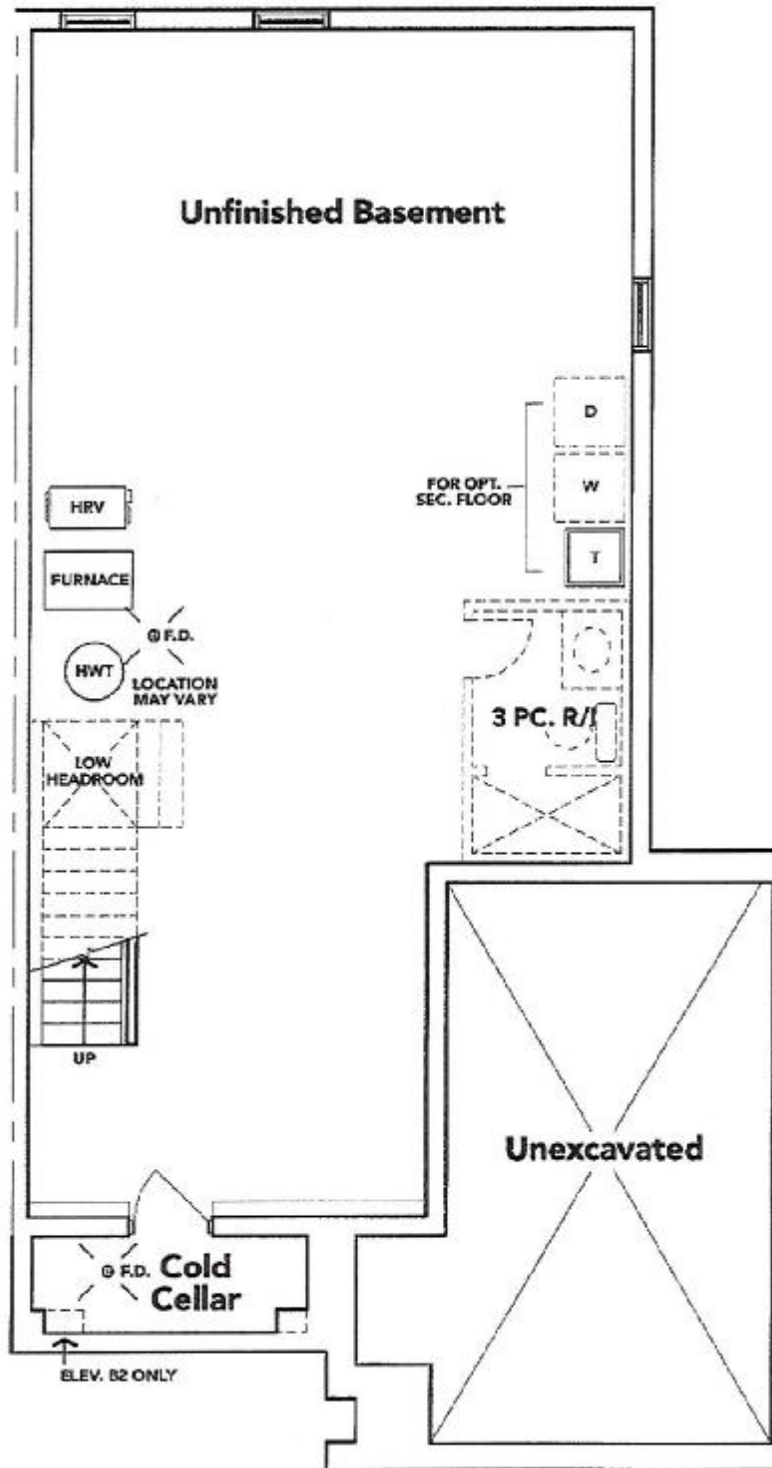

SEE ATTACHED FOR SIGNATURES

BASEMENT EL. B2A

The floor plans and elevations shown are pre-construction plans and may be revised or improved as necessitated by architectural controls and the construction process. The measurements adhere to the rules and regulations of the TARION Warranty Corporation's official method for the calculation of floor area. Materials, specifications and floor plans are subject to change without notice. All house renderings are artist's concept only. Actual usable floor space may vary from the stated floor area. All options shown are upgrades. E. & O. E.

Lot: 216
Thomas PH: 5A
Re: Undermount
Vanity sinks.

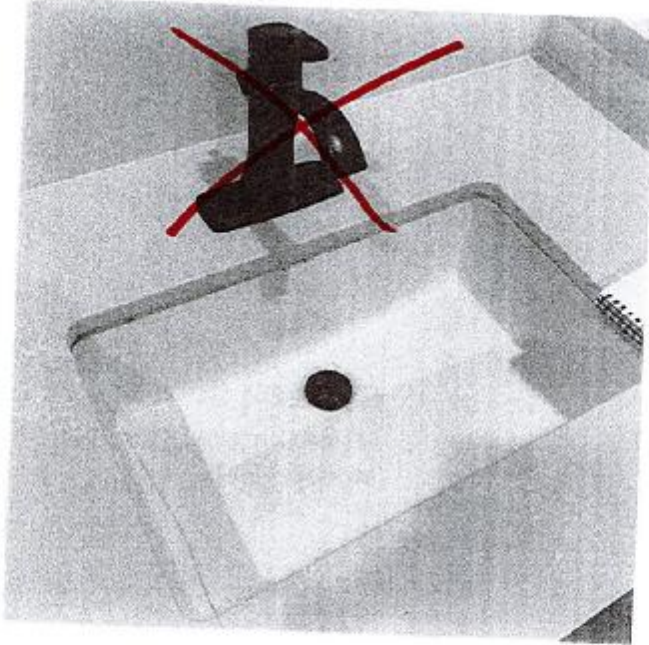

DISPLAY ITEMS

Sink (Item 9)

Contrac Catena Undermount
Model 4210CIY

SEE ATTACHED FOR SIGNATURES