



CONSTRUCTION SUMMARY

Kingsmen (Thames) Inc. / Havelock Corners (Kingsmen)

Lot/Unit: 100    Phase/Building: 4B    Model/Floor Plan: Philip (4202) Elev A 4 Bed - 2+1 Bath

ELECTRICAL

Inv.5095	1 - To supply & install the standard T.V. rough in in the great room and master bedroom... see sketch # 1 & # 2	
Line 66775	Note: Install the T.V. rough in at approx. 66 " + - centered + - to the F/P mantle in the great room....	
26Aug21 / 27Aug21		
Inv.5095	1 - To supply & install the standard Phone ( CAT 5 ) rough in in the great room, master bedroom and bedroo, # 4... see sketch # 1 & # 2	
Line 66776	Note: Install the Phone (CAT 5 ) rough in at approx. 66 " + - centered + - to the F/P mantle in the great room....	
26Aug21 / 27Aug21		
Inv.5095	1 - To SUPPLY AND INSTALL AN ADDITIONAL BASIC RECEPTACLE (NOT DEDICATED) at approx. 66 " + - up from the floor centered + - to the F/P mantle	
Line 66777	Note: in the great room.... see sketch # 1	
26Aug21 / 27Aug21                      THIS IS FOR A FUTURE WALL MOUNT T.V.		
Inv.5095	1 - To supply & install a capped ceiling elec rough in in the living room, have this cap connected to the standard switch, DO NOT have standard swich connected to the standard elec. outlet... See sketch # 1	
Line 66778	Note:	
26Aug21 / 27Aug21		
Inv.5095	1 - To supply & install a capped ceiling elec. rough in connected to a sep. switch over the breakfast bar in the kitchen... see sketch # 1	
Line 66779	Note:	
26Aug21 / 27Aug21		
Inv.5095	1 - Relocate the standard light from the upper stair landing to the O.T.B. area on the second floor... see sketch # 2	
Line 66780	Note:	
26Aug21 / 27Aug21		

HARDWOOD

Inv.5095	1 - As per schedule "PE": Vendor to inlcude engineered hardwood flooring thoruhgout the second floor hallway in lieu of included carpet, as per plan, and selections as outlined in schedule A for included hardwood on the main floor. This has no cash value.	
Line 66773	Note:	
26Aug21 / 27Aug21		

HEATING AND AIR CONDITIONING

Inv.5095	1 - As per schedule "PE": Vendor to install capped gas ine ( rough in only ) at rear of home for future BBQ location. Location to be finalized at vendors sole discretion.	
Line 66770	Note:	
26Aug21 / 27Aug21		
Inv.5095	1 - As per schedule "PE": Vendor to install gas line ( rough in only ) to kichen in at stove location ( as per plan) to include 110V code requirement.	
Line 66771	Note:	
26Aug21 / 27Aug21		
Inv.5095	1 - As per schedule "PE": Vendor to supply & install air conditioning unit, sized accordingly , from vendors standard samples.	
Line 66772	Note:	
26Aug21 / 27Aug21		



CONSTRUCTION SUMMARY

Kingsmen (Thames) Inc. / Havelock Corners (Kingsmen)

Lot/Unit: 100    Phase/Building: 4B    Model/Floor Plan: Philip (4202) Elev A 4 Bed - 2+1 Bath

EXTRAS AS PER OFFER

5 FREE APPLIANCES – STAINLESS STEEL FRONT - FRIDGE: STOVE AND DISHWASHER. WHITE WASHER AND DRYER (SUPPLIED ONLY, NOT INSTALLED, FROM BUILDERS STANDARD LINE). A BAD BOY APPLIANCES VOUCHER WILL BE GIVEN BY OUR DECOR CONSULTANT AT THE TIME OF BOOKING YOUR C <i>Worksheet</i> Note:	
5 FREE APPLIANCES ? STAINLESS STEEL FRONT - FRIDGE: STOVE AND DISHWASHER. WHITE WASHER AND DRYER (SUPPLIED ONLY, NOT INSTALLED, FROM BUILDERS STANDARD LINE). A BAD BOY APPLIANCES VOUCHER WILL BE GIVEN BY OUR DECOR CONSULTANT AT THE TIME OF BOOKING YOUR C <i>Worksheet</i> Note:	
VENDOR TO INSTALL CAPPED GAS LINE (ROUGH-IN ONLY) AT REAR OF HOME FOR FUTURE BBQ LOCATION.    LOCATION TO BE FINALIZED AT VENDORS SOLE DISCRETION. <i>Worksheet</i> Note:	
VENDOR TO INSTALL GAS LINE (ROUGH-IN ONLY) TO KITCHEN IN AT STOVE LOCATION (AS PER PLAN) TO INCLUDE 110V CODE REQUIREMENT. <i>Worksheet</i> Note:	
VENDOR TO SUPPLY & INSTALL AIR CONDITIONING UNIT, SIZED ACCORDINGLY, FROM VENDORS STANDARD SAMPLES. <i>Worksheet</i> Note:	
VENDOR TO INCLUDE ENGINEERED HARDWOOD FLOORING THROUGHOUT THE SECOND FLOOR HALLWAY IN LIEU OF INCLUDED CARPET, AS PER PLAN, AND SELECTIONS AS OUTLINED IN SCHEDULE A FOR INCLUDED ENGINEERED HARDWOOD ON THE MAIN FLOOR.    THIS HAS NO CASH VALUE. <i>Worksheet</i> Note:	

**Purchasers:** RAVINDER KUMAR BHATIA & RAJNI BALA BH  
**Property:** 100 of Plan - Draft Approval SB17-03-08  
**Telephone Res. / Bus:** / **Project:** Kingsmen (Thames) Inc.  
**Decor Advisor:** Barbara Coccia **Model and Elevation:** Philip (4202) Elev A 4 Bed - 2+1 Bath  
**Layout Changes:** ☐ Yes ☒ No **Sketch Attached:** ☒ Yes ☐ No **Exterior Colour Scheme:** \_\_\_\_\_

1. Cabinetry

	Style and Colour	Counter Top	Hardware
Kitchen / Breakfast	#3 Manchester Maple Espresso CL	#1, C/S # 9141 Ice Snow 3cm.	#12881 Handle
Kitchen Island	#3 Manchester Maple Espresso CL	#1, C/S # 9141 Ice Snow 3cm.	#12881 Handle
Laundry Room	/		
Powder Room	#3 Manchester Maple Espresso CL	Calcutta Marble 4925K-07	#135 Knob
Main Bathroom	#3 Manchester Maple Espresso CL	Calcutta Marble 4925K-07	#135 Knob
Master Ensuite Bathroom	#3 Manchester Maple Espresso CL	Calcutta Marble 4925K-07	#135 Knob
Second Ensuite Bathroom (If Applicable)	/		
	/		
	/		

Appliances

Custom Size Fridge

☐ Yes
☒ No

Valance Lighting

☐ Yes
☒ No

Microwave / Range Hood

☐ Yes
☒ No

Cooktop / Rangetop

☐ Yes
☒ No

Built in Wall Oven

☐ Yes
☒ No

Slide-in Range

☐ Yes
☒ No

Comment

/

2. Flooring

	Selection
Foyer	13 x13" Malena Ice
Main Hall	3 1/2" Elements oak Bearskin
Back Hall	/
Breakfast	13 x13" Malena Ice ( incl. Service area )
Laundry Room	13 x13" Malena Ice
Kitchen	13 x13" Malena Ice
Powder Room	13 x13" Malena Ice
Main Bathroom	13 x13" Malena Ice
Master Ensuite Bathroom (If Applicable)	/
Mud Room	13 x13" Malena Ice
Master Ens. Shower floor	2 x 2" Soho Warm Grey Matte
Living Room	3 1/2" Elements oak Bearskin
Dining Room	3 1/2" Elements oak Bearskin
Family / Great Room	3 1/2" Elements oak Bearskin
Den / Library / Study	/
Basement Landing (If Applies)	
Lower Landing (If Applicable)	3 1/2" Elements oak Bearskin
Upper Landing	3 1/2" Elements oak Bearskin
Upper Hall	3 1/2" Elements oak Bearskin
Master Bedroom	Stylish Story 1, 917 Pearl Glow
Bedroom #2	Stylish Story 1, 917 Pearl Glow
Bedroom #3	Stylish Story 1, 917 Pearl Glow
Bedroom #4	Stylish Story 1, 917 Pearl Glow
Bedroom #5	/
Shower Jamb/Sill	Master Ensuite: Anatolia Marmiline SNOW

Purchasers: RAVINDER KUMAR BHATIA & RAJNI BALA BHATIA Property: 100 of Plan - Draft Approval SB17-03-08  
Telephone Res. / Bus: / Project: Kingsmen (Thames) Inc.  
Decor Advisor: Barbara Coccia Model and Elevation: Philip (4202) Elev A 4 Bed - 2+1 Bath

2. Flooring - Continued -

Upgrade Underpad	Type	Area
	Standard	Master bedroom, Bedroom #2, #3 & #4
Carpet on Stairs	Capped	Runner - *Upgrade
Comment	/	/
/		

3. Plumbing Fixtures / Faucets

Kitchen	Standard	Second Ensuite	/	Powder Room	Standard
Master Ensuite	Standard			Other Room	/
Main Bathroom	Standard		/		

Comment

Still to install the standard under mount kitchen sink with single hole kitchen faucet. Still to install top mount vanity sinks with standard lav. faucets.

4. Wall Tile

	Tile Selection	Listello	Insert	Insert Selection
Main Bathroom	8 x 10" Malena Ice	<input type="checkbox"/>	<input type="checkbox"/>	
Master Ensuite				
Tub Deck	/	<input type="checkbox"/>	<input type="checkbox"/>	
Tub Apron	/	<input type="checkbox"/>	<input type="checkbox"/>	
Tub Surround	/	<input type="checkbox"/>	<input type="checkbox"/>	
Shower Stall	8 x 10" Malena Ice	<input type="checkbox"/>	<input type="checkbox"/>	
Second Ensuite	/	<input type="checkbox"/>	<input type="checkbox"/>	
	/	<input type="checkbox"/>	<input type="checkbox"/>	
	/	<input type="checkbox"/>	<input type="checkbox"/>	
Kitchen Backsplash		<input type="checkbox"/>	<input type="checkbox"/>	
Complete Backsplash	/	<input type="checkbox"/>	<input type="checkbox"/>	

Comment

Install the standard wall tiles on the 10" side HORIZONTALLY "STACKED" in the master ensuite and main bathroom where applicable.

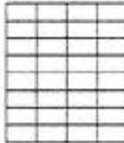

horizontal stacked



brick pattern



vertical stacked



diagonal/diamond

5. Fireplace

	Living Room			Family Room			Other Room - Specify Great Room		
	Purchased	As Per Plan	N/A	Purchased	As Per Plan	N/A	Purchased	As Per Plan	N/A
Fireplace Type	<input type="radio"/>	<input type="radio"/>	<input checked="" type="radio"/>	<input type="radio"/>	<input type="radio"/>	<input checked="" type="radio"/>	<input type="radio"/>	<input checked="" type="radio"/>	<input type="radio"/>
Mantle Type							Front Facing		
Over Mantle							NF-08		
Colour / Stain							/		
Surround							White		
Hearth							/		
Comment	/								

R.S. R.B.

Initial: \_\_\_\_\_

Page 2 of 3



4B-101100

**Purchasers:** RAVINDER KUMAR BHATIA & RAJNI BALA BH/Property: 100 of Plan - Draft Approval SB17-03-08  
**Telephone Res. / Bus:** / **Project:** Kingsmen (Thames) Inc.  
**Decor Advisor:** Barbara Coccia **Model and Elevation:** Philip (4202) Elev A 4 Bed - 2+1 Bath

### 6. Trim Carpentry

**Door Hardware** Standard Handle

**Interior Trim** Standard

**Comment**

/

#### Interior Doors

☐ 2 Panel Arch Top

☒ 2 Panel Square Top

☐ 6 Panel



Initial for Door Style

R.S.

R.S.

### 7. Railings and Pickets

**Railing Package** Standard oak Turned

**Railing Colour** Elements Bearskin

**Picket Colour** Elements Bearskin

**Wood Stairs** ☐ No ☒ Oak

**Tread Colour** Elements Bearskin

**Comment**

/

### 8. Plaster Mouldings and Medallions

**Foyer** /

**Main Hall** /

**Living Room** /

**Dining Room** /

**Family Room** /

**Kitchen/Breakfast** /

**Den/Library** /

**Lower Landing** /

**Comment**

/

### 9. Wall Paint

Kingsmen White

#### Smooth Ceilings

☐ First Floor

☐ First Floor incl. Second Floor Hall

☐ First and Second Floor

☒ Throughout

☐ Not Applicable

**Trim Paint** Kingsmen White

### 10. Additional Comments

/

### 11. Disclaimers and Notes

- Colours of all materials are as close as possible to builder's selection, but not necessarily identical due to variances in manufacturing.
- Any extras listed above are null and void unless accompanied by a separate invoice/amendment. Said invoice must be paid in full.
- The Purchaser acknowledges that after Interior Colour Selection form is signed and dated, no further changes will be permitted other than re-selection due to unavailability. R.S. R.S. Purchaser's Initials
- The Purchaser acknowledges reading and accepting the "Kingsmen Group Décor Centre Disclaimers" form. This document contains other miscellaneous disclaimers.

This Interior Colour Selection is final and approved by:

**Purchaser:** Ravinder Bhatia **Date:** AUG-27-2021

**Signature:** Rajni Bhatia **Date:** AUG-27-2021 **Vendor:** Kingsmen (Thames) Inc. Aug 30/21

SCHEDULE "B-1"  
Floor Plan

Lot: 100  
Phase 4B  
Model: Philip (4202) Elev A 4 Bed - 2+1 Bath  
Standard

sketch#1

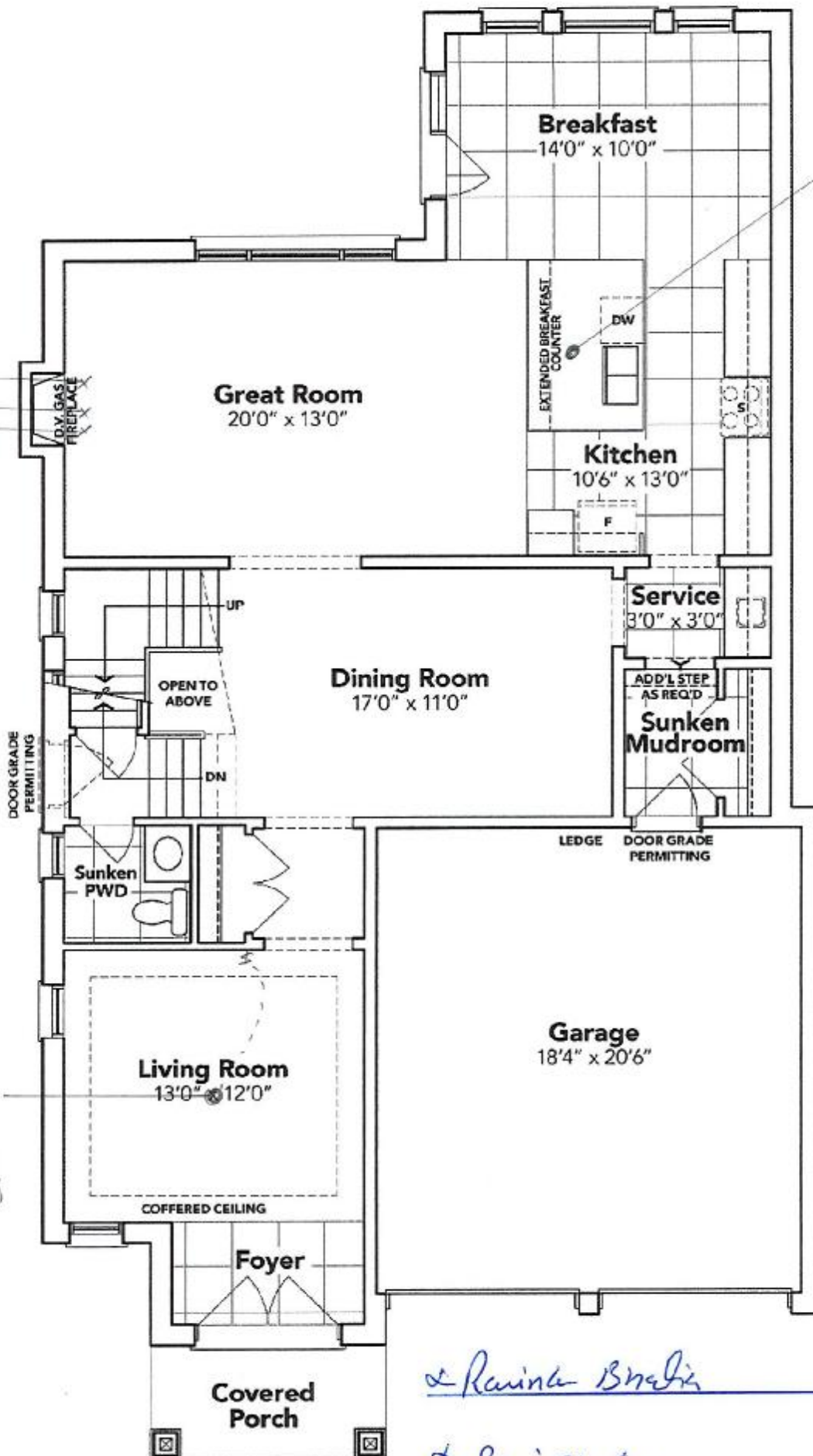

all 3 items @ approx. 66" ±  
up from floor  
✓ electrical outlet  
TV  
PWC

capped elec.  
on a step switch

capped elec.  
on a step switch

Ravina Bhatia

Ravi Bhatia

GROUND FLOOR EL. A

The floor plans and elevations shown are pre-construction plans and may be revised or improved as necessitated by architectural controls and the construction process. The measurements adhere to the rules and regulations of the TARION Warranty Corporation's official method for the calculation of floor area. Materials, specifications and floor plans are subject to change without notice. All house renderings are artist's concept only. Actual usable floor space may vary from the stated floor area. All options shown are upgrades. E. & O. E.

R.B. RB

**SCHEDULE "B-1"**  
**Floor Plan**

Lot 100  
Phase 4B  
Model: Philip (4202) Elev A 4 Bed - 2+1 Bath  
Standard

*Sketch #2*

*Relocate to old light*

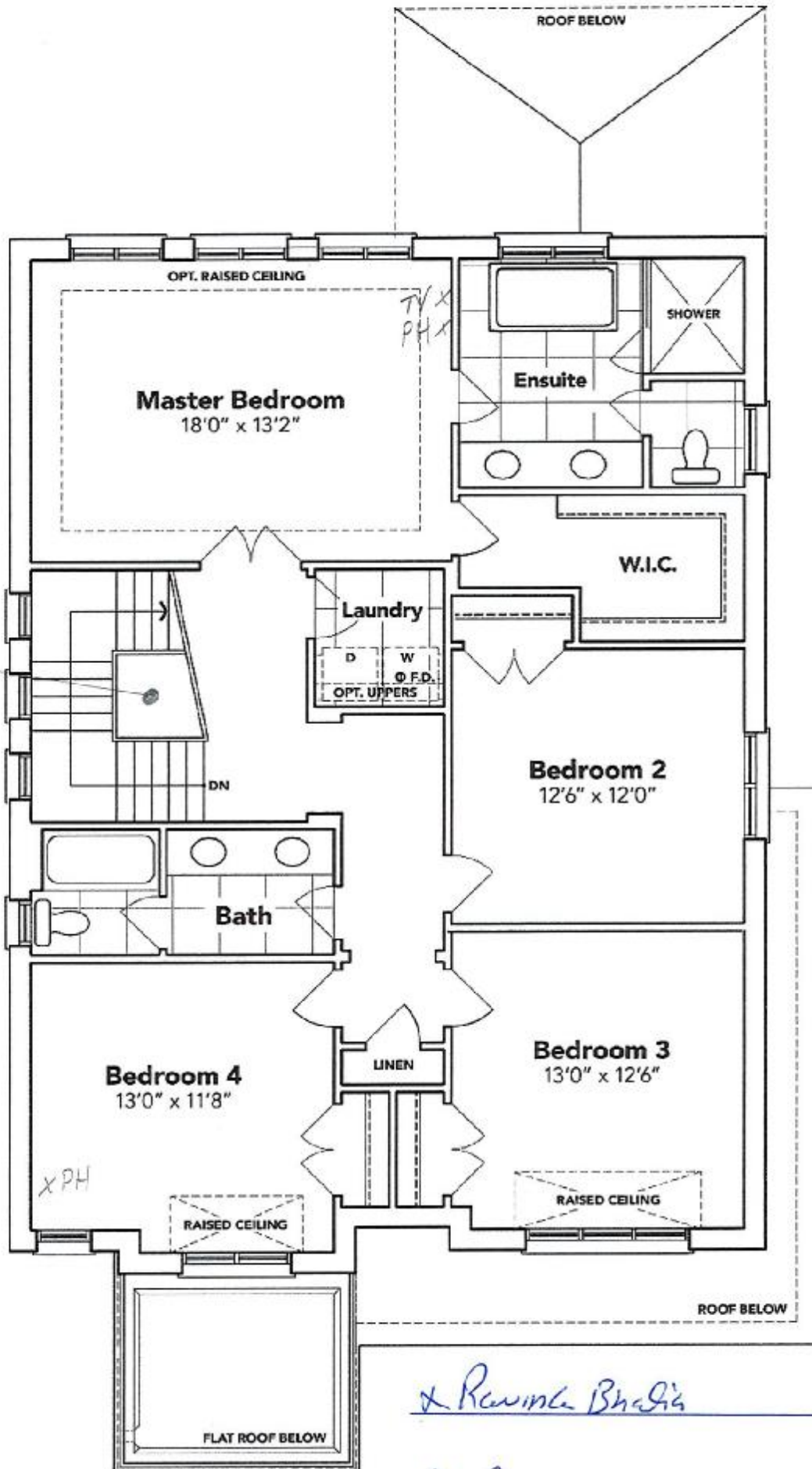

*x Ravinla Bhadia*

*x Rani Nhatie*

**SECOND FLOOR EL. A**

The floor plans and elevations shown are pre-construction plans and may be revised or improved as necessitated by architectural controls and the construction process. The measurements adhere to the rules and regulations of the TARION Warranty Corporation's official method for the calculation of floor area. Materials, specifications and floor plans are subject to change without notice. All house renderings are artist's concept only. Actual usable floor space may vary from the stated floor area. All options shown are upgrades. E. & O. E.



# SCHEDULE "B-1" Floor Plan

LOT 100  
Phase 4B  
Model: Philip (4202) Elev A 4 Bed - 2+1 Bath  
Standard

Sketch # 3

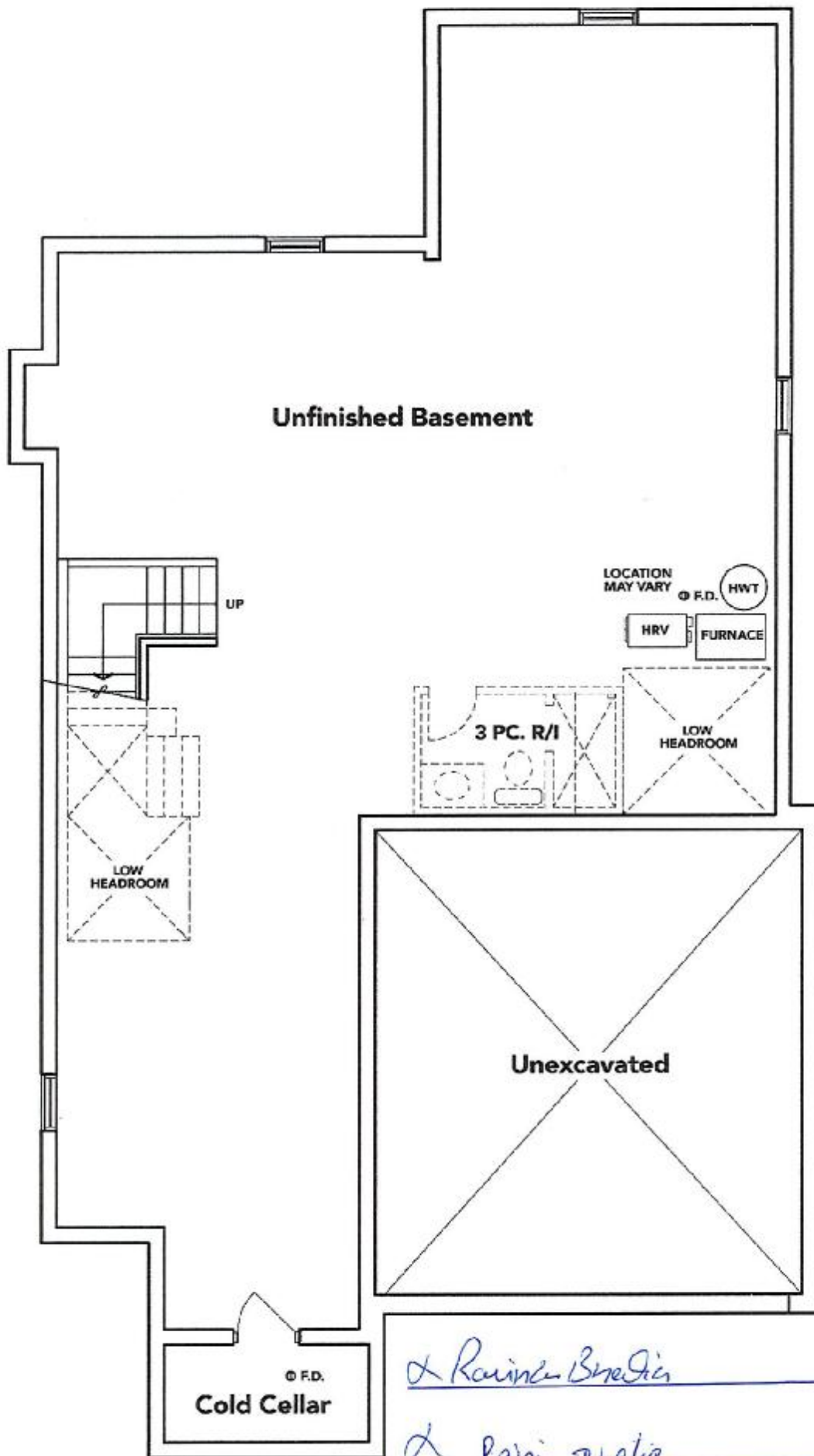

*R. B. B. B.*

*R. B. B. B.*

## BASEMENT EL. A

The floor plans and elevations shown are pre-construction plans and may be revised or improved as necessitated by architectural controls and the construction process. The measurements adhere to the rules and regulations of the TARIION Warranty Corporation's official method for the calculation of floor area. Materials, specifications and floor plans are subject to change without notice. All house renderings are artist's concept only. Actual usable floor space may vary from the stated floor area. All options shown are upgrades. E. & O. E.

SCHEDULE "B-1" - Page 1 of 3

Initials:

*R. B. B. B.*