

Kingsmen (Islington) Inc. / 9560 Islington

Lot/Unit: L101 Block 1 Phase/Building: 1 Model/Floor Plan: The Miami - 3 Bed (B5-3B)

CABINETRY

Inv.5014	1 - As Per Schedule "PE": Vendor agrees to supply and install one lower drawer in vanity in Powder Room (same as model suite) from Vendors standard samples. This item has no cash value, is non-negotiable and non-transferable.	
Line 64842	Note: See sketch #1	
20May21 / 20May21		
Inv.5014	1 - Purchaser has upgraded the kitchen sink, see spec's attached.	
Line 64869	Note:	
20May21 / 20May21		

CABINETRY ACCESSORIES

Inv.5014	3 - To supply and install LIGHT VALANCE - LIGHT VALANCE IS NOW APPROXIMATELY 2INCHES 50MM HIGH - - CLASSIC SERIES in the kitchen	
Line 64856	Note: PUCK LIGHTS HAVE BEEN PURCHASED AS A SEPARATE UPGRADE	
20May21 / 20May21		

CABINETRY APPLIANCE - FRIDGE

Inv.5014	1 - To supply and install 66CM DEEP FRIDGE ENCLOSURE - COUNTER DEPTH WITH - 1 WALL - 1 66CM DEEP GABLE AND 1 66CM DEEP CABINET - THIS IS NOT A ZERO CLEARANCE ENCLOSURE. STANDARD HEIGHTS AND WIDTHS WILL BE USED. - CLASSIC SERIES in the kitchen	
Line 64857	Note:	
20May21 / 20May21		

CABINETRY BASE CABINETS

Inv.5014	2 - To supply and install TWO POTS & PANS DRAWER - - SIZE SUBJECT TO FLOOR PLAN - CLASSIC SERIES on the island in the kitchen.. see sketch #1	
Line 64858	Note:	
20May21 / 20May21		

CABINETRY HOOD FANS

Inv.5014	1 - To ACCOMMODATE FOR MICROWAVE HOOD FAN COMBO - CLASSIC SERIES in the kitchen	
Line 64852	Note: NO OTR HAS BEEN PURCHASED STILL TO INSTALL THE STANDARD HOODFAN	
20May21 / 20May21		

CABINETRY VANITY

Inv.5014	2 - To supply and install a VANITY LOWER DRAWER PRICE - CLASSIC SERIES in the Master Ensuite.. see sketch #1	
Line 64859	Note:	
20May21 / 20May21		
Inv.5014	2 - To supply and install a VANITY - LOWER DRAWER CLASSIC SERIES in the Main Bathroom.. see sketch #1	
Line 64860	Note:	
20May21 / 20May21		

Kingsmen (Islington) Inc. / 9560 Islington

Lot/Unit: L101 Block 1 Phase/Building: 1 Model/Floor Plan: The Miami - 3 Bed (B5-3B)

Inv.5014	1 - To INCREASE VANITY TO KITCHEN HEIGHT - 90CM HIGH - MAINTAINS VANITY DEPTH - CLASSIC SERIES in the Powder Room	
Line 64861	Note:	
20May21 / 20May21		
Inv.5014	1 - To INCREASE VANITY TO KITCHEN HEIGHT - 90CM HIGH - MAINTAINS VANITY DEPTH - CLASSIC SERIES in the Master Ensuite	
Line 64862	Note:	
20May21 / 20May21		
Inv.5014	1 - To INCREASE VANITY TO KITCHEN HEIGHT 90CM HIGH - MAINTAINS VANITY DEPTH - CLASSIC SERIES in the Main Bathroom	
Line 64863	Note:	
20May21 / 20May21		

COUNTER TOP

Inv.5014	1 - As per Schedule "PE": Vendor agrees to supply and install quartz or granite counertops in kitchen and all bathrooms from standard samples of the Vendor. This promotion has no cash value, is non-negotiable and non-transferable.	
Line 64844	Note:	
20May21 / 20May21		

DOORS

Inv.5014	1 - To supply and install INTERIOR DOORS - UPGRADE TO LIVINGSTON HOLLOW CORE in lieu of the standard..	
Line 64864	Note:	
20May21 / 20May21		

ELECTRICAL

Inv.5014	1 - To supply and install the standard T.V Rough-in, in the Living Room and Master Bedroom.. see sketch #1	
Line 64845	Note:	
20May21 / 20May21		
Inv.5014	1 - To supply and install the standard Phone (CAT 5) rough-in, in the Living Room, Master Bedroom and Bedroom #2.. see sketch #1	
Line 64846	Note:	
20May21 / 20May21		
Inv.5014	1 - To supply & install an additional CAT 5 (phone) rough in in bedroom # 3... see sketch #1	
Line 64847	Note:	
20May21 / 20May21		
Inv.5014	1 - To supply and install a rough in capped electrical rough-in on a separate switch, in the Living Room.. see sketch #1	
Line 64848	Note:	
20May21 / 20May21		
Inv.5014	1 - To supply and install a capped electrical rough-in on a separate switch, over the breakfast bar..see sketch #1	
Line 64849	Note:	
20May21 / 20May21		

Kingsmen (Islington) Inc. / 9560 Islington

Lot/Unit: L101 Block 1 Phase/Building: 1 Model/Floor Plan: The Miami - 3 Bed (B5-3B)

Inv.5014	1 - To supply and install THREE UNDER CABINET PUCK LIGHTS (CA360WH) on a separate switch in the Kitchen.. see sketch #	
Line 64850	Note: LOWER VALENCE TRIM HAS BEEN PURCHASED AS A SEPARATE UPGRADE.	
20May21 / 20May21		
Inv.5014	1 - To supply and install the elec. required for a future OTR MICROWAVE HOOD	
Line 64851	Note: STILL TO INSTALL THE STANDARD HOODFAN. NO OTR HAS BEEN PURCHASED	
20May21 / 20May21		

HARDWARE

Inv.5014	1 - To supply and install DOOR HARDWARE - UPGRADE TO HALIFAX SQUARE SERIES - IRON BLACK - 514 (MATCHING HINGES INCLUDED) in lieu of the standard	
Line 64865	Note:	
20May21 / 20May21		

HARDWOOD

Inv.5014	1 - As Per Schedule "PE": The Vendor agrees to supply and install hardwood flooring in all bedrooms from standard samples of the Vendor. This promotion has no cash value, is non-negotiable and non-transferable.	
Line 64843	Note:	
20May21 / 20May21		

PLUMBING

Inv.5014	3 - To supply and install the CONTRAC CATENA MODEL #4210CIY in the Powder Room, Master Ensuite and Main Bathroom.. see spec's	
Line 64853	Note: STILL TO INSTALL THE STANDARD FAUCETS	
20May21 / 20May21		
Inv.5014	1 - To supply and install the Quatrus U2 MODEL #401247 in the kitchen in lieu of the standard sink.. see spec's	
Line 64854	Note: STILL TO INSTALL THE STANDARD FAUCET	
20May21 / 20May21		
Inv.5014	1 - To supply and install a Soap Dispenser Model #3944 in Chrome in the kitchen.. see spec's and sketch #1	
Line 64855	Note:	
20May21 / 20May21		

TILE - WALL

Inv.5014	1 - To supply and install UPGRADE 2 - BACKSPLASH - - BACKSPLASH TILE in the kitchen	
Line 64867	Note:	
20May21 / 20May21		
Inv.5014	1 - To supply and install TILE - WALL - BACKSPLASH - UPGRADE 2 - 70/30 OFF SET BRICK PATTERN.. see sketch #1	
Line 64868	Note:	
20May21 / 20May21		



CONSTRUCTION SUMMARY

Kingsmen (Islington) Inc. / 9560 Islington

Lot/Unit: L101 Block 1 Phase/Building: 1 Model/Floor Plan: The Miami - 3 Bed (B5-3B)

EXTRAS AS PER OFFER

5 Appliances including Stainless Steel Fridge, Stove, Dishwasher and white Washer / Dryer, from the standard offer of the Vendor. This promotion has no cash value, is non-negotiable and non-transferrable. <i>Worksheet</i> Note:	
Vendor agrees to supply and install hardwood flooring in all bedrooms from standard samples of the Vendor. This promotion has no cash value, is non-negotiable and non-transferrable. <i>Worksheet</i> Note:	
Vendor agrees to supply and install one lower drawer in vanity in Powder Room (same as model suite) from Vendors standard samples. This item has no cash value, is non-negotiable and non-tranferrable. <i>Worksheet</i> Note:	
Vendor agrees to supply and install quartz or granite countertops in kitchen and all bathrooms from standard samples of the Vendor. This promotion has no cash value, is non-negotiable and non-tranferrable. <i>Worksheet</i> Note:	

Purchaser: SOMARATNE HETTIARACHCHIGE

Property: L101 Block 1 of Plan -

Telephone Res. / Bus: /

Project: Kingsmen (Islington) Inc.

Decor Advisor: Barbara Coccia

Model and Elevation: The Miami - 3 Bed (B5-3B)

Layout Changes: ☐ Yes ☒ No Sketch Attached: ☐ Yes ☒ No Exterior Colour Scheme:

1. Cabinetry

	Style and Colour	Counter Top	Hardware
Kitchen / Breakfast	#3 Manchester Maple Espresso CL	#1 C/S #9141 Ice Snow 3cm	12881 Handle
Kitchen Island	#3 Manchester Maple Espresso CL	#1 C/S #9141 Ice Snow 3cm	12881 Handle
Laundry Room	/	/	/
Powder Room	#3 Manchester Maple Espresso CL	#1 C/S #9141 Ice Snow 3cm	12881 Handle
Main Bathroom	#3 Manchester Maple Espresso CL	#1 C/S #9141 Ice Snow 3cm	12881 Handle
Master Ensuite Bathroom	#3 Manchester Maple Espresso CL	#1 C/S #9141 Ice Snow 3cm	12881 Handle
Second Ensuite Bathroom (If Applicable)	/	/	/
	/	/	/
	/	/	/

Appliances

Custom Size Fridge

☐ Yes ☒ No

Valance Lighting

☒ Yes ☐ No

Microwave / Range Hood

☒ Yes ☐ No

Cooktop / Rangetop

☐ Yes ☒ No

Built in Wall Oven

☐ Yes ☒ No

Slide-in Range

☐ Yes ☒ No

Comment

2. Flooring

Selection

	/
Main Hall	/
Back Hall	/
Breakfast	/
Laundry Room	13x13" Cinq Grey
Kitchen	5" Elements Brushed Oak Wolverine
Powder Room	13x13" Keaton Ice
Main Bathroom	13x13" Keaton Ice
Master Ensuite	13x13" Keaton Ice
Bathroom (If Applicable)	/
Mud Room	/
Master Ensuite Shower Floor	2x2" Soho White Matte
Living Room	5" Elements Brushed Oak Wolverine
Dining Room	5" Elements Brushed Oak Wolverine
Family / Great Room	/
Den / Library / Study	/
Basement Landing (If Applies)	
Lower Landing (If Applicable)	5" Elements Brushed Oak Wolverine (If applicable)
Upper Landing	5" Elements Brushed Oak Wolverine (If applicable)
Upper Hall	(Lower Hallway)-5" Elements Brushed Oak Wolverine
Master Bedroom	5" Elements Brushed Oak Wolverine
Bedroom #2	5" Elements Brushed Oak Wolverine
Bedroom #3	5" Elements Brushed Oak Wolverine
Bedroom #4	/
Bedroom #5	/

Flooring Continued on Page 2

Initial: 

Page 1 of 3

Purchaser: SOMARATNE HETTIARACHCHIGE

Property: L101 Block 1 of Plan -

Telephone Res. / Bus: /

Project: Kingsmen (Islington) Inc.

Decor Advisor: Barbara Coccia

Model and Elevation: The Miami - 3 Bed (B5-3B)

2. Flooring - Continued -

Upgrade Underpad	Type	Area
	/	/
Carpet on Stairs	Capped	Runner - *Upgrade
Comment	/	/
/		

3. Plumbing Fixtures / Faucets

Kitchen	Standard	Second Ensuite	/	Powder Room	Standard
Master Ensuite	Standard			Other Room	/
Main Bathroom	Standard		/		

Comment

NOTE: Purchaser has upgraded kitchen sink.. still to install the standard faucet. Purchaser has upgraded all bathroom sinks.. still to install the standard faucets.

4. Wall Tile

	Tile Selection	Listello	Insert	Insert Selection
Main Bathroom	8x10" Keaton Ice	<input type="checkbox"/>	<input type="checkbox"/>	/
Master Ensuite				
Tub Deck	/	<input type="checkbox"/>	<input type="checkbox"/>	/
Tub Apron	/	<input type="checkbox"/>	<input type="checkbox"/>	/
Tub Surround	/	<input type="checkbox"/>	<input type="checkbox"/>	/
Shower Stall	8x10" Keaton Ice	<input type="checkbox"/>	<input type="checkbox"/>	/
Second Ensuite	/	<input type="checkbox"/>	<input type="checkbox"/>	/
	/	<input type="checkbox"/>	<input type="checkbox"/>	/
	/	<input type="checkbox"/>	<input type="checkbox"/>	/
Kitchen Backsplash	*4x16" Warm Grey Glossy 50-503 , 70/30 off set brick patt	<input type="checkbox"/>	<input type="checkbox"/>	/
Complete Backsplash	/	<input type="checkbox"/>	<input type="checkbox"/>	/

Comment



horizontal stacked

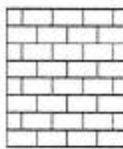

brick pattern



vertical stacked



diagonal diamond

5. Fireplace

	Living Room			Family Room			Other Room - Specify		
	Purchased	As Per Plan	N/A	Purchased	As Per Plan	N/A	Purchased	As Per Plan	N/A
Fireplace Type	<input type="radio"/>	<input type="radio"/>	<input checked="" type="radio"/>	<input type="radio"/>	<input type="radio"/>	<input checked="" type="radio"/>	<input type="radio"/>	<input type="radio"/>	<input checked="" type="radio"/>
Mantle Type									
Over Mantle									
Colour / Stain									
Surround									
Hearth									
Comment	/								

Initial: 

Page 2 of 3

Purchaser: SOMARATNE HETTIARACHCHIGE

Property: L101 Block 1 of Plan -

Telephone Res. / Bus: /

Project: Kingsmen (Islington) Inc.

Decor Advisor: Barbara Coccia

Model and Elevation: The Miami - 3 Bed (B5-3B)

6. Trim Carpentry

Door Hardware ☒ Upgraded

Interior Trim ☐ Standard

Comment

NOTE: PURCHASER HAS UPGRADED ALL INTERIOR DOORS

Interior Doors

☐ 2 Panel Arch Top

☐ 2 Panel Square Top

☐ 6 Panel

Initial for Door Style

7. Railings and Pickets

Railing Package ☐ Standard Metal Package

Railing Colour ☐ Elements Wolverine

Picket Colour ☐ Black Metal

Wood Stairs ☐ No ☒ Oak

Tread Colour ☐ Elements Wolverine

Comment

8. Plaster Mouldings and Medallions

Foyer	/	/	Kitchen/Breakfast	/	/
Main Hall	/	/	Den/Library	/	/
Living Room	/	/	Lower Landing	/	/
Dining Room	/	/	/	/	/
Family Room	/	/			

Comment

9. Wall Paint

Kingsmen White

Smooth Ceilings ☐ First Floor
☐ First Floor incl. Second Floor Hall
☐ First and Second Floor
☒ Throughout
☐ Not Applicable

Trim Paint ☐ Kingsmen White

10. Additional Comments

11. Disclaimers and Notes

- Colours of all materials are as close as possible to builder's selection, but not necessarily identical due to variances in manufacturing.
- Any extras listed above are null and void unless accompanied by a separate invoice/amendment. Said invoice must be paid in full.
- The Purchaser acknowledges that after Interior Colour Selection form is signed and dated, no further changes will be permitted other than re-selection due to unavailability.  Purchaser's Initials
- The Purchaser acknowledges reading and accepting the "Kingsmen Group Décor Centre Disclaimers" form. This document contains other miscellaneous disclaimers.

This Interior Colour Selection is final and approved by:

Purchaser:

Signature: 

Date: 20th May 2021

Vendor:

Kingsmen (Islington) Inc.

May 26, 21

SCHEDULE "B-1" **Floor Plan**

Townhouse No. L101 Block 1
Phase 1
Model: The Miami - 3 Bed (B5-3B)

Sketch #1

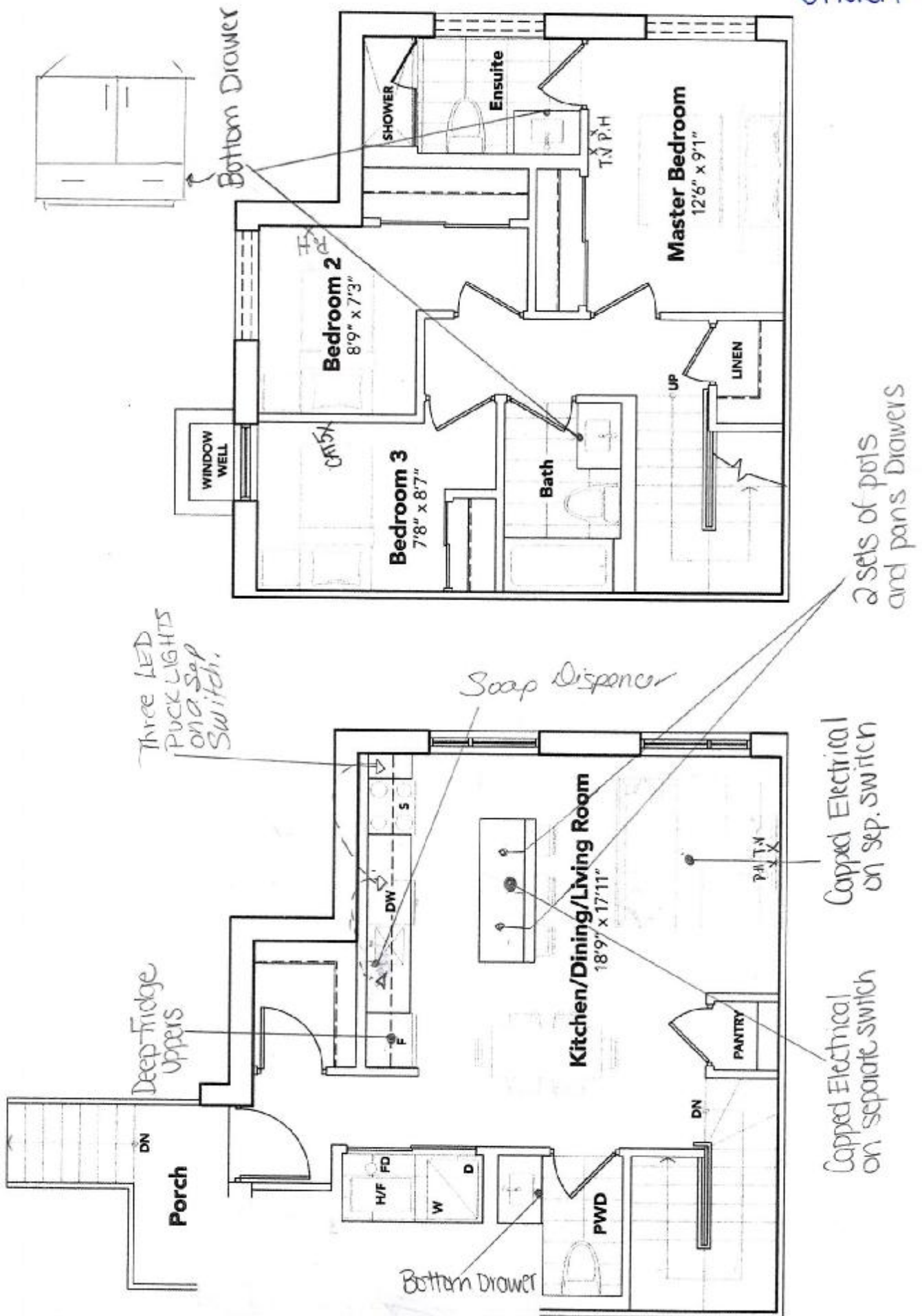

The floor plans and elevations shown are pre-construction plans and may be revised or improved as necessitated by architectural controls and the construction process. The measurements adhere to the rules and regulations of the TARIION Warranty Corporation's official method for the calculation of floor area. Materials, specifications and floor plans are subject to change without notice. All house renderings are artist's concept only. Actual usable floor space may vary from the stated floor area. All options shown are upgrades. L. & O. E.

Initials: _____

9560 ISLINGTON: UNIT L101
RE: UPG SINKS (PWD,
MASTER ENSUITE AND MAIN
BATHROOM)

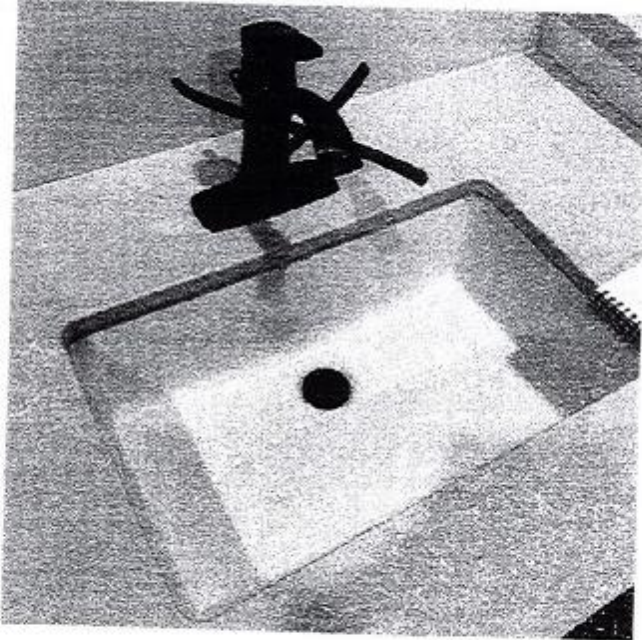

DISPLAY ITEMS

Sink (Item 9)

Contrac Catena Undermount
Model 4210CIY

A handwritten signature in blue ink, appearing to read 'Tomas', is written over a horizontal line.

9560 ISLINGTON: UNIT L101
RE: UPG KITCHEN SINK &
SOAP DISPENSER

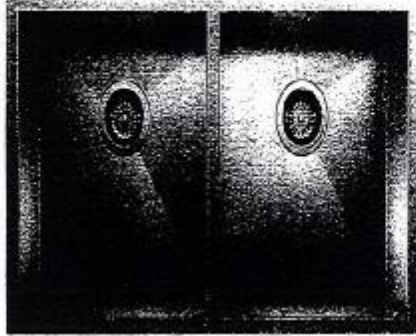

QUATRUS U2

MODEL: 401247.

Common engineered with 264 series, 18-gauge stainless steel

Zero-radius corners, 3-patten design grooves

Double bowl configuration for easy multi-tasking

18/10 chrome-nickel content for exceptional looks, durability and strength

Undermount installation

Minimum cabinet size: 26"



Transitional Soap or
Lotion Dispenser

Model 3942

Chrome

A 