

Kingsmen (Islington) Inc. / 9560 Islington

Lot/Unit: L108 Block 1 Phase/Building: 1 Model/Floor Plan: The Sydney - 2 Bed (B3-2B)

CABINETRY ACCESSORIES

Inv.5009	1 - To supply and install CABINETRY - OPTIONAL LIGHT VALANCE - UPGRADE 1 - CLASSIC COLLECTION - CLASSIC I in the kitchen	
Line 64789	Note:	
19May21 / 19May21		

CABINETRY APPLIANCE - FRIDGE

Inv.5009	1 - To supply and install 66CM DEEP FRIDGE ENCLOSURE - COUNTER DEPTH WITH - 1 WALL - 1 66CM DEEP GABLE AND 1 66CM DEEP CABINET - THIS IS NOT A ZERO CLEARANCE ENCLOSURE. STANDARD HEIGHTS AND WIDTHS WILL BE USED. - CLASSIC SERIES in the kitchen.. see sketch #1	
Line 64791	Note:	
19May21 / 19May21		

CABINETRY BASE CABINETS

Inv.5009	1 - To supply and install a BASE PIE CUT CORNER - CLASSIC SERIES in the kitchen.. see sketch #1	
Line 64794	Note: Due to this upgrade the standard bank of drawers in the kitchen needs to be relocate... see sketch #1	
19May21 / 19May21		
Inv.5009	1 - To supply and install a POTS & PANS DRAWER - SIZE SUBJECT TO FLOOR PLAN - CLASSIC SERIES- in the kitchen.. see sketch #1	
Line 64795	Note:	
19May21 / 19May21		

CABINETRY HOOD FANS

Inv.5009	1 - To ACCOMMODATE FOR FUTURE MICROWAVE HOOD FAN COMBO - CLASSIC SERIES in the KITCHEN	
Line 64786	Note: NO OTR HAS BEEN PURCHASE STILL TO INSTALL THE STANDARD HOODFAN	
19May21 / 19May21		

CABINETRY VANITY

Inv.5009	2 - To supply and install a VANITY LOWER DRAWER PRICE - CLASSIC SERIES in the Master Ensuite.. see sketch #1	
Line 64796	Note:	
19May21 / 19May21		
Inv.5009	2 - To supply and install a VANITY LOWER DRAWER PRICE - CLASSIC SERIES- in the Main Bathroom.. see sketch #1	
Line 64797	Note:	
19May21 / 19May21		

CABINETRY WALL AND HUTCH

Inv.5009	1 - To supply and install a COMBO - UPPER ANGLE CORNER PER UNIT WITH GLASS DOOR AND FINISHED INTERIOR - CLEAR -GLASS - CLASSIC SERIES in the kitchen.. see sketch #1	
Line 64798	Note:	
19May21 / 19May21		

COUNTER TOP



CONSTRUCTION SUMMARY

Kingsmen (Islington) Inc. / 9560 Islington

Lot/Unit: L108 Block 1 Phase/Building: 1 Model/Floor Plan: The Sydney - 2 Bed (B3-2B)

Inv.5009	1 - As per schedule "PE": Vendor agrees to supply and install quartz countertops in kitchen and all bathrooms from standard samples of the Vendor. This promotion has no cash value, is non-negotiable and non-transferrable.	
Line 64774	Note:	
19May21 / 19May21		

ELECTRICAL

Inv.5009	1 - To supply and install the standard Phone (CAT 5) rough-in, in the Living Room, Master Bedroom and Bedroom #2.. see sketch #1 To supply and install the standard T.V rough-in, in the Living Room and Master Bedroom.. see sketch #1	
Line 64780	Note:	
19May21 / 19May21		
Inv.5009	1 - To supply and install an additional T.V rough-in, in bedroom #2.. see sketch #1	
Line 64781	Note:	
19May21 / 19May21		
Inv.5009	1 - To supply and install a elec. outlet at approx. 66"+- up from the floor in the living room...see sketch #1	
Line 64782	Note: THIS IS FOR FUTURE WALL MOUNT T.V	
19May21 / 19May21		
Inv.5009	1 - To supply and install a conduit pipe in the living room, next to +- the upgraded elec. outlet, terminated next to +- the standard T.V and Phone rough-in.. see sketch #1	
Line 64783	Note: STILL IS FOR A FUTURE WALL MOUNT T.V	
19May21 / 19May21		
Inv.5009	1 - To supply and install a capped rough in electrical connected to a separate switch in the living room.. see sketch #1	
Line 64784	Note: NO LIGHT FIXTURE HAS BEEN PURCHASED.	
19May21 / 19May21		
Inv.5009	1 - To supply and install an electrical required for the future OTR OVER THE COUNTER MICROWAVE/RANGEHOOD	
Line 64785	Note: NO OTR HAS BEEN PURCHASED STILL TO INSTALL THE STANDARD HOODFAN	
19May21 / 19May21		
Inv.5009	1 - To supply and install FOUR LED UNDER CABINET PUCK LIGHTS (CA360WH) in the kitchen on a separate switch.. see sketch #1	
Line 64787	Note: Lower valance trim sold sep.	
19May21 / 19May21		

HARDWOOD

Inv.5009	1 - As per schedule "PE": Vendor agrees to supply and install hardwood flooring in all bedrooms from standard samples of the Vendor. This promotion has no cash value, is non-negotiable and non-transferrable.	
Line 64773	Note:	
19May21 / 19May21		

PLUMBING



CONSTRUCTION SUMMARY

Kingsmen (Islington) Inc. / 9560 Islington

Lot/Unit: L108 Block 1 Phase/Building: 1 Model/Floor Plan: The Sydney - 2 Bed (B3-2B)

Inv.5009	3 - To supply and install the Contrac Catena 4210CIY in the Powder Room, Master Ensuite and Main Bathroom in lieu of the standard topmount sinks.. see spec's	
Line 64790	Note: STILL TO INSTALL THE STANDARD FAUCETS.	
19May21 / 19May21		

EXTRAS AS PER OFFER

5 Appliances including Stainless Steel Fridge, Stove, Dishwasher and white Washer / Dryer, from the standard offer of the Vendor. This promotion has no cash value, is non-negotiable and non-transferrable. <i>Worksheet</i> Note:	
Vendor agrees to supply and install hardwood flooring in all bedrooms from standard samples of the Vendor. This promotion has no cash value, is non-negotiable and non-transferrable. <i>Worksheet</i> Note:	
Vendor agrees to supply and install quartz countertops in kitchen all bathrooms from standard samples of the Vendor. This promotion has no cash value, is non-negotiable and non-transferrable. <i>Worksheet</i> Note:	

Purchasers: ROSARIO ADAMO & DOMENICA ADAMO

Property: L108 Block 1 of Plan -

Telephone Res. / Bus: /

Project: Kingsmen (Islington) Inc.

Decor Advisor: Barbara Coccia

Model and Elevation: The Sydney - 2 Bed (B3-2B)

Layout Changes: ☐ Yes ☒ No

Sketch Attached: ☒ Yes ☐ No

Exterior Colour Scheme:

1. Cabinetry

	Style and Colour	Counter Top	Hardware
Kitchen / Breakfast	#3 Simcoe Orchid	#1 C/S #3040 Cement 3cm	12881 Handle
Kitchen Island	#3 Simcoe Orchid	#1 C/S #3040 Cement 3cm	12881 Handle
Laundry Room	/	/	/
Powder Room	#3 Charleston 3DL Orchid	#1 C/S #9141 Ice Snow 2cm	135 Knob
Main Bathroom	#3 Charleston 3DL Orchid	#1 C/S #9141 Ice Snow 2cm	135 Knob
Master Ensuite Bathroom	#3 Charleston 3DL Orchid	#1 C/S #9141 Ice Snow 2cm	135 Knob
Second Ensuite Bathroom (If Applicable)	/	/	/
	/	/	/
	/	/	/

Appliances

Custom Size Fridge

☐ Yes ☒ No

Valance Lighting

☒ Yes ☐ No

Microwave / Range Hood

☒ Yes ☐ No

Cooktop / Rangetop

☐ Yes ☒ No

Built in Wall Oven

☐ Yes ☒ No

Slide-in Range

☐ Yes ☒ No

Comment

2. Flooring

Selection

Main Hall	/
Back Hall	/
Breakfast	/
Laundry Room	13x13" Cinq Grey
Kitchen	5" Elements Brushed Oak Coho
Powder Room	13x13" Malena Ice
Main Bathroom	13x13" Malena Ice
Master Ensuite	13x13" Malena Carbon
Bathroom (If Applicable)	/
Mud Room	/
Master Ensuite Shower Floor	2x2" Soho White Matte
Living Room	5" Elements Brushed Oak Coho
Dining Room	5" Elements Brushed Oak Coho BC.
Family / Great Room	/
Den / Library / Study	/
Basement Landing (If Applies)	/
Lower Landing (If Applicable)	5" Elements Brushed Oak Coho
Upper Landing	5" Elements Brushed Oak Coho
Upper Hall	(Lower Hallway)-5" Elements Brushed Oak Coho
Master Bedroom	5" Elements Brushed Oak Coho
Bedroom #2	5" Elements Brushed Oak Coho
Bedroom #3	/
Bedroom #4	/
Bedroom #5	/

Flooring Continued on Page 2

Initial:

Page 1 of 3

Purchasers: ROSARIO ADAMO & DOMENICA ADAMO

Property: L108 Block 1 of Plan -

Telephone Res. / Bus: /

Project: Kingsmen (Islington) Inc.

Decor Advisor: Barbara Coccia

Model and Elevation: The Sydney - 2 Bed (B3-2B)

2. Flooring - Continued -

Upgrade Underpad	Type	Area
	/	/
Carpet on Stairs	Capped	Runner - *Upgrade
Comment	/	/

3. Plumbing Fixtures / Faucets

Kitchen	Standard	Second Ensuite	/	Powder Room	Standard
Master Ensuite	Standard			Other Room	/
Main Bathroom	Standard		/		

Comment

NOTE: Still to install the standard undermount kitchen sink and faucet. To supply upgraded sinks in all bathrooms, still to install the standard faucet.

4. Wall Tile

	Tile Selection	Listello	Insert	Insert Selection
Main Bathroom	8x10" Malena Carbon	<input type="checkbox"/>	<input type="checkbox"/>	/
Master Ensuite				
Tub Deck	/	<input type="checkbox"/>	<input type="checkbox"/>	/
Tub Apron	/	<input type="checkbox"/>	<input type="checkbox"/>	/
Tub Surround	/	<input type="checkbox"/>	<input type="checkbox"/>	/
Shower Stall	8x10" Malena Carbon	<input type="checkbox"/>	<input type="checkbox"/>	/
Second Ensuite	/	<input type="checkbox"/>	<input type="checkbox"/>	/
	/	<input type="checkbox"/>	<input type="checkbox"/>	/
	/	<input type="checkbox"/>	<input type="checkbox"/>	/
Kitchen Backsplash	/	<input type="checkbox"/>	<input type="checkbox"/>	/
Complete Backsplash	/	<input type="checkbox"/>	<input type="checkbox"/>	/

Comment

//

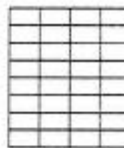

horizontal stacked

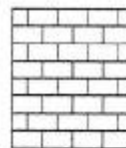

brick pattern



vertical stacked



diagonal/diamond

5. Fireplace

	Living Room			Family Room			Other Room - Specify		
	Purchased	As Per Plan	N/A	Purchased	As Per Plan	N/A	Purchased	As Per Plan	N/A
Fireplace Type	<input type="radio"/>	<input type="radio"/>	<input checked="" type="radio"/>	<input type="radio"/>	<input type="radio"/>	<input checked="" type="radio"/>	<input type="radio"/>	<input type="radio"/>	<input checked="" type="radio"/>

Mantle Type			
Over Mantle			
Colour / Stain			
Surround			
Hearth			

Comment

/

Initial:

[Handwritten initials]

Purchasers: ROSARIO ADAMO & DOMENICA ADAMO

Property: L108 Block 1 of Plan -

Telephone Res. / Bus: /

Project: Kingsmen (Islington) Inc.

Decor Advisor: Barbara Coccia

Model and Elevation: The Sydney - 2 Bed (B3-2B)

6. Trim Carpentry

Door Hardware: Standard Handle

Interior Trim: Standard

Comment:

Interior Doors

☐ 2 Panel Arch Top

☒ 2 Panel Square Top

☐ 6 Panel

Initial for Door Style

7. Railings and Pickets

Railing Package: Standard Black Metal Package

Railing Colour: Elements Coho

Picket Colour: Black Metal

Wood Stairs: ☐ No ☒ Oak

Tread Colour: Elements Coho

Comment:

8. Plaster Mouldings and Medallions

Foyer: / /

Kitchen/Breakfast: / /

Main Hall: / /

Den/Library: / /

Living Room: / /

Lower Landing: / /

Dining Room: / /

Family Room: / /

Comment:

9. Wall Paint

Kingsmen White

Smooth Ceilings: ☐ First Floor

☐ First Floor incl. Second Floor Hall

☐ First and Second Floor

☒ Throughout

☐ Not Applicable

Trim Paint: Kingsmen White

10. Additional Comments

11. Disclaimers and Notes

- Colours of all materials are as close as possible to builder's selection, but not necessarily identical due to variances in manufacturing.
- Any extras listed above are null and void unless accompanied by a separate invoice/amendment. Said invoice must be paid in full.
- The Purchaser acknowledges that after Interior Colour Selection form is signed and dated, no further changes will be permitted other than re-selection due to unavailability. Purchaser's Initials
- The Purchaser acknowledges reading and accepting the "Kingsmen Group Décor Centre Disclaimers" form. This document contains other miscellaneous disclaimers.

This Interior Colour Selection is final and approved by:

Purchaser:

Signature: [Signature]

Date: 19-05-2021

Signature: [Signature]

Date: 19.05.21

Vendor: [Signature]

Kingsmen (Islington) Inc. May 19, 21

Townhouse No. **L108 Block 1**
Phase 1
Model: **The Sydney - 2 Bed (B3-2B)**

The floor plan for the second floor includes the following details:

- Bedroom 2:** Located on the left side, measuring 12'7" x 8'8". It contains a bed and a window labeled "T.V. P.C.H".
- Ensuite:** Attached to Bedroom 2, containing a toilet and a sink.
- Master Bedroom:** Located on the right side, measuring 13'3" x 8'8". It contains a bed and a window labeled "P.C.H. T.V".
- Ensuite:** Attached to the Master Bedroom, containing a toilet, a sink, and a shower labeled "SHOWER".
- Linen Closet:** Located at the top of the plan, labeled "LINEN".
- Window Well:** Located at the bottom left, labeled "WINDOW WELL".
- Stairs:** A set of stairs labeled "UP" is located between the two bedrooms.

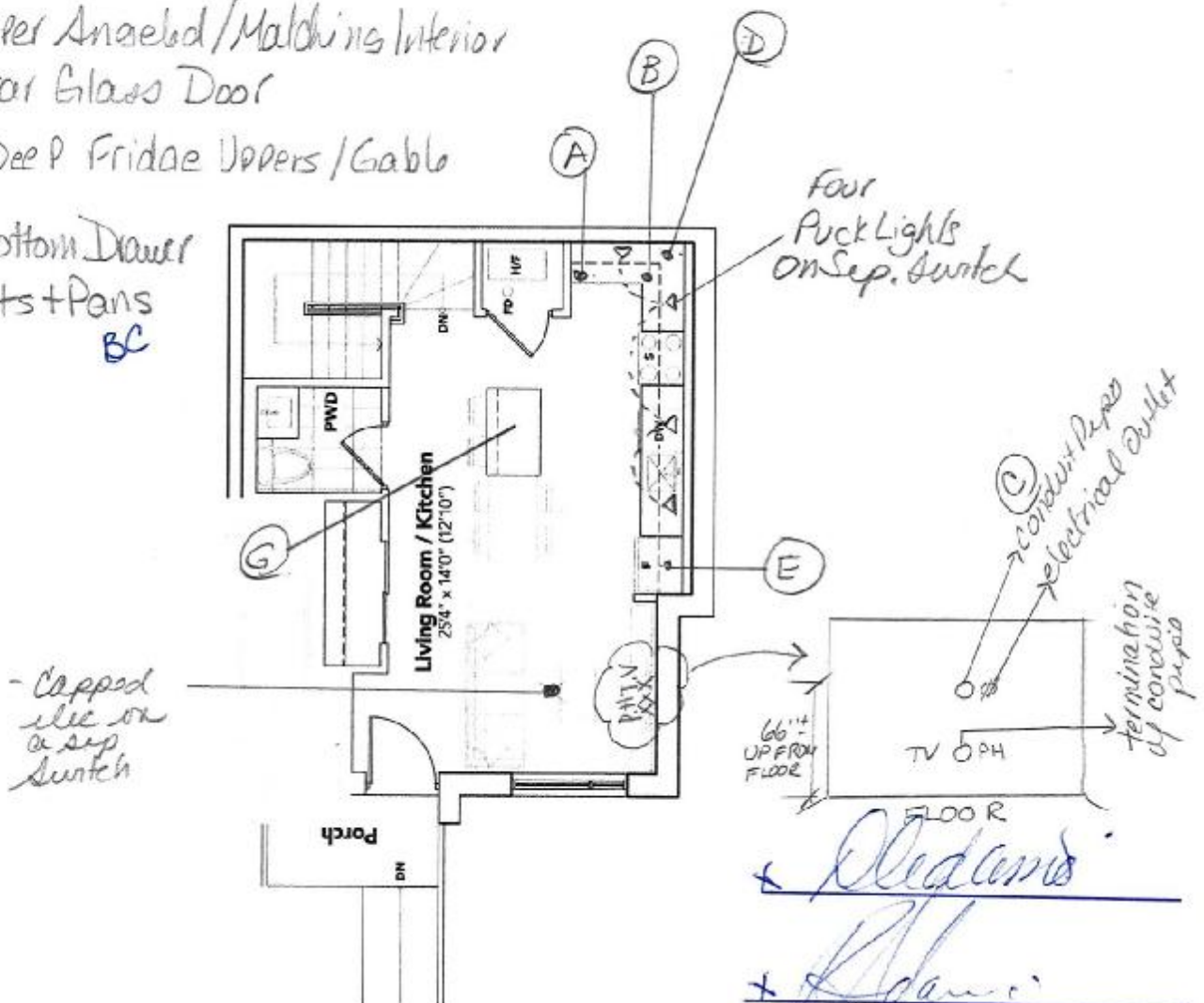
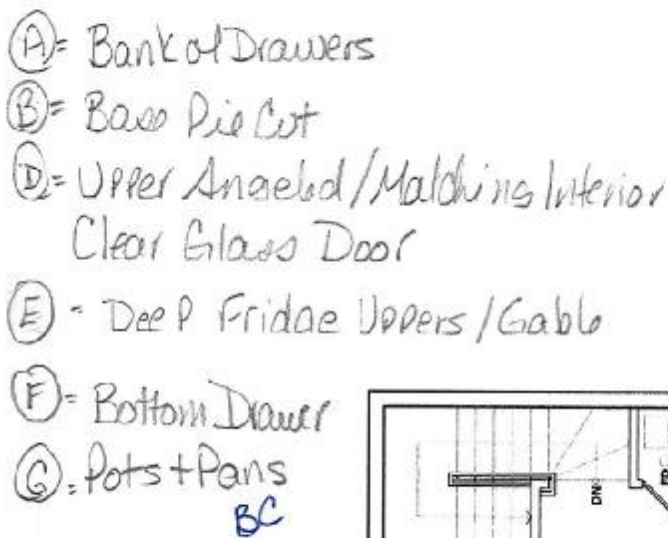

Initials: RA - RA

9560 ISLINGTON: UNIT L108(BLK 1)
RE: UPG. SINKS (PWD, MASTER
ENSUITE & MAIN BATHROOM)

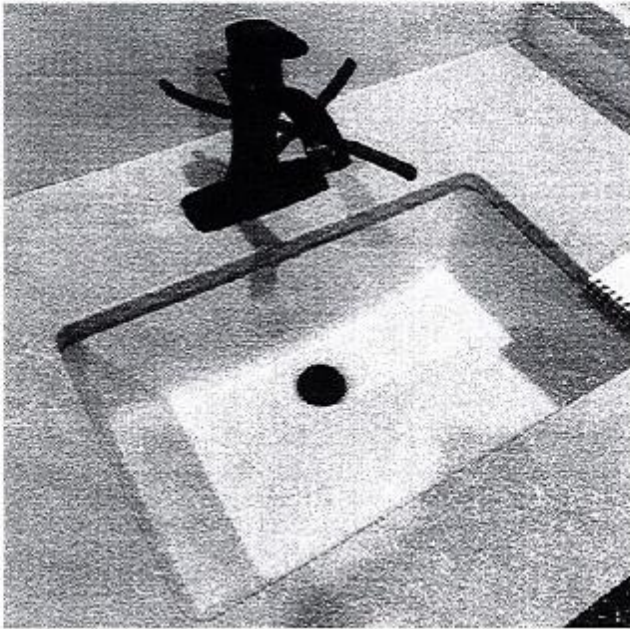

DISPLAY ITEMS

Sink (Item 9)

Contrac Catena Undermount
Model 4210CIY

+ Pladans
+ Adams