

Kingsmen (Thames) Inc. / Havelock Corners (Kingsmen)

Lot/Unit: 89 Phase/Building: 4B Model/Floor Plan: Arthur (4205) Elev A 4 Bed - 4+1 Bath

CABINETRY

Inv.4985	1 - To accomdate for 36" stove opening in lieu of the standard opening in the kitchen	
Line 64323	Note:	
23Apr21 / 29Apr21		
Inv.4985	1 - To supply & install accomodation for a future 36" COOKTOP CABINET WITH FALSE TOP DRAWER AND POTS AND PANS DRAWERS BELOW - SUPPLY SPECS - CLASSIC SERIES..see sketch # 1	
Line 64324	Note:	
23Apr21 / 29Apr21		

CABINETRY APPLIANCE - FRIDGE

Inv.4985	1 - To supply and install a66CM DEEP FRIDGE ENCLOSURE - COUNTER DEPTH WITH NO WALLS - 2 66CM DEEP GABLES AND 1 66CM DEEP CABINET - THIS IS NOT A ZERO CLEARANCE ENCLOSURE. STANDARD HEIGHTS AND WIDTHS WILL BE USED. - CLASSIC SERIES in the kitchen	
Line 64325	Note: See fridge spec's... see sketch # 1	
23Apr21 / 29Apr21		

CABINETRY BASE CABINETS

Inv.4985	1 - To supply & install an additional BANK OF DRAWERS CABINET - 40 CM MAXIMUM - SIZE SUBJECT TO FLOOR PLAN - CLASSIC SERIES in the kitchen .. see sektch # 1	
Line 64326	Note:	
23Apr21 / 29Apr21		
Inv.4985	1 - To supply and install BASE PIE CUT CORNER - CLASSIC SERIES in the kitchen..see sketch # 1	
Line 64329	Note:	
23Apr21 / 29Apr21		
Inv.4985	1 - To supply and install 45CM WIDE PULL-OUT DOOR BASE CABINET WASTE - RECYCLE CENTREE - 2 35L BINS - AVAILABLE ONLY WITH 45CM WIDE CABINET - CLASSIC SERIES in the kitchen	
Line 64330	Note:	
23Apr21 / 29Apr21		

CABINETRY HOOD FANS

Inv.4985	1 - To supply and install the HOOD FAN - PRO COLLECTION (SCB72236) WALL MOUNT RANGE HOOD WITH 650 CFM FAN - 36 INCH in the kitchen	
Line 64315	Note:	
23Apr21 / 29Apr21		
Inv.4985	1 - To ACCOMMODATE cabinetry for the Chimney Hoodfan	
Line 64316	Note:	
23Apr21 / 29Apr21		

CABINETRY MICROWAVE OVEN STOVE COOKTOP

Kingsmen (Thames) Inc. / Havelock Corners (Kingsmen)

Lot/Unit: 89 Phase/Building: 4B Model/Floor Plan: Arthur (4205) Elev A 4 Bed - 4+1 Bath

Inv.4985	1 - To supply and install a BUILT-IN TALL APPLIANCE CABINET WITH DRAWER - S BELOW FOR PANEL-MOUNT - PROUD - OR TRIM KIT INSTALLATIONS - TRIM KIT REQUIRED - SUPPLY ALL SPECS AND INSTALLATION GUIDES - COUNTER DEPTH - CLASSIC SERIES in the kitchen	
Line 64320	Note: See sketch # 1	
23Apr21 / 29Apr21		

CABINETRY WALL AND HUTCH

Inv.4985	1 - To supply & install the COMBO - UPPER ANGLE CORNER PER UNIT WITH GLASS DOOR AND FINISHED INTERIOR - SPECIFY CLEAR - GLASS - CLASSIC SERIES... see sketch # 1	
Line 64338	Note:	
23Apr21 / 29Apr21		

COUNTER TOP

Inv.4985	1 - To accomodate the quartz countertop for a future 36" Cooktop in the kitchen ...see spec's see sketch # 1	
Line 64322	Note:	
23Apr21 / 29Apr21		

ELECTRICAL

Inv.4985	1 - To supply and install the standard T.V rough-in, in the Greatroom and Master Bedroom.. see sketch #1 and #2	
Line 64308	Note:	
23Apr21 / 29Apr21		
Inv.4985	1 - To supply and install the standard Phone (CAT 5) rough-in, in the Greatroom, Master Bedroom and Bedroom #2 . see sketch #1 and #2	
Line 64309	Note:	
23Apr21 / 29Apr21		
Inv.4985	1 - To SUPPLY AND INSTALL AN ADDITIONAL BASIC RECEPTACLE (NOT DEDICATED) centered+- at 66" +- above the F/P Mantle in the greatroom, next to +-	
Line 64310	Note: the upgraded conduit pipe in the great room side	
23Apr21 / 29Apr21		
Inv.4985	1 - To SUPPLY AND INSTALL CONDUIT FOR TV OVER THE FIREPLACE in the Greatroom next to +- upgraded elec. outlet + - TERMINATED IN SAME ROOM next to the standard T.V and Phone rough-in.. see sketch #1	
Line 64311	Note:	
23Apr21 / 29Apr21		
Inv.4985	1 - To SUPPLY AND INSTALL REINFORCING FOR A CEILING to the open to below standard light.. see sketch #2	
Line 64313	Note:	
23Apr21 / 29Apr21		
Inv.4985	1 - To SUPPLY AND INSTALL EXTRA 240 STOVE PLUG to the Microwave/Wall Oven Combination.. see sketch #1	
Line 64314	Note:	
23Apr21 / 29Apr21		

HARDWOOD

Kingsmen (Thames) Inc. / Havelock Corners (Kingsmen)

Lot/Unit: 89 Phase/Building: 4B Model/Floor Plan: Arthur (4205) Elev A 4 Bed - 4+1 Bath

Inv.4985	1 - To supply and install 3 1/2" Elements Oak in the - UPPER HALL in lieu of the standard carpet..see colour chart for details	
Line 64335	Note:	
23Apr21 / 29Apr21		

HEATING AND AIR CONDITIONING

Inv.4985	1 - As per Schedule "PE": Vendor to install capped gas line (rough in only) at rear of home for future BBQ location. Location to be finalized at vendors sole discretion.	
Line 64186	Note:	
23Apr21 / 29Apr21		

Inv.4985	1 - As per Schedule "PE": Vendor to supply & install air conditioning unit, sized accordingly, from vendors standard samples.	
Line 64187	Note:	
23Apr21 / 29Apr21		

HVAC

Inv.4985	1 - As per Schedule "PE": Vendor to install gas line (Rough in ONLY) to kitchen in at stove location (as per plan) to include 110V code requirement.	
Line 64300	Note:	
23Apr21 / 29Apr21		

MISCELLANEOUS

Inv.4985	1 - To supply and install the standard coffered ceiling in the Dining Room..see sketch #1	
Line 64301	Note:	
23Apr21 / 29Apr21		

PLUMBING

Inv.4985	1 - To supply and install a WATERLINE ROUGH-IN TO THE DRYER LOCATION (NO HOOK UP)	
Line 64306	Note:	
23Apr21 / 29Apr21		

Inv.4985	1 - To supply and install a WATERLINE ROUGH-IN TO THE FRIDGE LOCATION (NO HOOK UP)	
Line 64307	Note:	
23Apr21 / 29Apr21		

Inv.4985	1 - To supply and install KITCHEN SOAP DISPENSER - MOEN CHROME - MODEL 3942.. see sketch #1 and spec's	
Line 64318	Note:	
23Apr21 / 29Apr21		



CONSTRUCTION SUMMARY

Kingsmen (Thames) Inc. / Havelock Corners (Kingsmen)

Lot/Unit: 89 Phase/Building: 4B Model/Floor Plan: Arthur (4205) Elev A 4 Bed - 4+1 Bath

EXTRAS AS PER OFFER

VENDOR TO INSTALL CAPPED GAS LINE (ROUGH-IN ONLY) AT REAR OF HOME FOR FUTURE BBQ LOCATION. LOCATION TO BE FINALIZED AT VENDORS SOLE DISCRETION. <i>Worksheet</i> Note:	
VENDOR TO INSTALL GAS LINE (ROUGH-IN ONLY) TO KITCHEN IN AT STOVE LOCATION (AS PER PLAN) TO INCLUDE 110V CODE REQUIREMENT. <i>Worksheet</i> Note:	
VENDOR TO SUPPLY & INSTALL AIR CONDITIONING UNIT, SIZED ACCORDINGLY, FROM VENDORS STANDARD SAMPLES. <i>Worksheet</i> Note:	

APR 30 2021

Purchasers: SUKHMANPREET SINGH SIDHU & HARJINDER
Telephone Res. / Bus: (647) 701-5166 /
Decor Advisor: Barbara Coccia
Property: 89 of Plan - Draft Approval SB17-03-08
Project: Kingsmen (Thames) Inc.
Model and Elevation: Arthur (4205) Elev A 4 Bed - 4+1 Bath

Layout Changes: ☒ Yes ☐ No **Sketch Attached:** ☒ Yes ☐ No **Exterior Colour Scheme:**

1. Cabinetry

	Style and Colour	Counter Top	Hardware
Kitchen / Breakfast	#3 Camden Maple Timberlake CL	#1 C/S #9141 Ice Snow 3cm	171 Knob
Kitchen Island	#3 Camden Maple Timberlake CL	#1 C/S #9141 Ice Snow 3cm	171 Knob
Laundry Room	/	/	/
Powder Room	#3 Camden Maple Timberlake CL	Spring Carnival 1876K-52	171 Knob
Main Bathroom	/	/	/
Master Ensuite Bathroom	#3 Camden Maple Porcini CL	Autumn Carnival 1877k-52	171 Knob
Second Ensuite Bathroom (If Applicable)	#3 Charleston 3DL Orchid	White Carrara 4924-38	9671 Handle
Bedroom #3 Bathroom	#3 Charleston 3DL Orchid	White Carrara 4924-38	9671 Handle
Bedroom #4 Bathroom	#3 Charleston 3DL Orchid	Calcutta Marble 4925k-07	9671 Handle

Appliances
Custom Size Fridge ☒ Yes ☐ No
Valance Lighting ☐ Yes ☒ No
Microwave / Range Hood ☐ Yes ☒ No
Cooktop / Rangetop ☒ Yes ☐ No
Built in Wall Oven ☒ Yes ☐ No
Slide-in Range ☐ Yes ☒ No
Comment

2. Flooring

	Selection
Foyer	13x13" Bellina Grey
Main Hall	13x13" Bellina Grey
Back Hall	/
Breakfast	13x13" Bellina Grey
Laundry Room	13x13" Malena Ivory
Kitchen	13x13" Bellina Grey
Powder Room	13x13" Bellina Grey
Main Bathroom	(Bedroom #2 Bathroom)- 13x13" Malena Ice
Master Ensuite	13x13" Malena Ivory SH/FL:2x2" Soho Warm Grey Matte
Bathroom (If Applicable)	(Bedroom #3 Bathroom)-13x13" Malena Ice SH/FL:2x2" Soho White Matte
Mud Room	13x13" Bellina Grey
Bedroom #4 Bathroom	13x13" Malena Ice
Living Room	/
Dining Room	3 1/2" Elements Oak Barley
Family / Great Room	3 1/2" Elements Oak Barley
Den / Library / Study	3 1/2" Elements Oak Barley
Basement Landing (If Applies)	
Lower Landing (If Applicable)	3 1/2" Elements Oak Barley (if Applicable)
Upper Landing	
Upper Hall	**3 1/2" Elements Oak Barley (Including the Computer Niche)
Master Bedroom	Stylish Story 1 : 725 Stone Lion
Bedroom #2	Stylish Story 1 : 725 Stone Lion
Bedroom #3	Stylish Story 1 : 725 Stone Lion
Bedroom #4	Stylish Story 1 : 725 Stone Lion
Bedroom #5	/
Shower Jambs (Sill)	Master Ensuite: Anatolia Marmiline IVORY Bed. #3 Bathroom- Anatolia Marmiline SNOW

Flooring Continued on Page 2

Initial: 

Page 1 of 3

APR 30 2021

Purchasers: SUKHMANNPREET SINGH SIDHU & HARJINDEEP
Telephone Res. / Bus: (647) 701-5166 /
Decor Advisor: Barbara Coccia
Property: 89 of Plan - Draft Approval SB17-03-08
Project: Kingsmen (Thames) Inc.
Model and Elevation: Arthur (4205) Elev A 4 Bed - 4+1 Bath

2. Flooring - Continued -

Upgrade Underpad	Type	Area
	Standard	Master Bedroom, Bedroom #2, #3 and #4
Carpet on Stairs	Capped	Runner - *Upgrade
Comment	/	/

3. Plumbing Fixtures / Faucets

Kitchen	Standard	Second Ensuite	Standard	Powder Room	Standard
Master Ensuite	Standard			Other Room	/
Main Bathroom	/	Bedroom #3/#4 Bathroom	Standard		

Comment

NOTE: Purchasers have not upgraded the kitchen sink.. still to install the standard undermount sink with the standard faucet. To install the standard topmount sinks in all bathrooms with the standard faucets.

4. Wall Tile

	Tile Selection	Listello	Insert	Insert Selection
Main Bathroom	/	<input type="checkbox"/>	<input type="checkbox"/>	/
Master Ensuite	/	<input type="checkbox"/>	<input type="checkbox"/>	/
Tub Deck	/	<input type="checkbox"/>	<input type="checkbox"/>	/
Tub Apron	/	<input type="checkbox"/>	<input type="checkbox"/>	/
Tub Surround	/	<input type="checkbox"/>	<input type="checkbox"/>	/
Shower Stall	8x10" Malena Ivory	<input type="checkbox"/>	<input type="checkbox"/>	/
Second Ensuite	8x10" Malena Ice	<input type="checkbox"/>	<input type="checkbox"/>	/
Bedroom #3 Bathroom	8x10" Malena Ice	<input type="checkbox"/>	<input type="checkbox"/>	/
Bedroom #4 Bathroom	8x10" Malena Ice	<input type="checkbox"/>	<input type="checkbox"/>	/
Kitchen Backsplash	/	<input type="checkbox"/>	<input type="checkbox"/>	/
Complete Backsplash	/	<input type="checkbox"/>	<input type="checkbox"/>	/

Comment

/



horizontal stacked

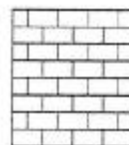

brick pattern

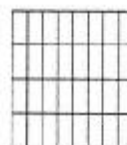

vertical stacked



diagonal/diamond

5. Fireplace

Living Room

Purchased ☐ As Per Plan ☐ N/A ☐

Family Room

Purchased ☐ As Per Plan ☐ N/A ☐

Other Room - Specify Great/study

Purchased ☐ As Per Plan ☒ N/A ☐

Fireplace Type			Two Sided
Mantle Type			NF-17 (GREATROOM ONLY)
Over Mantle			/
Colour / Stain			White
Surround			/
Hearth			/

Comment

NOTE: TO SUPPLY AND INSTALL NF-08 WHITE F/P Mantle ON THE STUDY SIDE.
 TO SUPPLY AND INSTALL NF-17 ON THE GREATROOM SIDE ONLY.

Initial:

SS WY BY

Page 2 of 3

Purchasers: SUKHMANNPREET SINGH SIDHU & HARJINDER
Telephone Res. / Bus: (647) 701-5166 /
Decor Advisor: Barbara Coccia
Property: 89 of Plan - Draft Approval SB17-03-08
Project: Kingsmen (Thames) Inc.
Model and Elevation: Arthur (4205) Elev A 4 Bed - 4+1 Bath

6. Trim Carpentry

Door Hardware Standard Handle

Interior Trim Standard

Comment

Interior Doors

☐ 2 Panel Arch Top

☒ 2 Panel Square Top

☐ 6 Panel



Initial for Door Style

SS
W
P

7. Railings and Pickets

Railing Package Standard TURNED Package

Railing Colour Elements Barley

Wood Stairs ☐ No ☒ Oak

Picket Colour Elements Barley

Tread Colour Elements Barley

Comment

8. Plaster Mouldings and Medallions

Foyer /

Main Hall /

Living Room /

Dining Room /

Family Room /

Kitchen/Breakfast /

Den/Library /

Lower Landing /

Comment

9. Wall Paint

Kingsmen White

Smooth Ceilings ☐ First Floor

☐ First Floor incl. Second Floor Hall

☐ First and Second Floor

☒ Throughout

☐ Not Applicable

Trim Paint Kingsmen White

10. Additional Comments

11. Disclaimers and Notes

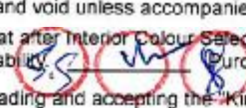
- Colours of all materials are as close as possible to builder's selection, but not necessarily identical due to variances in manufacturing.
- Any extras listed above are null and void unless accompanied by a separate invoice/amendment. Said invoice must be paid in full.
- The Purchaser acknowledges that after Interior Colour Selection form is signed and dated, no further changes will be permitted other than re-selection due to unavailability.  Purchaser's Initials
- The Purchaser acknowledges reading and accepting the "Kingsmen Group Décor Centre Disclaimers" form. This document contains other miscellaneous disclaimers.

This Interior Colour Selection is final and approved by:

Purchaser:

Signature:  Date: 04/29/21

Signature:  DATE: 29.4.2021

Signature:  Date: 04/29/21

Vendor:  Kingsmen (Thames) Inc.

SCHEDULE "B-1"
Floor Plan

Lot 89
Phase 4B
Model: Arthur (4205) Elev A 4 Bed - 4+1 Bath
Standard

APR 30 2021

Sketch #1

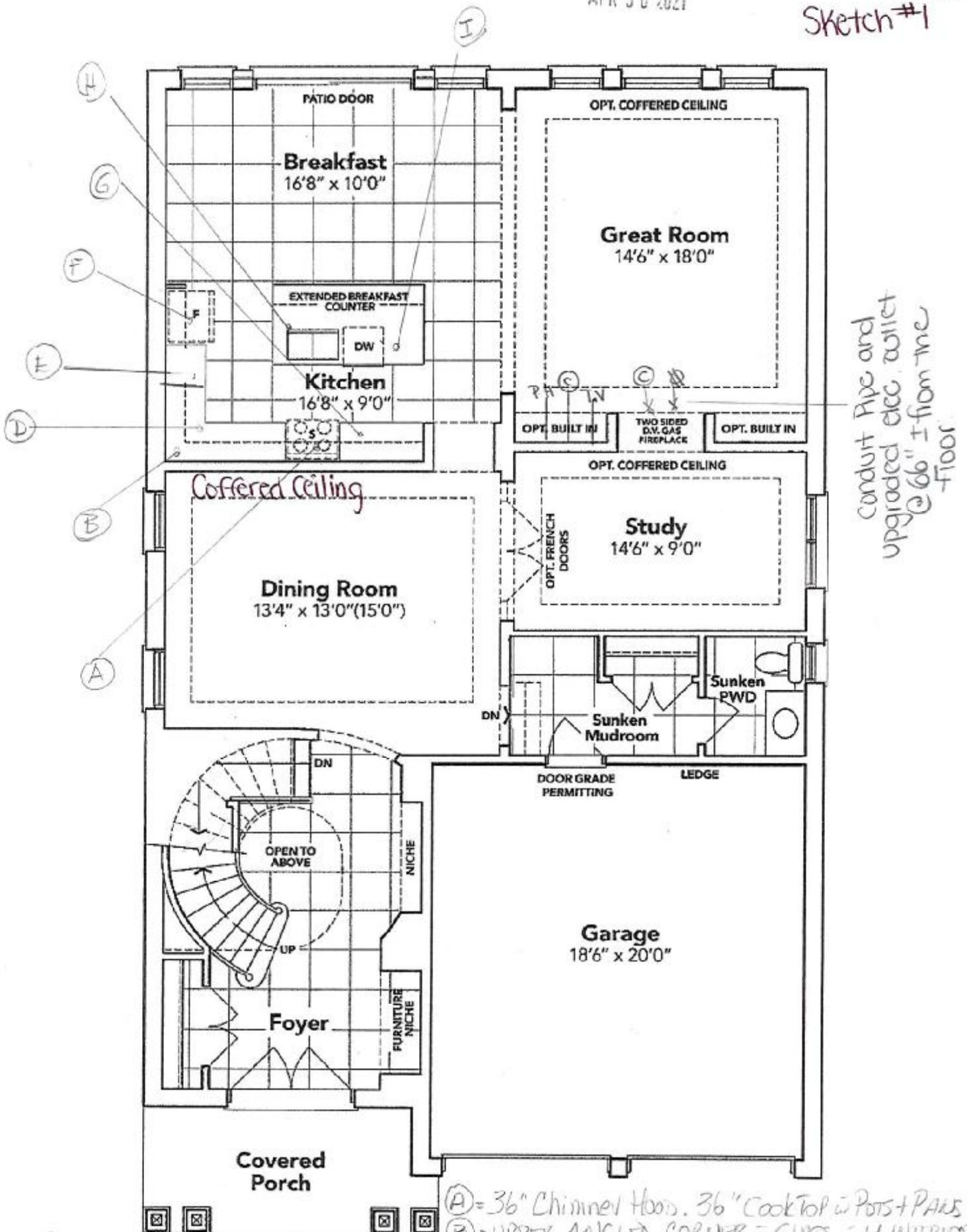

(H) = SOAP DISPENSER

GROUND FLOOR EL. A

(I) = GARBAGE PULL OUT

- (A) = 36" Chimney Hood, 36" Cooktop w Pots + Pans
(B) = UPPER ANGLED CORNER w GLASS w M. INTERIOR
(D) = BASE PIE CUT
(E) = WALL OVEN / MICRO. TOWER
(F) = DEEP FRIDGE UPERS
(G) = ADD. BANK OF DRAWERS

The floor plans and elevations shown are pre-construction plans and may be revised or improved as necessitated by architectural controls and the construction process. The measurements adhere to the rules and regulations of the TARION Warranty Corporation's official method for the calculation of floor area. Materials, specifications and floor plans are subject to change without notice. All house renderings are artist's concept only. Actual usable floor space may vary from the stated floor area. All options shown are upgrades. E. & O. E.

SCHEDULE "B-1"
Floor Plan

Lot 89
Phase 4B
Model: Arthur (4205) Elev A 4 Bed - 4+1 Bath
Standard

APR 30 2021

Sketch #2

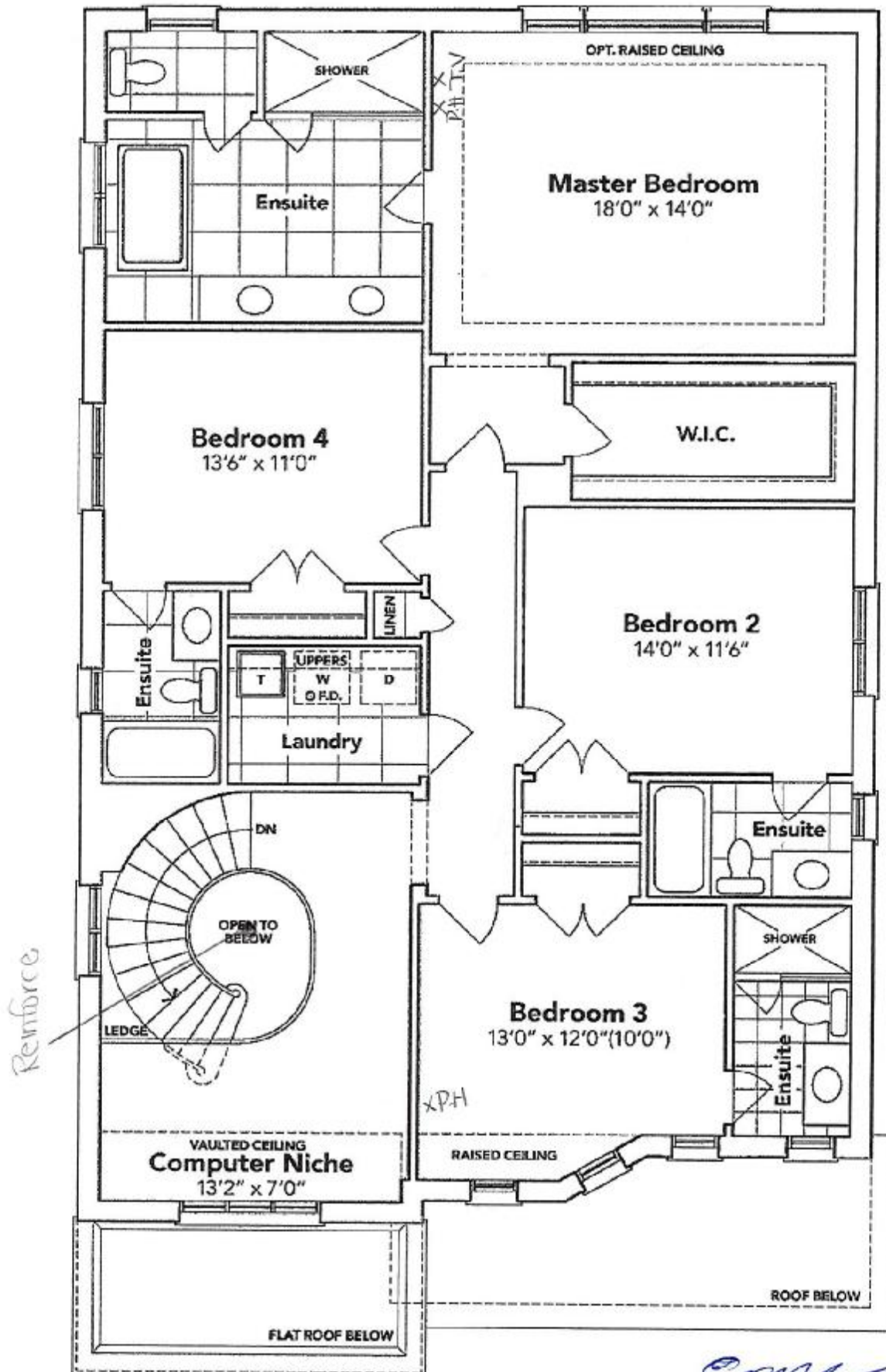

SECOND FLOOR EL. A

[Handwritten signatures and initials]

The floor plans and elevations shown are pre-construction plans and may be revised or improved as necessitated by architectural controls and the construction process. The measurements adhere to the rules and regulations of the TARIION Warranty Corporation's official method for the calculation of floor area. Materials, specifications and floor plans are subject to change without notice. All house renderings are artist's concept only. Actual usable floor space may vary from the stated floor area. All options shown are upgrades. E. & O. E.

SCHEDULE "B-1"
Floor Plan

Lot 89
Phase 4B
Model: Arthur (4205) Elev A 4 Bed - 4+1 Bath
Standard

APR 30 2021

Sketch #3

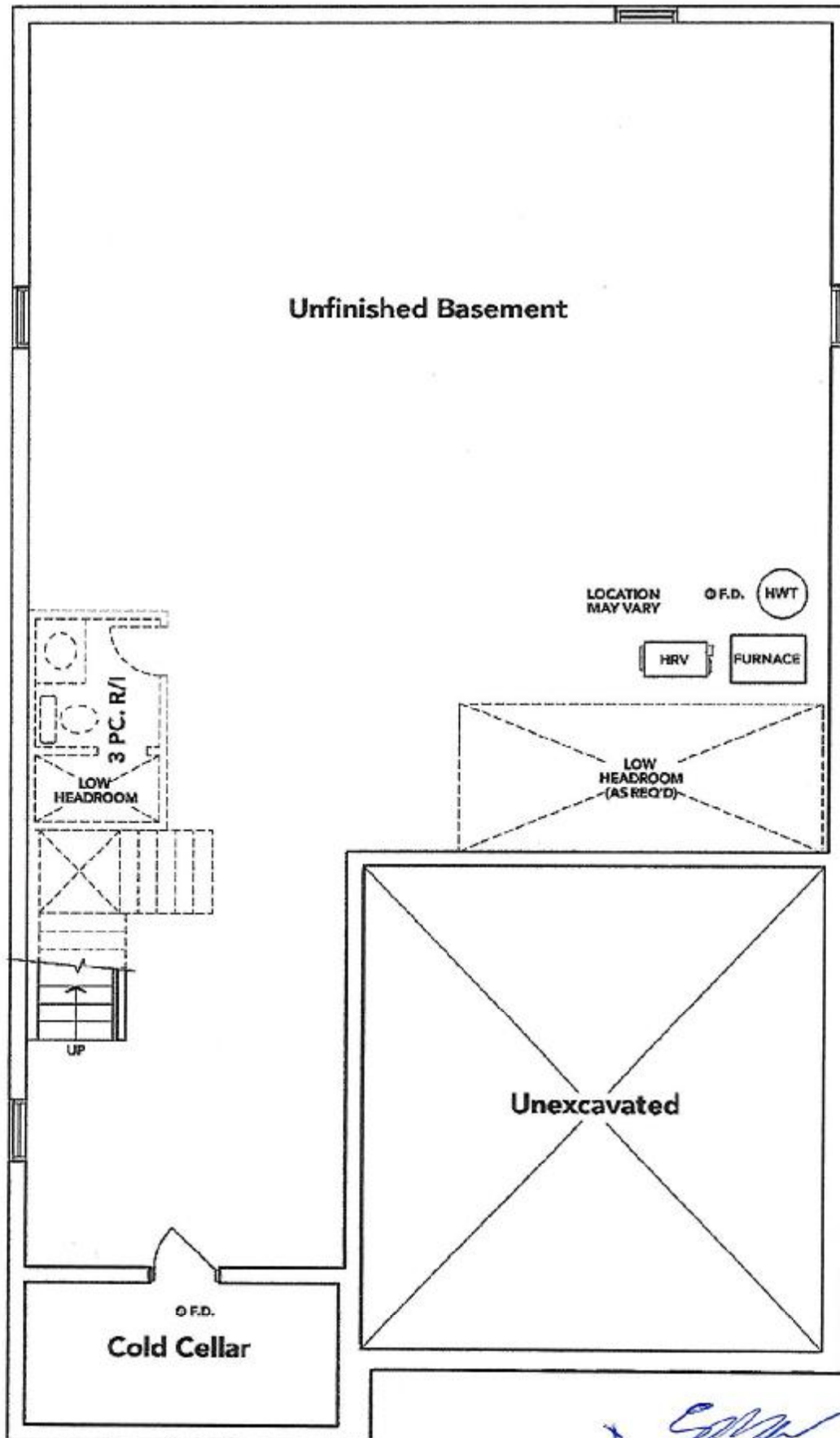

BASEMENT EL. A

The floor plans and elevations shown are pre-construction plans and may be revised or improved as necessitated by architectural controls and the construction process. The measurements adhere to the rules and regulations of the TARION Warranty Corporation's official method for the calculation of floor area. Materials, specifications and floor plans are subject to change without notice. All house renderings are artist's concept only. Actual usable floor space may vary from the stated floor area. All options shown are upgrades. E. & O. E.

THAMES 4B: LOT 89
RE: UPG. 36" CHIMNEY
HOODFAN

APR 30 2021

Specifications

Air Flow Volume: 650 CFM
Electrical Connection: 120V/60Hz
Power Consumption: 240 Watts
Current: 2.0 Amps
Fan Speed: 1599 RPM
Finishes: Stainless Steel
Duct: 6" Round
Knock-out: 6" Round - Top Only
Dimensions: Width: 30"/36"
Height: 44 1/2"
Depth: 19 3/4"
Noise Level: Min. 2 Sones
Max. 7 Sones

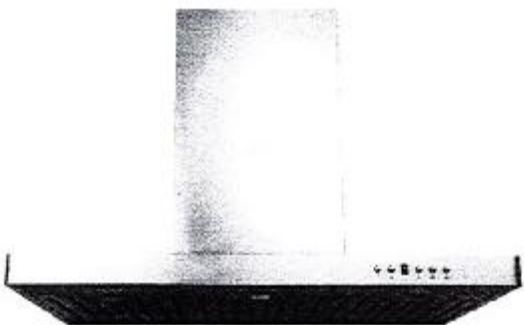

SCB722 - Baffle Filter



Ordering Model Chart

Model	Colour	Knock-out	Duct	Size	Filter	CFM
SCB72230	Stainless Steel	6"	6" Round	30"	Baffle	650
SCB72236	Stainless Steel	6"	6" Round	36"	Baffle	650

Notes

Emm

Nan

Pla

THAMES 4B: LOT 89
RE: UPG. MASTER ENSUITE
TUB & KITCHEN SOAP
DISPENSER

APR 30 2021

Soap or Lotion Dispensers

Traditional Transitional Modern

*However you define your faucet's style,
you can assure a coordinated look with Moen soap dispensers.*

KITCHEN



Transitional Soap or
Lotion Dispenser

Model 3942

Chrome

+

+

x

RF28K9070SR

28 cu. ft. 4-Door Flex™ Refrigerator

APR 30 2021

THAMES 4B: LOT 89
RE: FRIDGE SPEC'S

Features

- FlexZone™
- Large Capacity – 28 cu. ft.
- Triple Cooling System
- Ice Master Ice Maker in the Refrigerator
- Surface LED Lighting
- Fingerprint-Proof Coating
- ENERGY STAR®-Compliant
- Stainless-Look Display
- Stainless Steel Accents on Interior Shelving and Door Bins
- Tempered Glass Spill-Proof Shelves
- EZ Slide-Out Shelves in Freezer and FlexZone™
- Flip-Up Shelf
- Gallon Door Bins

Convenience

- Door Alarm
- Water Filter Indicator



ENERGY STAR®-rated:
780 kWh/yr

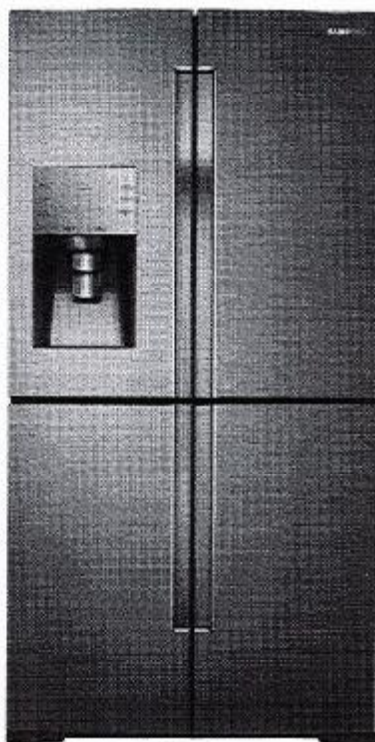

FlexZone™

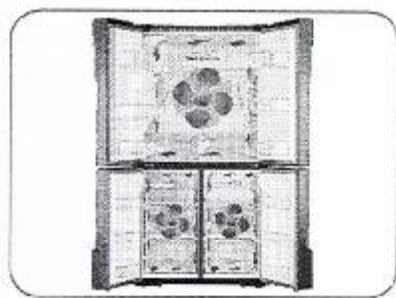

Triple Cooling System

Available Colors



Stainless Steel (shown)



Black Stainless Steel

Signature Features

FLEXZONE™

- Flexible, bottom-right door changes to a fridge or freezer, maximizing fresh food storage space.
- Four customizable fridge temperature settings: Cool at 41°F, Chilled at 30°F, Soft Freeze at 23°F, and Frozen at -8°F – 5°F.

LARGE CAPACITY

- Our 28 cu. ft. large-capacity Flex™ Refrigerator has enough room to fit up to 28 bags of groceries.*

*Grocery comparison based on each cubic foot of usable space equalling one paper bag.

TRIPLE COOLING

- Premium cooling system provides precise temperature control in all three zones using three evaporators.

† Among consumer-grade freestanding refrigerators.

SAMSUNG

+ Don

+ Wan

+ P

RF28K9070SR

28 cu. ft. 4-Door Flex™ Refrigerator

APR 30 2021

THAMES 4B: LOT 89
RE: FRIDGE SPEC'S

Installing Your Refrigerator

1. Measure the height, width and depth of the opening, making sure to include baseboards, molding, tile, countertop overhang, etc. Check to be sure there is enough room to open the door (consider walls, islands or other obstacles when measuring).
2. Refer to illustration below to determine dimensions.
3. Allow 2" of clearance on hinge side of refrigerator when installing next to a wall where handle may make contact.
4. Allow 1" minimum clearance at rear for proper air circulation and water/electrical connections. Allow a 3/8" minimum clearance at sides and top for ease of installation.
5. Ensure each door and entryway in the home is wide enough for the refrigerator to be moved through easily.

Please note: The following dimension and cutout information is for planning purposes only. For complete installation details, consult manual packed with product, or download manual online at samsung.com.

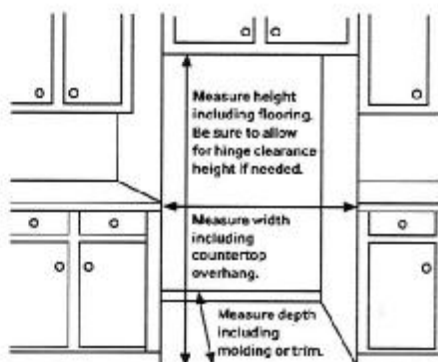

Dimensions

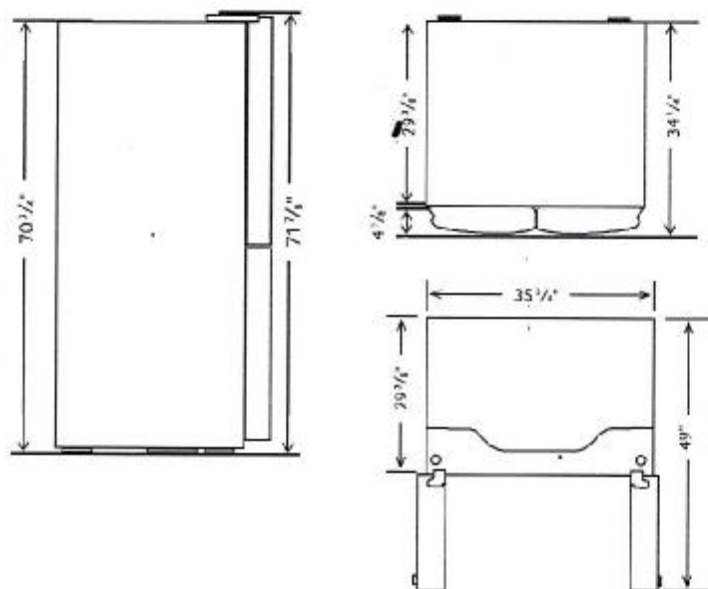

Total Capacity: 28.1 cu. ft.

Refrigerator: 16.6 cu. ft.

- Premium External Filtered Water and Ice Dispenser (Crushed or Cubed Ice)
- Ice Master Ice Maker
- 2 Clear Crispers
- Gallon Door Bins
- 5 Tempered Glass Spill-Proof Shelves
 - 1 Slide-In
 - 1 Flip-Up
 - 3 Fixed
- Surface LED Lighting

FlexZone™: 5.75 cu. ft.

- 1 EZ Slide-Out Shelf
- 2 Drawers
- 4 Temperature Zones:
 - 41°F
 - 30°F
 - 23°F
 - -8°F–5°F
- Surface LED Lighting

Freezer: 5.75 cu. ft.

- 1 EZ Slide-Out Shelf
- 2 Freezer Drawers
- Surface LED Lighting

Accessories

Water Filter: HAF-CIN/EXP

Warranty

One (1) Year Parts and Labor on Refrigerator
Five (5) Years Parts and Labor on Sealed Refrigeration System Only*
Ten (10) Years Parts and Five (5) Years Labor on Digital Inverter Compressor

*Compressor, evaporator, condenser, drier, connecting tubing.

Product Dimensions & Weight

Dimensions (WxHxD with hinges, handles and doors):

35 3/4" x 71 7/8" x 34 1/4"

Dimensions (WxHxD without hinges and door):

35 3/4" x 70 3/4" x 29 3/8"

Dimensions (WxHxD with hinge and door, no handle):

35 3/4" x 71 7/8" x 34 1/4"

Weight: 427.7 lbs.

Shipping Dimensions & Weight (WxHxD)

Dimensions: 38 5/16" x 78" x 36 1/4"

Weight: 361.5 lbs.

Color

Stainless Steel

Model

RF28K9070SR

UPC Code

887276134758

Black Stainless Steel

RF28K9070SG

887276127385

SAMSUNG

Actual color may vary. Design, specifications, and color availability are subject to change without notice. Non-metric weights and measurements are approximate.

©2016 Samsung Electronics America, Inc. 85 Challenger Road, Ridgefield Park, NJ 07660. Tel: 800-SAMSUNG, samsung.com. Samsung is a registered trademark of Samsung Electronics Co., Ltd.

+

+

+

NA36N7755TS

36" Gas Cooktop

APR 30 2021

THAMES 4B: LOT 89
RE: 36" COOKTOP SPEC'S

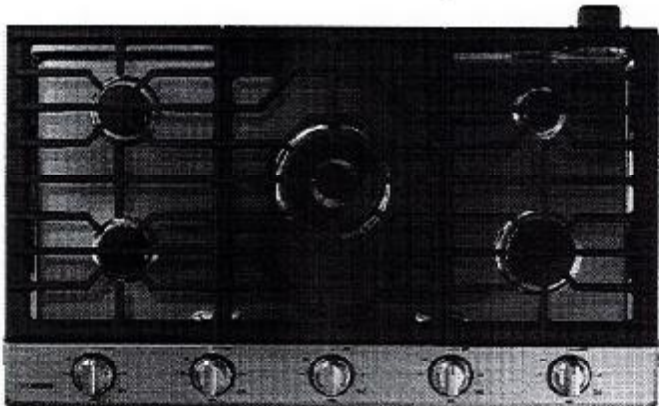

Signature Features

22K True Dual-Power Burner

- Two independent heating burners offer intense heat and precise control to quickly boil water or temper chocolate.

Analog Controls with Digital Wi-Fi and Bluetooth® Technology

- The ultimate combination of analog comfort and digital technology delivers exceptional cooking performance.

Cast Iron Griddle

- Cook breakfast, grill sandwiches, or sauté vegetables on the removable griddle.

Available Colors

-  Stainless Steel (shown)
-  Fingerprint Resistant Black Stainless Steel

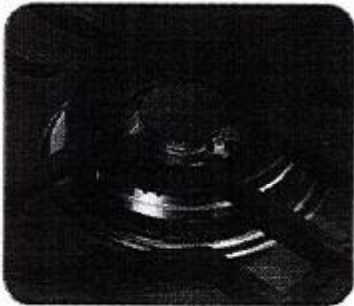

22K True Dual-Power Burner

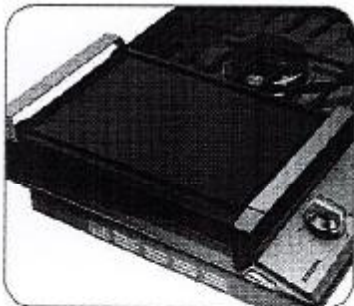

Cast Iron Griddle

Features

- Bluetooth® Connected to Hood
- Blue LED Lights
- Wi-Fi Connectivity
- Powerful Cooktop
 - Right Front: 13K BTU
 - Left Front: 9.5K BTU
 - Right Rear: 5K BTU
 - Left Rear: 9.5K BTU
 - Center: True Dual, 22K BTU (Brass)

- Cast Iron 3-Piece Grates
- Sealed Burners
- Burner On/Off Monitoring
- ADA Compliant

Convenience

- Wok Grate
- LP Conversion Kit



ADA Compliant

+ 

+ 

+ 

NA36N7755TS

36" Gas Cooktop

APR 30 2021

THAMES 4B: LOT 89
RE: 36" COOKTOP SPEC'S

Installation Requirements

Countertop cut-out and minimum clearance dimensions:

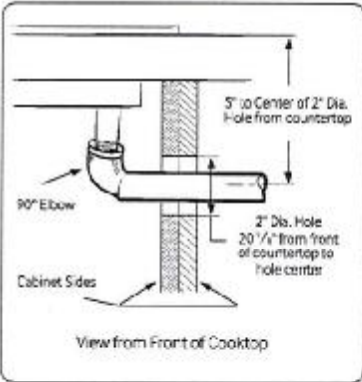
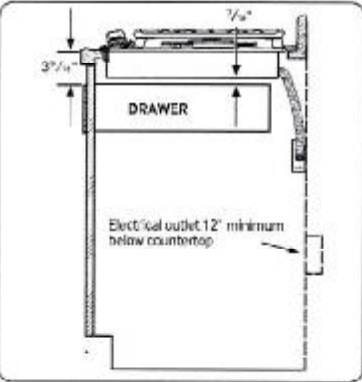
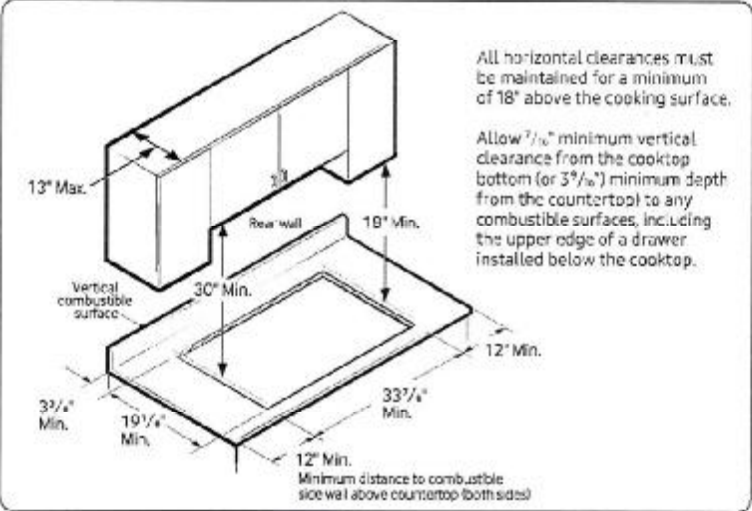

Total Power (BTU)
59K

Power Source
120V / 60 Hz / 1A

Gas Cooktop (BTU)

- Right Front: 13K
- Left Front: 9.5K
- Right Rear: 5K Simmer
- Left Rear: 9.5K
- Center: 22K (True Dual)

Warranty
One (1) Year A.I. Parts and Labor

Product Dimensions & Weight (WxHxD)
Outside (Max) Cooktop Dimensions:
36" x 5 41/32" x 22 1/3"

Cooktop Cut-Out Dimensions:
33 7/8" x 3 1/8" x 19 1/8"

Weight: 87.7 lbs. (88.4 lbs. Fingerprint Resistant Black Stainless Steel)

Shipping Dimensions & Weight (WxHxD)
Dimensions: 40 9/16" x 10 5/8" x 25 5/8"
Weight: 95.9 lbs. (97.2 lbs. Fingerprint Resistant Black Stainless Steel)

Color	Model #	UPC Code
Stainless Steel	NA36N7755TS	887276281766
Fingerprint Resistant Black Stainless Steel	NA36N7755TG	887276281759

Installing Over a Single Oven

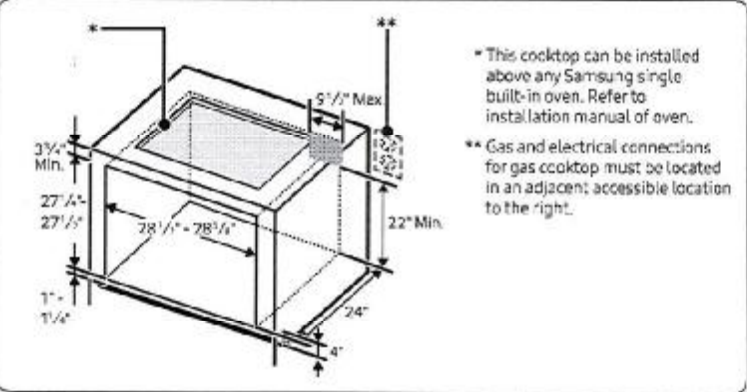

Cooktop Dimensions

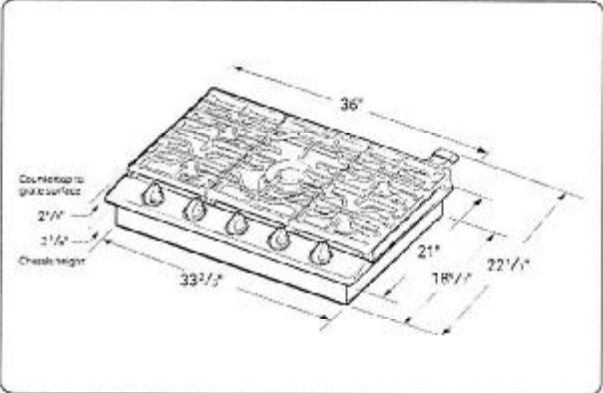

Actual color may vary. Design, specifications, and color availability are subject to change without notice. Non-metric weights and measurements are approximate.
©2018 Samsung Electronics America, Inc., 85 Challenger Road, Ridgefield Park, NJ 07660. Tel: 800-SAMSUNG, samsung.com. Samsung is a registered trademark of Samsung Electronics Co., Ltd.

[Handwritten signatures]

NQ70M7770DS

30" Microwave Combination Wall Oven

APR 30 2021

THAMES 4B: LOT 89
RE: 30" MICROWAVE COMB.
WALL OVEN SPEC'S

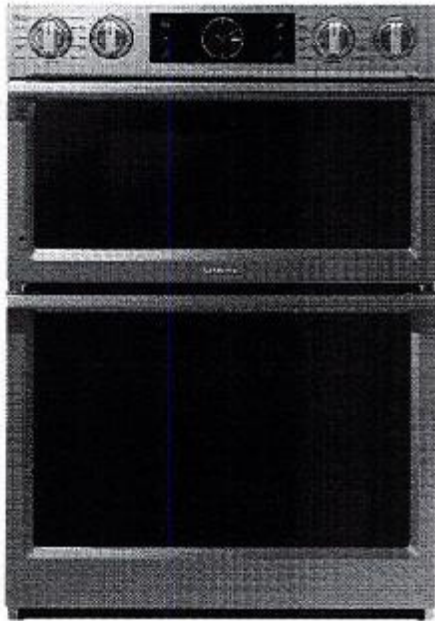

Signature Features

Steam Cook (Oven)

- Delivers moisture at precise times for a crisp, browned outside and tender inside.

Speed Cook (Microwave)

- Cook food faster and more evenly by using power convection.

Flex Duo™ (Oven)

- Cook two dishes at different temperatures simultaneously with the Smart Divider.

Available Colors



Stainless Steel (shown)



Black Stainless Steel

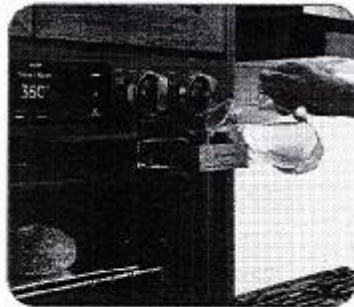

Steam Cook



Flex Duo™

Features

- Digital-Analog Controls
- 1.9/5.1 cu. ft. Capacity
- Hybrid Clean and Self-Clean (Oven)
- Gourmet Cook (Oven)
- Dual Convection (Oven)
- Wi-Fi Connectivity
- Wi-Fi Enabled Temperature Probe (Oven)
- LED Spotlights (Oven)
- Easy View Window
- 3 Heavy-Duty Racks including a Gliding Rack (Oven)
- Soft-Close Door (Oven)
- Ceramic Plate (Microwave)
- Rapid Preheat (Oven)
- Auto Latch Microwave Door
- 6 Oven Modes including Steam Bake and Steam Roast
- Blue LED Illuminated Knobs
- Broil Element
- Smart Control Key (Oven)
- 6 Rack Positions (Oven)
- Drop-Down Door Design
- LCD Display

Convenience

- Hidden Heating Element (Oven)
- Sabbath Mode (Oven)
- Delay Start (Oven)
- Proofing (Oven)
- Warming Mode (Oven)
- Kitchen Timer
- Child Safety Lock
- Convection Conversion

+ Sam

+ han

+ B

NQ70M7770DS

30" Microwave Combination Wall Oven

APR 30 2021

THAMES 4B: LOT 89
RE: 30" MICROWAVE COMB.
WALL OVEN SPEC'S

Cabinet Dimensions

Combination Oven Installed in Cabinet

* Junction Box

** Allow a minimum of 22" for clearance to adjacent corners, drawers, walls, etc. when door is open.

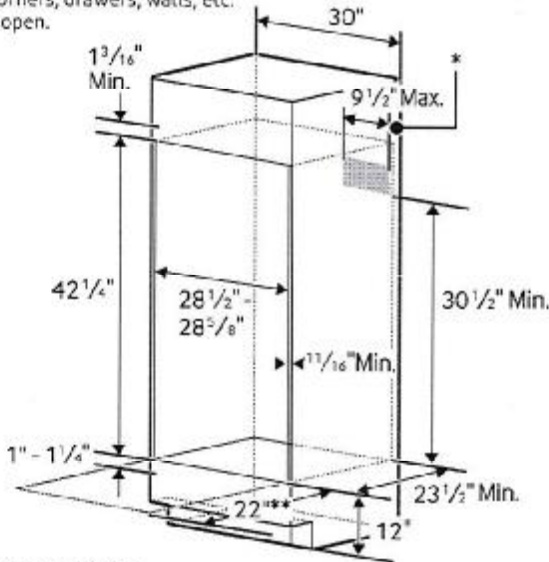

Product Dimensions

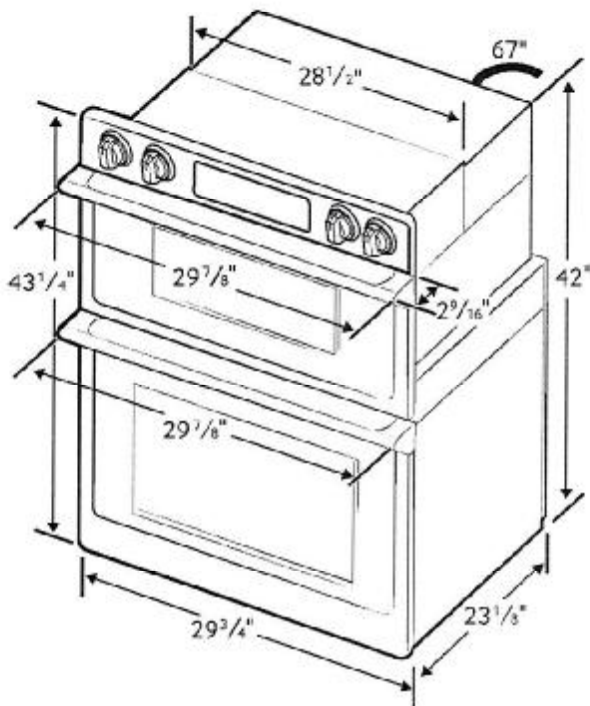

Total Capacity: 1.9/5.1 cu. ft.

- Microwave: 1.9 cu. ft.
- Wall Oven: 5.1 cu. ft. total, 2.8/2.2 cu. ft.
- Hidden Bake Element
- Bake: 175°F–550°F
- Convection Bake: 175°F–550°F
- Convection Roast: 175°F–550°F
- Broil: Low-High
- Steam Bake: 230°F–550°F
- Steam Roast: 230°F–550°F
- Proofing
- Sabbath Mode

Warranty

One (1) Year All Parts and Labor
Ten (10) Years Parts Warranty for Magnetron

Product Dimensions & Weight (WxHxD)

Outside (Max) Combination Oven Dimensions:
29 7/8" x 43 1/4" x 25 11/16"

Combination Oven Cut-Out Dimensions:
28 1/2" x 42 1/4" x 23 1/2"

Weight: 119 lbs.

Shipping Dimensions & Weight (WxHxD)

Dimensions:
33 5/8" x 48 5/8" x 29 51/64"

Weight: 132.5 lbs.

Color

Stainless Steel
Black Stainless Steel

Model #

NQ70M7770DS
NQ70M7770DG

UPC Code

887276195186
887276195162

RATING	
240V	9.5 kW
208V	7.2 kW
BREAKER SIZE	
240V	40 Amps
208V	40 Amps

Actual color may vary. Design, specifications, and color availability are subject to change without notice. Non-metric weights and measurements are approximate.
©2017 Samsung Electronics America, Inc. 85 Challenger Road, Ridgefield Park, NJ 07660. Tel: 800-SAMSUNG. samsung.com. Samsung is a registered trademark of Samsung Electronics Co. Ltd.

* 
* 
* 