

Kingsmen (Thames) Inc. / Havelock Corners (Kingsmen)

Lot/Unit: 96 Phase/Building: 4B Model/Floor Plan: John (4201) Elev B 4 Bed - 2+1 Bath

CABINETRY

Inv.4983	1 - To accommodate cabinetry for the chimney hoodfan	
Line 64252	Note:	
23Apr21 / 29Apr21		
Inv.4983	1 - To accomodate for a future buit in tall appliance cabinet with drawer(s) below for flush mount installations. (appliances to be installed flush with kitchen cabinetry in the kitchen... see sketch # 1 See spec's attached.	
Line 64261	Note:	
23Apr21 / 29Apr21		
Inv.4983	1 - To supply & isntall the CABINETRY - KITCHEN - UPGRADE throughout the kitchen... see colour chart for details.	
Line 64262	Note:	
23Apr21 / 29Apr21		
Inv.4983	1 - To accomodate for a future 36" wide stove opening in the kitchen.	
Line 64259	Note:	
23Apr21 / 29Apr21		
Inv.4983	1 - To accomodate for a buit in refrigertor with overlay/proud installation... see spec's	
Line 64274	Note:	
23Apr21 / 29Apr21		

CABINETRY APPLIANCE - FRIDGE

Inv.4983	1 - To supply & installt he 66CM DEEP FRIDGE ENCLOSURE - COUNTER DEPTH WITH - 1 WALL - 1 66CM DEEP GABLE AND 1 66CM DEEP CABINET - THIS IS NOT A ZERO CLEARANCE ENCLOSURE. STANDARD HEIGHTS AND WIDTHS WILL BE USED.CLASSIC SERIES in the kitchen.see sketch#1	
Line 64263	Note: See fridge spec's attached.	
23Apr21 / 29Apr21		
FLUSH MOUNT ACCOMODATIONS HAVE BEEN PURCHASED AS A SEPARATE UPGRADE.		

CABINETRY HARDWARE

Inv.4983	1 - To supply & install the BASE WASTE / RECYCLE CENTER PULL OUT DOOR - ONLY AVAILABLE IN 45 CM CABINET (2) 35L BINS - PRICE IS PER UNIT in the kitchen... see sketch # 1	
Line 64264	Note:	
23Apr21 / 29Apr21		

CABINETRY HOOD FANS

Inv.4983	1 - To supply and install HOOD FAN - PRO COLLECTION (SCB72236-NF) WALL MOUNT RANGE HOOD WITH 650 CFM FAN - 36 INCH - CHIMNEY FLUE NOT INCLUDED in lieu of the standard hoodfan	
Line 64251	Note:	
23Apr21 / 29Apr21		

CABINETRY MICROWAVE OVEN STOVE COOKTOP

Kingsmen (Thames) Inc. / Havelock Corners (Kingsmen)

Lot/Unit: 96 Phase/Building: 4B Model/Floor Plan: John (4201) Elev B 4 Bed - 2+1 Bath

Inv.4983	1 - To accomodate for a future 36" COOKTOP CABINET WITH FALSE TOP DRAWER AND POTS AND PANS DRAWERS BELOW CLASSIC SERIES ... see sketch # 1 See spec's	
Line 64273	Note:	
23Apr21 / 29Apr21		

COUNTER TOP

Inv.4983	1 - To accomodate the quartz for the future 36" cook top in the kitchen.... see spec's See sketch # 1	
Line 64260	Note:	
23Apr21 / 29Apr21		

ELECTRICAL

Inv.4983	1 - To supply and install the standard Phone (CAT 5) rough-in, in the Greatroom, Master Bedroom and Bedroom #4 see sketch #1 and #2 To supply and install the standard T.V rough-in, in the Greatroom and Master Bedroom.. see sketch #1 and #2	
Line 64247	Note: Install the T.V and Phone (CAT 5) in the great room at approx. 66" + - up from the floor centered + -to the F/P mantle.	
23Apr21 / 29Apr21		
Inv.4983	1 - To SUPPLY AND INSTALL AN ADDITIONAL BASIC RECEPTACLE (NOT DEDICATED) centered +- to the F/P Mantle at approx. 66"+-up from the floor..see sketch #1	
Line 64248	Note:	
23Apr21 / 29Apr21		
Inv.4983	1 - To SUPPLY AND INSTALL EXTRA CEILING BOX ROUGH IN CAPPED (INCLUDES SWITCH) over the breakfast bar in the kitchen.. see sketch #1	
Line 64249	Note: NO FIXTURE HAS BEEN PURCHASED	
23Apr21 / 29Apr21		
Inv.4983	1 - To SUPPLY AND INSTALL EXTRA 240 STOVE PLUG for the future wall oven in the kitchen... see spec's	
Line 64257	Note:	
23Apr21 / 29Apr21		
Inv.4983	1 - To SUPPLY AND INSTALL AN ADDITIONAL BASIC RECEPTACLE (DEDICATED CIRCUIT) for the future wall oven.... see spec's	
Line 64258	Note:	
23Apr21 / 29Apr21		

FIREPLACE

Inv.4983	1 - To supply & install the upgraded NF-17 white mantle to the F/P in the great room in lieu of the std. F/P mantle.	
Line 64266	Note:	
23Apr21 / 29Apr21		

HARDWOOD

Inv.4983	1 - To supply & install the 3 1/2" engineered hardwood to the UPPER HALL in lieu of the standard carpet... see colour chart for details.	
Line 64270	Note:	
23Apr21 / 29Apr21		

Kingsmen (Thames) Inc. / Havelock Corners (Kingsmen)

Lot/Unit: 96 Phase/Building: 4B Model/Floor Plan: John (4201) Elev B 4 Bed - 2+1 Bath

HEATING AND AIR CONDITIONING

Inv.4983	1 - As per Schedule "PE": Vendor to install capped gas line (rough in only) at rear of home for future BBQ location. Location to be finalized at vendors sole discretion.	
Line 64180	Note:	
23Apr21 / 29Apr21		
Inv.4983	1 - As per Schedule "PE": Vendor to install gas line (rough in only) to kitchen in at stove location (as per plan) to include 110V code requirement.	
Line 64181	Note:	
23Apr21 / 29Apr21		
Inv.4983	1 - As per Schedule "PE": Vendor to supply & install air conditioning unit, sized accordingly, from vendors standard samples.	
Line 64182	Note:	
23Apr21 / 29Apr21		

HVAC

Inv.4983	1 - To supply and install a humidifier	
Line 64245	Note:	
23Apr21 / 29Apr21		

MISCELLANEOUS

PLUMBING

Inv.4983	1 - Raise the standand toe tester to approx. 25" + - up from unfinished floor in the master ensuite shower.	
Line 64246	Note:	
23Apr21 / 29Apr21		
Inv.4983	1 - To supply & install a WATERLINE ROUGH-IN TO THE FRIDGE LOCATION (NO HOOK UP) in the kitchen.	
Line 64253	Note:	
23Apr21 / 29Apr21		
Inv.4983	1 - To supply & install a WATERLINE ROUGH-IN TO THE DRYER LOCATION (NO HOOK UP) in the laundr room..	
Line 64254	Note:	
23Apr21 / 29Apr21		
Inv.4983	1 - To supply & install the BLANCO QUATRUS U2 under mount model 401247 in the kitchen in lieu of the standard under mount kitchen sink... see specs	
Line 64255	Note: Still to install the std. single hole kitchen faucet.	
23Apr21 / 29Apr21		
Inv.4983	1 - To supply & install the MOEN soap dispenser model # 3944 in chrome in the kitchen... see spec's See sketch # 1	
Line 64256	Note:	
23Apr21 / 29Apr21		

RAILING



CONSTRUCTION SUMMARY

Kingsmen (Thames) Inc. / Havelock Corners (Kingsmen)

Lot/Unit: 96 Phase/Building: 4B Model/Floor Plan: John (4201) Elev B 4 Bed - 2+1 Bath

Inv.4983	1 - To supply & install the RAILING - UPGRADE 2 - METAL HANDRAIL WINDSOR IN OAK - PICKETS STEEL ½ INCH ROUND, SINGLE SPOON/PLAIN, WITH SHOES IN GUNMETAL - POSTS 3½ INCH SQUARE, CHAMFERED, WITH CAP OAK IN OAK in lieu of the std. pickets and rails.	
Line 64265	Note:	
23Apr21 / 29Apr21		

EXTRAS AS PER OFFER

VENDOR TO INSTALL CAPPED GAS LINE (ROUGH-IN ONLY) AT REAR OF HOME FOR FUTURE BBQ LOCATION. LOCATION TO BE FINALIZED AT VENDORS SOLE DISCRETION. <i>Worksheet</i> Note:	
VENDOR TO INSTALL GAS LINE (ROUGH-IN ONLY) TO KITCHEN IN AT STOVE LOCATION (AS PER PLAN) TO INCLUDE 110V CODE REQUIREMENT. <i>Worksheet</i> Note:	
VENDOR TO SUPPLY & INSTALL AIR CONDITIONING UNIT, SIZED ACCORDINGLY, FROM VENDORS STANDARD SAMPLES. <i>Worksheet</i> Note:	

Purchasers: HARINDERPAL SINGH HARIKA & SUKHDEEP
Telephone Res. / Bus: (416) 578-4565 /
Decor Advisor: Barbara Coccia
Property: 96 of Plan - Draft Approval SB17-03-08
Project: Kingsmen (Thames) Inc.
Model and Elevation: John (4201) Elev B 4 Bed - 2+1 Bath

Layout Changes: ☐ Yes ☒ No **Sketch Attached:** ☒ Yes ☐ No **Exterior Colour Scheme:**

1. Cabinetry

	Style and Colour	Counter Top	Hardware
Kitchen / Breakfast	**#6 Manchester Paint Orchid	#1 C/S #9141 Ice Snow 3cm	12881 Handle
Kitchen Island	**#6 Manchester Paint Orchid	#1 C/S #9141 Ice Snow 3cm	12881 Handle
Laundry Room	/	/	/
Powder Room	Cape Code Paint Orchid	Autumn Carnival 1877K-52	12881 Handle
Main Bathroom	#3 Slab LPL Spring Blossom	Calcutta Marble4925k-07	135 Knob
Master Ensuite Bathroom	#3 Slab LPL Spring Blossom	Paloma Polar 6698-46	135 Knob
Second Ensuite Bathroom (If Applicable)	/	/	/
	/	/	/
	/	/	/

Appliances

Custom Size Fridge

☒ Yes ☐ No

Valance Lighting

☐ Yes ☒ No

Microwave / Range Hood

☐ Yes ☒ No

Cooktop / Rangetop

☒ Yes ☐ No

Built in Wall Oven

☒ Yes ☐ No

Slide-in Range

☐ Yes ☒ No

Comment

/

2. Flooring

	Selection
Foyer	13x13" Bellina Grey
Main Hall	3 1/2" Elements Oak Lynx
Back Hall	(Formal Room)-3 1/2" Elements Oak Lynx
Breakfast	13x13" Bellina Grey
Laundry Room	13x13" Bellina Grey
Kitchen	13x13" Bellina Grey
Powder Room	13x13" Bellina Grey
Main Bathroom	13x13" Cinq White
Master Ensuite	13x13" Bellina Grey
Bathroom (If Applicable)	/
Mud Room	13x13" Bellina Grey
Master Ensuite SH/FL	2x2" Soho Warm Grey Matte
Living Room	/
Dining Room	/
Family / Great Room	3 1/2" Elements Oak Lynx
Den / Library / Study	/
Basement Landing (If Applies)	
Lower Landing (If Applicable)	3 1/2" Elements Oak Lynx
Upper Landing	3 1/2" Elements Oak Lynx
Upper Hall	**3 1/2" Elements Oak Lynx
Master Bedroom	Stylish Story 1:919 Early Frost
Bedroom #2	Stylish Story 1:919 Early Frost
Bedroom #3	Stylish Story 1:919 Early Frost
Bedroom #4	Stylish Story 1:919 Early Frost
Bedroom #5	/
Master Shower Jamb	Anatolia Marmiline Snow

Flooring Continued on Page 2

Initial: 

Page 1 of 3

APR 28 2021

Purchasers: HARINDERPAL SINGH HARIKA & SUKHDEEP
Telephone Res. / Bus: (416) 578-4565 /
Decor Advisor: Barbara Coccia
Property: 96 of Plan - Draft Approval SB17-03-08
Project: Kingsmen (Thames) Inc.
Model and Elevation: John (4201) Elev B 4 Bed - 2+1 Bath

2. Flooring - Continued -

Upgrade Underpad	Type	Area
	Standard	Master Bedroom, Bedroom #2, #3 & #4
Carpet on Stairs	Capped	Runner - *Upgrade
Comment	/	/

3. Plumbing Fixtures / Faucets

Kitchen	Standard	Second Ensuite	/	Powder Room	Standard
Master Ensuite	Standard			Other Room	/
Main Bathroom	Standard		/		

Comment

NOTE: The purchasers have upgraded to a undermount kitchen sink.. still to install the standard faucet. To install the standard topmount sinks in all bathrooms (Pwd, Master Ensuite and Main Bathroom) with the standard faucet.

4. Wall Tile

	Tile Selection	Listello	Insert	Insert Selection
Main Bathroom	8x10" Keaton Carbon	<input type="checkbox"/>	<input type="checkbox"/>	/
Master Ensuite				
Tub Deck	/	<input type="checkbox"/>	<input type="checkbox"/>	/
Tub Apron	/	<input type="checkbox"/>	<input type="checkbox"/>	/
Tub Surround	/	<input type="checkbox"/>	<input type="checkbox"/>	/
Shower Stall	8x10" Bellina Grey	<input type="checkbox"/>	<input type="checkbox"/>	/
Second Ensuite	/	<input type="checkbox"/>	<input type="checkbox"/>	/
	/	<input type="checkbox"/>	<input type="checkbox"/>	/
	/	<input type="checkbox"/>	<input type="checkbox"/>	/
Kitchen Backsplash	/	<input type="checkbox"/>	<input type="checkbox"/>	/
Complete Backsplash	/	<input type="checkbox"/>	<input type="checkbox"/>	/

Comment

NOTE: To supply and install all wall tiles in the Master Ensuite and Main Bathroom on the 10" side horizontally stacked, where applicable.

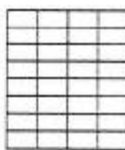

horizontal stacked

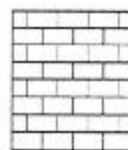

brick pattern



vertical stacked



diagonal/diamond

5. Fireplace

	Living Room			Family Room			Other Room - Specify Greatroom		
	Purchased	As Per Plan	N/A	Purchased	As Per Plan	N/A	Purchased	As Per Plan	N/A
Fireplace Type	<input type="radio"/>	<input type="radio"/>	<input type="radio"/>	<input type="radio"/>	<input type="radio"/>	<input type="radio"/>	<input type="radio"/>	<input checked="" type="radio"/>	<input type="radio"/>
Mantle Type									
Over Mantle									
Colour / Stain									
Surround									
Hearth									
Comment									

Initial:

[Handwritten Signature]

APR 28 2021

4B-96

Purchasers: HARINDERPAL SINGH HARIKA & SUKHDEEP
Telephone Res. / Bus: (416) 578-4565 /
Decor Advisor: Barbara Coccia
Property: 96 of Plan - Draft Approval SB17-03-08
Project: Kingsmen (Thames) Inc.
Model and Elevation: John (4201) Elev B 4 Bed - 2+1 Bath

6. Trim Carpentry

Door Hardware Standard Handle

Interior Trim Standard

Comment

Interior Doors

☐ 2 Panel Arch Top

☒ 2 Panel Square Top

☐ 6 Panel

Initial for Door Style

7. Railings and Pickets

Railing Package Upg #2 Gunmetal Package

Railing Colour Elements Lynx

Picket Colour Gunmetal

Wood Stairs ☐ No ☒ Oak

Tread Colour Elements Lynx

Comment

8. Plaster Mouldings and Medallions

Foyer

Main Hall

Living Room

Dining Room

Family Room

Kitchen/Breakfast

Den/Library

Lower Landing

Comment

9. Wall Paint

Kingsmen White

Smooth Ceilings ☐ First Floor

☐ First Floor incl. Second Floor Hall

☐ First and Second Floor

☒ Throughout

☐ Not Applicable

Trim Paint Kingsmen White

10. Additional Comments

11. Disclaimers and Notes

- Colours of all materials are as close as possible to builder's selection, but not necessarily identical due to variances in manufacturing.
- Any extras listed above are null and void unless accompanied by a separate invoice/amendment. Said invoice must be paid in full.
- The Purchaser acknowledges that after Interior Colour Selection form is signed and dated, no further changes will be permitted other than re-selection due to unavailability. Purchaser's Initials
- The Purchaser acknowledges reading and accepting the "Kingsmen Group Décor Centre Disclaimers" form. This document contains other miscellaneous disclaimers.

This Interior Colour Selection is final and approved by:

Purchaser:

Signature:

Date:

Signature:

Date:

Vendor:

Kingsmen (Thames) Inc.

Plan

Model: John (4201) Elev B 4 Bed - 2+1 Bath
Standard

4B-96

APR 28 2021

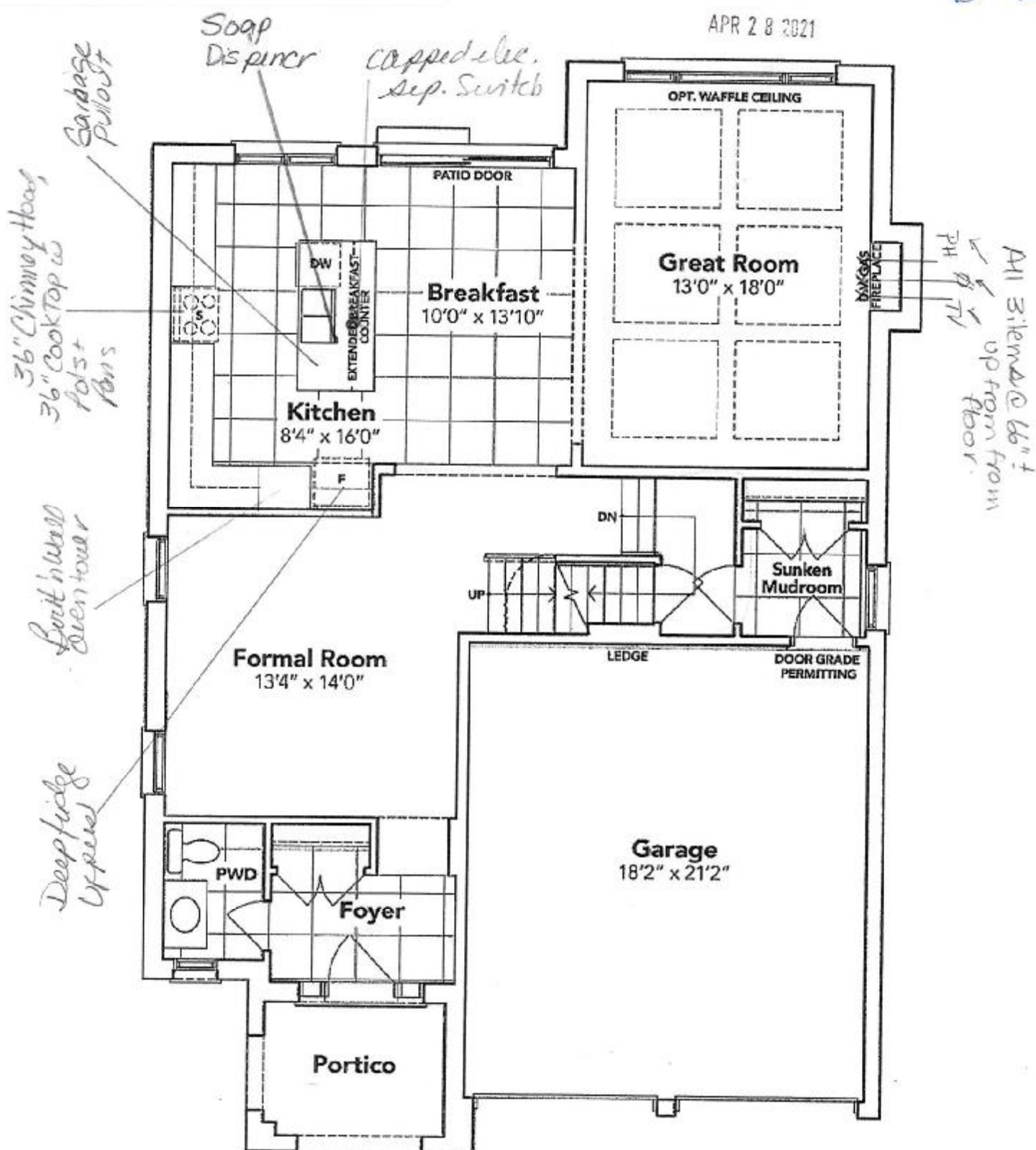

GROUND FLOOR EL. B

The floor plans and elevations shown are pre-construction plans and may be revised or improved as necessitated by architectural controls and the construction process. The measurements adhere to the rules and regulations of the TARIION Warranty Corporation's official method for the calculation of floor area. Materials, specifications and floor plans are subject to change without notice. All house renderings are artist's concept only. Actual usable floor space may vary from the stated floor area. All options shown are upgrades. E. & O. E.

SCHEDULE "B-1" - Page 3 of 3

inMS 014.rpt 22Sep18

Initials:

THAMES 4B: LOT 96
SKETCH #2

LE D-1
Plan

Model: John (4201) Elev B 4 Bed - 2+1 Bath
APR 28 2021

4B-96

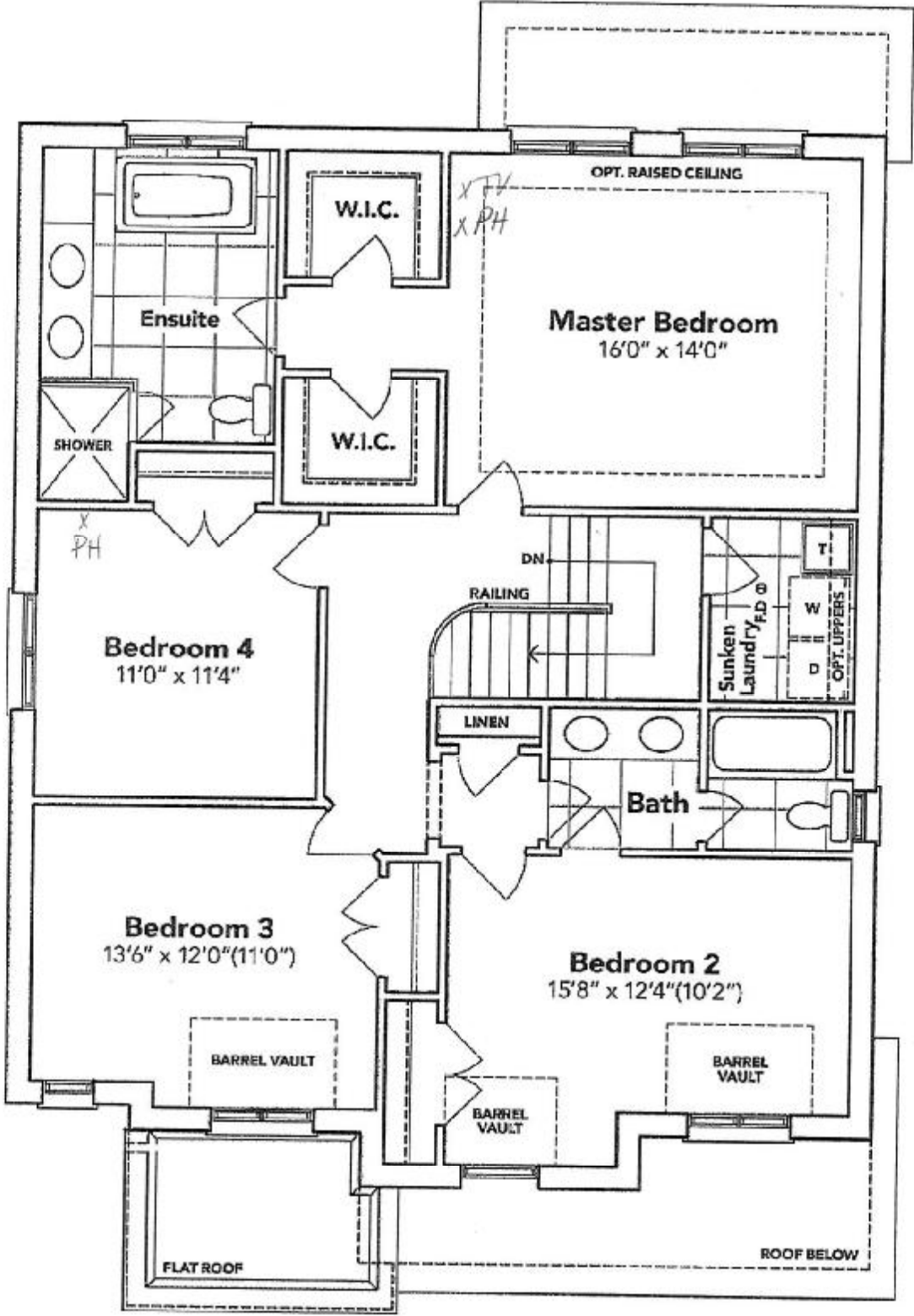

SECOND FLOOR EL. B

The floor plans and elevations shown are pre-construction plans and may be revised or improved as necessitated by architectural controls and the construction process. The measurements adhere to the rules and regulations of the TARIION Warranty Corporation's official method for the calculation of floor area. Materials, specifications and floor plans are subject to change without notice. All house renderings are artist's concept only. Actual usable floor space may vary from the stated floor area. All options shown are upgrades. E. & O. E.

THAMES 4B: LOT 96
SKETCH #3

LE D-1
Plan

Model: John (4201) Elev B 4 Bed - 2+1 Bath
Standard

APR 28 2021

4B-96

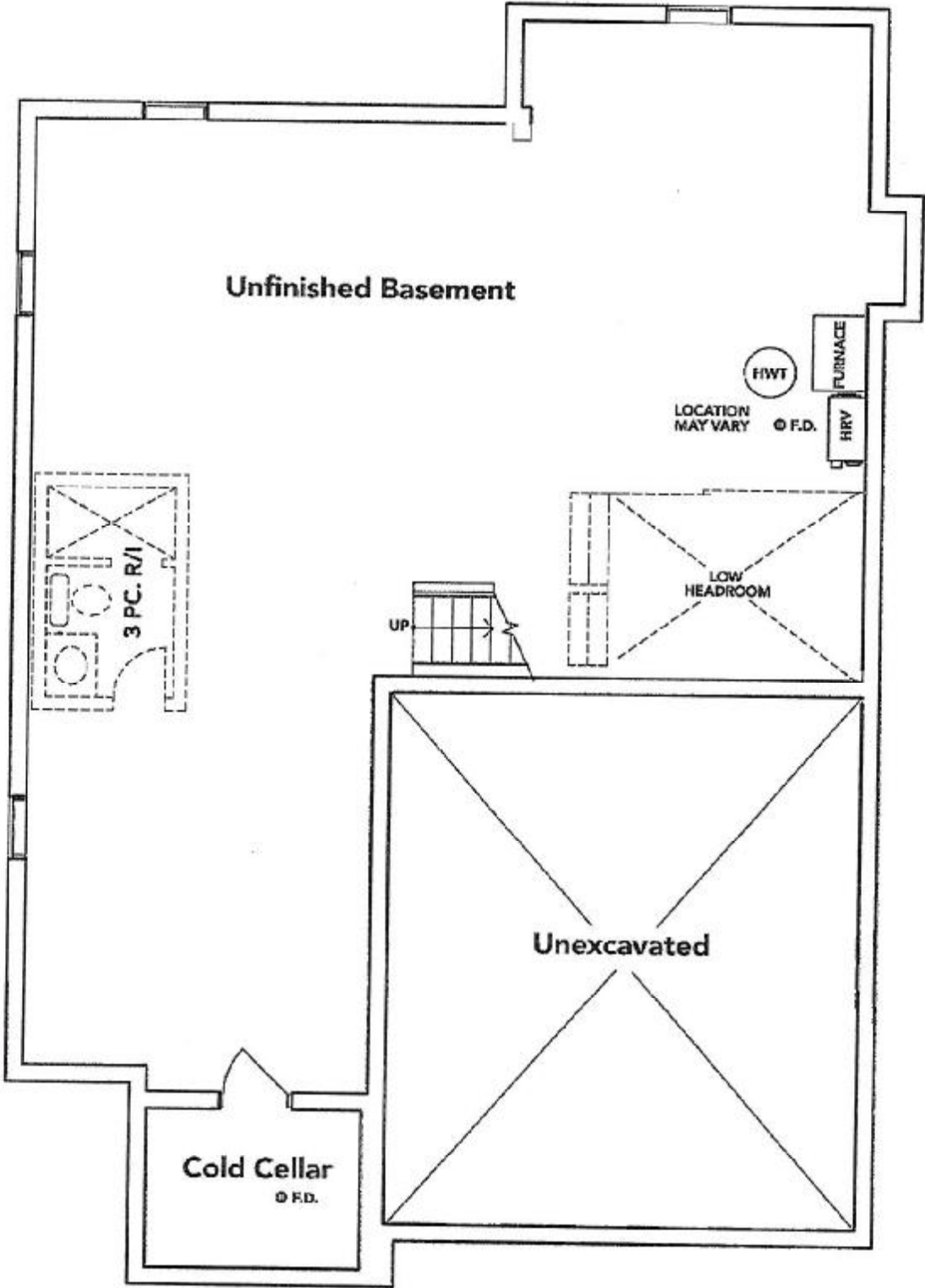

BASEMENT EL. B

The floor plans and elevations shown are pre-construction plans and may be revised or improved as necessitated by architectural controls and the construction process. The measurements adhere to the rules and regulations of the TARION Warranty Corporation's official method for the calculation of floor area. Materials, specifications and floor plans are subject to change without notice. All house renderings are artist's concept only. Actual usable floor space may vary from the stated floor area. All options shown are upgrades. E. & O. E.

THAMES 4B: LOT 96
RE: UPG. 36" CHIMNEY
HOODFAN

APR 28 2021

Specifications

Air Flow Volume: 650 CFM
Electrical Connection: 120V/60Hz
Power Consumption: 240 Watts
Current: 2.0 Amps
Fan Speed: 1599 RPM
Finishes: Stainless Steel
Duct: 6" Round
Knock-out: 6" Round - Top Only
Dimensions: Width: 30"/36"
Height: 44 1/2"
Depth: 19 3/4"
Noise Level: Min. 2 Sones
Max. 7 Sones

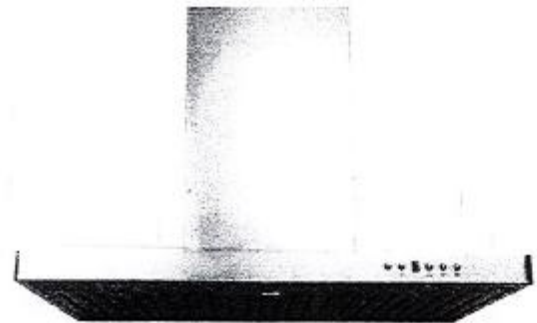

SCB722 - Baffle Filter



Ordering Model Chart

Model	Colour	Knock-out	Duct	Size	Filter	CFM
SGB72230	Stainless Steel	6"	6" Round	30"	Baffle	650
SCB72236	Stainless Steel	6"	6" Round	36"	Baffle	650

Notes

Cyclone®

APR 26 2021 THAMES 4B: LOT 96
RE: UPG. KITCHEN SINK AND
SOAP DISPENSER

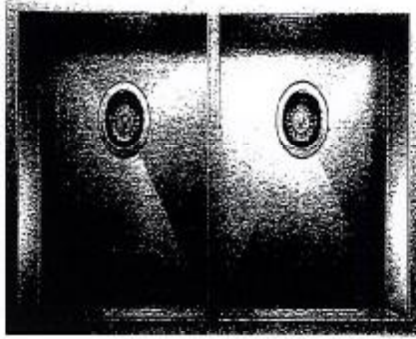

QUATRUS U2

MODEL: 401247

Germi engineered with 304 series, 18-gauge stainless steel

Zero-radius corners; 2-position drain system

Double bowl configuration for easy multi-tasking

18/10 chrome-nickel coating for exceptional luster, durability and strength

Undermount installation

Minimum cabinet size: 36"



**Transitional Soap or Lotion
Dispenser**

Model 3944

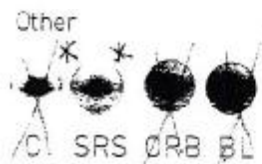

+

+

APR 28 2021

THAMES 4B

LOT 96

RE: UPG F/P MANTLE NF-17







36" Counter-Depth 4-Door Refrigerator

800 Series – Stainless Steel B36CL80ENS

APR 28 2021 THAMES 4B: LOT 96
RE: FRIDGE SPEC'S

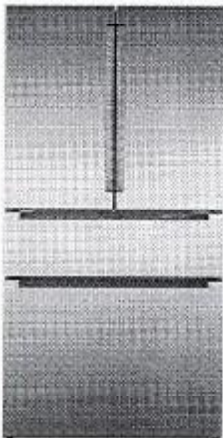
Flush Mount Accommodations



B36CL80ENS
Stainless Steel w/
Recessed Handles

Introducing the revolutionary, new FarmFresh System™, with four freshness technologies designed to work together to keep your food fresher, longer. Enjoy less food waste, new innovative features and more thoughtful design.

Features & Benefits

VitaFreshPro™ provides pre-programmed freshness settings to optimize temperature and humidity to keep meat, fish, and produce fresher, longer.

Interior Water Dispenser is thoughtfully placed inside for refreshing water at the touch of a button or a push of a nozzle.

FlexBar™ utilizes typically unused space in the upper refrigerator cavity.

Recessed handle provides flush design to match any sleek kitchen.

General Properties	
Full 72" height and true counter depth for built-in appearance	Yes
Lighting	Recessed LED light bars
Number of compressors/evaporators	2 / 2
Defrost process refrigerator section	Frost-free
Number of shelves – refrigerator	5
Adjustable shelves – refrigerator	4 half-width
Shelf material – refrigerator	Tempered glass
Type of shelves – refrigerator	Frameless split shelves with metal trim
Flexible storage bar	FlexBar™
Gallon storage bins	3
Humidity control compartments	2
Full width temp. & humidity controlled drawer	VitaFreshPro™
Ice maker	Yes
Water filter	UltraClarityPro™
Internal water dispenser	Yes
Touch control panel	Yes
AirFresh® filter	Yes
FreshProtect™ ethylene filter	Yes
MultiAirFlow™	Yes
Stainless steel back wall	Yes
Defrost process freezer section	Automatic
Number of drawers – freezer	3
Wi-Fi enabled	Yes, Home Connect™ app

Capacity	
Total capacity (cu. ft.)	20.5
Refrigerator capacity (cu. ft.)	14.5
Freezer capacity (cu. ft.)	6
Technical Details	
Current (A)	15 A
Volts (V)	115 V
Frequency (Hz)	60 Hz
Power cord length (in.)	91
Plug type	120V-3 prong
Dimensions & Weight	
Appliance dimensions with hinges and doors (H x W x D) (in.)	72** x 35 5/8" x 28 3/4"
Appliance dimensions without hinges and doors (H x W x D) (in.)	71 1/2" x 35 5/8" x 24***
Required cutout size (H x W x D) (in.)	72" x 36" x 25"
Net weight (lbs)	350 lbs
Efficiency	
Energy consumption (kWh/yr)	568
ENERGY STAR® qualified	Yes – Tier 1
Accessories	
UltraClarityPro™ Water Filter: BORPLFTR50 FreshProtect™ Ethylene Filter Kit: BOETHSCV10 FreshProtect™ Ethylene Filter Refill: BOFRSRF FlexBar™ Bottle Holder: BOFLEXBOTL FlexBar™ Deep Shelf: BOFLEXLGSH FlexBar™ Shallow Shelf: BOFLEXSMSh FlexBar™ Egg Tray: BOFLEXEGG	



*When leveling legs are fully extended, add 5/8" to overall height, total 72 5/8".

**The cutout depth of 25" includes the required 1" airflow. The electrical covers on the back of unit do not require additional depth.

Accessories: To purchase Bosch accessories, cleaners & parts please visit www.bosch-home.com/us/store or call 1-800-944-2904 (Mon to Fri 5 am to 6 pm PST, Sat: 5 am to 3 pm PST).
Notes: All height, width and depth dimensions are shown in inches. BSH reserves the absolute and unrestricted right to change product materials and specifications, at any time, without notice. Consult the product's installation instructions for final dimensional data and other details prior to making cutout.

Warranties: Please see Use & Care manual or Bosch website for statement of limited warranty.

For more information on our entire line of products, go to www.bosch-home.com/us or call 1-800-944-2904

© BSH Home Appliances Corporation. All rights reserved. Bosch is a registered trademark of Robert Bosch GmbH.

36" Counter-Depth 4-Door Refrigerator

800 Series – Stainless Steel B36CL80ENS

APR 28 2021

THAMES 4B: LOT 96
RE: FRIDGE SPEC'S

Flush Mount Accomodations

Installation Details

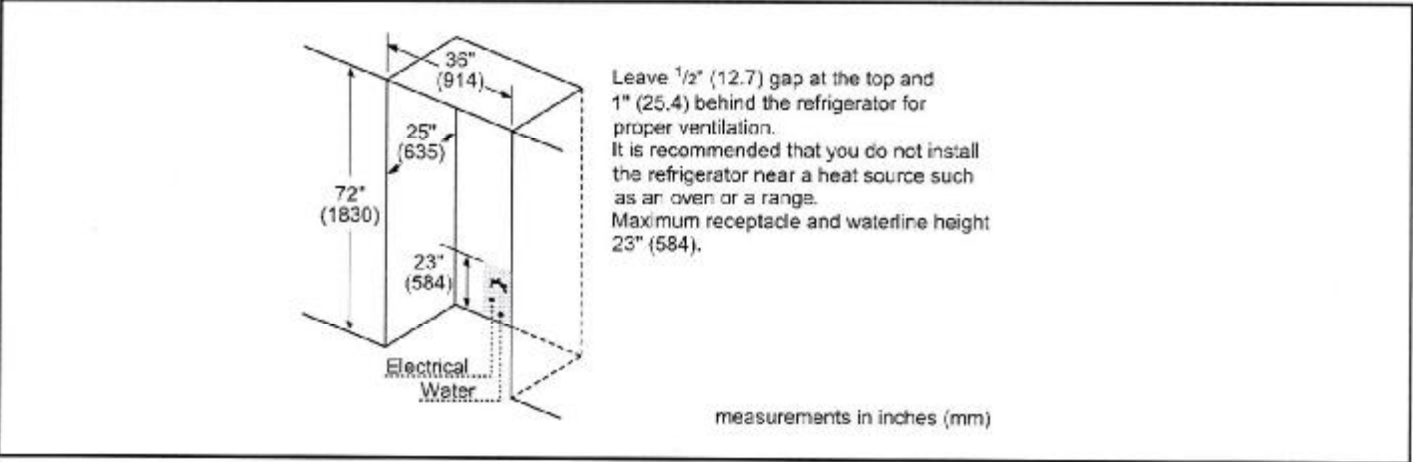
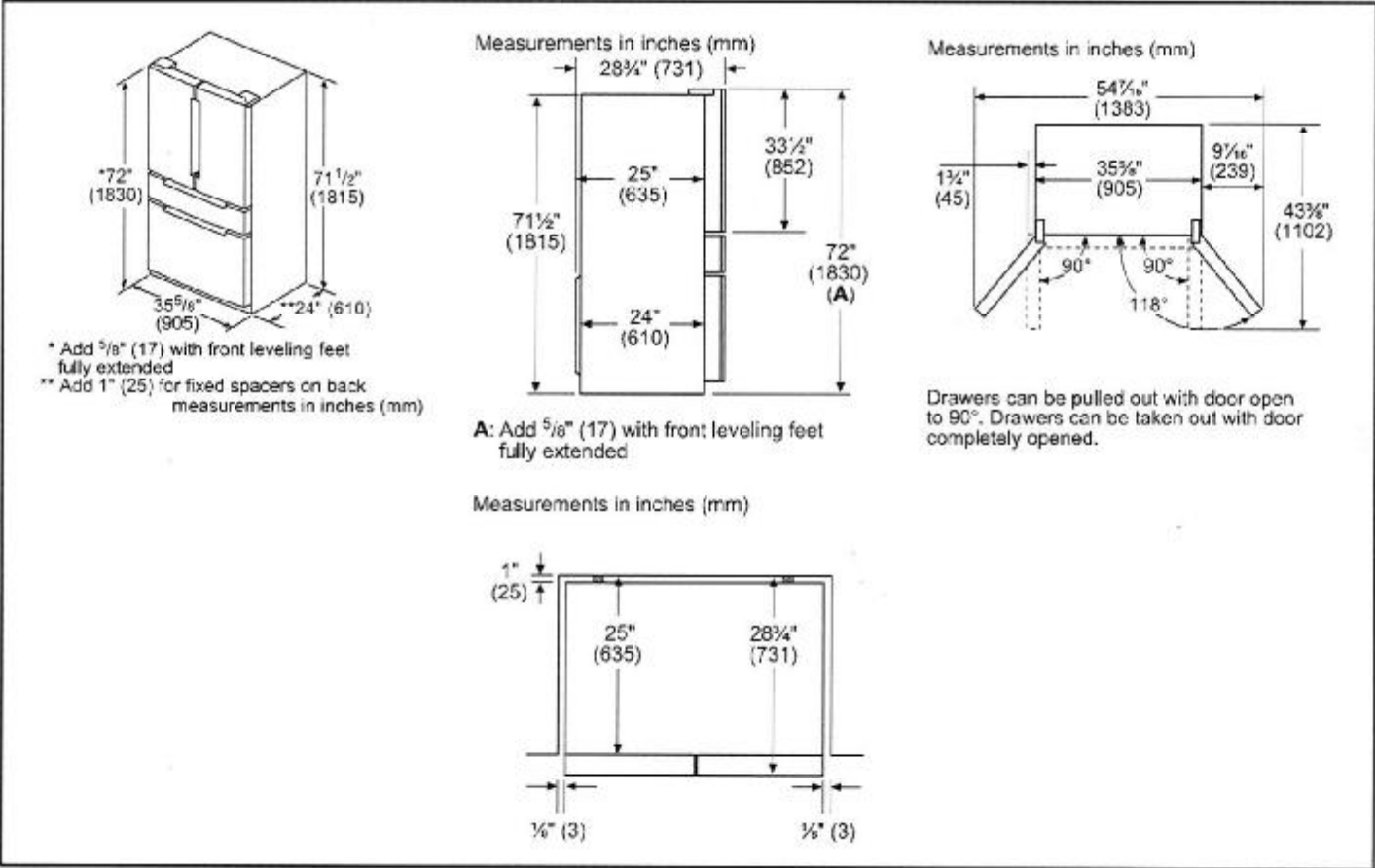

Accessories: To purchase Bosch accessories, cleaners & parts please visit www.bosch-home.com/us/store or call 1-800-944-2904 (Mon to Fri 5 am to 6 pm PST, Sat 6 am to 3 pm PST).

Notes: All height, width and depth dimensions are shown in inches. BSH reserves the absolute and unrestricted right to change product materials and specifications, at any time, without notice. Consult the product's installation instructions for final dimensional data and other details prior to making cutout.

Warranties: Please see Use & Care manual or Bosch website for statement of limited warranty.

For more information on our entire line of products, go to www.bosch-home.com/us or call 1-800-944-2904

© BSH Home Appliances Corporation. All rights reserved. Bosch is a registered trademark of Robert Bosch GmbH.

06/19

36" Gas Cooktop

800 Series – Stainless Steel NGM8657UC

Alt. 2 of 121

THAMES 4B: LOT 96
RE: 36" GAS COOKTOP SPEC'S



NGM8657UC
Stainless Steel

The stainless steel gas cooktop with FlameSelect® – achieve consistent cooking results thanks to nine precisely defined power levels.

Features & Benefits

FlameSelect® – allows for a precise adjustment of the flame size with nine defined power levels

Dual flame power burner with two heat options, quickly boil water or maintain a precise simmer

Heavy-duty grates can be easily and quickly cleaned in the dishwasher

OptiSim® burner – simmer delicate sauces and melt chocolate without scorching

Low profile stainless steel cooking surface is easily accessible and quick to clean

General Properties	
No. of burners	5
Knob color	Stainless steel appearance
Control location	Front-center
Sealed burners	Yes
Gas valves	Five 9-level step valves
Ignition system	Electric; thermocouple safety control
Cooktop surface material	Stainless steel
Grate material	Cast iron
Grate features	Continuous grates; dishwasher safe

Element Performance	
Total BTU load (NG / LP)	41,400 / 40,100
Power of front left burner (NG / LP) OptiSim®	3,400 / 3,400 BTU
Power of back left burner (NG / LP)	6,000 / 6,000 BTU
Power of center burner (NG / LP) Dual-flame	17,000 / 15,700 BTU
Power of back right burner (NG / LP)	9,000 / 9,000 BTU
Power of front right burner (NG / LP)	6,000 / 6,000 BTU

Technical Details	
Circuit breaker	15 A
Volts	120 V
Frequency	60 Hz
Plug type	3-prong
Power cord length	40"
Fuel type	Natural Gas (factory set)
Convertible to LP (kit required)	Yes

Dimensions & Weight	
Overall appliance dimensions (HxWxD)	2 23/64" x 36" x 20 1/2"
Required cutout size (HxWxD)	1 1/4" x 33 1/2" x 19 5/16"
Minimum distance from counter front	1 7/8"
Minimum distance from rear wall	3"
Net weight	42 lbs

Accessories – Included	
Included	LP conversion kit, OptiSim® cap

Accessories – Optional



HEZ298107
Wok ring



FlameSelect

Accessories: To purchase Bosch accessories, cleaners & parts please visit www.bosch-home.com/us/store or call 1-800-944-2904 (Mon to Fri 9 am to 6 pm PST, Sat 9 am to 5 pm PST).
Notes: All height, width and depth dimensions are shown in inches. BSH reserves the absolute and unrestricted right to change product materials and specifications, at any time, without notice. Consult the product's installation instructions for final dimensional data and other details prior to making cutout.
Warranties: Please see Use & Care manual or Bosch website for statement of limited warranty.
For more information on our entire line of products, go to www.bosch-home.com/us or call 1-800-944-2904
© BSH Home Appliances Corporation. All rights reserved. Bosch is a registered trademark of Robert Bosch GmbH.

36" Gas Cooktop

800 Series – Stainless Steel NGM8657UC

THAMES 4B: LOT 96
RE: 36" GAS COOKTOP SPEC'S

APR 28 2021

Installation Details

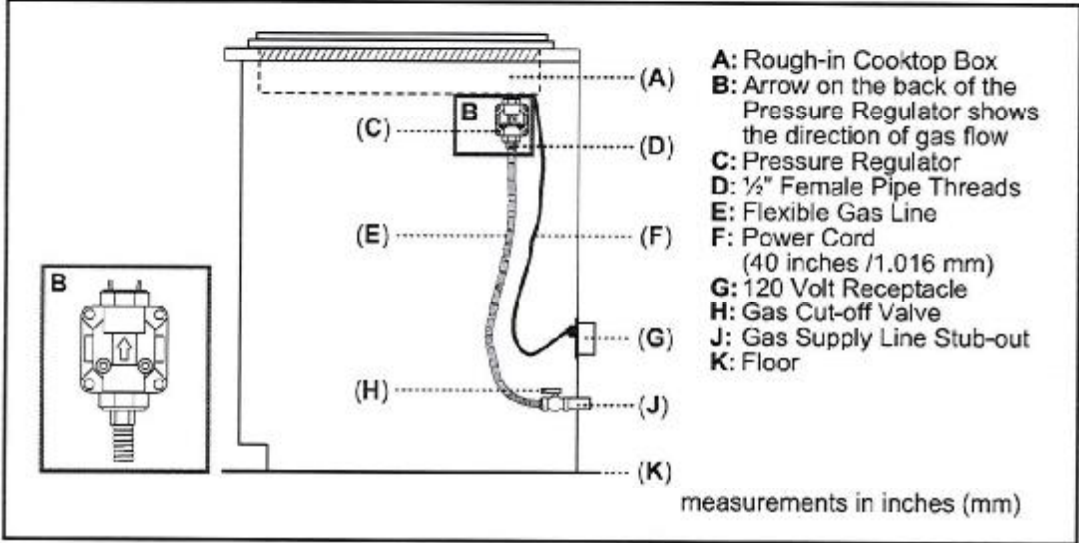
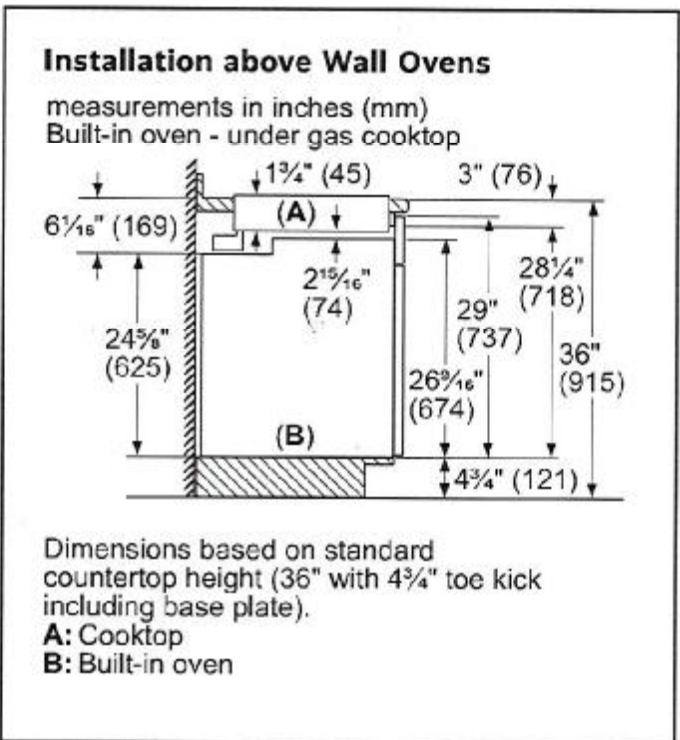
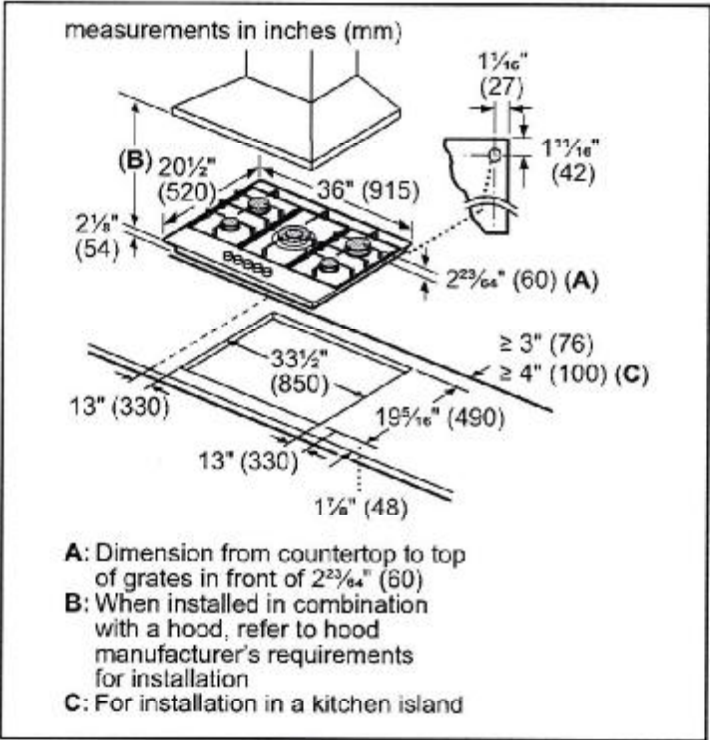

Accessories: To purchase Bosch accessories, cleaners & parts please visit www.bosch-home.com/us/store or call 1-800-944-2904 (Mon to Fri 5 am to 6 pm PST, Sat 6 am to 3 pm PST).

Notes: All height, width and depth dimensions are shown in inches. BSH reserves the absolute and unrestricted right to change product materials and specifications, at any time, without notice. Consult the product's installation instructions for final dimensional data and other details prior to making cutout.

Warranties: Please see Use & Care manual or Bosch website for statement of limited warranty.

For more information on our entire line of products, go to www.bosch-home.com/us or call 1-800-944-2904

© BSH Home Appliances Corporation. All rights reserved. Bosch is a registered trademark of Robert Bosch GmbH.

36" Gas Cooktop

800 Series – Stainless Steel NGM8657UC

THAMES 4B: LOT 96
RE: 36" GAS COOKTOP SPEC'S

APR 28 2021

Installation Details

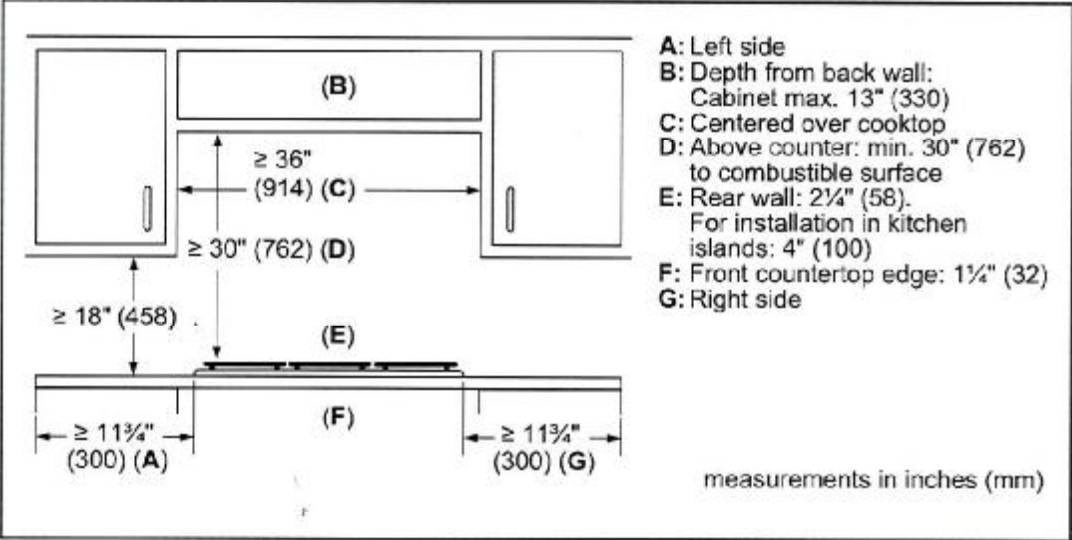

Accessories: To purchase Bosch accessories, cleaners & parts please visit www.bosch-home.com/us/store or call 1-800-944-2904 (Mon to Fri 5 am to 6 pm PST, Sat 6 am to 3 pm PST).
Notes: All height, width and depth dimensions are shown in inches. BSH reserves the absolute and unrestricted right to change product materials and specifications, at any time, without notice. Consult the product's installation instructions for final dimensional data and other details prior to making cutout.

Warranties: Please see Use & Care manual or Bosch website for statement of limited warranty

For more information on our entire line of products, go to www.bosch-home.com/us or call 1-800-944-2904

© BSH Home Appliances Corporation. All rights reserved. Bosch is a registered trademark of Robert Bosch GmbH.

06/19





30" Speed Oven

800 Series – Stainless Steel HMC80152UC

THAMES 4B: LOT 96
RE: 30" SPEED OVEN SPEC'S

APR 28 2021



HMC80152UC
Stainless Steel

The speed oven pairs the cooking qualities of a conventional oven with the speed of microwave technology.

Features & Benefits

- SpeedChef™ cooking cycles offer faster cooking times for your convenience.
- Flush install matches Bosch wall oven, steam oven, or warming drawer.
- 2-in-1 microwave and convection oven for a variety of cooking options.
- 30" width can be installed in horizontal and vertical configuration.
- Electrical connection – 120 Volt NEMA 5-20 three prong plug.
- LED lights

General Properties	
Cavity material	Stainless steel
Max. microwave power (W)	1,000 W
Capacity	
Cavity capacity (cu. ft.)	1.6
Turntable diameter (in.)	14 1/8"
Technical Details	
Watts (W)	1,920 W
Circuit breaker (A)	20 A
Volts (V)	120 V
Frequency (Hz)	60 Hz
Power cord length (in)	43"
Plug type	NEMA 5-20 – 3 prong plug

Dimensions & Weight	
Overall appliance dimensions (HxWxD) (in)	19 5/8" x 29 3/4" x 22 3/8"
Required cutout size (HxWxD) (in)	(Standard) 19 1/4" x 28 1/2" x 22"
	(Flush) 20 1/8" x 30" x 23 1/2"
Oven overall interior dimensions (HxWxD) (in.)	9 7/8" x 16 1/2" x 16 1/2"
Turntable – Metal Max. Cookware	12 3/4" dia.
Turntable – Ceramic Max. Cookware	12 1/2" dia.
Rack – Rectangular Cookware Max.	15" x 12"
Net weight (lbs)	92 lbs
Accessories-Included	
Included	Metal turntable, cooking rack, ceramic cooking tray



For help and assistance with Bosch accessories please call 1-800-944-2904 Mon-Fri 9am to 6pm EST

Notes: All height, width and depth dimensions are shown in inches. BSH reserves the absolute and unrestricted right to change product materials and specifications, at any time, without notice. Consult the product's installation instructions for final dimensional data and other details prior to making cutout. Applicable product warranty can be found in accompanying product literature or you may contact your account manager for further details.

Warranties: Bosch warrants that the Product is free from defects in materials and workmanship for a period of three hundred and sixty-five (365) days from the date of purchase. The foregoing timeline begins to run upon the date of purchase, and shall not be stalled, tolled, extended, or suspended, for any reason whatsoever. This Product is also warranted to be free from cosmetic defects in material and workmanship (such as scratches of stainless steel, paint/porcelain blemishes, chip, dents, or other damage) to the finish of the Product, for a period of thirty (30) days from the date of purchase or closing date for new construction. This cosmetic warranty excludes slight color variations due to inherent differences in painted and porcelain parts, as well as differences caused by kitchen lighting, product location, or other similar factors. This cosmetic warranty specifically excludes any display, floor, "As Is", or "B" stock appliances.

For more information on our entire line of products, go to www.bosch-home.ca or call 1-800-944-2904

© BSH Home Appliances Limited. All rights reserved. Bosch is a registered trademark of Robert Bosch GmbH.

30" Speed Oven

800 Series – Stainless Steel HMC80152UC

THAMES 4B: LOT 96
RE: 30" SPEED OVEN SPEC'S

APR 28 2021

Installation Details

* Power cord with plug on 120 V units is 43" (1092)

* Includes 3/4" (19) base plate
** Receptacle may be located to the left or right of the unit within reach of the power cord.

* Receptacle may be located above or beneath the unit within reach of the power cord.

IMPORTANT: Bosch Speed Oven is not approved to be installed under a cooktop.

measurements in inches (mm)

Flush Install Top View

* Flush Installation requires a 5/16" (8 mm) high x 28 1/2" (724 mm) wide x 22 1/2" (571 mm) deep baseplate underneath the unit body.

Side View

measurements in inches (mm)

Example Flush Install

For help and assistance with Bosch accessories please call 1-800-944-2904 Mon-Fri 8am to 6pm EST

Notes: All height, width and depth dimensions are shown in inches. BSH reserves the absolute and unrestricted right to change product materials and specifications, at any time, without notice. Consult the product's installation instructions for final dimensional data and other details prior to making cutout. Applicable product warranty can be found in accompanying product literature or you may contact your account manager for further details.

Warranties: Bosch warrants that the Product is free from defects in materials and workmanship for a period of three hundred and sixty-five (365) days from the date of purchase. The foregoing timeline begins to run upon the date of purchase, and shall not be stalled, tolled, extended, or suspended, for any reason whatsoever. This Product is also warranted to be free from cosmetic defects in material and workmanship (such as scratches of stainless steel, paint/porcelain blemishes, chip, dents, or other damage) to the finish of the Product, for a period of thirty (30) days from the date of purchase or closing date for new construction. This cosmetic warranty excludes slight color variations due to inherent differences in painted and porcelain parts, as well as differences caused by kitchen lighting, product location, or other similar factors. This cosmetic warranty specifically excludes any display, floor, "As Is", or "B" stock appliances.

For more information on our entire line of products, go to www.bosch-home.ca or call 1-800-944-2904

© BSH Home Appliances Limited. All rights reserved. Bosch is a registered trademark of Robert Bosch GmbH.

30" Speed Oven

800 Series – Stainless Steel HMC80152UC

THAMES 4B: LOT 96
RE: 30" SPEED OVEN SPEC'S

APR 28 2021

Installation Details

Standard

Side-by-Side Installation

The ovens will overlap the cutout resulting in a 1/2" (13mm) spacing between the products.

IMPORTANT: The spacing between cutouts applies when installing any Bosch 30" or 27" single, double, combination and 27"/30" compact oven in a side-by-side installation.

Flush

Standard Installation Over Single Oven

*Junction box may be located above or next to the unit within reach of the power cord.

** Junction box may be located below (depending on space) or next to the unit within reach of the power cord.

***Most combinations available as combo oven (one cut out, one electrical hook up).

Minimum dimension between cut outs:

- 1" (25 mm) for wall oven cut out height of 28⁵/₈"
- 2⁵/₈" (67 mm) for wall oven cut out height of 27"

Flush Installation Over Single Oven

Side View

Speed Oven or Microwave

***Flush installation requires a base plate underneath the body: 30" Products – Dimensions: H 5⁷/₈" (8) x W 28¹/₂" (724) x D 22¹/₂" (571)

flush cut out height

minimum 1/2" (13) required between cutouts*

Wall Oven

flush cut out height

*IMPORTANT: Base has to be able to support over weight. Please check oven manual for minimum weight requirements.

***Most combinations available as combo oven (one cut out, one electrical hook up).

measurements in inches (mm)

Flush Installation Over Single Oven with SideSwing door

Side View

Speed Oven or Microwave

***Flush installation requires a base plate underneath the body: 30" Products – Dimensions: H 5⁷/₈" (8) x W 28¹/₂" (724) x D 22¹/₂" (571)

flush cut out height

minimum 1/2" (13) required between cutouts*

Wall Oven

flush cut out height

*IMPORTANT: Base has to be able to support over weight. Please check oven manual for minimum weight requirements.

***Most combinations available as combo oven (one cut out, one electrical hook up).

measurements in inches (mm)

For help and assistance with Bosch accessories please call 1-800-944-2904 Mon-Fri 8am to 6pm EST

Notes: All height, width and depth dimensions are shown in inches. BSH reserves the absolute and unrestricted right to change product materials and specifications, at any time, without notice. Consult the product's installation instructions for final dimensional data and other details prior to making cutout. Applicable product warranty can be found in accompanying product literature or you may contact your account manager for further details.

Warranties: Bosch warrants that the Product is free from defects in materials and workmanship for a period of three hundred and sixty-five (365) days from the date of purchase. The foregoing timeline begins to run upon the date of purchase, and shall not be stalled, tolled, extended, or suspended, for any reason whatsoever. This Product is also warranted to be free from cosmetic defects in material and workmanship (such as scratches of stainless steel, paint/porcelain blemishes, chip, dents, or other damage) to the finish of the Product, for a period of thirty (30) days from the date of purchase or closing date for new construction. This cosmetic warranty excludes slight color variations due to inherent differences in painted and porcelain parts, as well as differences caused by kitchen lighting, product location, or other similar factors. This cosmetic warranty specifically excludes any display, floor, "As Is", or "B" stock appliances.

For more information on our entire line of products, go to www.bosch-home.ca or call 1-800-944-2904

© BSH Home Appliances Limited. All rights reserved. Bosch is a registered trademark of Robert Bosch GmbH.

30" Single Wall Oven

800 Series – Stainless Steel HBL8453UC

THAMES 4B: LOT 96
RE: 30" SINGLE WALL OVEN
SPEC'S

APR 28 2021



HBL8453UC
Stainless Steel

Also available in:
Black HBL8463UC
Black Stainless HBL8443UC
Steel

Using Genuine European Convection Roast, you can create a juicy, tender roast up to 25% faster than non-convection modes.

Features & Benefits

- Get the oven up to temperature in less time using Fast Preheat™, so meals are ready sooner.
- Whether cooking poultry, beef or pork, use the Temperature Meat Probe to monitor the internal temperature and get perfect results every time.
- Serve dinner on time with tools like an oven timer, delay cook feature, and digital kitchen timer.
- Oven is equipped with a self-cleaning cycle that easily cleans itself via 2, 3, and 4 hour cycle options.
- Download the Home Connect app to remotely monitor and control your Bosch wall oven with your smart phone or tablet.

General Properties	
Home Connect™ (WiFi enabled)	Yes
Oven modes	Bake, Variable Broil (hi & low), Roast, Warm, Sabbath, Proof Dough, Convection Bake, Convection Broil, Convection Roast, Pizza, Multi Rack Genuine European Convection, Convection Conversion, Temperature Probe, Fast Preheat
Cleaning type	Self Clean
Telescopic rack	1
Illumination type	Incandescent
Interior lights	2
Oven Performance	
Bake / broil element wattages	2,400 / 3,800 W
Convection element wattages	2,000 W
Technical Details	
Watts (W)	6,325 W
Circuit breaker (A)	30 A
Volts (V)	240 / 208 V
Frequency (Hz)	60 Hz
Power cord length (in)	50"
Plug type	Fixed Connection, No Plug
Energy source	Electric

Dimensions & Weight	
Overall appliance dimensions (HxWxD)(in)	29" x 29 3/4" x 24 1/2"
Required cutout size (HxWxD) (in)	27" – 28 5/8" x 28 1/2" x 23 1/2"
Oven cavity size (cu. ft.)	4.6
Overall oven interior dimensions (HxWxD) (in)	17 13/16" x 24 1/8" x 18"
Usable oven interior dimensions (HxWxD) (in)	12 1/4" x 23 1/4" x 15 1/4"
Net weight (lbs)	149 lbs
Accessories – Included	
Included	1 Telescopic and 2 Standard Oven Racks, Temperature Probe
Accessories – Optional	



HEZTR301
30" Telescopic Rack

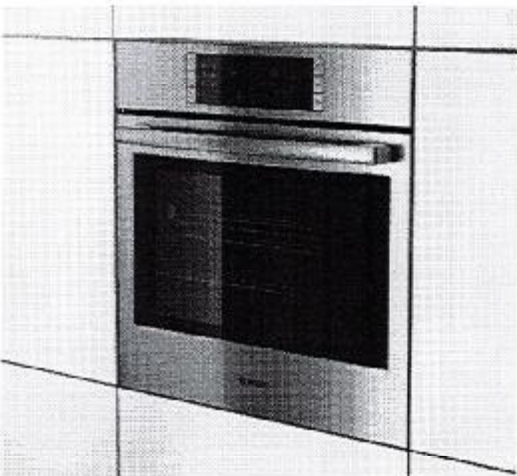

Accessories: To purchase Bosch accessories, cleaners & parts please visit www.bosch-home.com/us/store or call 1-800-944-2904 (Mon to Fri 5 am to 6 pm PST, Sat 6 am to 3 pm PST).
Notes: All height, width and depth dimensions are shown in inches. BSH reserves the absolute and unrestricted right to change product materials and specifications, at any time, without notice. Consult the product's installation instructions for final dimensional data and other details prior to making cutout.
Warranties: Please see Use & Care manual or Bosch website for statement of limited warranty.
For more information on our entire line of products, go to www.bosch-home.com/us or call 1-800-944-2904
© BSH Home Appliances Corporation. All rights reserved. Bosch is a registered trademark of Robert Bosch GmbH.

+

+

30" Single Wall Oven

800 Series – Stainless Steel HBL8453UC

THAMES 4B: LOT 96
RE: 30" SINGLE WALL OVEN
SPEC'S

APR 28 2021

Installation Details

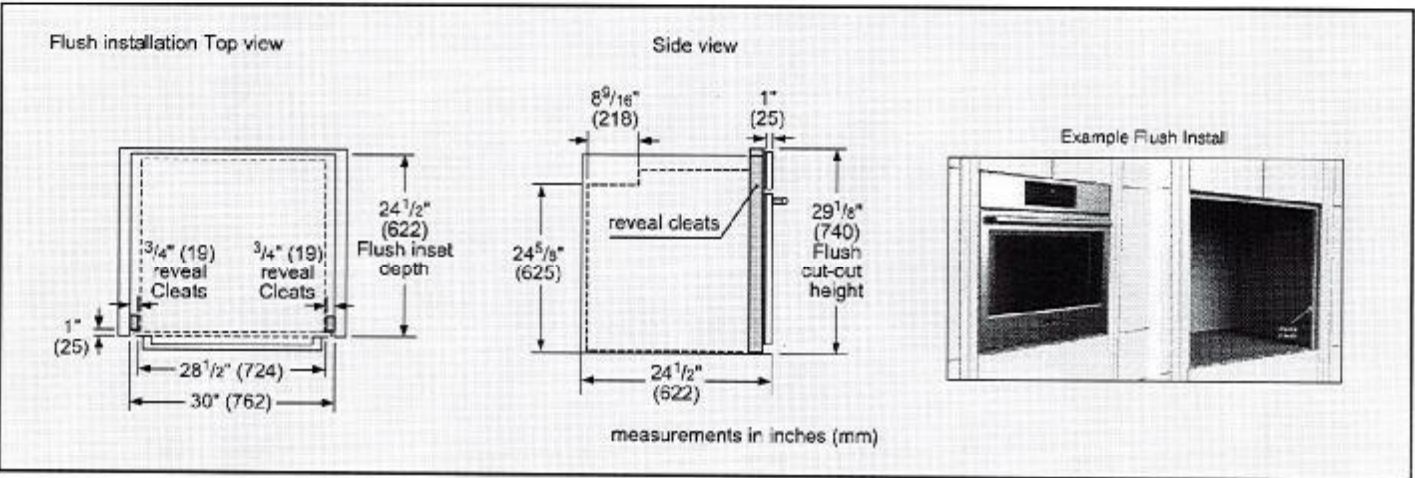
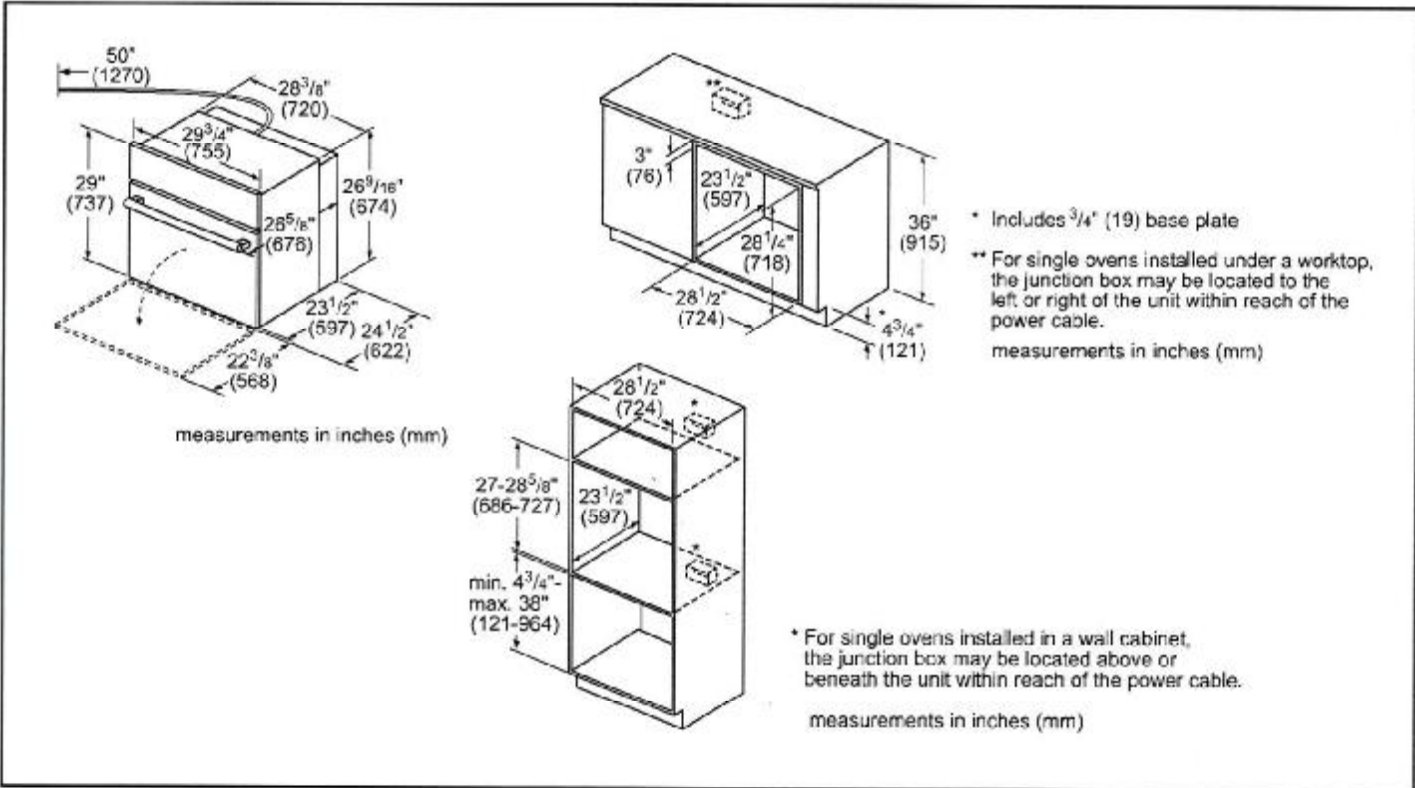

Accessories: To purchase Bosch accessories, cleaners & parts please visit www.bosch-home.com/us/store or call 1-800-944-2504 (Mon to Fri 5 am to 6 pm PST, Sat 6 am to 3 pm PST).

Notes: All height, width and depth dimensions are shown in inches. BSH reserves the absolute and unrestricted right to change product materials and specifications, at any time, without notice. Consult the product's installation instructions for final dimensional data and other details prior to making cutout.

Warranties: Please see Use & Care manual or Bosch website for statement of limited warranty.

For more information on our entire line of products, go to www.bosch-home.com/us or call 1-800-944-2504

© BSH Home Appliances Corporation. All rights reserved. Bosch is a registered trademark of Robert Bosch GmbH.

30" Single Wall Oven

800 Series – Stainless Steel HBL8453UC

THAMES 4B: LOT 96
RE: 30" SINGLE WALL OVEN
SPEC'S

APR 28 2021

Installation Details

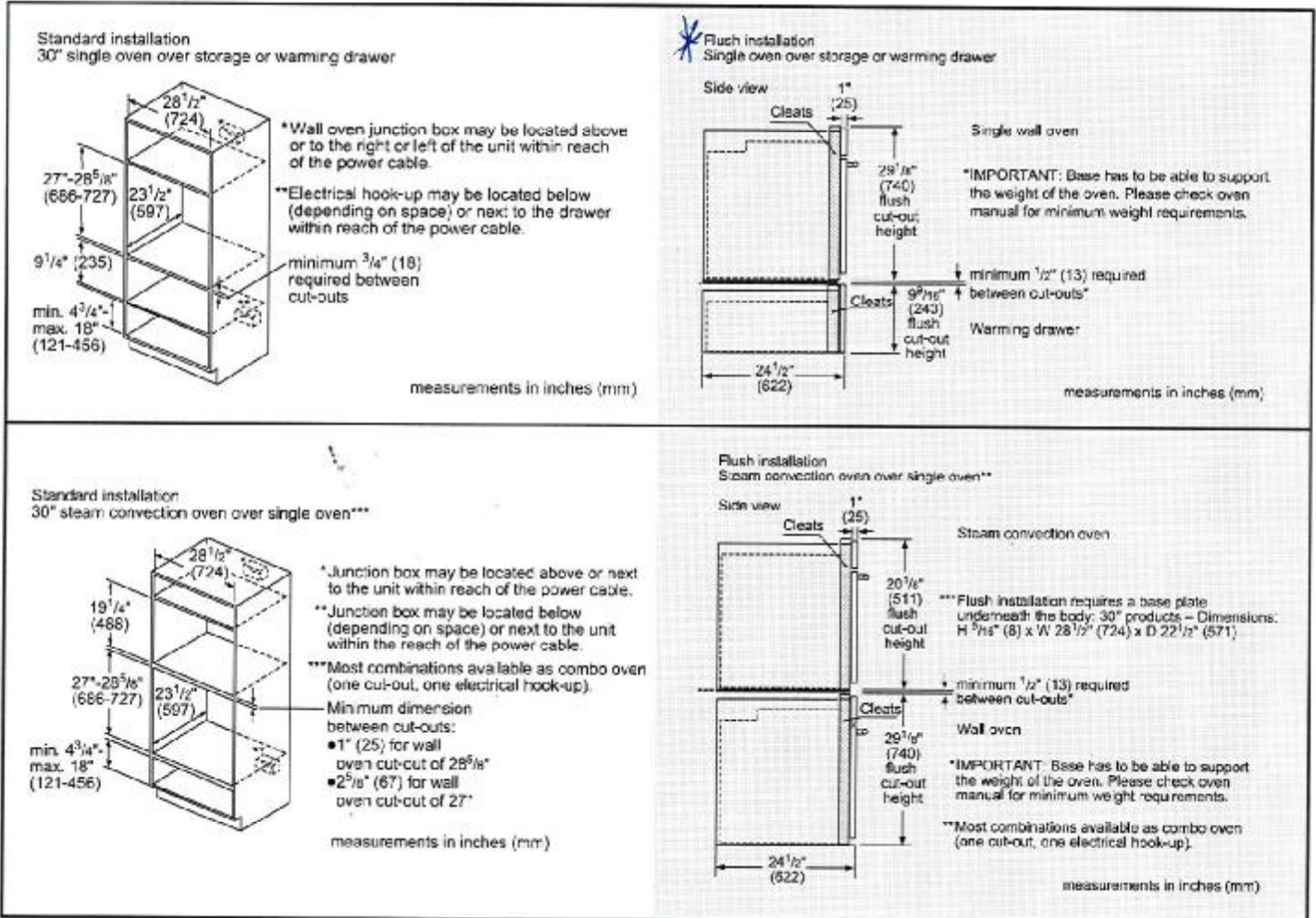

Accessories: To purchase Bosch accessories, cleaners & parts please visit www.bosch-home.com/us/store or call 1-800-944-2904 (Mon to Fri 9 am to 6 pm PST, Sat 9 am to 3 pm PST).

Notes: All height, width and depth dimensions are shown in inches. BSH reserves the absolute and unrestricted right to change product materials and specifications, at any time, without notice. Consult the product's installation instructions for final dimensional data and other details prior to making cutout.

Warranties: Please see Use & Care manual or Bosch website for statement of limited warranty.

For more information on our entire line of products, go to www.bosch-home.com/us or call 1-800-944-2904

© BSH Home Appliances Corporation. All rights reserved. Bosch is a registered trademark of Robert Bosch GmbH.

06/19