



CONSTRUCTION SUMMARY

Kingsmen (Thames) Inc. / Havelock Corners (Kingsmen)

Lot/Unit: 88    Phase/Building: 4B    Model/Floor Plan: Spencer (4204) Elev C 4 Bed - 4+1 Bath

ELECTRICAL

Inv.4876	1 - To supply & install the standard T.V. rough in in the great room & master bedroom... see sketh # 1 & # 2	
Line 62788	Note:	
29Jan21 / 29Jan21		
Inv.4876	1 - To supply & install the standar Phone ( CAT 5 ) rough in great room, master bedroom and Media niche area... see sketch # 1 & # 2	
Line 62789	Note:	
29Jan21 / 29Jan21		
Inv.4876	1 - Relocate the standard ceiling light from the upper stair lanidng to the O.T.B. area on the second floor... see sketch # 2	
Line 62790	Note:	
29Jan21 / 29Jan21		

HEATING AND AIR CONDITIONING

Inv.4876	1 - As per schedule "PE" Vender to install capped gas (rough in only ) at rear of home for future BBQ location. Location to be finalized at vendors sole discretion.	
Line 62786	Note:	
29Jan21 / 29Jan21		
Inv.4876	1 - As per schedule "PE" Vendor to supply & install air conditioning unit, sized accordingly, from vendors standard samples.	
Line 62787	Note:	
29Jan21 / 29Jan21		

PAINT AND DRYWALL

Inv.4876	1 - To supply & install the standard coffered ceiling in the dining room as per plan	
Line 62793	Note:	
29Jan21 / 29Jan21		

PLUMBING

Inv.4876	1 - To supply & install the BLANCO QUATRUS under mount kitchen sink model # 401247 in the kitchen in lieu of the standard under mount kitchens sink... see spec's	
Line 62791	Note: Still to install the standard single hole kitchen faucet.	
29Jan21 / 29Jan21		



CONSTRUCTION SUMMARY

Kingsmen (Thames) Inc. / Havelock Corners (Kingsmen)

Lot/Unit: 88    Phase/Building: 4B    Model/Floor Plan: Spencer (4204) Elev C 4 Bed - 4+1 Bath

EXTRAS AS PER OFFER

5 FREE APPLIANCES ? STAINLESS STEEL FRONT - FRIDGE: STOVE AND DISHWASHER. WHITE WASHER AND DRYER (SUPPLIED ONLY, NOT INSTALLED, FROM BUILDERS STANDARD LINE) TO ARRANGE DELIVERY ? CALL THE BRICK COMMERCIAL SALES DIVISION AT 1-877-353-2850. <i>Worksheet</i> Note:	
VENDOR TO INSTALL CAPPED GAS LINE (ROUGH-IN ONLY) AT REAR OF HOME FOR FUTURE BBQ LOCATION.   LOCATION TO BE FINALIZED AT VENDORS SOLE DISCRETION. <i>Worksheet</i> Note:	
VENDOR TO SUPPLY & INSTALL AIR CONDITIONING UNIT, SIZED ACCORDINGLY, FROM VENDORS STANDARD SAMPLES. <i>Worksheet</i> Note:	

FEB - 9 2021

**Purchasers:** JASVIR SINGH RANDHAWA & Charanjit K Randhawa  
**Telephone Res. / Bus:** /  
**Decor Advisor:** Barbara Coccia  
**Property:** 88 of Plan - Draft Approval SB17-03-08  
**Project:** Kingsmen (Thames) Inc.  
**Model and Elevation:** Spencer (4204) Elev C 4 Bed - 4+1 Bath

**Layout Changes:** ☐ Yes ☒ No **Sketch Attached:** ☒ Yes ☐ No **Exterior Colour Scheme:**

### 1. Cabinetry

	Style and Colour	Counter Top	Hardware
Kitchen / Breakfast	#3 Charleston 3DL Rain Cloud	#1 C/S #9141 Ice Snow 3cm	12881 Handle
Kitchen Island	#3 Charleston 3DL Rain Cloud	#1 C/S #9141 Ice Snow 3cm	12881 Handle
Laundry Room	/	/	/
Powder Room	#3 Charleston 3DL Rain Cloud	Calcutta Marble 4925K-07	12881 Handle
Main Bathroom	/	/	/
Master Ensuite Bathroom	#2 Slab LPL Stainless	White Carrara 4924-38	135 Knob
Second Ensuite Bathroom (If Applicable)	#2 Slab LPL Stainless	White Carrara 4924-38	135 Knob
Bedroom #3 Bathroom	#5 St. Lawrence Coffee Bean	Autumn Carnival 1877K-52	12843 Handle
Bedroom #4 Bathroom	#5 St. Lawrence Coffee Bean	Autumn Carnival 1877K-52	12843 Handle

**Appliances**  
**Custom Size Fridge** ☐ Yes ☒ No  
**Valance Lighting** ☐ Yes ☒ No  
**Microwave / Range Hood** ☐ Yes ☒ No  
**Cooktop / Rangetop** ☐ Yes ☒ No  
**Built in Wall Oven** ☐ Yes ☒ No  
**Slide-in Range** ☐ Yes ☒ No  
**Comment**

### 2. Flooring

	Selection
Foyer	13x13" Malena Ice
Main Hall	3 1/2" Elements Oak Wolfhound
Back Hall	/
Breakfast	13x13" Malena Ice
Laundry Room	13x13" Malena Ice
Kitchen	13x13" Malena Ice
Powder Room	13x13" Malena Ice
Main Bathroom	(Bedroom #2 Bathroom)-13x13" Cinq Black SH/FL: 2x2" Soho White Matte
Master Ensuite	13x13" Cinq Black SH/FL: 2x2" Soho White Matte
Bathroom (If Applicable)	(Bedroom #3 Bathroom)-13x13" Malena Ivory
Mud Room	13x13" Malena Ice
Bedroom #4 Bathroom	13x13" Malena Ivory
Living Room	/
Dining Room	3 1/2" Elements Oak Wolfhound
Family / Great Room	3 1/2" Elements Oak Wolfhound
Den / Library / Study	/
Basement Landing (If Applies)	/
Lower Landing (If Applicable)	3 1/2" Elements Oak Wolfhound
Upper Landing	3 1/2" Elements Oak Wolfhound
Upper Hall	Stylish Story 1: 945 Felt Hat (Including Media Niche)
Master Bedroom	Stylish Story 1: 945 Felt Hat
Bedroom #2	Stylish Story 1: 945 Felt Hat
Bedroom #3	Stylish Story 1: 945 Felt Hat
Bedroom #4	Stylish Story 1: 945 Felt Hat
Bedroom #5	/
Shower Jamb	Master Ensuite & Bedroom #2- Anatolia Marmiline SNOW

SEE ATTACHED FOR SIGNATURES

Flooring Continued on Page 2

Initial: 

Page 1 of 3



FEB - 9 2021

Purchasers: JASVIR SINGH RANDHAWA & Charanjit K Randhawa Property: 88 of Plan - Draft Approval SB17-03-08  
 Telephone Res. / Bus: / Project: Kingsmen (Thames) Inc.  
 Decor Advisor: Barbara Coccia Model and Elevation: Spencer (4204) Elev C 4 Bed - 4+1 Bath

### 2. Flooring - Continued -

Upgrade Underpad	Type	Area
	Standard	2nd Floor
Carpet on Stairs	Capped	Runner - *Upgrade
Comment	/	/

### 3. Plumbing Fixtures / Faucets

Kitchen	Standard	Second Ensuite	Standard	Powder Room	Standard
Master Ensuite	Standard			Other Room	/
Main Bathroom	/	Bedroom #3/#4 Bathroom	Standard		

#### Comment

NOTE: The purchasers have upgraded to a undermount kitchen sink.. still to install the standard single hole faucet.. see invoice for details.

### 4. Wall Tile

	Tile Selection	Listello	Insert	Insert Selection
Main Bathroom	/	<input type="checkbox"/>	<input type="checkbox"/>	/
Master Ensuite	/	<input type="checkbox"/>	<input type="checkbox"/>	/
Tub Deck	/	<input type="checkbox"/>	<input type="checkbox"/>	/
Tub Apron	/	<input type="checkbox"/>	<input type="checkbox"/>	/
Tub Surround	/	<input type="checkbox"/>	<input type="checkbox"/>	/
Shower Stall	8x10" Malena Carbon	<input type="checkbox"/>	<input type="checkbox"/>	/
Second Ensuite	8x10" Malena Carbon	<input type="checkbox"/>	<input type="checkbox"/>	/
Bedroom #3 Bathroom	8x10" Malena Ivory	<input type="checkbox"/>	<input type="checkbox"/>	/
Bedroom #4 Bathroom	8x10" Malena Ivory	<input type="checkbox"/>	<input type="checkbox"/>	/
Kitchen Backsplash	/	<input type="checkbox"/>	<input type="checkbox"/>	/
Complete Backsplash	/	<input type="checkbox"/>	<input type="checkbox"/>	//

#### Comment

NOTE: To supply and install all wall tiles in all bathrooms (Master, Bedroom #2, #3 and #4) on the 10" side horizontally stacked where applicable).



horizontal stacked

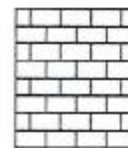

brick pattern

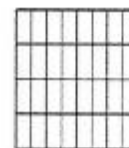

vertical stacked



diagonal/diamond

### 5. Fireplace

	Living Room			Family Room			Other Room - Specify Greatroom		
	Purchased	As Per Plan	N/A	Purchased	As Per Plan	N/A	Purchased	As Per Plan	N/A
Fireplace Type	<input type="radio"/>	<input type="radio"/>	<input type="radio"/>	<input type="radio"/>	<input type="radio"/>	<input type="radio"/>	<input type="radio"/>	<input checked="" type="radio"/>	<input type="radio"/>
Mantle Type							Front Facing		
Over Mantle							NF-08		
Colour / Stain							White		
Surround							/		
Hearth							/		
Comment	/								

SEE ATTACHED FOR SIGNATURES

Initial:

S.K.

**Purchasers:** JASVIR SINGH RANDHAWA & Charanjit K Randhawa **Property:** 88 of Plan - Draft Approval SB17-03-08  
**Telephone Res. / Bus:** / **Project:** Kingsmen (Thames) Inc.  
**Decor Advisor:** Barbara Coccia **Model and Elevation:** Spencer (4204) Elev C 4 Bed - 4+1 Bath

### 6. Trim Carpentry

Door Hardware

Interior Trim

Comment

#### Interior Doors

☐ 2 Panel Arch Top

☒ 2 Panel Square Top

☐ 6 Panel

Initial for Door Style C.K.

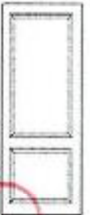

### 7. Railings and Pickets

Railing Package

Railing Colour

Wood Stairs ☐ No ☒ Oak

Picket Colour

Tread Colour

Comment

SEE ATTACHED FOR SIGNATURES

### 8. Plaster Mouldings and Medallions

Foyer

Main Hall

Living Room

Dining Room

Family Room

Kitchen/Breakfast

Den/Library

Lower Landing

Comment

### 9. Wall Paint

Smooth Ceilings ☐ First Floor

☐ First Floor incl. Second Floor Hall

☐ First and Second Floor

☒ Throughout

☐ Not Applicable

Trim Paint

### 10. Additional Comments

### 11. Disclaimers and Notes

- Colours of all materials are as close as possible to builder's selection, but not necessarily identical due to variances in manufacturing.
- Any extras listed above are null and void unless accompanied by a separate invoice/amendment. Said invoice must be paid in full.
- The Purchaser acknowledges that after Interior Colour Selection form is signed and dated, no further changes will be permitted other than re-selection due to unavailability. C.K. Purchaser's Initials SEE ATTACHED FOR SIGNATURES
- The Purchaser acknowledges reading and accepting the "Kingsmen Group Décor Centre Disclaimers" form. This document contains other miscellaneous disclaimers.

This Interior Colour Selection is final and approved by:

Purchaser:

Signature: Charanjit K Randhawa Date: 29 Jan 2021

Signature: SEE ATTACHED FOR SIGNATURES

Date: \_\_\_\_\_

Vendor: \_\_\_\_\_

Kingsmen (Thames) Inc.



# SCHEDULE "B-1"

## Floor Plan

FEB - 8 2021

Model: Spencer (4204) Elev C 4 Bed - 4+1 Bath  
Standard

Lot 88

Phase 4B

Sketch #1

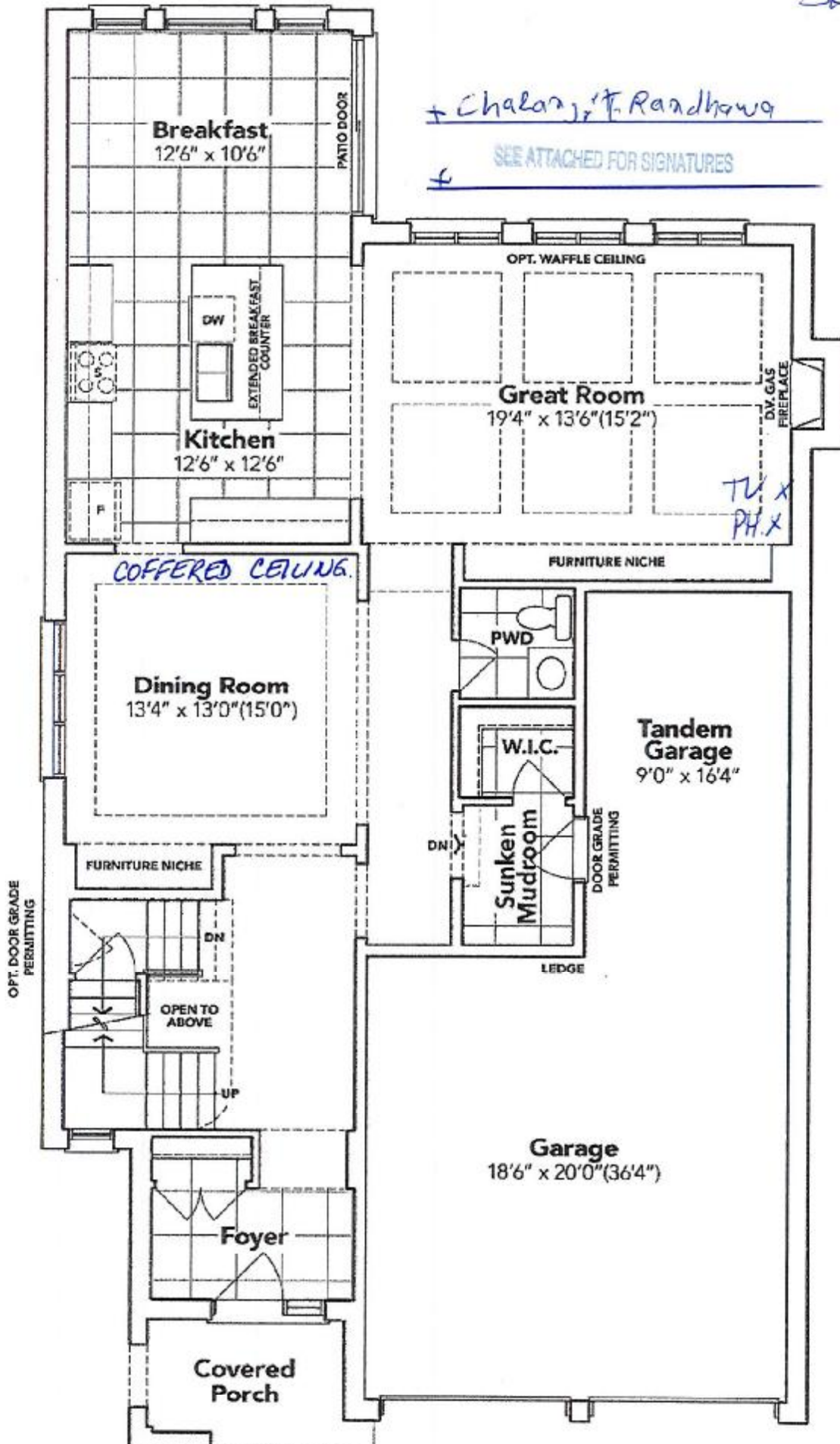

## GROUND FLOOR EL. C

The floor plans and elevations shown are pre-construction plans and may be revised or improved as necessitated by architectural controls and the construction process. The measurements adhere to the rules and regulations of the TARION Warranty Corporation's official method for the calculation of floor area. Materials, specifications and floor plans are subject to change without notice. All house renderings are artist's concept only. Actual usable floor space may vary from the stated floor area. All options shown are upgrades. E. & O. E.

**SCHEDULE "B-1"**  
**Floor Plan**

Lot 88  
Phase 4B  
Model: Spencer (4204) Elev C 4 Bed - 4+1 Bath  
Standard

FEB - 8 2021

Sketch #2

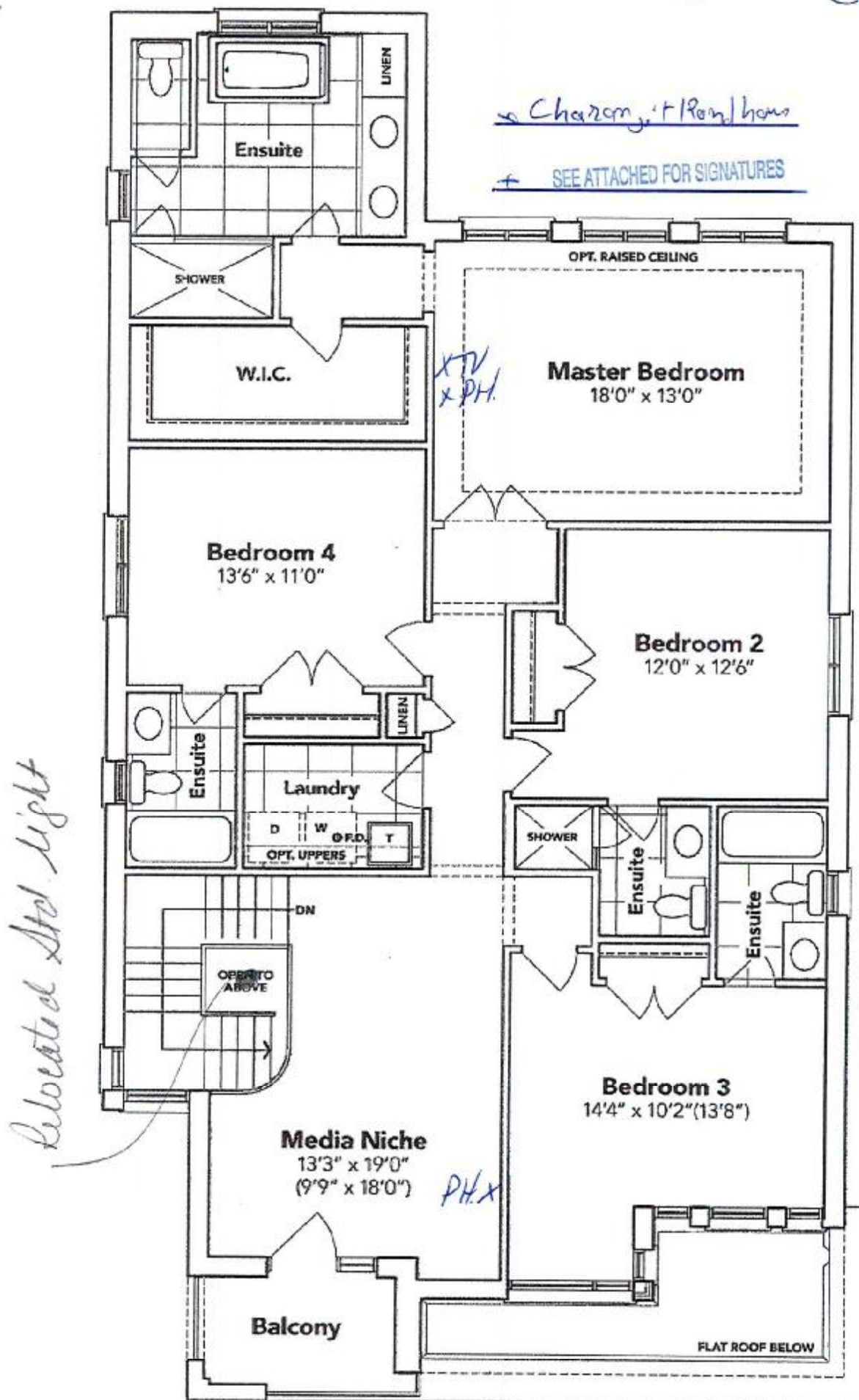

**SECOND FLOOR EL. C**

The floor plans and elevations shown are pre-construction plans and may be revised or improved as necessitated by architectural controls and the construction process. The measurements adhere to the rules and regulations of the TARIION Warranty Corporation's official method for the calculation of floor area. Materials, specifications and floor plans are subject to change without notice. All house renderings are artist's concept only. Actual usable floor space may vary from the stated floor area. All options shown are upgrades. E. & O. E.



**SCHEDULE "B-1"**  
**Floor Plan**

Lot 88  
Phase 4B  
Model: Spencer (4204) Elev C 4 Bed - 4+1 Bath  
Standard

FEB - 9 2021

*Sketch #3*

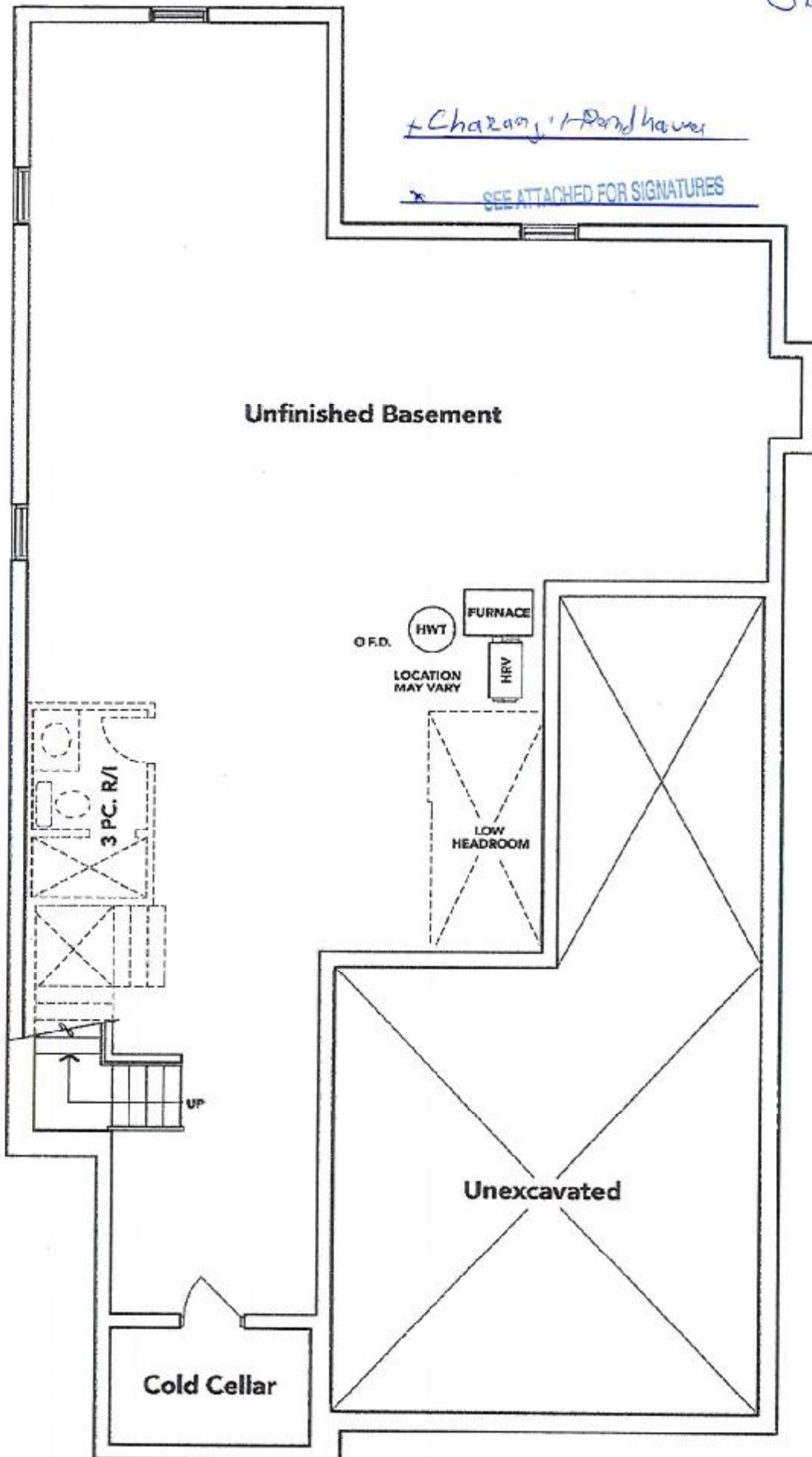

**BASEMENT EL. C**

The floor plans and elevations shown are pre-construction plans and may be revised or improved as necessitated by architectural controls and the construction process. The measurements adhere to the rules and regulations of the TARION Warranty Corporation's official method for the calculation of floor area. Materials, specifications and floor plans are subject to change without notice. All house renderings are artist's concept only. Actual usable floor space may vary from the stated floor area. All options shown are upgrades. E. & O. E.



FEB - 8 2021

LOT: 88  
Thames PH: 4B

Re: Under Mount Kitchen Sink  
\* Still to install Std. Single Hole  
Kitchen faucet \*

x Chazongit Pondhawa

SEE ATTACHED FOR SIGNATURES

x

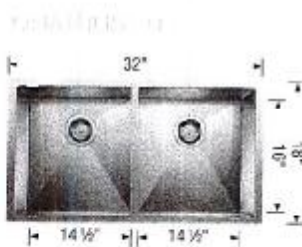

Undermount 401247  
Minimum Cabinet Size\*  
36" (915 mm)  
Bowl Depth  
9" (229 mm)  
Cubed Weight  
55 lb. (25 kg)