

Kingsmen (Thames) Inc. / Havelock Corners (Kingsmen)

Lot/Unit: 77 Phase/Building: 4B Model/Floor Plan: Louis (4203) Elev A 4 Bed - 4+1 Bath

CABINETRY APPLIANCE - FRIDGE

Inv.4870	1 - To supply & install the 66CM DEEP FRIDGE ENCLOSURE - COUNTER DEPTH WITH NO WALLS - 2 66CM DEEP GABLES AND 1 66CM DEEP CABINET - THIS IS NOT A ZERO CLEARANCE ENCLOSURE. STANDARD HEIGHTS AND WIDTHS WILL BE USED. - CLASSIC SERIES in the kitchen...	
Line 62522	Note: See sketch # 1	
19Jan21 / 21Jan21	See attached for fridge specifications.... NO ROUGH IN WATER LINE HAS BEEN PURCHASED	

CABINETRY MICROWAVE OVEN STOVE COOKTOP

Inv.4870	1 - To accomdate the cabinetry for a future SLIDE-IN STOVE PREP FOR QUARTZ - SUPPLY SPECS - CLASSIC SERIES see spec's	
Line 62512	Note:	
19Jan21 / 21Jan21		

CABINETRY WALL AND HUTCH

Inv.4870	1 - To supply & install the UPPER ANGLE CORNER PER UNIT - CLASSIC SERIES in the kitchen....see sketch # 1	
Line 62519	Note:	
19Jan21 / 21Jan21		
Inv.4870	1 - To supply & instal the GLASS DOOR -CLEAR GLASS - UNFINISHED CABINET INTERIOR - PRICED PER EACH - CLASSIC SERIES in the kitchen... see sketch # 1	
Line 62520	Note:	
19Jan21 / 21Jan21		
Inv.4870	1 - To supply & install a FINISHED - MATCHING INTERIOR PER CABINET - CLASSIC SERIES in the kitchen... see sketch # 1	
Line 62521	Note:	
19Jan21 / 21Jan21		

COUNTER TOP

Inv.4870	1 - To accmodate the quartz countertop for a future slide in stove.... see spec's	
Line 62513	Note:	
19Jan21 / 21Jan21		

ELECTRICAL

Inv.4870	1 - To supply & install the standard T.V. rough in in the great room and master bedroom... see sketch # 1 & # 2	
Line 62514	Note:	
19Jan21 / 21Jan21		
Inv.4870	1 - To supply & install the standard Phone (CAT 5) rough in in the great room, master bedroom and bedroom # 4... see sketch # 1 & # 2	
Line 62515	Note:	
19Jan21 / 21Jan21		
Inv.4870	1 - Relocate the standard light from the main stair case landing to the O.T.B. area on the second floor.	
Line 62516	Note:	
19Jan21 / 21Jan21		

HEATING AND AIR CONDITIONING

Kingsmen (Thames) Inc. / Havelock Corners (Kingsmen)

Lot/Unit: 77 Phase/Building: 4B Model/Floor Plan: Louis (4203) Elev A 4 Bed - 4+1 Bath

Inv.4870	1 - As per schedule"PE": Vendor to install capped gas line (rough in only) at rear of home for future BBQ location. Location to be finalized at vednors sole discretion.	
Line 62507	Note:	
19Jan21 / 21Jan21		
Inv.4870	1 - As per schedule"PE": Vendor to supply & install air conditioning unit, sized accordingly, from vendors standard samples.	
Line 62508	Note:	
19Jan21 / 21Jan21		
Inv.4870	1 - To supply & install a HUMMIDIFER to the furnace...	
Line 62509	Note:	
19Jan21 / 21Jan21		

MISCELLANEOUS

PLUMBING

Inv.4870	1 - To supply & install a WATERLINE ROUGH-IN TO THE DRYER LOCATION (NO HOOK UP) in the laundry room..	
Line 62510	Note:	
19Jan21 / 21Jan21		

TILE - FLOOR

Inv.4870	1 - To supply & install the UPGRADE 4 - FLOOR TILE - STACKED - FOYER TILE in lieu of the standard floor tiles... see colour chart for details.	
Line 62653	Note:	
19Jan21 / 21Jan21		
Inv.4870	1 - To supply & install the UPGRADE 4 - FLOOR TILE - STACKED - MUDROOM TILE in lieu of the standard floor tiles... see colour chart for details.	
Line 62654	Note:	
19Jan21 / 21Jan21		
Inv.4870	1 - To supply & install the UPGRADE 4 - FLOOR TILE - STACKED - POWDER ROOM TILE in lieu of the standard floor tiles... see colour chart for details.	
Line 62655	Note:	
19Jan21 / 21Jan21		
Inv.4870	1 - To supply & install the UPGRADE 4 - FLOOR TILE - STACKED - KITCHEN / BREAKFAST TILE in lieu of the standard floor tiles... see colour chart for details.	
Line 62656	Note:	
19Jan21 / 21Jan21		
Inv.4870	1 - To supply & install the UPGRADE 4 - FLOOR TILE - STACKED - SITTING AND MAIN HALLWAY TILE in lieu of the standard floor tiles... see colour chart for details.	
Line 62657	Note:	
19Jan21 / 21Jan21		

TRIM

Inv.4870	1 - To supply & install the INTERIOR DOORS - UPGRADE TO LIVINGSTON HOLLOW CORE throughout in lieu of the standard interior doors where applicable.	
Line 62523	Note:	
19Jan21 / 21Jan21		



CONSTRUCTION SUMMARY

Kingsmen (Thames) Inc. / Havelock Corners (Kingsmen)

Lot/Unit: 77 Phase/Building: 4B Model/Floor Plan: Louis (4203) Elev A 4 Bed - 4+1 Bath

EXTRAS AS PER OFFER

5 FREE APPLIANCES ? STAINLESS STEEL FRONT - FRIDGE: STOVE AND DISHWASHER. WHITE WASHER AND DRYER (SUPPLIED ONLY, NOT INSTALLED, FROM BUILDERS STANDARD LINE) TO ARRANGE DELIVERY ? CALL THE BRICK COMMERCIAL SALES DIVISION AT 1-877-353-2850. <i>Worksheet</i> Note:	
VENDOR TO INSTALL CAPPED GAS LINE (ROUGH-IN ONLY) AT REAR OF HOME FOR FUTURE BBQ LOCATION. LOCATION TO BE FINALIZED AT VENDORS SOLE DISCRETION. <i>Worksheet</i> Note:	
VENDOR TO SUPPLY & INSTALL AIR CONDITIONING UNIT, SIZED ACCORDINGLY, FROM VENDORS STANDARD SAMPLES. <i>Worksheet</i> Note:	

Purchasers:
SATNAM DHINDSA & HARPINDER KAUR MAHI

Property: 77 of Plan - Draft Approval SB17-03-08

Telephone Res. / Bus: /

Project: Kingsmen (Thames) Inc.

Decor Advisor: Barbara Coccia

Model and Elevation: Louis (4203) Elev A 4 Bed - 4+1 Bath

Layout Changes:
☐ Yes
☒ No

Sketch Attached:
☒ Yes
☐ No

Exterior Colour Scheme:

1. Cabinetry

	Style and Colour	Counter Top	Hardware
Kitchen / Breakfast	# 3 Slab LPL Meringue	#1 C/S #9141 Ice Snow 3cm	12881 Handle
Kitchen Island	# 3 Slab LPL Meringue	#1 C/S #9141 Ice Snow 3cm	12881 Handle
Laundry Room	/	/	/
Powder Room	# 3 Slab LPL Meringue	Italian White Di Pesco 4954K-22	12881 Handle
Main Bathroom	/	/	/
Master Ensuite Bathroom	#4 Soho Viva Weekend Getaway	White Carrara 4924-38	135 Knob
Second Ensuite Bathroom (If Applicable)	#4 Soho Viva Weekend Getaway	White Carrara 4924-38	135 Knob
Bedroom #3 Bathroom	#3 Slab Silk Touch White Cloud	Calcutta Marble 4925K-07	9671 Handle
Bedroom #4 Bathroom	#3 Slab Silk Touch White Cloud	Calcutta Marble 4925K-07	9671 Handle

Appliances

Custom Size Fridge
☒ Yes
☐ No

Cooktop / Rangetop
☐ Yes
☒ No

Valance Lighting
☐ Yes
☒ No

Built in Wall Oven
☐ Yes
☒ No

Microwave / Range Hood
☐ Yes
☒ No

Slide-in Range
☒ Yes
☐ No

Comment

2. Flooring

Selection

Foyer	**Upg. 4, 24 x 24" Mayfair Calacatta Oro HD Polished Rect. "STACKED"
Main Hall	**Upg. 4, 24 x 24" Mayfair Calacatta Oro HD Polished Rect. "STACKED"
Back Hall	Sitting Room: **Upg. 4, 24 x 24" Mayfair Calacatta Oro HD Polished Rect. "STACKED"
Breakfast	**Upg. 4, 24 x 24" Mayfair Calacatta Oro HD Polished Rect. "STACKED" (Including Pantry)
Laundry Room	13x13" Keaton Ivory
Kitchen	**Upg. 4, 24 x 24" Mayfair Calacatta Oro HD Polished Rect. "STACKED"
Powder Room	**Upg. 4, 24 x 24" Mayfair Calacatta Oro HD Polished Rect. "STACKED"
Main Bathroom	(Bedroom #2 Bathroom)-13x13" Keaton Ice SH/FL: 2x2" Soho White Matte
Master Ensuite	13x13" Keaton Ice SH/FL: 2x2" Soho White Matte
Bathroom (If Applicable)	(Bedroom #3 Bathroom)- 13x13" Malena Ice
Mud Room	**Upg. 4, 24 x 24" Mayfair Calacatta Oro HD Polished Rect. "STACKED"
Bedroom #4 Bathroom	13x13" Malena Ice
Living Room	/
Dining Room	/
Family / Great Room	3 1/2" Elements Oak Wolfhound
Den / Library / Study	/
Basement Landing (If Applies)	/
Lower Landing (If Applicable)	3 1/2" Elements Oak Wolfhound
Upper Landing	3 1/2" Elements Oak Wolfhound
Upper Hall	Stylish Story 1: 917 Pearl Glow
Master Bedroom	Stylish Story 1: 917 Pearl Glow
Bedroom #2	Stylish Story 1: 917 Pearl Glow
Bedroom #3	Stylish Story 1: 917 Pearl Glow
Bedroom #4	Stylish Story 1: 917 Pearl Glow
Bedroom #5	/
Shower Jamb (Sill)	Master Ensuite/ Bedroom #2 Bathroom- Anatolia Marmiline SNOW

Flooring Continued on Page 2

Initial:

Purchasers: SATNAM DHINDSA & HARPINDER KAUR MAHI Property: 77 of Plan - Draft Approval SB17-03-08
Telephone Res. / Bus: / Project: Kingsmen (Thames) Inc.
Decor Advisor: Barbara Coccia Model and Elevation: Louis (4203) Elev A 4 Bed - 4+1 Bath

2. Flooring - Continued -

Upgrade Underpad	Type Standard	Area 2nd floor
Carpet on Stairs	Capped	Runner - *Upgrade
Comment	/	/

3. Plumbing Fixtures / Faucets

Kitchen	Standard	Second Ensuite	Standard	Powder Room	Standard
Master Ensuite	Standard			Other Room	/
Main Bathroom	/	Bedroom #3/ #4 Bathroom	Standard		

Comment

NOTE: The Purchasers have not upgraded the kitchen sink... still to install the standard undermount sink with the standard single hole faucet.

4. Wall Tile

	Tile Selection	Listello	Insert	Insert Selection
Main Bathroom	/	<input type="checkbox"/>	<input type="checkbox"/>	/
Master Ensuite				
Tub Deck	/	<input type="checkbox"/>	<input type="checkbox"/>	/
Tub Apron	/	<input type="checkbox"/>	<input type="checkbox"/>	/
Tub Surround	/	<input type="checkbox"/>	<input type="checkbox"/>	/
Shower Stall	8x10" Keaton Ice	<input type="checkbox"/>	<input type="checkbox"/>	/
Second Ensuite	8x10" Keaton Ice	<input type="checkbox"/>	<input type="checkbox"/>	/
Bedroom #3 Bathroom	8x10" Malena Ice	<input type="checkbox"/>	<input type="checkbox"/>	/
Bedroom #4 Bathroom	8x10" Malena Ice	<input type="checkbox"/>	<input type="checkbox"/>	/
Kitchen Backsplash	/	<input type="checkbox"/>	<input type="checkbox"/>	/
Complete Backsplash	/	<input type="checkbox"/>	<input type="checkbox"/>	/

Comment

NOTE: to supply and install all wall tiles in all bathrooms (Master, Bedroom #2, #3 and #4) on the 10" side horizontally stacked, where applicable.

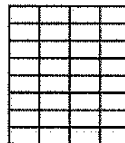

horizontal stacked

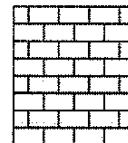

brick pattern

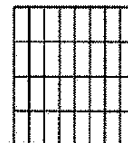

vertical stacked

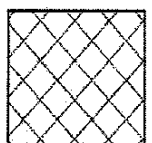

diagonal/diamond

5. Fireplace

	Living Room			Family Room			Other Room - Specify Greatroom		
	Purchased	As Per Plan	N/A	Purchased	As Per Plan	N/A	Purchased	As Per Plan	N/A
	<input type="radio"/>	<input type="radio"/>	<input type="radio"/>	<input type="radio"/>	<input type="radio"/>	<input type="radio"/>	<input type="radio"/>	<input checked="" type="radio"/>	<input type="radio"/>
Fireplace Type							Front Facing		
Mantle Type							NF-08		
Over Mantle							/		
Colour / Stain							White		
Surround							/		
Hearth							/		

Comment

Initial:

Page 2 of 3

Purchasers: SATNAM DHINDSA & HARPINDER KAUR MAHI **Property:** 77 of Plan - Draft Approval SB17-03-08
Telephone Res. / Bus: / **Project:** Kingsmen (Thames) Inc.
Decor Advisor: Barbara Coccia **Model and Elevation:** Louis (4203) Elev A 4 Bed - 4+1 Bath

6. Trim Carpentry

Door Hardware Standard Handle

Interior Trim Standard

Comment

NOTE: The Purchasers have upgraded their interior doors..see invoice for details.

Interior Doors

☐ 2 Panel Arch Top

☐ 2 Panel Square Top *BL*

☐ 6 Panel

Initial for Door Style *h.m.* *SD*

7. Railings and Pickets

Railing Package Standard Straight

Railing Colour Elements Oak Wolfhound

Wood Stairs ☐ No ☒ Oak

Picket Colour Elements Oak Wolfhound

Tread Colour Elements Oak Wolfhound

Comment

8. Plaster Mouldings and Medallions

Foyer

Main Hall

Living Room

Dining Room

Family Room

Kitchen/Breakfast

Den/Library

Lower Landing

Comment

9. Wall Paint

Kingsmen White

Smooth Ceilings

☐ First Floor

☐ First Floor incl. Second Floor Hall

☐ First and Second Floor

☒ Throughout

☐ Not Applicable

Trim Paint Kingsmen White

10. Additional Comments

11. Disclaimers and Notes

- Colours of all materials are as close as possible to builder's selection, but not necessarily identical due to variances in manufacturing.
- Any extras listed above are null and void unless accompanied by a separate invoice/amendment. Said invoice must be paid in full.
- The Purchaser acknowledges that after Interior Colour Selection form is signed and dated, no further changes will be permitted other than re-selection due to unavailability. *h.m.* *SD* Purchaser's Initials
- The Purchaser acknowledges reading and accepting the "Kingsmen Group Décor Centre Disclaimers" form. This document contains other miscellaneous disclaimers.

This Interior Colour Selection is final and approved by:

Purchaser:

Signature: *Harpreet* **Date:** 21-Jan-2021

Signature: *Satnam Dhindsa* **Date:** 21/01/21

Vendor:

Kingsmen (Thames) Inc.

SCHEDULE "B-1"
Floor Plan

JAN 19 2021

4B-77 Lot 77
Phase 4B
Model: Louis (4203) Elev A 4 Bed - 4+1 Bath
Standard

Sketch #1

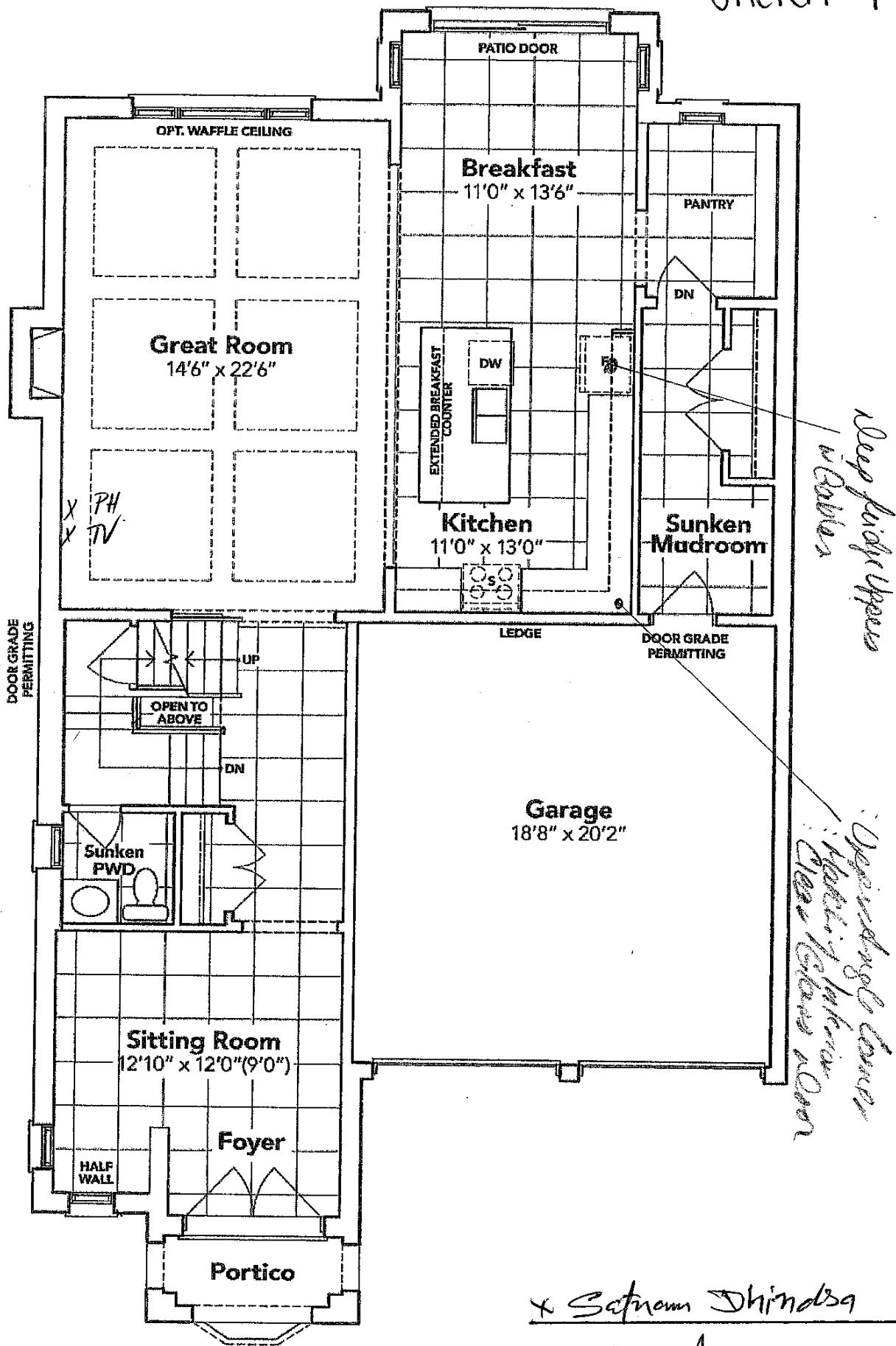

GROUND FLOOR EL. A

The floor plans and elevations shown are pre-construction plans and may be revised or improved as necessitated by architectural controls and the construction process. The measurements adhere to the rules and regulations of the TARION Warranty Corporation's official method for the calculation of floor area. Materials, specifications and floor plans are subject to change without notice. All house renderings are artist's concept only. Actual usable floor space may vary from the stated floor area. All options shown are upgrades. E. & O. E.

Sketch #2

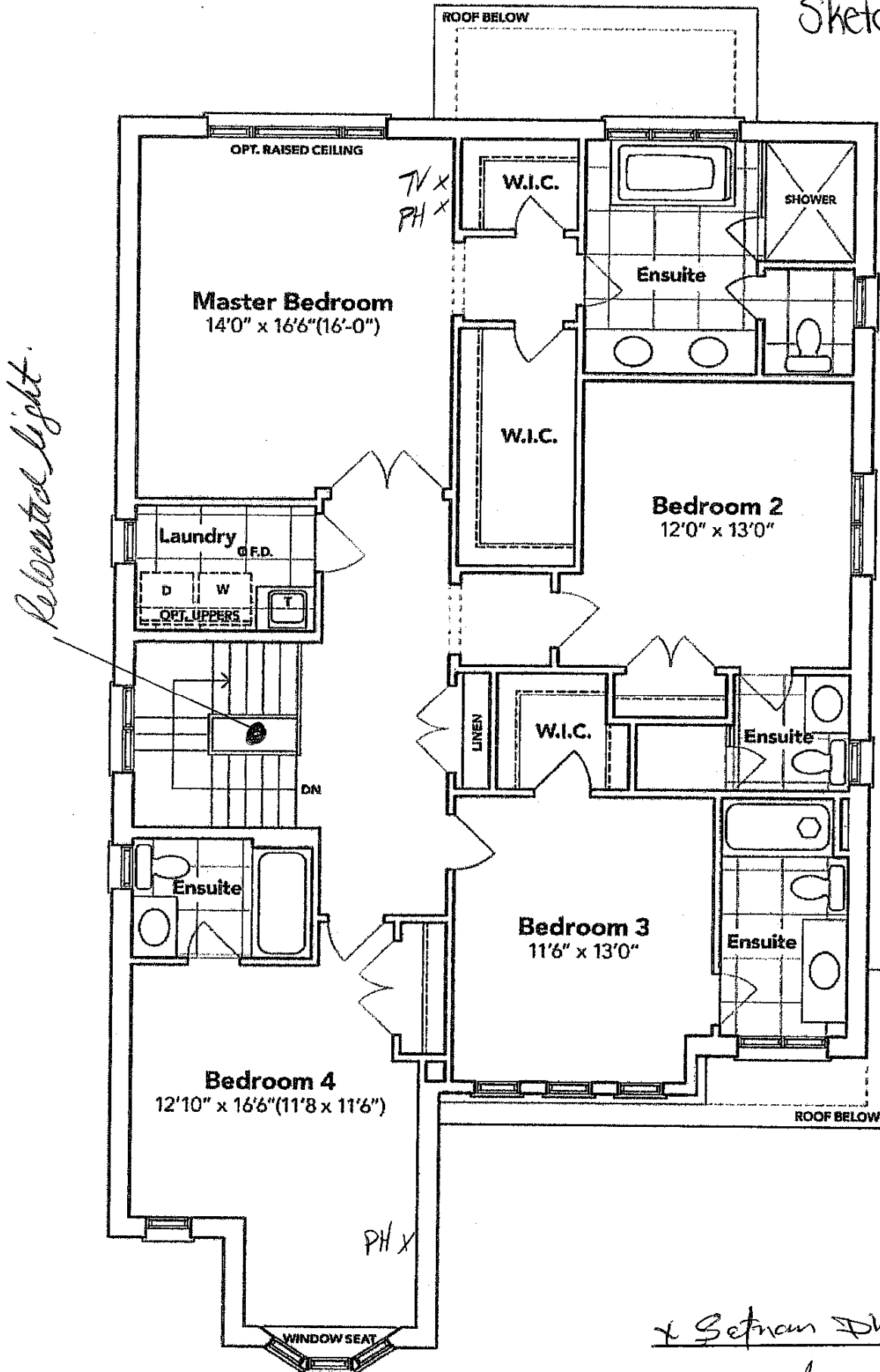

SECOND FLOOR EL. A

The floor plans and elevations shown are pre-construction plans and may be revised or improved as necessitated by architectural controls and the construction process. The measurements adhere to the rules and regulations of the TARION Warranty Corporation's official method for the calculation of floor area. Materials, specifications and floor plans are subject to change without notice. All house renderings are artist's concept only. Actual usable floor space may vary from the stated floor area. All options shown are upgrades. E. & O. E.

NP

SCHEDULE "B-1"

Floor Plan

JAN 19 2021

Model: Louis (4203) Elev A 4 Bed - 4+1 Bath Standard

4B-77

Lot 77

Phase 4B

Standard

Sketch #3

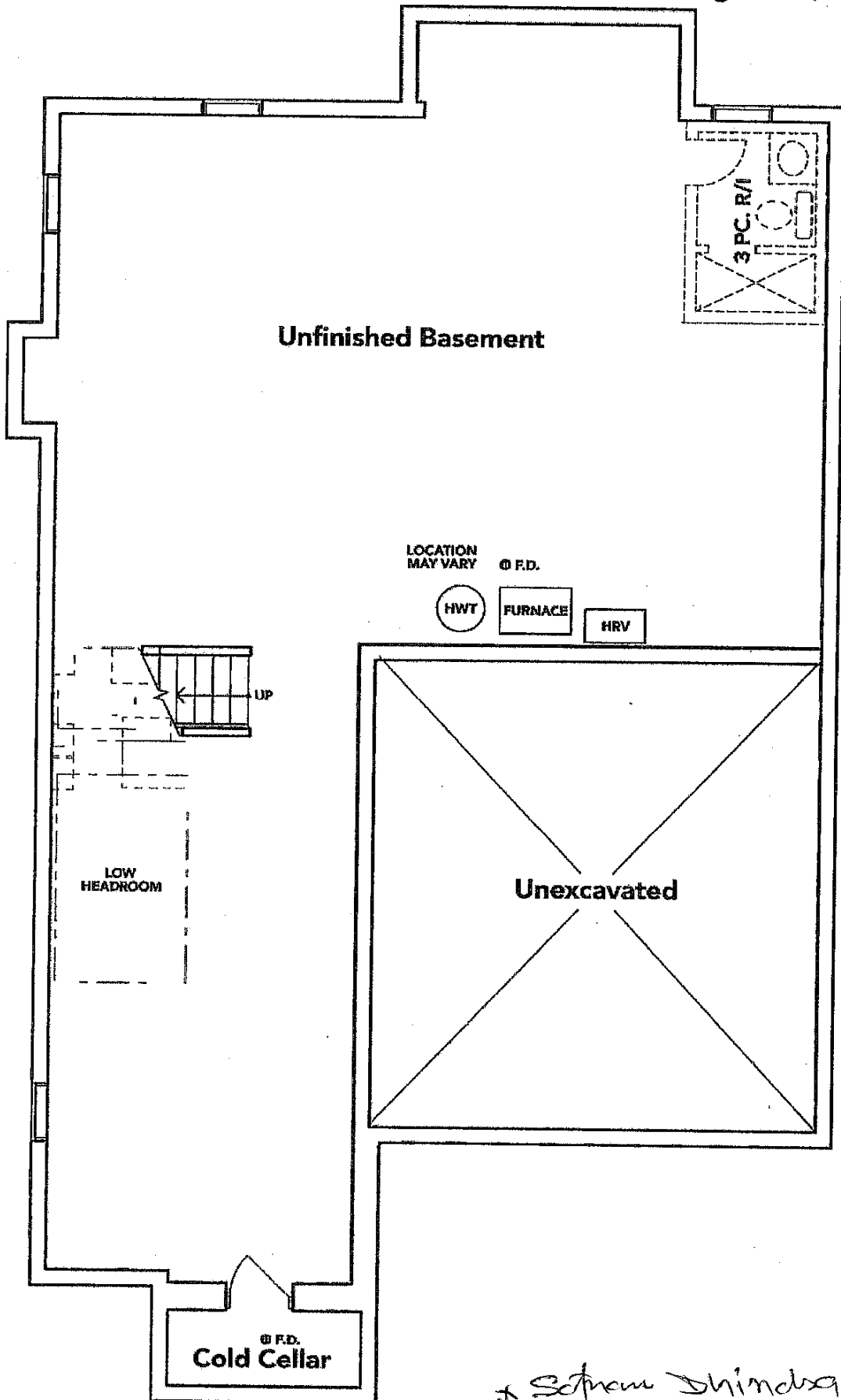

BASEMENT EL. A

x *Sofren Shindia*

x *Jack*

The floor plans and elevations shown are pre-construction plans and may be revised or improved as necessitated by architectural controls and the construction process. The measurements adhere to the rules and regulations of the TARION Warranty Corporation's official method for the calculation of floor area. Materials, specifications and floor plans are subject to change without notice. All house renderings are artist's concept only. Actual usable floor space may vary from the stated floor area. All options shown are upgrades. E. & O. E.



Lot #77
Thames 4B
RE: 30" Gas Slide in Range Specs

*NO Gasline or Electrical
has been purchased

JAN 19 2021

4B-77

Setham Dhindsa

Hark

30" Gas Slide-in Range

800 Series – Stainless Steel HGI8056UC

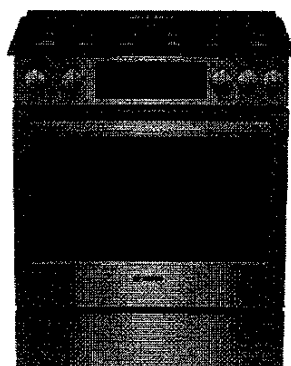

HGI8056UC
Stainless Steel

Also available in:

Black HGI8046UC
Stainless Steel

The full-depth gas slide-in range fits into any freestanding range cutout, and features five burners to cook more dishes at once.

Features & Benefits

The Bosch slide-in range fits in any freestanding range cutout.

Powerful 18,000 BTU center burner speeds cooking time.

At 4.8 cu. ft., a large oven capacity accommodates most pots and pans.

Heavy-duty metal knobs for a premium look and feel.

The warming drawer keeps everything you cook warm and ready to serve.

General Properties

Cooking modes	Bake, Variable Broil (hi & low), Roast, Warm, Proof, Dough, Convection Bake, Convection Roast, Convection Conversion, Pizza, Sabbath
Cleaning type	Self clean
Type of grate	Cast iron
Knob material	Metal
Interior light	1
Kitchen timer	Yes
Drawer type	Warming drawer
Sealed burners	Yes

Oven Performance

Bake / broil burner power BTU	18,000 / 12,500 BTU
Convection element watts (W)	N/A

Burner Performance

Total cooktop burners	5
Total cooktop (NG / LP) BTU	63,000 / 46,500
Power of front left burner (NG / LP) BTU	10,000 / 8,000
Power of back left burner (NG / LP) BTU	5,000 / 5,000
Power of center burner (NG / LP) BTU	18,000 / 15,000
Power of back right burner (NG / LP) BTU	5,000 / 5,000
Power of front right burner (NG / LP) BTU	15,000 / 13,500

Technical Details

Circuit breaker (A)	15 A
Volts (V)	120 V
Frequency (Hz)	60 Hz

Technical Details (continued)

Plug type	US 3-prong
Cord length (in.)	78"
Energy source	Gas
Gas type	Natural gas 15 mbar (USA)
Alternative gas type	LP 27.5 mbar (USA)

Dimensions & Weight

Overall appliance dimensions (HxWxD)(in.)	36 1/2"-38" x 31 1/2" x 29 3/16"
Required cutout size (HxWxD)(in.)	35 1/2"-37" x 30" x 25 1/4"
Adjustable range height (in.)	1 1/2"
Oven cavity size (cu. ft.)	4.8
Overall oven interior dimensions (HxWxD)(in.)	17 13/16" x 24 1/8" x 18"
Usable oven interior dimensions (HxWxD)(in.)	11 1/2" x 23 1/4" x 15 1/4"
Net weight (lbs)	226 lbs

Accessories—Included

Use and care manual, installation guide, LP conversion kit, 3 standard racks

Accessories—Optional

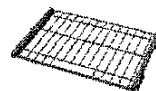

HEZTR301
30" Telescopic rack



HEZGR301
Griddle



HEZ298102
Wok ring



HGZBS301
4" Low backguard (stainless steel)



HGZIT301
Island Trim (stainless steel)



Accessories: To purchase Bosch accessories, cleaners & parts please visit www.bosch-home.com/us/store or call 1-800-944-2904 (Mon to Fri 5 am to 6 pm PST, Sat 6 am to 3 pm PST).
Notes: All height, width and depth dimensions are shown in inches. BSH reserves the absolute and unrestricted right to change product materials and specifications, at any time, without notice. Consult the product's installation instructions for final dimensional data and other details prior to making cutout.

Warranties: Please see Use & Care manual or Bosch website for statement of limited warranty.

For more information on our entire line of products, go to www.bosch-home.com/us or call 1-800-944-2904

© BSH Home Appliances Corporation. All rights reserved. Bosch is a registered trademark of Robert Bosch GmbH.

LOT#77
Thames 4B
RE: 30" Gas Slide In Range Specs

JAN 19 2021

4B-77

*NO Gasline or Electrical
has been purchased

Satiani Dhindsa

Hank

30" Gas Slide-in Range

800 Series – Stainless Steel HGI8056UC



Installation Details

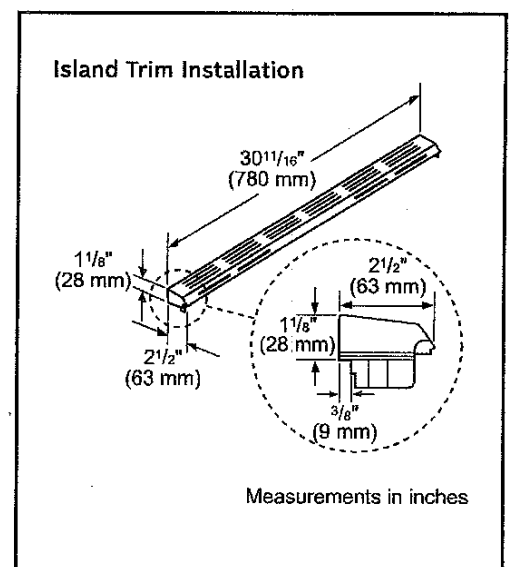
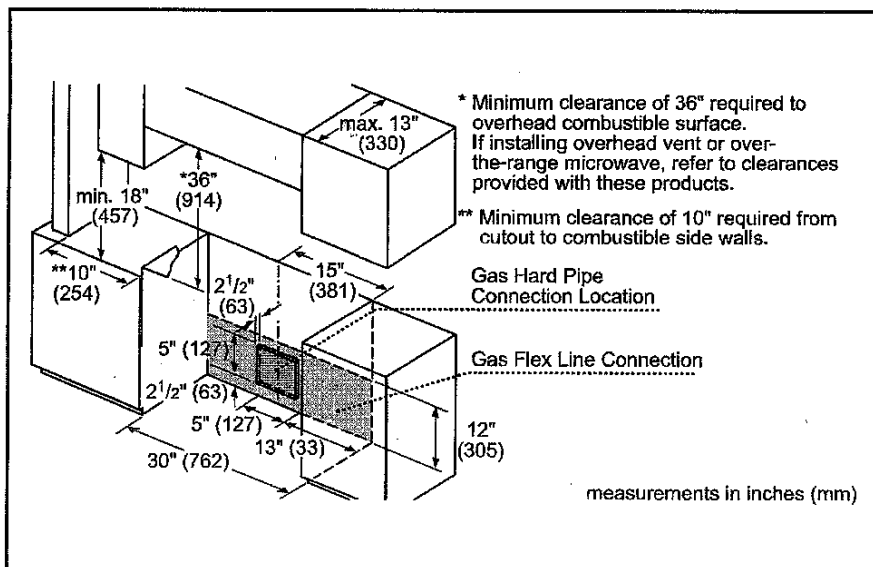
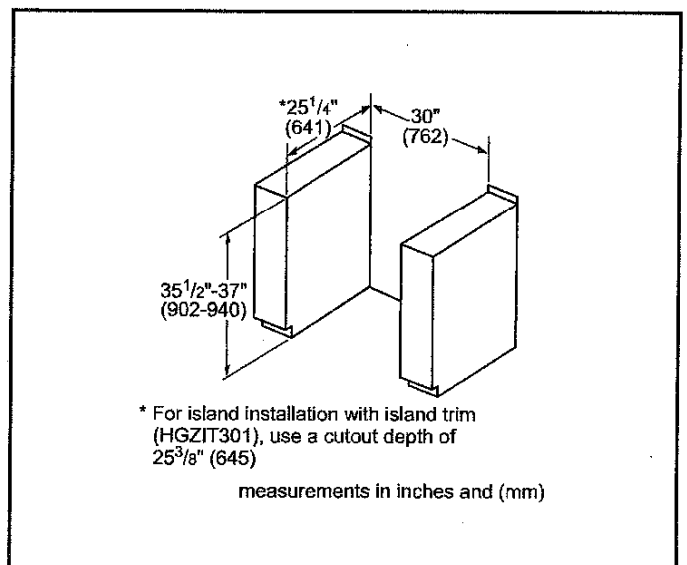
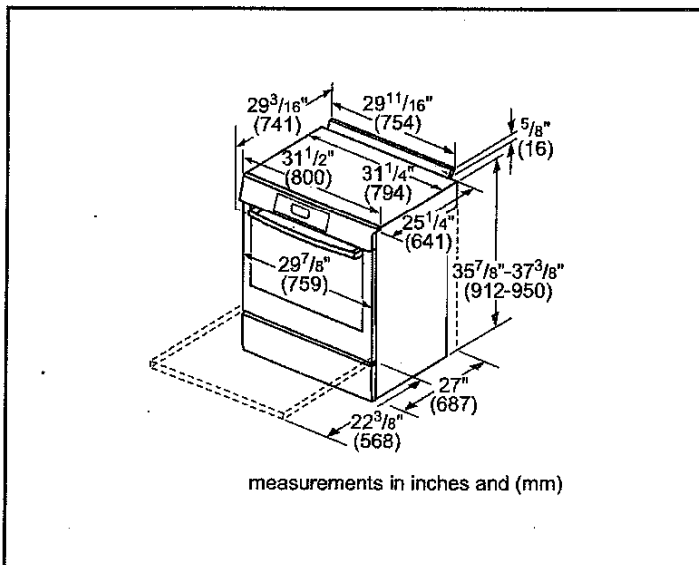

Accessories: To purchase Bosch accessories, cleaners & parts please visit www.bosch-home.com/us/store or call 1-800-944-2904 (Mon to Fri 5 am to 6 pm PST, Sat 6 am to 3 pm PST).

Notes: All height, width and depth dimensions are shown in inches. BSH reserves the absolute and unrestricted right to change product materials and specifications, at any time, without notice. Consult the product's installation instructions for final dimensional data and other details prior to making cutout.

Warranties: Please see Use & Care manual or Bosch website for statement of limited warranty.

For more information on our entire line of products, go to www.bosch-home.com/us or call 1-800-944-2904

© BSH Home Appliances Corporation. All rights reserved. Bosch is a registered trademark of Robert Bosch GmbH.

LOT #77

THOMAS 4B

RE: Fridge spec's

Note: No waterline rough-in has been purchased.

4B-77

JAN 19 2021

RF28R7201SR

SAMSUNG

28 cu. ft. 4-Door French Door Refrigerator

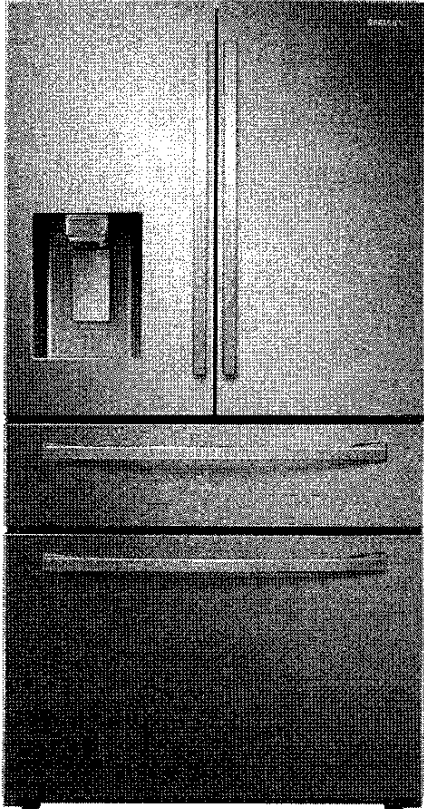

Satnam Dhindsa

Flavie

Signature Features

FlexZone™ Drawer

A flexible storage drawer with four different temperature settings and an adjustable Smart Divider to stay organized.

Fingerprint Resistant

A special finish to reduce smudges and minimize cleaning.

Wi-Fi and Bixby Enabled

Use your smartphone to control the temperature and monitor your refrigerator remotely.

Available Colors



Fingerprint Resistant
Stainless Steel (shown)



Fingerprint Resistant
Black Stainless Steel



Fingerprint Resistant
Tuscan Stainless Steel

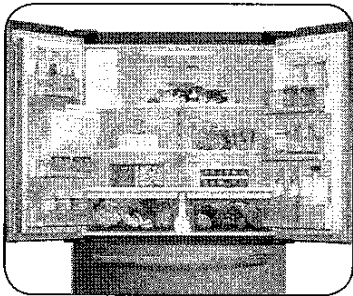

French Door Design

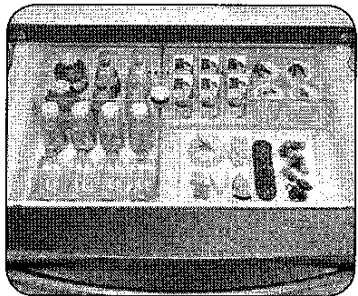

FlexZone™ Drawer

Convenience

- FlexZone™ Drawer with 4 Temperature Settings and Smart Divider
- Adjustable Shelves for Tall Oversized Items
- Auto Pull-Out Upper Freezer Drawer
- Water Filter Indicator

Design

- Modern External Filtered Water and Ice Dispenser
- High Efficiency LED Lighting
- Accessibility (ADA Compliant)
- EZ-Open Handle™ on Freezer Door and FlexZone™ Drawer
- Tempered Glass Spill-Proof Shelves
- Gallon Door Bins
- Dispenser Light

Performance

- Twin Cooling Plus®
- Ice Max - Stores up to 10 lbs of ice
- Energy Star® Compliant
- Power Freeze and Power Cool Options
- Two Humidity-Controlled Crispers
- CoolTight Door
- Door Alarm

Rating



ENERGY STAR® rated:
755 kWh/yr

LOT #77
Thomas 4B
RE: Fridge spec's

Note: No Wateline Rough-In has been purchased.

RF28R7201SR

28 cu. ft. 4-Door French Door Refrigerator

Installation Specifications

1. Measure the height, width and depth of the opening, making sure to include baseboards, molding tile, countertop overhang, etc. Check to be sure there is enough room to open the door (consider walls, islands or other obstacles when measuring).
2. Refer to illustration below to determine dimensions.
3. Allow 2.5" of clearance on hinge side of refrigerator when installing next to a wall where handle may make contact.
4. Allow 1" minimum clearance at rear for proper air circulation and water/electrical connections. Allow a 3/8" minimum clearance at sides and top for ease of installation.
5. Ensure each door and entryway in the home is wide enough for the refrigerator to be moved through easily.

For optimal usage and to be able to open refrigerator doors completely, do not install next to a wall.

Please note: The following dimension and cutout information is for planning purposes only. For complete installation details, consult manual packed with product, or download manual online at samsung.com.

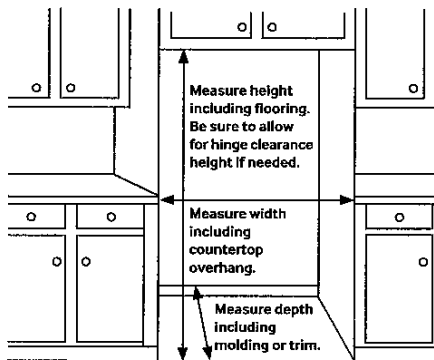

Dimensions

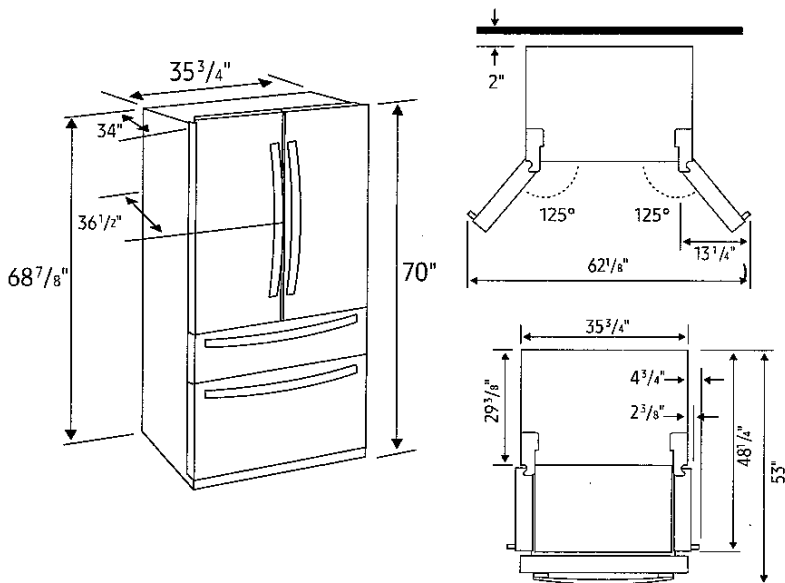

Total Capacity: 28 cu. ft.

Refrigerator: 15.9 cu. ft.

- Modern External Filtered Water and Ice Dispenser
 - Crushed or Cubed Ice
- Ice Max
- 2 Humidity-Controlled Crispers
- 5 Tempered Glass Spill-Proof Shelves
- Adjustable Shelf for Tall Oversized Items
- 6 Door Bins
 - Right Door: 3 Gallon Bins
 - Left Door: 3 Regular Bins
- High Efficiency LED Lighting

FlexZone™ Drawer: 3.8 cu. ft.

- EZ-Open Handle™
- 4 Temperature Zones with Smart Divider:
 - Meat/Fish (29°F)
 - Cold Drinks (33°F)
 - Deli/Snacks (37°F)
 - Wine/Party Dishes (42°F)
- High Efficiency LED Lighting

Freezer: 8.3 cu. ft.

- EZ-Open Handle™
- 1 Drawer Divider
- High Efficiency LED Lighting

Warranty

One (1) Year Parts and Labor on Refrigerator

Five (5) Years Parts and Labor on Sealed Refrigeration System Only*

Ten (10) Years Parts and Five (5) Years

Labor on Digital Inverter Compressor

*Compressor, evaporator, condenser, drier and connecting tubing.

Product Dimensions & Weight

Dimensions (WxHxD with hinges, handles and doors):

35 3/4" x 70" x 36 1/2"

Dimensions (WxHxD without hinges and door):

35 3/4" x 68 7/8" x 29 3/8"

Dimensions (WxHxD with hinge and door, no handle):

35 3/4" x 70" x 34"

Weight: 322 lbs.

Shipping Dimensions & Weight (WxHxD)

Dimensions: 38 1/4" x 75 3/4" x 36 1/4"

Weight: 344 lbs.

Color	Model #	UPC Code
Fingerprint Resistant Stainless Steel	RF28R7201SR	887276304922
Fingerprint Resistant Black Stainless Steel	RF28R7201SG	887276304915
Fingerprint Resistant Tuscan Stainless Steel	RF28R7201DT	887276304908