

Kingsmen (Thames) Inc. / Havelock Corners (Kingsmen)

Lot/Unit: 22 Phase/Building: 4A Model/Floor Plan: James (3601) Elev B 4 Bed - 2+1 Bath

CABINETRY ACCESSORIES

Inv.4835	3 - To supply & install the LIGHT VALANCE - LIGHT VALANCE IS NOW APPROXIMATELY 2INCHES 50MM HIGH - VIKING SERIES in the kitchen	
Line 62058	Note: No rough in wires or lights have been purchased.	
3Dec20 / 3Dec20		

CABINETRY APPLIANCE - FRIDGE

CABINETRY PANTRY

CABINETRY VANITY

CABINETRY WALL AND HUTCH

Inv.4835	1 - To supply & install the GLASS DOOR - SPECIFY -- CLEAR GLASS - UNFINISHED CABINET INTERIOR - PRICED PER EACH - VIKING SERIES to the upper corner cabinet in the kitchen... see sketch # 3	
Line 62057	Note: *Upper angled corner cabinet was purchased during the structural appointment dated April.23.2020.	
3Dec20 / 3Dec20		

CARPET

Inv.4835	1 - To supply & install the upgraded Escape to Maui carpet to the second floor in lieu of the standard carpet... see colour chart for details.	
Line 62059	Note: Still to install the standard carpet.	
3Dec20 / 3Dec20		

COUNTER TOP

ELECTRICAL

HEATING AND AIR CONDITIONING

MISCELLANEOUS

PLUMBING

Inv.4835	1 - To supply & install the BLANCO QUATRUS under mount sink model # 401247 in lieu of the standard kitchen sink... see spec's	
Line 62060	Note: Still to install the standard single hole kitchen faucet.	
3Dec20 / 3Dec20		
Inv.4835	1 - To supply & install the MOEN soap dispenser model: 3944 in chrome... see spec's See sketch # 3 for location of soap dispenser.	
Line 62061	Note:	
3Dec20 / 3Dec20		

EXTRAS AS PER OFFER

Note:	
-------	--

Kingsmen (Thames) Inc. / Havelock Corners (Kingsmen)

Lot/Unit: 22 Phase/Building: 4A Model/Floor Plan: James (3601) Elev B 4 Bed - 2+1 Bath

Purchasers:AMRITPAL SINGH AUJLA & HARPREET KAURProperty: 22 of Plan - Draft Approval SB17-03-08

Telephone Res. / Bus: /Project: Kingsmen (Thames) Inc.

Decor Advisor: Barbara CocciaModel and Elevation: James (3601) Elev B 4 Bed - 2+1 Bath

Layout Changes: ☐ Yes ☒ NoSketch Attached: ☒ Yes ☐ NoExterior Colour Scheme:

1. Cabinetry	Style and Colour	Counter Top	Hardware
Kitchen / Breakfast	#3 Charleston 3DL Orchid	#1 C/S #3040 Cement 3cm	135 Knob
Kitchen Island	#3 Charleston 3DL Orchid	#1 C/S #3040 Cement 3cm	135 Knob
Laundry Room	/	/	/
Powder Room	#3 Camden Maple Shale Grey CL	Argento Romano 6697-46	135 Knob
Main Bathroom	#2 Slab LPL Stainless	Leche Vesta 4987k-07	135 Knob
Master Ensuite Bathroom	#3 Charleston 3DL Moonlight	Mercury Vesta 4988k-07	135 Knob
Second Ensuite Bathroom (If Applicable)	/	/	/
	/	/	/
	/	/	/

Appliances

Custom Size Fridge

☐ Yes ☒ No

Valance Lighting

☒ Yes ☐ No

Microwave / Range Hood

☐ Yes ☒ No

Cooktop / Rangetop

☐ Yes ☒ No

Built in Wall Oven

☐ Yes ☒ No

Slide-in Range

☐ Yes ☒ No

Comment

-2. Flooring	Selection
Foyer	13x13" Malena Ice
Main Hall	13x13" Malena Ice
Back Hall	/
Breakfast	13x13" Malena Ice
Laundry Room	13x13" Cinq Grey
Kitchen	13x13" Malena Ice
Powder Room	13x13" Malena Ice
Main Bathroom	13x13" Cinq Grey
Master Ensuite	13x13" Cinq Black SH/FL- 2x2" Soho White Matte
Bathroom (If Applicable)	/
Mud Room	13x13" Malena Ice
	/
Living Room	/
Dining Room	/
Family / Great Room	3 1/2" Elements Oak Sturgeon
Den / Library / Study	/
Basement Landing (If Applies)	/
Lower Landing (If Applicable)	3 1/2" Elements Oak Sturgeon
Upper Landing	3 1/2" Elements Oak Sturgeon
Upper Hall	**Escape to Maui- Pilgrim's Path 89816
Master Bedroom	**Escape to Maui- Pilgrim's Path 89816
Bedroom #2	**Escape to Maui- Pilgrim's Path 89816
Bedroom #3	**Escape to Maui- Pilgrim's Path 89816
Bedroom #4	**Escape to Maui- Pilgrim's Path 89816
Bedroom #5	/
Master Shower Jamb (Sill)	Anatolia Marmiline SNOW

Purchasers: AMRITPAL SINGH AUJLA & HARPREET KAUR Property: 22 of Plan - Draft Approval SB17-03-08
Telephone Res. / Bus: / Project: Kingsmen (Thames) Inc.
Decor Advisor: Barbara Coccia Model and Elevation: James (3601) Elev B 4 Bed - 2+1 Bath

2. Flooring - Continued -

Upgrade Underpad	Type	Area
	Standard	2nd floor
Carpet on Stairs	Capped	Runner - *Upgrade
Comment	/	/

3. Plumbing Fixtures / Faucets

Kitchen	Standard	Second Ensuite	/	Powder Room	Standard
Master Ensuite	Standard			Other Room	/
Main Bathroom	Standard		/		

Comment
NOTE: The purchasers have upgraded the kitchen sink to undermount, sink to install the standard single hole faucet.

4. Wall Tile

	Tile Selection	Listello	Insert	Insert Selection
Main Bathroom	8x10" Cinq Grey	<input type="checkbox"/>	<input type="checkbox"/>	/
Master Ensuite				
Tub Deck	13x13" Cinq Black	<input type="checkbox"/>	<input type="checkbox"/>	/
Tub Apron	13x13" Cinq Black	<input type="checkbox"/>	<input type="checkbox"/>	/
Tub Surround	13x13" Cinq Black	<input type="checkbox"/>	<input type="checkbox"/>	/
Shower Stall	8x10" Cinq Black	<input type="checkbox"/>	<input type="checkbox"/>	/
Second Ensuite	/	<input type="checkbox"/>	<input type="checkbox"/>	/
	/	<input type="checkbox"/>	<input type="checkbox"/>	/
	/	<input type="checkbox"/>	<input type="checkbox"/>	/
Kitchen Backsplash	/	<input type="checkbox"/>	<input type="checkbox"/>	/
Complete Backsplash	/	<input type="checkbox"/>	<input type="checkbox"/>	/

Comment
To supply and install all wall tiles in the master ensuite and main bathroom on the 10" side horizontally stacked, where applicable.

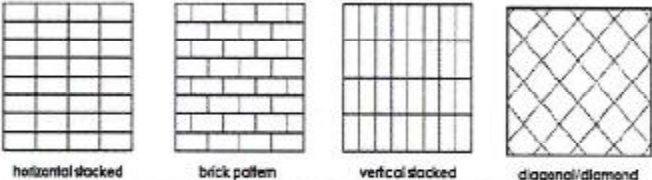

5. Fireplace

	Living Room			Family Room			Other Room - Specify Greatroom		
	Purchased	As Per Plan	N/A	Purchased	As Per Plan	N/A	Purchased	As Per Plan	N/A
Fireplace Type	<input type="radio"/>	<input type="radio"/>	<input type="radio"/>	<input type="radio"/>	<input type="radio"/>	<input type="radio"/>	<input type="radio"/>	<input checked="" type="radio"/>	<input type="radio"/>
Mantle Type							Front Facing		
Over Mantle							NF-08		
Colour / Stain							White		
Surround							/		
Hearth							/		
Comment	/								

Handwritten initials and signatures.

Purchasers: AMRITPAL SINGH AUJLA & HARPREET KAUR **Property:** 22 of Plan - Draft Approval SB17-03-08
Telephone Res. / Bus: / **Project:** Kingsmen (Thames) Inc.
Decor Advisor: Barbara Coccia **Model and Elevation:** James (3601) Elev B 4 Bed - 2+1 Bath

6. Trim Carpentry

Door Hardware Standard Handle

Interior Trim Standard

Comment

/

Interior Doors

☐ 2 Panel Arch Top

☒ 2 Panel Square Top

☐ 6 Panel

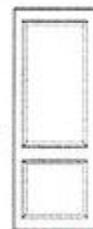

Initial for Door Style

AS

HK

7. Railings and Pickets

Railing Package Standard STRAIGHT

Railing Colour Elements Sturgeon

Wood Stairs ☐ No ☒ Oak

Picket Colour Elements Sturgeon

Tread Colour Elements Sturgeon

Comment

/

8. Plaster Mouldings and Medallions

Foyer / /
Main Hall / /
Living Room / /
Dining Room / /
Family Room / /

Kitchen/Breakfast / /
Den/Library / /
Lower Landing / /

Comment

/

9. Wall Paint

Kingsmen White

Smooth Ceilings ☐ First Floor
☐ First Floor incl. Second Floor Hall
☐ First and Second Floor
☒ Throughout
☐ Not Applicable

Trim Paint Kingsmen White

10. Additional Comments

/

11. Disclaimers and Notes

- Colours of all materials are as close as possible to builder's selection, but not necessarily identical due to variances in manufacturing.
- Any extras listed above are null and void unless accompanied by a separate invoice/amendment. Said invoice must be paid in full.
- The Purchaser acknowledges that after Interior Colour Selection form is signed and dated, no further changes will be permitted other than re-selection due to unavailability. AS HK Purchaser's Initials
- The Purchaser acknowledges reading and accepting the "Kingsmen Group Décor Centre Disclaimers" form. This document contains other miscellaneous disclaimers.

This Interior Colour Selection is final and approved by:

Purchaser: Amritpal Singh Aujla **Date:** 03/12/20

Signature: Harpreet Kaur **Date:** 03/12/20 **Vendor:** Kingsmen (Thames) Inc.

[Signature]

Kingsmen (Thames) Inc.

DEC - 3 2020

sketch #3

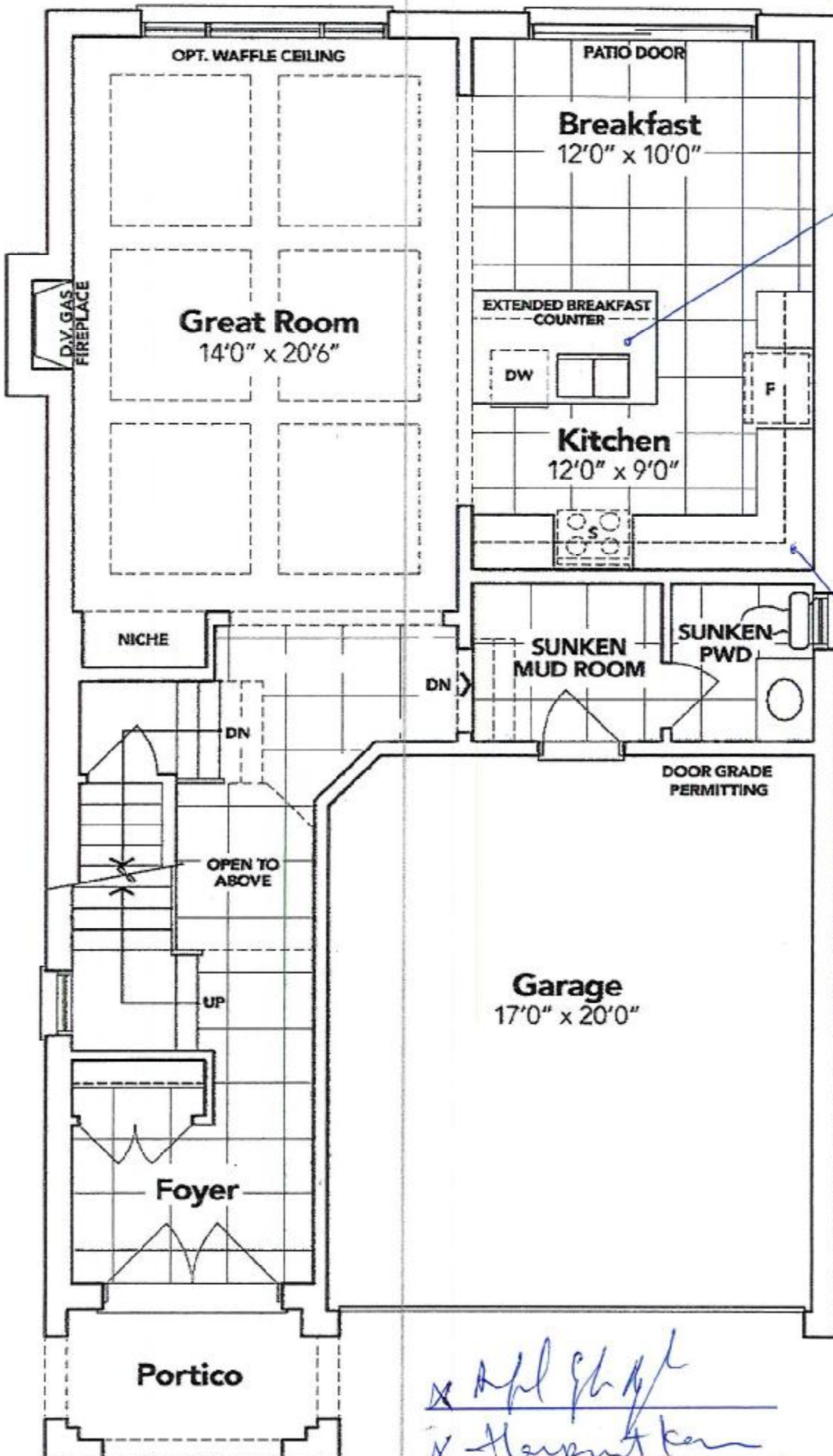

GROUND FLOOR EL. B

The floor plans and elevations shown are pre-construction plans and may be revised or improved as necessitated by architectural controls and the construction process. The measurements adhere to the rules and regulations of the TARION Warranty Corporation's official method for the calculation of floor area. Materials, specifications and floor plans are subject to change without notice. All house drawings are artist's concept only. Actual usable floor space may vary from the stated floor area. All options shown are upgrades. & O. E.

Re: Upg. Undermount Kitchen Sink

DEC - 3 2020

Thames 4A
Lot #22

+ Soap Dispenser

+ Still to Install Std. Single hole Kitchen
faucet*

QUATRUS®
Undermount

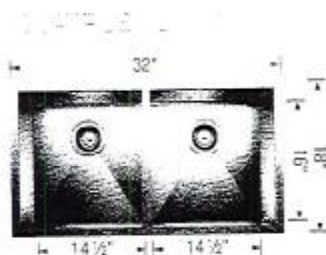

Undermount
Minimum Cabinet Size*
36" (915 mm)
Bowl Depth
9" (229 mm)
Cubed Weight
55 lb. (25 kg)

401247

[Handwritten signature]
[Handwritten signature]

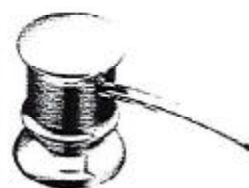

Soap or Lotion
Dispenser

Model 3944
Available in BL
Not available in W

Chrome - \$282.19