



CONSTRUCTION SUMMARY

Kingsmen (Thames) Inc. / Havelock Corners (Kingsmen)

Lot/Unit: 5 Phase/Building: 4A Model/Floor Plan: Louis (4203) Elev B 4 Bed - 4+1 Bath

CABINETRY

ELECTRICAL

HEATING AND AIR CONDITIONING

MISCELLANEOUS

PLUMBING

Inv.4829	1 - To supply & install the BLANCO QUATRUS under mount kitchen sink model: 401247 in lieu of the standard under mount sink in the kitchen... see spec's	
Line 62021	Note:	
25Nov20 / 25Nov20		
Inv.4829	1 - To supply & install the MOEN Soap displencer model 3942 Chrome in the kitchen... see spec's ... see sketch # 1 for location of soap dispencer.	
Line 62022	Note:	
25Nov20 / 25Nov20		

TILE - FLOOR

Inv.4829	1 - To supply & install the upgrade floor tile to the sitting and main floor hallway areas in lieu of the standard hardwood... see colour chart for details.	
Line 62023	Note:	
25Nov20 / 25Nov20		
Inv.4829	1 - To supply & install the UPGRADE 4 - FLOOR TILE STACKED - - FOYER TILE in lieu of the standard floor tiles..see colour chart for details.	
Line 62017	Note:	
25Nov20 / 25Nov20		
Inv.4829	1 - To supply & install the UPGRADE 4 - FLOOR TILE STACKED - POWDER ROOM TILE in lieu of the standard floor tiles..see colour chart for details.	
Line 62018	Note:	
25Nov20 / 25Nov20		
Inv.4829	1 - To supply & install the UPGRADE 4 - FLOOR TILE STACKED - MUD ROOM TILE in lieu of the standard floor tiles..see colour chart for details.	
Line 62019	Note:	
25Nov20 / 25Nov20		
Inv.4829	1 - To supply & install the UPGRADE 4 - FLOOR TILE STACKED - KITCHEN/BREAKFAST TILE in lieu of the standard floor tiles..see colour chart for details.	
Line 62020	Note:	
25Nov20 / 25Nov20		

EXTRAS AS PER OFFER

Purchasers: KULWANT SINGH JHATTU & Pawandeep Kaur IProperty: 5 of Plan - Draft Approval SB17-03-08
 Telephone Res. / Bus: / Project: Kingsmen (Thames) Inc.
 Decor Advisor: Barbara Coccia Model and Elevation: Louis (4203) Elev B 4 Bed - 4+1 Bath

Layout Changes: ☐ Yes ☒ No Sketch Attached: ☒ Yes ☐ No Exterior Colour Scheme:

1. Cabinetry

	Style and Colour	Counter Top	Hardware
Kitchen / Breakfast	#3 Slab LPL Spring Blossom	#1 C/S #9141 Ice Snow 3cm	12881 Handle
Kitchen Island	#3 Slab LPL Spring Blossom	#1 C/S #9141 Ice Snow 3cm	12881 Handle
Laundry Room	/	/	/
Powder Room	#3 Charleston 3DL Moonlight	Argento Romano 6697-46	135 Knob
Main Bathroom	/	/	/
Master Ensuite Bathroom	#3 Camden Maple Espresso CL	Calcatta Marble 4925k-07	12881 Handle
Second Ensuite Bathroom (If Applicable)	#4 Soho Viva Weekend Getaway	Inukshuk Carbon P-346-LM	135 Knob
Bedroom #3 Bathroom	#3 Camden Maple Chocolate CL	Autumn Carnival 1877k-52	135 Knob
Bedroom #4 Bathroom	#3 Charleston 3DL Moonlight	Argento Romano 6697-46	135 Knob

Appliances Custom Size Fridge ☒ Yes ☐ No Valance Lighting ☐ Yes ☒ No Microwave / Range Hood ☐ Yes ☒ No
 Cooktop / Rangetop ☐ Yes ☒ No Built in Wall Oven ☐ Yes ☒ No Slide-in Range ☐ Yes ☒ No
 Comment

2. Flooring

	Selection
Foyer	**UPG #4 24x24" Mayfair Calacatta Oro HD Polished Rectified STACKED
Main Hall	**UPG #4 24x24" Mayfair Calacatta Oro HD Polished Rectified STACKED
Back Hall	SITTING ROOM: **UPG #4 24x24" Mayfair Calacatta Oro HD Polished Rectified STACKED
Breakfast	**UPG #4 24x24" Mayfair Calacatta Oro HD Polished Rectified STACKED (INCLUDING PANTRY)
Laundry Room	13x13" Malena Ice
Kitchen	**UPG #4 24x24" Mayfair Calacatta Oro HD Polished Rectified STACKED
Powder Room	**UPG #4 24x24" Mayfair Calacatta Oro HD Polished Rectified STACKED
Main Bathroom	Bedroom #4 Bathroom: 13x13" Malena Ice
Master Ensuite	13x13" Keaton Ice SH/FL: 2x2" Soho White Matte
Bathroom (If Applicable)	Bedroom #2 Bathroom: 13x13" Keaton Ivory SH/FL: 2x2" Soho White Matte
Mud Room	**UPG #4 24x24" Mayfair Calacatta Oro HD Polished Rectified STACKED
Bedroom #3 Bathroom	13x13" Bellina Grey
Living Room	/
Dining Room	/
Family / Great Room	3 1/2" Elements Oak Talon
Den / Library / Study	/
Basement Landing (If Applies)	/
Lower Landing (If Applicable)	3 1/2" Elements Oak Talon
Upper Landing	3 1/2" Elements Oak Talon
Upper Hall	Stylish Story 1: 919 Early Frost
Master Bedroom	Stylish Story 1: 919 Early Frost
Bedroom #2	Stylish Story 1: 919 Early Frost
Bedroom #3	Stylish Story 1: 919 Early Frost
Bedroom #4	Stylish Story 1: 919 Early Frost
Bedroom #5	/
Shower Jambs	Master Ensuite and Bedroom #2 Bathroom: Anatolia Marmiline SNOW

SEE ATTACHED FOR SIGNATURES

Flooring Continued on Page 2

Initial: 

Page 1 of 3

Purchasers: KULWANT SINGH JHATTU & Pawandeep Kaur **Property:** 5 of Plan - Draft Approval SB17-03-08
Telephone Res. / Bus: / **Project:** Kingsmen (Thames) Inc.
Decor Advisor: Barbara Coccia **Model and Elevation:** Louis (4203) Elev B 4 Bed - 4+1 Bath

2. Flooring - Continued -

Upgrade Underpad	Type	Area
	STD	2nd Floor
Carpet on Stairs	Capped	Runner - *Upgrade
Comment	/	/

3. Plumbing Fixtures / Faucets

Kitchen	Standard	Second Ensuite	Standard	Powder Room	Standard
Master Ensuite	Standard			Other Room	/
Main Bathroom	/	Bedroom #3/#4 Bathroom	Standard		

Comment

NOTE: the purchaser has upgraded the kitchen sink and added a soap dispenser.. see invoice for details. Still to install the standard single hole kitchen faucet.

4. Wall Tile

	Tile Selection	Listello	Insert	Insert Selection
Main Bathroom	/	<input type="checkbox"/>	<input type="checkbox"/>	/
Master Ensuite	/	<input type="checkbox"/>	<input type="checkbox"/>	/
Tub Deck	/	<input type="checkbox"/>	<input type="checkbox"/>	/
Tub Apron	/	<input type="checkbox"/>	<input type="checkbox"/>	/
Tub Surround	/	<input type="checkbox"/>	<input type="checkbox"/>	/
Shower Stall	8x10" Keaton Ice	<input type="checkbox"/>	<input type="checkbox"/>	/
Second Ensuite	8x10" Keaton Ivory	<input type="checkbox"/>	<input type="checkbox"/>	/
Bedroom #3 Bathroom	8x10" Bellina Grey	<input type="checkbox"/>	<input type="checkbox"/>	/
Bedroom #4 Bathroom	8x10" Malena Ice	<input type="checkbox"/>	<input type="checkbox"/>	/
Kitchen Backsplash	/	<input type="checkbox"/>	<input type="checkbox"/>	/
Complete Backsplash	/	<input type="checkbox"/>	<input type="checkbox"/>	/

Comment

To supply and install all wall tiles in all bathrooms (Master, bedroom #2, #3 & #4 bathrooms) on the 10" side horizontally stacked where applicable.

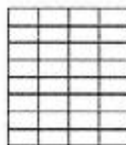

horizontal/stacked



brick pattern



vertical/stacked



diagonal/diamond

5. Fireplace

	Living Room			Family Room			Other Room - Specify Greatroom		
	Purchased	As Per Plan	N/A	Purchased	As Per Plan	N/A	Purchased	As Per Plan	N/A
Fireplace Type	<input type="radio"/>	<input type="radio"/>	<input type="radio"/>	<input type="radio"/>	<input type="radio"/>	<input type="radio"/>	<input type="radio"/>	<input checked="" type="radio"/>	<input type="radio"/>
Mantle Type							Front Facing		
Over Mantle							NF-08		
Colour / Stain							White		
Surround							/		
Hearth							/		
Comment	/								

SEE ATTACHED FOR SIGNATURES

Initial:

(Handwritten initials and signature)

NOV 26 2020

Purchasers: KULWANT SINGH JHATTU & Pawandeep Kaur **Property:** 5 of Plan - Draft Approval SB17-03-08
Telephone Res. / Bus: / **Project:** Kingsmen (Thames) Inc.
Decor Advisor: Barbara Coccia **Model and Elevation:** Louis (4203) Elev B 4 Bed - 4+1 Bath

6. Trim Carpentry

Door Hardware Standard

Interior Trim Standard

Comment

Interior Doors

☐ 2 Panel Arch Top

☒ 2 Panel Square Top

☐ 6 Panel



Initial for Door Style

7. Railings and Pickets

Railing Package Standard "STRAIGHT"

Railing Colour Elements Talon

Wood Stairs ☐ No ☒ Oak

Picket Colour Elements Talon

Tread Colour Elements Talon

Comment

SEE ATTACHED FOR SIGNATURE

8. Plaster Mouldings and Medallions

Foyer

Main Hall

Living Room

Dining Room

Family Room

Kitchen/Breakfast

Den/Library

Lower Landing

Comment

9. Wall Paint

Kingsmen White

Smooth Ceilings

☐ First Floor

☐ First Floor incl. Second Floor Hall

☐ First and Second Floor

☒ Throughout

☐ Not Applicable

Trim Paint Kingsmen White

10. Additional Comments

11. Disclaimers and Notes

- Colours of all materials are as close as possible to builder's selection, but not necessarily identical due to variances in manufacturing.
- Any extras listed above are null and void unless accompanied by a separate invoice/amendment. Said invoice must be paid in full.
- The Purchaser acknowledges that after Interior Colour Selection form is signed and dated, no further changes will be permitted other than re-selection due to unavailability. Purchaser's Initials **SEE ATTACHED FOR SIGNATURES**
- The Purchaser acknowledges reading and accepting the "Kingsmen Group Décor Centre Disclaimers" form. This document contains other miscellaneous disclaimers.

This Interior Colour Selection is final and approved by:

Purchaser:

Signature: *Pawandeep*

Date: Nov-25-2020

Signature:

SEE ATTACHED FOR SIGNATURES

Date:

Vendor:

Kingsmen (Thames) Inc.

SCHEDULE "B-1"
Floor Plan

NOV 26 2020

4A-5

LOT 4

Phase 4A

del: Louis (4203) Elev B 4 Bed - 4+1 Bath
Standard

Sketch #3

Soap Dispenser

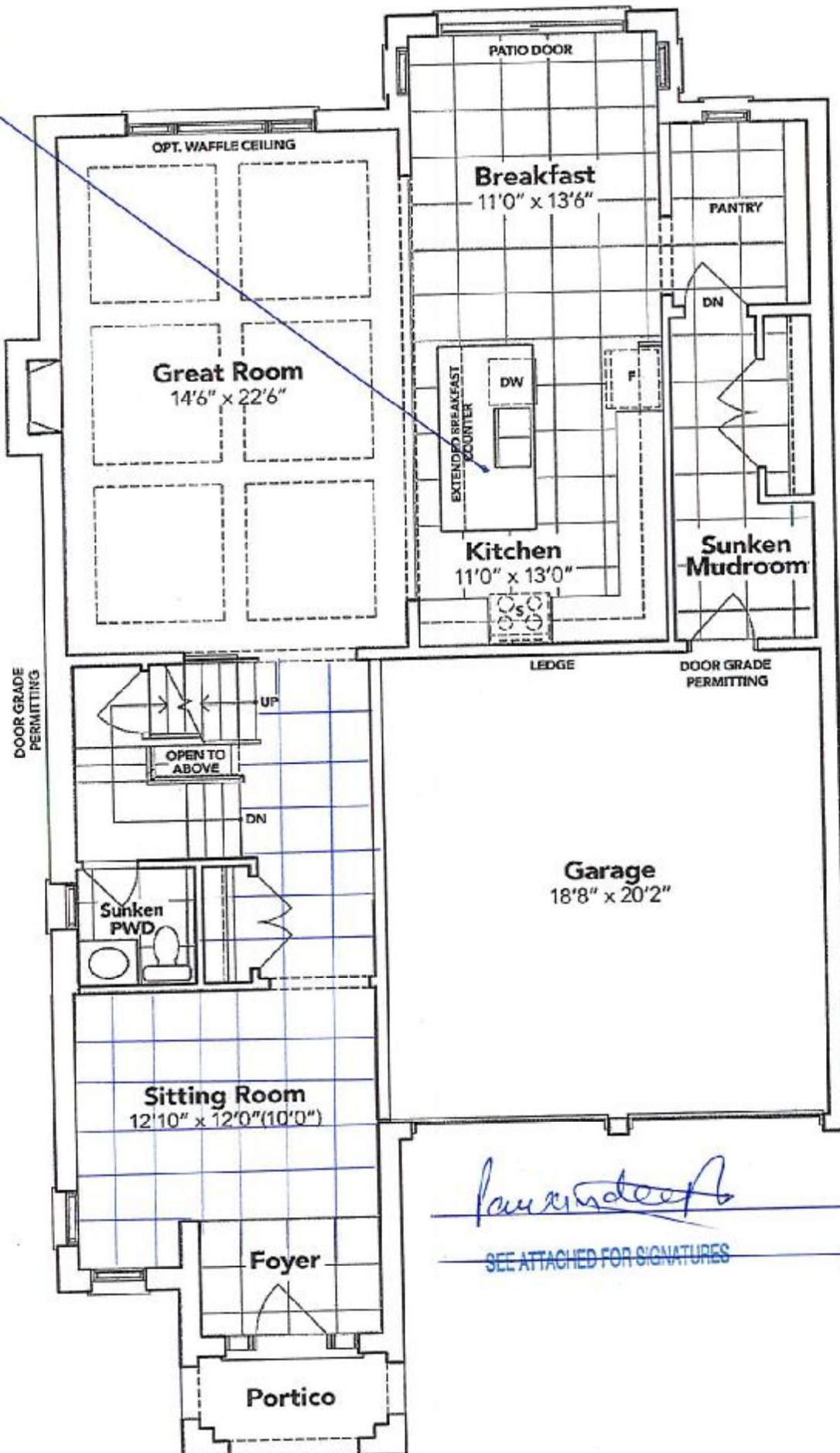

Lawrence

SEE ATTACHED FOR SIGNATURES

GROUND FLOOR EL. B

The floor plans and elevations shown are pre-construction plans and may be revised or improved as necessitated by architectural controls and the construction process. The measurements adhere to the rules and regulations of the TARIION Warranty Corporation's official method for the calculation of floor area. Materials, specifications and floor plans are subject to change without notice. All house renderings are artist's concept only. Actual usable floor space may vary from the stated floor area. All options shown are upgrades. E. & O. E.

NOV 26 2020

LOT#5
Thames 4A

Soap or Lotion Dispensers

Traditional | Transitional | Modern

However you define your faucet's style,
you can assure a coordinated look with Moen soap dispensers.

Lawrence

SEE ATTACHED FOR SIGNATURES



Soap or Lotion Dispenser

Model 3942

Not available in ORB

Chrome - \$282.19

QUATRUS® Undermount

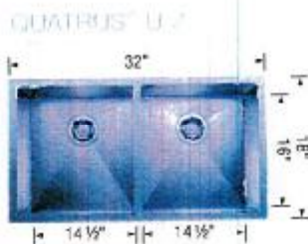

Undermount 401247
Minimum Cabinet Size*
36" (915 mm)
Bowl Depth
9" (229 mm)
Cubed Weight
55 lb. (25 kg)