

Kingsmen (Thames) Inc. / Havelock Corners (Kingsmen)

Lot/Unit: 17 Phase/Building: 4B Model/Floor Plan: Windsor(6003)Elev A 5 BED-5+1 BATH

CABINETRY

Inv. 4791 Line 61531 27Oct20 / 16Nov20	1 - Purchaser has upgraded to the 36" stove opening. Note: 	
Inv. 4791 Line 61549 27Oct20 / 16Nov20	1 - To accomodate for built in refrigerator with integrated or flush inset installation. (typically the door of this unit will be inline/flush with adjoining cabinetry, therefore blending in. Grill or vent is not visible (see spec's) NO PANELS. Note: 	
Inv. 4791 Line 61957 27Oct20 / 16Nov20	1 - To supply & install a built in tall appliance cabinet with drawer below(inc. soft close) for flush mount installations (appliances to be installed flush with kitchen cabinetry, see spec's.. see sketch # 2 Note: Homeowner acknowledges that appliances MUST be one single unit, or one brand of appliances with a common width sothey can be installed to appear flush with cabinetry. Insatllation done by another company, no kitchen supplier or KINGSMEN. 	

CABINETRY HARDWARE

Inv. 4791 Line 61553 27Oct20 / 16Nov20	1 - To supply & insall the BASE WASTE / RECYCLE CENTER PULL OUT DOOR (includes soft close) - ONLY AVAILABLE IN 45 CM CABINET (2) 35L BINS - PRICE IS PER UNIT in the kitchen... see sketch # 1 Note: 	
--	--	--

CABINETRY HOOD FANS

Inv. 4791 Line 61532 27Oct20 / 16Nov20	1 - To supply & install the NEW SIGNATURE HOOD CABINET FOR 36 INCHES STOVE WITH 600 CFM FANAAVAILABLE ONLY IN OAK - MAPLE - AND PAINT - AVAILABLE IN 36INCHES - REQUIRES ADDITIONAL LEAD TIME IN CONSTRUCTION SCHEDULE - CLASSIC SERIES Note: In the kitchen... see sketch # 1 	
--	--	--

CABINETRY MICROWAVE OVEN STOVE COOKTOP

Inv. 4791 Line 61547 27Oct20 / 16Nov20	1 - To suppy & install the RANGETOP CABINET 36 INCHES WIDE, MODIFIED HEIGHT WITH DRAWERS BELOW (includes soft close drawers) - SUPPLY SPECS -- CLASSIC SERIES in the kitchen... see sketch # 1 Note: 	
--	---	--

CABINETRY PANTRY

Inv. 4791 Line 61550 27Oct20 / 16Nov20	2 - To supply & install a PANTRY 66 CM DEEP IN LIEU OF UPPER - BASE - COUNTER DEPTH - - CLASSIC SERIES... see sketch # 1 Note: 	
--	--	--

CABINETRY VANITY

Kingsmen (Thames) Inc. / Havelock Corners (Kingsmen)

Lot/Unit: 17 Phase/Building: 4B Model/Floor Plan: Windsor(6003)Elev A 5 BED-5+1
BATH

Inv.4791	2 - To supply & insall TWO sets of VANITY BANK OF DRAWERS -approx. 40 cm +- wide (includes soft close) - CLASSIC SERIES to bedroom #2's bathroom... see sketch # 2	
Line 61554	Note:	
27Oct20 / 16Nov20		
Inv.4791	4 - To supply & install a VANITY LOWER DRAWER PRICE PER DRAWER - INCLUDES (soft close drawer) - CLASSIC SERIES in powder room, bedroom #3, #4 & #5's bathroom... see sketch # 2	
Line 61555	Note:	
27Oct20 / 16Nov20		
Inv.4791	1 - To INCREASE VANITY TO KITCHEN HEIGHT - 90CM HIGH - MAINTAINS VANITY DEPTH - CLASSIC SERIES for the powder room vanity in lieu of the standard height vanity.	
Line 61556	Note:	
27Oct20 / 16Nov20		
Inv.4791	2 - To INCREASE VANITY TO KITCHEN HEIGHT - 90CM HIGH - MAINTAINS VANITY DEPTH - CLASSIC SERIES for both master ensuite bathroom vanities in lieu of the standard height vanities MAKE UP COUNTER REMAINS AT STANDARD HEIGHT.	
Line 61557	Note:	
27Oct20 / 16Nov20		
Inv.4791	2 - To INCREASE VANITY TO KITCHEN HEIGHT - 90CM HIGH - MAINTAINS VANITY DEPTH - CLASSIC SERIES for the ensuite #2's & Ensuite #3's bathrooms vanity in lieu of the standard height vanity.	
Line 61558	Note:	
27Oct20 / 16Nov20		
Inv.4791	2 - To INCREASE VANITY TO KITCHEN HEIGHT - 90CM HIGH - MAINTAINS VANITY DEPTH - CLASSIC SERIES for the ensuite #4s; and ensuite #5's bathrooms vanity in lieu of the standard height vanity.	
Line 61559	Note:	
27Oct20 / 16Nov20		

COUNTER TOP

Inv.4791	1 - As per Schedule PE" Vendor to supply & install level 1 granite or quartz in lieu of all laminate countertops as per plan. Purchaser to select from builders standard samples.	
Line 61527	Note:	
27Oct20 / 16Nov20		

COUNTER TOP - VANITY

Inv.4791	1 - To supply & install the COUNTER TOP - VANITY - MASTER ENSUITE - 2CM COUNTER TOP - UPGRADE LEVEL 2 to the master enusite bathroom in lieu of the standard quartz countertop... see colour chart for details.	
Line 61955	Note:	
27Oct20 / 16Nov20		

DOORS AND WINDOWS

Inv.4791	1 - To supply & install the optional door to side of garage if grade permits... see sketch # 1	
Line 61529	Note:	
27Oct20 / 16Nov20		

ELECTRICAL

Kingsmen (Thames) Inc. / Havelock Corners (Kingsmen)

**Lot/Unit: 17 Phase/Building: 4B Model/Floor Plan: Windsor(6003)Elev A 5 BED-5+1
BATH**

Inv.4791	2 - To SUPPLY AND INSTALL TWO EXTRA 240 STOVE PLUG for the wall oven/micro combination... see spec's	
Line 61546	Note:	
27Oct20 / 16Nov20		
Inv.4791	1 - To supply & install the standrad T.V. rough in in the great room and master bedroom..see sketch # 1 & # 2	
Line 61534	Note:	
27Oct20 / 16Nov20		
Inv.4791	1 - To supply & install the standard Phone (CAT 5) rough in in the great room, master bedroom and library room... see sketch # 1 & # 2	
Line 61535	Note:	
27Oct20 / 16Nov20		
Inv.4791	1 - To SUPPLY AND INSTALL AN ADDITIONAL BASIC RECEPTACLE (NOT DEDICATED) at approx. 66" + - up from the floor centered +- to the F/P mantle	
Line 61536	Note: in the great room... see sketch # 1	
27Oct20 / 16Nov20		
Inv.4791	1 - To SUPPLY AND INSTALL CONDUIT FOR TV OVER THE FIREPLACE – TERMINATED IN SAME ROOM at approx. 66" + - up from the floor next to +- the upg. electrical outlet and terminated next to + - the standard T.V. rough in the great room...see sketch # 1	
Line 61537	Note:	
27Oct20 / 16Nov20		
Inv.4791	4 - To SUPPLY AND INSTALL CAT-5 ROUGH IN in bed #2, #3, #4 & #5 ... see sketch # 2	
Line 61538	Note:	
27Oct20 / 16Nov20		
Inv.4791	1 - To SUPPLY AND INSTALL REINFORCING FOR A CEILING light at O.T.B. on the second floor.... see sketh # 2	
Line 61539	Note:	
27Oct20 / 16Nov20		

HEATING AND AIR CONDITIONING

Inv.4791	1 - To supply & install a 3/4" gas rough in to include a 110 V elec. outlet at stove area...	
Line 61530	Note:	
27Oct20 / 16Nov20		
Inv.4791	1 - As per Schedule PE" Vender to install capped gas line (rough in only) at rear of home for future BBQ location. Location to be finalized at vendors sole discretion.	
Line 61525	Note:	
27Oct20 / 16Nov20		
Inv.4791	1 - As per Schedule PE" Vendor to supply & install air conditioning unit, sized accordingly, from vendors standard samples.	
Line 61526	Note:	
27Oct20 / 16Nov20		

MISCELLANEOUS

PAINT AND DRYWALL

Kingsmen (Thames) Inc. / Havelock Corners (Kingsmen)

Lot/Unit: 17 Phase/Building: 4B Model/Floor Plan: Windsor(6003)Elev A 5 BED-5+1
BATH

Inv.4791	1 - To supply & install the BLANCO QUATRUS under mount sink model 401248 in the kitchen in lieu of the standard under mount kitchen sink... see spec's	
Line 61560	Note:	
27Oct20 / 16Nov20		

PLUMBING

Inv.4791	1 - As per Schedule PE" Vendor to install undermount sinks in all areas where granite or quartz counter tops have been installed. Sinks to be chosen from builders level 1 under mount stainless steel sinks.	
Line 61561	Note: CLARIFICATION: To supply & install the CONTRAC CATENA Under mount vanity sinks throughout model 4210CIY see spec's	
27Oct20 / 16Nov20		
Inv.4791	1 - To supply & install the MOEN soap dispencer model: 3942 in CHROME in the kitchen... see sketch #1 for installation location, see spec's	
Line 61956	Note:	
27Oct20 / 16Nov20		
Inv.4791	1 - To supply & install the MIROLIN "BROOKE" Free standing tub in the master ensuite in lieu of the standard free standing tub ... see sepc's	
Line 61958	Note:	
27Oct20 / 16Nov20		
Inv.4791	1 - To supply & install the WATERLINE ROUGH-IN TO THE FRIDGE LOCATION (NO HOOK UP) in the kitchen...	
Line 61542	Note:	
27Oct20 / 16Nov20		

TILE - FLOOR

Inv.4791	1 - To supply & install the UPGRADE 2 - SHOWER FLOOR TILE - - MASTER ENSUITE SHOWER FLOOR TILE in lieu of the standard shower floor tiles.... see colour chart for details.	
Line 61562	Note:	
27Oct20 / 16Nov20		
Inv.4791	1 - To supply & install the UPGRADE 2 - SHOWER FLOOR TILE - ENSUITE #2's SHOWER FLOOR TILE in lieu of the standard shower floor tiles.... see colour chart for details.	
Line 61563	Note:	
27Oct20 / 16Nov20		
Inv.4791	1 - To supply & install the UPGRADE 2 - SHOWER FLOOR TILE - ENSUITE #4's SHOWER FLOOR TILE in lieu of the standard shower floor tiles.... see colour chart for details.	
Line 61564	Note:	
27Oct20 / 16Nov20		
Inv.4791	1 - To supply & install the UPGRADE 2 - SHOWER FLOOR TILE - ENSUITE #5's SHOWER FLOOR TILE in lieu of the standard shower floor tiles.... see colour chart for details.	
Line 61565	Note:	
27Oct20 / 16Nov20		



CONSTRUCTION SUMMARY

Kingsmen (Thames) Inc. / Havelock Corners (Kingsmen)

Lot/Unit: 17 Phase/Building: 4B Model/Floor Plan: Windsor(6003)Elev A 5 BED-5+1
BATH
EXTRAS AS PER OFFER

VENDOR TO INSTALL CAPPED GAS LINE (ROUGH-IN ONLY) AT REAR OF HOME FOR FUTURE BBQ LOCATION. LOCATION TO BE FINALIZED AT VENDORS SOLE DISCRETION. <i>Worksheet</i> Note:	
VENDOR TO SUPPLY & INSTALL AIR CONDITIONING UNIT, SIZED ACCORDINGLY, FROM VENDORS STANDARD SAMPLES. <i>Worksheet</i> Note:	
Vendor to install level 1 granite or quartz in lieu of all laminate countertops as per plan. Purchaser to select from builders standard samples. <i>Worksheet</i> Note:	
Vendor to install undermount sinks in all areas where granite or quartz counter tops have been installed. Sinks to be chosen from builders level 1 undermount stainless steel sinks <i>Worksheet</i> Note:	

NOV 16 2020

Purchasers: INDERJIT SINGH PUREWAL & Sarbjit Kaur Purewal
Telephone Res. / Bus: (416) 896-9797 /
Decor Advisor: Barbara Coccia
Property: 17 of Plan - Draft Approval SB17-03-08
Project: Kingsmen (Thames) Inc.
Model and Elevation: Windsor(6003)Elev A 5 BED-5+1 BATH

Layout Changes: ☐ Yes ☒ No **Sketch Attached:** ☒ Yes ☐ No **Exterior Colour Scheme:**

1. Cabinetry

	Style and Colour	Counter Top	Hardware
Kitchen / Breakfast	#6 Toronto Paint Winter White	#1 C/S #3040 Cement 3cm.	12881 Handle
Kitchen Island	#6 Toronto Paint Winter White	#1 C/S #3040 Cement 3cm.	12881 Handle
Laundry Room	/	/	/
Powder Room	#6 Toronto Paint Winter White	#1 C/S #3040 Cement 2cm.	12881 Handle
Main Bathroom	/	#1 C/S #3040 Cement 2cm.	12881 Handle
Master Ensuite Bathroom	#6 Toronto Paint Orchid	* #2,C/S #4141 MistyCarrara 2cm	12881 Handle
Second Ensuite Bathroom (If Applicable)	#6 Toronto Paint Orchid	#1 C/S #3040 Cement 2cm.	12881 Handle
Bedroom #3 & 4 Bathroom	#6 Kingston Maple Oyster CL	#1 C/S #6041 Nordic Loft 2m.	12881 Handle
Bedroom #5 Bathroom	#6 Toronto Paint Orchid	#1 C/S #3040 Cement 2cm.	12881 Handle

Appliances	Custom Size Fridge	Valance Lighting	Microwave / Range Hood
	<input checked="" type="radio"/> Yes <input type="radio"/> No	<input type="radio"/> Yes <input checked="" type="radio"/> No	<input type="radio"/> Yes <input checked="" type="radio"/> No
Comment	Cooktop / Rangetop	Built in Wall Oven	Slide-in Range
	<input checked="" type="radio"/> Yes <input type="radio"/> No	<input checked="" type="radio"/> Yes <input type="radio"/> No	<input type="radio"/> Yes <input checked="" type="radio"/> No

2. Flooring

	Selection
Foyer	12X24" Regency Mica HD Porcelain Tile "STACKED"
Main Hall	5" Elements Oak Brushed Wolverine
Back Hall	/
Breakfast	12X24" Regency Mica HD Porcelain Tile "STACKED"
Laundry Room	12X24" Regency Mica HD Porcelain Tile "STACKED"
Kitchen	12X24" Regency Mica HD Porcelain Tile "STACKED" (inc. servery & pnatry)
Powder Room	12X24" Regency Mica HD Porcelain Tile "STACKED"
Main Bathroom	(Bed. #2 & #5 Bathroom)- 13x13" Cinq Grey SH/FL- UPG #2, 2x2"Cinq Black Mosaics 46-192
Master Ensuite	12x24" Classic Cararra HD Porcelain Tile "STACKED" SH/FL-**UPG #2, 2x2" Malena Ice46-170
Bathroom (If Applicable)	(Bed. #3 & 4 BRM: 13 x 13" Cinq White
Mud Room	12X24" Regency Mica HD Porcelain Tile "STACKED"
Bed # 4's shower floor	**Upg. 2 x2" Cinq White 46-150 mosaic
Living Room	5" Elements Oak Brushed Wolverine
Dining Room	5" Elements Oak Brushed Wolverine
Family / Great Room	5" Elements Oak Brushed Wolverine
Den / Library / Study	5" Elements Oak Brushed Wolverine
Basement Landing (If Applies)	Basement Foyer- 13x13" Cinq Grey
Lower Landing (If Applicable)	5" Elements Oak Brushed Wolverine
Upper Landing	5" Elements Oak Brushed Wolverine
Upper Hall	5" Elements Oak Brushed Wolverine
Master Bedroom	5" Elements Oak Brushed Wolverine
Bedroom #2	5" Elements Oak Brushed Wolverine
Bedroom #3	5" Elements Oak Brushed Wolverine
Bedroom #4	5" Elements Oak Brushed Wolverine
Bedroom #5	5" Elements Oak Brushed Wolverine
Shower Jamb (Sill)	Master, bedroom #2, #4, #5- Anatolia Marmiline SNOW

Flooring Continued on Page 2



Initial: _____

Page 1 of 3

Purchasers: INDERJIT SINGH PUREWAL & Sarbjit Kaur Purewal
Telephone Res. / Bus: (416) 896-9797 /
Decor Advisor: Barbara Coccia
Property: 17 of Plan - Draft Approval SB17-03-08
Project: Kingsmen (Thames) Inc.
Model and Elevation: Windsor(6003)Elev A 5 BED-5+1 BATH

2. Flooring - Continued -

Upgrade Underpad	Type	Area
Carpet on Stairs	Capped	Runner - *Upgrade
Comment		

3. Plumbing Fixtures / Faucets

Kitchen	Standard	Second Ensuite	Standard	Powder Room	Standard
Master Ensuite	Standard			Other Room	
Main Bathroom		Bed. #3, #4, #5 Bathroom	Standard		

Comment

Please Note: Purchaser has upgraded all sinks to be undermount (in Kitchen, Pwd, Master, Bedroom #2, #3, #4, and #5). Still to install the standard faucets....see invoice for details.

4. Wall Tile

	Tile Selection	Listello	Insert	Insert Selection
Main Bathroom	Bed #3 & #4: 8x10" Cinq White	<input type="checkbox"/>	<input type="checkbox"/>	
Master Ensuite				
Tub Deck		<input type="checkbox"/>	<input type="checkbox"/>	
Tub Apron		<input type="checkbox"/>	<input type="checkbox"/>	
Tub Surround		<input type="checkbox"/>	<input type="checkbox"/>	
Shower Stall	8x10" Malena Ice	<input type="checkbox"/>	<input type="checkbox"/>	
Second Ensuite		<input type="checkbox"/>	<input type="checkbox"/>	
Bed. #2, & #5 Bath.	8x10" Cinq Black	<input type="checkbox"/>	<input type="checkbox"/>	
		<input type="checkbox"/>	<input type="checkbox"/>	
Kitchen Backsplash		<input type="checkbox"/>	<input type="checkbox"/>	
Complete Backsplash		<input type="checkbox"/>	<input type="checkbox"/>	

Comment

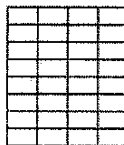

horizontal stacked

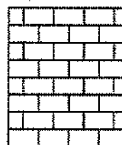

brick pattern



vertical stacked

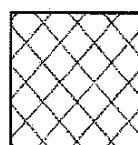

diagonal/diamond

5. Fireplace

	Living Room			Family Room			Other Room - Specify			Greatroom
	Purchased	As Per Plan	N/A	Purchased	As Per Plan	N/A	Purchased	As Per Plan	N/A	
Fireplace Type	<input type="radio"/>	<input type="radio"/>	<input checked="" type="radio"/>	<input type="radio"/>	<input type="radio"/>	<input checked="" type="radio"/>	<input type="radio"/>	<input checked="" type="radio"/>	<input type="radio"/>	
Mantle Type							Front Facing			
Over Mantle							NF-08			
Colour / Stain							White			
Surround										
Hearth										
Comment										



Initial: _____

Purchasers:INDERJIT SINGH PUREWAL & Sarbjit Kaur Purewal
Telephone Res. / Bus: (416) 896-9797 /
Decor Advisor: Barbara Coccia
Property: 17 of Plan - Draft Approval SB17-03-08
Project: Kingsmen (Thames) Inc.
Model and Elevation: Windsor(6003)Elev A 5 BED-5+1 BATH

6. Trim Carpentry

Door Hardware Standard Handle

Interior Trim Standard

Comment

Interior Doors

☐ 2 Panel Arch Top

☒ 2 Panel Square Top

☐ 6 Panel



Initial for Door Style

SP SP

7. Railings and Pickets

Railing Package Standard Metal Package

Railing Colour Elements Wolverine

Picket Colour Black

Wood Stairs ☐ No ☒ Oak

Tread Colour Elements Wolverine

Comment

8. Plaster Mouldings and Medallions

Foyer /

Main Hall /

Living Room /

Dining Room /

Family Room /

Kitchen/Breakfast /

Den/Library /

Lower Landing /

Comment

9. Wall Paint

Kingsmen White

Smooth Ceilings ☐ First Floor
☐ First Floor incl. Second Floor Hall
☐ First and Second Floor
☒ Throughout
☐ Not Applicable

Trim Paint Kingsmen White

10. Additional Comments

11. Disclaimers and Notes

- Colours of all materials are as close as possible to builder's selection, but not necessarily identical due to variances in manufacturing.
- Any extras listed above are null and void unless accompanied by a separate invoice/amendment. Said invoice must be paid in full.
- The Purchaser acknowledges that after Interior Colour Selection form is signed and dated, no further changes will be permitted other than re-selection due to unavailability. SP SP Purchaser's Initials
- The Purchaser acknowledges reading and accepting the "Kingsmen Group Décor Centre Disclaimers" form. This document contains other miscellaneous disclaimers.

This Interior Colour Selection is final and approved by:

Purchaser:
Signature: Indrajit Singh Purewal Date: Nov-16-2020

Signature: Sarbjit Kaur Purewal Date: Nov-16-2020

Vendor:

Kingsmen (Thames) Inc.

Sketch #1

Phase 4B

Model: Windsor(6003)Elev A 5 BED-5+1 BATH

Sketch #1



SCHEDULE "B-1" - Page 1 of 3

Initials:

"B-1" -
GP

SP.

SCHEDULE "B-1"
Floor Plan

Lot 17
Phase 4B
Model: Windsor(6003)Elev A 5 BED-5+1 BATH

NOV 16 2020

Sketch #2

Indrjit Singh Patel
Sarbjit Kaur Patel

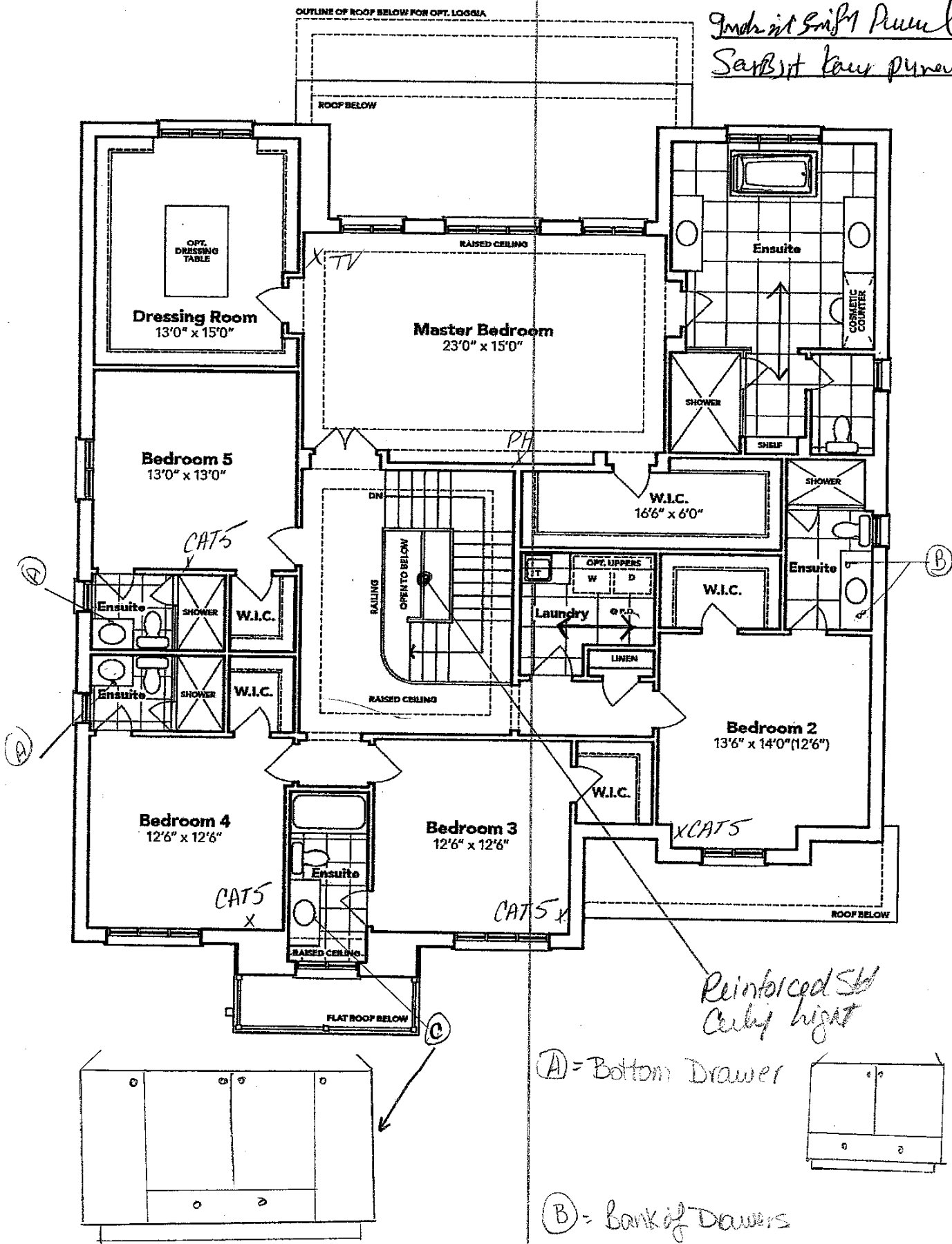

SECOND FLOOR EL. A

The floor plans and elevations shown are pre-construction plans and may be revised or improved as necessitated by architectural controls and the construction process. The measurements adhere to the rules and regulations of the TARION Warranty Corporation's official method for the calculation of floor area. Materials, specifications and floor plans are subject to change without notice. All house renderings are artist's concept only. Actual usable floor space may vary from the stated floor area. All options shown are upgrades. E. & O. E.

SCHEDULE "B-1"
Floor Plan

Lot 17
Phase 4B
Model: Windsor(6003)Elev A 5 BED-5+1 BATH
NOV 16 2020

Sketch #3

Under 2nd Smith Parcel
Saris 1st four parcels

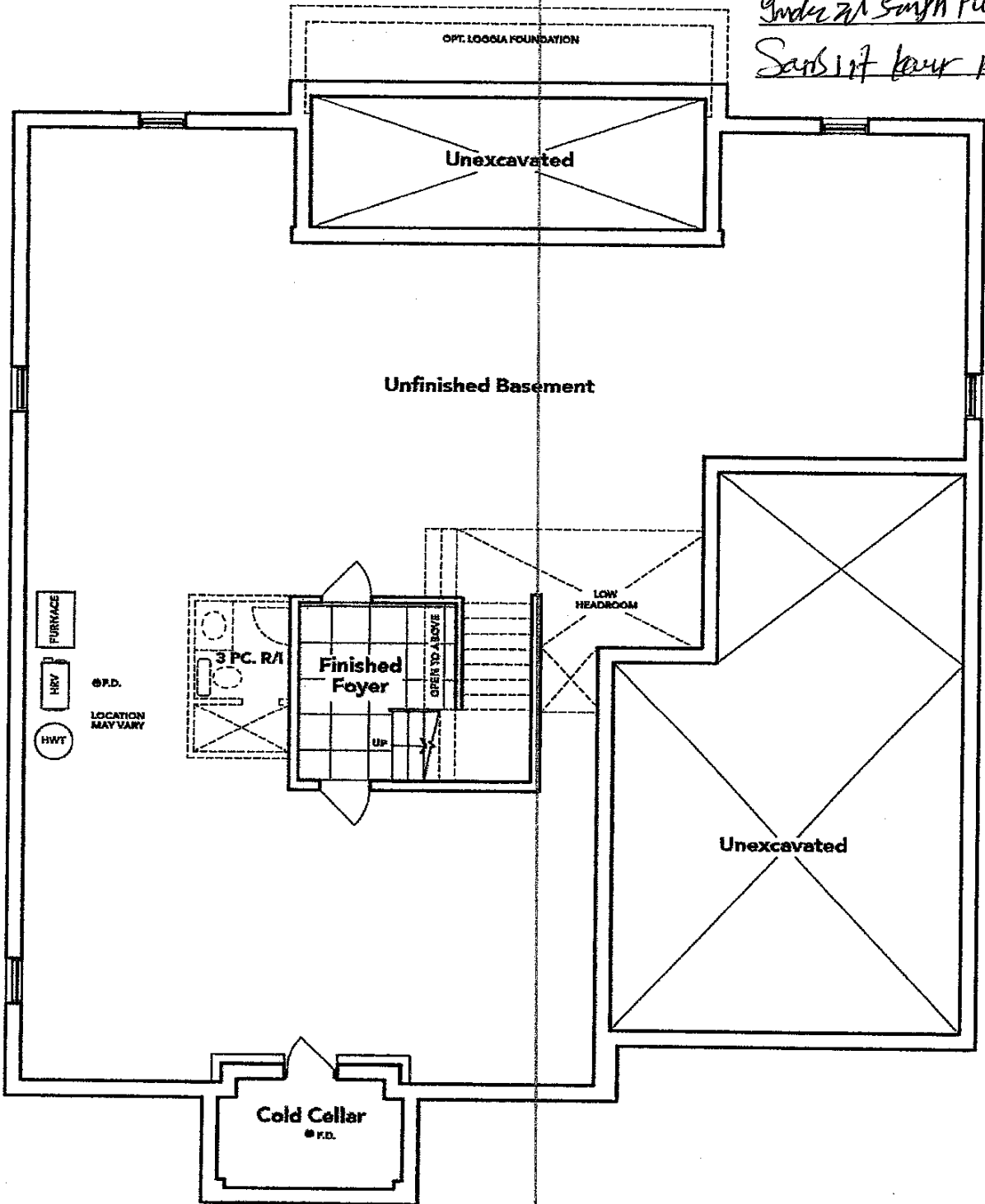

BASEMENT EL. A

The floor plans and elevations shown are pre-construction plans and may be revised or improved as necessitated by architectural controls and the construction process. The measurements adhere to the rules and regulations of the TARION Warranty Corporation's official method for the calculation of floor area. Materials, specifications and floor plans are subject to change without notice. All house renderings are artist's concept only. Actual usable floor space may vary from the stated floor area. All options shown are upgrades. E. & O. E.

4B-17

LOT: 17 THAMES PH. 4 B
RE: UPG. UNDER MOUNT KITCHEN SINK
AND SOAP DISPENSER.

NOV 16 2020

QUATRUS®
Undermount

Michael Smith Personal

Sevysth Personal

QUATRUS® UNDERMOUNT

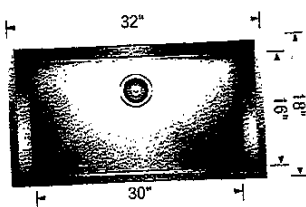

Undermount
Minimum Cabinet Size*
36" (915 mm)
Bowl Depth
9" (229 mm)
Cubed Weight
55 lb. (25 kg)

401248

\$ 815

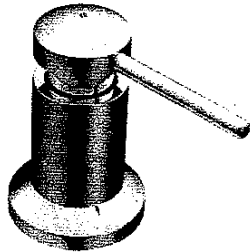

MOEN

Soap or Lotion
Dispenser

Model 3942

Not available in ORB

Chrome

- \$282.19

NOV 16 2020

LOT: 17 THAMES PH: 4 B
RE: UNDERMOUNT
SINKS THROUGHOUT ALL BATHROOMS.

Individual Sinks Provided
Sansit low pressure



Main Floor Vanity Display

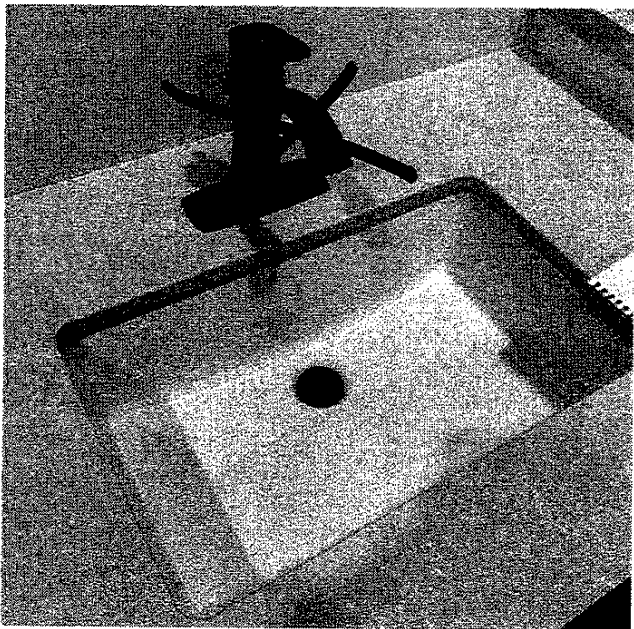

DISPLAY ITEMS

Sink (Item 9)
Contrac Catena Undermount
Model 4210CIY

NOV 16 2020

4B-17

LOT: 17 THAMES PH: 4 B
RE: UPG. FREESTANDING TUB
FOR MASTER ENSUITE.

Inds 2nd Smith Personal

Seymour Law Personal



Brooke™ | 1

Brooke™

Categories: Acrylic Freestanding

DESCRIPTION

68" Freestanding Bath
SKU #: CF2002

FEATURES

- Installation friendly two piece design
- Accepts deck mounted faucet
- Includes a chrome integral pop up drain and rectangular overflow
- ~~Brushed nickel drain and overflow covers available~~
- Centre drain
- Includes levelling feet
- Available in White Only

DIMENSIONS

68" x 36" x 23"

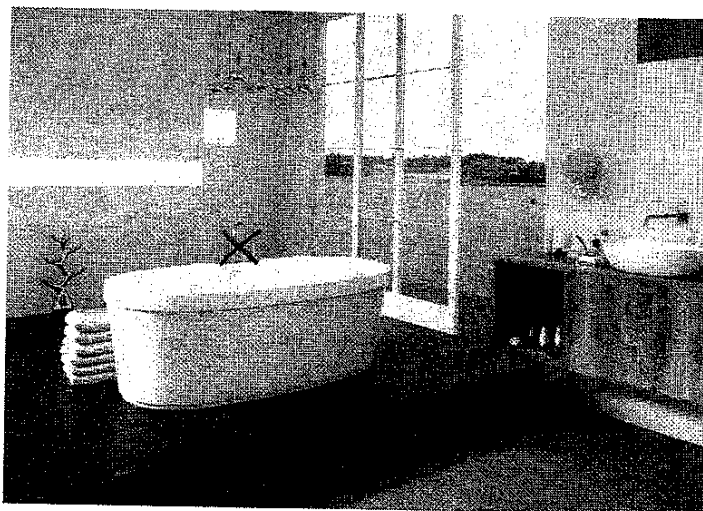

LOT: 17 THAMES PH: 4 B
RE: FRIDGE SPEC'S.

Gurjit Singh Puri
Sansat puri puri

JENN-AIR® DETAILED PLANNING DIMENSIONS 1 of 3
48" SIDE-BY-SIDE REFRIGERATORS WITH ICE & WATER DISPENSER
→ JS48PPDUDE 48 1/4" x 83 1/4" x 27 3/4" (with handles)
JS48SSDUDE 48 1/4" x 83 1/4" x 27 3/4" (with handles)

PRODUCT DIMENSIONS

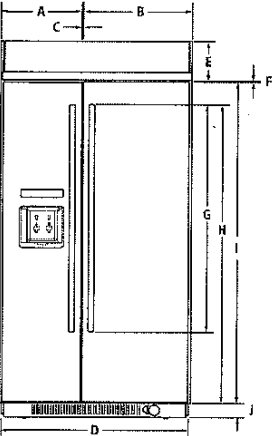

FRONT VIEW

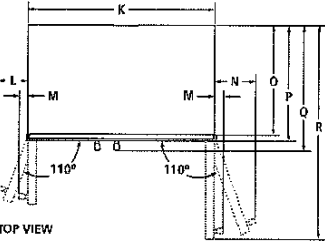

TOP VIEW

MODEL #		JS48PPDUDE JS48SSDUDE	
		in	cm
A	Width of freezer door (including hinge side offset)	20	50.8
B	Width of refrigerator door (including hinge side offset)	27	68.6
C	Space between doors	1/4	1.0
D	Overall width (including side trim)	48 1/4	122.9
E	Height of top grille	8 1/4	21.7
F	Space between doors and top grille	1/4	1.0
G	Height of handles		
	Pro-Style® Stainless	45 3/4	115.7
	Euro Style Stainless	50	127.1
H	Height to top of handles		
	Pro-Style® Stainless	63 1/2	163.5
	Euro Style Stainless	65 3/4	167.0
I	Height of doors	71	180.2
J	Height of bottom grille	3	7.6
K	Width of recessed refrigerator	47	119.4
L	Width from side of refrigerator to freezer handle – door fully open 110°		
	Pro-Style® Stainless	8 3/4	21.3
	Euro Style Stainless	8	20.3
M	Width from side of refrigerator to handle – door open 90°		
	Pro-Style® Stainless	2 3/4	6.7
	Euro Style Stainless	2	5.1
N	Width from side of refrigerator to refrigerator handle – door fully open 110°		
	Pro-Style® Stainless	10 1/4	27.6
	Euro Style Stainless	10 1/2	26.1
O	Depth without doors	22 1/4	56.2
P	Depth with doors	25 1/4	63.8
Q	Depth with handles		
	Pro-Style® Stainless	27 1/4	70.5
	Euro Style Stainless	27 3/4	68.8
R	Depth with refrigerator door open 90°	50 3/4	129.0

IMPORTANT: Dimensional specifications are provided for planning purposes only.
Do not make any cutouts based on this information. Refer to the Installation or Use & Care Guide before selecting cabinetry, verifying electrical/gas connections, making cutouts or beginning installation.
All Jenn-Air® appliances are appropriately UL, CUL or CSA approved.

LOT: 17 THAMES PH: 4 B
RE: FRIDGE SPEC'S.

Indezit Single Pinned
Sensyt four pinned

JENN-AIR® DETAILED PLANNING DIMENSIONS

2 of 3

48" SIDE-BY-SIDE REFRIGERATORS WITH ICE & WATER DISPENSER

→ JS48PPDUDE – 48 1/8" x 83 3/4" x 27 1/4" (with handles)
JS48SSDUDE – 48 1/8" x 83 3/4" x 27 1/4" (with handles)

DIMENSIONS AS INSTALLED

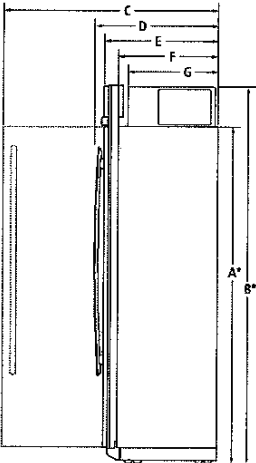

SIDE VIEW

MODEL #	JS48PPDUDE JS48SSDUDE	
	in	cm
A* Height without compressor (min.)	74 1/4	188.9
B* Height of recessed refrigerator (min.)	83 3/4	211.8
C Depth with refrigerator door open 90° (min.)	51 1/4	129.7
Depth with handles (min.)		
D Pro-Style® Stainless	27 1/4	70.5
Euro Style Stainless	27 1/2	68.8
E Depth with doors (min.)	25 1/4	63.8
F Depth without doors (min.)	22 1/4	56.2
G Depth of compressor (min.)	19 1/4	49.8

*Add 1 1/4" (3.2 cm) to the height dimension when leveling legs are fully extended.

IMPORTANT: Dimensional specifications are provided for planning purposes only.
Do not make any cutouts based on this information. Refer to the Installation or Use & Care Guide
before selecting cabinetry, verifying electrical/gas connections, making cutouts or beginning installation.
All Jenn-Air® appliances are appropriately UL, CUL or CSA approved.

LOT: 17 THAMES PH: 4 B
RE: FRIDGE SPEC'S.

NOV 16 2020

4B-17

Indesit Singh Perumal
Sansit Kew perumal

JENN-AIR® DETAILED PLANNING DIMENSIONS

3 of 3

48" SIDE-BY-SIDE REFRIGERATORS WITH ICE & WATER DISPENSER

JS48PPDUDE – 48 1/2" x 83 1/2" x 27 3/4" (with handles)
JS48SSDUDE – 48 1/2" x 83 1/2" x 27 3/4" (with handles)

OPENING/CLEARANCE DIMENSIONS

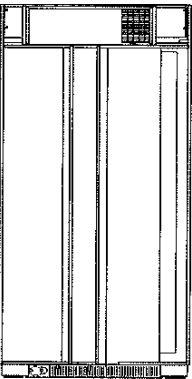
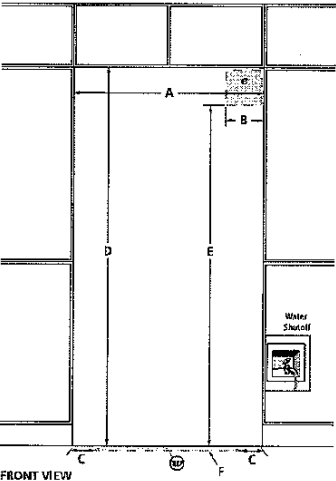

BACK VIEW

MODEL #		JS48PPDUDE JS48SSDUDE	
		in	cm
A	Width (min.)	47 1/2	120.7
B	Width of recommended electrical location	13 1/2	34.3
C	Distance from side of cabinet to recommended water connection location	6	15.2
D	Height (min.)	84	213.4
E	Height to recommended electrical location	77	195.6
F	Depth of recommended water connection location (max.)	1	2.5
e	Recommended electrical connection location		
w	Recommended water connection location		

ELECTRICAL REQUIREMENTS

115 volt, 60 Hz, AC only, 15- or 20-amp fused, grounded circuit is required. A dedicated circuit is recommended. Use an outlet that cannot be turned off by a switch. Minimum length of power cord is 84" (213.4 cm). Do not use an extension cord.

WATER PRESSURE REQUIREMENTS

A cold water supply with water pressure between 30 and 120 psi (207 and 827 kPa) is required to operate the water dispenser and ice maker. Call a licensed, qualified plumber with any questions about the water pressure.

Reverse Osmosis Water Supply

IMPORTANT: The pressure of the water coming out of a reverse osmosis system going to the water inlet valve of the refrigerator needs to be between 30 and 120 psi (207 and 827 kPa).

If a reverse osmosis water filtration system is connected to the cold water supply, the water pressure to the reverse osmosis system needs to be a minimum of 40 to 60 psi (276 to 414 kPa).

LOCATION REQUIREMENTS

Floor must be able to support refrigerator (more than 600 lb [272 kg]) and contents of the refrigerator and must be at the same level as flooring in the room.

IMPORTANT: Dimensional specifications are provided for planning purposes only. Do not make any cutouts based on this information. Refer to the Installation or Use & Care Guide before selecting cabinetry, verifying electrical/gas connections, making cutouts or beginning installation. All Jenn-Air® appliances are appropriately UL, ETL or CSA approved.

JENN-AIR®
8116A02w915

4B-17

NOV 16 2020

LOT: 17 THAMES PH: 4 B
RE: 36" GAS RANGE TOP SPEC'S.

Gagne 21 Smith Purwall
Sambit Kaur purwall

DIMENSIONS
JENNAIR® RANGETOPS
PRODUCT



	30" RANGETOP JCCF430H	36" RANGETOP JCCF436H	48" RANGETOP JCCF548H
Overall Width (A)	29-3/4" (75.6 cm)	35-3/4" (90.8 cm)	47-7/8" (121.6 cm)
Grate Depth (B)	22" (55.9 cm)	22" (55.9 cm)	22" (55.9 cm)
Depth without Control Panel (C)	23-1/4" (59.1 cm)	23-1/4" (59.1 cm)	23-1/4" (59.1 cm)
Depth with Control Panel Overhang (D)	27-1/2" (69.9 cm)	27-1/2" (69.9 cm)	27-1/2" (69.9 cm)
Depth with Kneecaps RISE* (E)	29-1/8" (74 cm)	29-1/8" (74 cm)	29-1/8" (74 cm)
Depth with Kneecaps NO RISE* (E)	29" (73.7 cm)	29" (73.7 cm)	29" (73.7 cm)

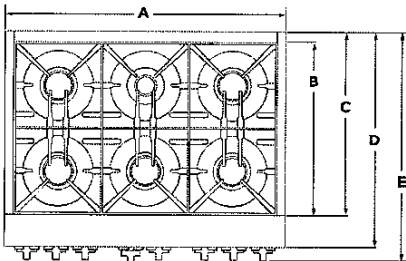

TOP VIEW

★ **IMPORTANT:** Dimensions and features are provided for planning purposes only. Do not make any decisions based on this information until you have read the Installation Guide before selecting cutouts and/or the electrical/water supply. Always consult a qualified installer. All Jennair appliances are approved for use in the U.S. only. © 2020 Jennair.

W11358024A

LOT: 17 THAMES PH: 4 B
RE: 36" GAS RANGE TOP SPEC'S.

Under sit Single Pannel
SanBsit four pannel

DIMENSIONS
JENNAIR® RANGETOPS
PRODUCT



	30" RANGETOP JGC430H	36" RANGETOP JGC438H	48" RANGETOP JGC439H
Height with Controls (J)	9" (22.9 cm)	9" (22.9 cm)	9" (22.9 cm)
Control Panel Height (K)	7-13/16" (19.8 cm)	7-13/16" (19.8 cm)	7-13/16" (19.8 cm)
Recessed Rangesop Height (L)	7" (17.8 cm)	7" (17.8 cm)	7" (17.8 cm)
Cooking Surface Height (M)	7-7/16" (18.9 cm)	7-7/16" (18.9 cm)	7-7/16" (18.9 cm)
Recessed Rangesop Depth (N)	21-7/8" (55.6 cm)	21-7/8" (55.6 cm)	21-7/8" (55.6 cm)
Depth with Control Panel (O)	25-1/2" (64.8 cm)	25-1/2" (64.8 cm)	25-1/2" (64.8 cm)

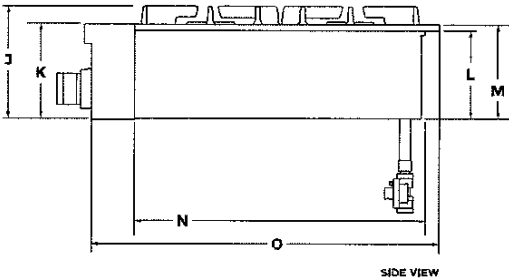

★ IMPORTANT: Supplied regulations do not define prohibited and restricted materials, products and services.

LOT: 17 THAMES PH: 4 B
RE: 36" GAS RANGE TOP SPEC'S.

NOV 16 2020 4B-17

Indesit Smith Purcell
Seerdt Haur Purcell

DIMENSIONS
JENNAIR® RANGETOPS
PRODUCT



	30" RANGETOP JCCF430H	36" RANGETOP JCCF436H	48" RANGETOP JCCF648H
Grate Width (F)	27-7/16" (69.7 cm)	33" (83.8 cm)	44-3/8" (112.7 cm)
Gas Inlet to Surface (G)	10-3/4" (27.3 cm)	10-3/4" (27.3 cm)	10-3/4" (27.3 cm)
Center to Gas Inlet (H)	11" (27.9 cm)	14-1/8" (35.9 cm)	19-5/8" (49.8 cm)
Enclosed Ranges Width (I)	29-1/8" (74 cm)	35" (88.9 cm)	47-1/4" (120 cm)

*Includes width of grates and griddle.

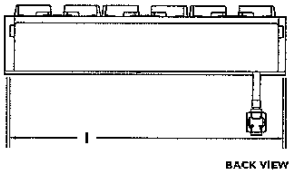
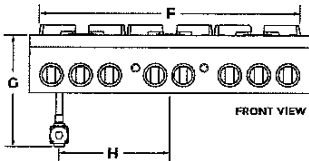

LOT: 17 THAMES PH: 4 B
RE: 36" GAS RANGE TOP SPEC'S.

NOV 16 2020

4B-17

Index it Single Personal
Sansit keur personal

DIMENSIONS
JENNAIR® RANGETOPS
OPENING AND CLEARANCE



	30" RANGETOP JCCP430H	36" RANGETOP JCCP436H	48" RANGETOP JCCP548H
Combustible Area Above Cooking Surface Width (A)	30" (76.2 cm) min.	36" (91.4 cm) min.	48" (121.9 cm) min.
Bottom of Cabinet Height Above Cooking Surface (B*)	42" (106.7 cm) min.	58" (147.3 cm) min.	58" (147.3 cm) min.
Bottom of Cabinet Height Above Countertop (C)	18" (45.7 cm) min.	18" (45.7 cm) min.	18" (45.7 cm) min.
Distance to Flood Wall or Combustible Material (D)	12" (30.5 cm) min.	12" (30.5 cm) min.	12" (30.5 cm) min.

*Dimension reduced by 5" (12.7 cm) when bottom of wood or metal cabinet is covered by at least 1/4" (6.4 mm) flame retardant millboard, which is in turn covered with at least No. 26 (1450) sheet metal, 20/16 (3.0 mm) stainless steel, 0.024" (0.6 mm) aluminum or 0.020 (0.5 mm) copper. If installing a hood above the range, follow the hood instructions for dimensional clearances above the cooking surface.

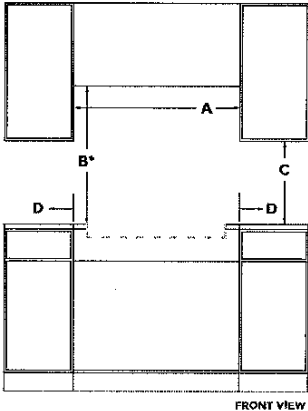

LOT: 17 THAMES PH: 4 B
RE: 36" GAS RANGE TOP SPEC'S.

Gurdeep Singh Puraana
Sanjit Puraana

DIMENSIONS
JENNAIR® RANGETOPS
OPENING AND CLEARANCE



	30" RANGETOP JOP430-H	36" RANGETOP JOP436-H	48" RANGETOP JOP436-H
Recommended Upper Cabinet Depth (E)	13" (33 cm)	13" (33 cm)	13" (33 cm)
Cutout to Wall Depth (F)*	1-1/2" (3.8 cm) min.	1-1/2" (3.8 cm) min.	1-1/2" (3.8 cm) min.
Cabinet to Countertop Height (G)	7-1/4" (18.4 cm)	7-1/4" (18.4 cm)	7-1/4" (18.4 cm)
Cabinet Depth (H)	24" (61 cm)	24" (61 cm)	24" (61 cm)

*If the back wall is constructed of a combustible material and a backsplash is not installed, a 1/4" (6.4 mm) minimum clearance is required from the cutout or 1/2" (12.7 mm) minimum clearance from the back edge of the rangetop.

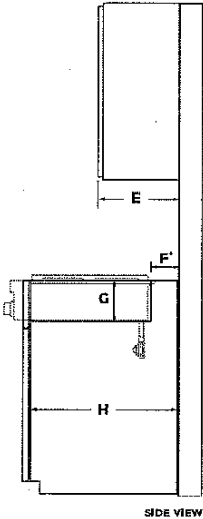

NOV 16 2020

4B-17

LOT: 17 THAMES PH: 4 B
RE: 36" GAS RANGE TOP SPEC'S.

Inde 2d Single Perme

Sansif pour pannel.

DIMENSIONS
JENNAIR® RANGETOPS
OPENING AND CLEARANCE



	30" RANGETOP JCCP-30H	36" RANGETOP JCCP-36H	48" RANGETOP JCCP-48H
Countertop and Cabinet Cutout Width (B)	29-1/4" (74.3 cm)	35-1/4" (89.5 cm)	47-3/8" (120.3 cm)
Countertop and Cabinet Depth (D)	22-1/4" (56.5 cm)	22-1/4" (56.5 cm)	22-1/4" (56.5 cm)
Knock Width (K)	5/16" (0.8 cm)	5/16" (0.8 cm)	5/16" (0.8 cm)
Cabinet Width (C)	29-7/8" (75.9 cm)	35-3/4" (90.8 cm)	47-7/8" (121.6 cm)

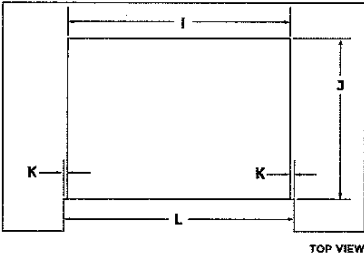

TOP VIEW

NOV 16 2020

4B-17

LOT: 17 THAMES PH: 4 B
RE: 36" GAS RANGE TOP SPEC'S.

Indesit Smith Personal
Sensit per personal.

DIMENSIONS
JENNAIR® RANGETOPS
ELECTRICAL REQUIREMENTS

ELECTRIC REQUIREMENTS CHECKLIST

☐

A 120 volt, 60 Hz, AC only, 15 amp fused, electrical circuit is required.

☐

A dedicated circuit is recommended.

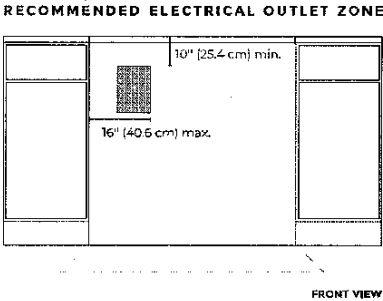

? IF YOU HAVE QUESTIONS ABOUT YOUR ELECTRICAL SUPPLY, CALL A LICENSED, QUALIFIED ELECTRICIAN.

4B-17

LOT: 17 THAMES PH: 4 B
RE: 36" GAS RANGE TOP SPEC'S.

NOV 16 2020

Gudrat Singh Parnal

Singh Parnal

DIMENSIONS
JENNAIR® RANGETOPS
GAS REQUIREMENTS

RECOMMENDED GAS SUPPLY LOCATION

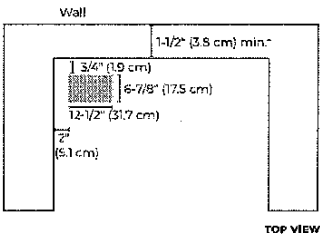

TOP VIEW

*If the back wall is constructed of a combustible material and a backplash is not installed, a 1/4" (2.5 cm) minimum clearance is required from the cutout or 0" (0 cm) minimum clearance from the back edge of the rangetop.

GAS SUPPLY ZONE

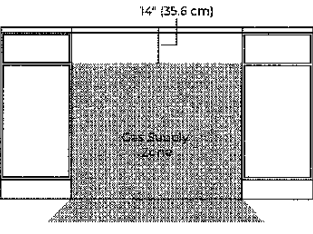

FRONT VIEW

? IF YOU HAVE QUESTIONS ABOUT YOUR GAS SUPPLY, CALL A LICENSED, QUALIFIED SERVICE TECHNICIAN.

LOT: 17 THAMES PH: 4 B
RE: BUILT IN WAL OVEN
AND MICRO. SPEC'S.

NOV 16 2020

4B-17

Gmohrit Singh Parnal

Sarbjit Kaur Parnal.



INSTALLATION INSTRUCTIONS

~~27" (68.6 CM) AND 30" (76.2 CM) ELECTRIC BUILT-IN
CONVECTION MICROWAVE OVEN~~

INSTRUCTIONS D'INSTALLATION

FOUR À MICRO-ONDES ENCASTRÉ ÉLECTRIQUE À
CONVECTION DE 27" (68,6 CM) ET 30" (76,2 CM)

Table of Contents/Table des matières

BUILT-IN MICROWAVE OVEN SAFETY.....	2	SÉCURITÉ DU FOUR À MICRO-ONDES ENCASTRÉ.....	8
INSTALLATION REQUIREMENTS.....	3	EXIGENCES D'INSTALLATION.....	8
Tools and Parts.....	3	Outils et pièces.....	8
Location Requirements.....	3	Exigences d'emplacement.....	8
Electrical Requirements.....	4	Spécifications électriques.....	10
INSTALLATION INSTRUCTIONS.....	5	INSTRUCTIONS D'INSTALLATION.....	11
Spacer Kit Installation.....	5	Installation de la trousse d'entretoise.....	11
Prepare Built-In Microwave Oven.....	5	Préparation du four à micro-ondes encastré.....	11
Make Electrical Connection.....	6	Raccordement électrique.....	11
Install Microwave Oven.....	6	Installation du four à micro-ondes.....	12
Complete Installation.....	7	Achever l'installation.....	13

IMPORTANT:
Save for local electrical inspector's use.

IMPORTANT:
À conserver pour consultation par l'inspecteur local des installations électriques.

W11235626A

LOT: 17 THAMES PH: 4 B
RE: BUILT IN WAL OVEN
AND MICRO. SPEC'S.

NOV 16 2020

4B-17

Indis it Smith Personal
Sonoff for personal

BUILT-IN MICROWAVE OVEN SAFETY

Your safety and the safety of others are very important.

We have provided many important safety messages in this manual and on your appliance. Always read and obey all safety messages.



This is the safety alert symbol.

This symbol alerts you to potential hazards that can kill or hurt you and others.

All safety messages will follow the safety alert symbol and either the word "DANGER" or "WARNING."

These words mean:

⚠ DANGER

You can be killed or seriously injured if you don't immediately follow instructions.

⚠ WARNING

You can be killed or seriously injured if you don't follow instructions.

All safety messages will tell you what the potential hazard is, tell you how to reduce the chance of injury, and tell you what can happen if the instructions are not followed.

LOT: 17 THAMES PH: 4 B
RE: BUILT IN WAL OVEN
AND MICRO. SPEC'S.

Inds. int. Singh Punjab
Sensit pour pannel.

INSTALLATION REQUIREMENTS

Tools and Parts

Gather the required tools and parts before starting installation. Read and follow the instructions provided with any tools listed here.

- Tools Needed**

 - Phillips screwdriver
 - Flat-blade screwdriver
 - Measuring tape
 - Level
- Drill (for wall cabinet installations)
 - 1/8" (3 mm) drill bit (for wall cabinet installations)
 - 1" (2.5 cm) drill bit (for wall cabinet installations)

- Parts Needed**
- UL listed or CSA approved conduit connector
 - UL listed wire connectors

- Parts Needed – Flush Installation**
- W10801485 Stainless steel flush installation kit for 27" (68.6 cm) models
 - W10801486 Stainless steel flush installation kit for 30" (76.2 cm) models
 - W10801487 Black flush installation kit for 30" (76.2 cm) models

To order, see the "Assistance or Service" section of the Use and Care Guide.

Parts Supplied



- A. Spacer bars (2)
- B. Bottom vent (1)
- C. 3/8" (9.5 mm) hex-head washer screws (4)
- D. 3/4" (1.9 cm) pan-head screws (4)

Check local codes. Check existing electrical supply. See "Electrical Requirements."

It is recommended that all electrical connections be made by a licensed, qualified electrical installer.

Location Requirements

- IMPORTANT:** Observe all governing codes and ordinances.
- Cabinet opening dimensions that are shown must be used. Given dimensions provide minimum clearance with microwave oven.
 - Recessed installation area must provide complete enclosure around the recessed portion of the microwave oven.
 - Grounded electrical supply is required. See "Electrical Requirements" section.
 - Electrical supply junction box should be located 3" (7.6 cm) maximum below the support surface when the microwave oven is installed in a wall cabinet. A 1" (2.5 cm) minimum diameter hole should have been drilled in the left rear corner of the support surface to pass the appliance cable through to the junction box.

- For installation above single built-in oven, the junction box must be located inside upper cabinet.
- If you are installing the junction box on rear wall behind the microwave oven, the junction box must be recessed and located in the upper or lower right or left corner of the cabinet; otherwise, the microwave oven will not fit into the cabinet opening.
- Microwave oven support surface must be solid, level, and flush with bottom of cabinet cutout. Floor must be able to support a weight of 108 lbs (49.0 kg).

IMPORTANT: To avoid damage to your cabinets, check with your builder or cabinet supplier to make sure that the materials used will not discolor, delaminate, or sustain other damage. This oven has been designed in accordance with the requirements of UL and CSA International and complies with the maximum allowable wood cabinet temperatures of 194°F (90°C).

Product Dimensions

27" (68.6 cm) and 30" (76.2 cm) Microwave Ovens

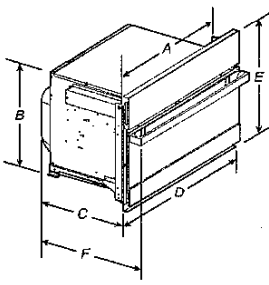

- 27" (68.6 cm) models**

 - A. 25 1/4" (64.5 cm)
 - B. 17 1/4" (44.1 cm)
 - C. 22 1/4" (57.7 cm)
 - D. 26 1/4" (68.0 cm) overall width
 - E. 19 1/4" (50.3 cm) overall height
 - F. JMC2427MA: 25 1/4" (64.9 cm)
JMC2427IL: 24 1/4" (62.9 cm)
- 30" (76.2 cm) models**

 - A. 28 1/4" (72.1 cm)
 - B. 17 1/4" (44.1 cm)
 - C. 26 1/4" (67.7 cm)
 - D. 29 1/4" (75.6 cm) overall width
 - E. 19 1/4" (50.3 cm) overall height
 - F. JMC2430MA: 25 1/4" (64.9 cm)
JMC2430IL: 24 1/4" (62.9 cm)

27" (68.6 cm) and 30" (76.2 cm) Microwave Oven Spacer Kit

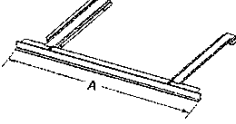

- 27" (68.6 cm) models**

 - A. 26 1/4" (67.9 cm) overall width
- 30" (76.2 cm) models**

 - A. 29 1/4" (75.6 cm) overall width

NOTE: The microwave oven spacer kit will allow the microwave oven to be installed in a 17 1/4" to 17 3/4" (44.1 to 45.1 cm) maximum cutout height.

LOT: 17 THAMES PH: 4 B
RE: BUILT IN WAL OVEN
AND MICRO. SPEC'S.

NOV 16 2020

4B-17

Indrajit Singh Puriel
Sarbat Kaur Puriel

A microwave oven spacer kit is available from your dealer that will allow the microwave oven to be installed in a 19" to 19 1/2" (48.3 to 50.2 cm) maximum cutout height. Match the oven size to the following kits:

- 27" (68.6 cm) Stainless Steel - Model W10469901
- 30" (76.2 cm) Stainless Steel - Model W10469903

To order, see the "Assistance or Service" section of the Use and Care Guide.

Cabinet Dimensions

27" (68.6 cm) and 30" (76.2 cm) Microwave Ovens

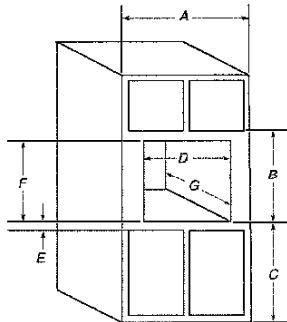

- | | |
|---|---|
| 27" (68.6 cm) models | 30" (76.2 cm) models |
| A. 27" (68.6 cm) min. cabinet width | A. 30" (76.2 cm) min. cabinet width |
| B. 19 1/2" (50.3 cm) from bottom of cutout to bottom of upper cabinet door | B. 19 1/2" (50.3 cm) from bottom of cutout to bottom of upper cabinet door |
| C. 40" (101.6 cm) bottom of cutout to floor (recommended) | C. 40" (101.6 cm) bottom of cutout to floor (recommended) |
| D. 25 1/2" (64.8 cm) cutout width | D. 25 1/2" (64.8 cm) cutout width |
| E. 1 1/2" (3.8 cm) min. bottom of cutout to top of cabinet door | E. 1 1/2" (3.8 cm) min. bottom of cutout to top of cabinet door |
| F. 17 1/2" (44.7 cm) recommended cutout height (will fit cutout height from 17 1/2" (44.1 cm) to 17 3/4" (45.1 cm)) | F. 17 1/2" (44.7 cm) recommended cutout height (will fit cutout height from 17 1/2" (44.1 cm) to 17 3/4" (45.1 cm)) |
| G. 21 1/2" (55.6 cm) min. cutout depth | G. 21 1/2" (55.6 cm) min. cutout depth |

Minimum Installation Clearances

For proper installation, the following minimum clearances must exist above and below the cabinet opening.

Installation Above Single Built-in Oven

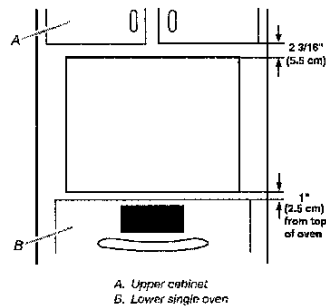

Electrical Requirements

GROUNDING INSTRUCTIONS

For a permanently connected microwave oven:

The microwave oven must be connected to a grounded, metallic, permanent wiring system, or an equipment grounding conductor should be run with the circuit conductors and connected to the equipment grounding terminal or lead on the microwave oven.

SAVE THESE INSTRUCTIONS

If codes permit and a separate ground wire is used, it is recommended that a qualified electrical installer determine that the ground path and wire gauge are in accordance with local codes.

Check with a qualified electrical installer if you are not sure the oven is properly grounded.

This oven must be connected to a grounded metal, permanent wiring system.

Be sure that the electrical connection and wire size are adequate and in conformance with the National Electrical Code, ANSI/NFPA 70 - latest edition or CSA Standards C22.1-94, Canadian Electrical Code, Part 1 and C22.2 No. 0-M91 - latest edition, and all local codes and ordinances.

A copy of the above code standards can be obtained from:

National Fire Protection Association
1 Batterymarch Park
Quincy, MA 02169-7471
CSA International
8501 East Pleasant Valley Road
Cleveland, OH 44131-5575

Electrical Connection

To properly install your microwave oven, you must determine the type of electrical connection you will be using and follow the instructions provided for it here.

LOT: 17 THAMES PH: 4 B
RE: BUILT IN WAL OVEN
AND MICRO. SPEC'S.

Indrajit Singh Puriwal
Sarbast kaur puriwal

- Microwave oven must be connected to the proper electrical voltage and frequency as specified on the model/serial/rating plate. The model/serial/rating plate is located underneath the control panel along the oven vent.

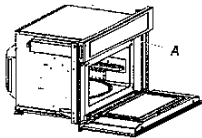

A. Model/serial/rating plate

- The microwave oven rated 120/240 V, 20 A, has 4 wires (L1, L2, N, and G) in the flex conduit, and should be connected to a 20 A maximum-rated circuit, overcurrent protected on both the L1 and L2 circuits.
- A time-delay fuse or circuit breaker is recommended.
- Flexible cable from the microwave oven should be connected directly to the junction box.

- Do not cut the conduit. The length of conduit provided is for serviceability of the microwave oven.

- A UL listed or CSA approved conduit connector must be provided.

- If the house has aluminum wiring, follow the procedure below:

Connect the aluminum wiring using special connectors and/or tools designed and UL listed for joining copper to aluminum.

Follow the electrical connector manufacturer's recommended procedure. Aluminum/copper connection must conform with local codes and industry accepted wiring practices.

For power requirements, refer to the following table:

Voltage	Microwave With Convection Oven
120/240 VAC	15 A
120/208 VAC	15 A

INSTALLATION INSTRUCTIONS

Spacer Kit Installation

NOTES:

- The microwave oven spacer kit allows the microwave oven to be installed in an 17¹¹/₁₆" to 17⁷/₈" (44.1 cm to 45.3 cm) maximum cutout height.
- If your cabinet cutout height is more than 17⁷/₈" (44.1 cm), you must install the spacer kit. Proceed to "Assemble Spacer Kit."
- If your cabinet cutout height is less than 17¹¹/₁₆" (44.1 cm), you do not have to install the spacer kit. Proceed to "Prepare Built-In Microwave Oven."

Assemble Spacer Kit

1. Attach the bottom vent to spacer bars using four 3/8" (9.5 mm) hex-head washer screws.

NOTE: Spacer bar flanges should be facing out.

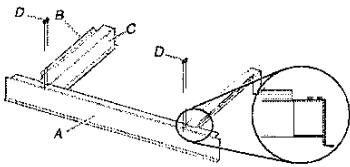

A. Bottom vent
B. Spacer bar flange
C. Spacer bars
D. 3/8" (9.5 mm) hex-head washer screws

Install Spacer Kit

1. Center assembled microwave oven spacer kit against lower front edge of the cabinet cutout.
2. Using an 1/8" (3.2 mm) drill bit, drill through the mounting holes in the spacer bars to create pilot holes.

3. Attach the assembled spacer kit to the cabinet using four 3/4" (1.9 cm) flat-head screws. Do not overtighten screws.

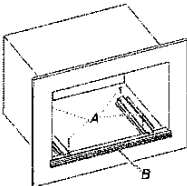

A. 3/4" (1.9 cm) flat-head screws
B. Spacer kit assembly

Prepare Built-In Microwave Oven

1. Locate existing wiring to avoid drilling into or severing wiring during installation.

⚠ WARNING

Excessive Weight Hazard

Use two or more people to move and install microwave oven.

Failure to do so can result in back or other injury.

2. To avoid floor damage, set the microwave oven onto cardboard prior to installation. Do not use handle or any portion of the front frame for lifting.
3. Remove the shipping materials and tape from the microwave oven.
4. Remove and set aside racks and other items from inside the microwave oven.
5. Remove the hardware package from inside the bag containing literature.
6. Move the microwave oven and cardboard close to the microwave oven's final location.

4B-17

LOT: 17 THAMES PH: 4 B
RE: BUILT IN WAL OVEN
AND MICRO. SPEC'S.

NOV 16 2020

Ink at Smith Personal
Sansit keur personal

Make Electrical Connection

⚠ WARNING



Electrical Shock Hazard

Disconnect power before servicing.
Use 12 gauge copper wire.
Electrically ground oven.
Failure to follow these instructions can result in death, fire, or electrical shock.

The microwave oven is manufactured with a neutral (white) power supply wire and a cabinet-connected green (or bare) ground wire.

1. Disconnect power.
2. Feed the flexible conduit from the microwave oven through the opening in the cabinet.
3. Remove junction box cover if it is present.
4. Install a UL listed or CSA approved conduit connector to the junction box.

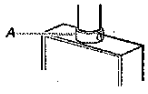

A. UL listed or CSA approved conduit connector

5. Route the flexible conduit from the microwave oven to the junction box through a UL listed or CSA approved conduit connector.
6. Tighten screws on conduit connector.
7. Complete electrical connection.

3-Wire Cable with Ground from Home Power Supply to Microwave Oven Cable with 4 Wires

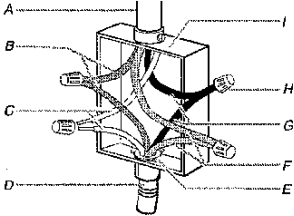

A. Cable from home power supply
B. Green (or bare) wires
C. White wires
D. 4-wire cable from microwave oven
E. UL listed or CSA approved conduit connector
F. Red wires
G. Black wires
H. UL listed wire connector
I. Junction box

1. Connect the 2 black wires (G) together using a UL listed wire connector.
2. Connect the 2 white wires (C) using a UL listed wire connector.
3. Connect the 2 red wires (F) together using a UL listed wire connector.
4. Connect the 2 green (or bare) wires (B) together using a UL listed wire connector.
5. Install junction box cover.

Install Microwave Oven

1. Using 2 or more people, lift the microwave oven partially into the cabinet cutout. If a spacer kit has been installed, lift the microwave oven over it and position the microwave oven between the guide strips.

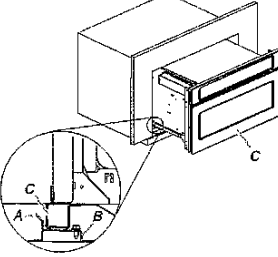

A. Spacer bar flange
B. Spacer bar
C. Microwave oven

LOT: 17 THAMES PH: 4 B
RE: BUILT IN WAL OVEN
AND MICRO. SPEC'S.

Indezel Singh Parnal
Sansit kar parnal

2. Push against the front frame of the microwave oven to insert oven into cabinet. Push microwave oven completely into cabinet and center in cabinet cutout.
NOTE: Open microwave oven door and push against seal area of microwave oven front frame when pushing microwave oven into cabinet. Do not push against outside edges.

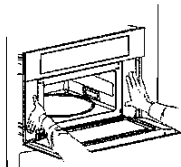

3. Using an 1/8" (3.2 mm) drill bit, predrill pilot holes through the mounting rails on each side of the microwave oven.
4. Securely fasten microwave oven to cabinet using two 3/4" (1.9 cm) flat-head screws provided. Insert the screws through holes in mounting rails. Do not overtighten screws.

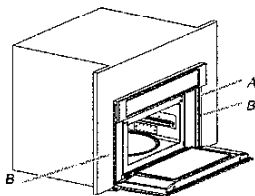

A. Mounting rail
B. Flat-head screws

5. Replace convection grid, turntable, and support hub.
6. Reconnect power.
7. Display panel will light briefly and the clock should appear in the display.
8. If display panel does not light, please reference the "Assistance or Service" section of the Use and Care Guide or contact the dealer from whom you purchased your microwave oven.

Complete Installation

1. Check that all parts are now installed. If there is an extra part, go back through the steps to see which step was skipped.
2. Check that you have all of your tools.
3. Dispose of/recycle all packaging materials.
4. For microwave oven use and cleaning, read the Use and Care Guide.

Check Operation of Microwave Oven

1. Fill a microwave-safe container with 1 cup (250 mL) of water and place container on the turntable inside the microwave oven. Close door firmly.
2. Touch COOK.
3. Set power level, temperature, and cook time to "2:00" minutes.
4. Press START.

If microwave oven does not operate, check the following:

- Household fuse is intact and tight or circuit breaker has not tripped.
- Electrical supply is connected.
- See "Troubleshooting" section in the Use and Care Guide.

When the display reads "1:00" minute, open the microwave oven door. The microwave oven should stop cooking. Close door firmly. The interior microwave oven light should turn off.

5. Touch START to resume a preset cycle. The microwave oven should begin cooking and the microwave oven interior light should be ON.
- Let microwave oven complete cooking time. Tones will sound at the end of the cooking time and the microwave oven will shut off.
6. Open microwave oven door and slowly remove container. Water in container should be hot.
7. To set the clock and other microwave oven functions, refer to the Use and Care Guide.

If you need Assistance or Service:

Please reference the "Assistance or Service" section of the Use and Care Guide or contact the dealer from whom you purchased your built-in microwave oven.

LOT: 17 THAMES PH: 4 B
RE: BUILT IN WAL OVEN
AND MICRO. SPEC'S.

NOV 16 2020

Indur zit Smth Panel
Sansit fair purnal

JENNAIR® DETAILED PLANNING DIMENSIONS 1 of 2

SINGLE WALL OVENS
JW24271 – 27" x 29-7/8" x 25-5/16"
JW24301, JW34301 – 30" x 29-7/8" x 25-5/16"

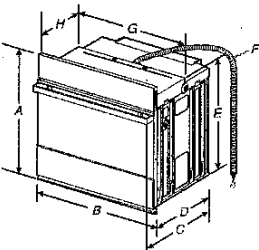

PRODUCT DIMENSIONS SINGLE OVENS	
27" (68.6 CM) MODELS	30" (76.2 CM) MODELS
A. 29-7/8" (75.8 cm) max. overall height	A. 29-7/8" (75.8 cm) max. overall height
B. 27" (68.6 cm) overall width	B. 30" (76.2 cm) overall width
C. JW24271M – 26-3/8" (67 cm) JW24271L – 27-3/16" (69 cm)	C. JW24301M – 26-3/8" (67 cm) JW24301L – 27-3/16" (69 cm) JW34301M – 26-3/8" (67 cm) JW34301L – 27-3/16" (69 cm)
D. 23-1/4" (59.1 cm) max. recessed depth	D. 23-1/4" (59.1 cm) max. recessed depth
E. 27-3/16" (69 cm) recessed height	E. 27-3/16" (69 cm)
F. 48" (121.9 cm) flexible conduit length	F. 48" (121.9 cm) flexible conduit length
G. 25-7/16" (64.6 cm) max. recessed width	G. 26-7/16" (72.2 cm) max. recessed width
H. 12" (30.5 cm) from back of control panel to start of strain relief	H. 12" (30.5 cm) from back of control panel to start of strain relief

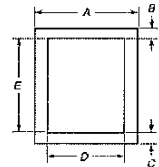

UNDERCOUNTER CABINET DIMENSIONS SINGLE OVENS	
27" (68.6 CM) MODELS	30" (76.2 CM) MODELS
A. 27" (68.6 cm) min. cabinet width	A. 30" (76.2 cm) min. cabinet width
B. 1-1/2" (3.8 cm) min. top of cutout to underside of countertop	B. 1-1/2" (3.8 cm) min. top of cutout to underside of countertop
C. 5-1/4" (13.3 cm) bottom of cutout to floor	C. 5-1/4" (13.3 cm) bottom of cutout to floor
D. 26-1/2" (64.8 cm) cutout width	D. 26-1/2" (72.4 cm) cutout width
E. 28" (71.2 cm) min. cutout height	E. 28" (71.2 cm) min. cutout height

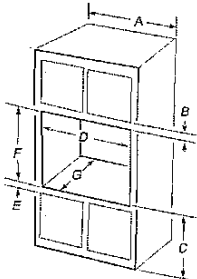

SINGLE OVENS INSTALLED IN CABINET	
27" (68.6 CM) MODELS	30" (76.2 CM) MODELS
A. 27" (68.6 cm) min. cabinet width	A. 30" (76.2 cm) min. cabinet width
B. 2-3/16" (5.5 cm) top of cutout to bottom of upper cabinet door	B. 2-3/16" (5.5 cm) top of cutout to bottom of upper cabinet door
C. 32" (81.3 cm) bottom of cutout to floor	C. 32" (81.3 cm) bottom of cutout to floor
D. 26-1/2" (64.8 cm) cutout width	D. 26-1/2" (72.4 cm) cutout width
E. 1-1/2" (3.8 cm) min. bottom of cutout to top of cabinet door	E. 1-1/2" (3.8 cm) min. bottom of cutout to top of cabinet door
F. 28" (71.2 cm) recommended cutout height	F. 28" (71.2 cm) recommended cutout height
G. 24" (60.7 cm) cutout depth	G. 24" (60.7 cm) cutout depth
*NOTE: The cutout height can be between 27-1/4" (69.2 cm) and 29-7/16" (74.8 cm) for 27" single ovens.	*NOTE: The cutout height can be between 27-1/4" (69.2 cm) and 29-7/16" (74.8 cm) for 30" single ovens.

IMPORTANT: Dimensional specifications are provided for planning purposes only. Do not make any cutouts based on this information. Refer to the Installation or Use & Care Guide before selecting cabinetry, verifying electrical/gas connections, making cutouts or beginning installation. All JennAir® appliances are appropriately UL, CUL or CSA approved.



LOT: 17 THAMES PH: 4 B
RE: BUILT IN WAL OVEN
AND MICRO. SPEC'S.

NOV 16 2020

Indle n/ Singh Purnel
Sansit bey purnel

JENNAIR® DETAILED PLANNING DIMENSIONS

2 of 2

SINGLE WALL OVENS

JJW24271-27" x 24 7/8" x 25 5/16"

JJW24301, JJW34301-30" x 24 7/8" x 25 5/16"

ELECTRICAL REQUIREMENTS

If codes permit and a separate ground wire is used, it is recommended that a qualified electrical installer determine that the ground path and the wire gauge are in accordance with local codes.

Check with a qualified electrical installer if you are not sure the oven is properly grounded.

This oven must be connected to a grounded metal, permanent wiring system.

Be sure that the electrical connection and wire size are adequate and in conformance with the National Electrical Code, ANSI/NFPA 70-latest edition or CSA Standards C22.1-94, Canadian Electrical Code, Part 1 and C22.2 No. 0-M51-latest edition, and all local codes and ordinances.

A copy of the above code standards can be obtained from:

National Fire Protection Association
1 Batterymarch Park
Quincy, MA 02169-7471
CSA International
8801 East Pleasant Valley Road
Cleveland, OH 44131-5575

- Models rated from 7.3 to 9.6 kW at 240 V (5.4 to 7.4 kW at 208 V) require a separate 40 A circuit. Models rated at 4.8 kW and below at 240 V (3.5 kW and below at 208 V) require a separate 20 A circuit.
- A circuit breaker is recommended.
- Connect directly to the circuit breaker box (or fused disconnect) through flexible, armored, or non-metallic sheathed, copper cable (with grounding wire).
- Flexible conduit from the oven should be connected directly to the junction box.
- Use both sides of the line.
- Do not cut the conduit. The length of conduit provided is for serviceability of the oven.
- A UL listed or CSA approved conduit connector must be provided.
- If the house has aluminum wiring, follow the procedure below:
Connect the aluminum wiring using special connectors and/or tools designed and UL listed for joining copper to aluminum. Follow the electrical connector manufacturer's recommended procedure. Aluminum/copper connection must conform with local codes and industry accepted wiring practices.

For power requirements for models JJW24271, JJW24301 and JJW34301, refer to the following table.

MODEL	240 VAC	208 VAC
	kW	kW
JJW24271	4.1	3.1
JJW24301	4.1	3.1
JJW34301	4.5	3.4

ELECTRICAL CONNECTION

To properly install your oven, you must determine the type of electrical connection you will be using and follow the instructions provided for it here.

- Oven must be connected to the proper electrical voltage and frequency as specified on the model/serial/rating plate. The model/serial/rating plate is located under the control panel on single ovens. See the following illustration.

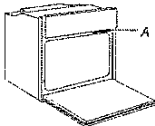

A. Model/Serial/Rating Plate

IMPORTANT: Dimensional specifications are provided for planning purposes only. Do not make any cutouts based on this information. Refer to the Installation or Use & Care Guide for selecting cabinetry, verifying electrical/gas connections, making cutouts or beginning installation. All JennAir® appliances are appropriately UL, CUL or CSA approved.

