

Kingsmen (Thames) Inc. / Havelock Corners (Kingsmen)

**Lot/Unit: 19 Phase/Building: 4B Model/Floor Plan: Windsor(6003)Elev B OPT GRND 5
BED-INLAW-6+1 BATH**

CABINETRY

Inv. 4736 Line 61437 1Sep20 / 18Nov20	1 - To supply & install STACKED uppers to the kitchen and servery area, standard upper cabinets may need to be reduced to accomodate this upgrade. ... see colour chart for detials... See sketch Note:	
Inv. 4736 Line 61438 1Sep20 / 18Nov20	1 - To supply & install a Fascia above the upgrades stacked uppers to cover 10" deep bulk head in the kitchen and servery area. Note:	
Inv. 4736 Line 61439 1Sep20 / 18Nov20	3 - To supply & install CROWN MOULDING at top of Facia at ceiling area for the kitchen and servery area... Note:	
Inv. 4736 Line 61524 1Sep20 / 18Nov20	1 - To accomodate for built in refrigerator with integrated or flush installation (typically the door of this unit will be inline/flush with adjoining cabinetry, therefore blending in. Grill or vent is not visible (Decorative pannel NOT included) Note: See spec's see sketch # 1	
Inv. 4736 Line 61676 1Sep20 / 18Nov20	3 - To supply & install three dummy door's in the kitchen ... see sketch Note:	
Inv. 4736 Line 61976 1Sep20 / 18Nov20	1 - Reduce the width of the upper cabinets on either side of the upgraded 48" Hood fan, to clear approx. 9-12" ... see sketch #1A Note:	

CABINETRY ACCESSORIES

Inv. 4736 Line 61440 1Sep20 / 18Nov20	3 - To supply & install the LIGHT VALANCE -LIGHT VALANCE IS NOW APPROXIMATELY 2INCHES 50MM HIGH - CLASSIC SERIES in the kitchen and servery area. Note: NO ROUGH IN WIRES OR LIGHTS HAVE BEEN PURCHASED.	
---	--	--

CABINETRY BASE CABINETS

Inv. 4736 Line 61441 1Sep20 / 18Nov20	1 - To supply & install BANK OF DRAWERS CABINET (includes soft close) - approx. 40 cm + - wide (same size of the standard bank of drawers) - SIZE SUBJECT TO FLOOR PLAN - CLASSIC SERIES in the kitchen.... see sketch # 1 Note:	
Inv. 4736 Line 61442 1Sep20 / 18Nov20	2 - To supply & install TWO sets of POTS & PANS DRAWERS - MINIMUM 60 CM - MAXIMUM 90 CM - SIZE SUBJECT TO FLOOR PLAN - (includes soft close) CLASSIC SERIES in the kitchen... see sketch # 1 Note:	

CABINETRY HARDWARE

Kingsmen (Thames) Inc. / Havelock Corners (Kingsmen)

**Lot/Unit: 19 Phase/Building: 4B Model/Floor Plan: Windsor(6003)Elev B OPT GRND 5
BED-INLAW-6+1 BATH**

Inv.4736	1 - DO NOT DRILL FOR HARDWARE - HARDWARE WILL NOT BE SUPPLIED OR CREDITED to the kitchen and servery cabinets.	
Line 61978	Note:	
1Sep20 / 18Nov20		

CABINETRY WALL AND HUTCH

Inv.4736	2 - To supply & install TWO GLASS DOOR - SPECIFY CLEAR GLASS - UNFINISHED CABINET INTERIOR - PRICED PER EACH - CLASSIC SERIES in the servery area off the kitchen... see sketch	
Line 61444	Note:	
1Sep20 / 18Nov20		
Inv.4736	2 - To supply & install TWO FINISHED - MATCHING INTERIOR PER CABINET - CLASSIC SERIES in the servery area... see skech	
Line 61445	Note:	
1Sep20 / 18Nov20		

COUNTER TOP

Inv.4736	1 - To supply & install the shower NICHE in the master ensuite in the IMPERIAL WHITE Quartz ... see sketch # 2	
Line 61451	Note:	
1Sep20 / 18Nov20		

DOORS AND WINDOWS

Inv.4736	1 - The vendor agrees to amend the front entry to include an 8 foot tall front door which is at least 40 inches in width. The vendor has complete design control as to the removal of all or one of the sidelights. Purchaser to select door from builders	
Line 61421	Note: provided samples at decor. Purchase price includes \$1,500 for this upgrade. Approved by vendor	
1Sep20 / 18Nov20		
Inv.4736	1 - Vendor has approved the deletion of door from covered Loggia to Opt. in law suite. Vendor will rplace door with a window. Dimentions of window to be at Vendors discretion. This will completed at no cost to purchaser.	
Line 61422	Note:	
1Sep20 / 18Nov20		

ELECTRICAL

Inv.4736	1 - To SUPPLY AND INSTALL AN EXTRA KITCHEN COUNTER 20AMP GFI RECEPTACLE at the island... install this additional receptacle next to + - the standard one at island.	
Line 61454	Note:	
1Sep20 / 18Nov20		
Inv.4736	1 - To SUPPLY AND INSTALL REINFORCING FOR A CEILING standard light at O.T.B. on the second floor at main stair case. ... see sketch # 2	
Line 61981	Note:	
1Sep20 / 18Nov20		
Inv.4736	1 - To supply & install the standard T.V. rough in in the great room and master bedroom... see sketch # 1 & # 2	
Line 61430	Note:	
1Sep20 / 18Nov20		

Kingsmen (Thames) Inc. / Havelock Corners (Kingsmen)

**Lot/Unit: 19 Phase/Building: 4B Model/Floor Plan: Windsor(6003)Elev B OPT GRND 5
BED-INLAW-6+1 BATH**

Inv. 4736 Line 61431 1Sep20 / 18Nov20	1 - To supply & install the Phone rough in (CAT 5) in the kitchen, library room and master bedroom... see sketch # 1 & # 2 Note:	
Inv. 4736 Line 61432 1Sep20 / 18Nov20	1 - To SUPPLY AND INSTALL AN ADDITIONAL BASIC RECEPTACLE (NOT DEDICATED) at approx. 66 " + - up from the floor centered + - to the F/P mantle Note: in the great room....See sketch # 1	
Inv. 4736 Line 61433 1Sep20 / 18Nov20	1 - To SUPPLY AND INSTALL CONDUIT FOR TV OVER THE FIREPLACE – TERMINATED IN SAME ROOM at approx. 66 " + - up from the floor next to + - the upgraded elec. outlet and terminated next to + - the standard T.V. rough in the great room..see sketch # 1 Note:	
Inv. 4736 Line 61436 1Sep20 / 18Nov20	1 - To supply & install a flush ceiling exterior light (rough in included) with a duel switch at Covered Loggia area at the back of the house... see sketch # 1 Note:	

HARDWOOD

Inv. 4736 Line 61480 1Sep20 / 18Nov20	1 - To supply & install the KENTWOOD PROGRESSIVES BRUSHED OAK 5" - - KITCHEN area in lieu of the standard tile... see colour chart for details. Note:	
Inv. 4736 Line 61481 1Sep20 / 18Nov20	1 - To supply & install the KENTWOOD PROGRESSIVES BRUSHED OAK 5" - SERVERY / PANTRY AREAS area in lieu of the standard tile... see colour chart for details. Note:	
Inv. 4736 Line 61482 1Sep20 / 18Nov20	1 - To supply & install the KENTWOOD PROGRESSIVES BRUSHED OAK 5" - BREAKFAST area in lieu of the standard tile... see colour chart for details. Note:	

HEATING AND AIR CONDITIONING

Inv. 4736 Line 61520 1Sep20 / 18Nov20	1 - To supply & install the CYCLONE PTB81248 (see spec's) with Flue PTB-D6.CH12 (chimney going all the way to the bulk head) above the future 48" gas stove... see spec's Note:	
Inv. 4736 Line 61521 1Sep20 / 18Nov20	1 - To accomodate for a future 48" range and hood fan... see range and hood fan spec's Note:	
Inv. 4736 Line 61523 1Sep20 / 18Nov20	1 - To supply & install a 3/4" gas rough in to the stove area to include a 110V elec. and to supply & install a 8" vent above the stove area to accomodate the upgraded 48" chimney hood... see spec's for stove and hood fan. Note:	

Kingsmen (Thames) Inc. / Havelock Corners (Kingsmen)

**Lot/Unit: 19 Phase/Building: 4B Model/Floor Plan: Windsor(6003)Elev B OPT GRND 5
BED-INLAW-6+1 BATH**

Inv.4736	1 - Vendor to install capped gas line (rough in only) at rear of home for future BBQ locaion. Location to be finialized at vendors sole discretion.	
Line 61419	Note:	
1Sep20 / 18Nov20		
Inv.4736	1 - Vendor to supply & install air conditioning unit, sized accordingly, from vendors standard samples.	
Line 61420	Note:	
1Sep20 / 18Nov20		
Inv.4736	1 - To supply & install the HUMMIDIFIER to the furnace	
Line 61425	Note:	
1Sep20 / 18Nov20		

MISCELLANEOUS

Inv.4736	1 - Remove the door and shelves to the WALK IN PANTRY off the kitchen/serery area.... see sketch # 1	
Line 61427	Note:	
1Sep20 / 18Nov20		
Inv.4736	1 - "Vendor agrees to delete the bathtub in optioan in law suite, on the main floor, and replace it with a walk in shower, finished the same level of finishes beign offered as standard, as per plan, in bedrooms 2,4 and 5 ensuite showers. See sketch	
Line 61423	Note: Vendor agrees to modify the optional in law suite ensuite at no charge to purchaser. All selection for finishes will be made at Decor as per Builders standard. " SKETCH, showing changes to optional in-law suite bathroom.	
1Sep20 / 18Nov20		
Inv.4736	1 - Do not supply or install the standard shelf and rod to the DRESSING ROOM in the master ensuite see sketch # 2	
Line 61977	Note:	
1Sep20 / 18Nov20		
Inv.4736	1 - Do not supply or install any towel bars, toilet paper holders or soap dishes throughout all bathrooms.	
Line 61979	Note:	
1Sep20 / 18Nov20		
Inv.4736	1 - Do not supply or install any of the standard mirrors throughout all the bathrooms.	
Line 61980	Note:	
1Sep20 / 18Nov20		

PLUMBING

Inv.4736	1 - To supply & install the WATERLINE ROUGH-IN TO THE FRIDGE LOCATION (NO HOOK UP) in the kitchen...	
Line 61428	Note:	
1Sep20 / 18Nov20		
Inv.4736	1 - To supply & install the MIROLIN "BROOKE" free standing tub in the master ensuite in lieu of the standard free standing tub... see spec's	
Line 61426	Note:	
1Sep20 / 18Nov20		

RAILING

Kingsmen (Thames) Inc. / Havelock Corners (Kingsmen)

Lot/Unit: 19 Phase/Building: 4B Model/Floor Plan: Windsor(6003)Elev B OPT GRND 5
BED-INLAW-6+1 BATH

Inv.4736	1 - To supply & install the upgraded POSTS 4 INCH PARIS, WITH 5 INCH BASE OAK throughout where applicable in lieu of the upgraded post(s) from the upg. 2 railing package.	
Line 61975	Note:	
1Sep20 / 18Nov20		

Inv.4736	1 - To supply & install the RAILING - UPGRADE 2 - METAL HANDRAIL WINDSOR IN OAK - PICKETS STEEL ½ INCH ROUND, SINGLE SPOON/PLAIN, WITH SHOES IN GUNMETAL - POSTS 3½ INCH SQUARE, CHAMFERED, WITH CAP OAK IN OAK in lieu of the standard picket and rails .	
Line 61479	Note: PURCHASER HAS UPGRADED THE POSTS OVER AND ABOVE THIS PACKAGE... SEE SEP. EXTRA	
1Sep20 / 18Nov20		

TILE - FLOOR

Inv.4736	1 - To supply & install the UPGRADE 3 - FLOOR TILE - - LAUNDRY TILE "STACKED" in lieu of the standard tile ... see sketch # 2 for installation direction... see colour chart for details.	
Line 61519	Note:	
1Sep20 / 18Nov20		

Inv.4736	1 - To install all upgraded floor tiles in a 70/30 Off set brick pattern to: Foyer, Powder room, Mud room, Master ensuite, Ens. #2, #3, #4, #5 and In-Law suite and laundry room where applicable...see sketch # 1	
Line 61982	Note:	
1Sep20 / 18Nov20		

Inv.4736	1 - To supply & install the UPGRADE 3 - FLOOR TILE - - FOYER TILE area in lieu of the standard floor tiles... see skech #1 for direction of tile installation... see colour chart for details.	
Line 61457	Note: Purchaser has upgraded to a pattern, see sep. upgrade	
1Sep20 / 18Nov20		

Inv.4736	1 - To supply & install the UPGRADE 3 - FLOOR TILE - MUD ROOM TILE area in lieu of the standard floor tiles... see skech #1 for direction of tile installation... see colour chart for details.	
Line 61458	Note: Purchaser has upgraded to a pattern, see sep. upgrade	
1Sep20 / 18Nov20		

Inv.4736	1 - To supply & install the UPGRADE 3 - FLOOR TILE - POWDER ROOM TILE area in lieu of the standard floor tiles... see skech #1 for direction of tile installation... see colour chart for details.	
Line 61459	Note: Purchaser has upgraded to a pattern, see sep. upgrade	
1Sep20 / 18Nov20		

Inv.4736	1 - To supply & install the UPGRADE 3 - FLOOR TILE - MASTER ENSUITE TILE area in lieu of the standard floor tiles... see skech #2 for direction of tile installation... see colour chart for details.	
Line 61461	Note: Purchaser has upgraded to a pattern, see sep. upgrade	
1Sep20 / 18Nov20		

Inv.4736	1 - To supply & install the UPGRADE 3 - FLOOR TILE - ENSUITE 2 TILE area in lieu of the standard floor tiles... see skech #2 for direction of tile installation... see colour chart for details.	
Line 61462	Note: Purchaser has upgraded to a pattern, see sep. upgrade	
1Sep20 / 18Nov20		

Kingsmen (Thames) Inc. / Havelock Corners (Kingsmen)

Lot/Unit: 19 Phase/Building: 4B Model/Floor Plan: Windsor(6003)Elev B OPT GRND 5
BED-INLAW-6+1 BATH

Inv.4736	1 - To supply & install the UPGRADE 3 - FLOOR TILE - ENSUITE 3 TILE area in lieu of the standard floor tiles... see skech #2 for direction of tile installation... see colour chart for details.	
Line 61463	Note: Purchaser has upgraded to a pattern, see sep. upgrade	
1Sep20 / 18Nov20		
Inv.4736	1 - To supply & install the UPGRADE 3 - FLOOR TILE - ENSUITE 4 TILE area in lieu of the standard floor tiles... see skech #2 for direction of tile installation... see colour chart for details.	
Line 61464	Note: Purchaser has upgraded to a pattern, see sep. upgrade	
1Sep20 / 18Nov20		
Inv.4736	1 - To supply & install the UPGRADE 3 - FLOOR TILE - ENSUITE 5 TILE area in lieu of the standard floor tiles... see skech #2 for direction of tile installation... see colour chart for details.	
Line 61465	Note: Purchaser has upgraded to a pattern, see sep. upgrade	
1Sep20 / 18Nov20		
Inv.4736	1 - To supply & install the UPGRADE 3 - FLOOR TILE - IN-LAW SUITE TILE area in lieu of the standard floor tiles... see skech #1 for direction of tile installation... see colour chart for details.	
Line 61467	Note: Purchaser has upgraded to a pattern, see sep. upgrade	
1Sep20 / 18Nov20		
Inv.4736	1 - To supply & install the UPGRADE 2 - SHOWER FLOOR TILE - MASTER ENSUITE SHOWER FLOOR TILE **2X2" Mayfair Statuario Venato HD basket weave mosaic to the shower floor in lieu of the standard shower floor tiles.	
Line 61468	Note:	
1Sep20 / 18Nov20		
Inv.4736	1 - To supply & install the UPGRADE 2 - SHOWER FLOOR TILE - ENSUITE 2 SHOWER FLOOR TILE **2X2" Mayfair Suave Bianco HD basket weave mosaic to the shower floor in lieu of the standard shower floor tiles.	
Line 61469	Note:	
1Sep20 / 18Nov20		
Inv.4736	1 - To supply & install the UPGRADE 2 - SHOWER FLOOR TILE - ENSUITE 4 SHOWER FLOOR TILE **2X2" Mayfair Stella Argento HD basket weave mosaic to the shower floor in lieu of the standard shower floor tiles.	
Line 61470	Note:	
1Sep20 / 18Nov20		
Inv.4736	1 - To supply & install the UPGRADE 2 - SHOWER FLOOR TILE - ENSUITE 5 SHOWER FLOOR TILE **2X2" Mayfair Statuario Venato HD basket weave mosaic to the shower floor in lieu of the standard shower floor tiles.	
Line 61471	Note:	
1Sep20 / 18Nov20		
Inv.4736	1 - To supply & install the UPGRADE 2 - SHOWER FLOOR TILE - IN-LAW SUITE SHOWER FLOOR TILE **2X2" Mayfair Calcatta Oro HD Basket weave mosaic to the shower floor in lieu of the standard shower floor tiles.	
Line 61472	Note:	
1Sep20 / 18Nov20		

TILE - WALL

Kingsmen (Thames) Inc. / Havelock Corners (Kingsmen)

Lot/Unit: 19 Phase/Building: 4B Model/Floor Plan: Windsor(6003)Elev B OPT GRND 5
BED-INLAW-6+1 BATH

Inv.4736	1 - To supply & install the Upg. 3 floor tiles to the master ensuite shower walls and ceiling where applicable in lieu of the standard wall tiles.... see sketch # 2 for direction of tile.... see colour chart for details.	
Line 61473	Note: Purchaser has upgraded to a pattern, see sep. upgrade.	
1Sep20 / 18Nov20		
Inv.4736	1 - To supply & install the Upg. 3 floor tiles to the Ensuite # 2's shower walls and ceiling where applicable in lieu of the standard wall tiles.... see sketch # 2 for direction of tile.... see colour chart for details.	
Line 61474	Note: Purchaser has upgraded to a pattern, see sep. upgrade	
1Sep20 / 18Nov20		
Inv.4736	1 - To supply & install the Upg. 3 floor tiles to the ENS. 3's bathtub walls and ceiling where applicable in lieu of the standard wall tiles.... see sketch # 2 for direction of tile.... see colour chart for details.	
Line 61475	Note: Purchaser has upgraded to a pattern, see sep. upgrade	
1Sep20 / 18Nov20		
Inv.4736	1 - To supply & install the Upg. 3 floor tiles to the ENS. #4's shower walls and ceiling where applicable in lieu of the standard wall tiles.... see sketch # 2 for direction of tile.... see colour chart for details.	
Line 61476	Note: Purchaser has upgraded to a pattern, see sep. upgrade	
1Sep20 / 18Nov20		
Inv.4736	1 - To supply & install the Upg. 3 floor tiles to the Ens. #5's shower walls and ceiling where applicable in lieu of the standard wall tiles.... see sketch # 2 for direction of tile.... see colour chart for details.	
Line 61477	Note: Purchaser has upgraded to a pattern, see sep. upgrade	
1Sep20 / 18Nov20		
Inv.4736	1 - To supply & install the Upg. 3 floor tiles to the In-law suite shower walls and ceiling where applicable in lieu of the standard wall tiles.... see sketch # 2 for direction of tile.... see colour chart for details.	
Line 61478	Note: Purchaser has upgraded to a pattern, see sep. upgrade	
1Sep20 / 18Nov20		
Inv.4736	1 - To install all upgraded wall tiles in a 70/30 Off set brick pattern to: Master ensuite, Ens. #2, #3, #4, #5 and In-Law suite where applicable...see sketch # 1	
Line 61983	Note:	
1Sep20 / 18Nov20		

TRIM

Inv.4736	1 - To supply & intall the DOOR LEVER - UPGRADE TO VEDANI PASSAGE LEVERS - SATIN NICKEL throughout in lieu of the standard interior handles TO INCLUDE Matching HINDGES	
Line 61453	Note:	
1Sep20 / 18Nov20		

Kingsmen (Thames) Inc. / Havelock Corners (Kingsmen)

Lot/Unit: 19 Phase/Building: 4B Model/Floor Plan: Windsor(6003)Elev B OPT GRND 5
BED-INLAW-6+1 BATH
EXTRAS AS PER OFFER

<div>VENDOR TO INSTALL CAPPED GAS LINE (ROUGH-IN ONLY) AT REAR OF HOME FOR FUTURE BBQ LOCATION. LOCATION TO BE FINALIZED AT VENDORS SOLE DISCRETION. <i>Worksheet</i> Note:</div>	
<div>VENDOR TO SUPPLY & INSTALL AIR CONDITIONING UNIT, SIZED ACCORDINGLY, FROM VENDORS STANDARD SAMPLES. <i>Worksheet</i> Note:</div>	
<div>5 FREE APPLIANCES ? STAINLESS STEEL FRONT - FRIDGE: STOVE AND DISHWASHER. WHITE WASHER AND DRYER (SUPPLIED ONLY, NOT INSTALLED, FROM BUILDERS STANDARD LINE) TO ARRANGE DELIVERY ? CALL THE BRICK COMMERCIAL SALES DIVISION AT 1-877-353-2850. <i>Worksheet</i> Note:</div>	
<div>The purchase price includes \$10,000 for the optional ground floor plan with bedroom on main <i>Worksheet</i> Note:</div>	
<div>The vendor agrees to amend the front entry to include an 8 foot tall front door which is at least 40 inches in width. The vendor has complete design control as to the removal of all or one of the sidelights. Purchaser to select door from builders provi <i>Worksheet</i> Note:</div>	
<div>Vendor has approved the deletion of door from covered Loggia to Optional In-law suite. Vendor will replace door with a window. Dimensions of window to be at Vendors discretion. This will completed at no cost to purchaser <i>Worksheet</i> Note:</div>	

NOV 18 2020

Purchasers: NAVDEEP SINGH DHALIWAL & AMARPREET K **Property:** 19 of Plan - Draft Approval SB17-03-08
Telephone Res. / Bus: / **Project:** Kingsmen (Thames) Inc.
Decor Advisor: Barbara Coccia **Model and Elevation:** Windsor(6003)Elev B OPT GRND 5 BED-I

Layout Changes: ☒ Yes ☐ No **Sketch Attached:** ☒ Yes ☐ No **Exterior Colour Scheme:**

1. Cabinetry

	Style and Colour	Counter Top	Hardware
Kitchen / Breakfast	#6 Manchester Paint Cannoli	#1, C/S # 9141 Ice Snow 3cm.	/
Kitchen Island	#6 Manchester Paint Cannoli	#1, C/S # 9141 Ice Snow 3cm.	/
Laundry Room	/	/	/
Powder Room	#6 Manchester Paint Cannoli	Inukshuk Taupe P-345-LM	Knob 135
Main Bathroom	In-law Suite: #6 Manchester Paint Winter WT.	Calcatta Marble 4925K-07	Knob 135
Master Ensuite Bathroom	& #5's BRM: #6 Manchestr Paint Winter White	Calcatta Marble 4925K-07	Knob 135
Second Ensuite Bathroom (If Applicable)	#6 Manchester Paint Cannoli	Calcatta Marble 4925K-07	Knob 135
Bed #3 Bathroom	#6 Manchester Paint Macadamia	Italian White Di Pesco 4954K-22	Knob 135
Bed #4's Bathroom	#6 Manchester Paint Winter White	Inukshuk Grey P-344-LM	Knob 135

Appliances

Custom Size Fridge <input checked="" type="radio"/> Yes <input type="radio"/> No	Valance Lighting <input checked="" type="radio"/> Yes <input type="radio"/> No	Microwave / Range Hood <input type="radio"/> Yes <input checked="" type="radio"/> No
Cooktop / Rangetop <input type="radio"/> Yes <input checked="" type="radio"/> No	Built in Wall Oven <input type="radio"/> Yes <input checked="" type="radio"/> No	Slide-in Range <input type="radio"/> Yes <input checked="" type="radio"/> No

Comment

2. Flooring

	Selection
Foyer	**Upg. 3, 12 x 24" Mayfair Calacatta Oro HD Polished Rect. Porcelain 70/30 off set brick
Main Hall	5" Elements Brushed Oak Cardinal
Back Hall	Bed.#4's BRM: **upg. 3, 12 x 24" Mayfair Stella Argento HD Polished Rect. Porcelain 70/30 off set
Breakfast	*5" Elements Brushed Oak Cardinal
Laundry Room	*upg. 3, 12 x 24" LaMarca Statyruetti Glazed Porcelain Rect. 70/30 off set
Kitchen	5" Elements Brushed Oak Cardinal (includes pantry and servery area)
Powder Room	**Upg. 3, 12 x 24" Mayfair Calacatta Oro HD Polished Rect. Porcelain 70/30 off set
Main Bathroom	2nd. BRM: **12 x 24" Mayfair Suave Bianco HD Polished Rect. Porcelain 70/30 off set
Master Ensuite	& #5's BRM: **Upg. 3, 12 x 24" Mayfair Statuario Venato HD Rect. Porcelain 70/30 off set
Bathroom (If Applicable)	In-law suite: **Upg. 3, 12 x 24" Mayfair Calacatta Oro HD Polished Rect. Porcelain 70/30 off set
Mud Room	**Upg. 3, 12 x 24" Mayfair Calacatta Oro HD Polished Rect. Porcelain 70/30 off set
Bed.# 3's bathroom	**upg. 3, 12 x 24" Mayfair Strada Ash HD Polished Rect. Porcelain 70/30 off set
Living Room	5" Elements Brushed Oak Cardinal
Dining Room	5" Elements Brushed Oak Cardinal
Family / Great Room	5" Elements Brushed Oak Cardinal
Den / Library / Study	5" Elements Brushed Oak Cardinal
Basement Landing (If Applies)	13 x 13" Keaton Ice
Lower Landing (If Applicable)	5" Elements Brushed Oak Cardinal
Upper Landing	5" Elements Brushed Oak Cardinal
Upper Hall	5" Elements Brushed Oak Cardinal
Master Bedroom	5" Elements Brushed Oak Cardinal
Bedroom #2	5" Elements Brushed Oak Cardinal
Bedroom #3	5" Elements Brushed Oak Cardinal
Bedroom #4	5" Elements Brushed Oak Cardinal
Bedroom #5	5" Elements Brushed Oak Cardinal
In-law Suite	5" Elements Brushed Oak Cardinal

Flooring Continued on Page 2

Initial:  

Page 1 of 3

Purchasers: NAVDEEP SINGH DHALIWAL & AMARPREET KProperty: 19 of Plan - Draft Approval SB17-03-08
Telephone Res. / Bus: / Project: Kingsmen (Thames) Inc.
Decor Advisor: Barbara Coccia Model and Elevation: Windsor(6003)Elev B OPT GRND 5 BED-I

2. Flooring - Continued -

Upgrade Underpad	Type	Area
Carpet on Stairs	Capped	Runner - *Upgrade
Comment		

See invoice for details on shower floors.
Shower jamb/sill for Master ensuite, bedrooms # 2, #4,#5 and in-law suite: Anatolia Marmiline SNOW

3. Plumbing Fixtures / Faucets

Kitchen	Standard	Second Ensuite	Standard	Powder Room	Standard
Master Ensuite	Standard			Other Room	
Main Bathroom		Bed.3,4,5,& In-law suite	Standard		

Comment
Still to install the standard under mount kitchen sink with single hole kitchen faucet.

4. Wall Tile

	Tile Selection	Listello	Insert	Insert Selection
Main Bathroom	Bed. 5'sBRM: ** SAME TILE AS MASTER ENSUITE	<input type="checkbox"/>	<input type="checkbox"/>	
Master Ensuite				
Tub Deck		<input type="checkbox"/>	<input type="checkbox"/>	
Tub Apron		<input type="checkbox"/>	<input type="checkbox"/>	
Tub Surround		<input type="checkbox"/>	<input type="checkbox"/>	
Shower Stall	*Upg.12 x 24"Mayfair StatuarioVenator HD Polished Rect.	<input type="checkbox"/>	<input type="checkbox"/>	
Second Ensuite	*Upg.12x24" Mayfair Suave Bianco HD Poished Rect.	<input type="checkbox"/>	<input type="checkbox"/>	
Bed. 3's bathroom	*Upg.12 x 24" Mayfair Strada Ash HD Polished Rect.	<input type="checkbox"/>	<input type="checkbox"/>	
Bed. #4's bathroom	*Upg. 12x24" Mayfair Stella Argento HD Polished Rect.	<input type="checkbox"/>	<input type="checkbox"/>	
Kitchen Backsplash		<input type="checkbox"/>	<input type="checkbox"/>	
Complete Backsplash		<input type="checkbox"/>	<input type="checkbox"/>	

Comment
In-law Suite: * Upg.12x24" Mayfair Calcatta Oro HD Polished Rect.
~~ALL WALL TILES ARE STACKED~~ see sketch for direction. ✓
ALL WALL TILES WHERE APPLICABLE WILL BE IN A 70/30 OFF SET PATTERN.

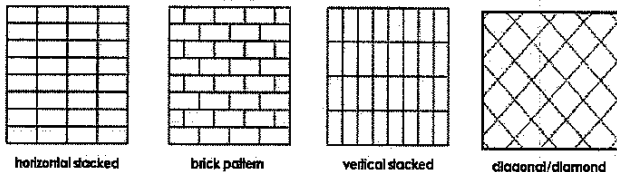

5. Fireplace

	Living Room	Family Room	Other Room - Specify
	Purchased As Per Plan N/A	Purchased As Per Plan N/A	Purchased As Per Plan N/A
Fireplace Type			Front Facing
Mantle Type			NF-08
Over Mantle			
Colour / Stain			White
Surround			
Hearth			
Comment			



Purchasers: NAVDEEP SINGH DHALIWAL & AMARPREET K **Property:** 19 of Plan - Draft Approval SB17-03-08
Telephone Res. / Bus: / **Project:** Kingsmen (Thames) Inc.
Decor Advisor: Barbara Coccia **Model and Elevation:** Windsor(6003)Elev B OPT GRND 5 BED-I

6. Trim Carpentry

Door Hardware **Upgrade... see invoice for details

Interior Trim Standard

Comment

Interior Doors

☐ 2 Panel Arch Top

☒ 2 Panel Square Top

☐ 6 Panel



Initial for Door Style

TD

AP

7. Railings and Pickets

Railing Package *Upg. 2 Metal Package

Railing Colour Elements Cardinal

Picket Colour Gun Metal

Wood Stairs ☐ No ☒ Oak

Tread Colour Elements Cardinal

Comment

** Purchaser has upgraded the POSTS from the upgrade 2 package, see invoice for details.

8. Plaster Mouldings and Medallions

Foyer

/

/

Kitchen/Breakfast

/

/

Main Hall

/

/

Den/Library

/

/

Living Room

/

/

Lower Landing

/

/

Dining Room

/

/

/

/

Family Room

/

/

/

/

Comment

9. Wall Paint

Kingsmen White

Smooth Ceilings

☐ First Floor

☐ First Floor incl. Second Floor Hall

☐ First and Second Floor

☒ Throughout

☐ Not Applicable

Trim Paint Kingsmen White

10. Additional Comments

11. Disclaimers and Notes

- Colours of all materials are as close as possible to builder's selection, but not necessarily identical due to variances in manufacturing.
- Any extras listed above are null and void unless accompanied by a separate invoice/amendment. Said invoice must be paid in full.
- The Purchaser acknowledges that after Interior Colour Selection form is signed and dated, no further changes will be permitted other than re-selection due to unavailability.  Purchaser's Initials
- The Purchaser acknowledges reading and accepting the "Kingsmen Group Décor Centre Disclaimers" form. This document contains other miscellaneous disclaimers.

This Interior Colour Selection is final and approved by:

Purchaser:

Signature: 

Date: 18 Nov 2020

Signature: 

Date: 11/18/20

Vendor:

Kingsmen (Thames) Inc.

Lot 19 Thames Ph. 4B
Sketch # 1

NOV 18 2020

Handwritten signature/initials

SCHEDULE "B-1"
Floor Plan

SKETCH (N) (B)
Model: Windsor(8003) Elev B OPT GRND 5 BED IN-LAW-6+1 BATH

Lot 19
Phase 4B

No door, Window (CAPS)

Standard Shower in view of included tub

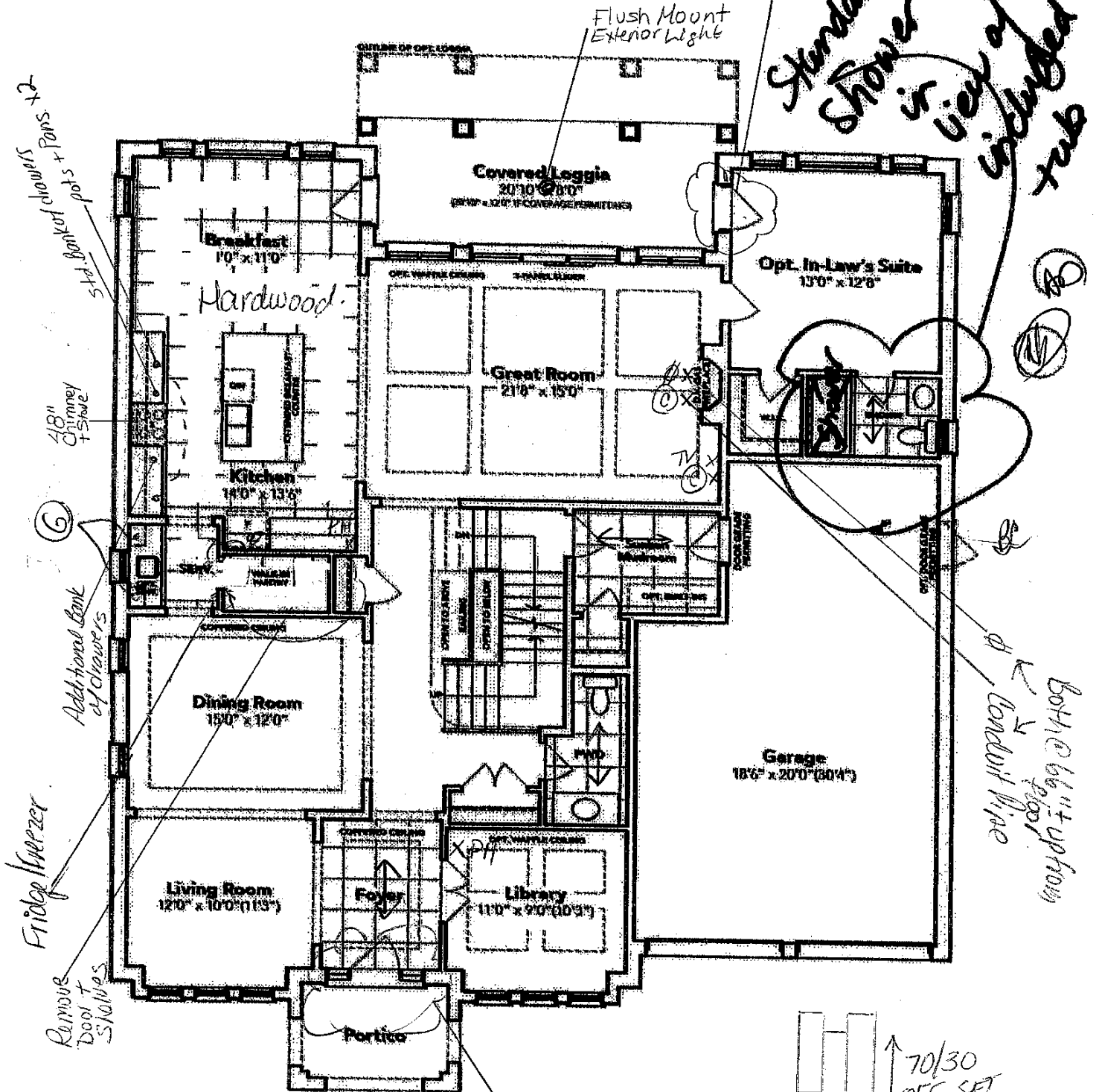

(G) = 2 glass doors Matching Interiors to Stacked Uppers.
(C) = Conduit Pipe.

Larger Door (CAPS)

70/30
OFF SET
BRICK PATTERN
NOT TO
SCALE.

NOV 18 2020

LOT 19 THAMES PH. 4 B
RE: 3D KITCHEN SKETCH "A"

Amel
Amel

Kitchen - LOT 19

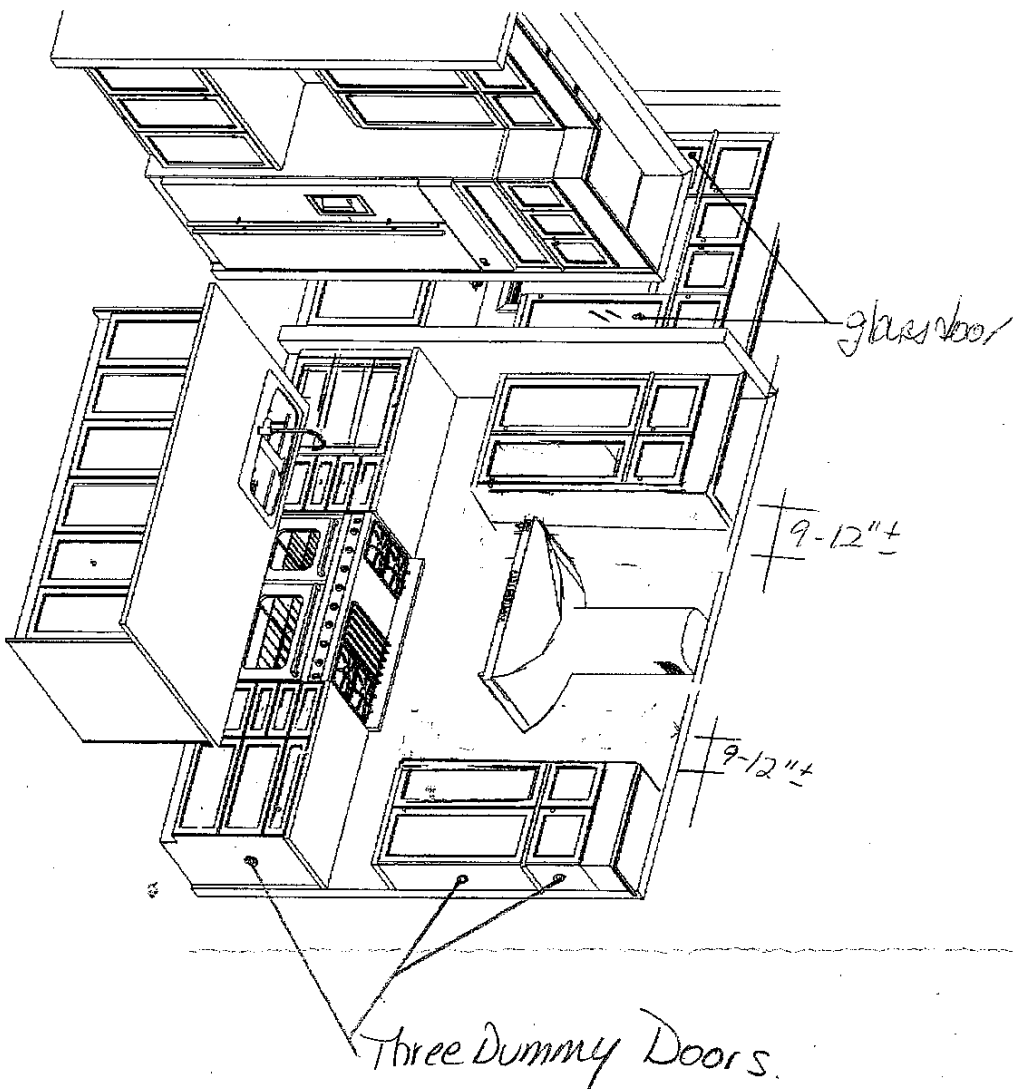

* This sketch is for DESIGN PURPOSES ONLY - It is not meant to be an exact rendition.

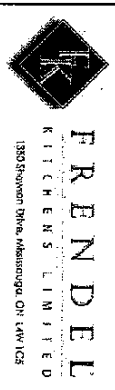

Kingsmen
Havelock Corners PH 4
(Woodstock)
Windsor/6003

Approved By Builder:

Date:

SCHEDULE "B-1"

Floor Plan

Model: Windsor(6003)Elev B OPT GRD 5 BED-INLAW-6+1 BATH

NOV 18 2020

Lot 19 Thames Ph. 4B
Sketch # 2

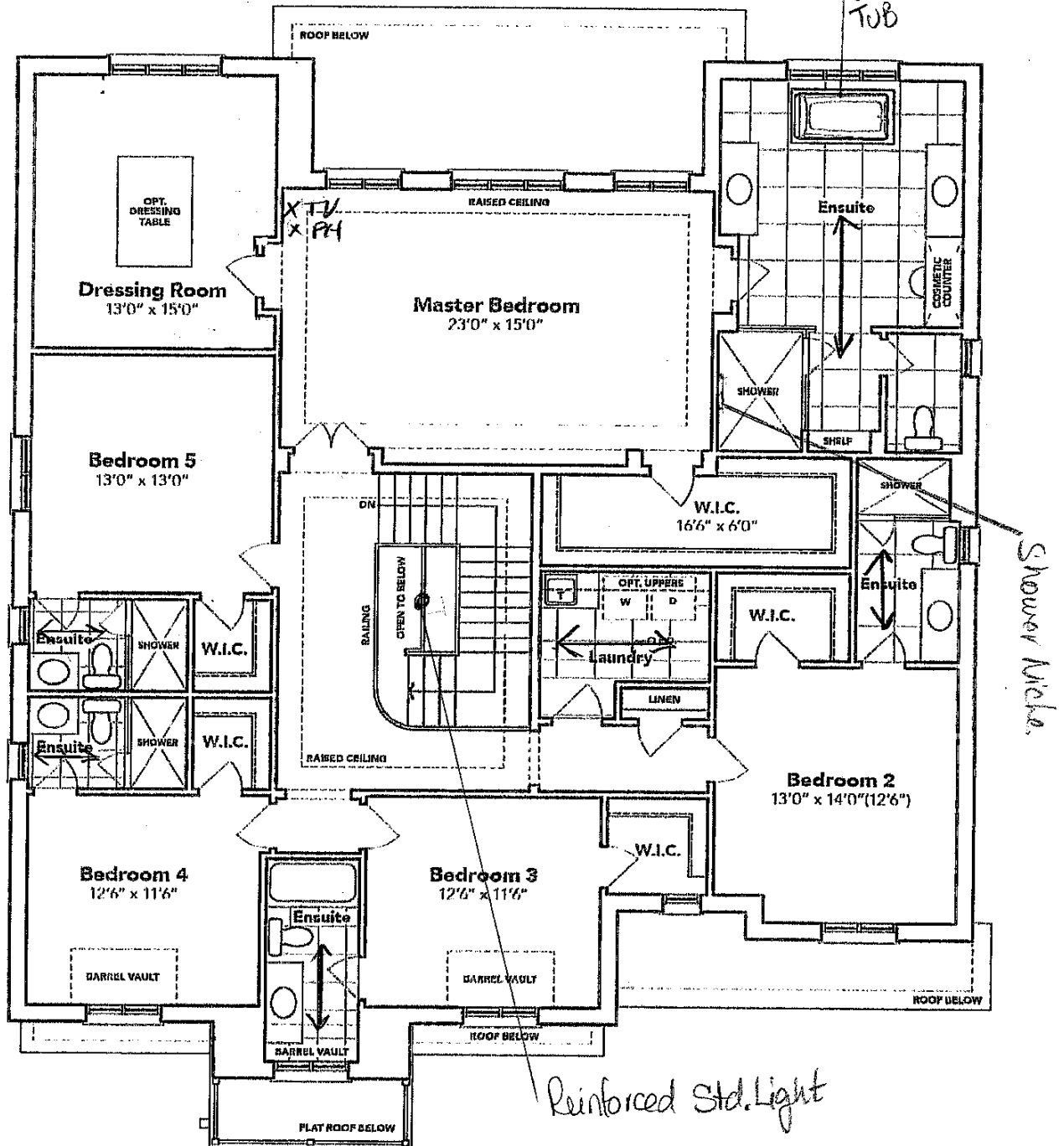

SECOND FLOOR EL. B

The floor plans and elevations shown are pre-construction plans and may be revised or improved as necessitated by architectural controls and the construction process. The measurements adhere to the rules and regulations of the TARION Warranty Corporation's official method for the calculation of floor area. Materials, specifications and floor plans are subject to change without notice. All house renderings are artist's concept only. Actual usable floor space may vary from the stated floor area. All options shown are upgrades. E. & O. E.

NOV 18 2020

Lot 19 Thames Ph. 4B
Sketch # 3

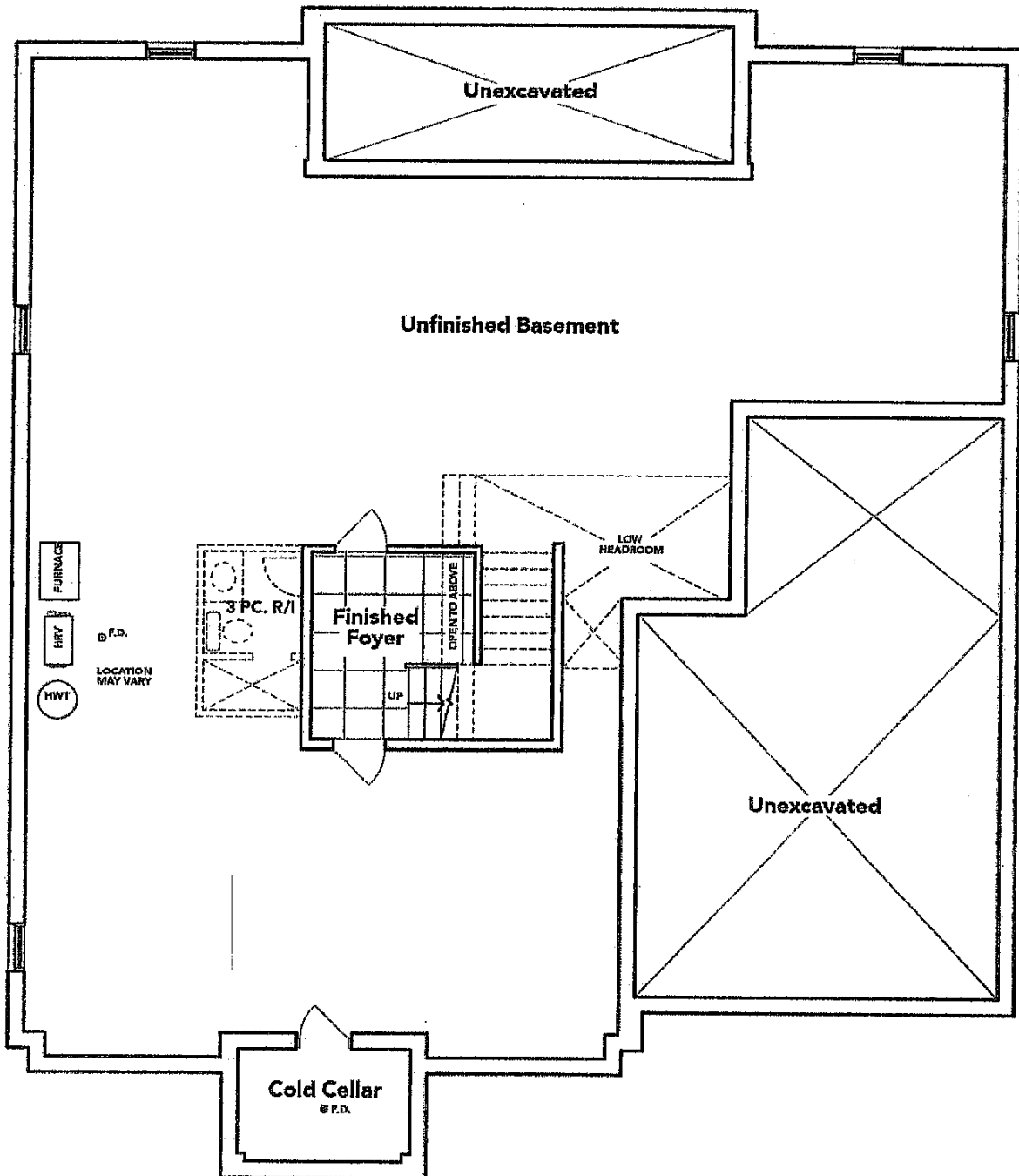

BASEMENT EL. B

The floor plans and elevations shown are pre-construction plans and may be revised or improved as necessitated by architectural controls and the construction process. The measurements adhere to the rules and regulations of the TARION Warranty Corporation's official method for the calculation of floor area. Materials, specifications and floor plans are subject to change without notice. All house renderings are artist's concept only. Actual usable floor space may vary from the stated floor area. All options shown are upgrades. E. & O. E.

LOT 19 THAMES PH. 4 B
RE: DIRECTION OF WALL TILES
WHERE APPLICABLE IN BATHROOMS.

NOV 18 2020

Michael

Ampt

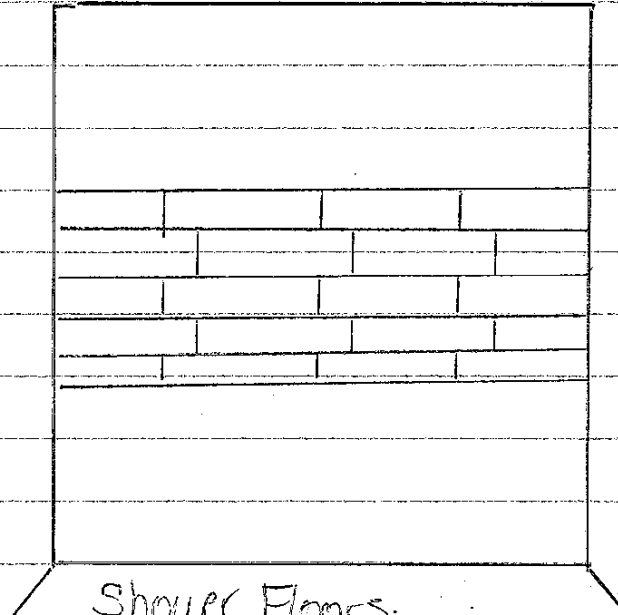

= Master Ens.
= Ens. 2.
= Ens. 4
= Ens. 5
= In-law Suite.
70/30 off set
Brick Pattern
"Not to Scale"

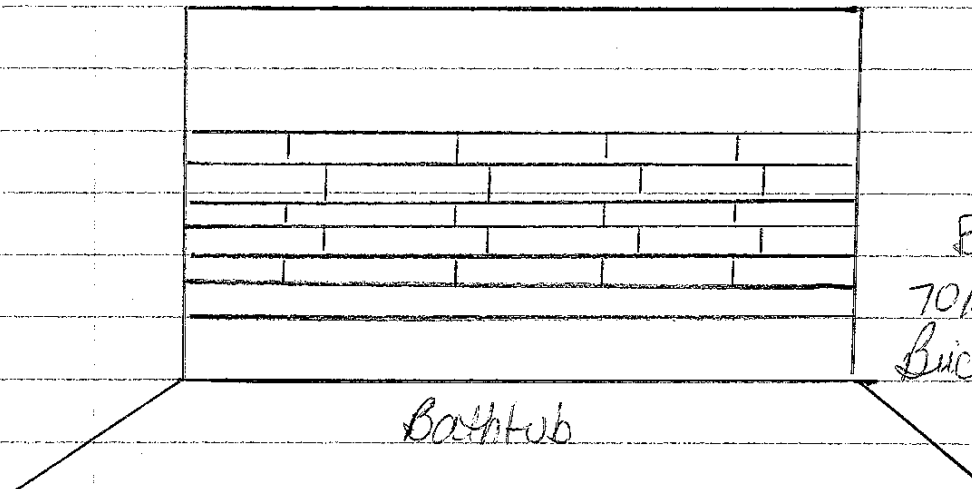

Be
Bed #3 Bathroom
70/30 off set
Brick Pattern
"Not to Scale"

Lot: 19 Thames Ph. 4B
Re: Upgraded free standing tub for master
ensuite bathroom

NOV 18 2020

Adeline
James



Brooke™ | 1

Brooke™

Categories: Acrylic Freestanding

DESCRIPTION

68" Freestanding Bath
SKU #: CF2002

FEATURES

- Installation friendly two piece design
- Accepts deck mounted faucet
- Includes a chrome integral pop up drain and rectangular overflow
- ~~• Brushed nickel drain and overflow covers available~~
- Centre drain
- Includes levelling feet
- Available in White Only

DIMENSIONS

68" x 36" x 23"

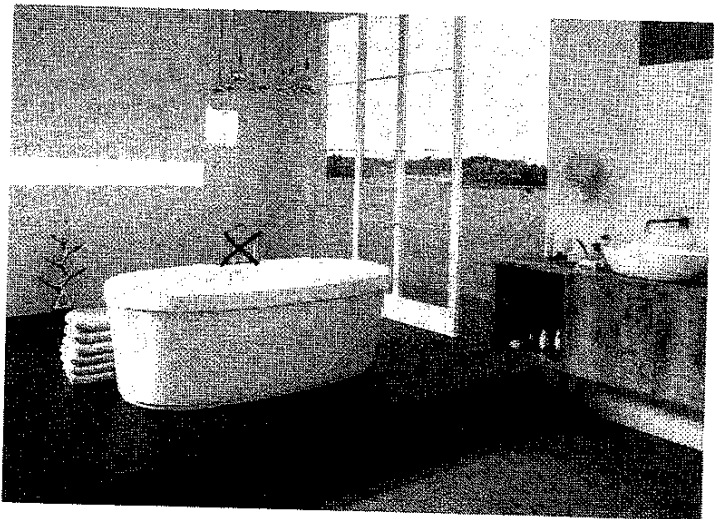

Lot: 19 Thames Ph. 4B
Re: 48" Chimney hood fan specifications

NOV 18 2020

PTB812 | PRO Collection

Cyclone®
Breathe Better

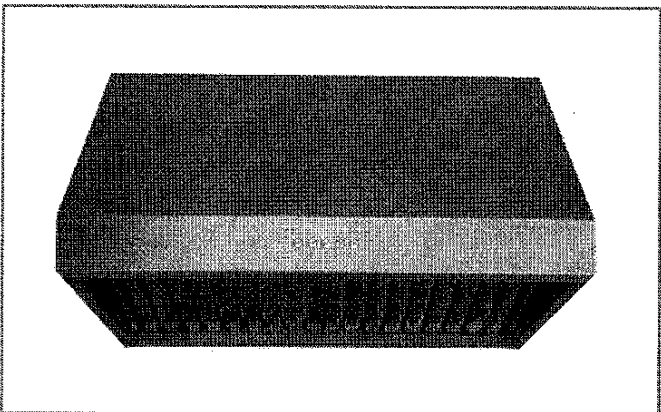
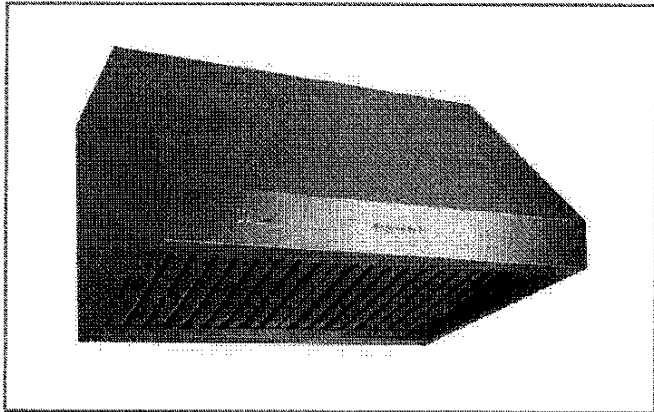

Undermount

Cyclone is excited to introduce its grandest undermount ever. Perfect for high-heat cooking. The PTB812 has an incredible 3-speed 1200 CFM fan wrapped in an imposing 18" tall wall-mount style stainless steel body. Quickly rid your kitchen of smoke and grease. Comes with durable and dishwasher-friendly baffle filters, 3 bright LED lights and a 8" duct connection for optimal performance and convenient installation, all backed by the best warranty in the business.

Green Features



3 Speed
Push Button
Control Panel



Dishwasher Safe
Baffle Filters



Time-Delay
OFF Feature



Grease Cup



Long-Lasting
LED Lights



Grease Tray

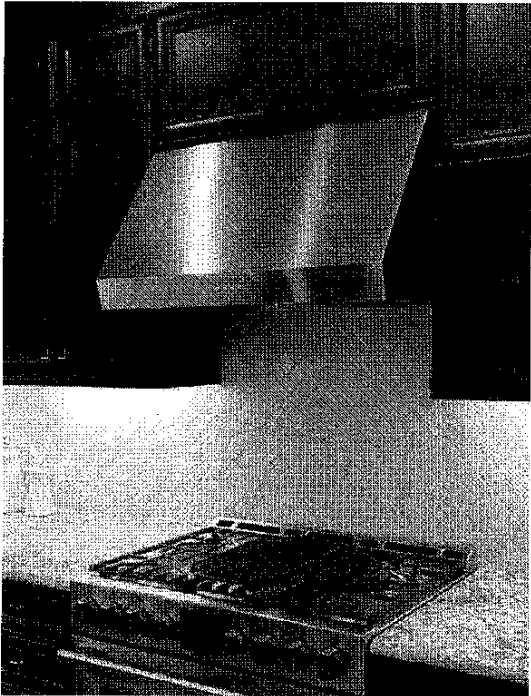

Model	Colour	Ducting	Filters	Size	CFM
PTB81236	Stainless Steel	8"	Baffle	36"	1200
PTB81242	Stainless Steel	8"	Baffle	42"	1200
PTB81248	Stainless Steel	8"	Baffle	48"	1200
PTB81296MB	Matte Black	8"	Baffle	36"	1200

Cyclone Range Hoods Inc.

1361 Huntingwood Drive, Unit 16, Toronto, ON, M1S 3J1, Canada

Toll Free: 1-888-293-5662 Tel: (416) 293-0933 Fax: (416) 293-4793 Website: www.CycloneRangeHoods.com

Lot: 19 Thames Ph. 4B
Re: 48" Chimney hood fan specifications

NOV 18 2020

[Signature]

PTB812 | PRO Collection



Features

- Undermount range hood
- 8" round duct adapter
- Non-stick aluminum fan blades
- 3 speed push button control
- 3 LED lights (3 x 1.4W, 4000K)
- Dishwasher-safe baffle filters with integrated handles
- 3 minutes time-delay OFF feature
- Plug-in connection

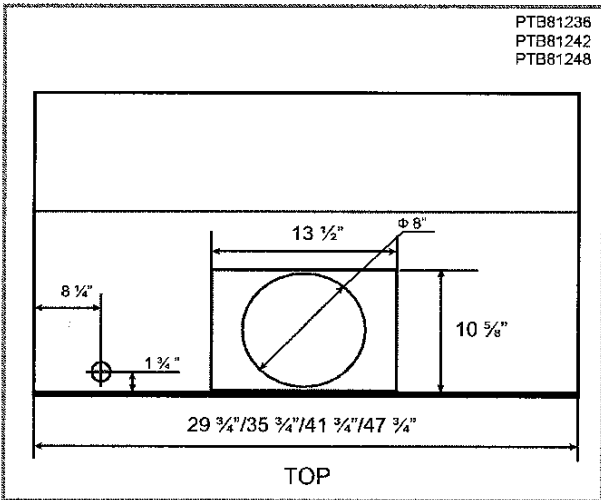
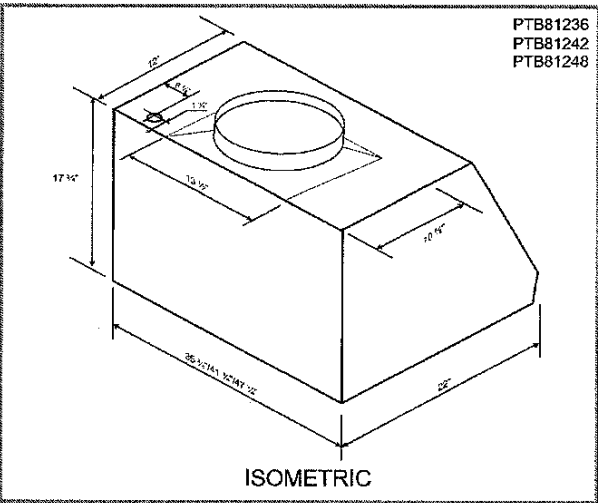

Options

- Chimney Flues:
TBD - short (8' ceilings)
TBD - extended (9' ceilings)
- Widths: 36", 42", 48"
- Finishes: Stainless Steel, Matte Black

Note: 42" and 48" in stainless steel only

Specifications

- | | | |
|--------------------------------------|--------------------------------|--|
| • Air Flow Volume: 1200 CFM | • Current: 2.5 Amps | • Finishes: Stainless Steel, Matte Black |
| • Electrical Connection: 120 V/60 Hz | • Fan Speed: 1599 RPM | • Ducting: 8" Round |
| • Power Consumption: 300 Watts | • Fan Type: Centrifugal Blower | • Noise Level: Min. 2 Sones
Max. TBD |



Toronto • Vancouver • Boston

Lot: 19 Thames Ph. 4B
Re: 48" Chimney hood fan specifications

NOV 18 2020

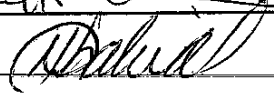
PTB812

Features

- 1200 CFM centrifugal fan
- 8" round ducting
- Non-stick fan blades
- Available sizes: ~~36"~~42"/48"
- Available finishes: stainless steel, mate black
- Optional 12" and 24" high Chimney Flues available

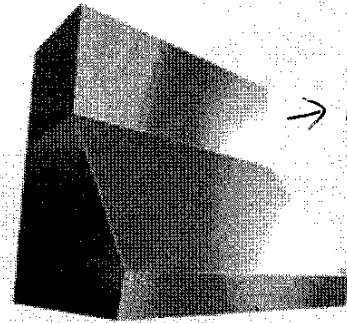
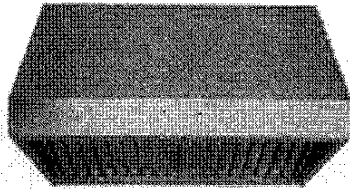

→ AD.

Green Initiatives

Maximize Energy Use: 3 speed push button control panel, and 3 long lasting LED lights

Minimizing Wasted Energy: Time-delay OFF feature up to 3 minutes

Improve Air Quality: Powerful centrifugal blower

Reduce Landfill: Dishwasher-safe permanent stainless steel baffle filters with integrated handles

Avoid Grease Build-up: Grease Extraction technology

LOT: 19 Thomas PH: 4B
Re: UP6. Post(s) Throughout
w upg. #2 pickets & keels

NOV 18 2020

~~and~~

~~Deliver~~

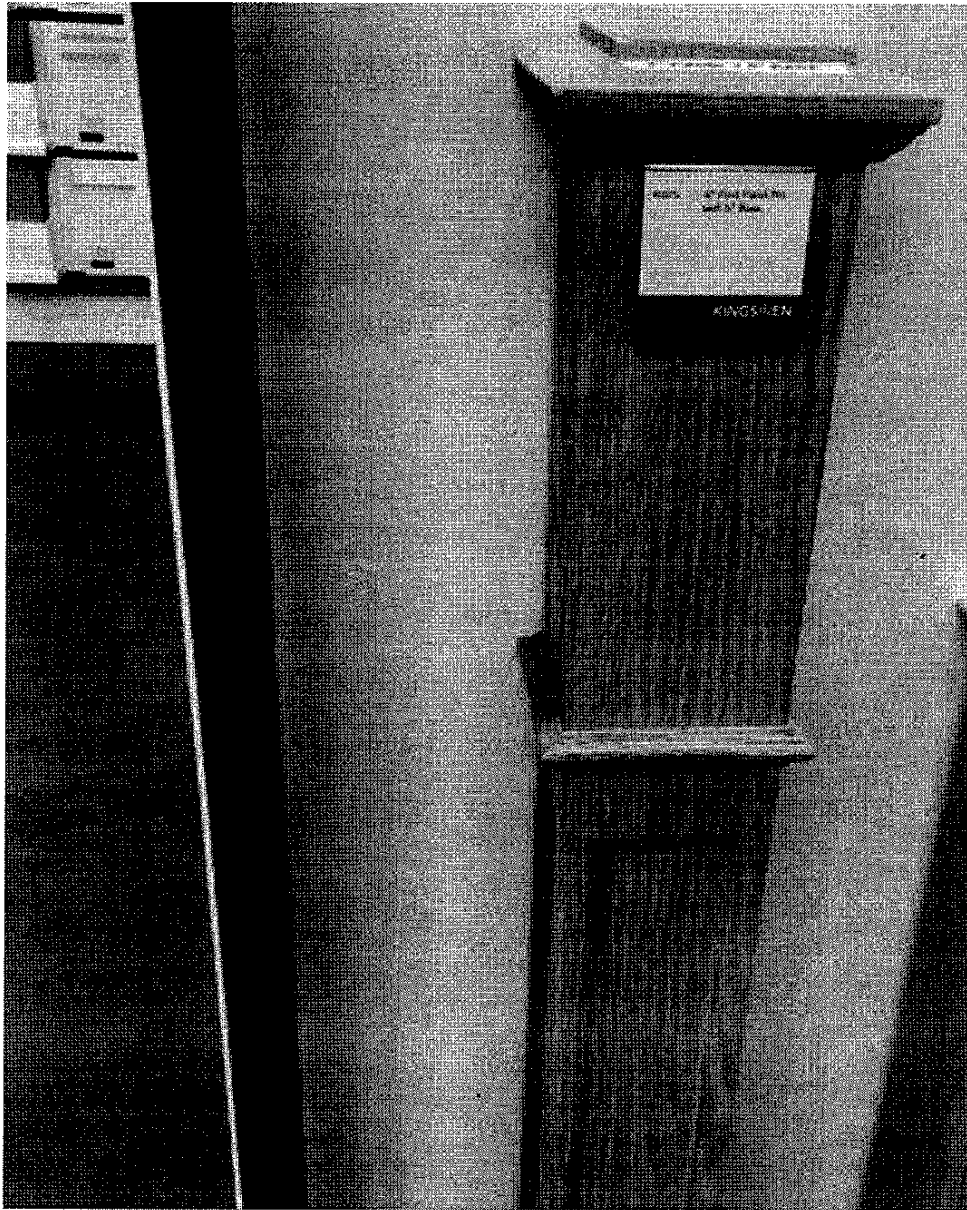

[Handwritten signature]
[Handwritten signature]

DIMENSIONS

JENNAIR® GAS RANGES
PRODUCT

MODEL #		48" GAS RANGE	
		in	cm
A	Overall width	47 ⁷ / ₈	121.6
B	Rear Vent Height	3	7.6
C	Bull nose Height	2 ¹ / ₈	5.4
D	Control Panel Height	7 ¹ / ₂	19.1
E	Door Height	20 ¹¹ / ₁₆	52.5
F	Door Bottom to Handle Top: RISE™	20	50.8
F	Door Bottom to Handle Top: NOIR™	20 ⁹ / ₁₆	52.4
G	Secondary Oven Door Width	17 ³ / ₄	45.1
H	Main Oven Door Width	29 ⁹ / ₁₆	75.2
I	Toe-Kick Height	6 ¹¹ / ₁₆	17

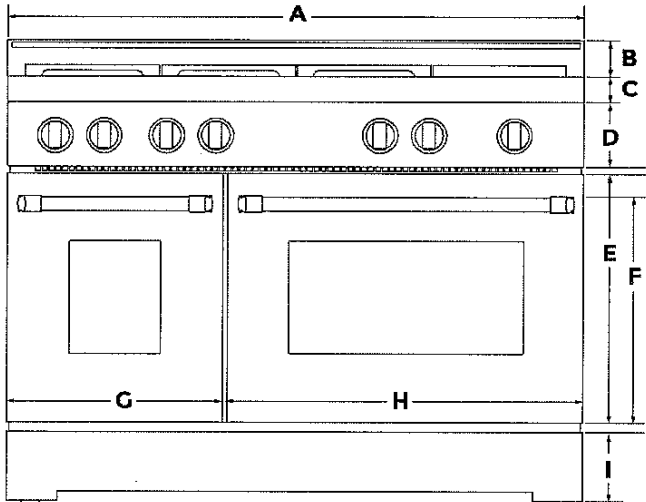

FRONT VIEW

IMPORTANT: Dimensional specifications are provided for planning purposes only.
Do not make any cutouts based on this information. Refer to the Installation Guide before selecting cabinetry, verifying electrical/gas connections, making cutouts or beginning installation.
All JennAir® appliances are appropriately UL, CUL or CSA approved.



Lot: 19 Thames Ph. 4 B
Re: 48" range specifications

[Handwritten Signature]
[Handwritten Signature]

DIMENSIONS

JENNAIR® GAS RANGES
PRODUCT

MODEL #		48" GAS RANGE	
		in	cm
J	Depth with Control Panel Overhang	27 ¹¹ / ₁₆	70.3
K	Depth with Handles: RISE™	29 ⁹ / ₁₆	75.7
K	Depth with Handles: NOIR™	29 ⁹ / ₁₆	74.5
L	Depth with Doors Fully Open	46 ¹ / ₂	118.1

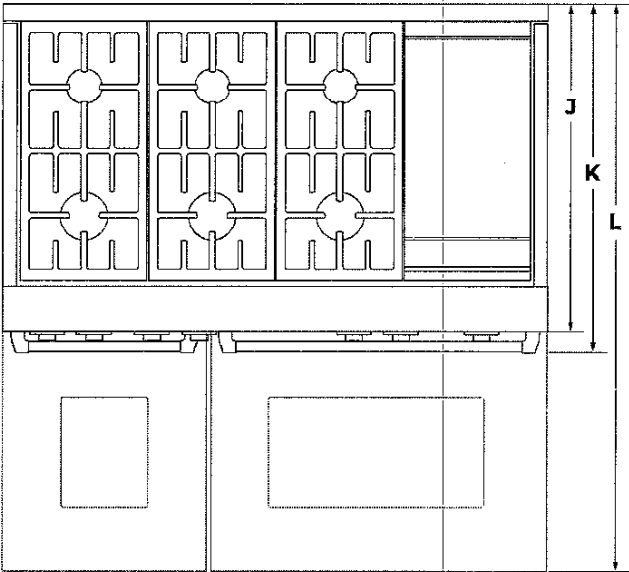

TOP VIEW



DIMENSIONS

5 of 20

JENNAIR® GAS RANGES
 PRODUCT

MODEL #		30" GAS RANGE		36" GAS RANGE		48" GAS RANGE	
		in	cm	in	cm	in	cm
A	Grates Top Height	37 ⁵ / ₁₆	94.8	37 ⁵ / ₁₆	94.8	37 ⁵ / ₁₆	94.8
B	Cooking Surface Top Height	36	91.4	36	91.4	36	91.4
C	Door Top Height	27 ¹³ / ₁₆	70.6	27 ¹³ / ₁₆	70.6	27 ¹³ / ₁₆	70.6
D	Handle Top Height: RISE™	27	68.6	27	68.6	27	68.6
D	Handle Top Height: NOIR™	27 ⁵ / ₈	70.2	27 ⁵ / ₈	70.2	27 ⁵ / ₈	70.2
E	Toe-Kick Height	6 ¹ / ₁₆	17	6 ¹ / ₁₆	17	6 ¹ / ₁₆	17
F	Height to Top of 9" Stainless Steel Backsplash	38 ³ / ₄	98.4	38 ³ / ₄	98.4	38 ³ / ₄	98.4

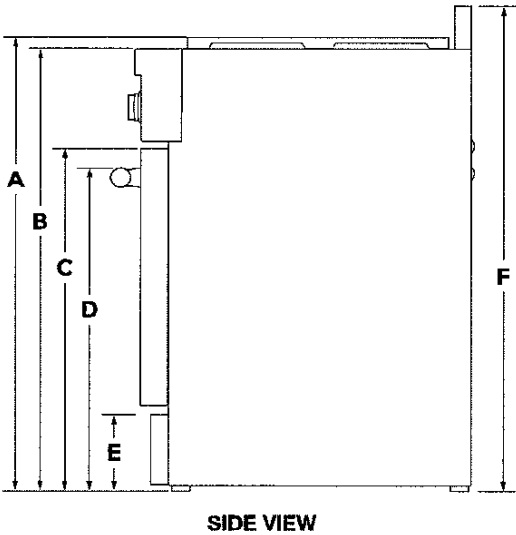

IMPORTANT: Minimum height dimensions are at the lowest point of the height adjustment range. When the leveling legs are fully extended, all heights have 1³/₄" (4.4 cm) of added height.



[Handwritten signature]



DIMENSIONS

JENNAIR® GAS RANGES
PRODUCT

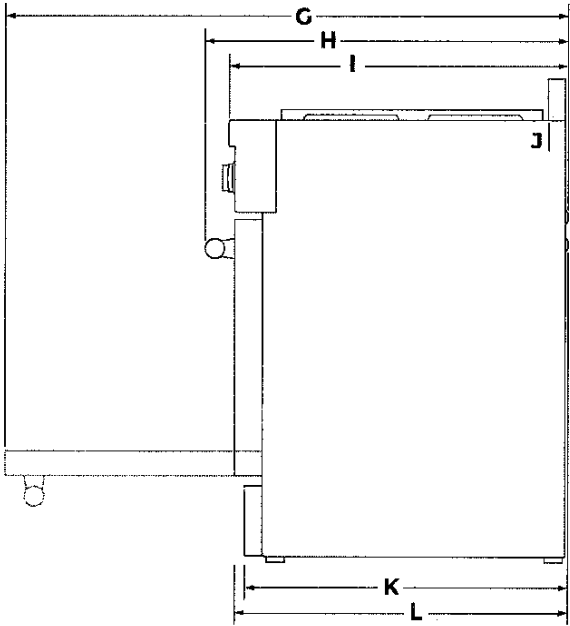
MODEL #		30" GAS RANGE		36" GAS RANGE		48" GAS RANGE	
		in	cm	in	cm	in	cm
G	Depth with Door Fully Open	46½	118.1	46½	118.1	46½	118.1
H	Depth with Handle: RISE™	29⅜	75.7	29⅜	75.7	29⅜	75.7
H	Depth with Handle: NOIR™	29⅝	74.5	29⅝	74.5	29⅝	74.5
I	Depth with Control Panel Overhang	27⅞	70.3	27⅞	70.3	27⅞	70.3
J	Rear Vent Depth	2¼	5.7	2¼	5.7	2¼	5.7
K	Depth to Toe-Kick with Door	26⅜	67	26⅜	67	26⅝	67
L	Depth with RISE™ Door	27¼	69.2	27¼	69.2	27¼	69.2
L	Depth with NOIR™ Door	27¼	69.2	27¼	69.2	27¼	69.2

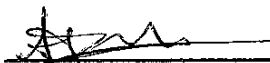

SIDE VIEW

DIMENSIONS

7 of 20

JENNAIR® GAS RANGES
OPENING AND CLEARANCE

MODEL #		30" GAS RANGE		36" GAS RANGE		48" GAS RANGE	
		in (min.)	cm (min.)	in (min.)	cm (min.)	in (min.)	cm (min.)
A	Combustible Area Above Cooking Surface Width	30	76.2	36	91.4	48	121.9
B*	Bottom of Cabinet Height Above Cooking Surface	42	106.7	58	147.3	58	147.3
C	Bottom of Cabinet Height Above Countertop	18	45.7	18	45.7	18	45.7
D	Distance to Fixed Wall or Combustible Material	12	30.5	12	30.5	12	30.5
E	Opening Width	30	76.2	36	91.4	48	121.9

*If installing a hood or hood liner above the range, follow the hood or hood liner instructions for dimensional clearances above the cooking surface.

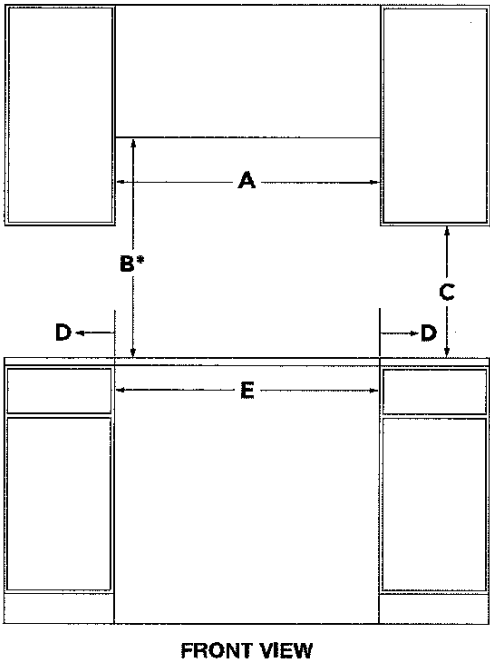

[Handwritten signature]

DIMENSIONS

JENNAIR® GAS RANGES
OPENING AND CLEARANCE

MODEL #		30" GAS RANGE		36" GAS RANGE		48" GAS RANGE	
		in	cm	in	cm	in	cm
F	Upper Cabinet Depth	13 (max.)	33 (max.)	13 (max.)	33 (max.)	13 (max.)	33 (max.)
G*	Distance to Fixed Wall or Combustible Material	1½	3.8	1½	3.8	1½	3.8

*If the back wall is constructed of a combustible material and a backsplash is not installed, a 1½" (3.8 cm) minimum clearance is required.

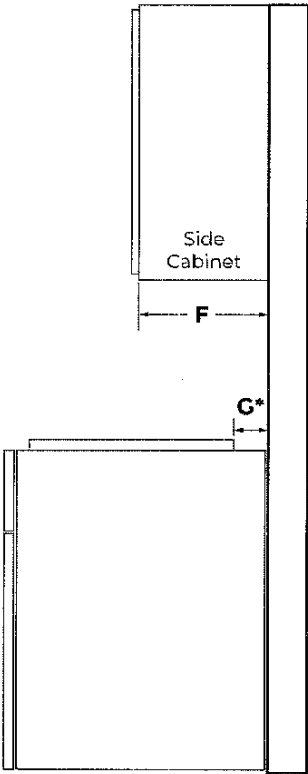

SIDE VIEW



DIMENSIONS

9 of 20

JENNAIR® GAS RANGES

ELECTRICAL REQUIREMENTS

MODEL #		30" GAS RANGE		36" GAS RANGE		48" GAS RANGE	
		in	cm	in	cm	in	cm
A	Electrical Zone Width	22	55.9	28	71.1	40	101.6
B	Electrical Zone Height	15	38.1	15	38.1	15	38.1
C	Electrical Zone Depth	5	12.7	5	12.7	5	12.7

ELECTRIC REQUIREMENTS CHECKLIST

■ A 240 V, 60 Hz, AC only 15 A, fused grounded circuit is required.

■ A dedicated circuit is recommended.

RECOMMENDED ELECTRICAL ZONE

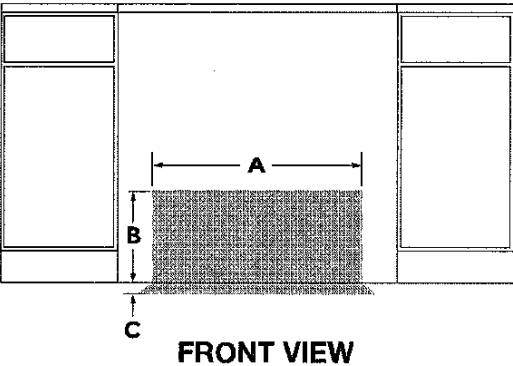

WIDTH TO ELECTRICAL CONDUIT

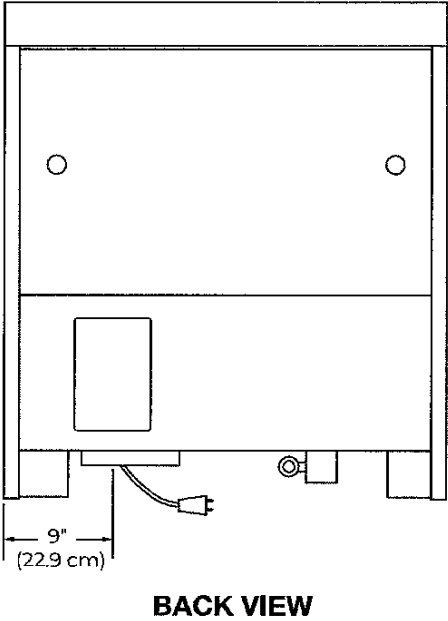

[Handwritten signature]
[Handwritten signature]

DIMENSIONS

JENNAIR® GAS RANGES
GAS REQUIREMENTS

MODEL #		30" DUAL-FUEL RANGE		36" DUAL-FUEL RANGE		48" DUAL-FUEL RANGE	
		in	cm	in	cm	in	cm
A	Gas Opening Width	3	7.6	11	28	21	53.3
B	Gas Opening Height	3	7.6	3	7.6	3	7.6
C	Gas Opening Depth	5	12.7	5	12.7	5	12.7
D	Distance from Side Cabinet to Gas Opening	9	22.9	9	22.9	9	22.9
E	Width to Gas Inlet	12¾	32.4	12¾	32.4	12¾	32.4

RECOMMENDED GAS ZONE

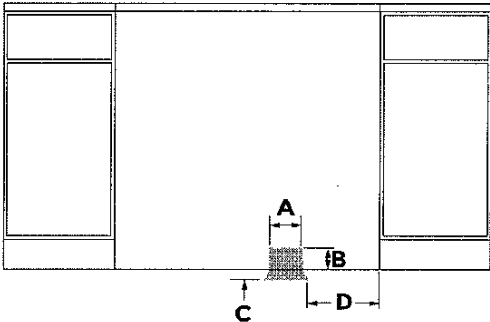

FRONT VIEW

WIDTH TO GAS INLET

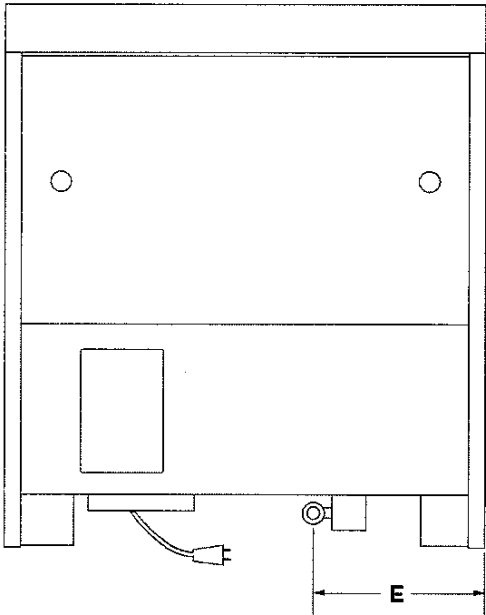

BACK VIEW

NOTE: IF YOU HAVE QUESTIONS ABOUT YOUR GAS SUPPLY,
CALL A LISCENSED, QUALIFIED SERVICE TECHNICIAN.



Lot: 19 Thames Ph. 4 B
Re: Fridge specification stainless
steel front

NOV 10 2020

[Handwritten signature]



42" FULLY INTEGRATED
SIDE-BY-SIDE REFRIGERATORS

DETAILED PLANNING DIMENSIONS GUIDE

(BASE UNIT REQUIRES SUITE-COORDINATING FULL HEIGHT PANEL KIT OR CUSTOM
PANELS AND HANDLES)

JS42NXFXDE – 41 3/4" (W) x 83 1/2" (H) x 24" (depth without door panels/handles)

BASE UNIT + FULL HEIGHT PANEL KIT = FINISHED REFRIGERATOR

Easily transform these overlay refrigerators into one of our signature kitchen suite designs with one of our suite-coordinating stainless steel panel kits. To do so, you must order one of the overlay base units (left column) and one of the suite-coordinating panel kits. The kits include refrigerator and freezer door panels, air grille and pre-installed handles.

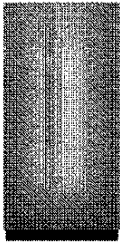
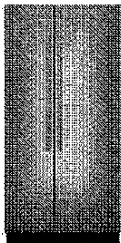
Base Unit Model Number	Coordinating Stainless Full Height Panel Kits			
	RISE™ Stainless		NOIR™ Stainless	
Side-by-Side JS42NXFXDE	JBSFS42NHL*		JBSFS42NHM	

OPTIONAL ACCESSORIES FOR CUSTOM OVERLAY DESIGNS

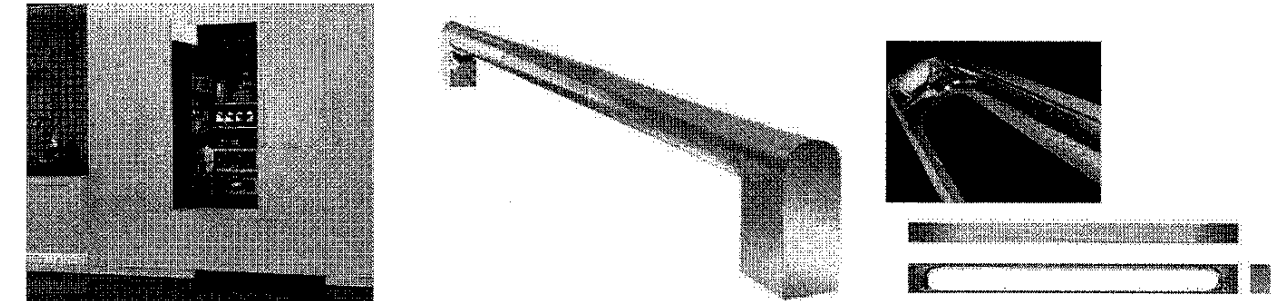

- ARMOIRE STYLE DOOR PANEL KIT**
W 10663564 – 42" – Obsidian Interior
- For use with fully integrated and flush refrigerators
 - Enables installation and proper venting of full height custom door panels (not included) that hide the top panel
 - Includes left and right grille brackets and machine compartment cover

- RISE™ STAINLESS HANDLE KIT**
W 11231243 – 42" Side-by-Side
- For use with Custom Overlay fully integrated built-in refrigerators

- NOIR™ STAINLESS HANDLE KIT**
W 11194770 – 42" Side-by-Side
- For use with Custom Overlay fully integrated built-in refrigerators

Because Whirlpool Corporation policy includes a continuous commitment to improve our products, we reserve the right to change materials and specifications without notice.

Dimensions are for planning purposes only. For complete details, see Installation Instructions packed with product. Specifications subject to change without notice.

W 11356553C

Lot: 19 Thames Ph. 4 B
Re: Fridge specification stainless
steel front con't

NOV 18 2020

[Handwritten signature]



42" FULLY INTEGRATED
SIDE-BY-SIDE REFRIGERATORS

DETAILED PLANNING DIMENSIONS GUIDE

(BASE UNIT REQUIRES SUITE-COORDINATING FULL HEIGHT PANEL KIT OR CUSTOM
PANELS AND HANDLES)

JS42NFXDE – 47 1/4" (W) x 83 1/2" (H) x 24" (depth without door panels/handles)

PRODUCT DIMENSIONS INCLUDING STAINLESS
STEEL DOOR PANEL KIT DIMENSIONS

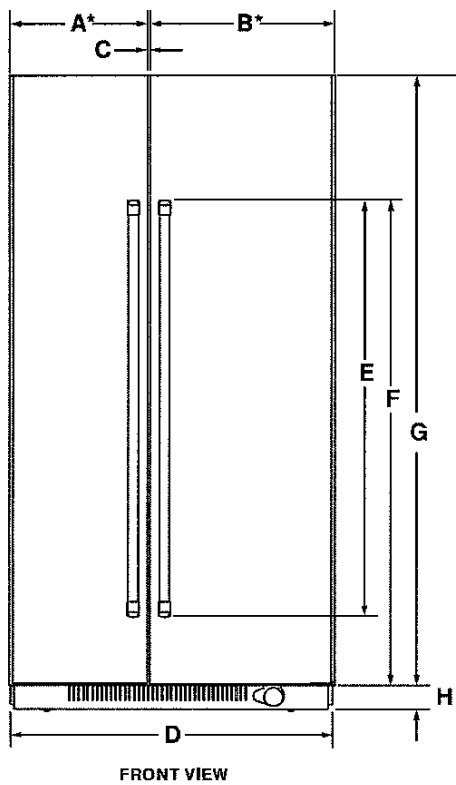

DIMENSION	DESCRIPTION	JS42NFXDE
A*	Width of freezer door	17 / " (45.2 cm)
B*	Width of refrigerator door	23 / " (60.4 cm)
C	Space between doors	1/8" (0.3 cm)
D	Overall width (including vinyl side trim)	41 / " (106 cm)
E	Height of door handle	
	RISE™ Stainless	58" (147.3 cm)
F	Height of door handle	
	NOIR™ Stainless	40 / " (103.2 cm)
G	Height to top of door handle	
	RISE™ Stainless	71 / " (182.1 cm)
H	Height to top of door handle	
	NOIR™ Stainless	69 / " (177.3 cm)
I	Height of door	81" (205.7 cm)
J	Height of bottom grille	3" (7.6 cm)
I	Width from side of refrigerator to freezer door handle – door fully open 110°	
	RISE™ Stainless	7 / " (18.6 cm)
J	Width from side of refrigerator to handle – door open 90°	
	RISE™ Stainless	6 / " (17.2 cm)
K	Width from side of refrigerator to handle – door open 90°	
	NOIR™ Stainless	2 / " (6.1 cm)
K	Width from side of refrigerator to refrigerator door handle – door fully open 110°	
	RISE™ Stainless	1 / " (4.1 cm)
L	Width from side of refrigerator to refrigerator door handle – door fully open 110°	
	NOIR™ Stainless	9 / " (23.8 cm)
M	Width from side of refrigerator to refrigerator door handle – door fully open 110°	
	NOIR™ Stainless	8 / " (22.4 cm)

*Door width dimensions are for stainless steel panel kit only.

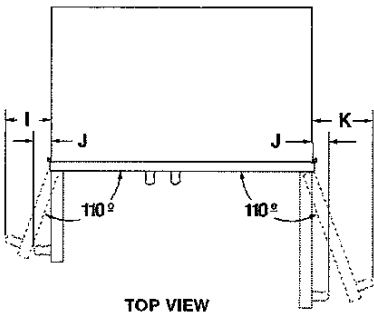

Because Whirlpool Corporation policy includes a continuous commitment to improve our products, we reserve the right to change materials and specifications without notice.

Dimensions are for planning purposes only. For complete details, see installation instructions packed with product. Specifications subject to change without notice.

Lot: 19 Thames Ph. 4 B
Re: Fridge specification stainless
steel front con't

NOV 18 2020

[Handwritten signature]



42" FULLY INTEGRATED
SIDE-BY-SIDE REFRIGERATORS

DETAILED PLANNING DIMENSIONS GUIDE

(BASE UNIT REQUIRES SUITE-COORDINATING FULL HEIGHT PANEL KIT OR CUSTOM
PANELS AND HANDLES)

JS42NFXDE – 41 3/4" (W) x 83 7/8" (H) x 24" (depth without door panels/handles)

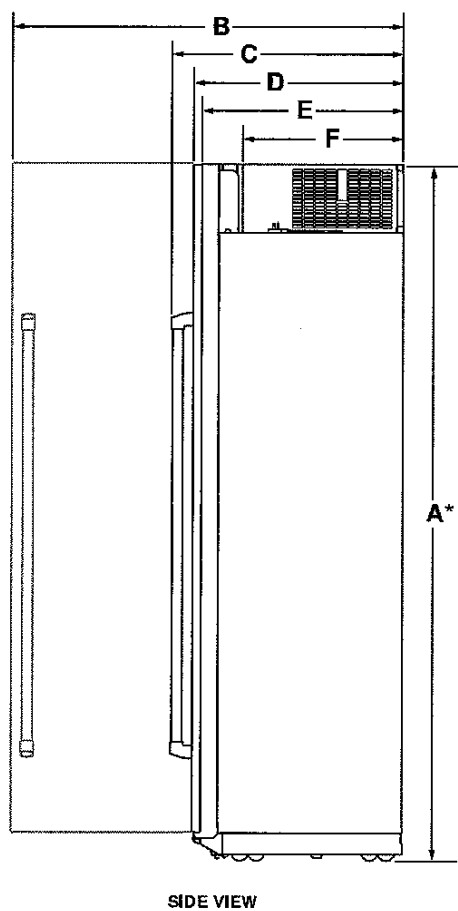

DIMENSION	DESCRIPTION	JS42NFXDE
A*	Height of recessed refrigerator (min.)	83 7/8" (211.1 cm)
B	Depth with refrigerator door open 90° (min.)	47 1/2" (120 cm)
C	Depth with handles (min.)	
	RISE™ Stainless	27 1/2" (70.2 cm)
	NOIR™ Stainless	26 1/2" (68.2 cm)
D	Depth with doors (min.)	
	RISE™ Stainless	24 1/2" (62.8 cm)
	NOIR™ Stainless	24 1/2" (62.8 cm)
	Custom panel (3/4" / 19 cm)	24 1/2" (62.8 cm)
E	Depth without door panel kit (min.)	24" (61 cm)
F	Depth of compressor cover (min.)	19 1/2" (50.5 cm)

*Add 1 1/2" (3.2 cm) to the height dimension when leveling legs are fully extended.

Because Whirlpool Corporation policy includes a continuous commitment to improve our products, we reserve the right to change materials and specifications without notice.

Dimensions are for planning purposes only. For complete details, see Installation Instructions packed with product. Specifications subject to change without notice.

Lot: 19 Thames Ph. 4 B
Re: Fridge specification stainless
steel front con't

NOV 18 2020

[Handwritten signature]



42" FULLY INTEGRATED
SIDE-BY-SIDE REFRIGERATORS
DETAILED PLANNING DIMENSIONS GUIDE
(BASE UNIT REQUIRES SUITE-COORDINATING FULL HEIGHT PANEL KIT OR CUSTOM
PANELS AND HANDLES)
JS42NXFXDE - 4 1/4" (W) x 83 1/2" (H) x 24" (depth without door panels/handles)

AIRFLOW VENTING RECOMMENDATIONS
CLOSED SOFFIT CABINET

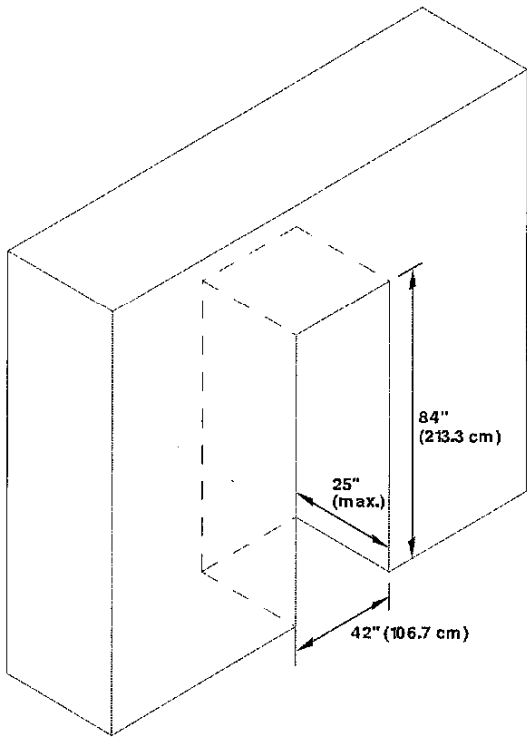

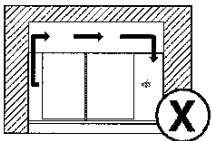
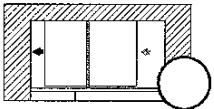
- Depth of cabinet must be less than 25" (63.5 cm).
 - Height of soffit must not exceed 84" (213.3 cm).
 - Following illustrations explain the cabinet construction (soffit and rear wall positions) required for optimum ventilation and airflow.
- 

Top View

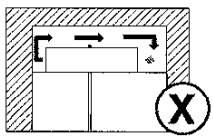
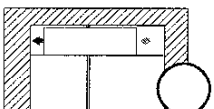

Front View

Grey arrow = ambient air; Black arrow = warm air

Cabinet depth 25" and soffit located at 84", provides proper airflow/ventilation to the refrigerator. Efficient cooling is achieved.

Cabinet depth more than 25" and/or soffit located at more than 84", causes air gap at back and/or top of the refrigerator. Air gap allows warm air recirculation causing loss in cooling efficiency.
- If your opening does not meet these requirements, you will need to make modifications.

Because Whirlpool Corporation policy includes a continuous commitment to improve our products, we reserve the right to change materials and specifications without notice.

Dimensions are for planning purposes only. For complete details, see Installation Instructions packed with product. Specifications subject to change without notice.

Lot: 19 Thames Ph. 4 B
Re: Fridge specification stainless
steel front con't

NOV 18 2020

[Handwritten signature]



42" FULLY INTEGRATED
SIDE-BY-SIDE REFRIGERATORS

DETAILED PLANNING DIMENSIONS GUIDE
(BASE UNIT REQUIRES SUITE-COORDINATING FULL HEIGHT PANEL KIT OR CUSTOM
PANELS AND HANDLES)
JS42NXFXDE – 4 13/4" (W) x 83 7/8" (H) x 24" (depth without door panels/handles)

CLEARANCE DIMENSIONS

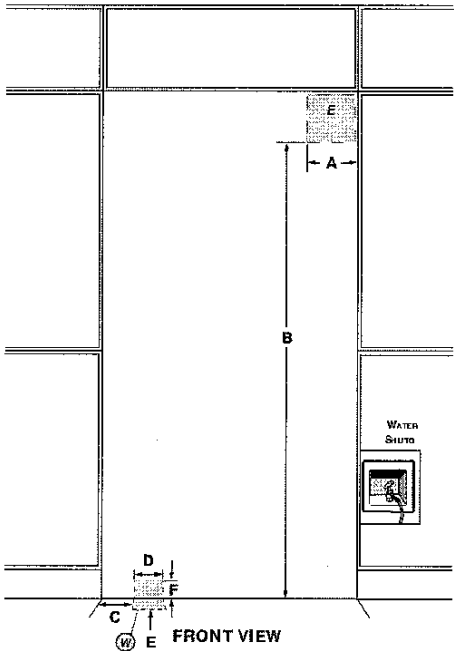

DIMENSION	DESCRIPTION	JS42NXFXDE
A	Width of recommended electrical location	7" (19.1cm)
B	Height to recommended electrical location	77" (195.6 cm)
C	Distance from side of cabinet to recommended water connection location	6 1/8" (16.5 cm)
D	Width of recommended water connection location	1 1/2" (3.81cm)
E	Depth of recommended water connection location (max.)	2" (5 cm)
F	Height of recommended water connection location (behind the unit)	2 1/2" (6.35 cm)
Recommended electrical connection location		
Recommended water connection location		

*A minimum 2" (5.1cm) furniture return must extend behind the face of the cabinet on all sides.

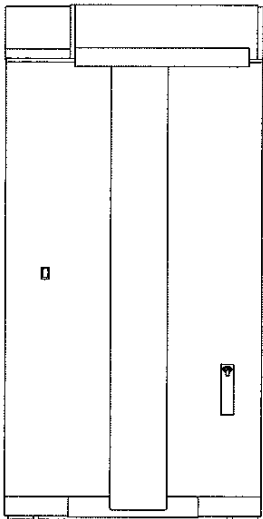

BACK VIEW

Because Whirlpool Corporation policy includes a continuous commitment to improve our products, we reserve the right to change materials and specifications without notice.

Dimensions are for planning purposes only. For complete details, see installation instructions packed with product. Specifications subject to change without notice.

Lot: 19 Thames Ph. 4 B
Re: Fridge specification stainless
steel front con't

NOV 18 2020

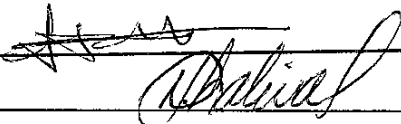

ELECTRICAL REQUIREMENTS

⚠ WARNING



Electrical Shock Hazard

Plug into a grounded 3 prong outlet.

Do not remove ground prong.

Do not use an adapter.

Do not use an extension cord.

Failure to follow these instructions can result in death, fire, or electrical shock.

115 V, 60 Hz, AC only, 15 A or 20 A fused, grounded circuit is required. A dedicated circuit is recommended. Use an outlet that cannot be turned off by a switch. Do not use an extension cord.

WATER PRESSURE REQUIREMENTS

A cold water supply with water pressure between 30 psi and 120 psi (207 kPa and 827 kPa) is required to operate the ice maker. Call a licensed, qualified plumber with any questions about the water pressure.

Reverse Osmosis Water Supply

IMPORTANT: The pressure of the water coming out of a reverse osmosis system going to the water inlet valve of the refrigerator needs to be between 30 psi and 120 psi (207 kPa and 827 kPa).

If a reverse osmosis water filtration system is connected to the cold water supply, the water pressure to the reverse osmosis system needs to be a minimum of 40 psi to 60 psi (276 kPa to 414 kPa).

LOCATION REQUIREMENTS

⚠ WARNING



Explosion Hazard

Keep flammable materials and vapors, such as gasoline, away from refrigerator.

Failure to do so can result in death, explosion, or fire.

Floor must be able to support refrigerator (more than 600 lb [272 kg]), door panels and contents of the refrigerator and must be at the same level as flooring in the room.

NOV 18 2020

Lot: 19 Thames Ph. 4 B
Re:Dishwasher...specifications
stainless steel front



Prepared by
fawad mohammad
fmohammad@appliancecanada.com (905) 660-2424 2316

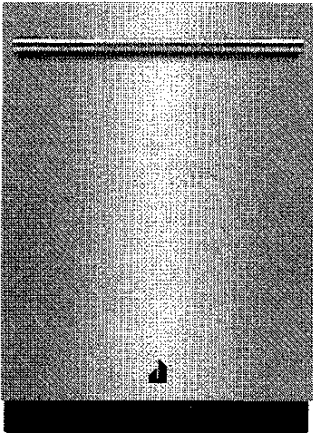

24" RISE™ TriFecta™ Dishwasher, 38 dBA
JDTSS246GL

Available Finishes/Colours

	JDTSS246GL Stainless Steel
---	-------------------------------

Dimensions	
Depth	26 1/2
Height	34 1/2
Width	23 7/8

Misc.	
Accessory Relationships	Yes
Home Delivery	Yes
Will Call	Yes

Configuration and Overview	
Dishwasher Type	Built-In
Decibel Level dBA	38







Features	
Rinse Aid Dispenser Level Indicator	Yes
Sound Package	Yes
Number of Wash Levels	5

Inside, a storm rages, as relentless power and technology bring every dish and glass to a state of refined clean. Outside, tranquility, with sleek lines wrapped in high design. Experiential ease. Tech connected. This is the quietest luxury dishwasher brand—period.

Top Features
38 dBA Tranquility
TriFecta™ Wash System
Precision Dry® Plus Option

Controls	
Automatic Temperature Controls	Yes
Last Cycle Recall	Yes
Control Location	Hidden, Top
Sensor	Yes
Status Light	White
Control Type	Electronic Touch

Details	
Dispenser	Detergent and Rinse Aid
Rinse Aid Dispenser Level Indicator	Yes
True Hold Door	No
Rack Material	Nylon

- Manuals & Literature:
-  [CAD Image](#)
 -  [Dimension Guide](#)
 -  [Energy Guide](#)
 -  [Installation Guide](#)
 -  [Use and Care Guide](#)
 -  [Warranty Information](#)



Because Whirlpool Corporation policy includes a continuous commitment to improve our products, we reserve the right to change materials and specifications without notice. Dimensions are for planning purposes only. For complete details, see Installation Instructions packed with product. Specifications subject to change without notice.