

Kingsmen (Thames) Inc. / Havelock Corners (Kingsmen)

Lot/Unit: 74 Phase/Building: 4A Model/Floor Plan: Spencer (4204) Elev B 4 Bed - 4+1 Bath

Miscellaneous

Cabinetry

Inv.4787	1 - To supply & install a different colour kitchen island in the kitchen... see colour chart for details.	
Line 61386	Note:	
23Oct20 / 28Oct20		

CABINETRY APPLIANCE - FRIDGE

CABINETRY MICROWAVE OVEN STOVE COOKTOP

CABINETRY PANTRY

CABINETRY VANITY

COUNTER TOP

ELECTRICAL

Heating And Air Conditioning

MISCELLANEOUS

PLUMBING

Inv.4787	1 - To supply & install the BLACNO QUATRUS model: 401244 in lieu of the standard under mount kitchen sink... see spec's	
Line 61387	Note:	
23Oct20 / 28Oct20		

TILE - FLOOR

Inv.4787	1 - To supply & install the UPGRADE 3 - FLOOR TILE - - FOYER TILE "STACKED" in lieu of the stanard floor tile ... see colour chart for details.... see sketch # 5 for direction of instalation.	
Line 61388	Note:	
23Oct20 / 28Oct20		
Inv.4787	1 - To supply & install the UPGRADE 3 - FLOOR TILE - MUD ROOM TILE "STACKED" in lieu of the stanard floor tile ... see colour chart for details.... see sketch # 5 for direction of instalation.	
Line 61389	Note:	
23Oct20 / 28Oct20		
Inv.4787	1 - To supply & install the UPGRADE 3 - FLOOR TILE - POWDER ROOM TILE "STACKED" in lieu of the stanard floor tile ... see colour chart for details.... see sketch # 5 for direction of instalation.	
Line 61390	Note:	
23Oct20 / 28Oct20		

Kingsmen (Thames) Inc. / Havelock Corners (Kingsmen)

Lot/Unit: 74 Phase/Building: 4A Model/Floor Plan: Spencer (4204) Elev B 4 Bed - 4+1 Bath

Inv.4787	1 - To supply & install the UPGRADE 3 - FLOOR TILE - KITCHEN/BREAKFAST TILE "STACKED" in lieu of the stanard floor tile ... see colour chart for details.... see sketch # 5 for direction of instalation.	
Line 61391	Note:	
23Oct20 / 28Oct20		

EXTRAS AS PER OFFER

Purchaser: ASIF EKBAUL HAMID OCT 23 2020 Property: 74 of Plan - Draft Approval SB17-03-08
 Telephone Res. / Bus: / Project: Kingsmen (Thames) Inc.
 Decor Advisor: Barbara Coccia Model and Elevation: Spencer (4204) Elev B 4 Bed - 4+1 Bath

Layout Changes: ☐ Yes ☒ No Sketch Attached: ☐ Yes ☒ No Exterior Colour Scheme:

1. Cabinetry

	Style and Colour	Counter Top	Hardware
Kitchen / Breakfast	Cape Cod Paint Orchid	#1 C/S #3040 Cement	12881 Handle
Kitchen Island	** #3 Charleston 3DL Moonlight	#1 C/S #3040 Cement	12881 Handle
Laundry Room	/	/	/
Powder Room	#3 Charleston 3DL Raincloud	Calcutta Marble 4925K-07	12881 Handle
Main Bathroom	/	/	/
Master Ensuite Bathroom	#2 Slab LPL Stainless	Black Alicante 4926K-07	12881 Handle
Second Ensuite Bathroom (If Applicable)	#3 Manchester Maple Shale Grey CL	Calcutta Marble 4925K-07	135 Knob
Bedroom #3 Bathroom	#3 Manchester Maple Shale Grey CL	Calcutta Marble 4925K-07	135 Knob
Bedroom #4 Bathroom	#3 Manchester Maple Shale Grey CL	Calcutta Marble 4925K-07	135 Knob

Appliances Custom Size Fridge Valance Lighting Microwave / Range Hood
☒ Yes ☐ No ☐ Yes ☒ No ☐ Yes ☒ No
 Cooktop / Rangetop Built in Wall Oven Slide-in Range
☒ Yes ☐ No ☒ Yes ☐ No ☐ Yes ☒ No

Comment

Spec's on the fridge, wall oven and cooktop were done as a revision dated Sept. 28 and Oct. 13, 2020.

2. Flooring

	Selection
Foyer	** 12 X 24" Mayfair Statuario Venato HD Polished Rect. Porcelain " STACKED"
Main Hall	3 1/2" Elements Oak Sturgeon
Back Hall	/
Breakfast	** 12 X 24" Mayfair Statuario Venato HD Polished Rect. Porcelain " STACKED"
Laundry Room	13X13" Malena Ice
Kitchen	** 12 X 24" Mayfair Statuario Venato HD Polished Rect. Porcelain " STACKED"
Powder Room	** 12 X 24" Mayfair Statuario Venato HD Polished Rect. Porcelain " STACKED"
Main Bathroom	/
Master Ensuite	13 x 13" Cinq Black
Bathroom (If Applicable)	Master ens & Bed #2 shower floor tile: 2 x 2" Soho White Matte
Mud Room	** 12 X 24" Mayfair Statuario Venato HD Polished Rect. Porcelain " STACKED"
Bed #2, # 3 & #4	13 x 13" Malena Carbon
Living Room	/
Dining Room	3 1/2" Elements Oak Sturgeon
Family / Great Room	3 1/2" Elements Oak Sturgeon
Den / Library / Study	/
Basement Landing (If Applies)	
Lower Landing (If Applicable)	3 1/2" Elements Oak Sturgeon
Upper Landing	3 1/2" Elements Oak Sturgeon
Upper Hall	Stylish Story 1- 919 Early Frost (Including Media Niche)
Master Bedroom	Stylish Story 1- 919 Early Frost
Bedroom #2	Stylish Story 1- 919 Early Frost
Bedroom #3	Stylish Story 1- 919 Early Frost
Bedroom #4	Stylish Story 1- 919 Early Frost
Bedroom #5	/
Shower Jamb / sill	Sill: Master Ensuite & Bedroom #2 Bathroom- Anatolia Marmiline SNOW

Flooring Continued on Page 2

Initial:

PA

Page 1 of 3

OCT 23 2020

Purchaser: ASIF EKBAUL HAMID

Property: 74 of Plan - Draft Approval SB17-03-08

Telephone Res. / Bus: /

Project: Kingsmen (Thames) Inc.

Decor Advisor: Barbara Coccia

Model and Elevation: Spencer (4204) Elev B 4 Bed - 4+1 Bath

2. Flooring - Continued -

Upgrade Underpad	Type	Area
	Standard	Second Floor
Carpet on Stairs	Capped	Runner - *Upgrade
Comment	/	/

3. Plumbing Fixtures / Faucets

Kitchen	Standard	Second Ensuite	Standard	Powder Room	Standard
Master Ensuite	Standard			Other Room	/
Main Bathroom	/	Bed #3 & #4 bathroom	Standard		

Comment

Purchaser has upgraded the kitchen sink, see invoice for details. Still to install the standard single hole kitchen faucet.

4. Wall Tile

	Tile Selection	Listello	Insert	Insert Selection
Main Bathroom	/	<input type="checkbox"/>	<input type="checkbox"/>	/
Master Ensuite				
Tub Deck	/	<input type="checkbox"/>	<input type="checkbox"/>	/
Tub Apron	/	<input type="checkbox"/>	<input type="checkbox"/>	/
Tub Surround	/	<input type="checkbox"/>	<input type="checkbox"/>	/
Shower Stall	8 x 10" Cinq Grey	<input type="checkbox"/>	<input type="checkbox"/>	/
Second Ensuite	8 x 10" Malena Ice	<input type="checkbox"/>	<input type="checkbox"/>	/
Bedroom #3 Bath.	8 x 10" Malena Ice	<input type="checkbox"/>	<input type="checkbox"/>	/
Bedroom #4 Bath.	8 x 10" Malena Ice	<input type="checkbox"/>	<input type="checkbox"/>	/
Kitchen Backsplash	/	<input type="checkbox"/>	<input type="checkbox"/>	/
Complete Backsplash	/	<input type="checkbox"/>	<input type="checkbox"/>	/

Comment

To install all wall tiles, in all bathrooms (master, Bedroom #2, #3, #4 Bathroom) on the 10" side horizontally stacked (where applicable).



horizontal stacked

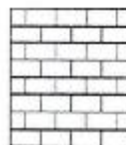

brick pattern



vertical stacked



diagonal/diamond

5. Fireplace

	Living Room			Family Room			Other Room - Specify Greatroom		
	Purchased	As Per Plan	N/A	Purchased	As Per Plan	N/A	Purchased	As Per Plan	N/A
Fireplace Type	<input type="radio"/>	<input type="radio"/>	<input checked="" type="radio"/>	<input type="radio"/>	<input type="radio"/>	<input checked="" type="radio"/>	<input type="radio"/>	<input checked="" type="radio"/>	<input type="radio"/>
Mantle Type									
Over Mantle									
Colour / Stain									
Surround									
Hearth									
Comment									

Initial: 

Page 2 of 3

OCT 23 2020

Purchaser: ASIF EKBAUL HAMID

Property: 74 of Plan - Draft Approval SB17-03-08

Telephone Res. / Bus: /

Project: Kingsmen (Thames) Inc.

Decor Advisor: Barbara Coccia

Model and Elevation: Spencer (4204) Elev B 4 Bed - 4+1 Bath

6. Trim Carpentry

Door Hardware

Interior Trim

Comment

Interior Doors

☐ 2 Panel Arch Top

☒ 2 Panel Square Top

☐ 6 Panel

Initial for Door Style



7. Railings and Pickets

Railing Package

Railing Colour

Wood Stairs ☐ No ☒ Oak

Picket Colour

Tread Colour

Comment

8. Plaster Mouldings and Medallions

Foyer

Kitchen/Breakfast

Main Hall

Den/Library

Living Room

Lower Landing

Dining Room

Family Room

Comment

9. Wall Paint

Kingsmen White

Smooth Ceilings

☐ First Floor

☐ First Floor incl. Second Floor Hall

☐ First and Second Floor

☒ Throughout

☐ Not Applicable

Trim Paint

10. Additional Comments

11. Disclaimers and Notes

- Colours of all materials are as close as possible to builder's selection, but not necessarily identical due to variances in manufacturing.
- Any extras listed above are null and void unless accompanied by a separate invoice/amendment. Said invoice must be paid in full.
- The Purchaser acknowledges that after Interior Colour Selection form is signed and dated, no further changes will be permitted other than re-selection due to unavailability. ☒ Purchaser's Initials
- The Purchaser acknowledges reading and accepting the "Kingsmen Group Décor Centre Disclaimers" form. This document contains other miscellaneous disclaimers.

This Interior Colour Selection is final and approved by:

Purchaser:

Signature:

Date:

23/04/2020

Vendor:

Kingsmen (Thames) Inc.

Sketch #5

Revised

SEE ATTACHED FOR SIGNATURES

* Direction of Floor Tile Only.

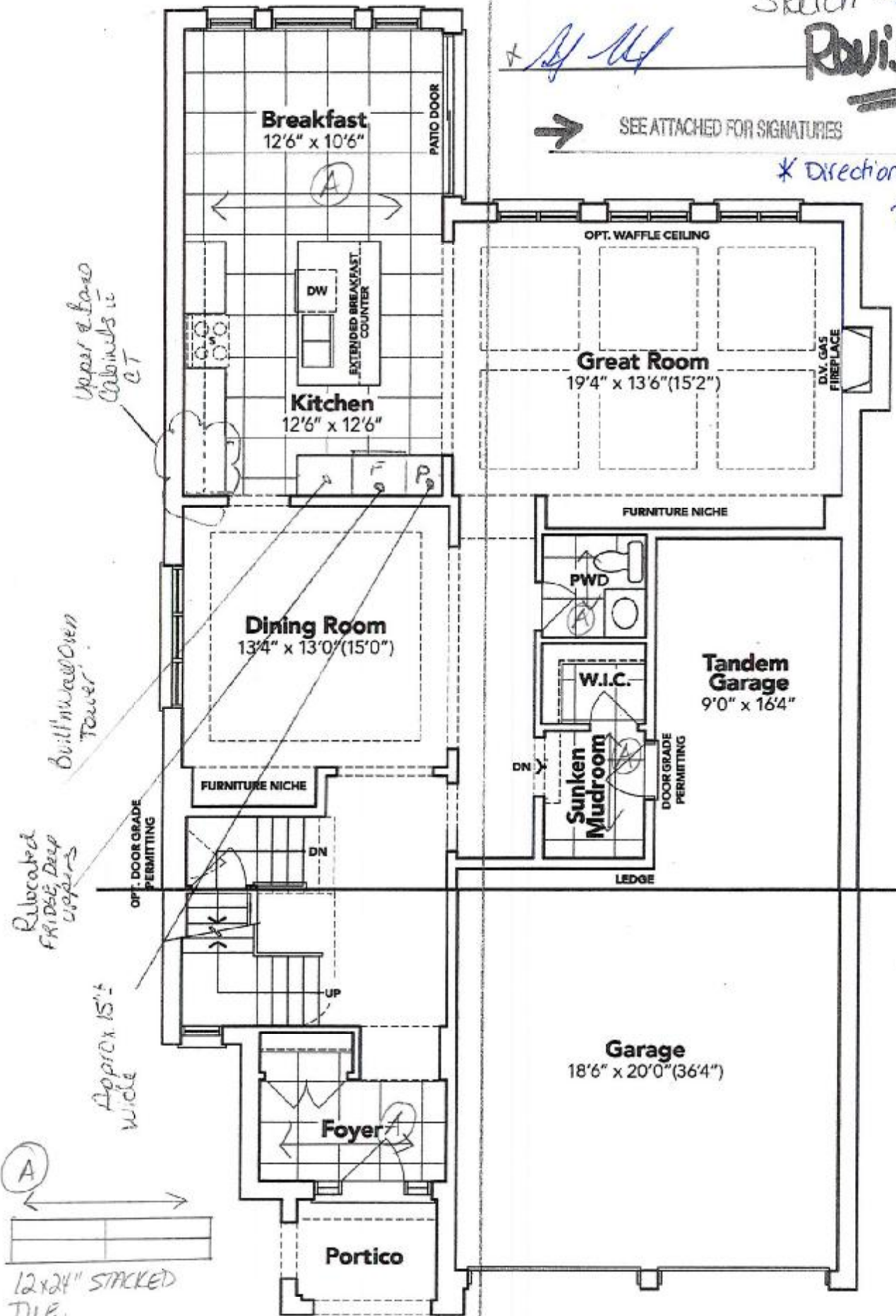

PART. GROUND FLOOR EL. B

The floor plans and elevations shown are pre-construction plans and may be revised or improved as necessitated by architectural controls and the construction process. The measurements adhere to the rules and regulations of the TARIION Warranty Corporation's official method for the calculation of floor area. Materials, specifications and floor plans are subject to change without notice. All house renderings are artist's concept only. Actual usable floor space may vary from the stated floor area. All options shown are upgrades. E. & O. E.

ULI 2 3 4020

Thames 4A

Lot # 74

QUATRUS® Undermount

Stainless Steel
Sinks

QUATRUS® U 134

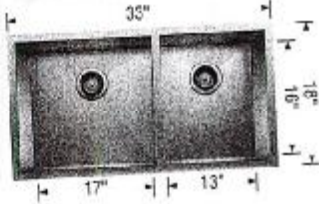

Sink Specifications

Undermount
Minimum Cabinet Size*
36" (915 mm)
Bowl Depth
9" (229 mm)
Cubed Weight
56 lb. (25.4 kg)

Model
N°

401244

List Price

\$ 986

Qty

2

1

1

x *[Signature]*