

**Kingsmen (Thames) Inc. / Havelock Corners (Kingsmen)**

**Lot/Unit: 4    Phase/Building: 4B    Model/Floor Plan: Windsor(6003)Elev C 5 BED-5+1 BATH**

**CABINETRY**

Inv.4730 Line 60569  27Aug20 / 7Oct20	1 - Purchaser has upgraded to a 36" chimney hood fan, see spec's Note:  STAINLESS STEEL FRONTS, NO PANEL FRONTS.	
Inv.4730 Line 60607  27Aug20 / 7Oct20	1 - To supply & install accomodations for built in tall appliance cabinet with drawer ( incl. soft close ) below for flush mount instalions. ( appliances to be installed flush with kitchen cabinetry) see spec's attached. See sketch # 1 Note: Electrical required for this upgrade is sold sep.	
Inv.4730 Line 61234  27Aug20 / 7Oct20	1 - To supply & install a different colour island in the kitchen... see colour chart for details... Note:	

**CABINETRY APPLIANCE - FRIDGE**

Inv.4730 Line 60605  27Aug20 / 7Oct20	1 - To accomodate for bulit in refridgerator/freezer with intergrated or flush inset installation. ( typically the door of this unit will be inline/flush with adjoining cabinetry, therefore blending in. Grill or vent is not visible) see spec's attached. Note:	
--	--	--

**CABINETRY HOOD FANS**

Inv.4730 Line 60570  27Aug20 / 7Oct20	1 - To supply & install the HOOD FAN - PRO COLLECTION (SCB72236) WALL MOUNT RANGE HOOD WITH 650 CFM FAN - 36 INCH... see spec's attached. Note:	
--	--	--

**CABINETRY MICROWAVE OVEN STOVE COOKTOP**

Inv.4730 Line 60571  27Aug20 / 7Oct20	1 - To supply & insatl RANGETOP CABINET 36INCHES WIDE OR LESS - MODIFIED HEIGHT WITH DRAWERS BELOW - SUPPLY SPECS - NA WITH LAMINATE COUNTERTOP. - CLASSIC SERIES in the kitchen... this upgrade includes soft close drawers. Note: See sketch # 1, see spec's attached.	
--	---	--

**CABINETRY PANTRY**

Inv.4730 Line 60610  27Aug20 / 7Oct20	2 - To supply & install an approx. 18" + - wide PANTRY( includes soft close ) 66 CM DEEP IN LIEU OF UPPER - BASE - COUNTER DEPTH - CLASSIC SERIES in the kitchen next to the wall oven built in micorwave tower... see sketch # 1 Note:	
--	--	--

**CABINETRY VANITY**

Inv.4730 Line 60572  27Aug20 / 7Oct20	1 - To supply & install VANITY- LOWER DRAWER PRICE PER DRAWER - INCLUDES soft close drawer- CLASSIC SERIES in the powder room... see sketch # 1 Note:	
--	--	--

**Kingsmen (Thames) Inc. / Havelock Corners (Kingsmen)**

**Lot/Unit: 4    Phase/Building: 4B    Model/Floor Plan: Windsor(6003)Elev C 5 BED-5+1 BATH**

Inv.4730	1 - To supply & install TWO VANITY TOP DRAWERS -includes soft close- CLASSIC SERIES to bedroom #2's bathroom... see sketch # 2	
Line 60574	Note:	
27Aug20 / 7Oct20		
Inv.4730	1 - To supply & install TWO VANITY TOP DRAWERS -includes soft close- CLASSIC SERIES to bedroom #3 's bathroom... see sketch # 2	
Line 60575	Note:	
27Aug20 / 7Oct20		

**COUNTER TOP**

Inv.4730	1 - As per schedule "PE": Vendor to install Level 1 Quartz or Granite countertops in all bathrooms in lieu of included laminate, Purchaser to select from builders standard samples at decor appointment.	
Line 60528	Note:	
27Aug20 / 7Oct20		

**COUNTER TOP - KITCHEN**

Inv.4730	1 - To supply & install the COUNTER TOP - KITCHEN - KITCHEN - 3CM COUNTER TOP - UPGRADE LEVEL 2 in lieu of the standard quartz .... see colour chart for details.	
Line 60555	Note: This includes the servery area.	
27Aug20 / 7Oct20		

**ELECTRICAL**

Inv.4730	1 - To supply & install the standard T.V. rough in in the great room and master bedroom... see sketch #1 & # 2	
Line 60552	Note:	
27Aug20 / 7Oct20		
Inv.4730	1 - To supply & install the standard Phone rough in ( CAT 5) in the great room, media room and bedroom #2... see sketch # 1 & # 2	
Line 60553	Note:	
27Aug20 / 7Oct20		
Inv.4730	2 - To SUPPLY AND INSTALL "TWO" EXTRA 240 STOVE PLUGS, one for the wall oven and one for the built in microwave... see spec's	
Line 60578	Note:	
27Aug20 / 7Oct20		

**FIREPLACE**

Inv.4730	1 - To supply & install a fireplace fan to the F/P in the great room	
Line 60580	Note:	
27Aug20 / 7Oct20		

**HEATING AND AIR CONDITIONING**

Inv.4730	1 - As per schedule "PE": Vendor to insall capped gas line ( rough in only ) at rear of home for future BBQ locaion. Location to be finalized at Vednors sole discretion.	
Line 60526	Note:	
27Aug20 / 7Oct20		

**Kingsmen (Thames) Inc. / Havelock Corners (Kingsmen)**

**Lot/Unit: 4    Phase/Building: 4B    Model/Floor Plan: Windsor(6003)Elev C 5 BED-5+1 BATH**

Inv.4730	1 - As per schedule "PE": Vendor to supply & install air conditioning unit, sized accordingly, from vendors standard samples.	
Line 60527	Note:	
27Aug20 / 7Oct20		
Inv.4730	1 - As per schedule "PE": Vendor to insall gas line ( rough in only) to kitchen in at stove location ( as per plan ) to include 110V code requirement.	
Line 60529	Note:	
27Aug20 / 7Oct20		

**MISCELLANEOUS**

Inv.4730	1 - As per schedule "PE": Vendor agrees to increase the size of the front door to an oversized single door ( minimum 40 inches wide by 8 feet high). Purchaser acknowledges that that the front door will be modified to accomodate the larger front door,	
Line 60530	Note: and that the vendor retains final and complete architectural control as to design and style of the modified front door.	
27Aug20 / 7Oct20		
Inv.4730	1 - As per schedule "PE": Builder to seperate the dining room from living room with a trimmed off 42 inch high knee wall, as per sketch # 1	
Line 60531	Note:	
27Aug20 / 7Oct20		
Inv.4730	1 - To supply & install the optional side door into garage if grade permints... see sketch # 1	
Line 60545	Note:	
27Aug20 / 7Oct20		
Inv.4730	1 - Do not supply or install any towel bars, toilet paper holders or soap dishes throughout all bathrooms.	
Line 60554	Note:	
27Aug20 / 7Oct20		

**PLUMBING**

Inv.4730	1 - To supply & install the BLANCO QUATRUS under mount kitchen sink model number 401247 in the kitchen in lieu of the standard kitchen sink... see spec's	
Line 61237	Note: Still to install the standard single hole kitchen faucet.	
27Aug20 / 7Oct20		
Inv.4730	6 - To supply & install the CONTRAC Catena under mount vanity sinks model 4210CIY to the master ensuite, bed #2, #3, #4 and #5's bathroom... see spec's	
Line 61238	Note: Still to install the standard vanity faucets in all bathrooms Purchaser has NOT upgraded the sink the powder room	
27Aug20 / 7Oct20		
Inv.4730	1 - To supply & install the MILOLIN BROOKE free standing tub in the master ensuite in lieu of the standard free standing tub... see spec's	
Line 60546	Note:	
27Aug20 / 7Oct20		
Inv.4730	2 - Raise the toe tester in both bedroom # 2's & #5's shower to aprprox. 30-32" + - up from the unfinished floors.	
Line 60547	Note:	
27Aug20 / 7Oct20		

**TILE - FLOOR**

**Kingsmen (Thames) Inc. / Havelock Corners (Kingsmen)**

**Lot/Unit: 4    Phase/Building: 4B    Model/Floor Plan: Windsor(6003)Elev C 5 BED-5+1 BATH**

Inv.4730 Line 61235 27Aug20 / 7Oct20	1 - To supply & install the UPGRADE 4 - FLOOR TILE "STACKED" - - MASTER ENSUITE FLOOR TILE in lieu of the standard floor tiles... see colour chart for details. Note:	
Inv.4730 Line 60556 27Aug20 / 7Oct20	1 - To supply & install the UPGRADE 4 - FLOOR TILE "STACKED" - - FOYER TILE area in lieu of the standrd floor tiles.... see colour chart for details. Note:	
Inv.4730 Line 60557 27Aug20 / 7Oct20	1 - To supply & install the UPGRADE 3 - FLOOR TILE - POWDER ROOM TILE in lieu of the standard floor tiles... see colour chart for details, see sketch # 1 for direction of STACKED tiles. Note:	
Inv.4730 Line 60558 27Aug20 / 7Oct20	1 - To supply & install the UPGRADE 3 - FLOOR TILE - MUD ROOM TILE in lieu of the standard floor tiles... see colour chart for details, see sketch # 1 for direction of STACKED tiles. Note:	
Inv.4730 Line 60559 27Aug20 / 7Oct20	1 - To supply & install the UPGRADE 4 - FLOOR TILE - - KITCHEN/BREAKFAST TILE ( including the servery area ) in lieu of the standard floor tiles... see colour chart for details. Note: This includes the servery and pantry area	

**TILE - WALL**

Inv.4730 Line 60560 27Aug20 / 7Oct20	3 - To supply & install the standard wall tile where applicable on the 10" side Horizontally in a 70/30+ - off set brick pattern in the bedroom #2, #4 & #5's bathrooms. See sketch # 2 Note:	
Inv.4730 Line 61236 27Aug20 / 7Oct20	1 - To supply & install the UPGRADE 1 - WALL TILE 4 x 16" WT-Glossy 50-500 MASTER ENSUITE WALL TILE in the master ensuite shower "STACKED" where applicable. Note: AND To supply & Install two rows of the 4 x 16" Taupe Glossy 50-604 tile at approx. 66" + - up from the floor... see sketch	

**TRIM**

Inv.4730 Line 60581 27Aug20 / 7Oct20	1 - To supply & install the INTERIOR DOORS - UPGRADE TO LIVINGSTON HOLLOW CORE throughout in lieu of the standard interior doors. Note:	
Inv.4730 Line 60582 27Aug20 / 7Oct20	1 - To supply & install the DOOR LEVER - UPGRADE TO HALIFAX SQUARE ROSE PASSAGE LEVERS - SATIN NICKEL in lieu of the standard door levers throughout where applicable.... Note:	

**Kingsmen (Thames) Inc. / Havelock Corners (Kingsmen)**

**Lot/Unit: 4    Phase/Building: 4B    Model/Floor Plan: Windsor(6003)Elev C 5 BED-5+1 BATH**

**EXTRAS AS PER OFFER**

5 FREE APPLIANCES ? STAINLESS STEEL FRONT - FRIDGE: STOVE AND DISHWASHER. WHITE WASHER AND DRYER (SUPPLIED ONLY, NOT INSTALLED, FROM BUILDERS STANDARD LINE) TO ARRANGE DELIVERY ? CALL THE BRICK COMMERCIAL SALES DIVISION AT 1-877-353-2850. <i>Worksheet</i> Note:	
VENDOR TO INSTALL CAPPED GAS LINE (ROUGH-IN ONLY) AT REAR OF HOME FOR FUTURE BBQ LOCATION.    LOCATION TO BE FINALIZED AT VENDORS SOLE DISCRETION. <i>Worksheet</i> Note:	
VENDOR TO SUPPLY & INSTALL AIR CONDITIONING UNIT, SIZED ACCORDINGLY, FROM VENDORS STANDARD SAMPLES. <i>Worksheet</i> Note:	
Vendor to install Level 1 Quartz or Granite countertops in all bathrooms in lieu of included laminate. Purchaser to select from builders standard samples at decor appointment. <i>Worksheet</i> Note:	
VENDOR TO INSTALL GAS LINE (ROUGH-IN ONLY) TO KITCHEN IN AT STOVE LOCATION (AS PER PLAN) TO INCLUDE 110V CODE REQUIREMENT. <i>Worksheet</i> Note:	
Vendor agrees to increase the size of the front door to an oversized single door (minimum 40 inches wide by 8 feet high). Purchasers acknowledges that that the front door elevation will be modified to accomodate the larger front door, and that the vendor <i>Worksheet</i> Note:	
Builder to seperate Dining Room from Living Room with a trimmed off 42 inch high knee wall, as per SKETCH #1. <i>Worksheet</i> Note:	



Purchasers: KULPREET KAUR MARWAH-KWATRA & ROOPProperty: 4 of Plan - Draft Approval SB17-03-08  
Telephone Res. / Bus: / Project: Kingsmen (Thames) Inc.  
Decor Advisor: Barbara Coccia Model and Elevation: Windsor(6003)Elev C 5 BED-5+1 BATH  
Layout Changes: ☒ Yes ☐ No Sketch Attached: ☒ Yes ☐ No Exterior Colour Scheme:

## 1. Cabinetry

	Style and Colour	Counter Top	Hardware
Kitchen / Breakfast	#6 Manchester Paint Orchid	*Upg. 2 H/S Whistler 3cm	#12881 Handle
Kitchen Island	**#6 Manchester Paint Navy Blue	*Upg. 2 H/S Whistler 3cm	#12881 Handle
Laundry Room	/		
Powder Room	#6 Manchester Paint Moonlight	#1, C/S # 9141 Ice Snow 2cm.	#12881 Handle
Main Bathroom			
Master Ensuite Bathroom	#6 Manchester Paint Moonlight	#1, C/S # 9141 Ice Snow 2cm.	#12881 Handle
Second Ensuite Bathroom (If Applicable)	#3 Manchester Maple Shale Grey CL	#1, C/S # 9141 Ice Snow 2cm.	#12881 Handle
Bed. 3,4 & 5 Bathrooms	#3 Manchester Maple Shale Grey CL	#1, C/S # 9141 Ice Snow 2cm.	#12881 Handle

## Appliances

## Custom Size Fridge

☒ Yes ☐ No

## Valance Lighting

☐ Yes ☒ No

## Microwave / Range Hood

☐ Yes ☒ No

## Cooktop / Rangetop

☒ Yes ☐ No

## Built in Wall Oven

☒ Yes ☐ No

## Slide-in Range

☐ Yes ☒ No

## Comment

/

## 2. Flooring

## Selection

Foyer	*Upg.4, 24x 24" Mayfair Volakas Grigio HD Polished " STACKED"
Main Hall	5" Elements Brushed Oak Coho
Back Hall	/
Breakfast	*Upg.4, 24x 24" Mayfair Volakas Grigio HD Polished "STACKED"
Laundry Room	12x24" Classic Calacatta HD Porcelain Tile "STACKED"
Kitchen	*Upg.4, 24x 24" Mayfair Volakas Grigio HD Polished "STACKED" Includes Servery + Pantry DC.
Powder Room	*Upg.3, 12 x 24" Mayfair Volakas Grigio HD Polished "STACKED"
Main Bathroom	/
Master Ensuite	*Upg.4 24x 24" Mayfair Volakas Grigio HD Polished "STACKED" SH/FL: 2 x 2" Soho White Matte
Bathroom (If Applicable)	Bed #2, #4 & #5's SHOWER FLOOR: 2x2" Soho white Matte
Mud Room	*Upg.3, 12 x 24" Mayfair Volakas Grigio HD Polished "STACKED"
Bed. #2, 3,4 & 5 Bathrooms	13 x 13" Malena Ice
Living Room	5" Elements Brushed Oak Coho
Dining Room	5" Elements Brushed Oak Coho
Family / Great Room	5" Elements Brushed Oak Coho
Den / Library / Study	5" Elements Brushed Oak Coho
Basement Landing (If Applies)	Basement Foyer: 13 x 13" Malena Ice
Lower Landing (If Applicable)	5" Elements Brushed Oak Coho
Upper Landing	5" Elements Brushed Oak Coho
Upper Hall	5" Elements Brushed Oak Coho
Master Bedroom	5" Elements Brushed Oak Coho
Bedroom #2	5" Elements Brushed Oak Coho
Bedroom #3	5" Elements Brushed Oak Coho
Bedroom #4	5" Elements Brushed Oak Coho
Bedroom #5	5" Elements Brushed Oak Coho
Shower jams	Master ens. Bed #2,#4 & #5's bathroom: Anatolia Marmiline SNOW

Flooring Continued on Page 2

Initial:

SEE ATTACHED FOR SIGNATURES

Page 1 of 3

Purchasers: KULPREET KAUR MARWAH-KWATRA & ROOF Property: 4 of Plan - Draft Approval SB17-03-08  
Telephone Res. / Bus: / Project: Kingsmen (Thames) Inc.  
Decor Advisor: Barbara Coccia Model and Elevation: Windsor(6003)Elev C 5 BED-5+1 BATH  
4. Flooring - Continued -

Upgrade Underpad	Type	Area
	/	/
Carpet on Stairs	Capped	Runner - *Upgrade
Comment	/	/

## 3. Plumbing Fixtures / Faucets

Kitchen	STD	Second Ensuite	STD	Powder Room	STD
Master Ensuite	STD			Other Room	/
Main Bathroom	/	Bed. #3, #4, & #5 Bath.	STD		

## Comment

Please note the purchasers have upgraded the kitchen sink, Master ensuite, bedroom #2, #3, #4 and #5 sinks. Still to install the standard faucets.

## 4. Wall Tile

	Tile Selection	Listello	Insert	Insert Selection
Main Bathroom	/	<input type="checkbox"/>	<input type="checkbox"/>	/
Master Ensuite				
Tub Deck	/	<input type="checkbox"/>	<input type="checkbox"/>	/
Tub Apron	/	<input type="checkbox"/>	<input type="checkbox"/>	/
Tub Surround	/	<input type="checkbox"/>	<input type="checkbox"/>	/
Shower Stall	*4x16" White Glossy 50-500&4x16" Taupe Glossy 50-604	<input type="checkbox"/>	<input type="checkbox"/>	/
Second Ensuite	8x10" Malena Ice	<input type="checkbox"/>	<input type="checkbox"/>	/
Bed #3,#4 & #5's Bath	8x10" Malena Ice	<input type="checkbox"/>	<input type="checkbox"/>	/
	/	<input type="checkbox"/>	<input type="checkbox"/>	/
Kitchen Backsplash	/	<input type="checkbox"/>	<input type="checkbox"/>	/
Complete Backsplash	/	<input type="checkbox"/>	<input type="checkbox"/>	/

## Comment

Install the wall tiles where applicable for the ens.#2, bathroom #4 & #5's on the 10" side horizontally in a 70/30 + - off set pattern. For the master ensuite please see invoice for details on how to install the wall tiles. Bed#3, 10" side horizontal "stacked"



horizontal stacked

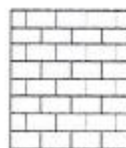

brick pattern



vertical stacked



diagonal diamond

## 5. Fireplace

	Living Room			Family Room			Other Room - Specify Great room		
	Purchased	As Per Plan	N/A	Purchased	As Per Plan	N/A	Purchased	As Per Plan	N/A
Fireplace Type	<input type="radio"/>	<input type="radio"/>	<input checked="" type="radio"/>	<input type="radio"/>	<input type="radio"/>	<input checked="" type="radio"/>	<input type="radio"/>	<input checked="" type="radio"/>	<input type="radio"/>
Mantle Type							Front Facing		
Over Mantle							NF-08		
Colour / Stain							/		
Surround							White		
Hearth							/		
Comment							/		



Initial:

SEE ATTACHED FOR SIGNATURES

Page 2 of 3



**Purchasers:** KULPREET KAUR MARWAH-KWATRA & ROOP  
**Telephone Res. / Bus:** /  
**Decor Advisor:** Barbara Coccia  
**Property:** 4 of Plan - Draft Approval SB17-03-08  
**Project:** Kingsmen (Thames) Inc.  
**Model and Elevation:** Windsor(6003)Elev C 5 BED-5+1 BATH

### 6. Trim Carpentry

**Door Hardware** \*\*UPG Halifax Sqaure Satin Nickel

**Interior Trim** STD

**Comment**

Please note the purchasers have upgraded all interior doors... see invoice for details.

#### Interior Doors

☐ 2 Panel Arch Top

☐ 2 Panel Square Top

☐ 6 Panel

SEE ATTACHED FOR SIGNATURES

Initial for Door Style \_\_\_\_\_

### 7. Railings and Pickets

**Railing Package** Standard Metal package

**Railing Colour** Elements Coho

**Wood Stairs** ☐ No ☒ Oak

**Picket Colour** Black

**Tread Colour** Elements Coho

**Comment**

/

### 8. Plaster Mouldings and Medallions

**Foyer** /

**Main Hall** /

**Living Room** /

**Dining Room** /

**Family Room** /

**Kitchen/Breakfast** /

**Den/Library** /

**Lower Landing** /

**Comment**

/

### 9. Wall Paint

Kingsmen White

#### Smooth Ceilings

☐ First Floor

☐ First Floor incl. Second Floor Hall

☐ First and Second Floor

☒ Throughout

☐ Not Applicable

**Trim Paint** Kingsmen White

### 10. Additional Comments

/

### 11. Disclaimers and Notes

- Colours of all materials are as close as possible to builder's selection, but not necessarily identical due to variances in manufacturing.
- Any extras listed above are null and void unless accompanied by a separate invoice/amendment. Said invoice must be paid in full.
- The Purchaser acknowledges that after Interior Colour Selection form is signed and dated, no further changes will be permitted other than re-selection due to unavailability. **Purchaser's Initials** SEE ATTACHED FOR SIGNATURES
- The Purchaser acknowledges reading and accepting the "Kingsmen Group Décor Centre Disclaimers" form. This document contains other miscellaneous disclaimers.

This Interior Colour Selection is final and approved by:

**Purchaser:**

Signature: SEE ATTACHED FOR SIGNATURES Date: \_\_\_\_\_

Signature: SEE ATTACHED FOR SIGNATURES Date: \_\_\_\_\_

**Vendor:** \_\_\_\_\_

Kingsmen (Thames) Inc.



OCT 13 2020

SCHEDULE "B-1"

Floor Plan

Sketch #1

THAMES LOT: 4 PH: 4B

4B-4

Model: Windsor(6003) Elev C 5 BED-6+1 BATH

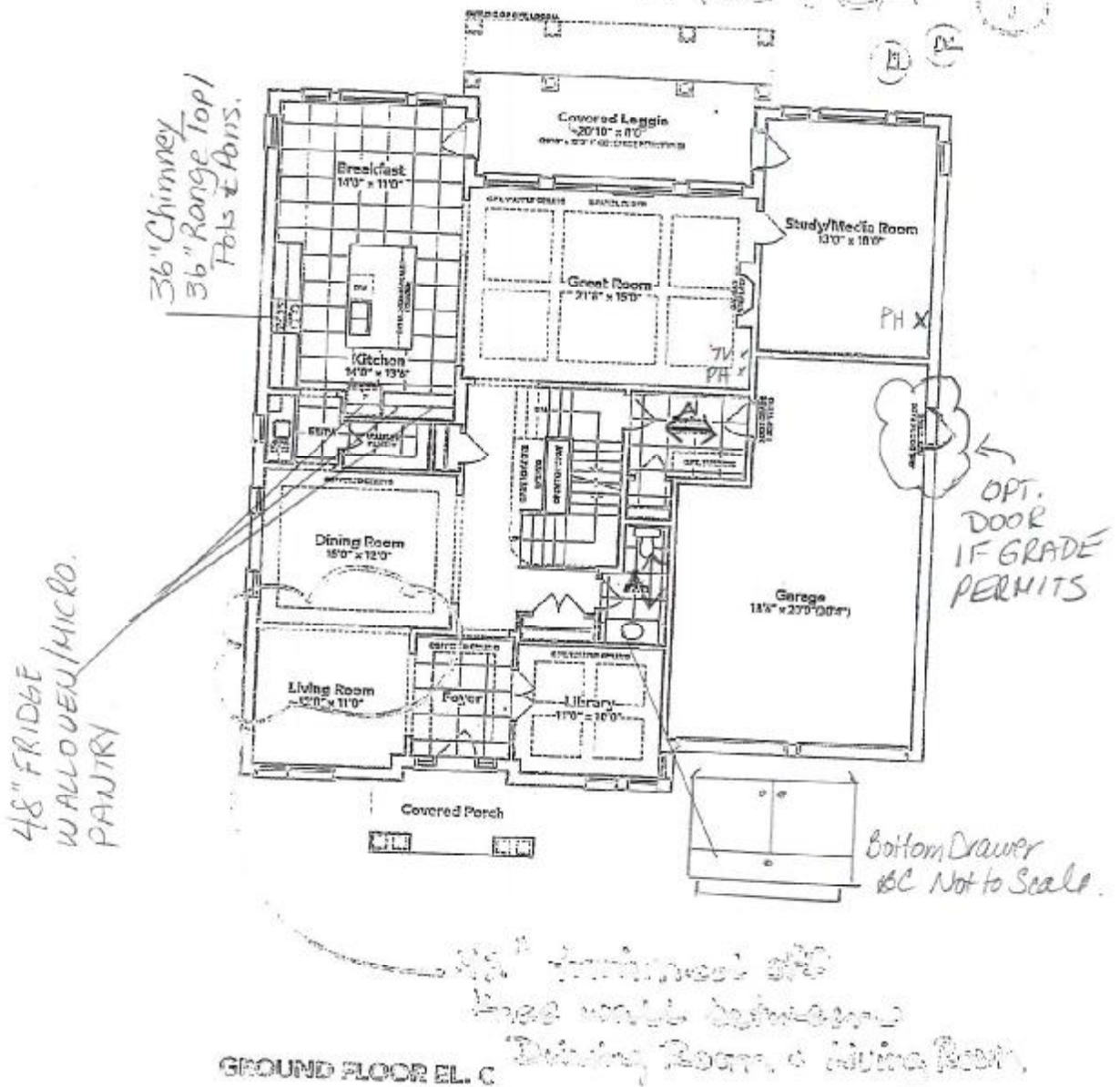

The floor plans and elevations shown are pre-construction plans and may be revised or improved as necessitated by architectural controls and the construction process. The measurements adhere to the rules and regulations of the TARIUM Warranty Corporation's official method for the calculation of floor area. Materials, specifications and floor plans are subject to change without notice. All house renderings are artist's concept only. Actual usable floor space may vary from the stated floor area. All options shown are upgrades. E. & O. E.

SCHEDULE "B-1" - Page 1 of 3

0018\_014-001 2/10/17

Initials: \_\_\_\_\_

(A) = direction of 12x24" floor tile STACKED

*[Signature]*  
*[Signature]*

OCT 13 2020

Kitchen - LOT 4

Thomas PH 4B

Refrigerator  
Stove  
Sinks

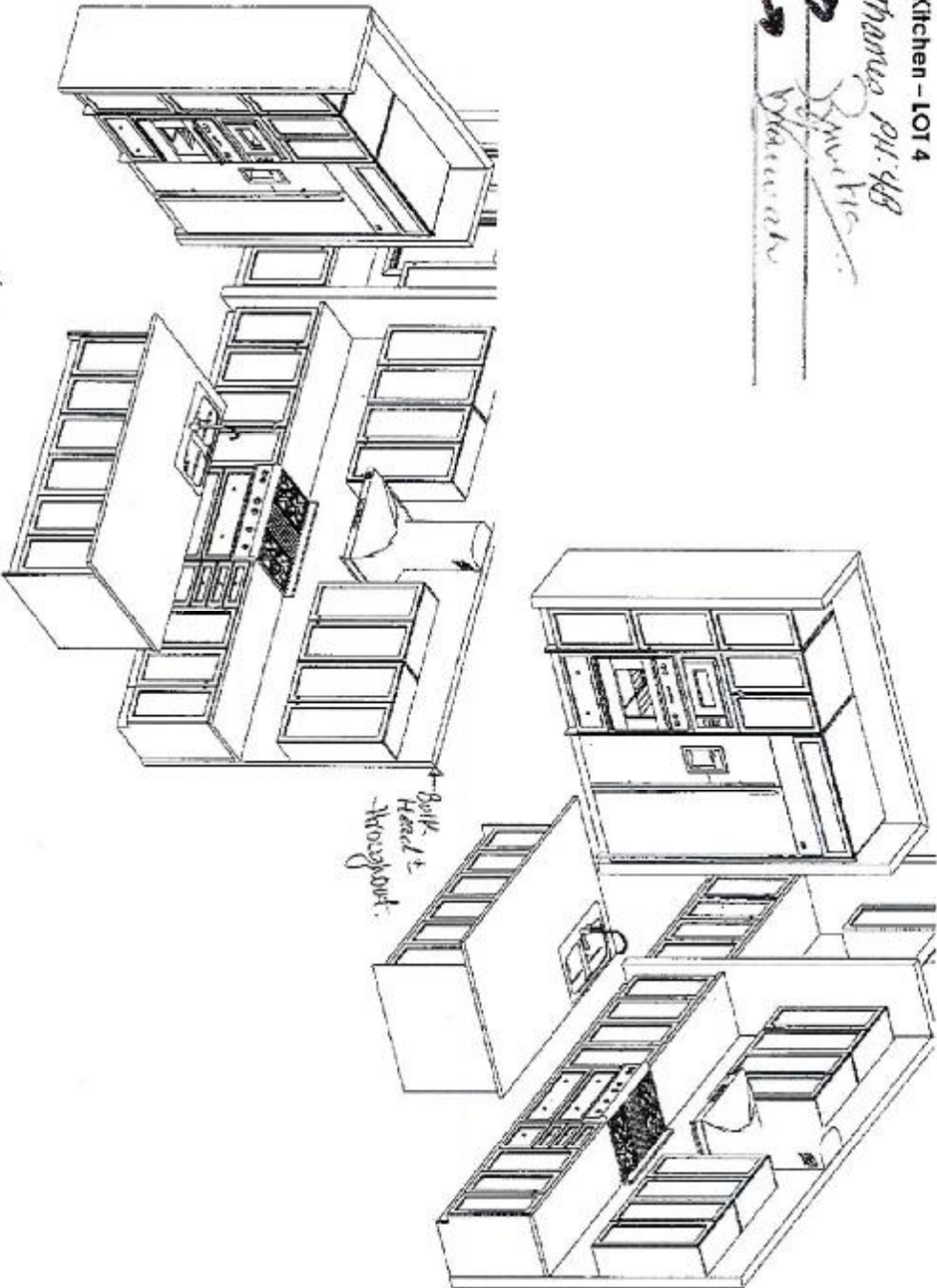

Bulk  
Head &  
Worktop

\*This sketch is for DESIGN PURPOSES ONLY - It is not meant to be an exact rendition.



F R E N D E L  
K I T C H E N  
1 1 9 3 1 1 8  
1800-234-2345

Kingsmen  
Havelock Commons PH 4  
(Woodstock)  
Windsor/6003



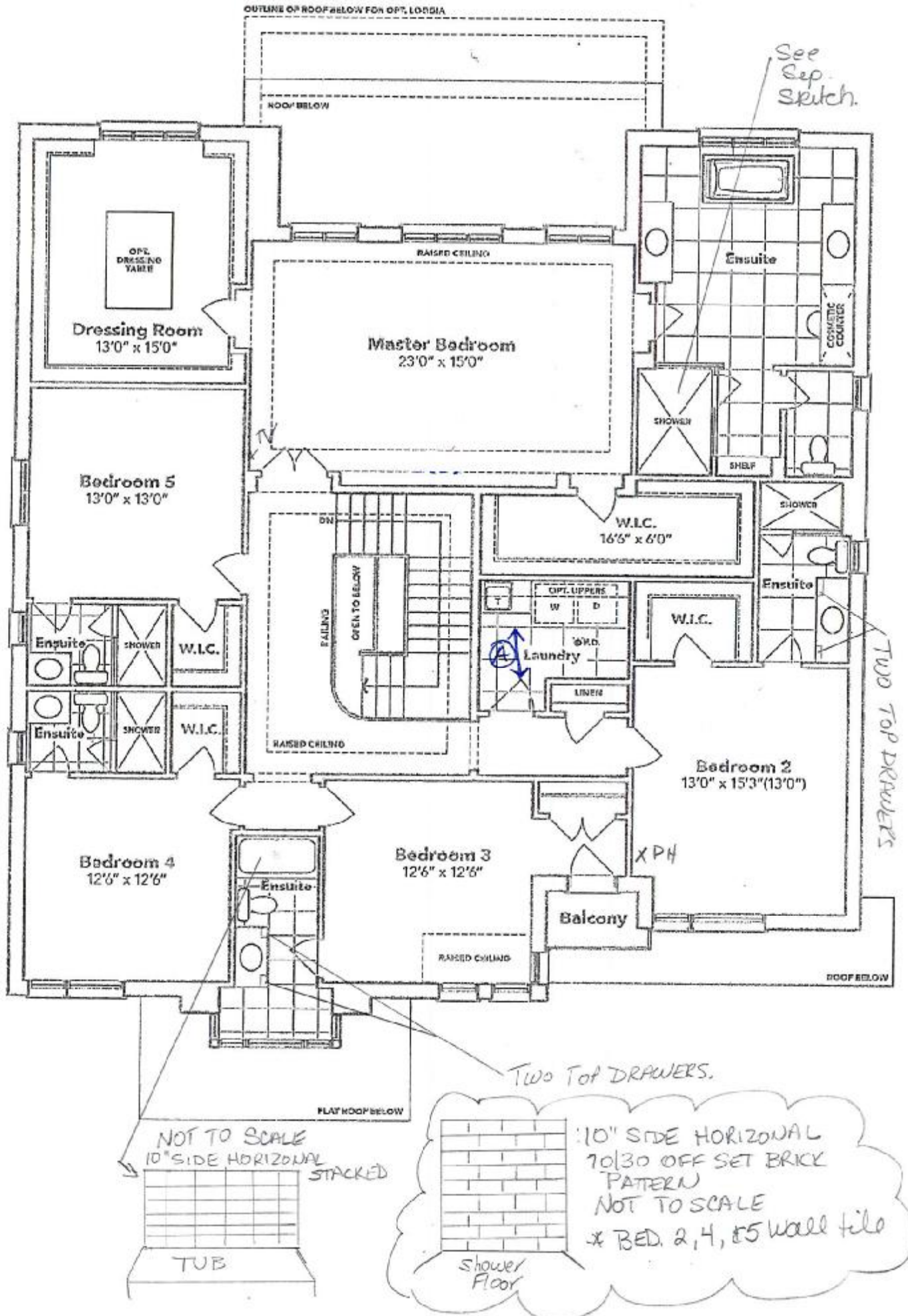

## SECOND FLOOR EL. C

*Source*

*Sketch #3*

*Mayan*

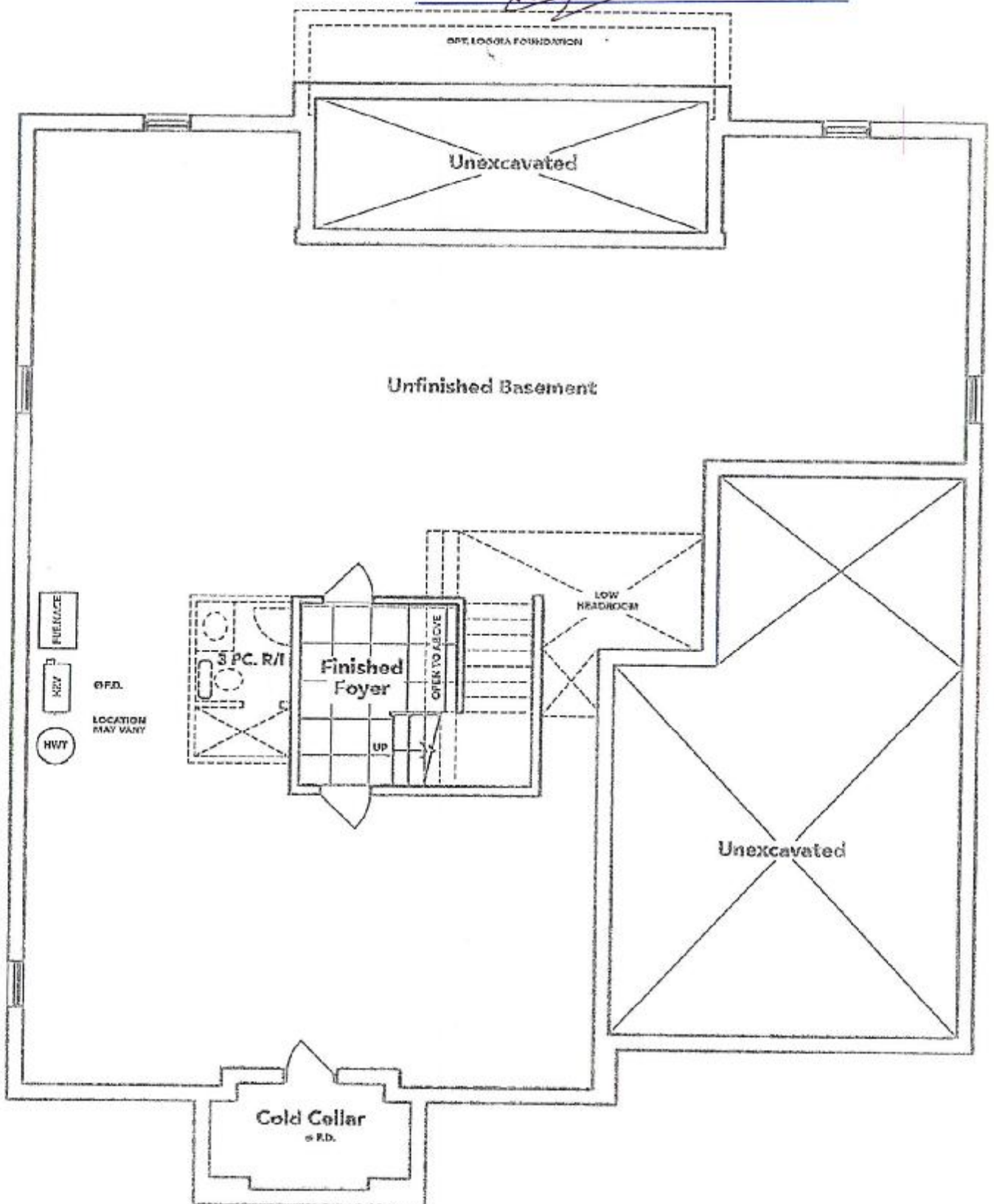

## BASEMENT EL. C

The floor plans and elevations shown are pre-construction plans and may be revised or improved as necessitated by architectural controls and the construction process. The measurements adhere to the rules and regulations of the TARION Warranty Corporation.



LOT: 4 Thames PH: 4B

OCT 13 2020

Re: Master Ens. Shower Wall/Ceiling

\* Not to Scale \*

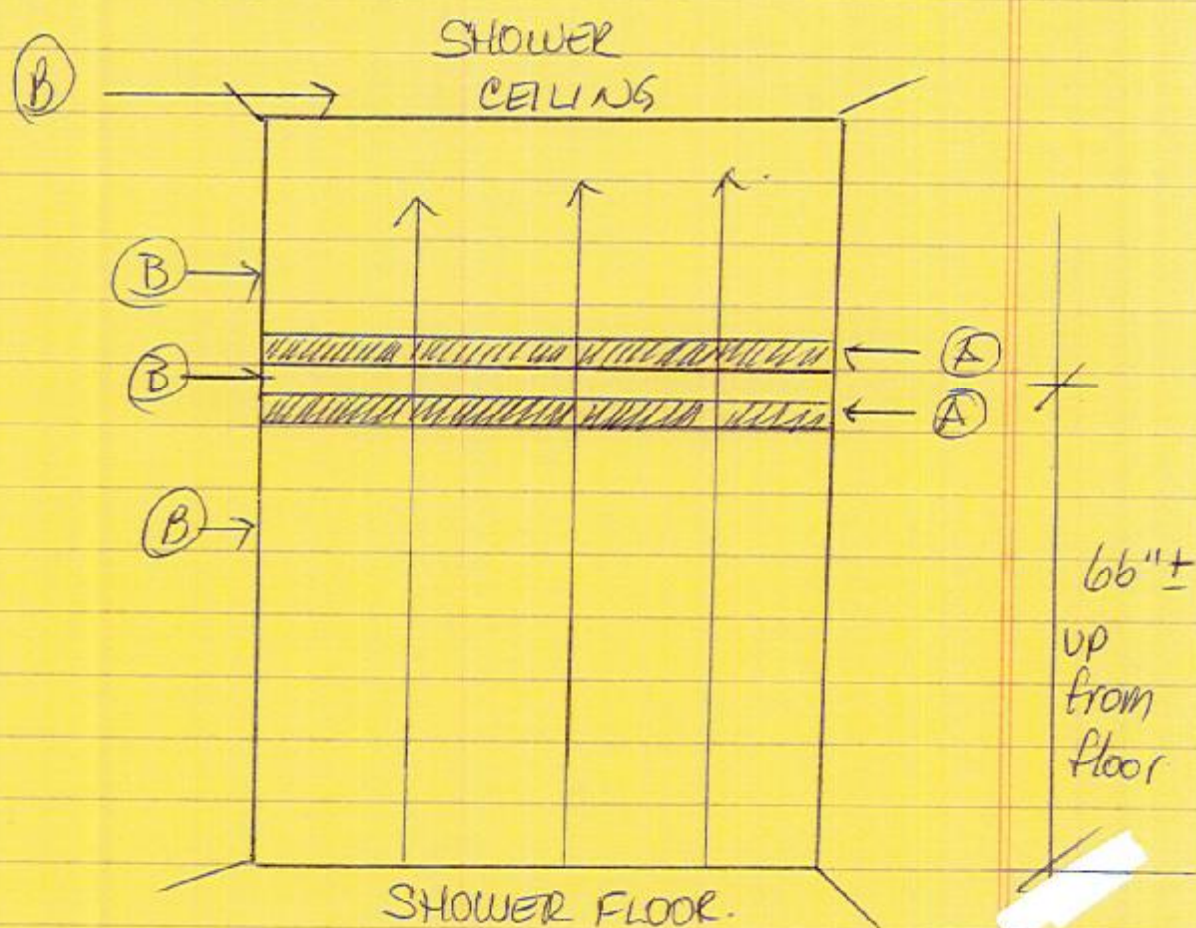

(A) = 4x16" Taupe Glossy 50-604 "STACKED"

(B) = 4x16" White Glossy 50-500 "STACKED"

Donna,

Kanwah

4B-4

OCT 13 2020

Lot: 4 Thames PH:4B.  
Re: UPG. 36" Chimney hood fan.

Specifications

- Air Flow Volume: 650 CFM
- Electrical Connection: 120V/60Hz
- Power Consumption: 240 Watts
- Current: 2.0 Amps
- Fan Speed: 1599 RPM
- Finishes: Stainless Steel
- Duct: 6" Round
- Knock-out: 6" Round - Top Only
- Dimensions: Width: 30"/36"  
Height: 44 1/2"  
Depth: 19 3/4"
- Noise Level: Min. 2 Sones  
Max. 7 Sones

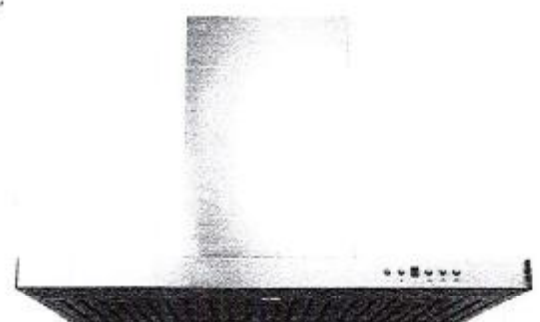

SCB722 - Baffle Filter



Ordering Model Chart

Model	Colour	Knock-out	Duct	Size	Filter	CFM
<del>SCB72230</del>	<del>Stainless Steel</del>	<del>6"</del>	<del>6" Round</del>	<del>30"</del>	<del>Baffle</del>	<del>650</del>
SCB72236	Stainless Steel	6"	6" Round	36"	Baffle	650

Notes

\_\_\_\_\_

\_\_\_\_\_

\_\_\_\_\_

\_\_\_\_\_

\_\_\_\_\_

\_\_\_\_\_

\_\_\_\_\_





OCT 13 2020

4B-4

Lot: 4 Thames PH: 4B

Re: Upg. Kitchen Sink

\* Still to Install Std. Single hole faucet \*

QUATRUS®  
Undermount

*[Signature]*

*[Signature]*

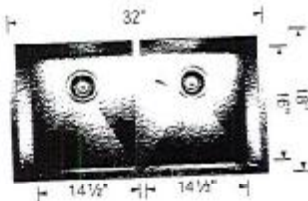

Undermount  
Minimum Cabinet Size\*  
35" (915 mm)  
Bowl Depth  
9" (229 mm)  
Cubed Weight  
55 lb. (25 kg)

401247

S 888

4B-4

OCT 13 2020

Lot: 4 Thames PH: 4B  
Re: Upg. Undermount Vanity Sinks for  
Mastr, Bed #2's, #3's, #4's & #5's Bathrooms.  
\*Still to Install Std. faucets\*.

*[Signature]*

*[Signature]*

**KINGSIIEN**

GROUP INC.

## Main Floor Vanity Display

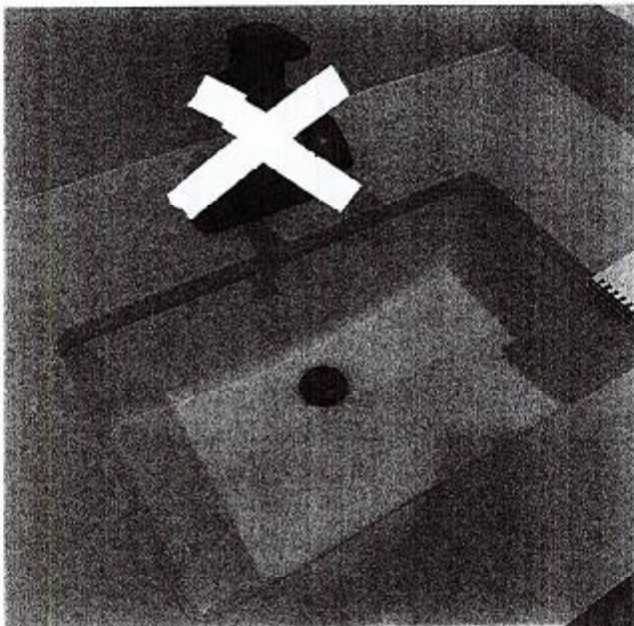

### DISPLAY ITEMS

#### Sink ( Item 9)

Contrac Catena Undermount  
Model 4210CIY



4B-4

OCT 13 2020

Lot: 4 Thomas PH: 4A  
Re: Upg. Free standing tub for Master Ens.

*[Signature]*

*[Signature]*



Brooke™ | 1

## Brooke™

Categories: Acrylic Freestanding

### DESCRIPTION

68" Freestanding Bath  
SKU #: CF2002

### FEATURES

- Installation friendly two piece design
- Accepts deck mounted faucet
- Includes a chrome integral pop up drain and rectangular overflow
- ~~Brushed nickel drain and overflow~~
- Centre drain
- Includes levelling feet
- Available in White Only



### DIMENSIONS

68" x 36" x 23"

## OPTIONS & ACCESSORIES

### SOAKER

CF2002



# 36" GAS PROFESSIONAL RANGETOP

Lot #4  
Thames  
4B

## Signature Features

### 15 RANGETOP CONFIGURATIONS

With 15 unique configurations, it's up to you. Infused with chrome, our griddle cleans up well after heavy usage. Fire up the grill for indoor entertainment on your terms.

### HALO-EFFECT KNOBS

A halo of luminary LEDs glows softly when the burner is lit or the oven is on.

### DUAL-STACKED POWERBURNERS

Two stacked, symmetrical flames bloom and retreat at your inclination, offering total control over heat levels. High-heat searing and wok cooking. Low, slow simmer and melt. Infinite intermediate settings satisfy every appetite.

JGCP436H

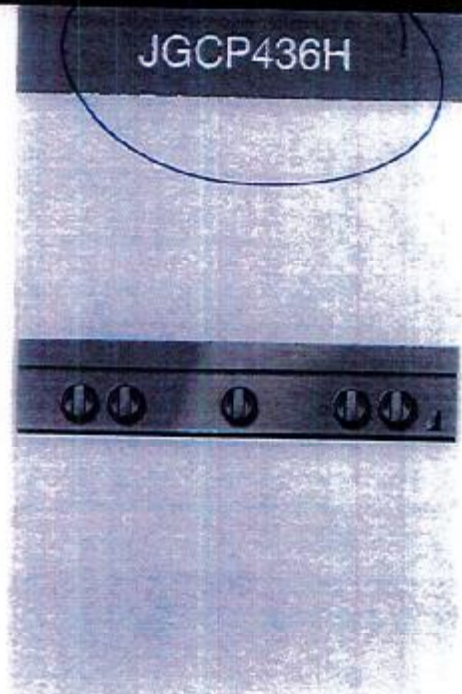

## Feature Listing

### PERFORMANCE FEATURES

#### Dual-Stacked PowerBurners

20,000 BTU Dual-Stacked PowerBurner

18,000 BTU Dual-Stacked PowerBurner

9,000 BTU Dual-Stacked PowerBurner

Electronic Ignition with Flame-Sensing™ Re-ignition

### CONTROL FEATURES

Halo-Effect Knobs

### DESIGN FEATURES

15 Rangertop Configurations

Cast Iron Grates

### OPTIONAL ACCESSORIES

Gas Connector Kit (Required) - 30-48KITRC

High Altitude Kit (Natural Gas) - W10160841

High Altitude Kit (LP Gas) - W10237848

9" Stainless Steel Backsplash - W10115776

Stainless Steel Backsplash with Two Shelves (36") - W10285448

Wok Ring - W10216179

Atfresh™ Kitchen & Appliance Cleaner, 18 oz. - W10366010



## Style Options

Thames PH 4B - Lot 4  
RE: Appliance Spec's



LIMITED  
WARRANTY

Bold = Top Features

JENN-AIR®

4B-4

JENNAIR® DIMENSIONS  
RANGETOPS  
PRODUCT

OCT 13 2020

	30" RANGETOP JGCP430H	36" RANGETOP JGCP436H	48" RANGETOP JGCP548H
Overall Width (A)	29-3/4" (75.6 cm)	35-3/4" (90.8 cm)	47-7/8" (121.6 cm)
Grate Depth (B)	22" (55.9 cm)	22" (55.9 cm)	22" (55.9 cm)
Depth without Control Panel (C)	23-1/4" (59.1 cm)	23-1/4" (59.1 cm)	23-1/4" (59.1 cm)
Depth with Control Panel Overhang (D)	27-1/2" (69.9 cm)	27-1/2" (69.9 cm)	27-1/2" (69.9 cm)
Depth with Knobs: RISE™ (E)	29-1/8" (74 cm)	29-1/8" (74 cm)	29-1/8" (74 cm)
Depth with Knobs: NOIR™ (E)	29" (73.7 cm)	29" (73.7 cm)	29" (73.7 cm)

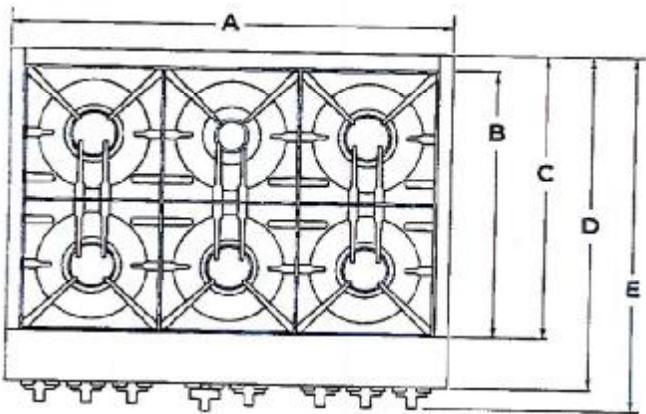

TOP VIEW

pk

KK

Thames PH 4B – Lot 4  
RE: Appliance Spec's



**IMPORTANT:** Dimensional specifications are provided for planning purposes only. Do not make any cutouts based on this information. Refer to the Installation Guide before selecting cabinetry, verifying electrical/gas connections, making cutouts or beginning installation. All JennAir® appliances are appropriately UL, CUL or CSA approved.



JENNAIR® DIMENSIONS

RANGETOPS

PRODUCT

PK

KK

	30" RANGETOP JGCP430H	36" RANGETOP JGCP436H	48" RANGETOP JGCP548H
Grate Width (F)*	27-7/16" (69.7 cm)	33" (83.8 cm)	44-3/8" (112.7 cm)
Gas Inlet to Surface (G)	10-3/4" (27.3 cm)	10-3/4" (27.3 cm)	10-3/4" (27.3 cm)
Center to Gas Inlet (H)	11" (27.9 cm)	14-1/8" (35.9 cm)	19-5/8" (49.8 cm)
Recessed Rangetop Width (I)	29-1/8" (74 cm)	35" (88.9 cm)	47-1/4" (120 cm)

\*Includes width of grates and griddle.

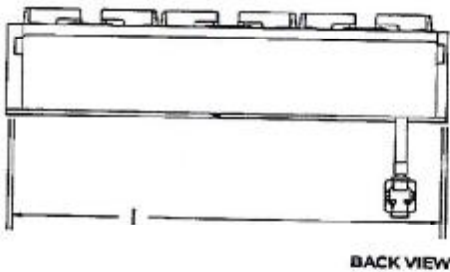
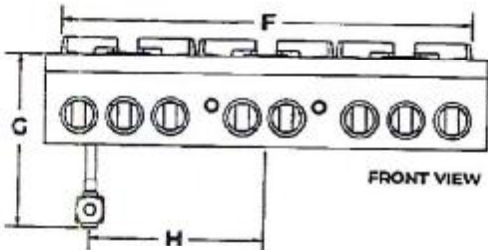

Thames PH 4B – Lot 4  
RE: Appliance Spec's



OCT 13 2020

JENNAIR® DIMENSIONS  
RANGETOPS  
PRODUCT

	30" RANGETOP JGCP430H	36" RANGETOP JGCP436H	48" RANGETOP JGCP548H
Height with Grates (J)	9" (22.9 cm)	9" (22.9 cm)	9" (22.9 cm)
Control Panel Height (K)	7-13/16" (19.8 cm)	7-13/16" (19.8 cm)	7-13/16" (19.8 cm)
Recessed Rangetop Height (L)	7" (17.8 cm)	7" (17.8 cm)	7" (17.8 cm)
Cooking Surface Height (M)	7-7/16" (18.9 cm)	7-7/16" (18.9 cm)	7-7/16" (18.9 cm)
Recessed Rangetop Depth (N)	21-7/8" (55.6 cm)	21-7/8" (55.6 cm)	21-7/8" (55.6 cm)
Depth with Control Panel (O)	25-1/2" (64.8 cm)	25-1/2" (64.8 cm)	25-1/2" (64.8 cm)

pu KK

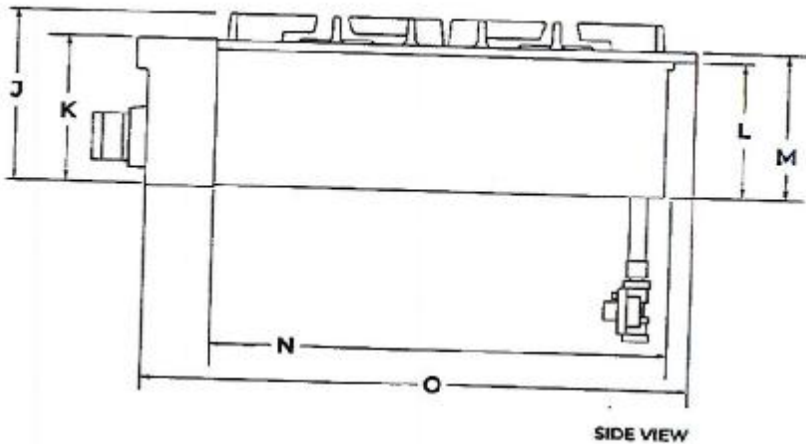

Thames PH 4B – Lot 4  
RE: Appliance Spec's

★ **IMPORTANT:** Supplied regulator does not come preattached and is pictured for reference purposes only.

4B-4

OCT 13 2020

JENNAIR® DIMENSIONS  
RANGETOPS  
OPENING AND CLEARANCE

	30" RANGETOP JGCP430H	36" RANGETOP JGCP436H	48" RANGETOP JGCP548H
Combustible Area Above Cooking Surface Width (A)	30" (76.2 cm) min.	36" (91.4 cm) min.	48" (121.9 cm) min.
Bottom of Cabinet Height Above Cooking Surface (B)*	42" (106.7 cm) min.	58" (147.3 cm) min.	58" (147.3 cm) min.
Bottom of Cabinet Height Above Countertop (C)	18" (45.7 cm) min.	18" (45.7 cm) min.	18" (45.7 cm) min.
Distance to Fixed Wall or Combustible Material (D)	12" (30.5 cm) min.	12" (30.5 cm) min.	12" (30.5 cm) min.

\*Dimension reduced by 6" (15.2 cm) when bottom of wood or metal cabinet is covered by at least 1/4" (0.6 cm) flame retardant millboard, which is in turn covered with at least No. 28 MSG sheet metal, 0.015" (0.4 mm) stainless steel, 0.024" (0.6 mm) aluminum or 0.020" (0.5 mm) copper. If installing a hood above the rangetop, follow the hood instructions for dimensional clearances above the cooking surface.

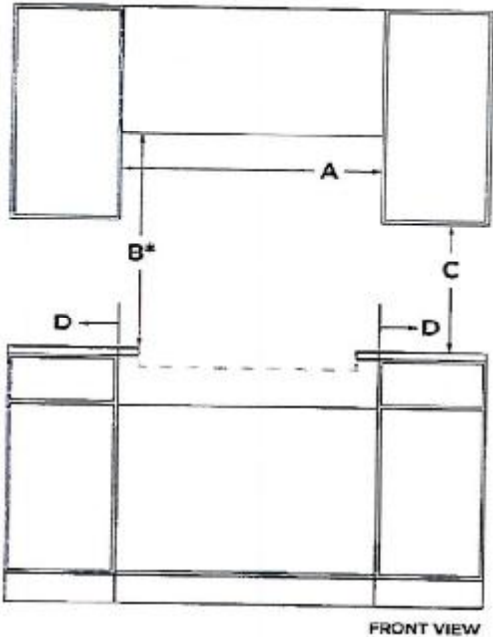

pu

KK

Thames PH 4B – Lot 4  
RE: Appliance Spec's

4B-4

OCT 13 2020

JENNAIR® DIMENSIONS  
RANGETOPS  
OPENING AND CLEARANCE

	30" RANGETOP JGCP430H	36" RANGETOP JGCP436H	48" RANGETOP JGCP548H
Recommended Upper Cabinet Depth (E)	13" (33 cm)	13" (33 cm)	13" (33 cm)
Cutout to Wall Depth (F)*	1-1/2" (3.8 cm) min.	1-1/2" (3.8 cm) min.	1-1/2" (3.8 cm) min.
Cabinet to Countertop Height (G)	7-1/4" (18.4 cm)	7-1/4" (18.4 cm)	7-1/4" (18.4 cm)
Cabinet Depth (H)	24" (61 cm)	24" (61 cm)	24" (61 cm)

\*If the back wall is constructed of a combustible material and a backsplash is not installed, a 7-1/2" (19.1 cm) minimum clearance is required from the cutout or 6" (15.2 cm) minimum clearance from the back edge of the rangetop.

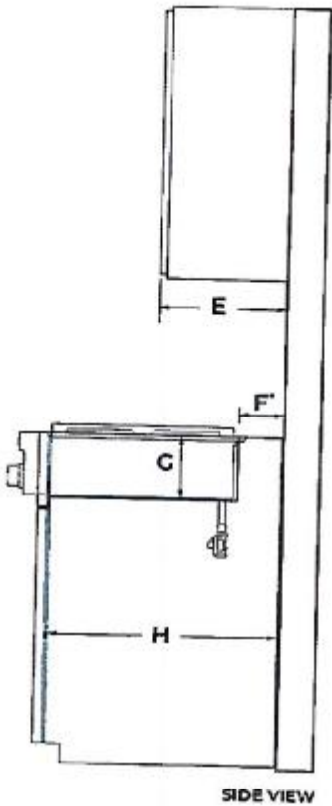

pk

KK

Thames PH 4B – Lot 4  
RE: Appliance Spec's

OCT 13 2020

JENNAIR® DIMENSIONS  
RANGETOPS  
OPENING AND CLEARANCE

	30" RANGETOP JGCP430H	36" RANGETOP JGCP436H	48" RANGETOP JGCP548H
Countertop and Cabinet Cutout Width (I)	29-1/4" (74.3 cm)	35-1/4" (89.5 cm)	47-3/8" (120.3 cm)
Countertop and Cutout Depth (J)	22-1/4" (56.5 cm)	22-1/4" (56.5 cm)	22-1/4" (56.5 cm)
Notch Width (K)	5/16" (0.8 cm)	5/16" (0.8 cm)	5/16" (0.8 cm)
Cutout Width (L)	29-7/8" (75.9 cm)	35-3/4" (90.8 cm)	47-7/8" (121.6 cm)

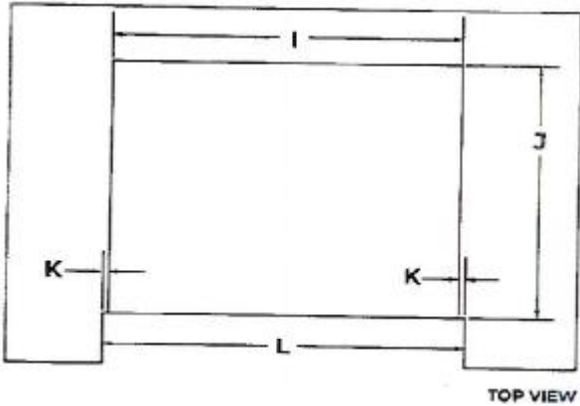

PH KK



4B-4

OCT 13 2020

**JENNAIR® DIMENSIONS**  
**RANGETOPS**  
ELECTRICAL REQUIREMENTS

**ELECTRIC REQUIREMENTS CHECKLIST**

☐

A 120 volt, 60 Hz, AC only, 15-amp fused, electrical circuit is required.

☐

A dedicated circuit is recommended.

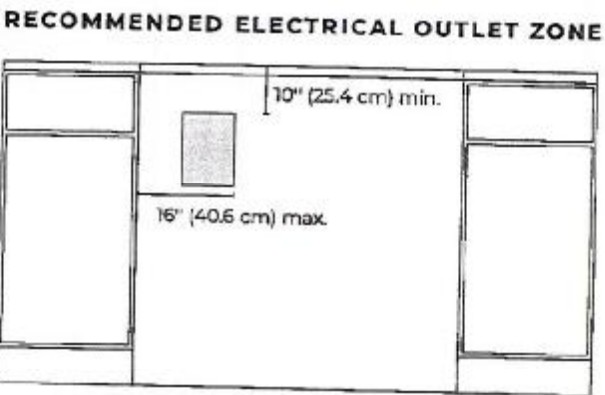

FRONT VIEW

PK

Thames PH 4B – Lot 4  
RE: Appliance Spec's

**IF YOU HAVE QUESTIONS ABOUT YOUR ELECTRICAL SUPPLY CALL A LICENSED, QUALIFIED ELECTRICIAN.**

OCT 13 2020

# JENNAIR® DIMENSIONS

## RANGETOPS

### GAS REQUIREMENTS

#### RECOMMENDED GAS SUPPLY LOCATION

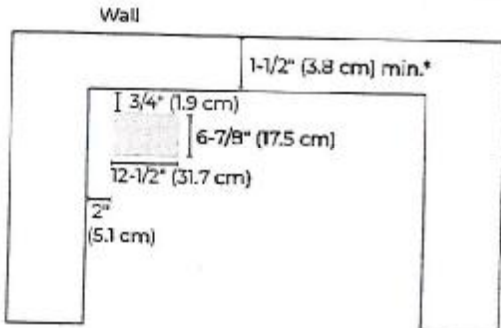

TOP VIEW

\*If the back wall is constructed of a combustible material and a backsplash is not installed, a 7-1/2" (19.1 cm) minimum clearance is required from the cutout or 6" (15.2 cm) minimum clearance from the back edge of the rangetop.

#### GAS SUPPLY ZONE

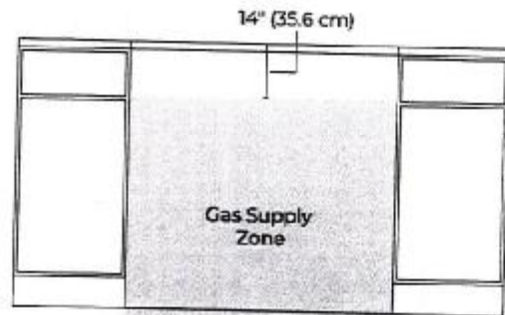

FRONT VIEW

pe

KK

Thames PH 4B – Lot 4  
RE: Appliance Spec's

? IF YOU HAVE QUESTIONS ABOUT YOUR GAS SUPPLY, CALL A LICENSED, QUALIFIED SERVICE TECHNICIAN.

4B-4

OCT 13 2020

JennAir® NOIR™ 30" BUILT-IN MICROWAVE OVEN WITH SPEED-COOK

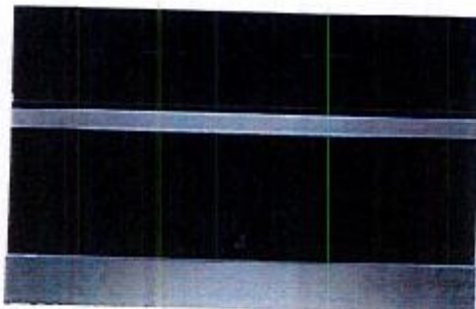

JMC2430IM

Available Finishes/Colours



JMC2430IM  
FA

per KK

Let your appetite run wild with microwave and convection energy. With curated recipes and full-color doneness images, an intelligent culinary experience awaits your touch.

- Top Features
- 4.3-Inch Full Color LCD Display
- Seamless Touches
- Stainless Steel Microwave Interior

- Manuals & Literature:
- Use and Care
  - Installation Instructions
  - Warranty

Thames PH 4B – Lot 4  
RE: Appliance Spec's



Because Whirlpool Corporation policy includes a continuous commitment to improve our products, we reserve the right to change materials and specifications without notice. Dimensions are for planning purposes only. For complete details, see installation instructions packed with product. Specifications subject to change without notice.





# INSTALLATION REQUIREMENTS

## Tools and Parts

Gather the required tools and parts before starting installation. Read and follow the instructions provided with any tools listed here.

### Tools Needed

- Phillips screwdriver
- Flat-blade screwdriver
- Measuring tape
- Level
- Drill (for wall cabinet installations)
- 1/8" (3 mm) drill bit (for wall cabinet installations)
- 1" (2.5 cm) drill bit (for wall cabinet installations)

### Parts Needed

- UL listed or CSA approved conduit connector
- UL listed wire connectors

### Parts Needed – Flush Installation

- W10801485 Stainless steel flush installation kit for 27" (68.6 cm) models
- W10801486 Stainless steel flush installation kit for 30" (76.2 cm) models
- W10801487 Black flush installation kit for 30" (76.2 cm) models

To order, see the "Assistance or Service" section of the Use and Care Guide.

### Parts Supplied

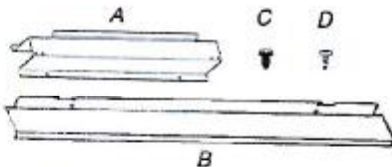

- A. Spacer bars (2)
- B. Bottom vent (1)
- C. 3/8" (9.5 mm) hex-head washer screws (4)
- D. 3/4" (1.9 cm) pan-head screws (4)

Check local codes. Check existing electrical supply. See "Electrical Requirements."

It is recommended that all electrical connections be made by a licensed, qualified electrical installer.

## Location Requirements

**IMPORTANT:** Observe all governing codes and ordinances.

- Cabinet opening dimensions that are shown must be used. Given dimensions provide minimum clearance with microwave oven.
- Recessed installation area must provide complete enclosure around the recessed portion of the microwave oven.
- Grounded electrical supply is required. See "Electrical Requirements" section.
- Electrical supply junction box should be located 3" (7.6 cm) maximum below the support surface when the microwave oven is installed in a wall cabinet. A 1" (2.5 cm) minimum diameter hole should have been drilled in the left rear corner of the support surface to pass the appliance cable through to the junction box.

- For installation above single built-in oven, the junction box must be located inside upper cabinet.
- If you are installing the junction box on rear wall behind the microwave oven, the junction box must be recessed and located in the upper or lower right or left corner of the cabinet; otherwise, the microwave oven will not fit into the cabinet opening.
- Microwave oven support surface must be solid, level, and flush with bottom of cabinet cutout. Floor must be able to support a weight of 108 lbs (49.0 kg).

**IMPORTANT:** To avoid damage to your cabinets, check with your builder or cabinet supplier to make sure that the materials used will not discolor, delaminate, or sustain other damage. This oven has been designed in accordance with the requirements of UL and CSA International and complies with the maximum allowable wood cabinet temperatures of 194°F (90°C).

### Product Dimensions

27" (68.6 cm) and 30" (76.2 cm) Microwave Ovens

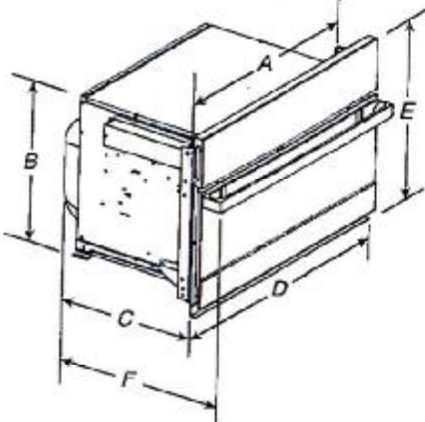

#### 27" (68.6 cm) models

- A. 25 3/16" (64.5 cm)
- B. 17 1/4" (44.1 cm)
- C. 22 11/16" (57.7 cm)
- D. 26 1/4" (66.0 cm) overall width
- E. 14 1/8" (50.3 cm) overall height
- F. JMC2427IM: 25 3/16" (64.9 cm)  
JMC2427IL: 24 1/4" (62.9 cm)

#### 30" (76.2 cm) models

- A. 29 1/8" (72.1 cm)
- B. 17 1/8" (44.1 cm)
- C. 22 11/16" (57.7 cm)
- D. 29 1/4" (75.6 cm) overall width
- E. 19 7/8" (50.3 cm) overall height
- F. JMC2430IM: 25 3/16" (64.9 cm)  
JMC2430IL: 24 1/4" (62.9 cm)

27" (68.6 cm) and 30" (76.2 cm) Microwave Oven Spacer Kit

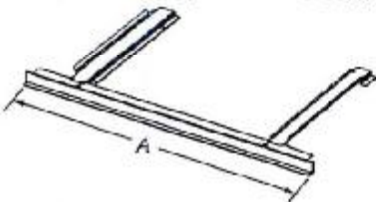

#### 27" (68.6 cm) models

- A. 26 1/4" (67.9 cm) overall width

#### 30" (76.2 cm) models

- A. 29 1/4" (75.6 cm) overall width

**NOTE:** The microwave oven spacer kit will allow the microwave oven to be installed in a 17 1/8" to 17 3/4" (44.1 to 45.1 cm) maximum cutout height.

Thames PH 4B – Lot 4  
RE: Appliance Spec's



INSTALLATION INSTRUCTIONS  
27" (68.6 CM) AND 30" (76.2 CM) ELECTRIC  
BUILT-IN MICROWAVE OVEN FLUSH  
INSTALLATION KIT

INSTRUCTIONS D'INSTALLATION  
POUR ENSEMBLE D'INSTALLATION EN  
AFFLEUREMENT DE FOUR À MICRO-ONDES  
ÉLECTRIQUE ENCASTRÉ DE 27" (68,6 CM)  
ET 30" (76,2 CM)

27" (68.6 cm) Flush Installation Kits Ensembles d'installation en affleurement de 27" (68,6 cm)			
Model#/ Modèle n°	Stainless Steel Acier inoxydable	Stainless Steel/ Acier inoxydable, RISE™/NOIR™	
	Kit PN/ Ensemble référence: W10801485	Kit PN/ Ensemble référence: W11358283	
JMC2427DS	**	*	
JMC2427IM, JMC2427IL	*	**	

30" (76.2 cm) Flush Installation Kits Ensembles d'installation en affleurement de 30" (76,2 cm)			
Model#/ Modèle n°	Black Noir	Stainless Steel/ Acier inoxydable	Stainless Steel/ Acier inoxydable, RISE™/NOIR™
	Kit PN/ Ensemble référence: W10801487	Kit PN/ Ensemble référence: W10801486	Kit PN/ Ensemble référence: W11358282
JMC2430DB	**	*	*
JMC2430DP, JMC2430DS	*	**	*
JMC2430IM, JMC2430IL	*	*	**

\* Approved for use.  
\*\* Recommended color and approved for use.  
\* Approuvé pour l'utilisation.  
\*\* Couleur recommandée et approuvé pour l'utilisation.

Table of Contents/ Table des matières	
BUILT-IN MICROWAVE OVEN SAFETY.....	2
INSTALLATION REQUIREMENTS.....	2
Tools and Parts.....	2
Location Requirements.....	2
INSTALLATION INSTRUCTIONS.....	4
Prepare Built-In Oven.....	4
Install Spacer Kit.....	4
Install Microwave Oven.....	4
Complete Installation.....	4
SÉCURITÉ DU FOUR À MICRO-ONDES ENCASTRÉ.....	5
EXIGENCES D'INSTALLATION.....	5
Outils et pièces.....	5
Exigences d'emplacement.....	5
INSTRUCTIONS D'INSTALLATION.....	7
Assemblage de la trousse d'entretoise.....	7
Installation de la trousse d'entretoise.....	7
Installation du four à micro-ondes.....	7
Achever l'installation.....	7

IMPORTANT:  
Save for local electrical inspector's use.  
IMPORTANT:  
À conserver pour consultation par l'inspecteur local des installations électriques.  
W11356316A

06-May-2019 13:38:40 EDT | RELEASED

In some European factories the letter "W" of the part code mentioned herein will be automatically replaced by the number "4000" (e.g. "W12345678" becomes "400012345678")

Thames PH 4B – Lot 4  
RE: Appliance Spec's

Cabinet Dimensions - Flush Installation

A 23 1/4" (59 cm) minimum cutout depth is required. These dimensions will result in a 1/4" (6.3 mm) reveal on the top, a 1/4" (6.3 mm) reveal on the sides, and a 1/8" (3.1 mm) reveal on the bottom of the microwave oven. The front face of the cleats and platform will be visible and should be treated as a finished surface.

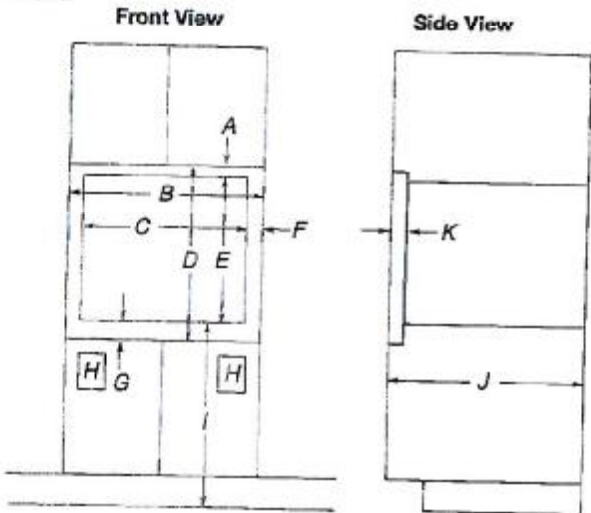

27" (68.6 cm) Models

- A. 1 3/16" (4.7 cm) top cleat\*
- B. 27 1/4" (69.2 cm) minimum width of flush inset cutout
- C. 25 1/8" (65.7 cm) minimum width of opening
- D. 20 1/8" (51.3 cm) minimum height of flush inset cutout
- E. 17 1/8" (44.7 cm) recommended cutout height
- F. 1 1/16" (1.7 cm) side cleat\*
- G. 3/4" (1.9 cm) bottom cleat\*
- H. Recommended junction box location
- I. 40" (101.6 cm) bottom of cutout to floor (recommended)
- J. 23 1/4" (59.0 cm) minimum depth of cutout
- K. 1 3/8" (3.5 cm) recess from front of cabinet

30" (76.2 cm) Models

- A. 1 3/16" (4.7 cm) top cleat\*
- B. 30 1/4" (76.8 cm) minimum width of flush inset cutout
- C. 28 1/8" (70.8 cm) minimum width of opening
- D. 20 1/8" (51.3 cm) minimum height of flush inset cutout
- E. 17 1/8" (44.7 cm) recommended cutout height
- F. 1 1/16" (1.7 cm) side cleat\*
- G. 3/4" (1.9 cm) bottom cleat\*
- H. Recommended junction box location
- I. 40" (101.6 cm) bottom of cutout to floor (recommended)
- J. 23 1/4" (59.0 cm) minimum depth of cutout
- K. 1 3/8" (3.5 cm) recess from front of cabinet

\*Cleats must be recessed 1 3/8" (3.5 cm) from the front of the cabinet.

Minimum Installation Clearances

For proper installation, the following minimum clearances must exist below the cabinet opening.

Installation Above Single Built-In Oven

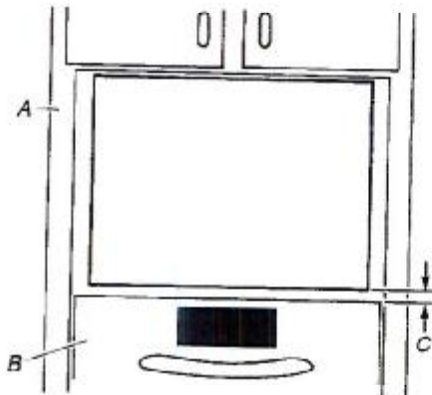

- A. Upper cabinet
- B. Lower single oven\*
- C. 1" (2.5 cm) from top of oven



Thames PH 4B - Lot 4  
RE: Appliance Spec's



## INSTALLATION INSTRUCTIONS

### Prepare Built-In Oven

1. Attach bottom vent to spacer bars using four 3/8" (9.5 mm) hexhead washer screws.

**NOTE:** Spacer bar flanges should be facing out.

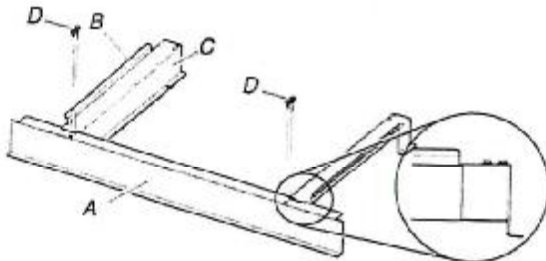

A. Bottom vent  
B. Spacer bar flange  
C. Spacer bars  
D. 3/8" (9.5 mm) hex-head washer screws

### Install Spacer Kit

1. Center assembled microwave oven spacer kit against lower, front edge of the cabinet cutout.
2. Using an 1/8" (3.1 mm) drill bit, drill through the mounting holes in the spacer bars to create pilot holes.
3. Attach the assembled spacer kit to the cabinet using four 3/4" (1.9 cm) pan-head screws provided. Do not overtighten screws.

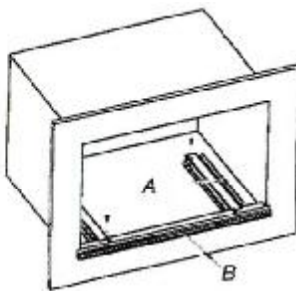

A. 3/4" (1.9 cm) pan-head screws  
B. Spacer kit assembly

### Install Microwave Oven

Follow the instructions below along with the instructions in the Electric Built-In Microwave Oven Installation Instructions.

Read the "Electrical Requirements" and "Electrical Connection" sections, along with all other sections of the Installation Instructions, before installing the microwave oven.

### ⚠ WARNING

#### Excessive Weight Hazard

Use two or more people to move and install microwave oven.

Failure to do so can result in back or other injury.

1. Using 2 or more people, lift the microwave oven partially into the cabinet cutout above the spacer kit. Place microwave oven in between the spacer bar flanges.

**NOTE:** When pushing the microwave oven into the cabinet, open the microwave oven door and push against the seal area on the front frame. Do not push against the outside edges.

2. Push against the front frame of the microwave oven to push oven into cabinet. Push microwave oven completely into cabinet and center in cabinet cutout.

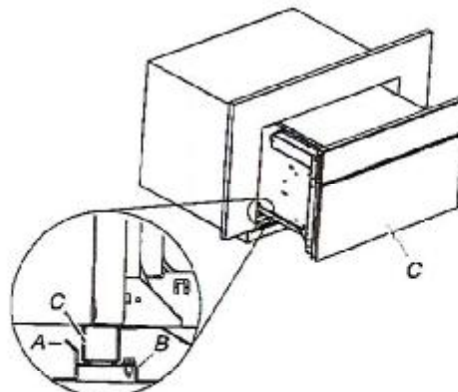

A. Spacer bar flange  
B. Spacer bar  
C. Microwave oven

### Complete Installation

1. Check that all parts are now installed. If there is an extra part, go back through the steps to see which step was skipped.
2. Check that you have all of your tools.
3. Dispose of/recycle all packaging materials.

#### If you need Assistance or Service:

Please reference the "Assistance or Service" section of the Use and Care Guide or contact the dealer from whom you purchased your built-in microwave oven spacer kit.

## INSTALLATION REQUIREMENTS

### Tools and Parts

Gather the required tools and parts before starting installation. Read and follow the instructions provided with any tools listed here.

#### Tools Needed

- Phillips screwdriver
- Flat-blade screwdriver
- Measuring tape
- Level
- Drill (for wall cabinet installations)
- 1/8" (3 mm) drill bit (for wall cabinet installations)
- 1" (2.5 cm) drill bit (for wall cabinet installations)

#### Parts Needed

- UL listed or CSA approved conduit connector
- UL listed wire connectors

#### Parts Needed – Flush Installation

- W10801485 Stainless steel flush installation kit for 27" (68.6 cm) models
- W10801486 Stainless steel flush installation kit for 30" (76.2 cm) models
- W10801487 Black flush installation kit for 30" (76.2 cm) models

To order, see the "Assistance or Service" section of the Use and Care Guide.

#### Parts Supplied

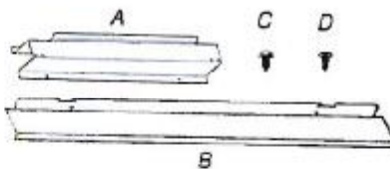

- A. Spacer bars (2)
- B. Bottom vent (1)
- C. 3/8" (9.5 mm) hex-head washer screws (4)
- D. 3/4" (1.9 cm) pan-head screws (4)

Check local codes. Check existing electrical supply. See "Electrical Requirements."

It is recommended that all electrical connections be made by a licensed, qualified electrical installer.

### Location Requirements

**IMPORTANT:** Observe all governing codes and ordinances.

- Cabinet opening dimensions that are shown must be used. Given dimensions provide minimum clearance with microwave oven.
- Recessed installation area must provide complete enclosure around the recessed portion of the microwave oven.
- Grounded electrical supply is required. See "Electrical Requirements" section.
- Electrical supply junction box should be located 3" (7.6 cm) maximum below the support surface when the microwave oven is installed in a wall cabinet. A 1" (2.5 cm) minimum diameter hole should have been drilled in the left rear corner of the support surface to pass the appliance cable through to the junction box.

- For installation above single built-in oven, the junction box must be located inside upper cabinet.
- If you are installing the junction box on rear wall behind the microwave oven, the junction box must be recessed and located in the upper or lower right or left corner of the cabinet; otherwise, the microwave oven will not fit into the cabinet opening.
- Microwave oven support surface must be solid, level, and flush with bottom of cabinet cutout. Floor must be able to support a weight of 108 lbs (49.0 kg).

**IMPORTANT:** To avoid damage to your cabinets, check with your builder or cabinet supplier to make sure that the materials used will not discolor, delaminate, or sustain other damage. This oven has been designed in accordance with the requirements of UL and CSA International and complies with the maximum allowable wood cabinet temperatures of 194°F (90°C).

#### Product Dimensions

27" (68.6 cm) and 30" (76.2 cm) Microwave Ovens

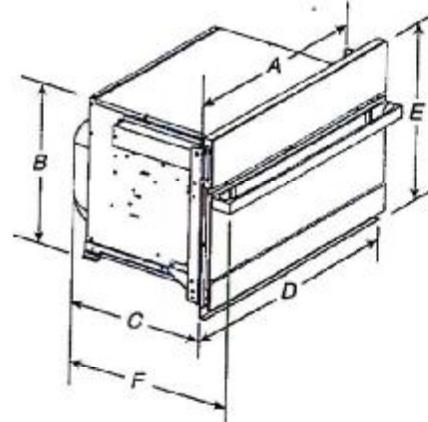

#### 27" (68.6 cm) models

- A. 25 1/4" (64.5 cm)
- B. 17 1/4" (44.1 cm)
- C. 22 1/4" (57.7 cm)
- D. 26 1/4" (68.6 cm) overall width
- E. 19 1/4" (50.3 cm) overall height
- F. JMC2427IM: 25 1/4" (64.9 cm)
- JMC2427IL: 24 1/4" (62.9 cm)

#### 30" (76.2 cm) models

- A. 28 1/4" (72.1 cm)
- B. 17 1/4" (44.1 cm)
- C. 22 1/4" (57.7 cm)
- D. 29 1/4" (75.6 cm) overall width
- E. 19 1/4" (50.3 cm) overall height
- F. JMC2430IM: 25 1/4" (64.9 cm)
- JMC2430IL: 24 1/4" (62.9 cm)

27" (68.6 cm) and 30" (76.2 cm) Microwave Oven Spacer Kit

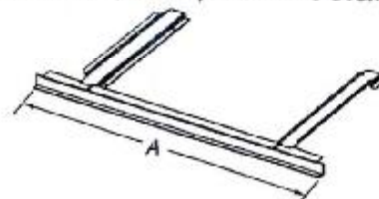

#### 27" (68.6 cm) models

- A. 26 1/4" (67.9 cm) overall width

#### 30" (76.2 cm) models

- A. 29 1/4" (75.6 cm) overall width

**NOTE:** The microwave oven spacer kit will allow the microwave oven to be installed in a 17 3/4" to 17 1/4" (44.1 to 45.1 cm) maximum cutout height.

Thames PH 4B – Lot 4  
RE: Appliance Spec's



A microwave oven spacer kit is available from your dealer that will allow the microwave oven to be installed in a 19" to 19<sup>13/16</sup>" (48.3 to 50.2 cm) maximum cutout height. Match the oven size to the following kits:

- 27" (68.6 cm) Stainless Steel – Model W10469901
- 30" (76.2 cm) Stainless Steel – Model W10469903

To order, see the "Assistance or Service" section of the Use and Care Guide.

#### Cabinet Dimensions

27" (68.6 cm) and 30" (76.2 cm) Microwave Ovens

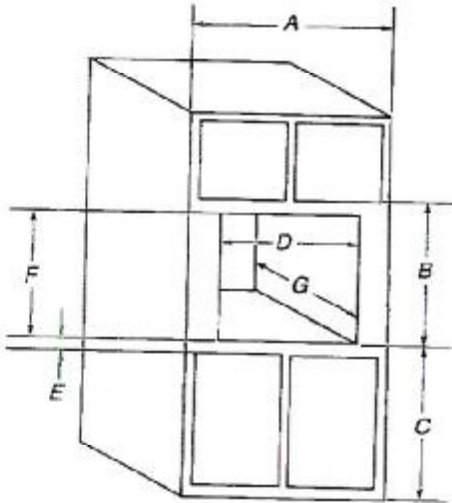

#### 27" (68.6 cm) models

- A. 27" (68.6 cm) min. cabinet width
- B. 19<sup>13/16</sup>" (50.3 cm) from bottom of cutout to bottom of upper cabinet door
- C. 40" (101.6 cm) bottom of cutout to floor (recommended)
- D. 25<sup>1/2</sup>" (64.8 cm) cutout width
- E. 1<sup>1/2</sup>" (3.8 cm) min. bottom of cutout to top of cabinet door
- F. 17<sup>1/8</sup>" (44.7 cm) recommended cutout height (will fit cutout height from 17<sup>1/8</sup>" [44.1 cm] to 17<sup>3/4</sup>" [45.1 cm])
- G. 21<sup>1/8</sup>" (55.5 cm) min. cutout depth

#### 30" (76.2 cm) models

- A. 30" (76.2 cm) min. cabinet width
- B. 19<sup>13/16</sup>" (50.3 cm) from bottom of cutout to bottom of upper cabinet door
- C. 40" (101.6 cm) bottom of cutout to floor (recommended)
- D. 28<sup>1/2</sup>" (72.4 cm) cutout width
- E. 1<sup>1/2</sup>" (3.8 cm) min. bottom of cutout to top of cabinet door
- F. 17<sup>1/8</sup>" (44.7 cm) recommended cutout height (will fit cutout height from 17<sup>1/8</sup>" [44.1 cm] to 17<sup>3/4</sup>" [45.1 cm])
- G. 21<sup>1/8</sup>" (55.5 cm) min. cutout depth

#### Minimum Installation Clearances

For proper installation, the following minimum clearances must exist above and below the cabinet opening.

#### Installation Above Single Built-In Oven

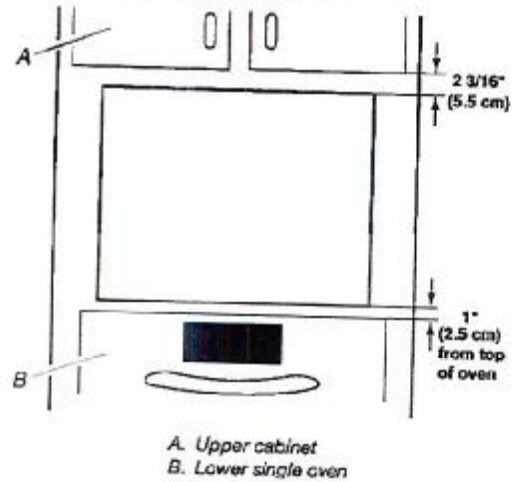

#### Electrical Requirements

##### GROUNDING INSTRUCTIONS

**For a permanently connected microwave oven:**

The microwave oven must be connected to a grounded, metallic, permanent wiring system, or an equipment grounding conductor should be run with the circuit conductors and connected to the equipment grounding terminal or lead on the microwave oven.

##### SAVE THESE INSTRUCTIONS

If codes permit and a separate ground wire is used, it is recommended that a qualified electrical installer determine that the ground path and wire gauge are in accordance with local codes.

Check with a qualified electrical installer if you are not sure the oven is properly grounded.

This oven must be connected to a grounded metal, permanent wiring system.

Be sure that the electrical connection and wire size are adequate and in conformance with the National Electrical Code, ANSI/NFPA 70 – latest edition or CSA Standards C22.1-94, Canadian Electrical Code, Part 1 and C22.2 No. 0-M91 – latest edition, and all local codes and ordinances.

A copy of the above code standards can be obtained from:

National Fire Protection Association  
1 Batterymarch Park  
Quincy, MA 02169-7471  
CSA International  
8501 East Pleasant Valley Road  
Cleveland, OH 44131-5575

#### Electrical Connection

To properly install your microwave oven, you must determine the type of electrical connection you will be using and follow the instructions provided for it here.



- Microwave oven must be connected to the proper electrical voltage and frequency as specified on the model/serial/rating plate. The model/serial/rating plate is located underneath the control panel along the oven vent.

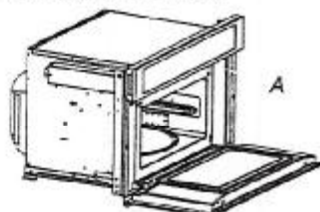

A. Model/serial/rating plate

- The microwave oven rated 120/240 V, 20 A, has 4 wires (L1, L2, N, and G) in the flex conduit, and should be connected to a 20 A maximum-rated circuit, overcurrent protected on both the L1 and L2 circuits.
- A time-delay fuse or circuit breaker is recommended.
- Flexible cable from the microwave oven should be connected directly to the junction box.

- Do not cut the conduit. The length of conduit provided is for serviceability of the microwave oven.
- A UL listed or CSA approved conduit connector must be provided.
- If the house has aluminum wiring, follow the procedure below:

Connect the aluminum wiring using special connectors and/or tools designed and UL listed for joining copper to aluminum.

Follow the electrical connector manufacturer's recommended procedure. Aluminum/copper connection must conform with local codes and industry accepted wiring practices.

For power requirements, refer to the following table:

Voltage	Microwave With Convection Oven
120/240 VAC	15 A
120/208 VAC	15 A

## INSTALLATION INSTRUCTIONS

### Spacer Kit Installation

#### NOTES:

- The microwave oven spacer kit allows the microwave oven to be installed in an 17<sup>7</sup>/<sub>16</sub>" to 17<sup>7</sup>/<sub>8</sub>" (44.1 cm to 45.3 cm) maximum cutout height.
- If your cabinet cutout height is more than 17<sup>7</sup>/<sub>16</sub>" (44.1 cm), you must install the spacer kit. Proceed to "Assemble Spacer Kit."
- If your cabinet cutout height is less than 17<sup>7</sup>/<sub>16</sub>" (44.1 cm), you do not have to install the spacer kit. Proceed to "Prepare Built-in Microwave Oven."

#### Assemble Spacer Kit

1. Attach the bottom vent to spacer bars using four 3/8" (9.5 mm) hex-head washer screws.

NOTE: Spacer bar flanges should be facing out.

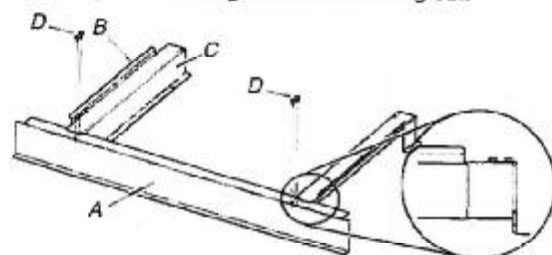

A. Bottom vent  
B. Spacer bar flange  
C. Spacer bars  
D. 3/8" (9.5 mm) hex-head washer screws

#### Install Spacer Kit

1. Center assembled microwave oven spacer kit against lower front edge of the cabinet cutout.
2. Using an 1/8" (3.2 mm) drill bit, drill through the mounting holes in the spacer bars to create pilot holes.

3. Attach the assembled spacer kit to the cabinet using four 3/4" (1.9 cm) (flat-head screws. Do not overtighten screws.

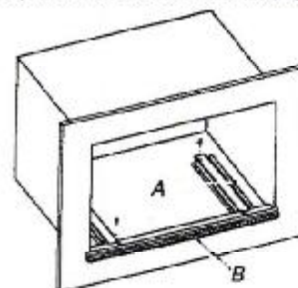

A. 3/4" (1.9 cm) flat-head screws  
B. Spacer kit assembly

### Prepare Built-in Microwave Oven

1. Locate existing wiring to avoid drilling into or severing wiring during installation.

#### ⚠ WARNING

##### Excessive Weight Hazard

Use two or more people to move and install microwave oven.

Failure to do so can result in back or other injury.

2. To avoid floor damage, set the microwave oven onto cardboard prior to installation. Do not use handle or any portion of the front frame for lifting.
3. Remove the shipping materials and tape from the microwave oven.
4. Remove and set aside racks and other items from inside the microwave oven.
5. Remove the hardware package from inside the bag containing literature.
6. Move the microwave oven and cardboard close to the microwave oven's final location.



# 30" SINGLE WALL OVEN WITH MULTIMODE® CONVECTION SYSTEM

## Signature Features

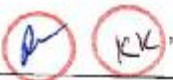

### MULTIMODE® CONVECTION SYSTEM

Steady heat produced by three elements is circulated by whirling metal blades, weaving around every flat line. Yield your cooking prowess from marbled meats to succulent roasts.

### MY CREATIONS

Curate recipe presets at will. Bake for 30 minutes, broil for 4 and keep dishes warm until you're ready to dine—all without lifting a finger.

### IRRESISTIBLE INTERIOR

Captivation cloaked in black. Beyond a dark glass expanse, cinematic lighting illuminates smooth racks, flat tines, and an enticing jet black interior.

JJW2430I

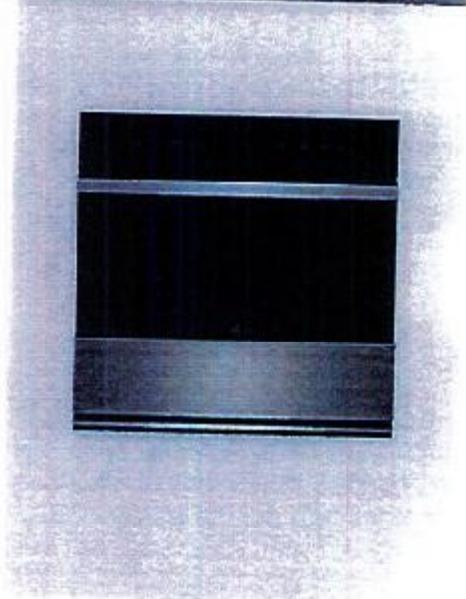

## Feature Listing

### DESIGN & CRAFTSMANSHIP

- Irresistible Interior
- 4.3-Inch Full Color LCD Display
- Cinematic Lighting
- Seamless Touches
- Glide Rack
- Smooth Close Door
- 5.0 Cu. Ft. Capacity

### PERFORMANCE

- Multimode® Convection System
- My Creations
- Closed Door Broiling
- Versatile Modes
- 3,200-Watt Convection Element
- 2,800-Watt Hidden Bake Element
- 4,000-Watt Broil Element
- 8-Pass Reflective Broil Element
- Temperature Probe

### ADDITIONAL FEATURES

- Keep Warm™ Option
- Auto Convection Conversion
- Auto Convection Modes
- Manual Convection Modes
- Rapid Preheat
- Proofing Option
- Control Lock
- Sabbath Mode
- ADA Compliant
- Backless at the Ready
- Serviced by a Select Few

## Specifications

- Shipping Weight (lbs) 184
- Volts 240
- Amps 20
- Capacity (Cu. Ft.) 5.0

## Dimensions

- Overall Dimensions 30" x 29(7/8)" x 25(5/16)"
- Opening / Clearance Dimensions (Traditional Installation) 28(1/2)" x 28" x 24"
- Opening / Clearance Dimensions (Flush Installation) 30(1/4)" x 30(7/16)" x 25"
- Do not make any cutouts based on this information

## Style Options

RISE™  
JJW2430IL

NOIR™  
JJW2430IM

Thames PH 4B – Lot 4  
RE: Appliance Spec's



LIMITED WARRANTY

Bold = Top Features

JENNAIR®

© 2019 Jennair Inc. All rights reserved. Specifications subject to change without notice.



## JENNAIR® DETAILED PLANNING DIMENSIONS

1 of 2

## SINGLE WALL OVENS

~~JJW2427I - 27" x 29-7/8" x 25-5/16"~~

JJW2430I, JJW3430I - 30" x 29-7/8" x 25-5/16"

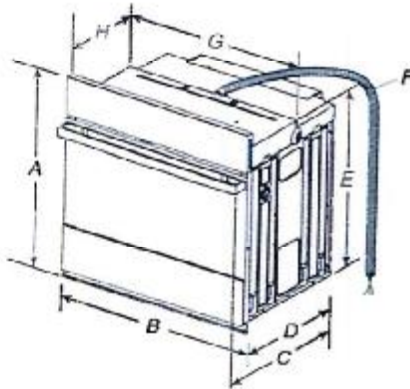

## PRODUCT DIMENSIONS - SINGLE OVENS

~~27" (68.6 CM) MODELS~~

- A. 29-7/8" (75.8 cm) max. overall height
- B. 27" (68.6 cm) overall width
- C. JJW2427IM - 26-3/8" (67 cm)  
JJW2427IL - 27-3/16" (69 cm)
- D. 23-1/4" (59.1 cm) max. recessed depth
- E. 27-3/16" (69 cm) recessed height
- F. 48" (121.9 cm) flexible conduit length
- G. 25-7/16" (64.6 cm) max. recessed width
- H. 12" (30.5 cm) from back of control panel to start of strain relief

## 30" (76.2 CM) MODELS

- A. 29-7/8" (75.8 cm) max. overall height
- B. 30" (76.2 cm) overall width
- C. JJW2430IM - 26-3/8" (67 cm)  
JJW2430IL - 27-3/16" (69 cm)  
JJW3430IM - 26-3/8" (67 cm)  
JJW3430IL - 27-3/16" (69 cm)
- D. 23-1/4" (59.1 cm) max. recessed depth
- E. 27-3/16" (69 cm)
- F. 48" (121.9 cm) flexible conduit length
- G. 28-7/16" (72.2 cm) max. recessed width
- H. 12" (30.5 cm) from back of control panel to start of strain relief

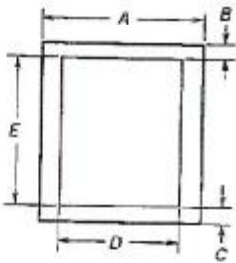

## UNDERCOUNTER CABINET DIMENSIONS - SINGLE OVENS

~~27" (68.6 CM) MODELS~~

- A. 27" (68.6 cm) min. cabinet width
- B. 1-1/2" (3.8 cm) min. top of cutout to underside of countertop
- C. 5-1/4" (13.3 cm) bottom of cutout to floor
- D. 25-1/2" (64.8 cm) cutout width
- E. 28" (71.2 cm) min. cutout height

## 30" (76.2 CM) MODELS

- A. 30" (76.2 cm) min. cabinet width
- B. 1-1/2" (3.8 cm) min. top of cutout to underside of countertop
- C. 5-1/4" (13.3 cm) bottom of cutout to floor
- D. 28-1/2" (72.4 cm) cutout width
- E. 28" (71.2 cm) min. cutout height

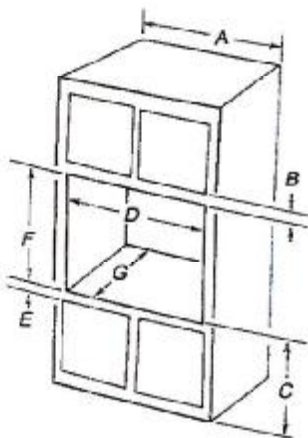

## SINGLE OVENS INSTALLED IN CABINET

~~27" (68.6 CM) MODELS~~

- A. 27" (68.6 cm) min. cabinet width
- B. 2-3/16" (5.5 cm) top of cutout to bottom of upper cabinet door
- C. 32" (81.3 cm) bottom of cutout to floor
- D. 25-1/2" (64.8 cm) cutout width
- E. 1-1/2" (3.8 cm) min. bottom of cutout to top of cabinet door
- F. 28" (71.2 cm) recommended cutout height
- G. 24" (60.7 cm) cutout depth

\*NOTE: The cutout height can be between 27-1/4" (69.2 cm) and 29-7/16" (74.8 cm) for 27" single ovens.

## 30" (76.2 CM) MODELS

- A. 30" (76.2 cm) min. cabinet width
- B. 2-3/16" (5.5 cm) top of cutout to bottom of upper cabinet door
- C. 32" (81.3 cm) bottom of cutout to floor
- D. 28-1/2" (72.4 cm) cutout width
- E. 1-1/2" (3.8 cm) min. bottom of cutout to top of cabinet door
- F. 28" (71.2 cm) recommended cutout height
- G. 24" (60.7 cm) cutout depth

\*NOTE: The cutout height can be between 27-1/4" (69.2 cm) and 29-7/16" (74.8 cm) for 30" single ovens.

**IMPORTANT:** Dimensional specifications are provided for planning purposes only. Do not make any cutouts based on this information. Refer to the Installation or Use & Care Guide before selecting cabinetry, verifying electrical/gas connections, making cutouts or beginning installation. All JennAir® appliances are appropriately UL, CUL or CSA approved.

©/™ 2018 JennAir. All rights reserved. JEN 25280-00F



Thames PH 4B - Lot 4  
RE: Appliance Spec's



4B-4

OCT 13 2020

JENNAIR® DETAILED PLANNING DIMENSIONS

SINGLE WALL OVENS

JJW24271 – 27" x 29-7/8" x 25-5/16"  
JJW24301, JJW34301 – 30" x 29-7/8" x 25-5/16"



ELECTRICAL REQUIREMENTS

If codes permit and a separate ground wire is used, it is recommended that a qualified electrical installer determine that the ground path and the wire gauge are in accordance with local codes.

Check with a qualified electrical installer if you are not sure the oven is properly grounded.

This oven must be connected to a grounded metal, permanent wiring system.

Be sure that the electrical connection and wire size are adequate and in conformance with the National Electrical Code, ANSI/NFPA 70-latest edition or CSA Standards C22.1-94, Canadian Electrical Code, Part 1 and C22.2 No. 0-M91-latest edition, and all local codes and ordinances.

A copy of the above code standards can be obtained from:

National Fire Protection Association  
1 Batterymarch Park  
Quincy, MA 02169-7471  
CSA International  
8501 East Pleasant Valley Road  
Cleveland, OH 44131-5575

- Models rated from 7.3 to 9.6 kW at 240 V (5.4 to 7.4 kW at 208 V) require a separate 40 A circuit. Models rated at 4.8 kW and below at 240 V (3.6 kW and below at 208 V) require a separate 20 A circuit.
- A circuit breaker is recommended.
- Connect directly to the circuit breaker box (or fused disconnect) through flexible, armored, or nonmetallic sheathed, copper cable (with grounding wire).
- Flexible conduit from the oven should be connected directly to the junction box.
- Fuse both sides of the line.
- Do not cut the conduit. The length of conduit provided is for serviceability of the oven.
- A UL listed or CSA approved conduit connector must be provided.
- If the house has aluminum wiring, follow the procedure below: Connect the aluminum wiring using special connectors and/or tools designed and UL listed for joining copper to aluminum. Follow the electrical connector manufacturer's recommended procedure. Aluminum/copper connection must conform with local codes and industry accepted wiring practices.

For power requirements for models JJW24271, JJW24301 and JJW34301, refer to the following table.

Model	240 VAC	208 VAC
	kW	kW
JJW24271	4.1	3.1
JJW24301	4.1	3.1
JJW34301	4.5	3.4

ELECTRICAL CONNECTION

To properly install your oven, you must determine the type of electrical connection you will be using and follow the instructions provided for it here.

- Oven must be connected to the proper electrical voltage and frequency as specified on the model/serial/rating plate. The model/serial/rating plate is located under the control panel on single ovens. See the following illustration



A. Model/Serial/Rating Plate

Thames PH 4B – Lot 4  
RE: Appliance Spec's

**IMPORTANT:** Dimensional specifications are provided for planning purposes only. Do not make any cutouts based on this information. Refer to the Installation or Use & Care Guide before selecting cabinetry, verifying electrical/gas connections, making cutouts or beginning installation. All JennAir® appliances are appropriately UL, CUL or CSA approved.





# 48" FULLY INTEGRATED BUILT-IN SIDE-BY-SIDE REFRIGERATOR

## Signature Features

### OBSSIDIAN INTERIOR

Showcases food items throughout the refrigerator, and provides a sharper contrast than white interiors. Includes coordinating crisper drawers and freezer.

### FULLY INTEGRATED AND FLUSH DESIGN WITH ARTICULATING HINGE

Blends into custom cabinetry with a truly seamless appearance that ensures the opened door remains within the plane of surrounding cabinetry.

### PRECISION TEMPERATURE MANAGEMENT™ SYSTEM

A sensor-controlled system that uses a variable-speed compressor with an independent sensor in each compartment to monitor and adjust temperatures.

JS48NXFXDE

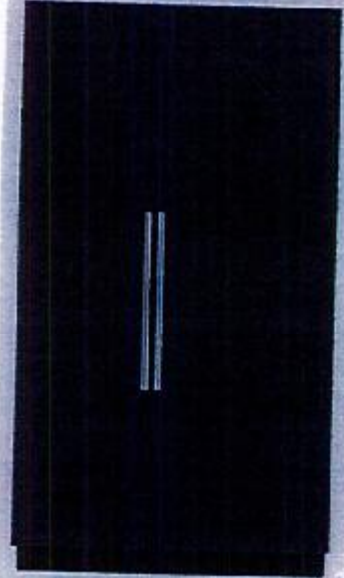

## Feature Listing

### PERFORMANCE FEATURES

Precision Temperature Management™ System  
Capacitive Touch Controls with LED Display  
Pulsed Defrost  
Quiet Operation  
Sabbath Mode  
Star-K Certified

### CONTROL FEATURES

Max Cold Option  
Over Temp Alarm  
Door Open Alarm  
Water Filter with Replace Filter Indicator

### REFRIGERATOR FEATURES

Produce Preserver  
Advanced Climate Control Drawer  
Soft, Auto-Close Crisper Drawers  
Gallon Door Storage Bin  
Adjustable Elegance Shelving  
Adjustable Door Bins with Metal Accents

### FREEZER FEATURES

Automatic Ice Maker with Storage Bin  
Adjustable Door Bins with Metal Accents

### DESIGN FEATURES

Obsidian Interior  
Fully Integrated and Flush Design with Articulating Hinge  
Multi-Point LED Theater Lighting  
Removable Ease-Grille Water Filter  
90°/110° Door Stop Position

Four-Point Front Leveling

### OPTIONAL ACCESSORIES

48" Built-In Side By Side Panel Rise - JS48NXFXDE - JBSFS48NHL  
Full Height Panel Kit (Euro-Style Stainless) - JBSFS48NHS  
Full Height Panel Kit (Pro-Style® Stainless) - JBSFS48NHP  
Pro-Style® Stainless Handle Kit - W10250643  
Euro-Style Stainless Steel Handle Kit - W10250640  
48" Armole-Style Door Panel Kit - W10663565  
Handle Kit-JA,RISE,BIR,SxS (Qty=2 handles) - W11231243  
Handle Kit-JA,NOIR,BIR,SxS (Qty=2 handles) - W11194770  
EveryDrop® Filter by Whirlpool Water (Replacement Filter Cartridge) - EDR3RXD1  
Produce Preserver Keep Fresh Packet Refill - P1KC6R1  
Affresh™ Stainless Steel Cleaner, 16 oz. - W10355016  
48" Built-In Side By Side Panel NOIR - JS48NXFXDE - JBSFS48NHM

## Specifications

Shipping Weight (lbs) 549  
Volts 115  
Amps 15-20  
Total Capacity (Cu. Ft. AHAM) 29.2  
Refrigerator Capacity (Cu. Ft. AHAM) 18.7  
Freezer Capacity (Cu. Ft. AHAM) 10.5

## Dimensions

## Style Options

**RISE™**  
JS48NXFXDE with JBSFS48NHL Kit

**EURO-STYLE**  
JS48NXFXDE with JBSFS48NHS Kit

**BASE UNIT**  
JS48NXFXDE

**PRO-STYLE®**  
JS48NXFXDE with JBSFS48NHP Kit

**NOIR™**  
JS48NXFXDE with JBSFS48NHM Kit

Thames PH 4B – Lot 4  
RE: Appliance Spec's

OCT 13 2020

4B-4

me KIC

Overall Dimensions 47(3/4)" x 83(1/8)" x 24"  
Opening / Clearance Dimensions (Standard  
Push Installation) 48" x 84" x 25"  
Opening / Clearance Dimensions (Retrofit  
Installation) 48" x 84" x 24"  
Do not make any cutouts based on this information

Thames PH 4B – Lot 4  
RE: Appliance Spec's



Bold = Top Features

JENNAIR®





**JENNAIR****48" FULLY INTEGRATED  
SIDE-BY-SIDE REFRIGERATOR****DETAILED PLANNING DIMENSIONS GUIDE**

(BASE UNIT REQUIRES SUITE-COORDINATING FULL HEIGHT PANEL KIT OR CUSTOM PANELS AND HANDLES)

JS48NFXDE - 47 $\frac{1}{4}$ " (W) x 83 $\frac{1}{2}$ " (H) x 24" (depth without door panels/handles)**BASE UNIT + FULL HEIGHT PANEL KIT = FINISHED REFRIGERATOR**

Easily transform these overlay refrigerators into one of our signature kitchen suite designs with one of our suite-coordinating stainless steel panel kits. To do so, you must order one of the overlay base units (left column) and one of the suite-coordinating panel kits. The kits include refrigerator and freezer door panels, air grille and pre-installed handles.

Base Unit Model Number	Coordinating Stainless Full Height Panel Kits	
	RISE™ Stainless	NOIR™ Stainless
Side-by-Side JS48NFXDE	 JBSFS48NHL	 JBSFS48NHM

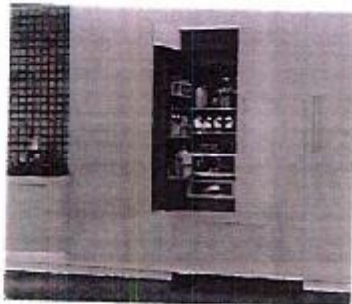
**OPTIONAL ACCESSORIES FOR CUSTOM OVERLAY DESIGNS****ARMOIRE-STYLE DOOR PANEL KIT****W10663565** - 48" - Obsidian Interior

- For use with fully integrated and flush refrigerators
- Enables installation and proper venting of full height custom door panels (not included) that hide the top panel
- Includes left and right grille brackets and machine compartment cover

Because Whirlpool Corporation policy includes a continuous commitment to improve our products, we reserve the right to change materials and specifications without notice.

**W11356555C****RISE™ STAINLESS HANDLE KIT****W11231243** - 48" Side-by-Side

- For use with Custom Overlay fully integrated built-in refrigerators

**NOIR™ STAINLESS HANDLE KIT****W11194770** - 48" Side-by-Side

- For use with Custom Overlay fully integrated built-in refrigerators

Dimensions are for planning purposes only. For complete details, see Installation Instructions packed with product. Specifications subject to change without notice.



# 48" FULLY INTEGRATED SIDE-BY-SIDE REFRIGERATOR

## DETAILED PLANNING DIMENSIONS GUIDE

(BASE UNIT REQUIRES SUITE-COORDINATING FULL HEIGHT PANEL KIT OR CUSTOM  
PANELS AND HANDLES)  
JS48NFXDE - 47 1/4" (W) x 83 1/2" (H) x 24" (depth without door panels/handles)

PRODUCT DIMENSIONS (INCLUDING STAINLESS  
STEEL DOOR PANEL KIT DIMENSIONS)

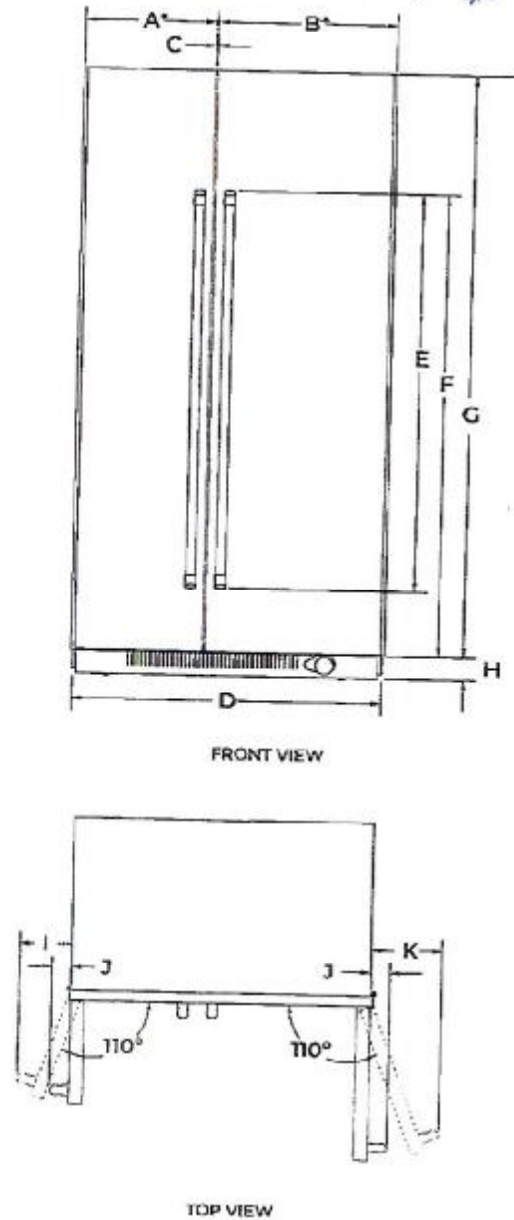

DIMENSION	DESCRIPTION	JS48NFXDE
A*	Width of freezer door	20 1/2" (51.6 cm)
B*	Width of refrigerator door	27 1/2" (69.4 cm)
C	Space between doors	1/8" (0.3 cm)
D	Overall width (including vinyl side trim)	47 3/4" (121.3 cm)
E	Height of door handle	
	RISE™ Stainless	58" (147.3 cm)
	NOIR™ Stainless	40 1/8" (103.2 cm)
F	Height to top of door handle	
	RISE™ Stainless	71 1/4" (182.1 cm)
	NOIR™ Stainless	69 1/4" (177.3 cm)
G	Height of door	81" (205.7 cm)
H	Height of bottom grille	3" (7.6 cm)
I	Width from side of refrigerator to freezer door handle - door fully open 110°	
	RISE™ Stainless	8 1/8" (20.7 cm)
	NOIR™ Stainless	7 3/4" (19.3 cm)
J	Width from side of refrigerator to handle - door open 90°	
	RISE™ Stainless	2 3/8" (6.1 cm)
	NOIR™ Stainless	1 1/4" (4.3 cm)
K	Width from side of refrigerator to refrigerator door handle - door fully open 110°	
	RISE™ Stainless	10 1/4" (25.8 cm)
	NOIR™ Stainless	10 1/4" (25.5 cm)

\*Door width dimensions are for stainless steel panel kit only.

Because Whirlpool Corporation policy includes a continuous commitment to improve our products, we reserve the right to change materials and specifications without notice.

Dimensions are for planning purposes only. For complete details, see Installation Instructions packed with product. Specifications subject to change without notice.

Thames PH 4B – Lot 4  
RE: Appliance Spec's





# 48" FULLY INTEGRATED SIDE-BY-SIDE REFRIGERATOR

## DETAILED PLANNING DIMENSIONS GUIDE

(BASE UNIT REQUIRES SUITE-COORDINATING FULL HEIGHT PANEL KIT OR CUSTOM PANELS AND HANDLES)

JS48NFXDE - 47 1/4" (W) x 83 1/8" (H) x 24" (depth without door panels/handles)

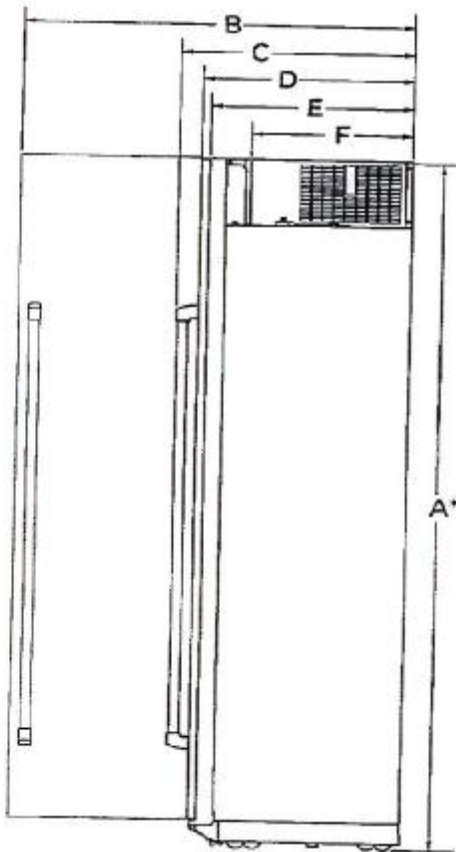

SIDE VIEW

DIMENSION	DESCRIPTION	JS48NFXDE
A*	Height of recessed refrigerator (min.)	83 1/8" (211.1 cm)
B	Depth with refrigerator door open 90° (min.)	50 1/4" (128.6 cm)
C	Depth with handles (min.)	
	RISE™ Stainless	27 3/16" (70.2 cm)
	NOIR™ Stainless	26 7/8" (68.2 cm)
D	Depth with doors (min.)	
	RISE™ Stainless	24 3/4" (62.8 cm)
	NOIR™ Stainless	24 3/4" (62.8 cm)
	Custom panel (3/4"/1.9 cm)	24 3/4" (62.8 cm)
E	Depth without door panel kit (min.)	24" (61 cm)
F	Depth of compressor cover (min.)	19 5/8" (50.5 cm)

\*Add 1 3/4" (3.2 cm) to the height dimension when leveling legs are fully extended.

Thames PH 4B – Lot 4  
RE: Appliance Spec's

Because Whirlpool Corporation policy includes a continuous commitment to improve our products, we reserve the right to change materials and specifications without notice.

Dimensions are for planning purposes only. For complete details, see Installation Instructions packed with product. Specifications subject to change without notice.





JENNAIR

# 48" FULLY INTEGRATED SIDE-BY-SIDE REFRIGERATOR

## DETAILED PLANNING DIMENSIONS GUIDE

(BASE UNIT REQUIRES SUITE-COORDINATING FULL HEIGHT PANEL KIT OR CUSTOM PANELS AND HANDLES)

JS48NFXDE - 47 1/2" (W) x 83 1/8" (H) x 24" (depth without door panels/handles)

### AIRFLOW VENTING RECOMMENDATIONS

### CLOSED SOFFIT CABINET

### OPEN TO CEILING OR SOFFIT CABINET

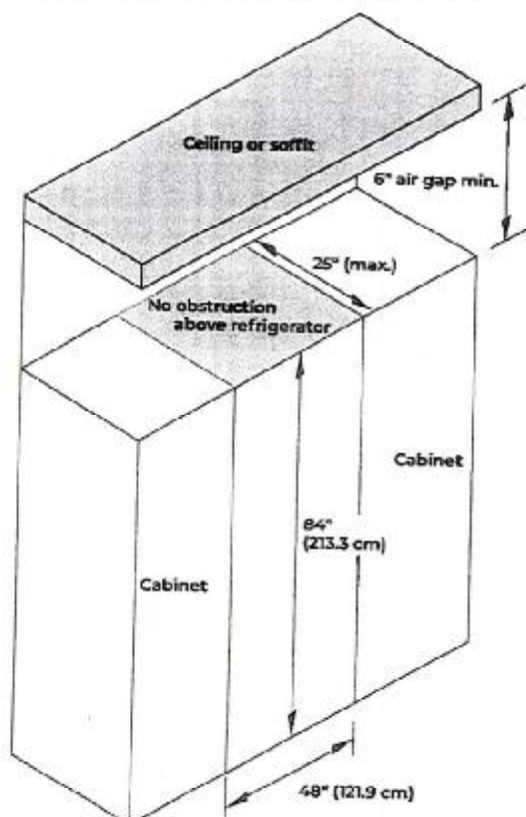

- These type of installations require a minimum of 6" (15.24 cm) of open space above the refrigerator. This space must not be blocked in any way, including soffits.
- Depth of cabinet must be less than 25" (63.5 cm).
- If your opening does not meet these requirements, you will need to make modifications.

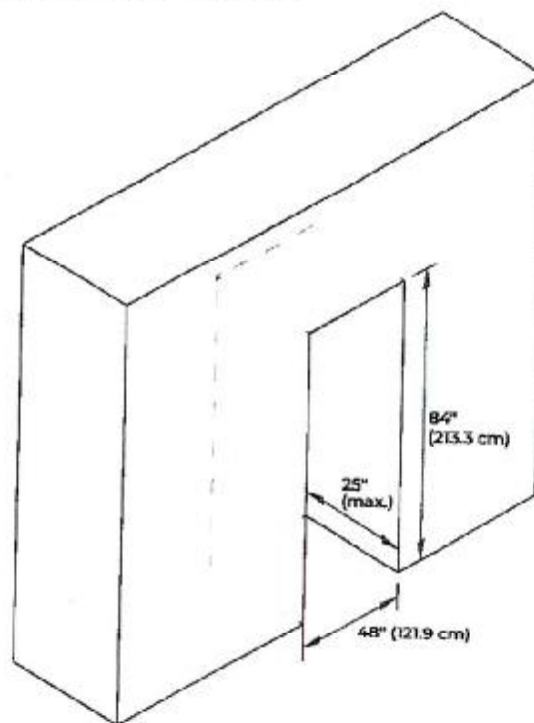

- Depth of cabinet must be less than 25" (63.5 cm).
- Height of soffit must not exceed 84" (213.3 cm).
- Following illustrations explain the cabinet construction (soffit and rear wall positions) required for optimum ventilation and airflow.

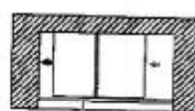

Top View

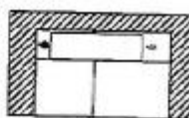
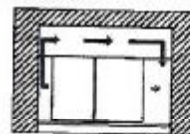

Front View

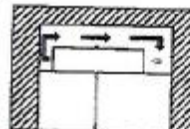

Gray arrow = ambient air; Black arrow = warm air  
Cabinet depth 25" and soffit located at 84" provides proper airflow/ventilation to the refrigerator. Efficient cooling is achieved.  
Cabinet depth more than 25" and/or soffit located at more than 84" causes air gap at back and/or top of the refrigerator. Air gap allows warm air recirculation causing loss in cooling efficiency.

- If your opening does not meet these requirements, you will need to make modifications.

Because Whirlpool Corporation policy includes a continuous commitment to improve our products, we reserve the right to change materials and specifications without notice.

Dimensions are for planning purposes only. For complete details, see installation instructions packed with product. Specifications subject to change without notice.

Thames PH 4B - Lot 4  
RE: Appliance Spec's





48" FULLY INTEGRATED  
SIDE-BY-SIDE REFRIGERATOR

DETAILED PLANNING DIMENSIONS GUIDE

(BASE UNIT REQUIRES SUITE-COORDINATING FULL HEIGHT PANEL KIT OR CUSTOM  
PANELS AND HANDLES)

JS48NFXDE - 47½" (W) x 83½" (H) x 24" (depth without door panels/handles)

CLEARANCE DIMENSIONS

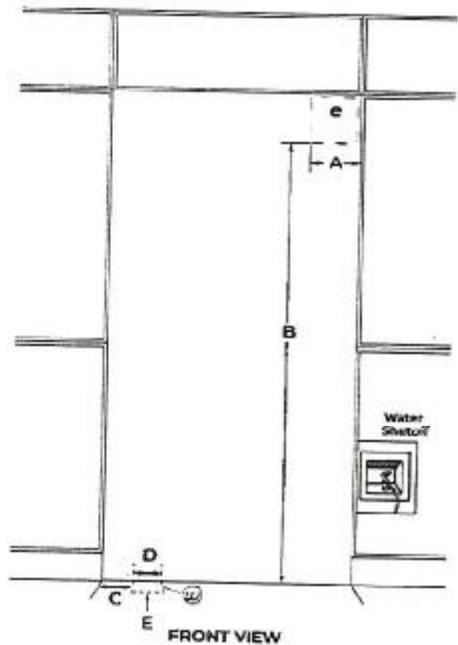

DIMENSION	DESCRIPTION	JS48NFXDE
A	Width of recommended electrical location	7½" (19.1 cm)
B	Height to recommended electrical location	77" (195.6 cm)
C	Distance from side of cabinet to recommended water connection location	6½" (16.5 cm)
D	Width of recommended water location	1½" (3.81 cm)
E	Depth of recommended water connection location (max)	2" (5 cm)
e	Recommended electrical connection location	
W	Recommended water connection location	

\*A minimum 2" (5.1 cm) furniture return must extend behind the face of the cabinet on all sides.

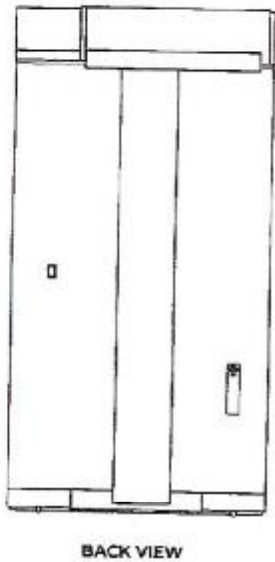

Thames PH 4B – Lot 4  
RE: Appliance Spec's

Because Whirlpool Corporation policy includes a continuous commitment to improve our products, we reserve the right to change materials and specifications without notice.

Dimensions are for planning purposes only. For complete details, see installation instructions packed with product. Specifications subject to change without notice.

OCT 13 2020



4B-4

#### ELECTRICAL REQUIREMENTS

**⚠ WARNING**

**Electrical Shock Hazard**  
Plug into a grounded 3 prong outlet.  
Do not remove ground prong.  
Do not use an adapter.  
Do not use an extension cord.  
Failure to follow these instructions can result in death, fire, or electrical shock.

115 V, 60 Hz, AC only, 15 A or 20 A fused, grounded circuit is required. A dedicated circuit is recommended. Use an outlet that cannot be turned off by a switch. Do not use an extension cord.

#### WATER PRESSURE REQUIREMENTS

A cold water supply with water pressure between 30 psi and 120 psi (207 kPa and 827 kPa) is required to operate the ice maker. Call a licensed, qualified plumber with any questions about the water pressure.

#### Reverse Osmosis Water Supply

**IMPORTANT:** The pressure of the water coming out of a reverse osmosis system going to the water inlet valve of the refrigerator needs to be between 30 psi and 120 psi (207 kPa and 827 kPa).

If a reverse osmosis water filtration system is connected to the cold water supply, the water pressure to the reverse osmosis system needs to be a minimum of 40 psi to 60 psi (276 kPa to 414 kPa).

#### LOCATION REQUIREMENTS

**⚠ WARNING**

**Explosion Hazard**  
Keep flammable materials and vapors, such as gasoline, away from refrigerator.  
Failure to do so can result in death, explosion, or fire.

Floor must be able to support refrigerator (more than 600 lb [272 kg]), door panels and contents of the refrigerator and must be at the same level as flooring in the room.

Thames PH 4B – Lot 4  
RE: Appliance Spec's

WT1356555C

©/TM ©2019 JennAir. All rights reserved.

12/19





# 24" TRIFECTA™ DISHWASHER, 38 DBA

## Signature Features

Handwritten initials: "K" and "KK" in circles.

### 38 DBA\* TRANQUILITY

Listen to the hush. At 38 dBA\*, JennAir® is the quietest luxury dishwasher brand, all without sacrificing performance.

### TRIFECTA™ WASH SYSTEM

No need to choose between brilliant cleaning, water/energy reduction or quiet operation because our dishwashers deliver all three. Three-stage filtration, pressurized wash arms and alternating wash action in two zones yield superlative results.

### REMOTE ACCESS\*

Remote start. Cycle monitoring. Connect to WiFi for real-time notifications and control your dishwasher from anywhere. Even download custom wash cycles directly to your appliance. Tap and swipe on both iOS and Android devices.\*

JDTSS246G



## Feature Listing

### DESIGN & CRAFTSMANSHIP

- Removable 3rd-Level Rack
- UltraGlide Lower Rack
- Daring Obsidian Racks
- Cinematic Lighting
- SuperiorGlide Upper Rack
- Fold-Away™ Tines
- Flexible Capacity
- Elevation Rack Adjusters
- Concealed Controls
- Culinary Caddy

### PERFORMANCE

- 38 dBA\* Tranquility
- TriFecta™ Wash System
- Tall Bottle Wash
- 3-Stage Filtration
- Stainless Steel Spray Arms
- ClearScan™ Sensor Cycle
- Precision Dry® Plus Option
- 1-Hour Wash Cycle
- Top Rack Wash Option
- Bottom Rack Wash Option
- Cookware/Bakeware Cycle
- Crystal Cycle
- Hi-Temp Wash Option
- Refresh Cycle
- Sanitize Rinse Option
- Normal Tableware Cycle
- SteamFinish Option

### CONNECTIVITY

- Remote Access\*

- Smart Integration
- On-Demand Experts
- Monthly Reports
- 1 to 24-Hour Delay Start Option
- Auto Reorder
- Custom Cycles

### ADDITIONAL FEATURES

- Detergent Dispenser
- Folding Tines (Lower Rack)
- Protector Racks with Cushioning Tines
- Silverware Basket
- Stainless Steel Tall Tub
- Shift Tines
- True Hold Door
- Cup Shelves with Stemware Holders
- Condensation Drying
- ENERGY STAR® Certified
- Emotive Feedback
- Fold-Away Shelf
- Waterlock™ Flood Protection
- Sabbath Mode
- Badasses at the Ready
- Serviced by a Select Few

## Specifications

- Shipping Weight (lbs) 95
- Volts 120
- Amps 15-20
- Sound Rating (dBA) 38
- Capacity (Place Settings) 14

## Style Options

### EURO-STYLE

JDTSS246GS

### NOIR™

JDTSS246GM

### PRO-STYLE\*

JDTSS246GP

### RISE™

JDTSS246GL

## Dimensions

Overall Dimensions 23(7/8)" x 33(1/2)" x 28(19/32)"

Do not make any cutouts based on this information

Thames PH 4B – Lot 4  
RE: Appliance Spec's

# JENN-AIR® DETAILED PLANNING DIMENSIONS

OCT 13 2020

4B-4

1 of 3

## DISHWASHERS

JDTSS246G, JDTSS244G – 23½" x 33½" x 28⅞" (including handle)

JDTSS245G, JDTSS243G – 23½" x 33½" x 24" (not including handle)

## PRODUCT DIMENSIONS

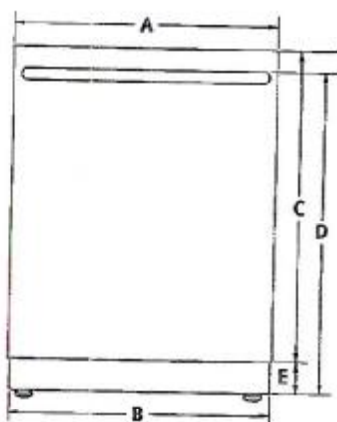

FRONT VIEW

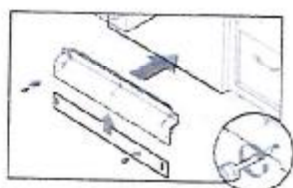

ADJUSTABLE TOE KICK

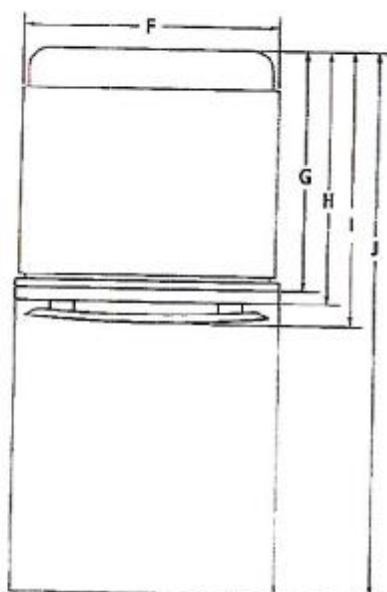

TOP VIEW

**IMPORTANT:** Dimensional specifications are provided for planning purposes only. Do not make any cutouts based on this information. Refer to the Installation or Use & Care Guide before selecting cabinetry, verifying electrical/gas connections, making cutouts or beginning installation. All Jenn-Air® appliances are appropriately UL, CUL or CSA approved.

MODEL #		JDTSS246G JDTSS244G		JDTSS245G JDTSS243G	
		in	cm	in	cm
A	Width of door	23½	60.6	23½	60.6
B	Width of toe kick	23½	59.7	23½	59.7
C	Height of door				
	Pro-Style® Stainless	30	76.2	—	—
	Euro-Style Stainless	30	76.2	—	—
	Custom panel (¾" / 1.9 cm)	—	—	30	76.2
D	Height to top of handle				
	Pro-Style® Stainless	31⅞	80.1	—	—
	Euro-Style Stainless	31⅞	80.1	—	—
	Custom panel (¾" / 1.9 cm)	—	—	*	*
E	Height of adjustable toe kick (min.-max.)	3½-4¼	8.8-10.6	3½-4¼	8.8-10.6
F	Width of recessed dishwasher	23½	60.6	23½	60.6
G	Depth with tub flange	21	53.3	21	53.3
H	Depth with door				
	Pro-Style® Stainless	24½	62.2	—	—
	Euro-Style Stainless	24½	62.2	—	—
	Custom panel (¾" / 1.9 cm)	—	—	24	60.0
I	Depth with handle				
	Pro-Style® Stainless	29⅞	73.9	—	—
	Euro-Style Stainless	28⅞	72.6	—	—
	Custom panel (¾" / 1.9 cm)	—	—	*	*
J	Depth with door fully open	49½	125.7	49½	125.7

\*For custom panel models, this depends on handle chosen.

Thames PH 4B – Lot 4  
RE: Appliance Spec's

**JENN-AIR®**

9009Ad2w317



JENN-AIR® DETAILED PLANNING DIMENSIONS

OCT 13 2020

2 of 3

DISHWASHERS

JDTSS246G, JDTSS245G – 23<sup>3⁄8</sup>" x 33<sup>1⁄2</sup>" x 28<sup>15⁄16</sup>" (including handle)

JDTSS245G, JDTSS243G – 23<sup>3⁄8</sup>" x 33<sup>1⁄2</sup>" x 24" (not including handle)



DIMENSIONS AS INSTALLED

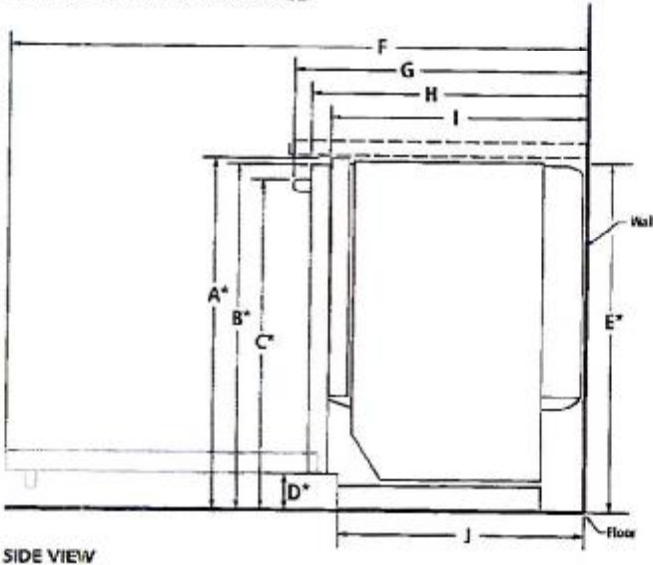

SIDE VIEW

MODEL #	JDTSS246G JDTSS245G JDTSS244G JDTSS243G	
	in	cm
A*	Height to top of tub flange (min.)	33 <sup>3⁄8</sup> 85.1
B*	Height to top of door (min.)	33 <sup>3⁄8</sup> 85.7
C*	Height to top of handle (min.)	
	Pro-Style® Stainless	31 <sup>1⁄2</sup> 80.1
	Euro-Style Stainless	31 <sup>1⁄2</sup> 80.1
	Custom panel (3⁄4"/1.9 cm)	+ +
D*	Height to bottom of door	3" 9.4
E*	Height of recessed dishwasher (min.)	33 <sup>3⁄8</sup> 85.5
F	Depth with door fully open (min.)	49 <sup>1⁄2</sup> 125.7
G	Depth with handle (min.)	
	Pro-Style® Stainless	29 <sup>3⁄4</sup> 73.9
	Euro-Style Stainless	28 <sup>15⁄16</sup> 72.6
	Custom panel (3⁄4"/1.9 cm)	+ +
H	Depth with door (min.)	
	Pro-Style® Stainless	26 <sup>1⁄2</sup> 67.3
	Euro-Style Stainless	26 <sup>1⁄2</sup> 67.3
	Custom panel (3⁄4"/1.9 cm)	24 <sup>1⁄2</sup> 62.2
I	Depth with tub flange (min.)	22 <sup>3⁄4</sup> 57.4
J	Depth with toe kick (min.)	20" 52.9

\*With wheels removed. Add up to 1" (2.5 cm) to height with wheels and leg levelers fully extended.

†For custom panel models, this depends on handle chosen.

Thames PH 4B – Lot 4  
RE: Appliance Spec's

**IMPORTANT:** Dimensional specifications are provided for planning purposes only. Do not make any cutouts based on this information. Refer to the Installation or Use & Care Guide before selecting cabinetry, verifying electrical/gas connections, making cutouts or beginning installation. All Jenn-Air® appliances are appropriately UL, CUL or CSA approved.



9009AdZw317



JENN-AIR® DETAILED PLANNING DIMENSIONS

3 of 3

DISHWASHERS

JDTSS246G, JDTSS244G – 23 1/4" x 33 1/2" x 28 1/2" (including handle)  
JDTSS245G, JDTSS243G – 23 1/4" x 33 1/2" x 24 1/2" (not including handle)

OPENING/CLEARANCE DIMENSIONS

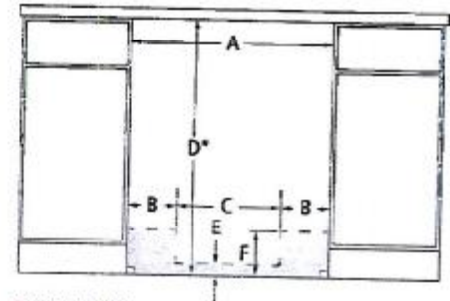

FRONT VIEW

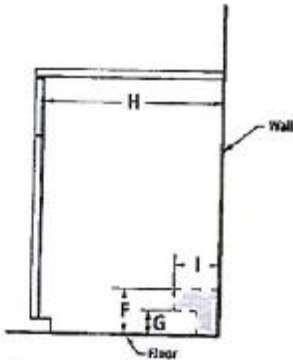

SIDE VIEW



BACK VIEW

MODEL #		JDTSS246G JDTSS245G JDTSS244G JDTSS243G	
		in	cm
A	Width (min.)	24	61.0
B	Width of possible utility installation area (back wall)	6 3/4	17.2
C	Width of clear area (back wall)	10 1/2	26.7
D*	Height with wheels removed (min.)	34	86.4
E	Height of possible utility installation area (back wall)	2 1/4	6.4
F	Height of possible utility installation area (back/side wall)	6 3/4	15.9
G	Height of clear area (side wall)	3	7.6
H	Depth (min.)	24	61.0
I	Depth of utility location (side wall)	4	10.2

Electrical, water and drain connections may be installed in shaded areas

Recommended drain connection location – closest to sink	1 1/2 dia. 3.8 dia.
Recommended electrical connection location – right-hand side or back wall	1 1/2 dia. 3.8 dia.
Recommended water connection location – left-hand side or back wall	1/2 dia. 1.3 dia.

\*Measured from the lowest point on the underside of countertop.

ELECTRICAL REQUIREMENTS

20-volt, 60 Hz, AC-only, 15- or 20-amp. fused electrical supply. Copper wire only. A time delay fuse or circuit breaker and separate circuit is recommended.

WATER SUPPLY REQUIREMENTS

120°F (49°C) hot water supply with water pressure between 20 and 120 psi (138 and 862 kPa) is required. If you have questions about your water pressure, call a licensed, qualified plumber.

DRAIN REQUIREMENTS

Connect drain hose to waste tee or disposer inlet above drain trap. Maximum drain hose length 12' (3.7 m).

LOCATION REQUIREMENTS

Corner locations require a 2" (5.1 cm) minimum clearance between the side of the dishwasher door and the wall or cabinet.

Thames PH 4B – Lot 4  
RE: Appliance Spec's

**IMPORTANT:** Dimensional specifications are provided for planning purposes only. Do not make any cutouts based on this information. Refer to the Installation or Use & Care Guide before selecting cabinetry, verifying electrical/gas connections, making cutouts or beginning installation. All Jenn-Air® appliances are appropriately UL, CUL or CSA approved.

JENN-AIR®

9009Ad2w317