

Kingsmen (Thames) Inc. / Havelock Corners (Kingsmen)

Lot/Unit: 15 Phase/Building: 4A Model/Floor Plan: Edward (3602) Elev B 4 Bed - 2+1 Bath

ELECTRICAL

HEATING AND AIR CONDITIONING

MISCELLANEOUS

Inv.4739	1 - Purchaser has requested the design consultant to select their interior finishes; they were selected on September 8th,2020.	
Line 60524	Note:	
7Sep20 / 9Oct20		

TILE

Inv.4739	1 - To supply & Install a standard floor tile to the main floor hallway in lieu of the standard hardwood.... see colour chart for details.	
Line 61300	Note:	
7Sep20 / 9Oct20		

EXTRAS AS PER OFFER

Note:	
-------	--

OCT 09 2020

Purchaser: BARJINDER SINGH BARYAH

Property: 15 of Plan - Draft Approval SB17-03-08

Telephone Res. / Bus: /

Project: Kingsmen (Thames) Inc.

Decor Advisor: Barbara Coccia

Model and Elevation: Edward (3602) Elev B 4 Bed - 2+1 Bath

Layout Changes: ☐ Yes ☒ No

Sketch Attached: ☐ Yes ☒ No

Exterior Colour Scheme:

1. Cabinetry

	Style and Colour	Counter Top	Hardware
Kitchen / Breakfast	#3 Camden Maple Espresso CL	Italian White Di Pesco 4954k-22	# 12843 Handle
Kitchen Island	#3 Camden Maple Espresso CL	Italian White Di Pesco 4954k-22	# 12843 Handle
Laundry Room			
Powder Room	#3 Camden Maple Espresso CL	Italian White Di Pesco 4954k-22	# 12843 Handle
Main Bathroom	#3 Camden Maple Espresso CL	Italian White Di Pesco 4954k-22	# 12843 Handle
Master Ensuite Bathroom	#3 Slab LPL Cafe Noir	Calcutta Marble 4925k-07	# 12881 Handle
Second Ensuite Bathroom (If Applicable)	/	/	

Appliances

Custom Size Fridge

☐ Yes ☒ No

Valance Lighting

☐ Yes ☒ No

Microwave / Range Hood

☐ Yes ☒ No

Cooktop / Rangetop

☐ Yes ☒ No

Built in Wall Oven

☐ Yes ☒ No

Slide-in Range

☐ Yes ☒ No

Comment

2. Flooring

	Selection
Foyer	13 x 13" Bellina Grey
Main Hall	**13 x 13" Bellina Grey
Back Hall	/
Breakfast	13 x 13" Bellina Grey
Laundry Room	13 x 13" Bellina Grey
Kitchen	13 x 13" Bellina Grey
Powder Room	13 x 13" Bellina Grey
Main Bathroom	13 x 13" Bellina Grey
Master Ensuite	13 x 13" Cinq Black
Bathroom (If Applicable)	/
Mud Room	/
Master Ens. Shower floor	2x2" Soho White matte
Living Room	/
Dining Room	3 1/2" Elements Oak Natural
Family / Great Room	3 1/2" Elements Oak Natural
Den / Library / Study	
Basement Landing (If Applies)	
Lower Landing (If Applicable)	3 1/2" Elements Oak Natural
Upper Landing	3 1/2" Elements Oak Natural
Upper Hall	Sylish Story I, # 917 Pearl Glow
Master Bedroom	Sylish Story I, # 917 Pearl Glow
Bedroom #2	Sylish Story I, # 917 Pearl Glow
Bedroom #3	Sylish Story I, # 917 Pearl Glow
Bedroom #4	Sylish Story I, # 917 Pearl Glow
Bedroom #5	/
Master Ens. Shower jamb	Anatolia Marmiline SNOW

Flooring Continued on Page 2

Initial: BSB

Page 1 of 3

Printed 10/9/2020 12:03:24

OCT 09 2020

4A-15

Purchaser: BARJINDER SINGH BARYAH

Property: 15 of Plan - Draft Approval SB17-03-08

Telephone Res. / Bus: /

Project: Kingsmen (Thames) Inc.

Decor Advisor: Barbara Coccia

Model and Elevation: Edward (3602) Elev B 4 Bed - 2+1 Bath

2. Flooring - Continued -

Upgrade Underpad	Type	Area
	Standard	2nd floor
Carpet on Stairs	Capped	Runner - *Upgrade
Comment	/	/

3. Plumbing Fixtures / Faucets

Kitchen	Standard	Second Ensuite	/	Powder Room	Standard
Master Ensuite	Standard			Other Room	/
Main Bathroom	Standard				

Comment

4. Wall Tile

	Tile Selection	Listello	Insert	Insert Selection
Main Bathroom	8 x 10" Bellina Grey	<input type="checkbox"/>	<input type="checkbox"/>	
Master Ensuite				
Tub Deck	13 x13" Cinq Black	<input type="checkbox"/>	<input type="checkbox"/>	
Tub Apron	13 x13" Cinq Black	<input type="checkbox"/>	<input type="checkbox"/>	
Tub Surround	13 x13" Cinq Black	<input type="checkbox"/>	<input type="checkbox"/>	
Shower Stall	8 x 10" Keaton Ice	<input type="checkbox"/>	<input type="checkbox"/>	
Second Ensuite	/	<input type="checkbox"/>	<input type="checkbox"/>	
	/	<input type="checkbox"/>	<input type="checkbox"/>	
	/	<input type="checkbox"/>	<input type="checkbox"/>	
Kitchen Backsplash	/	<input type="checkbox"/>	<input type="checkbox"/>	
Complete Backsplash	/	<input type="checkbox"/>	<input type="checkbox"/>	

Comment

Install the standard wall tile on the 10" side STACKED horizontally where applicable for the master ensuite and main bathroom..



horizontal stacked

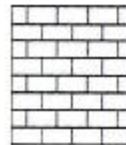

brick pattern



vertical stacked



diagonal/diamond

5. Fireplace

Living Room

Purchased As Per Plan N/A

☐ ☐ ☒

Family Room

Purchased As Per Plan N/A

☐ ☐ ☒

Other Room - Specify Great room

Purchased As Per Plan N/A

☐ ☒ ☐

Fireplace Type

Mantle Type

Over Mantle

Colour / Stain

Surround

Hearth

Comment

Front Facing

NF-8

/

White

/

/

Initial: _____

BSB

Page 2 of 3

OCT 09 2020

Purchaser: BARJINDER SINGH BARYAH

Property: 15 of Plan - Draft Approval SB17-03-08

Telephone Res. / Bus: /

Project: Kingsmen (Thames) Inc.

Decor Advisor: Barbara Coccia

Model and Elevation: Edward (3602) Elev B 4 Bed - 2+1 Bath

6. Trim Carpentry

Door Hardware

Interior Trim

Comment

Interior Doors

☐ 2 Panel Arch Top

☒ 2 Panel Square Top

☐ 6 Panel

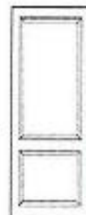

Initial for Door Style

BSP

7. Railings and Pickets

Railing Package

Railing Colour

Wood Stairs ☐ No ☒ Oak

Picket Colour

Tread Colour

Comment

8. Plaster Mouldings and Medallions

Foyer

Kitchen/Breakfast

Main Hall

Den/Library

Living Room

Lower Landing

Dining Room

Family Room

Comment

9. Wall Paint

Kingsmen White

Smooth Ceilings

☐ First Floor

☐ First Floor incl. Second Floor Hall

☐ First and Second Floor

☒ Throughout

☐ Not Applicable

Trim Paint

10. Additional Comments

11. Disclaimers and Notes

- Colours of all materials are as close as possible to builder's selection, but not necessarily identical due to variances in manufacturing.
- Any extras listed above are null and void unless accompanied by a separate invoice/amendment. Said invoice must be paid in full.
- The Purchaser acknowledges that after Interior Colour Selection form is signed and dated, no further changes will be permitted other than re-selection due to unavailability. BSP Purchaser's Initials
- The Purchaser acknowledges reading and accepting the "Kingsmen Group Décor Centre Disclaimers" form. This document contains other miscellaneous disclaimers.

This Interior Colour Selection is final and approved by:

Purchaser:

Signature: Barjinder Singh Baryah Date: Oct 9-2020

Vendor:

Kingsmen (Thames) Inc.

SCHEDULE "B-1"
Floor Plan

OCT 09 2020

4A-15

Lot 15
Phase 4A
Model: Edward (3602) Elev B 4 Bed - 2+1 Bath
Standard

sketch #3

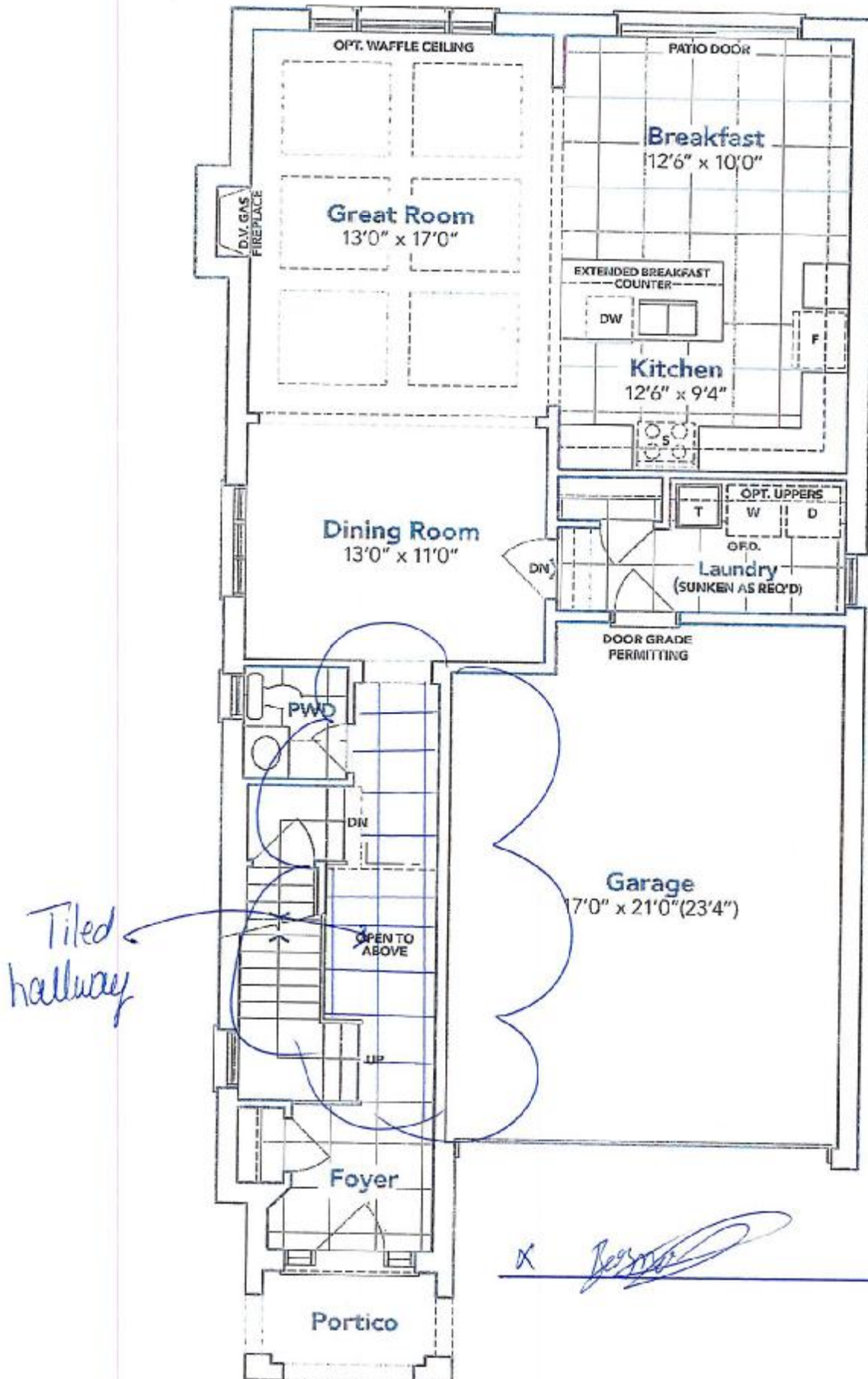

GROUND FLOOR EL. B

The floor plans and elevations shown are pre-construction plans and may be revised or improved as necessitated by architectural controls and the construction process. The measurements adhere to the rules and regulations of the TARION Warranty Corporation's official method for the calculation of floor area. Materials, specifications and floor plans are subject to change without notice. All house renderings are artist's concept only. Actual usable floor space may vary from the stated floor area. All options shown are upgrades. E. & O. E.

SCHEDULE "B-1" - Page 3 of 3

Initials: DSB