

**Kingsmen (Thames) Inc. / Havelock Corners (Kingsmen)**

**Lot/Unit: 13    Phase/Building: 4A    Model/Floor Plan: Edward (3602) Elev C 4 Bed - 2+1 Bath**

**CABINETRY**

**CABINETRY ACCESSORIES**

**CABINETRY BASE CABINETS**

**CABINETRY MICROWAVE OVEN STOVE COOKTOP**

**CABINETRY PANTRY**

**CABINETRY VANITY**

**CABINETRY WALL AND HUTCH**

**CARPET**

**COUNTER TOP**

**COUNTER TOP - EXTRAS**

**COUNTER TOP - KITCHEN**

**ELECTRICAL**

**HARDWOOD**

**HEATING AND AIR CONDITIONING**

**MISCELLANEOUS**

Inv. 4758	1 - Relocate the microwave shelf and electrical outlet for future microwave in the kitchen... see sketch # 4 ( this upgrade doesn't fit the original location requested )	
Line 61005	Note: This upgrade was purchased during the strcutural appointment dated April 29, 2020 extra no: 23 & 24.	
24Sep20 / 24Sep20		

**PAINT AND DRYWALL**

**PLUMBING**

**RAILING**

**TILE - FLOOR**

**TRIM**

**EXTRAS AS PER OFFER**

LOT:13 Thomas 9A

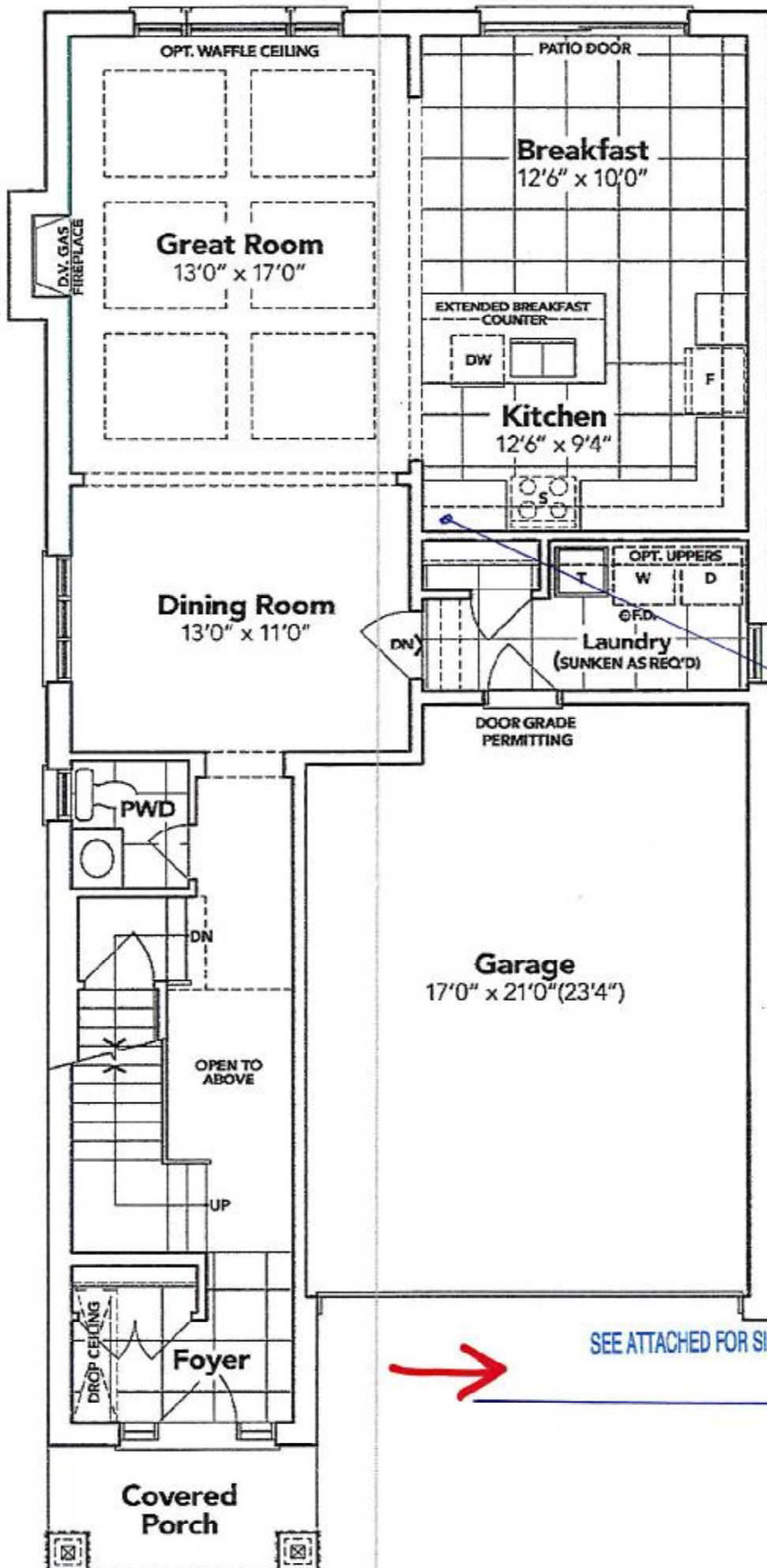

\*New location of Micro. Shelf + Outlet Only \*

microwave shelf + outlet.

SEE ATTACHED FOR SIGNATURES

GROUND FLOOR EL. C

floor plans and elevations shown are pre-construction plans and may be revised or improved as necessitated by architectural controls and the construction process. The measurements adhere to the rules and regulations of the TARIION Warranty Corporation's official method for the calculation of floor area. Materials, specifications and floor plans are subject to change without notice. All house drawings are artist's concept only. Actual usable floor space may vary from the stated floor area. All options shown are upgrades. & O. E.