

Kingsmen (Thames) Inc. / Havelock Corners (Kingsmen)

Lot/Unit: 9 Phase/Building: 4A Model/Floor Plan: John (4201) Elev A 4 Bed - 2+1 Bath

CABINETRY

CABINETRY ACCESSORIES

CABINETRY BASE CABINETS

CABINETRY HOOD FANS

CABINETRY MICROWAVE OVEN STOVE COOKTOP

CABINETRY VANITY

COUNTER TOP

COUNTER TOP - KITCHEN

Inv.4734	1 - To supply & install the COUNTER TOP - KITCHEN - KITCHEN - 3CM COUNTER TOP - UPGRADE LEVEL 2 in lieu of the standard quartz countertop in the kitchens, see colour chart for details.	
Line 60357	Note: Still to install the standard under mount kitchen sink with standard kitchen faucet.	
31Aug20 / 31Aug20		

ELECTRICAL

FIREPLACE

Inv.4734	1 - Purchaser has upgraded the Fireplace mantle during the structural appointment, see paper work dated May 20,2020	
Line 60362	Note:	
31Aug20 / 31Aug20		

HARDWOOD

Inv.4734	1 - To supply & install the STAINED KENTWOOD PROGRESSIVES OAK 3 1/2" - - UPPER HALL in lieu of the standard carpet... see colour chart for details	
Line 60358	Note:	
31Aug20 / 31Aug20		

HEATING AND AIR CONDITIONING

MISCELLANEOUS

Inv.4734	1 - Purchaser selected their interior finishes on August 31, 2020.	
Line 60356	Note:	
31Aug20 / 31Aug20		

PLUMBING

Inv.4734	5 - To supply & install the CONTRAC Calvin oval under mount sink in the powder room, master ensuite and main bathroom in lieu of the standard sinks. see spec's attached.	
Line 60360	Note: Still to install the standard faucets.	
31Aug20 / 31Aug20		



CONSTRUCTION SUMMARY

Kingsmen (Thames) Inc. / Havelock Corners (Kingsmen)

Lot/Unit: 9 Phase/Building: 4A Model/Floor Plan: John (4201) Elev A 4 Bed - 2+1 Bath

Inv.4734	1 - To supply & install the MOEN soap dispenser model 3942 in CHROME in the kitchen... see specs attached, see sketch # 3 for location of soap dispenser	
Line 60361	Note:	
31Aug20 / 31Aug20		

RAILING

Inv.4734	1 - To supply & install the RAILING - UPGRADE 2 - METAL HANDRAIL WINDSOR IN OAK - PICKETS STEEL ½ INCH ROUND, SINGLE SPOON/PLAIN, WITH SHOES IN GUNMETAL - POSTS 3½ INCH SQUARE, CHAMFERED, WITH CAP OAK IN OAK in lieu of the standard pickets and rails.	
Line 60359	Note:	
31Aug20 / 31Aug20		

EXTRAS AS PER OFFER

Purchaser: HARDEEP K SANDHU

Property: 9 of Plan - Draft Approval SB17-03-08

Telephone Res. / Bus: /

Project: Kingsmen (Thames) Inc.

Decor Advisor: Barbara Coccia

Model and Elevation: John (4201) Elev A 4 Bed - 2+1 Bath

Layout Changes: ☐ Yes ☒ No

Sketch Attached: ☐ Yes ☒ No

Exterior Colour Scheme:

1. Cabinetry

	Style and Colour	Counter Top	Hardware
Kitchen / Breakfast	Cape Code Paint Orchid	UPG#2 C/S #4600 Organic White	Handle 12881
Kitchen Island	Cape Code Paint Orchid	UPG#2 C/S #4600 Organic White	Handle 12881
Laundry Room	/	/	/
Powder Room	Cape Code Paint Orchid	#1 C/S #3040 Cement 2cm	Knob 135
Main Bathroom	Cape Code Paint Orchid	#1 C/S #3040 Cement 2cm	Knob 135
Master Ensuite Bathroom	Cape Code Paint Orchid	#1 C/S #6041 Nordic Loft 2cm	Knob 135
Second Ensuite Bathroom (If Applicable)	/	/	/
	/	/	/
	/	/	/

Appliances

Custom Size Fridge

☐ Yes ☒ No

Valance Lighting

☒ Yes ☐ No

Microwave / Range Hood

☐ Yes ☒ No

Cooktop / Rangetop

☐ Yes ☒ No

Built in Wall Oven

☐ Yes ☒ No

Slide-in Range

☐ Yes ☒ No

Comment

Purchaser has upgraded to the lower valance trim with no rough in wires or lights during the structural appointment dated May 20, 2020.

Upgraded Counter top in the kitchen/breakfast and kitchen island is to be installed 3cm thick.

2. Flooring

	Selection
Foyer	13x13" Malena Ice
Main Hall	3 1/2" Elements Oak Sturgeon
Back Hall	/
Breakfast	13x13" Malena Ice
Laundry Room	13x13" Malena Ice
Kitchen	13x13" Malena Ice
Powder Room	13x13" Malena Ice
Main Bathroom	13x13" Malena Ice
Master Ensuite	13x13" Malena Ivory
Bathroom (If Applicable)	/
Mud Room	13x13" Malena Ice
Master Ens. Shower Floor	2x2" Soho White Matte
Living Room	Formal Room: 3 1/2" Elements Oak Sturgeon
Dining Room	/
Family / Great Room	3 1/2" Elements Oak Sturgeon
Den / Library / Study	/
Basement Landing (If Applies)	
Lower Landing (If Applicable)	3 1/2" Elements Oak Sturgeon
Upper Landing	3 1/2" Elements Oak Sturgeon
Upper Hall	3 1/2" Elements Oak Sturgeon
Master Bedroom	Stylish Story 1- 945 Felt Hat
Bedroom #2	Stylish Story 1- 945 Felt Hat
Bedroom #3	Stylish Story 1- 945 Felt Hat
Bedroom #4	Stylish Story 1- 945 Felt Hat
Bedroom #5	/
Master Ens. Shower Jamb	Anatolia Marmiline Snow

SEE ATTACHED FOR SIGNATURES

Flooring Continued on Page 2

Initial: 

Page 1 of 3

4A-1019



Purchaser: HARDEEP K SANDHU

Property: 9 of Plan - Draft Approval SB17-03-08

Telephone Res. / Bus: /

Project: Kingsmen (Thames) Inc.

Decor Advisor: Barbara Coccia

Model and Elevation: John (4201) Elev A 4 Bed - 2+1 Bath

2. Flooring - Continued -

Upgrade Underpad	Type	Area
	STD	Master, Bedroom #2, #3 & #4
Carpet on Stairs	Capped	Runner - *Upgrade
	/	/
Comment		
/		

3. Plumbing Fixtures / Faucets

Kitchen	STD	Second Ensuite	/	Powder Room	STD
Master Ensuite	STD			Other Room	/
Main Bathroom	STD				

Comment

Still to install standard kitchen undermount sink and faucet. Purchaser has upgraded all bathroom sinks (Powder room, master ensuite and main bathroom), see invoice for details, still to install standard bathroom faucets

4. Wall Tile

	Tile Selection	Listello	Insert	Insert Selection
Main Bathroom	8x10" Malena Ice	<input type="checkbox"/>	<input type="checkbox"/>	/
Master Ensuite				
Tub Deck	/	<input type="checkbox"/>	<input type="checkbox"/>	/
Tub Apron	/	<input type="checkbox"/>	<input type="checkbox"/>	/
Tub Surround	/	<input type="checkbox"/>	<input type="checkbox"/>	/
Shower Stall	8x10" Malena Ivory	<input type="checkbox"/>	<input type="checkbox"/>	/
Second Ensuite	/	<input type="checkbox"/>	<input type="checkbox"/>	/
	/	<input type="checkbox"/>	<input type="checkbox"/>	/
	/	<input type="checkbox"/>	<input type="checkbox"/>	/
Kitchen Backsplash	/	<input type="checkbox"/>	<input type="checkbox"/>	/
Complete Backsplash	/	<input type="checkbox"/>	<input type="checkbox"/>	/

Comment

/

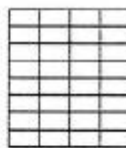

horizontal stacked

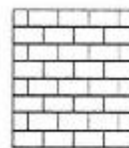

brick pattern



vertical stacked



diagonal/diamond

5. Fireplace

	Living Room			Family Room			Other Room - Specify		
	Purchased	As Per Plan	N/A	Purchased	As Per Plan	N/A	Purchased	As Per Plan	N/A
Fireplace Type	<input type="radio"/>	<input type="radio"/>	<input type="radio"/>	<input type="radio"/>	<input type="radio"/>	<input type="radio"/>	<input checked="" type="radio"/>	<input type="radio"/>	<input type="radio"/>
Mantle Type							Front Facing		
Over Mantle							**EFS1 Mantle		
Colour / Stain							White		
Surround							/		
Hearth							/		
Comment									

Purchaser has upgraded the mantle during the structural appointment dated May 20, 2020.

SEE ATTACHED FOR SIGNATURES



Initial: _____

Page 2 of 3

Purchaser: HARDEEP K SANDHU

Property: 9 of Plan - Draft Approval SB17-03-08

Telephone Res. / Bus: /

Project: Kingsmen (Thames) Inc.

Decor Advisor: Barbara Coccia

Model and Elevation: John (4201) Elev A 4 Bed - 2+1 Bath

6. Trim Carpentry

Door Hardware STD

Interior Trim STD

Comment

Interior Doors

☐ 2 Panel Arch Top

☒ 2 Panel Square Top

☐ 6 Panel

Initial for Door Style



7. Railings and Pickets

Railing Package UPG #2 Metal Package

Railing Colour Elements Sturgeon

Wood Stairs ☐ No ☒ Oak

Picket Colour Gunmetal

Tread Colour Elements Sturgeon

Comment

SEE ATTACHED FOR SIGNATURES

8. Plaster Mouldings and Medallions

Foyer /

Main Hall /

Living Room /

Dining Room /

Family Room /

Kitchen/Breakfast /

Den/Library /

Lower Landing /

Comment

9. Wall Paint

Kingsmen White

Smooth Ceilings

☐ First Floor

☐ First Floor incl. Second Floor Hall

☐ First and Second Floor

☒ Throughout

☐ Not Applicable

Trim Paint Kingsmen White

10. Additional Comments

11. Disclaimers and Notes

- Colours of all materials are as close as possible to builder's selection, but not necessarily identical due to variances in manufacturing.
- Any extras listed above are null and void unless accompanied by a separate invoice/amendment. Said invoice must be paid in full.
- The Purchaser acknowledges that after Interior Colour Selection form is signed and dated, no further changes will be permitted other than re-selection due to unavailability. *Purchaser's Initials* *SEE ATTACHED FOR SIGNATURES*
- The Purchaser acknowledges reading and accepting the "Kingsmen Group Décor Centre Disclaimers" form. This document contains other miscellaneous disclaimers.

This Interior Colour Selection is final and approved by:

Purchaser:

Signature: *SEE ATTACHED FOR SIGNATURES* **Date:** _____

Vendor: _____

Kingsmen (Thames) Inc.

SCHEDULE "B-1"
Floor Plan

Lot 9
Phase 4A
Model: John (4201) Elev A 4 Bed - 2+1 Bath
Standard

Sketch #3
Re: Soap dispenser
location Only.

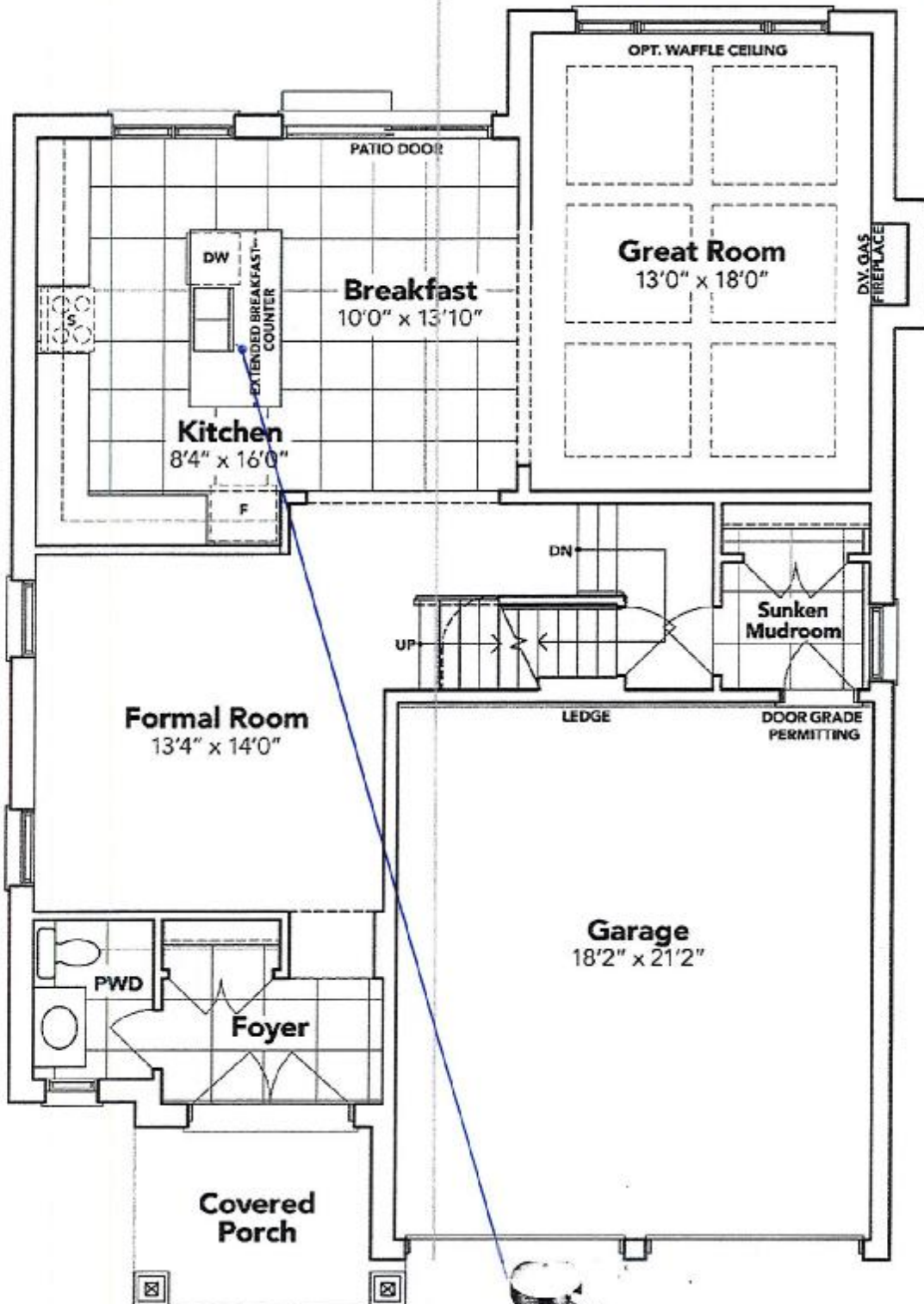

SEE ATTACHED FOR SIGNATURES

GROUND FLOOR EL. A

**Soap or Lotion
Dispenser**

Model 3942
Not available in GRB

Chrome - \$282.19

The floor plans and elevations shown are pre-construction plans and may be revised or improved as necessitated by architectural controls and the construction process. The measurements adhere to the rules and regulations of the TARION Warranty Corporation's official method for the calculation of floor area. Materials, specifications and floor plans are subject to change without notice. All house renderings are artist's concept only. Actual usable floor space may vary from the stated floor area. All options shown are upgrades. E. & O. E.

PH4A-147
Lot: 9 Thames Ph: 4A
Re: Undermount Sinks for Powder Room, Main &
Master Ens. Bathrooms.
- Still to install Sld. Bathroom faucets. (25)



19 1/4" OVAL UNDERMOUNT SINK

Undermount Sink

COMPLIANCE CERTIFICATIONS

- Meets or exceeds the following:
- APMO cUPC
 - ASME A112.19.2 / CSA B45.1

SHIPPING

Cube	1.53
GW	19 lbs

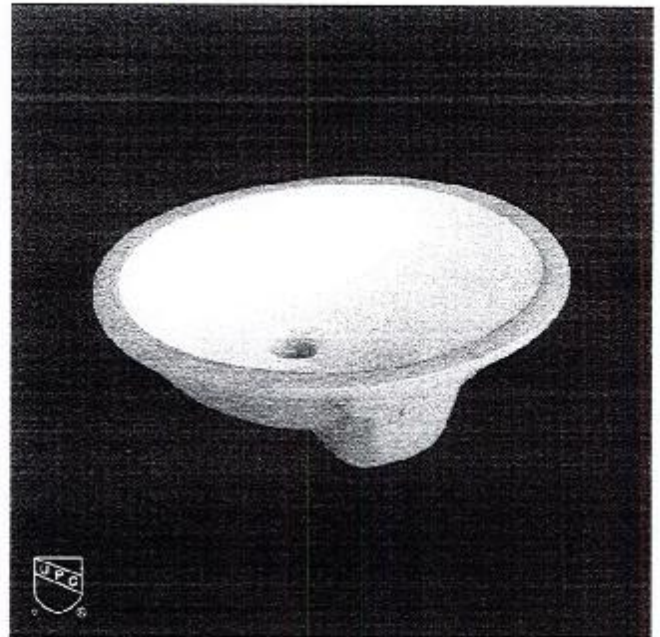

TO BE SPECIFIED

■ Soft White

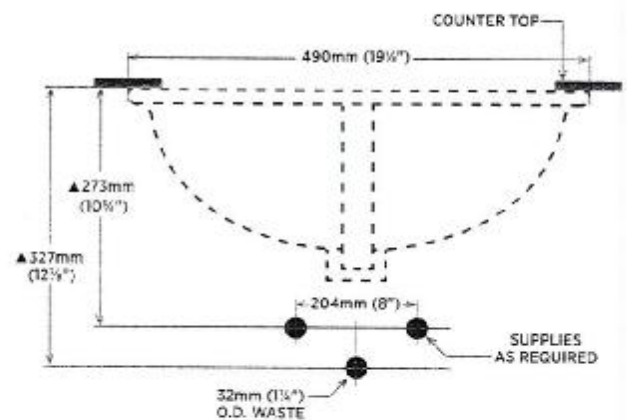
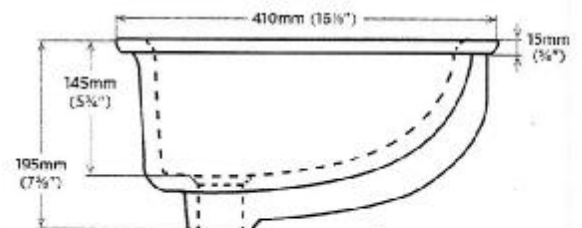

▲ Dimensions shown for location of supplies and "P" trap are suggested.