

Kingsmen (Thames) Inc. / Havelock Corners (Kingsmen)

Lot/Unit: 42    Phase/Building: 4A    Model/Floor Plan: James (3601) Elev A 4 Bed - 2+1 Bath

ELECTRICAL

HEATING AND AIR CONDITIONING

MISCELLANEOUS

Inv.4719	1 - Purchaser has selected their interior finishes on Aug. 18, 2020.	
Line 60268	Note:	
18Aug20 / 18Aug20		

RAILING

Inv.4719	1 - To supply and Install RAILING - UPGRADE 1 - METAL HANDRAIL 3 INCH OVAL IN OAK - PICKETS STEEL ½ INCH SQUARE, PLAIN, WITH SHOES IN FLAT BLACK - POSTS 3½ INCH SQUARE, WITH CAP OAK IN OAK in lieu of standard.	
Line 60274	Note:	
18Aug20 / 18Aug20		

TILE - FLOOR

Inv.4719	1 - To supply and install UPGRADE 3 - FLOOR TILE - - FOYER TILE in lieu of standard floor tile, see colour chart for details. See sketch #3 for direction of tile.	
Line 60269	Note:	
18Aug20 / 18Aug20		
Inv.4719	1 - To supply and install UPGRADE 3 - FLOOR TILE - - HALL TILE in lieu of standard floor tile, see colour chart for details. See sketch #3 for direction of tile	
Line 60270	Note:	
18Aug20 / 18Aug20		
Inv.4719	1 - To supply and install UPGRADE 3- FLOOR TILE - - MUDROOM TILE in lieu of standard floor tile, see colour chart for details. See sketch #3 for direction of tile.	
Line 60271	Note:	
18Aug20 / 18Aug20		
Inv.4719	1 - To supply and install UPGRADE 3 -FLOOR TILE - - POWDER ROOM TILE in lieu of standard floor tile, see colour chart for details. See sketch #3 for direction of tile.	
Line 60272	Note:	
18Aug20 / 18Aug20		
Inv.4719	1 - To supply and install UPGRADE 3- FLOOR TILE - - KITCHEN/BREAKFAST TILE in lieu of standard floor tile, see colour chart for details. See sketch #3 for direction of tile.	
Line 60273	Note:	
18Aug20 / 18Aug20		

EXTRAS AS PER OFFER

CHA -  
Set 42

Purchaser: BALVIR GHATAURA

Property: 42 of Plan - Draft Approval SB17-03-08

Telephone Res. / Bus: /

Project: Kingsmen (Thames) Inc.

Decor Advisor: Barbara Coccia

Model and Elevation: James (3601) Elev A 4 Bed - 2+1 Bath

Layout Changes: ☐ Yes ☒ No

Sketch Attached: ☐ Yes ☒ No

Exterior Colour Scheme:

### 1. Cabinetry

	Style and Colour	Counter Top	Hardware
Kitchen / Breakfast	#3 Charleston 3DL Rain Cloud	Italian White Di Pesco 4954K-22	Handle 12881
Kitchen Island	#3 Charleston 3DL Rain Cloud	Italian White Di Pesco 4954K-22	Handle 12881
Laundry Room	/	/	/
Powder Room	#3 Charleston 3DL Rain Cloud	Italian White Di Pesco 4954K-22	Handle 12881
Main Bathroom	#3 Trinity Viva Sunset Cruise	Inukshuk Taupe P-345-LM	Handle 12881
Master Ensuite Bathroom	#3 Trinity Viva Weekend Getaway	Inukshuk Grey P-344-LM	Handle 12881
Second Ensuite Bathroom (If Applicable)	/	/	/
	/	/	/
	/	/	/

### Appliances

Custom Size Fridge

☐ Yes ☒ No

Valance Lighting

☐ Yes ☒ No

Microwave / Range Hood

☐ Yes ☒ No

Cooktop / Rangetop

☐ Yes ☒ No

Built in Wall Oven

☐ Yes ☒ No

Slide-in Range

☐ Yes ☒ No

Comment

/

### 2. Flooring

	Selection
Foyer	***UPG #3 12X24" Mayfair Suave Bianco HD Polished Rect. Porcelain STACKED
Main Hall	***UPG #3 12X24" Mayfair Suave Bianco HD Polished Rect. Porcelain STACKED
Back Hall	/
Breakfast	***UPG #3 12X24" Mayfair Suave Bianco HD Polished Rect. Porcelain STACKED
Laundry Room	13x13" Bellina Grey
Kitchen	***UPG #3 12X24" Mayfair Suave Bianco HD Polished Rect. Porcelain STACKED
Powder Room	***UPG #3 12X24" Mayfair Suave Bianco HD Polished Rect. Porcelain STACKED
Main Bathroom	13x13" Bellina Grey
Master Ensuite Bathroom (If Applicable)	13x13" Keaton Ice
Mud Room	***UPG #3 12X24" Mayfair Suave Bianco HD Polished Rect. Porcelain STACKED
Master Ens. Shower Floor	2x2" Soho White Matte
Living Room	/
Dining Room	/
Family / Great Room	3 1/2" Elements Natural Oak
Den / Library / Study	/
Basement Landing (If Applies)	/
Lower Landing (If Applicable)	3 1/2" Elements Natural Oak
Upper Landing	3 1/2" Elements Natural Oak
Upper Hall	Stylish Story 1- 929 Mink
Master Bedroom	Stylish Story 1- 929 Mink
Bedroom #2	Stylish Story 1- 929 Mink
Bedroom #3	Stylish Story 1- 929 Mink
Bedroom #4	Stylish Story 1- 929 Mink
Bedroom #5	/
Master Ens. Shower Jamb	Anatolia Marmiline Snow

Flooring Continued on Page 2

Initial:



Page 1 of 3

Purchaser: BALVIR GHATAURA

Property: 42 of Plan - Draft Approval SB17-03-08

Telephone Res. / Bus: /

Project: Kingsmen (Thames) Inc.

Decor Advisor: Barbara Coccia

Model and Elevation: James (3601) Elev A 4 Bed - 2+1 Bath

## 2. Flooring - Continued -

Upgrade Underpad	Type	Area
	STD	2nd Floor
Carpet on Stairs	Capped	Runner - *Upgrade
Comment	/	/

## 3. Plumbing Fixtures / Faucets

Kitchen	STD	Second Ensuite	/	Powder Room	STD
Master Ensuite	STD			Other Room	/
Main Bathroom	STD		/		

Comment

## 4. Wall Tile

	Tile Selection	Listello	Insert	Insert Selection
Main Bathroom	8x10" Bellina Grey	<input type="checkbox"/>	<input type="checkbox"/>	/
Master Ensuite				
Tub Deck	13x13" Keaton Ice	<input type="checkbox"/>	<input type="checkbox"/>	/
Tub Apron	13x13" Keaton Ice	<input type="checkbox"/>	<input type="checkbox"/>	/
Tub Surround	13x13" Keaton Ice	<input type="checkbox"/>	<input type="checkbox"/>	/
Shower Stall	8x10" Keaton Ice <i>Carbon Be</i>	<input type="checkbox"/>	<input type="checkbox"/>	/
Second Ensuite	/	<input type="checkbox"/>	<input type="checkbox"/>	/
	/	<input type="checkbox"/>	<input type="checkbox"/>	/
	/	<input type="checkbox"/>	<input type="checkbox"/>	/
Kitchen Backsplash	/	<input type="checkbox"/>	<input type="checkbox"/>	/
Complete Backsplash	/	<input type="checkbox"/>	<input type="checkbox"/>	/

Comment

To install all wall tiles in the master and main bathroom on the 10" side stacked horizontally where applicable.



horizontal stacked

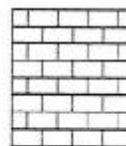

brick pattern



vertical stacked



diagonal/diamond

## 5. Fireplace

## Living Room

Purchased As Per Plan N/A



## Family Room

Purchased As Per Plan N/A



## Other Room - Specify Great Room

Purchased As Per Plan N/A



Fireplace Type

Mantle Type

Over Mantle

Colour / Stain

Surround

Hearth

Comment

Front Facing

NF-08

/

White

/

/



Purchaser: BALVIR GHATAURA

Property: 42 of Plan - Draft Approval SB17-03-08

Telephone Res. / Bus: /

Project: Kingsmen (Thames) Inc.

Decor Advisor: Barbara Coccia

Model and Elevation: James (3601) Elev A 4 Bed - 2+1 Bath

### 6. Trim Carpentry

Door Hardware

Interior Trim

Comment

/

#### Interior Doors

☐ 2 Panel Arch Top

☒ 2 Panel Square Top

☐ 6 Panel



Initial for Door Style 

### 7. Railings and Pickets

Railing Package

Railing Colour  Picket Colour

Wood Stairs ☐ No ☒ Oak Tread Colour

Comment

See invoice for details.

### 8. Plaster Mouldings and Medallions

Foyer

Main Hall

Living Room

Dining Room

Family Room

Comment

/

### 9. Wall Paint

Kingsmen White

Smooth Ceilings ☐ First Floor  
☐ First Floor incl. Second Floor Hall  
☐ First and Second Floor  
☒ Throughout  
☐ Not Applicable

Trim Paint

### 10. Additional Comments

/

### 11. Disclaimers and Notes

- Colours of all materials are as close as possible to builder's selection, but not necessarily identical due to variances in manufacturing.
- Any extras listed above are null and void unless accompanied by a separate invoice/amendment. Said invoice must be paid in full.
- The Purchaser acknowledges that after Interior Colour Selection form is signed and dated, no further changes will be permitted other than re-selection due to unavailability.  Purchaser's Initials
- The Purchaser acknowledges reading and accepting the "Kingsmen Group Décor Centre Disclaimers" form. This document contains other miscellaneous disclaimers.

This Interior Colour Selection is final and approved by:

Purchaser:

Signature: Balvir K. Ghataura Date: Aug 18, 2020

Vendor:

Kingsmen (Thames) Inc.

**SCHEDULE "B-1"**  
**Floor Plan**

Lot 42  
Phase 4A  
Model: James (3601) Elev A 4 Bed - 2+1 Bath  
Standard

*Sketch #3*

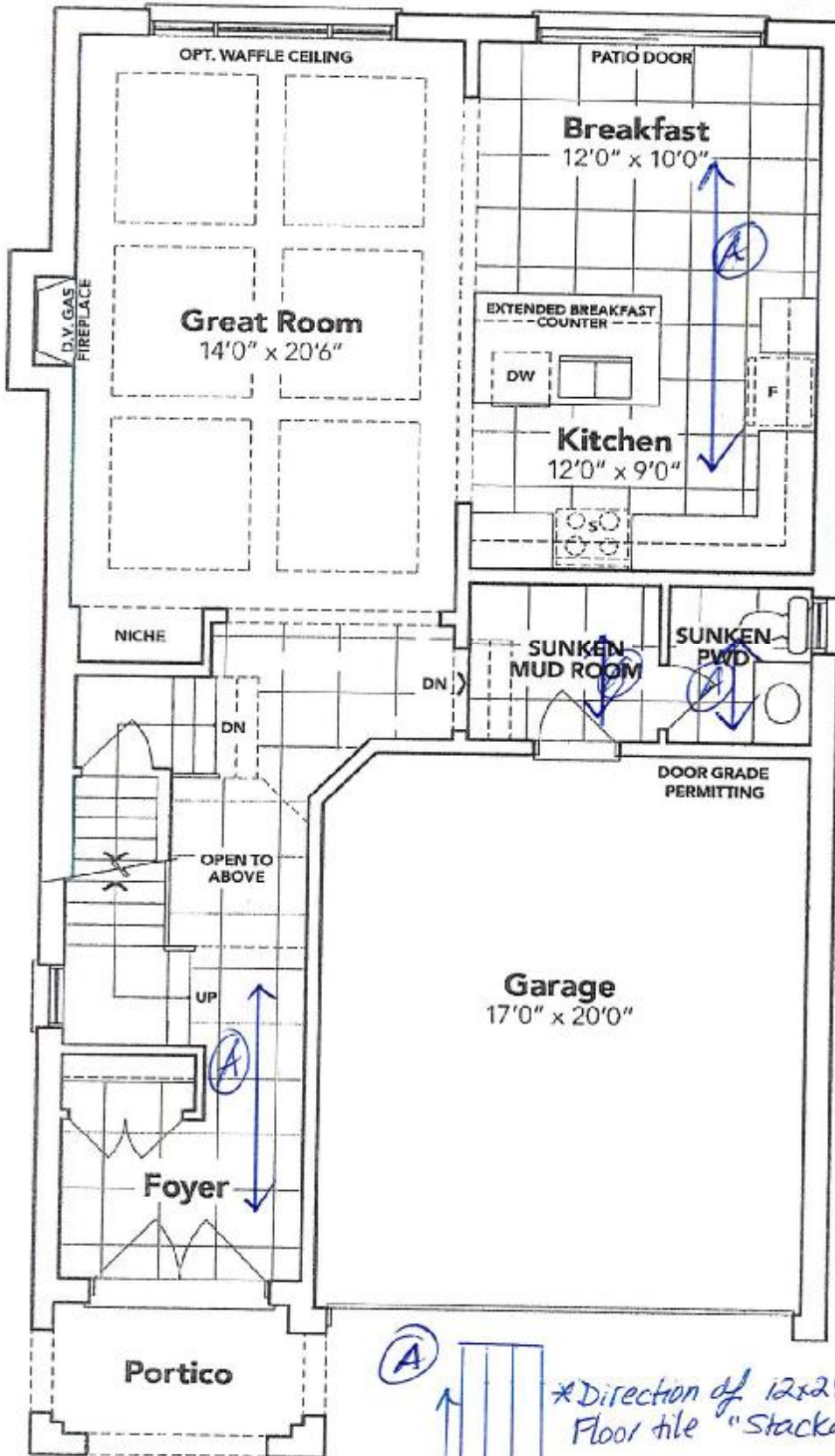

*Re:  
Direction  
of upg.  
tile only.*

*\*Direction of 12x24" UPG.  
Floor tile "Stacked"*

*Balwin K. Ghutaurer*

**GROUND FLOOR EL. A**

The floor plans and elevations shown are pre-construction plans and may be revised or improved as necessitated by architectural controls and the construction process. The measurements adhere to the rules and regulations of the TARION Warranty Corporation's official method for the calculation of floor area. Materials, specifications and floor plans are subject to change without notice. All house renderings are artist's concept only. Actual usable floor space may vary from the stated floor area. All options shown are upgrades, E. & O. E.