



CONSTRUCTION SUMMARY

Kingsmen (Thames) Inc. / Havelock Corners (Kingsmen)

Lot/Unit: 4 Phase/Building: 4A Model/Floor Plan: Spencer (4204) Elev B 4 Bed - 4+1 Bath

CABINETRY

ELECTRICAL

HEATING AND AIR CONDITIONING

MISCELLANEOUS

Inv.4718	1 - Purchaser has selected their interior finishes on Aug. 17, 2020.	
Line 60260	Note:	
17Aug20 / 17Aug20		

PLUMBING

Inv.4718	1 - To supply & install the MOEN soap dispenser Model: 3942 in chrome in the kitchen... see sketch #3 for location and spec's.	
Line 60266	Note:	
17Aug20 / 17Aug20		

TILE - FLOOR

Inv.4718	1 - To supply & install the UPGRADE 4 - FLOOR TILE - - FOYER TILE in lieu of the standard floor tiles... see colour chart for details.	
Line 60261	Note:	
17Aug20 / 17Aug20		
Inv.4718	1 - To supply & install the UPGRADE 4 - FLOOR TILE - MUDROOM TILE in lieu of the standard floor tiles... see colour chart for details.	
Line 60262	Note:	
17Aug20 / 17Aug20		
Inv.4718	1 - To supply & install the UPGRADE 4 - FLOOR TILE - POWDER ROOM TILE in lieu of the standard floor tiles... see colour chart for details.	
Line 60263	Note:	
17Aug20 / 17Aug20		
Inv.4718	1 - To supply & install the UPGRADE 4 - FLOOR TILE - KITCHEN/BREAKFAST TILE in lieu of the standard floor tiles... see colour chart for details.	
Line 60264	Note:	
17Aug20 / 17Aug20		
Inv.4718	1 - To supply & install the upgrade 4, 24 x 24" tile to the main floor hallway(s) in lieu of the standard hardwood... see colour chart for details.... sketch #3	
Line 60265	Note:	
17Aug20 / 17Aug20		

EXTRAS AS PER OFFER

4A -
Lot 4

Purchaser: Gangandeep Singh

Property: 4 of Plan - Draft Approval SB17-03-08

Telephone Res. / Bus: /

Project: Kingsmen (Thames) Inc.

Decor Advisor: Barbara Coccia

Model and Elevation: Spencer (4204) Elev B 4 Bed - 4+1 Bath

Layout Changes: ☐ Yes ☒ No

Sketch Attached: ☐ Yes ☒ No

Exterior Colour Scheme:

1. Cabinetry

	Style and Colour	Counter Top	Hardware
Kitchen / Breakfast	#3 Slab LPL Spring Blossom	#1 C/S #9141 Ice Snow 3cm	12881 Handle
Kitchen Island	#3 Slab LPL Spring Blossom	#1 C/S #9141 Ice Snow 3cm	12881 Handle
Laundry Room	/	/	/
Powder Room	#3 Slab LPL Spring Blossom	Calcutta Marble 4925K-07	12881 Handle
Main Bathroom	/	/	/
Master Ensuite Bathroom	#5 Humber Coffee Bean	Italian White Di Pesco 4954K-22	9671 Handle
Second Ensuite Bathroom (If Applicable)	#5 Humber Coffee Bean	Italian White Di Pesco 4954K-22	9671 Handle
Bed #3's Bathroom	#5 Humber White Sugar	Autumn Carnival 1877K-52	9671 Handle
Bed #4's Bathroom	#5 Humber White Sugar	Autumn Carnival 1877K-52	9671 Handle

Appliances

Custom Size Fridge

☒ Yes ☐ No

Valance Lighting

☐ Yes ☒ No

Microwave / Range Hood

☐ Yes ☒ No

Cooktop / Rangetop

☐ Yes ☒ No

Built in Wall Oven

☐ Yes ☒ No

Slide-in Range

☐ Yes ☒ No

Comment

Fridge spec's were provided at the time of the structural appointment dated May 27, 2020.

2. Flooring

Selection

Foyer	****UPG #4, 24x24" Mayfair Calacatta Oro HD Polished
Main Hall	****UPG #4, 24x24" Mayfair Calacatta Oro HD Polished
Back Hall	/
Breakfast	****UPG #4, 24x24" Mayfair Calacatta Oro HD Polished
Laundry Room	13x13 Bellina Grey ✓
Kitchen	****UPG #4, 24x24" Mayfair Calacatta Oro HD Polished
Powder Room	****UPG #4, 24x24" Mayfair Calacatta Oro HD Polished
Main Bathroom	Bed #2's Bathroom: 13x13" Bellina Grey Sh/Fl: 2x2" Soho White Matte
Master Ensuite	13x13" Bellina Grey Sh/Fl: 2x2" Soho White Matte
Bathroom (If Applicable)	Bed #3's Bathroom: 13x13" Keaton Ice
Mud Room	****UPG #4, 24x24" Mayfair Calacatta Oro HD Polished
Bed #4's Bathroom	13x13" Keaton Ice
Living Room	/
Dining Room	3 1/2" Elements Oak Talon
Family / Great Room	3 1/2" Elements Oak Talon
Den / Library / Study	/
Basement Landing (If Applies)	
Lower Landing (If Applicable)	3 1/2" Elements Oak Talon
Upper Landing	3 1/2" Elements Oak Talon
Upper Hall	Stylish Story 1- 929 Mink (Including Media Niche)
Master Bedroom	Stylish Story 1- 929 Mink
Bedroom #2	Stylish Story 1- 929 Mink
Bedroom #3	Stylish Story 1- 929 Mink
Bedroom #4	Stylish Story 1- 929 Mink
Bedroom #5	/
Shower Jamb:	Master ens: Anatolia Marmiline Snow Bed #2 Bathroom: Anatolia Marmiline Snow ✓

Flooring Continued on Page 2

Initial:



Page 1 of 3

Purchaser: Gangandeep Singh

Property: 4 of Plan - Draft Approval SB17-03-08

Telephone Res. / Bus: /

Project: Kingsmen (Thames) Inc.

Decor Advisor: Barbara Coccia

Model and Elevation: Spencer (4204) Elev B 4 Bed - 4+1 Bath

2. Flooring - Continued -

Upgrade Underpad	Type	Area
	STD	2nd floor
Carpet on Stairs	Capped	Runner - *Upgrade
Comment	/	/

3. Plumbing Fixtures / Faucets

Kitchen	STD	Second Ensuite	STD	Powder Room	STD
Master Ensuite	STD			Powder Room	/
Main Bathroom	/	Bed #3 & #4 Bathroom	STD		

Comment

Upgraded soap dispenser, see invoice for details. Still to install the standard under mount kitchen sink and standard kitchen faucet.

4. Wall Tile

	Tile Selection	Listello	Insert	Insert Selection
Main Bathroom	/	<input type="checkbox"/>	<input type="checkbox"/>	/
Master Ensuite				
Tub Deck	/	<input type="checkbox"/>	<input type="checkbox"/>	/
Tub Apron	/	<input type="checkbox"/>	<input type="checkbox"/>	/
Tub Surround	/	<input type="checkbox"/>	<input type="checkbox"/>	/
Shower Stall	8X10" Bellina Grey	<input type="checkbox"/>	<input type="checkbox"/>	/
Second Ensuite	8X10" Bellina Grey	<input type="checkbox"/>	<input type="checkbox"/>	/
Bed #3's Bathroom	8x10" Keaton Ice	<input type="checkbox"/>	<input type="checkbox"/>	/
Bed #4's Bathroom	8x10" Keaton Ice	<input type="checkbox"/>	<input type="checkbox"/>	/
Kitchen Backsplash	/	<input type="checkbox"/>	<input type="checkbox"/>	/
Complete Backsplash	/	<input type="checkbox"/>	<input type="checkbox"/>	/

Comment

To install all wall tiles in all washrooms on the 10" side horizontally, STACKED where applicable.

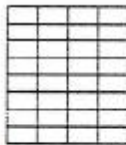

horizontal stacked

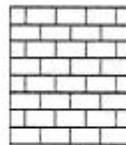

brick pattern



vertical stacked

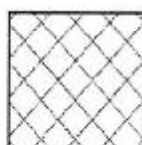

diagonal/diamond

5. Fireplace

	Living Room			Family Room			Other Room - Specify Great Room		
	Purchased	As Per Plan	N/A	Purchased	As Per Plan	N/A	Purchased	As Per Plan	N/A
Fireplace Type	<input type="radio"/>	<input type="radio"/>	<input checked="" type="radio"/>	<input type="radio"/>	<input type="radio"/>	<input checked="" type="radio"/>	<input type="radio"/>	<input checked="" type="radio"/>	<input type="radio"/>
Mantle Type									
Over Mantle									
Colour / Stain									
Surround									
Hearth									
Comment	/								

Initial: 

Page 2 of 3

4A-
J+cf

Purchaser: Gangandeep Singh

Property: 4 of Plan - Draft Approval SB17-03-08

Telephone Res. / Bus: /

Project: Kingsmen (Thames) Inc.

Decor Advisor: Barbara Coccia

Model and Elevation: Spencer (4204) Elev B 4 Bed - 4+1 Bath

6. Trim Carpentry

Door Hardware

Interior Trim

Comment

Interior Doors

☐ 2 Panel Arch Top

☒ 2 Panel Square Top

☐ 6 Panel



Initial for Door Style

7. Railings and Pickets

Railing Package

Railing Colour

Picket Colour

Wood Stairs ☐ No ☒ Oak

Tread Colour

Comment

8. Plaster Mouldings and Medallions

Foyer

Kitchen/Breakfast

Main Hall

Den/Library

Living Room

Lower Landing

Dining Room

Family Room

Comment

9. Wall Paint

Smooth Ceilings

☐ First Floor

☐ First Floor incl. Second Floor Hall

☐ First and Second Floor

☒ Throughout

☐ Not Applicable

Trim Paint

10. Additional Comments

11. Disclaimers and Notes

- Colours of all materials are as close as possible to builder's selection, but not necessarily identical due to variances in manufacturing.
- Any extras listed above are null and void unless accompanied by a separate invoice/amendment. Said invoice must be paid in full.
- The Purchaser acknowledges that after Interior Colour Selection form is signed and dated, no further changes will be permitted other than re-selection due to unavailability.  Purchaser's Initials
- The Purchaser acknowledges reading and accepting the "Kingsmen Group Décor Centre Disclaimers" form. This document contains other miscellaneous disclaimers.

This Interior Colour Selection is final and approved by:

Purchaser:

Signature

Date:

17/8/20

Vendor:

Kingsmen (Thames) Inc.

SCHEDULE "B-1"
Floor Plan

Phase 4A
Model: Spencer (4204) Elev B 4 Bed - 4+1 Bath
Standard

LOT: 4
Sketch #3

Ri: Tiled hallway(s)
Reference only

& Soap dispenser
location

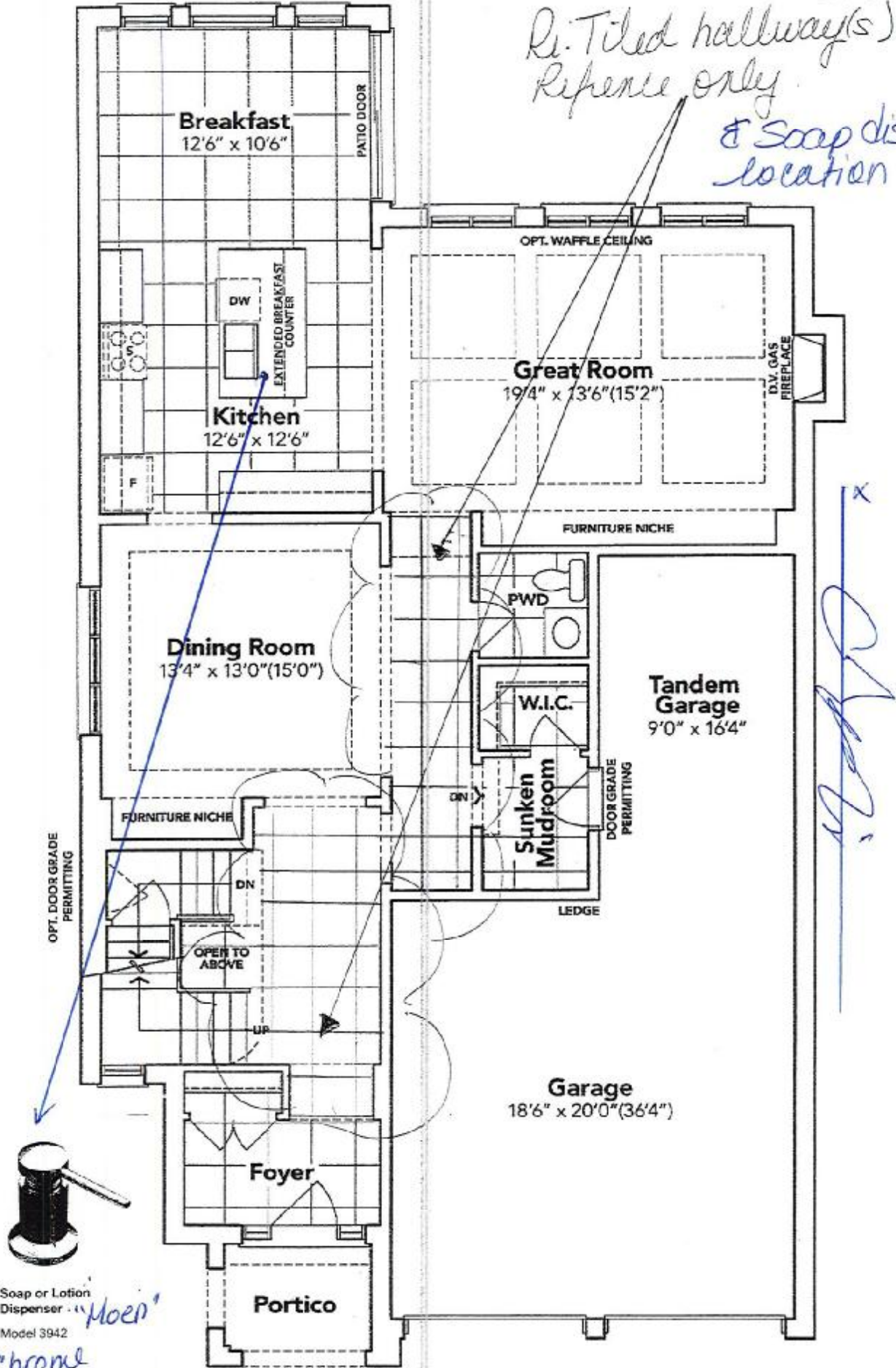

GROUND FLOOR EL. B

The floor plans and elevations shown are pre-construction plans and may be revised or improved as necessitated by architectural controls and the construction process. The measurements adhere to the rules and regulations of the TARION Warranty Corporation's official method for the calculation of floor area. Materials, specifications and floor plans are subject to change without notice. All house renderings are artist's concept only. Actual usable floor space may vary from the stated floor area. All options shown are upgrades. E. & O. E.

SCHEDULE "B-1" - Page 3 of 3

Initials: